

of the Wire

THE ASSOCIATED PRESS
NEWS FROM THE WORLD

LINDBERGH'S LAND
LIVERPOOL, Dec. 31. — The Linberghs, declared by members of the ship's crew to have left the United States to avoid the execution of Hauptmann, landed today in Liverpool. They went into seclusion at a hotel in downtown Liverpool. They cut down the gangplank and went directly to the Adelphia Hotel. They were escorted by a carload of detectives. Ship employees report Hauptmann as saying: "We are not going to Paris, we're staying in Liverpool." Whether he meant permanently or not is undetermined. The ship was swept through the lobby of the hotel without registering and the rooms, whose numbers are kept secret.

SILVER TALK
WASHINGTON, Dec. 31. — Secretary Morgenthau reported a successful talk in preliminary sessions with the Mexican delegation, now here.

EGYPTIAN RIOTS
CAIRO, Dec. 31. — New violence flared here today with the opening of the International Survey of the Congress. Two British officers escorting Premier Nessim's auto were roughly handled by a crowd yelling "Down England for Egyptians." The Egyptian minister of Justice was arrested, and the Premier prepared to leave the country after reaching the meeting place where students who rushed his car.

GANGSTER SLAIN
ST. LOUIS, Dec. 31. — Police today announced the slaying of a gangster, James Buckley, 26, and the slaying of Frank Sundberg, who is here on a "numbers racket." Police believed the same slayer shot both men last night. Buckley's body was deposited from the steps of a hospital, and Sundberg was found wounded in the same hospital.

Hauptmann ENCOURAGED
BOSTON, Dec. 31. — Hauptmann's counsel said today that Hauptmann was "very much encouraged" over his fight to escape from prison. Prison officials said he was nervous yesterday before the execution of a fellow inmate, the Johnson, negro, but they said his condition was "natural."

SLAYING MYSTERY
CHICAGO, Dec. 31. — Silence hampered efforts to solve the slaying of State Representative Albert Prignano. Albert Prignano, an automobile salesman, refused to tell police anything about the membership of the killer's car. Prignano said that Lazzia's employee handled the deal for the car which was sold to Sam Lazzia. Lazzia has not yet been found.

Today's Weather
 (Compiled by Blitha Scott)

| Temperature | | Weather |
|---------------|-------|---------|
| AM | PM | |
| 48 | 50 | Cloudy |
| 43 | 57 | Clear |
| 26 | 44 | Clear |
| 36 | 44 | Cloudy |
| 34 | 46 | Clear |
| 42 | 74 | Cloudy |
| 36 | 57 | Cloudy |
| 11 | 19 | Clear |
| 42 | 66 | Clear |
| 28 | 49 P. | Cloudy |
| 34 | 35 | Cloudy |
| (1 inch snow) | | |
| 12 | 20 P. | Cloudy |
| 35 | 52 | Clear |
| TODAY | | |
| 36 | 40 | Cloudy |

Memphis Democrat

THE VOICE OF THE UPPER RED RIVER VALLEY
 Your Home Paper
 WEEKLY DEMOCRAT EST. 1967
 DAILY DEMOCRAT EST. 1934

29th Year No. 205 AP SERVICE Memphis, Hall County, Texas, Tuesday, Dec. 31, 1935. * * Price 5 Cents

Tomorrow's Rose Bowl Contenders



Here's the Southern Methodist first team lineup that will face Stanford, Jan. 1, in the Rose Bowl. Backfield, left to right: Johnny Sprague, right half; Harry Shuford, quarterback; Bobby Wilson, left half; and Shelly Burt, fullback. Line: Capt. Maco Stewart, Maurice Orr, Billy Stamps, Art Johnson, Charles Baker, Truman Spain, and Bill Tipton.



Stanford's Big Red team, defeated two years in a row in the Rose Bowl, presents this lineup against S. M. U. Backfield, left to right: Bones Hamilton, blocking back; Jim Coffis, half; Bob Grayson, full; and Bill Paulman, quarter. Line: Keith Topping, Dale Beedle, Bob Reynolds, Wes Muller, Larry Rouble, Woody Adams, and Monk Moserip. A knee injury may keep Moserip out.

WILL BEAUTIFY CEMETERY HERE WITH TREES

Three Hundred Trees to Be Set Out in Fairview Cemetery

The Fairview Cemetery Association is planning a beautification campaign for the cemetery grounds, in which the planting of 300 trees will be the main item. The Association has agreed to furnish the trees if the lot owners will contribute to a fund to pay for the work of setting them out and watering them. Lot owners who are interested in the beautification program are urged to get in touch at once with H. B. Estes, secretary of the organization, who can explain the plan and its cost. If the lot owners are interested to the extent of donating trees, they should contact the secretary. (Continued on Page 8)

NEW ECW HEAD HAS ARRIVED

E. McBride Replaces Hull Here as Camp Superintendent

E. McBride has arrived in Memphis to take over the supervisory tendency of the Local Emergency Conservation Work camp. Mr. McBride, coming to Memphis from Lamesa, where he was technical foreman of the camp there, will replace George E. Hull, who leaves within the next day or two for Amarillo, where he has accepted a position with the regional Soil Conservation Service headquarters as aide to the chief engineer. Both SCS men are receiving promotions. Mr. McBride moves here tomorrow. (Continued on page 7)

M. E. MINISTER TO WASHINGTON

Rev. Carter to Attend General Missionary Council at Capital

Rev. Orion W. Carter, pastor of the First Methodist church here, will leave tomorrow for Washington, D. C., to attend the General Missionary Council of the Methodist Episcopal Church of the South, in session in Washington, January 7, 8, and 9. Delegates will represent various Annual Conference Boards of Missions. Rev. Carter will be delegate from the Northwest Texas conference. This meeting will bring together notable men of the ministry from over the world, including denominations other than Methodists. (Continued on page 8)

BOND JUMPER IS ARRESTED AT CHILDRESS

Return Lloyd Booth to Jail Here After Jumping Bond

Lloyd Booth, convicted of theft in District Court here and sentenced to two years in the penitentiary, is again in the local jail, after jumping his appeal bond. Booth's sentence was recently affirmed by the Court of Criminal Appeals, but when officers sought him he had left the county. Saturday he was apprehended in Childress by officers of Childress. (Continued on Page 8)

MACHINERY FOR IOOF BUILDING TEST DELAYED BY BURLINGTON

Railroad Fights Road Crossing Near the Knorpp Test Well

"Swede" Kemnitz, oil drilling contractor of the company of Johnson-Kemnitz, which is drilling the Knorpp No. 1 oil well in Hall County south of Parnell, was in Memphis yesterday conferring with Otho Fitzjarrald, Judge A. S. Moss and others here interested in the oil well development south of Red River. Mr. Kemnitz said that there are some objections to the proposed road crossing near the Knorpp test well. (Continued on Page 8)

IOOF BUILDING IS DAMAGED BY FIRE YESTERDAY

Defective Flue Cause of Blaze on Second Floor of Building

Flames resulting from a defective flue yesterday caused about \$100 damage to the second floor of the Oddfellows Building on North Fifth Street. The alarm was turned in about 1:45 p.m., and when the department arrived they found the second floor choked with smoke but very little fire visible. Ventilation of the second floor disclosed the cause of the fire. (Continued on Page 8)

BAYLOR MAN ON COMMITTEE

Wade Davis Named on Committee for Cotton Reduction

Wade Davis was reelected as community committeeman at Baylor yesterday afternoon by cotton producers to assist in carrying out the government cotton reduction plan in Hall County. R.E.L. Pattillo, county agricultural agent, announced this morning. An election of a community committeeman was set for yesterday after an illegal election was held last week. Mr. Pattillo stated. Other community heads have been named. (Continued on Page 8)

FUNERAL RITES FOR E. S. FOOTE

Final Rites to Be Held This Afternoon at Greeley, Colorado

Funeral rites for E. S. Foote, who died suddenly Saturday night, were conducted yesterday at the family home, 309 North Tenth Street, with Dr. John Angus MacMillan, pastor of the First Presbyterian church, conducting the services, assisted by Rev. Orion W. Carter, pastor of the First Methodist church. Dr. MacMillan paid a beautiful tribute to the life of the deceased as a citizen and friend. The body was taken to Greeley, Colorado. (Continued on Page 7)

NRS OFFICE TO CLOSE HERE

Closing of Office to Present Problem in WPA Labor Matter

Indigent Memphis and Hall County residents crowded the local National Reemployment Service office today in anticipation of the office being closed tomorrow by orders from district headquarters at Amarillo. Frank N. Ilevius, local head of the office, was ordered last week from the Amarillo office to close the Memphis NRS branch. Unless the local office is re-opened, today was the last day for the unemployed to apply for work. (Continued on Page 8)

The Weather

WEST TEXAS: Partly cloudy tonight and Wednesday; colder north and west Wednesday. A light mist fell for a time here this morning, and the sky is cloudy and threatening. Rainfall last night locally was .20 inches.

Special Notices

NOTICE BY PUBLICATION OF THE STATE OF TEXAS

Sheriff or Any Constable of County—GREETING: I, ARE HEREBY COM-

ED, That by making publication of this Citation in some newspaper published in the County, once each week for consecutive weeks, previous to the return day hereof you, J. E. Timmons and The heirs of P. C. Timmons, deceased, and their heirs, whose residence is in the County of Dallas, to be and appear before the District Court of the County of Dallas, at the Court House in the City of Dallas, at ten o'clock a. m., of the next following the expiration of Forty-two days from the date of this citation, being at 10 o'clock a. m., on the day of February A. D. 1936, and there to answer the petition of The Travelers Insurance Company, a corporation, in said Court on the 12th day of December A. D. 1935, as said J. F. Timmons, known as Fletcher E. Timmons, being all known heirs of P. C. Timmons, deceased, and The unknown heirs of P. C. Timmons, deceased, or unknown heirs, for suit, being Numbered 19285-F, the substance of which demand is as follows: Plaintiff alleges that on the 1st day of December, 1935, and still is the same simple of the following premises, to-wit: Being 314.4 acres of land, more or less, situate in part of survey No. 13, J. Poitevent and beginning at a stake and stone mound in the NE corner of said survey No. 2, same being 84 vrs to the northwest corner of said Turner survey No. 2, being 150.6 vrs south of an mound on the southeast canyon; thence south 84 vrs to the west boundary line of survey No. 2; Robert Turner; and thence north 84 vrs to Block 1, J. Poitevent; 23.4 vrs point in North corner for the common south surveys Nos. 13 and 14, J. Poitevent; thence up with its meanders and meanders of the south line of said survey No. 77 deg. 24' west 933 vrs to corner; thence; 63.3 vrs to a point in boundary line of said survey No. 13; thence east with boundary line 900 vrs to place of beginning. Being 208.59 acres of land, more or less, situate in part of survey No. 1, M. S. McKimney and beginning at the most easterly south corner of said survey No. 4, M. S. McKimney and which point is the northeast corner of survey No. 2 M. S. McKimney; thence north 15 deg. 15' west with the boundary south boundary of said survey No. 4, and the boundary line of survey No. 1, M. S. McKimney, 876 vrs to a point north 1347.5 vrs to corner; thence East 876 vrs to most easterly northeast corner of said survey No. 4, M. S. McKimney, and the northwest corner of survey No. 1, same being 1341 vrs to place of beginning. Being 318.4 acres of land, more or less, situate in part of survey No. 1, M. S. McKimney, Beginning at a stake and stone mound in the NW corner of said survey No. 2, M. S. McKimney, and the NW corner of said survey No. 1, M. S. McKimney, thence

and there to answer the petition of The Travelers Insurance Company, a corporation, in said Court on the 12th day of December A. D. 1935, as said J. F. Timmons, known as Fletcher E. Timmons, being all known heirs of P. C. Timmons, deceased, and The unknown heirs of P. C. Timmons, deceased, or unknown heirs, for suit, being Numbered 19285-F, the substance of which demand is as follows: Plaintiff alleges that on the 1st day of December, 1935, and still is the same simple of the following premises, to-wit: Being 314.4 acres of land, more or less, situate in part of survey No. 13, J. Poitevent and beginning at a stake and stone mound in the NE corner of said survey No. 2, same being 84 vrs to the northwest corner of said Turner survey No. 2, being 150.6 vrs south of an mound on the southeast canyon; thence south 84 vrs to the west boundary line of survey No. 2; Robert Turner; and thence north 84 vrs to Block 1, J. Poitevent; 23.4 vrs point in North corner for the common south surveys Nos. 13 and 14, J. Poitevent; thence up with its meanders and meanders of the south line of said survey No. 77 deg. 24' west 933 vrs to corner; thence; 63.3 vrs to a point in boundary line of said survey No. 13; thence east with boundary line 900 vrs to place of beginning. Being 208.59 acres of land, more or less, situate in part of survey No. 1, M. S. McKimney and beginning at the most easterly south corner of said survey No. 4, M. S. McKimney and which point is the northeast corner of survey No. 2 M. S. McKimney; thence north 15 deg. 15' west with the boundary south boundary of said survey No. 4, and the boundary line of survey No. 1, M. S. McKimney, 876 vrs to a point north 1347.5 vrs to corner; thence East 876 vrs to most easterly northeast corner of said survey No. 4, M. S. McKimney, and the northwest corner of survey No. 1, same being 1341 vrs to place of beginning. Being 318.4 acres of land, more or less, situate in part of survey No. 1, M. S. McKimney, Beginning at a stake and stone mound in the NW corner of said survey No. 2, M. S. McKimney, and the NW corner of said survey No. 1, M. S. McKimney, thence

and there to answer the petition of The Travelers Insurance Company, a corporation, in said Court on the 12th day of December A. D. 1935, as said J. F. Timmons, known as Fletcher E. Timmons, being all known heirs of P. C. Timmons, deceased, and The unknown heirs of P. C. Timmons, deceased, or unknown heirs, for suit, being Numbered 19285-F, the substance of which demand is as follows: Plaintiff alleges that on the 1st day of December, 1935, and still is the same simple of the following premises, to-wit: Being 314.4 acres of land, more or less, situate in part of survey No. 13, J. Poitevent and beginning at a stake and stone mound in the NE corner of said survey No. 2, same being 84 vrs to the northwest corner of said Turner survey No. 2, being 150.6 vrs south of an mound on the southeast canyon; thence south 84 vrs to the west boundary line of survey No. 2; Robert Turner; and thence north 84 vrs to Block 1, J. Poitevent; 23.4 vrs point in North corner for the common south surveys Nos. 13 and 14, J. Poitevent; thence up with its meanders and meanders of the south line of said survey No. 77 deg. 24' west 933 vrs to corner; thence; 63.3 vrs to a point in boundary line of said survey No. 13; thence east with boundary line 900 vrs to place of beginning. Being 208.59 acres of land, more or less, situate in part of survey No. 1, M. S. McKimney and beginning at the most easterly south corner of said survey No. 4, M. S. McKimney and which point is the northeast corner of survey No. 2 M. S. McKimney; thence north 15 deg. 15' west with the boundary south boundary of said survey No. 4, and the boundary line of survey No. 1, M. S. McKimney, 876 vrs to a point north 1347.5 vrs to corner; thence East 876 vrs to most easterly northeast corner of said survey No. 4, M. S. McKimney, and the northwest corner of survey No. 1, same being 1341 vrs to place of beginning. Being 318.4 acres of land, more or less, situate in part of survey No. 1, M. S. McKimney, Beginning at a stake and stone mound in the NW corner of said survey No. 2, M. S. McKimney, and the NW corner of said survey No. 1, M. S. McKimney, thence

and there to answer the petition of The Travelers Insurance Company, a corporation, in said Court on the 12th day of December A. D. 1935, as said J. F. Timmons, known as Fletcher E. Timmons, being all known heirs of P. C. Timmons, deceased, and The unknown heirs of P. C. Timmons, deceased, or unknown heirs, for suit, being Numbered 19285-F, the substance of which demand is as follows: Plaintiff alleges that on the 1st day of December, 1935, and still is the same simple of the following premises, to-wit: Being 314.4 acres of land, more or less, situate in part of survey No. 13, J. Poitevent and beginning at a stake and stone mound in the NE corner of said survey No. 2, same being 84 vrs to the northwest corner of said Turner survey No. 2, being 150.6 vrs south of an mound on the southeast canyon; thence south 84 vrs to the west boundary line of survey No. 2; Robert Turner; and thence north 84 vrs to Block 1, J. Poitevent; 23.4 vrs point in North corner for the common south surveys Nos. 13 and 14, J. Poitevent; thence up with its meanders and meanders of the south line of said survey No. 77 deg. 24' west 933 vrs to corner; thence; 63.3 vrs to a point in boundary line of said survey No. 13; thence east with boundary line 900 vrs to place of beginning. Being 208.59 acres of land, more or less, situate in part of survey No. 1, M. S. McKimney and beginning at the most easterly south corner of said survey No. 4, M. S. McKimney and which point is the northeast corner of survey No. 2 M. S. McKimney; thence north 15 deg. 15' west with the boundary south boundary of said survey No. 4, and the boundary line of survey No. 1, M. S. McKimney, 876 vrs to a point north 1347.5 vrs to corner; thence East 876 vrs to most easterly northeast corner of said survey No. 4, M. S. McKimney, and the northwest corner of survey No. 1, same being 1341 vrs to place of beginning. Being 318.4 acres of land, more or less, situate in part of survey No. 1, M. S. McKimney, Beginning at a stake and stone mound in the NW corner of said survey No. 2, M. S. McKimney, and the NW corner of said survey No. 1, M. S. McKimney, thence

and there to answer the petition of The Travelers Insurance Company, a corporation, in said Court on the 12th day of December A. D. 1935, as said J. F. Timmons, known as Fletcher E. Timmons, being all known heirs of P. C. Timmons, deceased, and The unknown heirs of P. C. Timmons, deceased, or unknown heirs, for suit, being Numbered 19285-F, the substance of which demand is as follows: Plaintiff alleges that on the 1st day of December, 1935, and still is the same simple of the following premises, to-wit: Being 314.4 acres of land, more or less, situate in part of survey No. 13, J. Poitevent and beginning at a stake and stone mound in the NE corner of said survey No. 2, same being 84 vrs to the northwest corner of said Turner survey No. 2, being 150.6 vrs south of an mound on the southeast canyon; thence south 84 vrs to the west boundary line of survey No. 2; Robert Turner; and thence north 84 vrs to Block 1, J. Poitevent; 23.4 vrs point in North corner for the common south surveys Nos. 13 and 14, J. Poitevent; thence up with its meanders and meanders of the south line of said survey No. 77 deg. 24' west 933 vrs to corner; thence; 63.3 vrs to a point in boundary line of said survey No. 13; thence east with boundary line 900 vrs to place of beginning. Being 208.59 acres of land, more or less, situate in part of survey No. 1, M. S. McKimney and beginning at the most easterly south corner of said survey No. 4, M. S. McKimney and which point is the northeast corner of survey No. 2 M. S. McKimney; thence north 15 deg. 15' west with the boundary south boundary of said survey No. 4, and the boundary line of survey No. 1, M. S. McKimney, 876 vrs to a point north 1347.5 vrs to corner; thence East 876 vrs to most easterly northeast corner of said survey No. 4, M. S. McKimney, and the northwest corner of survey No. 1, same being 1341 vrs to place of beginning. Being 318.4 acres of land, more or less, situate in part of survey No. 1, M. S. McKimney, Beginning at a stake and stone mound in the NW corner of said survey No. 2, M. S. McKimney, and the NW corner of said survey No. 1, M. S. McKimney, thence

Just How Good Is Your Memory?

Can You Answer Fifty Questions on Events of the Year? If You Think You Can, Here's Chance To Prove It

How good is your memory on current events? What news loomed large in 1935?

Every year there are happenings that will be written into history, that the next generation will read. It's all just in the day's news to many of us, to be forgotten as soon as the next sensation is blazoned in black headlines across the front pages.

Can you answer 50 questions on the events of 1935?

Give your memory a workout, then turn to the column found elsewhere in this issue for the correct answers. You'll be surprised how many of them you'll miss, unless you've kept close tab on the day's news throughout the year and remembered most of the details of major events.

1.—What former German territory voted in plebiscite to return to the fatherland?

2.—What "perfect marriage" movie couple was divorced in California?

3.—Did the U. S. Senate vote for or against World Court adherence?

4.—What Governor was ousted by state supreme court order?

5.—What great American dirigible was wrecked and where?

6.—Whom did America's richest girl marry?

7.—What Asiatic king abdicated?

8.—Who is the new governor general of Canada?

9.—What "easy money" scheme swept the country in the spring?

10.—On what island were more than 3000 killed by an earthquake?

11.—Who was named governor of the Federal Reserve Board?

12.—Name the Kentucky Derby winner.

13.—What U. S. senator was killed in a plane crash?

14.—What famous dictator, World War hero, died in Warsaw?

15.—What American "multimillionaire" divorced a prince one day and married a count the next?

16.—Did House and Senate vote to override or sustain Roosevelt's bonus veto?

17.—Name the Tacoma boy ransomed from kidnapers.

18.—On what date did the Di-

sonne quintuplets observe their first anniversary?

19.—Who won the Indianapolis 500-mile auto race?

20.—What mammoth new liner set a speed mark in crossing the Atlantic?

21.—Who won the world heavyweight boxing title and who lost it?

22.—Who were the two bro-

thers who set a world air endurance record?

23.—Name the U. S. women's singles tennis champion.

24.—How old was John D. Rockefeller on his July 8, 1935, anniversary?

25.—What renowned G-man quit the federal service?

26.—What King celebrated the 25th year of his reign?

27.—What two famous men died in an Alaska air crash?

28.—Where did a hurricane kill more than 300 World War veterans?

29.—What speed did Sir Malcolm Campbell average in setting a world auto record?

30.—What European queen was killed in an auto accident?

31.—What was the name of Huey Long's assassin?

32.—Who was elected first president of the Philippines?

33.—Who is the new chief of staff of the U. S. army?

34.—Name the new prime minister of England.

35.—Who was named Canadian prime minister for the third time?

36.—Who replaced General De Bono as chief of the Italian forces in Ethiopia?

37.—What deposed European king returned to his throne?

38.—What U. S. senator, famed as a liberal, announced he would retire at the end of his term?

39.—Who was the first woman to fly the South Atlantic alone?

40.—How long did it take the China Clipper to fly from California to Manila on its first commercial hop?

41.—What noted evangelist died?

42.—Who was the ace flyer who vanished on an England-Australia flight?

43.—What height did Stevens and Annonson attain on their stratosphere hop?

44.—What is the name of the holy city of Ethiopia captured by the Italians?

45.—What noted "exile" returned to New York?

46.—Who were the two great English World War commanders who died?

47.—What notorious New York gang chief was slain by his foes?



WHAT SHIPS ARE FLYING PACIFIC?



WHO SMACKED MAXIE?



WHAT WAS YEAR'S BIGGEST FRAUD?



WHERE DID 1000 QUAKES HIT?



WHO'S GETTING 'CIVILIZED'?



WHO BROKE AUTO SPEED MARK?



WHO'S THIS BACK HOME?



HOW HIGH IS UP, UP, AND UP?

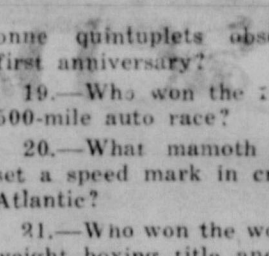

WHOSE JUBILEE WAS THIS?

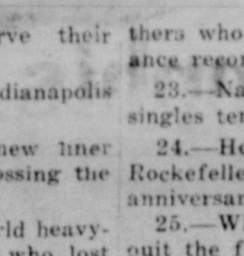

WHOSE AUTO SPEED MARK?

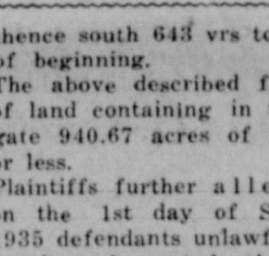

WHO'S THIS BACK HOME?

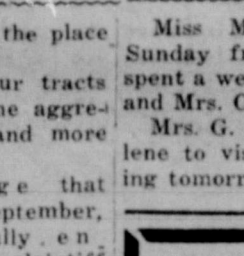

WHO'S GETTING 'CIVILIZED'?

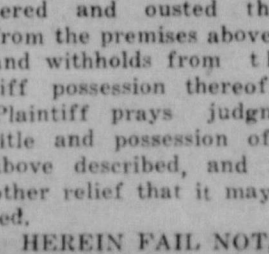

WHO'S THIS BACK HOME?



WHO'S GETTING 'CIVILIZED'?

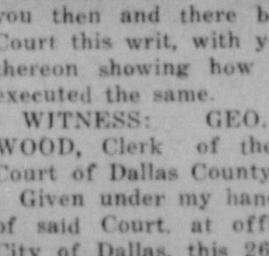

WHO'S THIS BACK HOME?

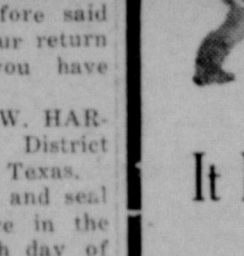

WHO'S GETTING 'CIVILIZED'?

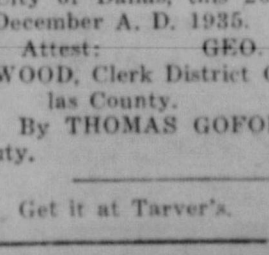

WHO'S THIS BACK HOME?

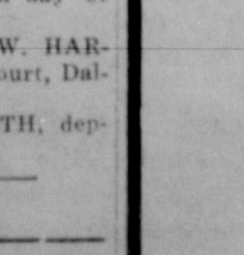

WHO'S GETTING 'CIVILIZED'?

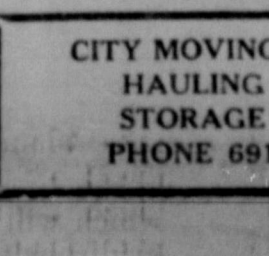

WHO'S THIS BACK HOME?



WHO'S GETTING 'CIVILIZED'?

- 27.—What two famous men died in an Alaska air crash?
28.—Where did a hurricane kill more than 300 World War veterans?
29.—What speed did Sir Malcolm Campbell average in setting a world auto record?
30.—What European queen was killed in an auto accident?
31.—What was the name of Huey Long's assassin?
32.—Who was elected first president of the Philippines?
33.—Who is the new chief of staff of the U. S. army?
34.—Name the new prime minister of England.
35.—Who was named Canadian prime minister for the third time?
36.—Who replaced General De Bono as chief of the Italian forces in Ethiopia?
37.—What deposed European king returned to his throne?
38.—What U. S. senator, famed as a liberal, announced he would retire at the end of his term?
39.—Who was the first woman to fly the South Atlantic alone?
40.—How long did it take the China Clipper to fly from California to Manila on its first commercial hop?
41.—What noted evangelist died?
42.—Who was the ace flyer who vanished on an England-Australia flight?
43.—What height did Stevens and Annonson attain on their stratosphere hop?
44.—What is the name of the holy city of Ethiopia captured by the Italians?
45.—What noted "exile" returned to New York?
46.—Who were the two great English World War commanders who died?
47.—What notorious New York gang chief was slain by his foes?
48.—Who won the U. S. Open golf crown?
49.—What novel by what author won the Pulitzer prize?
50.—What noted woman flyer was seriously hurt in a plane crash?

Answers to the above questions will be found elsewhere in this issue.

Memphis Bowling Alleys Bowl for Health 608 Noel Cash prizes each week Jack McLaurin, Mgr.

HAPPY NEW YEAR It is Our Sincere Wish That All Enjoy A Prosperous 1936. O. E. HAGEMEIER, Prop. City Dairy CITY MOVING—HAULING STORAGE PHONE 691

SUBSCRIPTION RATES By Carrier In Memphis, Newlin, Estelle, Lekeview, Plaska, Hedley, Clara Lake, Giles, Quittage and One Month By Mail One Month Three Months One Year In Hall, Dunlop, Galloway, Childress, Motley and Cottle Elsewhere

NOTICE TO THE PUBLIC Any erroneous reflection, notice, standing or reputation, which may be caused by any error in the columns of this paper, shall be corrected upon due notice given to the editor person or office at 617 Main Street, Memphis, Tennessee.

SON'S INDUSTRIAL REVIEW

BUSINESS OUTLOOK FOR 1936

of what the Court has vital corner-stone Deal, some farm likely to back off dur- I have in mind hogs products. The cycle production is once and quotations in group will prob- during the year. The apply to the dairy to field crops; al- the weather such an ator, it is poor policy dogmatic forecasts on. As for cotton, I are due to recapture tion of the exports 1934 and 1935 so that vor moderately high- this vital southern

WHOLESALE PRICES commodity prices me the rising trend interrupted when the to crack up. They efficiently inflated to Department of Labor rice index between 5 cent. Sharp advances on depend to a large the type of business we experience. Con- the normal, healthy h we are now enjoy- about only mod- ups. If, on the other should go on another aboree and credit could get under full would mount rapid- ter is now likely for alers will do all they any sudden price election-time.

be good news to ers who have felt slowly rising living now food prices are highest level in five years, but they are r peak for the time December the aver- holder's running ex- total 5 per cent larger but his food bills are be any higher than they may even be less. ll probably come in er cent), rent (8 per furnishings (5 per y electricity and gas ll be slightly lower. (coal, coke, and oil) burdensome.

WANTED eady given my opin- outlook for the heavy where unemployment severe. With these etting back on their mber of people re- ork will be one of the ter on in the year. in demand for dur- during recent months ason for not expect- a percentage rise in early in the New ver, as volume picks nes, activity will be hundreds of other e concrete result jobs, fatter pay en- higher wage rates by er.

1936 will probably e strikes than dur- just closed. How- any stiff increase in and no real shortage labor as yet, I have prolonged tie-ups in dustry next year. By as, industrial employ- tory payrolls should eak for the re- d—roughly 10 per the 1935 level. One the coming twelve a labor standpoint demand for, and prem- ed by, skilled work- ers point to marked in purchasing pow- al areas.

FARM RECOVERY ver in farm sections higher — probably percent. No matter eame Court may de- AAA, benefit pay- ers will continue at

least until the snow flies. With more acreage and a fourth year of drouth unlikely, crops should be better. Larger harvests, multiplied by approximately the same prices, equal larger total income. Since the cost of the products which the farmer must buy will not be much higher, his profits in 1936 should continue to upward tendency which started several years ago. Farmers have now greatly reduced their debts, so their increased income will mean even more money for new purchases.

Merchants face the best trade outlook in five years. The combination of increased farm income, larger factory payrolls, and greater dividend payments should boost sales in most lines between 8 and 12 per cent above the 1935 average. Because wholesale prices are not slated for any sharp advance, retail price tags, which are now slightly above a year ago, will show startling mark-ups during 1936. Installment buying, aided by lower carrying charges, will be very brisk. Quality goods will move better than they have in recent years. One of the bright spots of the recent holiday season was the good call for luxury merchandise and this trend will be even more noticeable next year.

A SELLING YEAR If ever there was a time to get behind sales campaigns and drive them ahead, it is now. Sales managers and salesmen alike can expect fine rewards next year for people are in a buying mood. I advise fixing sale quotas 10 per cent as a minimum above the 1935 level. In some lines and territories calculations should be scaled upward even more because selling will be very profitable in 1936. Lineage totals will continue the rise which began in 1933 and advertising managers should figure on at least 10 per cent gain over the 1935 level. The best gains will be shown in the rural areas during the early months.

Farm regions appear to me as the best selling territories. They have been most unfavorable sales areas for the past eighteen months. However, urban centers are due for a come-back and they may have the edge by next December. The best advice I can give is to spread your advertising risk geographically, keeping in mind that the Pacific Coast, the Rocky Mountain, the Middle-west, and the Southern states will give you the best return as the year opens. Most important of all, be sure that your selling methods are in step with the times. New ideas, fresh copy, attractive displays—and delivery of the goods—decide whether or not you will maintain your trade position and whether the profits of your company will keep pace with the general improvement in earnings.

BULL MARKET NOT OVER The huge increase in industrial profits and the steady advance in dividend payments have been very much in the 1935 spotlight. The same will be true in coming months. As a rough estimate, I should say that profits would swell by about 25 per cent. That is the principal reason why I am not worried over the sharp rise in prices since last March. My basic position on stocks is that a bull market began in July, 1932 and that long-pull upward swing has not yet culminated. Despite any temporary unsettlement, the trend next year will be upward. As to the extent of the rise, it is impossible to make a definite forecast although I would be surprised if it were less than 10 per cent.

Within this broad pattern there are a number of industries whose percentage gains will be better-than-average from here on. Those groups connected with the heavy industries, as distinguished from those doing a consumers' business, look best to me. Building

PLEASANT VALLEY

Homer Crawford and Mr. White of Plaska are in San Antonio on business.

Mr. and Mrs. Remus Wakefield are visiting friends and relatives here.

Buck Whitfield and Marshall Lenoir from Lompoc, Calif., are visiting relatives here.

Mrs. Bob Vandeventer from Lompoc is visiting her parents, Mr. and Mrs. Stantey Cruse.

Mr. and Mrs. Leard Weaver spent the Christmas holidays at Quail visiting his parents.

Clyde Crawford and Orville Vandeventer attended a dance at Newlin at the home of Maurice Lefue.

Beverly Mello from California is visiting Homer Crawford during the holidays.

A Christmas tree and supper were enjoyed by the family and a few friends at the home of Mr. and Mrs. Roy Rea.

A bridal shower was given Margerite Williams Monday afternoon.

Mr. and Mrs. Austin Williams spent the Christmas holidays with her parents, Mr. and Mrs. Stanley Cruse.

Gaston Medford was a business visitor in Memphis Saturday.

Mrs. Molly Bishop returned from Clarendon Thursday after spending Christmas there.

Mr. and Mrs. William Bishop spent from Sunday until Thursday with Mrs. Bishop's parents, Mr. and Mrs. Pannell of Plaska.

Mrs. Jewel Vallance is visiting her sister in Fort Worth.

A musicale was enjoyed by a large crowd December 25, given in honor of Orville Vandeventer at his home. About 100 guests attended.

FAIRVIEW

Mr. and Mrs. Henry Phillips and family spent the Christmas holidays with relatives at Coleman.

Mr. and Mrs. Frank Painter and family of Lefors spent Christmas here with his parents, Mr. and Mrs. J. L. Painter.

Mr. and Mrs. Bill Wesley of Petersburg spent the past few days visiting her parents, Mr. and Mrs. W. P. Rogers.

John Ethridge of Taft, Texas, spent Sunday with Mr. and Mrs. Roscoe Eller.

Miss Verna Hollan of Petersburg, spent Christmas with her parents, Mr. and Mrs. W. P. Rogers.

Mr. and Mrs. Park Bolton of Turkey spent the holidays visiting her parents, Mr. and Mrs.

companies will reflect the big improvement in construction activity. They will stimulate many other industries, particularly raw and fabricated metals such as the coppers and steel. Farm tool, industrial machinery, and office equipment concerns face another year of recovery. Electrical equipment makers anticipate a better demand for their profitable heavy items. Automobile production will easily top this year's output of 4,135,000 cars, lifting accessory business along with it.

UTILITIES AND RAILS Other groups do not have quite such an optimistic outlook, although only few lines will show losses. Mail order and chemical earnings will be satisfactory. The railroads will welcome heavier crop and durable goods tonnage but higher operating costs will prevent satisfactory earnings. Dairy foods, grocery chains, meat packing, coal, and textiles will enjoy only moderate gains. On the other hand, the outlook for paper, oil, and department store groups is promising. Despite political uncertainties the power industry has a great future. Taken as a whole, the stock outlook by industries is fundamentally sound.

Continued Tomorrow

John Bradley. Mr. and Mrs. Rupert Bradley and family spent Christmas with relatives in Shamrock.

Mr. and Mrs. Leo Collins are visiting relatives at Medicine Mound.

Mr. and Mrs. Roscoe Ellred and family spent Christmas with Mr. and Mrs. J. E. Gable and Mr. and Mrs. B. J. Eller.

Mr. and Mrs. Fred Spry and family spent the holidays with his parents, Mr. and Mrs. Tom Spry of Plaska.

Eber Henderson of Sanford visited in this community Sunday.

Citizens here regretted to hear of the death of Rev. Leon Henderson of Gentry, Arkansas. Rev. Henderson formerly lived here and at Memphis.

Mr. and Mrs. Neal Sweatt of Memphis spent Thursday with Mr. and Mrs. Eyie Sweatt.

Mr. and Mrs. James Patterson spent Christmas with her parents, Mr. and Mrs. Frank Hall.

Mr. and Mrs. R. Eller visited in the L. Dowell home Thursday.

Mr. and Mrs. Lewis Townsend of Newlin spent the week-end in this community.

David Wallace made a business trip to Clarendon yesterday.

Mr. and Mrs. David Hudgins were visitors in Wichita Falls Sunday.



Send your sooty clothes to us TODAY! At DOSS DRY CLEANERS you're always sure of De Luxe service at reasonable prices.

DOSS DRY CLEANERS
622 Main Phone 554



POINSETTIAS
Cut and pot plants. Christmas wreaths, Roses and a large variety of blooming plants in attractively decorated pots. Unusually large selection of cut flowers for Xmas. The Ideal Gift for Last Minute Shoppers.
Hightower Greenhouse



Why Run? Just Call 157 For A Taxi Its Only A Dime.
BELL GASOLINE FEDERAL TIRES CHAMPLIN'S OILS
24 Hour Service
CUDD BROS.

NEW YEAR'S GREETINGS
May good fortune be yours in the coming year. It is a pleasure to hold an office in Hall County.
JOHNNIE WILSON
County Treasurer



GREETINGS of the NEW YEAR

FLOYD SPRINGER
County Clerk

OUT OUR WAY

By "Cowboy" Williams



M. E. Minister—

(Continued from Page 1.)

diste.

An address, "Mission of America," by Cordell Hull, Secretary of State, will be a feature of the second day of the program.

Rev. Mr. Carter will be away for ten days. Rev. E. D. Landreth of Clarendon, formerly pastor of the Methodist church here, will deliver the sermon at the morning hour Sunday. Rev. Bareus, Presiding Elder, will occupy the pulpit at the evening service.

NRS Office To—

(Continued from Page 1.)

that needy Hall County citizens could become affiliated with the NRS for work.

City and county officials were still puzzled this morning as to what stand the Works Progress Administration would take in the matter. At present all WPA workers must get their employment through the NRS office; and in the event the office is closed permanently WPA work in the county will hit a snag, unless other means for furnishing labor are provided.

CLASSIFIED ADVERTISING

NOTICE: If you owe me your account is due. Please come in and settle. John W. Fitzjarrald. 172tf.

FOR RENT: 2 room furnished apartment. Deposits paid. 1213 Dover St. 202-5p.

FOR SALE—Two row lister, two row cultivator, number of good mules. I. W. Thomason, One mile north of Memphis.

WANTED—To rent 800 acres of land. Call at Democrat office. 204-3p.

FOR RENT—Furnished apartment. Call at 423 South Sixth. 205-tfc.

LOST—32x6 casing, 10-ply, with rim and Simplex house jack, Monday forenoon between Hedley and Clarendon. Will pay a reward of \$10 for their return. Fred Annen, Claude, Texas.

WANTED—To rent 160 acres or more. Will buy teams and tools. Prefer Hall or Donley County.—Three and one half miles south of Lakeview, Cap Smith's place, 205-f

Watch Party

A "watch party" is to be held at the First Methodist church tonight at 7:30 o'clock. A dinner will be served to the entire membership, followed by an evening of informal entertainment. An effort will be made to bring by radio the principal address of the evening—the vocation of the young people of the Methodist church being held at this time in Memphis, Tenn.

With All My—

(Continued from Page 4)

so crushed, such a woebegone little figure that Aunt Ellen could scarcely bear to look at her. Tears stung her eyelids. She wondered if the poor child knew what she was about. It was a serious thing, leaving a husband. Giving up a sweetheart. Aunt Ellen knew. Scott's grandfather had been proud and had never asked her to reconsider, though he had loved her deeply.

Nancy had decided: "Dana's weak. She couldn't stand being poor, so she pulled out."

Mrs. Cameron was first to break the circle. She got up, pulling her robe about her. "We'll all take cold sitting here," she said firmly. "Dana looks dead on her feet. She must get some sleep."

Secretly she was girding her resources for battle. She said to herself, "The silly child is still in love with him. It's written all over her face. If he tries he might be able to persuade her to go back to him. But she'll stay here if I can keep her!"

After breakfast Dana sat in the vicinity of the telephone, fully expecting it to ring. But the morning hours wore away and there was no call from Scott.

He was showing more judgment, Mrs. Cameron thought, than she had expected. Maybe he, too, had decided it was impossible for them to make a success of their marriage.

If that were so, the plan she had in mind, could be speedily carried out.

(To Be Continued)

Mrs. C. W. Weekley returned to her home in Vernon this morning after a visit here with her daughter, Mrs. Russell Middleton.

Mrs. C. H. Brown and children of Lockney were guests of Judge and Mrs. A. S. Moss Sunday.

Machinery For—

(Continued from Page 1)

five truck loads of machinery loaded in Oklahoma City and ready to be moved to the Knorpp location in the county. Moving of the machinery is being held up until Fort Worth and Denver Railroad officials open a railway crossing near the Knorpp location, four miles east of the Tampico crossing.

Fort Worth and Denver railroad officials maintain that opening a crossing near the location is too hazardous, as there is not enough vision approaching the crossing from any direction; and it is thought that accidents might occur as the hundreds of trucks crossed the railway tracks going to and from the oil well. Dozens of trucks would be crossing the tracks until the oil well is drilled.

An entire new rig is being shipped here from Oklahoma City. Three engines, pumps, mudhogs, casings, drill stems, bits, and other drilling equipment—all new—are to be put in action at the Knorpp No. 1 location. Several truck loads of equipment has been unloaded at the railroad, awaiting orders to cross the tracks.

When the new rig is constructed, the drillers will be able to go to almost any depth desired; and the rig will be almost elaborate as the Phillips rig nearby.

Drilling at the Knorpp well has been shut down, awaiting the new rig. Three crews are still in operation at the Phillips test, but the depth of the well was not disclosed.

THE ADDRESS OF DISTINCTION

ASTOR HOTEL

TIMES SQUARE NEW YORK

ROOMS FROM

AND A LUNCHEON

Will Beautify—

(Continued from page 1)

fraying his expense, the trees will be planted during the next month. They will be equally distributed between the old and new plots in the cemetery.

Baylor Man—

(Continued from page 1)

already been announced. The county agricultural agent's office was closed today, and it will be closed tomorrow for the new year holiday.

IOOF Building—

(Continued from page 1)

the blaze in the floor, where a defect in the flue from the Easy Laundry on the first floor had set the floor studding on fire.

The flames were quickly brought under control by the firemen, with very little damage, most of which was confined to a small area of the flooring.

Bond Jumper—

(Continued from page 1)

dress County, and held for local officers. Officers from the Sheriff's department went down Sunday and brought him back here, where he will be held until penitentiary officers call for him.

A brother of Booth, Cecil Booth, is under charges of theft and robbery at Childress and Quail.

Russell Middleton, publisher of the Memphis Daily Democrat, who has been very ill with the flu since Christmas Day at his home, 716 West Harrison Street, is reported to be improving.

SCHOOL MON

One dollar and 21 cents per capita of state money received here by Verne Gilreath, county school superintendent, for payment of various rural schools over the county.

The per capita amount amounted to \$1,657.73, third per capita allotment received here for the year's school expenses.

Carl Brown of Amherst spent the week-end here as the guest of Judge and Mrs. A. S. Moss.

GULF INSURANCE COMPANY DALLAS

.. is a Texas Company whose activities are aimed at building up a rich the State of

Carrying your insurance in this Company through your local agent builds your own state and your own city.

Local Agents: DELANEY AGENCY GRUNDY BROTHERS Memphis, Tenn.

Gulf Insurance Company DALLAS

Happy New Year



IT'S BEEN A PLEASURE TO SERVE YOU

May Prosperity, and Happiness be yours

JOE. N. COLBY Sheriff Hall Co

To Our Friends And Customers



We are indebted to you for the greatest volume of business in our history for the year 1935... for which we are truly thankful. Ours is a service grocery store. We really try to be of service to our customers. Rest assured that we will do all in our power to give you complete satisfaction in every way.

We wish to take this opportunity to wish you the HAPPIEST and MOST PROSPEROUS YEAR. Come in to see us often.

CITY GROCERY J. E. ROPER FOREST McCREARY H. B. B...