

Comparison Early And Present City Shows Rapid Gain

A comparison of the Slaton of a few months after the town was opened and the town as it is today shows the remarkably rapid and steady growth that the city has enjoyed during the period between 1911 and 1928.

When Slaton was 80 days old it had 1,000 inhabitants of cosmopolitan composition. It had several blocks of concrete sidewalk, eight blocks of macadamized streets, a church building under construction, church and lodge organizations, a winter term of public school, twenty buildings under construction, twenty brick buildings either completed or under construction, more than one hundred residences and business houses, the Santa Fe plant, and best of all, a progressive citizenship.

Slaton Today.
Slaton's population today is approximately 6,000, of which an increase from 1,525 was made since 1920. Land values have improved to where range land under improvement costs from \$40 to \$70 per acre and unimproved land costs from \$30 to \$50 per acre, depending on distance from market.

Cotton grown in Slaton territory amounted in 1927 to more than 20,000 bales, and the total value of all crops in the territory amounted to between two and three millions of dollars. Poultry and dairying have found a prominent part in the agricultural program of the rural population, and an annual poultry show is staged each first Thursday, Friday and Saturday in December. Slaton farmers organized the first co-operative registered bull association formed in the county, and herds are being improved through breeding of registered stock.

The investment of the Santa Fe has grown to \$4,000,000, including several miles of trackage in the yards, a roundhouse containing 18 locomotive stalls, large repair shops, offices of the division superintendent, the Harvey House, the reading room, and other equipment. The annual payroll amounts to approximately two millions of dollars.

Industrial Gains.
Water and sewer system is municipally owned, and is within reach of practically everyone. The water supply is pure and of better quality than any of other South Plains towns and cities.

The Texas Utilities company provides light, power and ice. Natural gas for domestic use as well as industrial use is provided by the West Texas Gas company.

A telephone system costing \$77,000 has been installed by the Southwestern Bell Telephone company.

A cotton oil mill costing \$100,000, and having five presses, is located here, as is a cotton compress having a daily capacity of 1,500 bales of cotton. There are five modern cotton gins in the city, and nine other gins situated within a radius of ten miles.

Building permits have averaged \$300,000 annually in the past six years; there are 35 blocks of brick and concrete paving. There is a "way" lighting system in the city district and street lights placed on six principal residential thoroughfares.

Public Schools.
There are four public school buildings, having an enrollment of 1,416 scholars, and representing a financial investment of \$250,000. The high school building cost \$135,000 alone. Slaton schools have 32 units of affiliation and hold membership in the Southern Association of Schools and Colleges, giving high school graduates easy entrance to any college in the United States.

Six churches have handsome buildings and large congregations. A seventh church is planning a new building.

There are 1,000 residences, the great majority of them being of the better type; and home beautification is being encouraged and sponsored through contests held annually. A clubhouse erected at a cost of \$20,000 is located in the northwest part of the city. The city's municipal building is in the center of the square, and was built at a cost of \$25,000.

Strong Banks.
Two strong banking institutions

(Continued on Last Page.)

Saloons Taboo Here Since City Founded

Slaton has an untarnished and unblemished reputation as a "prohibition" town since the founding of the city, as there has never been, and in all probability will never be, a public saloon here.

Railroad men, who constituted most of the population of early Slaton, were bound by rules to remain sober, and no saloon-keeper had the nerve to try to start a business here.

Santa Fe, West Side, Threaten Texas Ave. Lead

With Nick Deavers pitching good ball, the Santa Fe team Wednesday evening handed the Texas Avenue team the second defeat suffered by them this season, by a score of 5 to 0, and threatened the hold the Avenuers have had on the top of the city league.

West Side, by virtue of a double victory over the North Side Tuesday afternoon, tied Santa Fe for second place, each team having five victories and two losses. Texas Avenue holds first place with seven victories and two defeats.

Wednesday's game between the Santa Fe and Texas Avenue teams was perhaps one of the best games played this season. Deavers held the Avenuers, who have been winning their games with heavy hitting, to three singles, of which two were made by Splawn, the other being credited to Moseley.

Robertson, who started for the Avenuers on the mound, was wild, and was relieved by Jochetz after two runs had been scored by the railmen in the second inning without a hit. The railreaders came back in the fourth to score three runs on three hits.

West Siders Win Two
The North Siders and West Siders played till dark Tuesday evening, and agreed to call the result two games, the West Siders taking both by scores of 9 to 0 and 4 to 1. Pitchers were wild and errors were frequent on both sides. The double victory put the West Siders back in the running for the first half of the league schedule, which ends next Wednesday.

Thursday afternoon G. R. M. and North Side play; Monday Texas Utilities and West Siders battle; Tuesday the Texas Avenuers and G. R. M. battle each other; and the final game Wednesday will be played between the West Siders and the Santa Fe.

Tied games and rained out games leave the Santa Fe with two games to be played; West Side with one; Texas Utilities with two; G. R. M. with one; and North Side with two.

The standing of the teams through Wednesday's games is:

TEAM	P.	W.	L.	Pct.
Texas Avenue	9	7	2	.777
Santa Fe	7	5	2	.714
West Side	7	5	2	.714
Texas Utilities	7	3	4	.428
G. R. M.	7	2	5	.285
North Side	7	1	6	.142

Good-Will Group To Wilson Community

Wilson community was the destination of a large party of Slaton people who were to leave from the city square Thursday night at 7:45 o'clock on the weekly good-will trip sponsored by the local Chamber of Commerce.

J. T. Williams, prominent merchant of Wilson, will be one of the hosts. Ice Cream will be carried by the Slaton delegation, and other refreshments will be served.

Rotary Theme To Be Development Friday

Community development will be the theme of the Rotary meeting to be held this Friday noon at the Slaton clubhouse.

"How Best Can the Farmer Be Educated in Marketing Problems and Diversification to Curb Surplus Production" is the title of a discussion to be led by J. A. Elliott, Joe Teague, Jr. and Earl F. King.

Electra—Northside Creamery formally opens plant here June 1.

Higgins—Santa Fe railroad installs electric lights in local station.

Slaton To Raise Money To Keep Up Scout Work Here

With the aim of raising from Slaton people approximately \$1,000 for the purpose of carrying on Boy Scout work in Slaton, a part of the South Plains area council of the Boy Scouts of America, committees were formed at a meeting held last Tuesday in the city hall, under the direction of Tom A. White, of Lubbock, chairman of the finance committee of the area council.

W. P. Knox, area executive, met with the group, and outlined the purposes for which the money is being raised. He said that the South Plains area annual budget had been set at a minimum of \$7,200, of which \$6,000 has been subscribed already by the city of Lubbock, and another part, amounting to a few hundred dollars, had been raised at Spur. He expressed his belief that Slaton would easily subscribe her part of the budget.

Those present at the meeting, other than Mr. Knox and Mr. White, were J. W. Hood, W. E. Olive, A. G. Sanders, Abe Keasel, Ben Holloway, Jr., Harry Burris, O. Z. Ball, C. G. Catching, Tom H. Johnson, and L. A. Willson.

Preparation For Fort Worth Trip Near Completion

Committees in charge of arranging for Slaton's representation in the West Texas Chamber of Commerce convention at Fort Worth next Monday, Tuesday and Wednesday, report that everything is "all set" except that more cars are needed to make the trip.

L. R. Cypert, O. Z. Ball and I. M. Brewer are the three committeemen who are doing all in their power to get enough cars promised for the trip to what is described by advance notices as the biggest and most colorful West Texas Chamber of Commerce convention ever held.

Car Response Small.
These men say they have approached dozens of Slaton people about taking their cars on the trip and have met with surprisingly small response, only ten cars having been promised so far. These will convey about twenty members of the Slaton band to the convention, whereas there are thirty-six members requiring transportation.

To Leave Sunday.
It is planned for the Slaton party to leave here at 5 o'clock Sunday morning. Besides the band members, Slaton's "My Home Town" contest speaker, Worland McAtee, will make the trip, and Miss Louise Lanham, Slaton princess, is to attend the convention to represent Slaton in the big pageant Monday night, the West Texas parade Tuesday and other events during the three days.

Banners To Be Used.
Banners for cars, arm bands and lapel ribbons to advertise Slaton and the South Plains will be used by those in the party to go from here. Literature giving facts about Slaton and the Slaton territory will be distributed at the convention. Plans for placing this city very favorably in the limelight before thousands of people are complete.

PACK CHINA IN BRANCHES
JOHANNESBURG.—A British firm recently used a packing case made of woven branches for shipping china to South Africa. Sides were woven of twigs about three inches apart and the corners were made of larger branches. Straw was used generously inside and no breakage was reported, due to the elastic quality of the container.

NEGRO SINGERS POPULAR
PARIS.—The old-time songs from the land of cotton are becoming more and more popular in France, even among people who do not understand a word of them.

The Fish Jubilee Singers, a negro quartet from Fish university, in Tennessee, have visited Paris three times in the last six months and packed audiences applauded each appearance.

Railroad Lines Here Built By G. W. Harris

Construction of the Santa Fe railroad lines which brought the town of Slaton into existence was made under the direction of G. W. Harris.

The lines were first extended from Lubbock, after that city had succeeded Plainview as a terminal point, and later were extended south to meet the system lines reaching out of Sweetwater.

Baseball League Revised To Four Teams From Six

Announcement of the revision of the present city league baseball clubs, making the league a four-club instead of a six-club loop, has been made by Carl Lewis, president of the league.

Correspondingly, the schedule for the second half of the season has been changed. There has been a suggestion received by the league officials that each Wednesday be reserved to play off rained-out and tie games, but no action has been taken on this as yet.

According to the revision of the clubs, the Santa Fe shop team, known as the G. R. M. team, will consolidate with the Texas Utilities team, and the North Side will merge with the West Side team.

What the names of the two teams made from four will be has not been determined, nor have the players or managers been named.

The Schedule.
The following tentative schedule has been drawn up for the second half of the season:

(Note: In order to avoid confusion between the two Santa Fe teams, the combined G. R. M. and Texas Utilities teams will be referred to as Texas Utilities, and the North and West Side will be referred to as the West Side.)

June 21, Texas Avenue vs. Utilities; June 22, Santa Fe vs. West Side; June 25, Texas Avenue vs. West Side; June 26, Santa Fe vs. Utilities; June 27, Santa Fe vs. Texas Avenue; June 28, Utilities vs. West Side; June 29, West Side vs. Santa Fe; July 2, Utilities vs. Texas Avenue; July 3, Texas Avenue vs. Santa Fe; July 4, West Side vs. Utilities; July 5, West Side vs. Texas Avenue; July 5, Utilities vs. Santa Fe; July 9, Texas Avenue vs. Santa Fe; July 10, Utilities vs. West Side; July 11, Santa Fe vs. West Side; July 12, Texas Avenue vs. Utilities; July 13, Texas Avenue vs. West Side; July 16, Santa Fe vs. Utilities; July 17, Utilities vs. Texas Avenue; July 18, West Side vs. Santa Fe; July 19, West Side vs. Texas Avenue; July 20, Utilities vs. Santa Fe; July 23, West Side vs. Utilities; July 24, Santa Fe

(Continued on Last Page.)

Reading Room Here Is Praised By Head Of System's Rooms

G. R. Miller of Chicago, superintendent of the Santa Fe railroad reading rooms, passed through Slaton Monday on an inspection tour of the reading rooms of the system.

Mr. Miller told "Uncle George" Marriot, librarian of the local reading room, that it was the best of the system that he had visited on his tour, which included all division points between Slaton and Chicago. He praised the trees, lawn, and flowers and the general arrangement of the surroundings.

Mr. Miller was enroute to Los Angeles.

Stonefield Engineer Of First Train In

George Stonefield, now deceased, was the engineer of the train which was brought into Slaton on the opening day. The train came in from Amarillo.

Fat J. Lowery was conductor of the train. He as well as Stonefield slept that night in a tent, the only hotel accommodations available.

Marble Falls—Local wool shipments will be about six carloads.

Cleburne—New warehouse for Greeny company west of Slaton freight station near completion.

Seventeen Years Bring Slaton From Cattle's Grazing Ground To a Leading City of the Great South Plains Region

President of Santa Fe Arranged Slaton Streets By Design

Due to the unusual arrangement of Slaton's streets in the business district, the identity of the man who laid out the plan of the city is the subject of query of the newcomer in this city.

W. B. Storey, now president of the Santa Fe railroad with offices in Chicago, is the man who is responsible for the unusual arrangement. He conceived the idea of building a town along the same plan of San Francisco, with all streets converging at a central place similar to the convergence of San Francisco streets at Market street.

J. W. Walters, civil engineer, staked off the lines of the streets according to Mr. Storey's plan, and E. H. Olsen drew up the blueprints under Mr. Storey's direction.

Convention West Texas C. C. Will Draw Thousands

More than a thousand South Plains citizens will attend the annual West Texas Chamber of Commerce convention at Fort Worth, June 18, 19, 20, and a co-operative movement to attract as much attention and publicity as possible to this section has been worked out by the South Plains commercial executives.

Headquarters for all South Plains towns will be at Ellison's Furniture company, and delegates will wear arm bands reading, "The South Plains of Texas." A sign will reach across the street, pointing to Ellison's and reading: "The South Plains of Texas," and another sign will be hung over the main entrance giving the names of the towns co-operating in the movement.

To Have One Float.
One mammoth float is being prepared for the South Plains delegation which will carry the sponsor from each town co-operating and Mrs. Paul T. Miller, Tahoka secretary and president of the South Plains Commercial Executives association. Mrs. Miller will be "Miss South Plains."

Behind the float, the Junior Cowboy band of Post will march, followed by other bands and delegations in alphabetical order. Besides the Post band, Floydada, Tahoka, Plainview, Lubbock, Slaton, and other towns expect to have bands at the convention. The Blue Bonnet chorus of Lamesa will also attend and make a showing for Lamesa and the South Plains.

Wilson Chairman.
Lloyd A. Wilson, Slaton secretary, has been selected as general chairman of the delegation. He will direct the office at headquarters, will have charge of the delegations in the parade and will look after other matters.

At a recent meeting of the executives' association, it was announced that the following towns have sent in checks to pay their pro-rata part of expense of the co-operative publicity and will have a princess to ride the South Plains float: Floydada, Lamesa, Levelland, Littlefield, Lockney, Lubbock, O'Donnell, Olton, Plainview, Post, Ralls, Slaton and Tahoka.

Fort Worth Ready.

FORT WORTH.—With assurance that at least seventy-five bands will be in attendance, with more than the same number of cities and towns in West Texas sending organized delegations.

(Continued on Last Page.)

City Officials Had No Place Of Meeting

Slaton's city officials had to get along without a specific place of meeting until 1923, when the present city hall was built.

Meetings were generally held in any office available, usually in the office of the mayor who happened to be in power at the time.

Town Has Enjoyed a Steady Growth Since 1911.

Springing to life from the prairie where cattle roamed seventeen years ago, Slaton has developed during the period since that time to a small city which is rapidly taking its place among the leading towns of the yet unexploited area of the great South Plains region.

Today, Friday, June 15, 1928, marks the seventeenth anniversary of the date when the public sale of lands opening the town for settlement was held.

Prior to 1911, the land upon which the townsite is now situated was the undisturbed pasture land for the cattle of the O'G ranch, owned by J. W. and H. L. Kokernot of San Antonio. The Santa Fe tracks which had terminated at Plainview were later extended to Lubbock, and prospects indicated that the latter city would be the place selected for the location of the division point of the Santa Fe lines, and the construction of the great shops and roundhouses now located here.

Lubbock Falls.
Had this event taken place, it is likely that what is now Slaton would be farming land, grazing land, or perhaps the central point of a rural farming community.

However, Santa Fe officials and landowners in Lubbock could not arrive at a mutually agreeable price on the land needed for the division point facilities, so the railroad decided to come farther south. The result was the founding of the city of Slaton.

Part of Ranch.
The part of the O'G ranch on which Slaton is now situated was bought from a Mr. Phillips, now deceased. The property included four sections, which was platted and sold by the Santa Fe at a public opening sale held June 15, 1911. The townsite agent who conducted the sale was C. M. McCullough, but a part of the land had been sold in private sale a few days prior to this. Among the land sold privately was the addition now known as South Slaton which was bought by J. S. Edwards, who opened the land to public purchase.

Mr. Edwards had come to Slaton several days before the town was opened, and with about thirty other men, was tent-camping here. There were no buildings here then.

Buildings Spring Up.
Immediately after the sale of land, buildings sprang into existence as if

(Continued on Last Page.)

Hotel Facilities In Early Slaton Scant

Hotel facilities at Slaton when the town was opened, and shortly after, were very scant. The old Trauman house, now located just off Texas Avenue near the present depot, was then located at Fourth and Lynn.

The present Hotel Forrest, formerly known as the Singleton hotel, was not built until 1912. J. S. Edwards financing the construction of the building.

Then there was the old Capp hotel at the corner where Texas Avenue and Eighth street converge at the northeast corner of the square. The lobby of the hotel was where the Singer Sewing Machine company is now located.

Nine Mayors Have Held Office Here

Slaton has had nine mayors since the town was opened on June 15, 1911, some of whom served more than one term, some of whom served only a part of a term, and some of whom served the remainder of a term after the resignation of the elected mayor.

W. G. Reese, the present mayor, was preceded by S. F. King, and other mayors who have served include W. H. McKinnin, J. L. Crules, H. C. Jones, R. J. Murray, W. E. Olive, A. J. Payne, and L. P. Lewis.

Slaton's first mayor was J. J. "Deb" Murray, now of Lubbock, who was also the first president of the local Ice Lays club, which was founded three years ago.

John Santa Fe

AND Santa Fe HIS

Family of Folks

Miss Edith Cook of Clovis is visiting her sister here, Mrs. Jimmy McGinnis.

Mrs. W. H. McKirahan will spend the week-end with Mr. and Mrs. George Marriott.

R. A. Rutledge, district engineer from Amarillo, was in Slaton last week on company business.

Mr. and Mrs. W. O. Clark left Tuesday for Albuquerque. Mr. Clark is road electrician for the Santa Fe.

Reuben Privett, who is ill at the company hospital at Clovis, is reported to be getting along nicely.

A. F. Hibler, motor car mechanic, whose headquarters are at Albuquerque, N. M., has been in Slaton doing repair work on the Slaton motor car.

Mrs. Dick Skelton and Mrs. Elizabeth Hise, sister and mother, respectively, of Mrs. George Marriott, are visiting in Shreveport.

Passenger Conductor Jimmy Smock will be back on his run soon, according to reports received. Perry Moss has been taking care of his run.

W. H. McKirahan, former mayor of Slaton, is in Slaton this week with T. B. Hamilton. Both are valuation accountants with headquarters at Amarillo.

Jesse Wall, who has been receiving treatment at the company hospital at Clovis, is back on duty at Wellington, Kansas, where he is aiding to care for the wheat rush.

Mrs. William Rvst and daughters, Adean, Daurice, and Billy, have gone to Alabama, and will later tour through Minnesota, Wisconsin, thence to Pennsylvania and return.

"Uncle George" Marriott will leave

Saturday noon for Fort Worth, where he will attend the West Texas Chamber of Commerce convention. He will spend Sunday with a cousin in Fort Worth.

"Uncle George" Marriott, librarian of the reading room, attained his 67th birthday last Saturday, and in commemoration of the event, an informal party was held in his honor with approximately 35 couples attending.

The party was held at the reading room, and "Uncle George" was the recipient of many nice presents from friends. Music for the occasion was furnished by Mr. and Mrs. B. E. Clark, who rendered mandolin selections, and by Joe Michou, who gave piano numbers.

Of Uncle George's 67 birthdays, the past 15 have been spent in Slaton, and at each of the 15 he has been given a party. He says that as a result of the last one he has enough cigars to last till the next one.

Postponed Memorial Service To Be Held Next Sunday Evening

Due to rainy weather, the memorial service planned by the local Odd Fellows lodge to have taken place last Sunday was postponed until next Sunday, according to an announcement by Rev. M. S. Leveridge, who will be in charge of the services.

Odd Fellows and Rebekahs will meet at 5:30 o'clock at the lodge hall next Sunday afternoon, and will carry flowers to the cemetery for decoration of the graves. At 8:30 o'clock services will be held at the Methodist church.

Topics of the Town -and- News of its People

Mrs. E. C. Foster left Wednesday for Dalhart for a visit.

Mr. and Mrs. L. A. Rivers have left for a tour of the western states.

G. E. Welch and family visited Sunday with relatives in Dimmitt.

Miss Eunice McDonald has returned from a visit with relatives in Littlefield.

Mr. and Mrs. Billingsley, formerly of the Hackberry community, have moved to Slaton.

Dr. W. E. Payne and family spent Sunday in Lameza, visiting with friends, W. E. Cox, and family.

Mrs. Myrtle Lovejoy and daughter, of Loring, are visiting W. D. Eads here. Mrs. Lovejoy is a sister to Mr. Eads.

Dr. W. A. Tucker is driving a new model A Ford business coupe, delivered to him Wednesday by the Slaton Motor company, local Ford dealers.

Jack Holman, advertising manager for the Palace and Custer theatres here, was in Plainview Tuesday on business for the K. & H. circuit.

Ben G. Holloway, Jr., will leave this week-end for Boulder, Colorado,

where he will attend summer school at the state university of Colorado.

P. G. Stokes, Greer Whitaker, Henry Thorne and Gerald Whitaker returned Wednesday from Dallas, driving back three of the new model Ford cars.

Miss Aline Phillips of Lameza and Miss Joan Bullock of Post, both teachers in the school here the past year, are visiting Mrs. W. H. Clark.

Misses Marjorie Elizabeth, Irma Gray and Mary Bemar Adams of Sabinal, nieces of Mrs. B. G. Holloway, are visiting in the home of Rev. and Mrs. Holloway.

The family of Rev. W. H. Phillips, pastor of the Nazarene church, has arrived here from Hamlin to assist in the church services. They are located at 140 North Fifth street.

Captain and Mrs. James E. Matthews visited with Mrs. B. G. Holloway while enroute to Los Angeles, where Captain Matthews will be associate professor of military tactics. They are from Columbus, Georgia. Captain Matthews is a brother to Mrs. Holloway.

SICKLY, FEEVISH CHILDREN

Children suffering from intestinal worms are cross, restless and unhealthy. There are other symptoms, however. If the child is pale, has dark rings under the eyes, bad breath and takes no interest in play, it is almost a certainty that worms are eating away its vitality. The surest remedy for worms is White's Cream Vermifuge. It is positive destruction to the worms but harmless to the child. Price 35c. Sold by CITY DRUG STORE

GAS MADE HER CROSS, CAN'T EAT OR SLEEP

"When I ate I would bloat up with gas. I couldn't sleep, was cross and nervous. Adlerika has given me real relief."—Mrs. M. Meyer.

Adlerika relieves stomach gas and sourness in TEN minutes. Acting on BOTH upper and lower bowel, it removes old waste matter you never thought was in your system. Let Adlerika give your stomach and bowels a REAL cleansing and see how much better you feel. It will surprise you! City Drug Store.

A mother caught picking pockets pleaded that she needed the money to give her daughter an education. Now the daughter may at least learn the meaning of a sentence.

Records show that 69 lives have been saved by Bell system employees through the application of first aid methods.

OWN A TYPEWRITER

\$3 DOWN
Brings You a Shipman-Ward Rebuilt UNDERWOOD
Rebuilt Like New. Every machine fully rebuilt. Worn parts replaced. New enamel, new nickel, new platen, new type, new key rings, etc.
Ten Days' Trial. You get ten days' free trial.
Easy Payments. Our easy monthly payment plan makes it possible for you to have this splendid machine immediately.
G. W. BOWNS

Saturday Specials

10 BARS, P. & G.	
SOAP	.38
48 LBS OUR SEAL—PER SACK	
FLOUR	\$1.85
NO. 2 BUFFALO SWEET, WRINKLED—PER CAN	
PEAS	.15
3 LBS. BLOSSOM PEABERRY—PER CAN	
COFFEE	\$1.17
HUDSON—3 CANS	
LYE	.25
WHITE SWAN—PER PACKAGE	
CORN FLAKES	.10
VAN CAMP'S, NO. 2—3 CANS	
PORK & BEANS	.25
CANADIAN MAID—PER CAN	
MALT SYRUP	.56
1 GAL. NEW CROP TEXAS—PER GAL.	
BLACKBERRIES	.56
10 POUNDS	
NEW SPUDS	.28
1-4 LIPTON'S—PER CAN	
TEA	.21
1-2 LIPTON'S—PER CAN	
TEA	.41
1-POUND CAN RUMFORD	
BAKING POWDER	.25
1 GAL. B. L.—PER GAL.	
KARO	.58
AMOUNTS OF \$2.50 AND OVER DELIVERED. PHONE NO. 197.	

Friday and Saturday

This is Your Day



Friday Morning
9 Until 10 o'clock
Extra Special
Ladies' Silk Hose
One hour only, or as long as they last—
4 Pair for \$1.00

Children's 3-4
Hose
Values to 35c—
4 Pair for \$1.00

Crash Toweling
Heavy quality white and ecru, 23c value—
10 Yds. for \$1.00

Gingham
Your golden opportunity. Solids, checks and plaids. While it lasts—
12 Yds. for \$1.00

Ready-to-Wear and Millinery
All new. Just received a big shipment.
Dresses, \$4.95, \$7.85, \$12.75
Hats, \$1.95, \$2.95, \$3.95

CLOSE OUT DRESS SALE
20 Ladies' Dresses
25 Misses' Dresses
Values up to \$4.95. Close out for—
\$1.00

Ladies' Undergarments
Bloomers, Teds, Gowns and Muslin Unions. Values up to \$1.50, choice—
2 for \$1.00

Saturday Morning
10 Until 11 o'clock
Extra Special
PRINTED TAFFETA SILKS
Big assortment of other kinds and patterns. Values up to \$2.50; as long as they last—
\$1.00 per Yd.

Men's and Boys' Caps
New Summer patterns. Extra values to \$2.50, for—
\$1.00

Ladies' Silk Hose
Guaranteed, 95c value—
2 Pair for \$1.00

Ladies' Silk Hose
Guaranteed, \$1.50 value—
\$1.00 Pair

Space will not let us quote all prices and specials given for this Dollar Day saving to you. Come one, come all. Get your share.

Model Dry Goods Company

SLATON, TEXAS



Judge a USED CAR by the Integrity of the Dealer

Your Buick dealer's good reputation in the community is worth far more to him than the profit on any used car transaction.

He is the head of an established business and he knows that to get more business, he must please his present customers.

He carries a representative stock of used cars, including both used Buicks and cars of other makes—and he represents them honestly.

You're sure of a square deal when you buy from the Buick dealer. He stands back of the used cars he sells.

BUICK MOTOR COMPANY
FLINT, MICHIGAN
Division of General Motors Corporation

BETTER AUTOMOBILES ARE BUILT TO BUILD THEM
Slaughter Motor Co.
Lubbock, Texas



KANSAS CITY.—All is in readiness for the great Republican convention, and the eyes of the nation are turned to the party leaders who will select the Republican candidate and formulate the party platform. Everything points to a very lively and exciting convention.

Among those very prominent at the convention can be numbered Senator Fred Smoot of Utah, who, it is said, may be appointed head of the important resolutions committee.

Very much in evidence during the sessions, it is expected, will be Secretary of the Treasury Andrew Mellon. And of course another brilliant, colorful personality in the foreground of convention events will be Charles D. Hilles, of New York, vice-chairman of the Republican National committee.

William M. Butler has been named by President Coolidge as chairman of the Republican National committee, and has been acting as chairman of the committee on arrangements at Kansas City.

Another important convention figure will be Senator George H. Moses of New Hampshire. There is a movement on foot to make him the permanent chairman of the convention.

Simon D. Fess will be the keynote speaker. He is expected to deliver an earnest, forceful address. He is an historian and staunch administration adherent.

Kansas City was chosen as the scene of the Republican National convention last December, after the most hotly staged battle to choose the convention city ever fought.

The convention will be held at the Convention hall at Kansas City, which was built in 1900 for the Democratic convention held that year, when the Democrats nominated William Jennings Bryan.

At the beginning of the year there were 9,380 telephone companies, and over 45,000 rural lines, in the United States giving service to 18,523,000 telephones.

Get a Facial
the
Rosebud Way
JUNE 15
is
SLATON'S BIRTHDAY

You'll want to celebrate, of course—with a facial the Rosebud Way.

\$1.00 Up

Know the delight of a restful facial at the hands of our excellent operator. And then—fresh, charming beauty, and the confidence that comes with it.

CALL 373

The
Rosebud Beauty Shoppe
TEXAS AVENUE

Japanese Babe Hit By Meteor Fragment

JAPAN.—The hitting of a human being by a meteorite is probably the rarest of all accidents. Yet that is what happened to a three-year-old Japanese baby living near Sukatu, a village northeast of Tokio.

At the time of the occurrence the child happened to be playing out of doors alone. Hearing a sudden cry the mother rushed out to find the infant seared across the neck as if by a hot iron. Further search disclosed a small stone in a fold of the child's dress. It was still slightly warm, which evidently had caused the burn on the neck. Transmitted to Yamamoto and examined by the scientists of Kyoto university, this stone proved to be a typical meteorite, covered with the usual black crust caused by melting during its flight through the air.

The stone is only about one-fourth of an inch in length and weighs only a few grains, making it probably the smallest meteorite ever recorded. In spite of the millions of meteorites that hit the earth's atmosphere each day and burn up to make shooting stars, only a few reach the ground. In only one previous historic instance is one known to have hit a human being. That occurred in 1827, when a native of India was killed by a meteorite.

Quaint English Town Is Sold at Auction

LONDON.—An example of the old order changing in the matter of English land-ownership was afforded today rather unusual circumstances today, when, lot by lot, a large part of the quaint town of Amerham, Buckinghamshire—hidden in the Chiltern hills—went under the auctioneer's hammer.

For some time the cottages, as well as the more pretentious residences, stores, shops and gardens, bore catalogue number in anticipation of the sale, which was held in the malt house of the town brewery, as the ancient town hall was too small to hold the crowd.

The property for generations was owned by the Drake family, the recent owner being Tyrwhitt Drake, councillor of the borough of Maidstone. Every tenant, previous to the sale, had received an opportunity to purchase the cottage he occupied, which seventy cottagers did. Some years ago the town of Shatsbury, Dorsetshire, was sold under somewhat similar conditions.

Women Taxi Drivers Prove Satisfactory

BALTIMORE.—Baltimore's feminine taxicab drivers are here to stay. The reasons, as outlined by G. M. Stevenson, manager of a local company, which several months ago employed a number of women cabbies, says the Baltimore Sun, are:

More efficient, more prompt, more courteous, more careful, and on the average run, more reliable.

Asked if the trial has fully justified the company's judgment in hiring women drivers, Mr. Stevenson said: "It certainly has. Our women drivers have given us entire satisfaction and we intend to increase their number. I'm the oldest taxicab man in Baltimore and I have never known a better group of drivers than they are."

There are now ten women cabbies piloting the company's machines. Twenty-five men are employed. "In time," said Mr. Stevenson, "we expect to employ just as many women as men, maybe more. We need more drivers for certain kinds of trips, but for ordinary daytime work girl cabbies are best."

Ferns like shade, but grow best in an airy, slightly sunny place rather than in a dark sunless corner of a room.

Eastland—Concrete being poured for sixth floor of new court house.

McLean—Empire Gas and Fuel company's No. 1 Dauer flowing estimated 50 barrels oil daily.

Big Spring—Texon Oil and Land company Settles No. 2 brought in flowing 500 barrels.

Watch for the Hook

Some smooth, slick talking salesman may come talking gildt-edged stock some day, But you had better not crack down Till you have all about it found; For stock in many a quick paying scheme is not what it at first might seem And no matter how the bait may lock It pays to watch out for the hook. The First State Bank will help you find The worth of stock of every kind.

The First State Bank

(Capt. 1925 Adm. Reserve Master)

Capital \$40,000.00

"Sixteen Years Serving Slaton and Slaton Community"

YOU, Mr. Tire User!

For the Next Ten Days, Beginning Saturday, June 9th, We Will Sell

Racine Automobile Tires

At the Prices Below

Never before in the history of the tire industry have such low prices been offered.

Williams Auto Supply Company operates in lieu of Racine Rubber Company factory and guarantees satisfactory service. Floor plan adjustments.

Our stocks are complete in all rim sizes from 30x3 to 40x8 in high pressure and 27x4.40 to 34x7.50 in Balloon sizes.

These prices apply to all of our stores.

On sale at the following places in Lubbock:

- Williams Auto Supply Company
1109 Main Street
Broadway Service Station
801 Broadway Street
- Hub Service Station
1720 Avenue H
- Williams Auto Supply Company
Ninth and Lynn Streets, Slaton

SPECIAL SPECIAL SPECIAL SPECIAL SPECIAL

30x3½ Trusty Cord	\$4.25	30x3½ Grey Tube	\$.75
30x3½ Klinger Cord	\$4.50	29x4:40 Grey Tube	\$1.05
29x4:40 Klinger Cord	\$5.45		

HIGH PRESSURE RACINE COUNTRY ROAD CORDS

	Formerly Priced	Sale Price
30x3	\$ 5.85	\$ 4.47
30x3½	\$ 6.75	\$ 5.20
31x4	\$11.60	\$ 9.10
32x4	\$12.40	\$ 9.50
32x4½	\$16.90	\$12.95

BALLOONS RACINE COUNTRY ROAD CORDS

	Formerly Priced	Sale Price
29x4:40	\$ 8.40	\$ 6.45
29x4:75	\$10.50	\$ 8.05
30x5:00	\$11.80	\$ 9.00
31x5:00	\$12.35	\$ 9.35
30x5:25	\$13.65	\$10.45
31x5:25	\$14.20	\$10.90

RACINE MULTI-MILE CORDS

	Formerly Priced	Sale Price
30x3½	\$ 9.20	\$ 7.10
31x4	\$14.45	\$11.10
32x4	\$15.30	\$11.75
32x4½	\$20.85	\$16.00
30x5 Reg	\$23.70	\$19.30
30x5 H. D.	\$31.45	\$24.10
32x6 H. D.	\$51.00	\$39.05
34x7	\$72.25	\$55.30
40x8	\$110.00	\$84.15

RACINE MULTI-MILE CORDS

	Formerly Priced	Sale Price
29x4:40	\$10.15	\$ 7.80
29x4:40 H. D.	\$12.40	\$ 9.50
30x4:50	\$11.15	\$ 8.65
30x5:00	\$14.45	\$11.10
30x6:00	\$19.20	\$14.65
30x5:25	\$16.85	\$12.90
31x5:25	\$17.40	\$13.30
33x6:00	\$21.00	\$16.15
33x6:00 H. D.	\$24.20	\$18.55

WILLIAMS AUTO SUPPLY CO.

SLATON -- LUBBOCK -- MIDLAND

Largest and oldest Racine Distributor operating chain stores in West Texas. Our buying power and volume of business enables us to pass these unusually low tire prices on to the buying public.

Hail! Hail! Hail!

We are prepared to protect your growing crops from HAIL DAMAGE at reasonable cost. Terms if desired. See us at once and let us explain this coverage.

RECTOR INSURANCE AGENCY

First State Bank Bldg. Phone 248

ON EDGE Worried A Lot

"I took Cardui at intervals for three years, and have been in good health since last fall," says Mrs. Noble J. Hayes, of Waterloo, S. C. "My improvement after taking a course of this medicine was really remarkable."

"I am much stronger and can accomplish so much more work now. My weight increased twenty pounds, and my color is good."

"For a long time I had been feeling poorly. Some days I dragged around the house and had not enough energy to do my housework."

"I worried a lot about myself. I did not seem like myself, and my nerves were all on edge. I did not sleep well, and my appetite left me."

"I found Cardui to be an excellent tonic. After I had taken it a few weeks, I began to pick up and to gain in weight and strength." At all drug stores.



New Production Mark Is Set By Chevrolet Motor

DETROIT, Mich.—All previous production records in the sixteen-year existence of the Chevrolet Motor company were shattered here in May when the company turned out 140,700 units.

The output for a single day also reached a new level on May 28 when 7,075 finished cars and trucks rolled off the assembly lines.

These figures, released here today by W. S. Knudsen, president and general manager, lent substance to a growing feeling in automotive circles that Chevrolet would not only equal its 1927 volume of a million cars well before the close of 1928, but that it also would duplicate its 1927 performance of building and selling more cars than any other manufacturer in the world.

Production of bigger and better 1928 models to June 1 was 651,000 units, Mr. Knudsen stated. He pointed out that this figure includes production since the first of the year as well as 32,000 new cars built in December so that dealers in all parts of the country would have cars for immediate delivery when the new model was publicly announced on January 1.

Up to June 1 last year the company had built 513,000 new models; in 1926, 326,000 units, and in 1925 less than one-third the volume achieved during the corresponding period this year, according to Mr. Knudsen.

The output for the month just ended was 25,000 units in excess of the 115,000 cars and trucks built in May, 1927, which, until this year, had been the largest production month in the history of the company. In May, 1926, the turn-out was 74,000 units, and in May of the previous year 52,000 units.

The record set up last May was bettered by 2,000 units during the past February. March in turn was 17,000 units ahead of February; and April with a volume of 135,800 cars and trucks exceeded the March performance by 2,000 units.

In view of the high May volume, and the schedule for June, Mr. Knudsen stated that by the middle of the year the number of new cars built would be well beyond the three-quarter million mark.

Letter In Sea-Tossed Bottle Brings Reply

PITTSFIELD, Mass.—Robert G. Newman, high school student, has had a letter from the keeper of a lonely French lighthouse on the Ile de d'Ouessant off the rocky coast of Finisters, because he threw a bottle into mid-ocean last August.

Newman, returning from Europe with his parents, wrote a note, enclosed it in a bottle and offered in it a reward to the finder. In April the battered little bottle attracted the attention of lighthouse keeper H. Mason as it lay on the beach at his feet.

"Marchin' Through Georgia" Tabooed For Houston Meet

HOUSTON.—Delegates, alternates and visitors attending the Democratic national convention in Houston June 26, will be regaled with a wide variety of melodies by the bands which will appear on the streets, hotels and other points of vantage, including the hospitality house and coliseum, during the life of the national meet.

But there's one tune, which will be absolutely taboo. And this information comes directly from the committee in charge of band activities. "Marchin' Through Georgia," a melody which was composed soon after General Sherman's march through the Cracker State during the war between the states, will be eliminated from the programs. This ultimatum, principally in deference to the Georgia delegation, but also a gracious gesture toward the entire South, was among the first issued by the committee.

General Jacob F. Wolters, chairman, announces that all bands promised

WANTED
Will Buy Notes—Promissory or Vendor's Lien. See me if you have notes for sale.
R. L. VIVIAL

MOTT'S SANDWICH SHOP
For the Best in Fountain Service,
and Keg Beer, Hot Dogs, Chili,
Sandwiches, and other
Quick Lunches.
On West Side of Ninth Street

will be on hand, and that it is intended to arrange the band schedule so that two bands will be on duty in the coliseum at all working sessions—other units will be paraded to the railroad depots to greet incoming visitors.

As a pleasant surprise, it was planned to have the welcoming bands greet the respective delegations by playing the airs familiar in their home states. Copies of these selections are already in the hands of band leaders, and rehearsals are now under way.

Among the bands scheduled for the convention, in addition to the Houston Municipal band, will be Brownwood's famous "Old Gray Mare Band;" Gold Medal band, Memphis; Dallas Municipal band, donated by the citizens of that city in honor of Jesse H. Jones, and which will be his personal band throughout the life of the convention; Edinburg band, crack Rio Grande valley organization; the Magnolia Petroleum band, Beaumont, a prime favorite with radio patrons throughout the nation by virtue of appearing over the ether from time to time; Missouri Pacific Booster band, headquarters at Palestine, and one of the finest bands in the state; Houston own 143rd Infantry band, and the novelty, Houston Ladies band, consisting solely of Houston housewives, and which is said to offer a rare treat not only to the ear, but to the eye, since all the musicians are unusually pretty.

Arrangements for quartering the visiting bands are complete. Some will be stationed at various fire depots throughout the city. A room in the Democratic building has been set aside for the use of the bands.

ROBY.—Roby is building a 25-room, modern brick hotel.

Two-Year Hunt For Missing Link Begun

NEW YORK.—A two-year hunt for the Darwinian "missing link" began when an expedition sailed on the White Star liner Majestic on the first leg of a trip that will lead to the Kalahari desert of Africa. The leaders of the expedition are Dr. Will J. Cameron, Chicago dental surgeon and big game hunter, who is financing the trip; D. C. Ernest Cadle, anthropologist, and Professor R. L. Menden, geologist from the University of Texas.

Living in the desert that is to be explored, Dr. Cameron said, there is a group of tribes of pygmy bushmen more closely resembling the ape than any known human species. The desert lies 1,200 miles northeast of Cape Town and has been shunned by scientists because of the tales of cunning and cruelty told of the bushmen. The known facts of these tribes indicate

the people are living in conditions believed to have existed during the stone age. They use only bows and arrows to hunt and their homes are of the crudest construction.

Dr. Cameron's knowledge of teeth makes him eager to study the dental formations of these people, for he believes that through this study much can be learned of scientific value. He will also take moving pictures, having equipped the caterpillar trucks he will use with refrigeration plants to preserve the emulsion on the films during the hot weather. If these trucks are satisfactory over the desert sands the expedition may work all the way from Cape Town to Cairo.

Booker.—Work progressing on installation of water system here.

109 YEARS OLD
MARSALA, Italy.—The hundredth birthday anniversary of Signora Rosaria Scarfitta, third centenarian, of her family within the past two centuries, has just been celebrated here.

El Paso.—Bids opened for construction of hangar at local airbase.

PREVENTS INFECTION
The greatest discovery in flesh healing is the marvelous Borosone, a preparation that comes in liquid and powder form. It is a combination treatment that not only purifies the wound of germs but causes infection but it heals the flesh with extraordinary speed. Bad wounds or cuts which take weeks to heal with the ordinary liniments mend quickly under the powerful influence of this wonderful remedy. Price (liquid) 30c, 60c and \$1.20. Powder 30c and 60c. Sold by
CITY DRUG STORE

WANTED

Poultry, live or dressed, fresh eggs.

All kinds of fruit and produce.

We have the greatest market at Atlantic City, N. J., for all kinds of poultry, eggs and country produce. We charge 10 per cent commission, quick returns. Ship all goods to Pleasantville, N. J., by express or freight to

ABSECON MARKET CO., Inc.,
Pleasantville, N. J.
P. O. Box 413

HAVE YOUR SHEET METAL WORK DONE BY EXPERTS

Orders Promptly Filled—Work Guaranteed. Tanks, Troughs, Suctions, etc.

LILES SHEET METAL WORKS
165 N. Panhandle Ave. Phone 195

When Summer Time Comes We Give
Our Attention to

Summer Time Needs

Tonics, Amusement Accessories, Such as Kodaks, Phonographs, Flashlights, Etc.

Fountain Service Unsurpassed

Make Our Store Your "Cooling-Off" Headquarters. We are here to serve you.

Prescriptions Accurately Compounded

TEAGUE'S Drug Store

Slaton, Texas

WILLIAMS Transfer & Storage

L. M. WILLIAMS, Owner

Prompt, Courteous and Economical Transfer and Drayage Service
Long Hauls a Specialty.
Economical, Fireproof Storage Room. Satisfaction Guaranteed.

TELEPHONE 51

O. N. ALCORN

Transfer and Storage

Daily Truck to Lubbock
Long Hauls Our Specialty.

All Work Guaranteed.

Night Phone 278-J

Day Phone 99

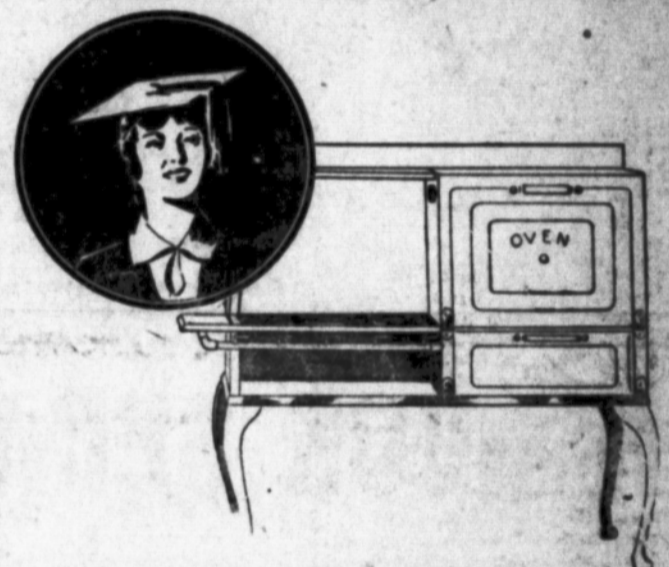

When the Girl Graduate Comes Home . . .

. . . Remember, Mother, she has learned her Home Economics in a scientific way. She will judge the kitchen stove by its efficiency, performance and certainty of results. She will judge the refrigerator by the degree of constant dry cold that it maintains for protecting the family food. She will judge the water heating system by its economy, convenience and dependability.

Modernize With Approved and Tested

Gas Equipment

and thereby conform to scientific standards of home making. It will save time and work, bring your methods up-to-date and make the house more convenient for the whole family.

WEST TEXAS GAS COMPANY

Three Big Dollar Days

Just a Few of the Many Dollar Values are Listed Below

White Turkish Towels, 15x25 inches, 10 for \$1.00
Men's Athletic Union Suits, 3 for \$1.00
Men's Good Grade Half-Hose, 10 Pairs for \$1.00
Men's White Broadcloth Shirts, collar attach. \$1.00
36-inch English Prints, 35c grade, 4 yards for \$1.00

\$1.00

36-inch Print Percale, 6 yards for \$1.00
2 Pairs Ladies' Felt House Shoes for \$1.00
9-4 Bleached Sheeting, 3 yards for \$1.00
Men's Coat Style Work Shirts, 2 for \$1.00
One lot Ladies' Hats, \$4 and \$5 values, for \$1.00

Friday, Saturday and Monday, June 15 - 16 - 18

Jones Dry Goods, Inc.

SLATON, TEXAS

The Slaton Slatonite

Published Tuesdays and Fridays.
Slaton Times Purchased Jan. 20, 1927.

Slaton, Lubbock County, Texas.

T. E. Roderick - Publisher
Tom H. Johnson - Editor
E. W. Collier, Jr. - Adv. Mgr.

Subscription price, per year - \$3.00
Display advertising rate,
per single-column inch - 35c

Entered as second class mail matter
of the postoffice at Slaton, Texas.

A BIRTHDAY

Friday, June 15, 1928, marks the
seventeenth anniversary of the found-
ing of Slaton.

As noted elsewhere in this paper,
this city has made remarkable pro-
gress during the period between the
founding and the present time.

Cities are made by the people who
live within them. They grow in
accordance with the progressiveness of their citi-
zens.

According to this criterion there
are great things in store for Slaton.
All hands should be joined for the up-
building of a greater city.

SANTA FE AFTER THE ORIENT?

The report that the Santa Fe had
bought the Orient seems to have had
only the fruit of premature. Of-
ficials of the Santa Fe have kept si-
lent. But Mr. Kemper of the Orient
is authority for the information that
what the Santa Fe has bought is the
stockholding of the English group.
This, though, is only 40 per cent of
the total, so that the report that the
Santa Fe had bought up the Orient
is ahead of the fact. Yet the fact
is apt to catch up, for Mr. Kemper
says the Santa Fe is now negotiating
for the stock held by him and his as-
sociates. It is not likely the negoti-
ation will be barren.

In the days when it was a popular
pastime to wish the Orient on some
system which could at once use it and
offset to own it the Santa Fe was
now and then nominated. But at least
three others were put under larger
call. The Southern Pacific, the Mis-
souri Pacific, and even the Frisco,
were much more numerously tagged
than the Santa Fe.

The Santa Fe has been engaged for
a year or more in a struggle with the
Burlington in West Texas for primacy
in that empire, and on the whole a
losing struggle it should seem. Its
efforts to extend its lines have not
fared well, whereas those of the Bur-
lington have. Its position in that sec-
tion would be greatly improved if it
could add the Orient's mileage to its
own. The Orient goes into Kansas
City over the tracks of the Santa Fe,
and its Southern reaches do not in-
trude troublesome nor competitively
into Santa Fe territory. The Orient

Get Your Car Washed!

500-lb. pressure washer. Will clean
your engine of dirt and grease. Also
first class mechanic to do your repair
work. All work guaranteed. Also
rent cars and taxis, at Selmon Bldg.
Phone 344.

Selmon & Clark



The Traffic Officer

If every car owner used
Champion Spark Plugs
there would be fewer
traffic jams due to cars
stalling.

Champion is the better spark plug
because it has an exclusive sili-
cimate insulator specially treated to with-
stand the much higher
temperatures of the
modern high-compres-
sion engine. Also a new
patented solid copper
gasket seal that remains
absolutely gas-tight
under high compres-
sion. Special analysis
electrodes which assure
a final spark-gap under
all driving conditions.

CHAMPION
Spark Plugs
Toledo, Ohio
Dependable for Every Engine

is destined to become a great railroad
in any case. But it would become such
much more speedily as a Santa Fe
property.—Dallas News.

Scrapbook Gems

BUGLE SONG

The splendor falls on castle walls
And snowy summits old in story;
The long light shakes across the lakes
And the wild cataract leaps in glory.
Blow, bugle, blow, set the wild echoes
flying.

Blow, bugle; answer, echoes, dying,
dying, dying.

O hark, O hear! how thin and clear,
And thinner, clearer, farther going!
O sweet and far from cliff and scar
The horns of Elfland faintly blowing!
Blow, let us hear the purple glens
replaying:
Blow, bugle; answer, echoes, dying,
dying, dying.

O love, they die in yon rich sky,
They faint on hill or field or river:
Our echoes roll from soul to soul,
And grow for ever and for ever.
Blow, bugle, blow, set the wild echoes
flying.
And answer, echoes, answer, dying,
dying. —Tennyson.

**Wife of Pastor To
Conduct Nazarenes**

In the absence of Rev. W. H. Phil-
lips, pastor of the Nazarene church,
who is now attending the general as-
sembly at Columbus, Ohio, Mrs. Phil-
lips will conduct the Sunday church
services in the city hall auditorium.

Mrs. Phillips has just arrived from
Hamlin, where she has been teaching
for the past four years in the academy
there. Her two daughters will sing
at the services, and one will give a
recitation.

Services will be held at 11 a. m. and
8 p. m., with Sunday school at 10 a. m.

**Luther Program At
Wilson Next Sunday**

A Luther league program will be
rendered at Wilson next Sunday eve-
ning, beginning at 8:30 o'clock, ac-
cording to announcement made.

The opening song will be "Abide
With Me," Miss Angela Wilke will
talk on "College," Selma Voight will
present a recitation, Southland girls
will give a pantomime, and a roll call
with response of a Bible verse will be
taken.

**Sunset Legion At
Palace Saturday**

A study in historical firearms was
recently instituted by Fred Thomson,
popular Western star of Paramount,
who is now appearing in his latest
western thriller, entitled, "The Sun-
set Legion," showing at the Palace
Saturday, matinee and night. In this
new picture with the star of "Jesse
James" and "The Pioneer Scout,"
Thomson poses as a revolver sales-
man, and included in his demonstra-
tion is his display of firearms used by
such famous characters as Wild Bill
Hickok, Billy the Kid, Jesse James
and others, and the manner in which
they "drew from the hip." It was
while studying these types of fire-
arms that Thomson made an interest-
ing discovery.

"Colt's Navy" is mentioned in every
history of the western phases of the
Civil war. It is the weapon which
made it possible for guerillas to ride
with their reins in their teeth and a
gun in each hand. Every rider had
from four to six of them. They killed
whole companies of regular soldiers
who had to stop to reload. The Bor-
der Raiders always used them, and
the famous James boys never rode
without them.

The invention of this then sensa-
tional weapon is credited to Col. Sam-

uel Colt, born in Hartford, Conn., July
19, 1814, and died in 1862. His guns
have written western history.

**Mayor Reese Fireman
On First Passenger
Train Out of Slaton**

Mayor W. G. Reese was fireman on
the first passenger train to make a
run out of Slaton. The run was made
from Slaton to Amarillo with an en-
gine which the mayor said would "look
like a coffee pot" compared to present
day locomotives.

Pat Lowery was conductor on the
train, A. B. Zook was engineer and
Frank Dimmitt was flagman. Zook
now has his headquarters at Amaril-
lo; Lowery has been dead several
years; and Dimmitt is now on the pen-
sion roll.

The train had five coaches, whose
combined weight would be no more
than two of the present-day coaches.

Dr. Serge Voronoff believes that
people could be made to live 150
years. Dr. Voronoff is the originator
of the monkey gland treatment, which
seems to work on the principle that
a man can keep young by making a
monkey of himself.

Good Milk is Your Best
Health Insurance
—and your most economical
food.



THE FLORENCE JERSEY
Milk, Cream and Butter are
recommended from 14 years con-
tinuous use to be unexcelled in
richness, flavors and sanitation.
Delivered Twice Daily and on
Special Call.
Phone 86

**Only Two Forms Of
Government Used By
Slaton Since Birth**

Since the date of incorporation, Oc-
tober 26, 1912, Slaton has had but two
forms of government, the mayor and
aldermanic method, and the present
mayor and city commission form of
government.

The aldermanic form of govern-
ment, adopted after the incorporation,
was continued until April 4, 1922,
when by vote of the people it was
changed to the present form.

The city voted to incorporate by a
very close margin, 31 votes being
cast for incorporation, and 23 against.

Corpus Christi—New Kress build-
ing here nears completion.

- EAT AND DRINK at
- Mutz & Jeff Filling Station
- Cold Drinks, Light Lunches,
- Prompt Service
- Next Door Williams Auto Supply

A. KESSEL



Graduate of School of Podopedic, us-
ing Dr. Scholls foot appliances, spe-
cializing in correct shoe fitting. No
charge for consultation, carrying full
stock of corrected shoes.
At Kessel's Department Store.

**What Dr. Caldwell Learned
in 47 Years Practice**

Dr. Caldwell watched the results of
constipation for 47 years, and believed
that no matter how careful people are
of their health, diet and exercise, con-
stipation will occur from time to time
regardless of how much one tries to
avoid it. Of next importance, then, is
how to treat it when it comes. Dr.
Caldwell always was in favor of get-
ting as close to nature as possible,
hence his remedy for constipation,
known as Dr. Caldwell's Syrup Pepsin,
is a mild vegetable compound. It can
not harm the most delicate system and
is not a habit forming preparation.
Syrup Pepsin is pleasant-tasting, and
youngsters love it. It does not grip.
Thousands of mothers have written us
to that effect.

Dr. Caldwell did not approve of
drastic physics and purges. He did
not believe they were good for human
beings to put into their system. In a
practice of 47 years he never saw
any reason for their use when a me-
dicine like Syrup Pepsin will empty the
bowels just as promptly, more cleanly
and gently, without griping and harm
to the system.

Keep free from constipation! It robs
your strength, hardens your arteries
and brings on premature old age. Do
not let a day go by without a bowel
movement. Do not sit and hope, but
go to a druggist and get one of the
generous bottles of Dr. Caldwell's Syrup
Pepsin. Take the proper dose that night
and by morning you will feel like a
different person. Use Syrup Pepsin for



J. B. Caldwell, M.D.
AT AGE 83

yourself and members of the family in
constipation, biliousness, sour and
crampy stomach, bad breath, no appe-
tite, headaches, and to break up fevers
and colds. Always have a bottle in the
house, and observe these three rules of
health: Keep the head cool, the feet
warm, the bowels open.
We would be glad to have you prove
at our expense how much Dr. Cald-
well's Syrup Pepsin can mean to you
and yours. Just write "Syrup Pepsin,"
Monticello, Illinois, and we will send you
prepaid a FREE SAMPLE BOTTLE.

-- 24 Hour --

-- Abstract Service --

Your Business Appreciated.

PEMBER & STAGGS

Ask about our \$5,000.00 Automobile
Accident Policy.

PEMBER INSURANCE AGENCY

New Hoosier Cabinets

FOR THE JUNE BRIDE

These cabinets are painted to match your
other furniture, or to carry out any color
scheme. Newest shipment.

LOWEST PRICES
...on...
Odd Rockers
...and...
Occasional Chairs

That New Living Room Suite---

You'll want to choose it from the
new shipment we have just received. For
distinctive dining rooms, too, there are
suits that will suit the most discriminating
taste. Beautiful bedroom furniture of the
same high grade.

You'll like the prices, too, they are
remarkably low.

See our line and get our prices before
you buy.

ELROD & BIRKES

for Economical Transportation

CHEVROLET

Over a Half
Million
New Chevrolets
on the road since
Jan. 1st



The COACH
\$585
The Touring \$495
or Reo-tourer...
The Coupe... \$595
The 4-Door... \$675
The Convertible... \$695
The Imperial... \$715
The Utility Truck... \$495
(Chevrolet Only)...
Light Delivery... \$375
(Chevrolet Only)...
All prices f. o. b. Flint,
Michigan
Chevy Chevrolets
Delivered Prices
They include the lowest
handling and loading
charges available.

Since its announcement
on January 1st of this year
the Bigger and Better
Chevrolet has been award-
ed a public acceptance
of spectacular proportions.
Every day thousands of
people purchase new
Chevrolets. Already there
are more than a half-
million of these new
cars on the road!

Never before has a new
model been so enthu-
siastically received—for
never before has any auto-

mobile represented such
an amazing revelation in
beauty, performance and
low price! Here are the
quality features and the
interior refinements de-
manded in the world's
finest motor cars—to a
completeness of detail
astounding in a low-priced
automobile!

Come in and see for your-
self. There are seven dis-
tinctive models for you to
choose from.

Removal of War Tax Lowers Delivered Prices!

Jackson Chevrolet Co
QUALITY AT LOW COST

CLASSIFIED ADS

do not ask us to carry charge on classified advertisements, cannot do it.
Respectfully,
The Publishers.

TRACTS—Two 11-acre tracts, one 20-acre tract, located within one-half mile of town; has gas tap made to each tract. Owner will make good terms. See J. T. Overby, Agent. 46-2c

FOR SALE CHEAP—Windmill, tank and tower. See them at 209 South Fifth street. See Tom Harris for terms or phone 98. 47-3p

BARGAIN in one 5-room modern house, if sold at once; terms very little more than rent. J. T. Overby, Agent. 46-2c

CALL at City Drug Store to pay all accounts due Jno. Dabney & Son. 47-3c

FOR LOTS in district west of County Park, see me for prices and terms. J. T. Overby, Real Estate. 46-2c

FOR SALE—Packard Piano in good condition. Mrs. S. R. McManus, 400 South Fifth Street. 45-47p

WANTED—Day nurse for five-month-old baby. Apply at Vanity Fair Beauty Parlor, Ninth Street. 47-1c

ELDORADO. — Ranchmen in this section are co-operating in fly trapping.

BIG LAKE. — Soft water will be turned into mains of Big Lake in June.

"Scientists Seek to Kill Disease Bacilli by Radio"—News headline. We know several broadcasters we could recommend to these scientists.

VANITY FAIR



MARCELS

EVERY WEDNESDAY
EVERY THURSDAY—

These are MARCEL DAYS. Get your mid-week marcel from Mrs. Ethel Kline, who comes to us from Lubbock on these days, especially for your service.

Mrs. Lena McElroy
Call 252. Ninth Street

Miss Mae Murfee Enters Race For Superintendency

Miss Mae Murfee, member of a pioneer Lubbock county family, for a number of years a school teacher, and for the past several years secretary of Lubbock chapter of the American Red Cross, today authorized the Slatonite to announce her candidacy for the position of superintendent of Lubbock county's schools.

In regard to her candidacy, Miss Murfee makes the following statement:

To the Voters of Lubbock County
At the solicitation of friends over the county, I am hereby announcing for superintendent of Lubbock county schools at the coming Democratic primary election on July 28, 1928. I realize the hardships incidental to the campaign and my responsibilities if elected, but it is needless for me to speak further of myself as my family and I have lived in Lubbock county for the past twenty-four years, much of which time I have spent in teaching in Lubbock county schools, part of the time in the rural schools, part in the elementary and a number of years in the high school of the city of Lubbock and a large number of my patrons, pupils and superintendents are in the county at this time who will possibly be a better judge of my work than I would be. I am a Democrat, a graduate of both high school and college and have tried to make a success of whatever work I have gone into and if elected to this office will appreciate it and try and serve the schools of this county to the best of my ability with fairness toward all.

(Signed) MAE MURFEE.

Engagement Miss McReynolds To Mr. Shepherd Is Told

Mrs. Dick Odom and Mrs. P. A. Minor were hostesses at a charming little dance at the Santa Fe reading room last Tuesday night, honoring Miss Vertizuma McReynolds, whose engagement to R. Morris Shepherd was announced at that time.

The reading room was attractively decorated with streamers of crepe paper and baskets of roses to carry out the color scheme of pink and white. Music was furnished by the Panatrop and by Joe Mishou at the piano. Punch was served throughout the evening, the table being presided over by Mrs. C. T. Lokey.

When the strains of the wedding march were heard, little Miss Nancy Nell Everline entered carrying a basket of pink roses, followed by Tommie Blair as ring bearer. Miss Maxine Odom and Miss Doris Minor as brides and groom came next. Dainty little

Miss Posey Lou Gainer acted as train bearer for the bride. These passed among the guests, carrying little cards announcing the coming nuptials of Miss McReynolds and Mr. Shepherd.

The guests included: Misses Josephine McHugh, Frances Bluntell, Aline Tucker, Della Smith, Marion McHugh, Lillian Henry, Lola Bell McRae, Edith Marrs, Pauline Lokey, Lucile Henry, Mildred Redwine, Virginia Montague, Jo Hestand and Vertizuma McReynolds; Messrs. Sug Roberts, Howard Hoffman, Roy Brock, Pat Murphy, Bruce Pember, Herschel Dawson, Mark Leveridge, Cecil Cope, William Sewell, C. C. Hoffman, N. N. Mullins, Joe Mishou, Jack Shepherd, Robert McKee, and Gilder Levy of Abilene; Mr. and Mrs. Kirby Brown, Floyd Rector, Harry Green, Roe Gainer, Fred England, E. B. Caraway, Tom Blair, George Everline, J. F. Merrill, George Marriott, C. T. Lokey.

The out of town guests included Mr. and Mrs. Dwight Hale of Lubbock, Mrs. Joe Kuykendall of Marysville, California; Mrs. Colquitt Williams of Comanche, Mrs. J. P. Posey of Lubbock and C. E. McReynolds of Sweetwater.

Miss McAtee Honoree At Bridge Thursday

Miss Ann McAtee was honoree at a bridge party given by Mrs. Zeph Fogerson at her home Thursday morning.

Two prizes were awarded, one being received by Joe Hestand for high score, and Miss McAtee receiving the guest prize.

There were five tables of bridge. When Dr. Voronoff's theories prove true, we may see the older generation scoring shameful conduct of seventy-year-old flappers.

Charles M. Schwab says he does not know how much money he has—he is too busy to find out. Some of us are too frightened to find out how much we have.

ELLIOTT & LOKEY
• Wiring, Electrical Supplies and
• Radios PHONE 340
• Service Calls Answered Promptly

Lubbock Sanitarium (A Modern Fireproof Building) and Lubbock Sanitarium Clinic

DR. J. T. KRUEGER
Surgery and Consultations
DR. J. T. HUTCHINSON
Eye, Ear, Nose and Throat
DR. M. C. OVERTON
Diseases of Children
DR. J. P. LATTIMORE
General Medicine
DR. F. B. MALONE
Eye, Ear, Nose and Throat
DR. J. H. STILES
General Medicine
DR. L. P. SMITH
General Medicine
MISS MABEL McCLENDON
X-Ray and Laboratory
C. E. HUNT
Business Manager

A chartered Training School for Nurses is conducted in connection with the Sanitarium. Young women who desire to enter training may address the Lubbock Sanitarium.

SPECIALS! FOR SATURDAY AND MONDAY June 16 and 18

Values like these are found only in one of our Stores.

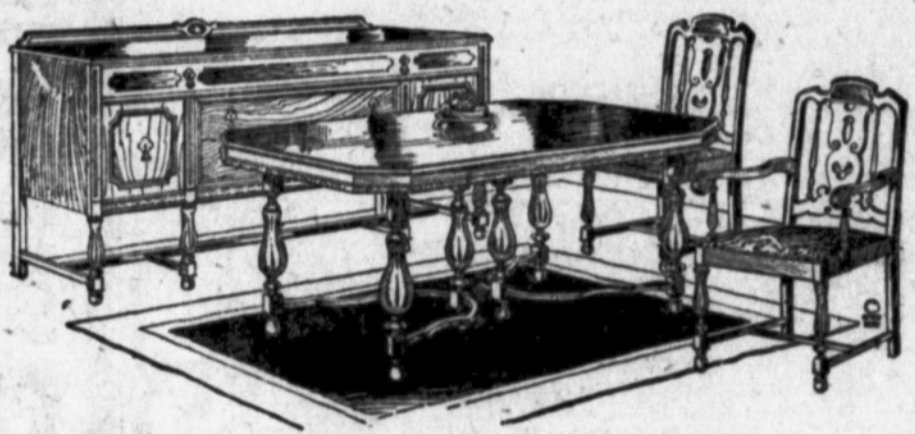

Always read our ads. You will profit by doing it.

We make our own Mattresses

8-Piece Dining Room Suite in Walnut

Extension Table, large and strong. 54-inch Buffet, two-toned and decorated. Six Heavy Chairs with Velour Seat—

\$91.75

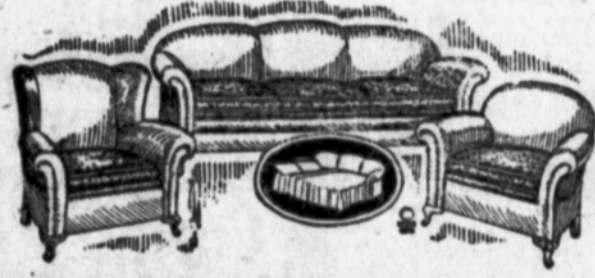

3-Piece Bed Living Room Suite Overstuffed

Covered with heavy Jacquard Velour in Taupe and Mulberry colors—

\$91.75

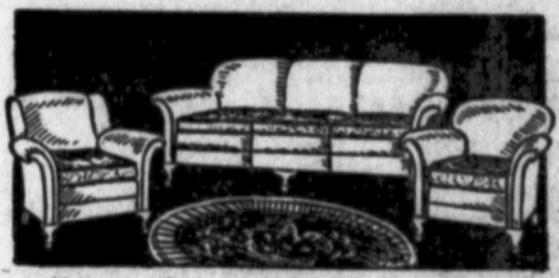

3-Piece Overstuffed Living Room Suite

Covered with Heavy Jacquard Velour in Taupe and Blue colors—

\$91.75

WOOL WILTON RUGS

On Saturday afternoon, for ONE HOUR ONLY (3:30 to 4:30) we will sell Beautiful Wool Wilton Rugs, \$125.00 value, for only—

\$81.75

DANDY ICE CREAM FREEZER

Starting Saturday morning, we will sell the family size DANDY Ice Cream Freezer, while they last for only—

98c

Amarillo Furniture Company

Slaton Branch

Phone 53

Store No. 11

PALACE THEATRE SLATON

Saturday—Matinee and Night



FRED THOMSON in 'The Sunset Legion'

COMING

Monday and Tuesday
JUNE 18-19

Gals, Hide the Boy Friends

Here's the blonde they all prefer. She's beautiful, but not NEARLY so dumb. Men can't forget this baby. They always remember—with diamonds and jewels. Paramount's KNEE-PLUS-ULTRA comedy.



WHERE is nothing quite like Bayer Aspirin for all sorts of aches and pains, but be sure it is genuine Bayer; that name must be on the package, and on every tablet. Bayer is genuine, and the word genuine—in red—is on every box. You can't go wrong if you will just look at the box when you buy it!



McMillan Chosen Head of Camping Scout Committee

R. J. Murray, president of the South Plains area council, Boy Scouts of America, announces the selection of W. G. McMillan, of Lubbock, to head the camping committee of the Boy Scouts of the South Plains.

"The camping program is the most important part of our Boy Scout work," Mr. Murray says. "It is in the great outdoors that the boy comes in contact with nature and learns those great principles of life which are so essential to a happy nation. It is in the outdoors that the boy builds himself physically, mentally and morally. Because of the importance of this part of our program the executive committee has given considerable thought to the selection of a man to head the camping program. In Mr. McMillan we feel that we have secured the right man. Mr. McMillan is an outdoor man, having had a great deal of experience in camping, hunting, and fishing. He took a very ac-

tive part in the recent district Scout Leaders' Training school at Lubbock. The outdoor session of that training course was held on the Boy Scout camp at Post. Here Mr. McMillan became interested in the possibilities for development of this camp. Mr. McMillan is a graduate of A. & M. college and is in the contracting business. His knowledge of construction work and camping should help us to develop a real scout camp for the South Plains."

Mr. McMillan is now working on the development of plans for the summer training camp for the scouts of the South Plains. He has announced the dates of July 30 to August 8 as those for the holding of the summer camp. It is expected that there will be such a large enrollment that an additional ten-day period will be held following the first camp. Mr. McMillan plans to spend a couple of days at the Post

camp in the near future, looking over the equipment and completing plans for the summer camp.

Oakland-Pontiac Sales 128,305 In Last Five Months

Sales of Oakland and Pontiac sixes during the first five months of this year reached a record total of 128,305 cars, according to figures released at the factory this week.

This volume of sales shows an increase of 49,019 or nearly 62 per cent over the 79,286 Oakland-Pontiac sales recorded during the first five months of 1927 when the Oakland Motor Car company was moving up from ninth

to fifth place in the automotive industry.

Oakland executives are making no predictions as to what position the company may attain by the end of the year. They merely point to the figures. One illuminating bit of data shows that when the year 1928 was only three months old, the sales of Oakland-Pontiac sixes had reached a total of 74,118, which very nearly equals the sales registered by the company during the entire first five months of 1927.

W. R. Tracy, vice-president in

charge of sales, states that recently increased factory facilities now are adequate to take care of the growing volume of orders.

Influence of Home Town Paper Urged

MEMPHIS. — No publication carries greater interest and greater influence to the rising generation than the home town newspaper, Charles M. Merdeith, editor of the Quaker-town, Pa., Free Press, said Monday

in his president's message to the forty-third annual convention of the National Editorial Association.

Merdeith warned his fellow editors "not to be robbed of tranquility" through fear of consequences if they publish the truth pertaining to the welfare of their communities, but urged them to strive at all times to keep their columns free of "questionable politics and questionable advertising." "Advocate strict observance of the law and thereby promote the highest ideals possible," he said.

An Investment with an EXTRA DIVIDEND

THERE'S a big difference between an investment and a speculation. You can speculate in any old gasoline and hope it will deliver a satisfactory number of miles per gallon. You can invest in Summer Conoco and be sure of an extra dividend—a bonus of extra miles.

Your purchases of gasoline during the touring season represent a substantial investment. Make sure that the returns from that investment are the highest you can get.

Fill at the Conoco pump.

CONTINENTAL OIL COMPANY
Producers, Refiners and Marketers
of high-grade Petroleum products in Arkansas, Colorado, Idaho, Kansas, Missouri, Montana, Nebraska, New Mexico, Oklahoma, Oregon, South Dakota, Texas, Utah, Washington and Wyoming



packed with
—extra miles!

June Clean-up Sale

Beginning 15

On Quality Merchandise

COMPARE OUR PRICES

WE SAVE YOU MONEY

and

SELL YOU QUALITY MERCHANDISE

CYPERT DRY GOODS

WE GIVE AND REDEEM GOLD BOND STAMPS
SLATON TEXAS

FORDOR SEDAN—

Within the next few days we will have on our Sales Floor the

New Model Fordor Sedan

We invite you to call and see this wonderful car, which will compare favorably with other makes of cars selling up to \$1,500.00 in performance, workmanship, material and refinement.

Slaton Motor Company

LINCOLN FORD FORDSON

Father's Day



Sunday, June 17
For Dad

- Cigars Pipes
- Tobaccos
- Fountain Pens Pencils
- Stationery
- Belt Buckles Watch Chains
- Watches
- Pocket Knives Razors
- Shaving Sets

Many other gifts for this day are to be found at our store.

CITY DRUG STORE

RIGGS & MYERS
Texas Avenue Through Eighth St.

Mother!

Child's Best Laxative is
"California Fig Syrup"



Tongue Shows
Bilious, Constipated

Happy Mother! Even a fretful, peevish child loves the pleasant taste of "California Fig Syrup" and it never opens the bowels. A teaspoonful may prevent a sick child tomorrow. Ask your druggist for genuine "California Fig Syrup" which has directions for babies and children of all ages printed on bottle. Mother! You may say "California" or you may get a cheap imitation fig syrup.

Faithful Wives In India Once Punished By Having Noses Cut

OMBAY.—In India it used to be a gentle Hindu custom to punish unfaithful wives by cutting off their noses. But after the liege lords and lords of these nose bereft ladies had fled to Nirvana—or whatever it was they were headed for—the ladies looked about for methods of making their existence more tolerable. Their technique consisted in dissecting a piece out of the biceps muscle—that muscle on the upper arm which the youthful male is so fond of exhibiting for the purpose of exciting feminine admiration.

The piece of muscle was left connected with the mainland by a few shreds. They would then give the loose flap a nose-like shape, roughen up the surface where the old nose, or the stump of a nose, held forth and sew the flesh model fast on this firm nose. Then they bound the arm solidly to the head by a special apparatus, which held it in this position until granulation and healing took place. This usually required about three weeks. Finally, when the new nose had grown on, the arm was cut loose.

Gaspara Tegliocozzi, a professor of anatomy at the University of Bologna, rediscovered this operation in the sixteenth century. When he died in 1597 his admiring fellow citizens made a statue of him and placed it in the market square of his native town. Here he was represented in a dignified, graceful attitude, pleasantly but carelessly, holding a human nose in his hand.

Use Dummies In Test Of Driving Dangers

WASHINGTON.—By the use of dummies of adults and children, scientists at the bureau of standards have performed a number of tests that show some of the hazards of night automobile driving and the difficulties of providing adequate lighting. One of the striking results of the experiments proved the importance of light-colored clothing at night as an additional protection to the pedestrian.

When the dummy of the man was dressed in white it was seen twice as easily as when clothed in dark garb and appeared to be considerably larger.

First U. S. Newspaper Printed in Alexandria

WASHINGTON.—Before Washington was founded there was being published in a city only six miles away a newspaper which now claims to be the oldest daily in America.

"The Alexandria Gazette" began its existence in 1874 in the Virginia city of the same name. Before it was a year old it reported the meeting at Mount Vernon which resulted in calling the constitutional convention. In 1789 "The Gazette" gave a graphic account of Washington's inauguration and how the President passed through the flower-strewn streets of Alexandria on his way to New York for the inauguration. Ten years later its pages were in mourning for the passing of this great American. "The Gazette" carried an account of the inauguration of Thomas Jefferson in the struggling and muddy village of Washington.

In the Civil War "The Gazette" was pro-South. After Colonel Ellsworth was killed in the Marshall house, Alexandria, the city was occupied by Union troops. "The Gazette" was so outspoken about the seizure of the rector of old Christ church in the pulpit by soldiers that the newspaper plant was fired. But the paper continued to be printed on a hand-press in secret, receiving its news via the "grapevine" system.

Find Speckled Trout In Vinegar Barrel

YAKIMA, Wash.—The resurrected toad found in Texas has little on a speckled trout which grew up in a vinegar barrel while floating half submerged in Bumping lake, near here. One of a party of anglers caught his hook on the side of a barrel. Splashing in the barrel attracted attention, and on breaking in the head a sixteen-inch well developed trout was liberated—into the creel of a proud angler.

The bung of the barrel was too small to admit such a fish, so the fishermen surmised it swam into the caisson while a minnow.

TULLA.—Through efforts of the chamber of commerce, postcards showing Tulla scenes will be available here soon.

Spelling List Made By Interscholastic League for Schools

AUSTIN.—Two hundred thousand copies of the revised interscholastic league spelling list will be issued by the Interscholastic League bureau of the University of Texas at Austin during the summer, according to Roy Bedichek, chief of the bureau. This is the largest edition of a single bulletin ever printed by the University Press, Mr. Bedichek said.

Arranged in three different lists, the bulletin will contain 7,000 words. Lists are prepared for the sub-juniors, children up to the fifth grade; for the juniors, children from 10 to 14 years of age; and for the seniors, pupils from 14 to 20 years of age.

Greater effort than ever before has been made to secure a list which represents only words in the vocabulary of the children so that they will not waste time in learning words which will be of no use to them, Mr. Bedichek pointed out. These words were selected by having a questionnaire circulated among 10,000 Texas teachers, who listed the words from children's themes and from words the children found difficulty in spelling. From these questionnaires was compiled the basic list, which was then compared with similar lists from other states. Recognized spelling lists, such as Horne's and Ayre's were then referred to, and the completed list arranged.

Some 5,500 Texas schools take part in the Interscholastic league spelling contest each year, Mr. Bedichek added.

PORTALES, N. M. — Capacity of the local cheese factory is to be doubled upon arrival of new equipment.

Wild Horse Herds In Mexico Hard to Find

MEXICO CITY.—Gone are the days in Mexico when horse were to be had by anyone able to capture and time wild ones from masterless herds roaming the land.

The Mexican revolution practically wiped out the already dwindling numbers of wild horses in this country. Perhaps a few may still be found in very inaccessible regions, but they are so scarce and so difficult to find it is no longer worth while to hunt them as a profession.

Many years ago only laziness, clumsiness or poverty could explain a person's failure to own a horse in Mexico. Anyone with the skill and ability to do so could help himself from wild herds or buy animals from those who had captured them. The supply was so abundant that hunters could be choiced about the points they desired in their catch. The government once commissioned a wild horse contractor in Chihuahua to supply 5,000 cavalry mounts. He replied: "What color do you want? The story goes that his men caught that number of the required color.

WHAT MAKES A GROUCH?
CHICAGO.—Leading psychiatrists, neurologists and sociologists have started a discussion as to what makes the grouchy worker grouchy and how to remove the grouch, thus saving business many thousands of dollars—if they can find the "grouch germ." They will scrutinize the mental workings of the grouch, the kicker, the supersensitive and the idle dreamer at a luncheon under the auspices of the Illinois Society for Mental Hygiene.

Tenaha—First State bank of Tenaha to move into its new home soon.

Mussolini Is Santa Claus To Children

ROME.—When boys and girls of Italy want things very badly they write to Mussolini or to good Queen Elena, just as American youngsters write to Santa Claus. And more often than not their wishes are fulfilled.

Mussolini recently "dug down" to buy a uniform for a poor young "Avanguardista," unable to provide himself with an outfit. The Queen at about the same time bestowed a big doll on a girl whose parents were too poor to give her one and accompanied her gift with a letter.

"The august majesty that shrouds a king" protects Victor Emmanuel from requests of this character. Mussolini, being a child of the people, and proud of it, and Queen Elena, known

everywhere in her kingdom for her charity, do not instill the same awe in juvenile souls and are consequently more often solicited.

Less than one per cent of the telephone calls made in Chicago result in wrong numbers, according to a check made by the department of public service of Illinois.

A SPLENDID FEELING
That tired, half-sick, discouraged feeling caused by a torpid liver and constipated bowels can be gotten rid of with surprising promptness by using Herbine. You feel its beneficial effect with the first dose as its purifying and regulating effect is thorough and complete. It not only drives out bile and impurities but it imparts a splendid feeling of exhilaration, strength, vim, and buoyancy of spirits. Price 60c. Sold by
CITY DRUG STORE

A Progressive Bank

We are for anything that means progress for Slaton or Slaton communities.

If you have business problems worrying you, talk them over with us. Maybe we can help.

Slaton State Bank

Directors: R. J. MURRAY, Pres. W. E. SMART, Vice Pres. W. E. OLIVE, Active Vice Pres. CARL W. GEORGE, Cashier. J. S. TEKELL, Ass't. Cashier.
Officers: R. J. MURRAY W. E. SMART W. E. OLIVE CARL W. GEORGE W. S. POSEY

AS THE DAYS GET WARMER—
OUR PLACE GETS COOLER
—The most up-to-date Cold Drink Fountain and Confectionery in Slaton is BY THE POST OFFICE.
The Star-Telegram Magazines Periodicals
SLATON CONFECTIONERY
W. E. GARREN HENRY PHILLIPS

Hurry! You Can't Afford to Miss This Big Event!

Kessel's Gigantic Reorganization

SALE

STARTING

Friday June 15, at 9:00 A. M.

Oil Cloth
Regular 35c value per yard **19c**
Voile
Solid colors, 35c value, per yard **19c**

Men's Suits
Values up to \$17.50, special at **\$9.98**
Men's Overalls
Good grade, special at only **88c**

Silk Dresses
Good assortment, new and stylish, worth up to \$10, special at **\$4.95**
There will be big values like these all through the store but we haven't room here to list them. Come and see.

FEDERATED STORES
A Chain of Independent Stores United in Buying and Advertising.
Announcement:
Several months ago this store became one of several hundred **Federated Chain Stores**, a great National association of individually owned stores. Today the Federated Stores is the fastest growing chain in America with headquarters in all principal cities in the United States. After long weeks of experimenting and research this store has been selected as the official 100 per cent Federated store in this section.
Drastic Changes in Our Operation Must Go Into Effect at Once!
(1) Modern methods of merchandising are to be instituted.
(2) Scientific means of stock control—stock management and display must be used.
(3) Standardized systems of selling and advertising are to be employed the moment we have reduced our present stocks to the **FEDERATED** standard. Hence our decision to close out every dollar's worth of surplus merchandise within these four walls.



KESSEL'S

"Where You Do Better"
SLATON, TEXAS

LOOK!
100 Dandy Good House Brooms. While they last, at—
1c Each

LOOK!
100 6-Cup Aluminum Percolators. While they last, at—
1c Each

Announcements

The Slatonite has been authorized to announce the following persons as candidates for public office, subject to the action of the Democratic Primary in July, 1928. Voters of Slaton and Lubbock county are requested to give careful consideration to those whose names are listed as follows:

For District Judge, 99 & Judicial District:

CLARK M. MULLICAN, of Lubbock (for re-election)
CHAS. NORDYKE, of Lubbock.

For County Judge:

D. E. KEMP, of Slaton.
GEORGE W. FOSTER, of Lubbock
ROBERT H. BEAN, of Lubbock

For County Attorney:

BENJAMIN KUCERA, of Lubbock.
VAUGHN E. WILSON (of Lubbock)

For Sheriff:

H. L. (Bud) JOHNSTON, of Lubbock (for re-election)
WADE HARDY, of Lubbock
C. A. HOLCOMB, of Lubbock
ROSCOE PARKS, of Lubbock.

For County Clerk:

AMOS H. HOWARD, of Lubbock (for re-election to 2nd term)

For County Treasurer:

VIRGINIA FANN, of Lubbock.
MISS ANNIE FORD, of Lubbock.

For Tax Collector:

A. J. CLARK, of Lubbock.

For Tax Assessor:

R. C. (ROLLIE) BURNS, of Lubbock (For Re-Election)
CHAS. B. METCALFE, of Lubbock.
A. B. ELLIS, of Lubbock.

For Justice of Peace, Precinct No. 2:

J. H. PHILLIPS

For Commissioner of Precinct No. 2:

J. T. PINKSTON, of Slaton (Re-election)

For Public Weigher, Precinct No. 2:

I. E. MADDEN (for re-election)
J. G. HARPER

MISS MAS MURFEE, of Lubbock
For County School Superintendent:

PROFESSIONAL DIRECTORY

Dr. L. W. KITCHEN
VETERINARY SURGEON
POST, TEXAS

FOSTER
Funeral Home
Slaton, Texas

Embalming and Funeral Directing. Ambulance Service.
Phone 125 — Day or Night.
Agents for Lubbock Floral Co.

DR. J. B. JACKSON
DENTIST
208-210 Ellis Building
Phone 535-1873W Lubbock, Tex.

Hightower & Shanks
DENTISTS
Benton Bldg. Slaton, Texas

W. L. Huckabay, M.D.
Slaton, Texas
Special Attention Given to Diseases of Women and Children
Office in City Drug Store
Phones: Office 245; Res. 175

BOONE and BOONE
CHIROPRACTORS
301 Myrick Bldg.
LUBBOCK, TEXAS

Swart Optical Co.
Lenses Ground, Eyes Tested, Glasses Fitted
First Floor, Myrick Bldg.
Office Ph. 1785—Res. Ph. 199W
LUBBOCK, TEXAS

News Shorts Of Towns of Texas

Nacogdoches—Graveling Cushing highway from near here to Cushing sought.

Pittsburg—\$77,000 contract let for construction of new Camp county court house here.

Average number of local and toll telephone calls in state of Texas over Bell system wires is now more than 4,500,000 per day.

Eastland—Three oil tests spudded in during recent week by H. B. Mays and associates.

Wickett—Construction work started laying six-inch welded gas line into this place from Hendricks field.

Houston—Laying concrete on Galveston road completed.

Mexia—New concrete highway from here to Groesbeck opened.

Jefferson—Contract let for graveling Highway No. 49 from here to Louisiana line.

Corpus Christi—Nine-story Cotton Exchange building being erected here.

Pampa—Gray county fair will be held here this year October 11-12.

Corpus Christi—H. H. Key to erect \$8,000 new store building on Leopard street.

Eastland 20,000 horsepower unit of Oil Belt power plant installed.

Eastland—Good progress being made on construction of \$20,000 building for Ideai dairy.

Cleburne—Fire hydrants to be installed on Woodward avenue.

Eastland—Mickle Hardware company moves into L. B. Wright building.

Stinnett—Work being rushed to completion on erection of new school building here.

Albany—Decatur Oil company opens new shallow pool in southern Shackelford county.

Eastland—Two new dairy farms near here are latest developments in county dairy program.

Grand Saline—Burned school building of Van Independent district will be rebuilt.

Dalhart—H. C. Coleman constructing new brick building to be occupied by Dalhart Public Service company.

San Saba—Four carloads eggs shipped from here within past three months.

Jacksonville—Oil prospecting operations to begin in Mud Creek section east of here.

Rusk—\$62,000 contract let for construction of new hospital building for insane here.

Tyler—Local Chamber of Commerce proposes purchase of municipal air-drome of 100 acres.

Canadian—Southwestern Bell Telephone company to increase its cable capacity in southeastern part of town.

Borger—Searification work in progress on Borger-Phillips school house road.

Borger—Bridge being built across Dixon creek near Ralph-Baker corporation plant two miles east of here.

Brownwood—Anchor Oil company's No. 1 brought in on land of C. E. Taylor, three and one-half miles west of here.

Coleman—Texas company brought in big gasser in N. W. Vance tract 10 miles south of here.

Wichita Falls—Texas Pipe Line company has completed and is testing its new oil carrier from Kingsmills to Gray county.

Signorina Scarfitta came by her longevity by inheritance. Her mother lived 102 years and eleven days, and an aunt also reached 102.

Booksellers Decry Salacious Books

ATLANTIC CITY, N. J.—Salacious books were the target of the board of trade committee of the American Booksellers association at their annual convention.

"The publication and sale of books primarily on the basis of their salacious appeal invites censorship, with its obvious evils," said Arthur Brentano, Jr., of New York, vice-president and spokesman for the association. "The board is pleased to report that the furor caused by censorship publicity—which is not always to the advantage of the trade—has subsided somewhat during the last year. We are opposed to federal, state and municipal censorship. Intelligence, good taste, humor and common sense are the real censors to whose dictates publishers, booksellers and the reading public should conform."

Increasing travel by Americans, Mr. Brentano added, had stimulated the sale of books enormously, as witnessed by the fact that his firm alone sent an average of 2,000 books to passengers on every steamer leaving New York.

All the delegates reported that Americans in general seemed to have more time for reading.

"Sex stories are rapidly losing ground," said Fred Melcher, editor of "The Publishers' Weekly," "though these and religious works will always have their following. The popular trend is toward philosophy and biography. Fiction is having a hard pull on sales."



Fine Points

Neatness often depends on scissors with the right points—fine and sharp, points that meet with a firm "snip" at the tip. Your scissors should combine these points with sharp blades and accurate adjustment; and they will if their name is

KEEN KUTTER

Scissors and Shears For 37 years the standard of quality. The very best pocket knives for men and women are marked Keen Kutter, the entire Keen Kutter line being sold under this mark and motto: "The Recollection of Quality Remains Long After the Price is Forgotten." Trade Mark Registered.

"The House of Satisfaction"

Worley Hardware Company

Hardware at Popular Prices

Quality—Service

PHONE 121 SLATON, TEXAS

Free Picture

SATURDAY, JUNE 16, IS

National Children's Day

One 8x10 Tinted Picture for all Children under 12 years

Saturday and Monday

With each Dozen Photographs, any size.

Manire Studio

Mel Thurman, Manager.

EXPERT MERCHANDISING

The Piggly Wiggly system guarantees you the finest foods in the finest possible condition Our icebox is always open for your selection Piggly Wiggly foods stay fresh

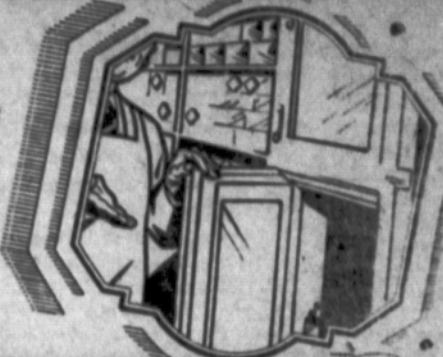

PIGGLY WIGGLY

New Spuds	Per Pound	.02 ¹ / ₂
Lard	White Cloud 8-Pound Pails	1.08
Post Bran	Per Package	.10
Meal	Gold Medal 10 Pounds	.35
Peaches	Blue Ribbon 2 Pounds	.37
Raisins	Market Day 4 Pounds	.34
Syrup	Blue Brer Rabbit Per Gallon	.78
Kraut	Van Camp's Medium Can	.09
Hominy	Van Camp's Medium, 3 Cans	.19
Soap	Crystal White 6 Bars	.23
Salmon	Pink Per Can	.17 ¹ / ₂
Macaroni	American Maid Per Package	.06
Corn	Concho No. 2	.12 ¹ / ₂
Red Beans	Wapco Per Can	.08 ¹ / ₂
Wesson Oil	Pints	.25
Coffee	Blossom Peaberry 3-Pound Can	1.19
Pickles	A. A., Quart, Sour Per Quart	.23
Honey	Extracted Per Gallon	1.23
Blatz Malt	Per Can	.53
Preserves	Ever Best Pure Fruit Ass'd. Flavors, 1-lb. Jar	.28

Market Specials

BACON, Best Grade, Sliced, Per Pound	.38
MEAT LOAF, Per Pound	.20
PORK STEAK, Per Pound	.22
HAMBURGER STEAK, Per Pound	.20

Slaton History
(Continued From Page One.)

by magic. The first group of brick buildings erected was the group now on the west side of the square, exclusive of the present Hotel Forrest, which was built later.

J. S. Edwards and P. E. Jordan financed the building now occupied by the First State bank and three others, J. E. Lidington financed one, Dr. J. F. Scott financed one, S. S. Forrest financed two, and Judge W. A. Hainer of Clovis financed two.

The north side of the square was the scene of the next growth in the business district. By the fall of 1911 there were five brick buildings housing business enterprises.

Residences Follow.

Corresponding with the growth of the business district, a residential district sprang into existence. The first three residences were built by S. S. Forrest, P. E. Jordan, and J. S. Edwards. They were located on Grand avenue, due south of where the Christian church now stands.

With a substantial town assured by the location of the railroad division point, factories and industries began to find a home in Slaton. The Slaton Cotton gin was built within a few months after the town was opened.

Santa Fe Builds.

Within that same brief period of time the Santa Fe had constructed and had under process of construction a roundhouse, a machine shop, a power plant, a water plant, a coal chute, a sand house, a blacksmith shop, a store house, lavatory buildings, offices, a fire station, a sewage system, an electric light system, and twenty miles of sidetrack facilities.

Under contemplation were the freight and passenger depot, the Harvey House, and the reading room. As development of the town demanded, these facilities have been augmented, the latest improvements being made in 1927 at a cost of approximately \$300,000, bringing the vested interests of the Santa Fe here to more than \$4,000,000.

Slaton had a substantial backbone assured, and the framework has grown constantly since. At the present writing the outlook is bright for a steady growth which will bring Slaton to the front as a leading West Texas city.

Austin—Bids requested for furnishing large quantity of road machinery, including 20 crawler-type tractors.

Telephone Operator Helps In Recapture

COLUMBUS.—While it was the officers of the law who were successful in apprehending the prisoners who recently broke jail in Columbus, Ohio, it was the telephone that led directly to their capture, and more particularly it was Mrs. Mary Berry, telephone operator for the Ohio Bell Telephone company at Galloway, who showed much initiative in rounding up the culprits.

Mrs. Berry received warning from the Columbus long distance operator that the prisoners were believed to have escaped in that direction. She called Georgesville and learned that the convicts' car had just passed that point. She then called London, where she assisted in getting the sheriff of Madison county and other officials lined up, so that when the prisoners came along the Georgesville-London road the police officials were waiting them.

Convention

(Continued From Page One.)

gations, indications are a week in advance of the tenth annual West Texas Chamber of Commerce convention that the event will be by far the greatest gathering in the history of the organization.

The first business session of the West Texas body, the largest regional chamber of commerce in the world, will be held on Monday, June 18, and continue until Wednesday evening, when the new president will be installed and the next meeting place selected. Thousands of rooms have already been reserved for the visitors, while scores of delegations will come prepared to camp in the various parks or tourist camps of the city. Local committees, composed of more than 150 of Fort Worth's leading business men, have been devoting much time to the plans for the convention, and were tomorrow the opening date, according to Manager Homer D. Wade, the city would be ready for the guests.

League Changed

(Continued From Page One.)

vs. Texas Avenue; July 25, West Side vs. Santa Fe; July 26, Texas Avenue vs. Utilities; July 27, Utilities vs. Santa Fe; July 31, Texas Avenue vs. West Side; Aug. 1, West Side vs. Utilities; Aug. 2, Santa Fe vs. Texas Avenue;

Aug. 3, Utilities vs. Texas Avenue; Aug. 6, Santa Fe vs. West Side; Aug. 7, Santa Fe vs. Utilities; Aug. 8, West Side vs. Texas Avenue; Aug. 9, Texas Avenue vs. Santa Fe; Aug. 10, Utilities vs. West Side; Aug. 13, Texas Avenue vs. West Side; Aug. 14, Utilities vs. Santa Fe; Aug. 16, Texas Avenue vs. Utilities; Aug. 17, Santa Fe vs. West Side; Aug. 20, West Side vs. Utilities; Aug. 21, Santa Fe vs. Texas Avenue; Aug. 22, West Side vs. Texas Avenue; Aug. 23, Santa Fe vs. Utilities; Aug. 24, West Side vs. Santa Fe; Aug. 27, Utilities vs. West Side; Aug. 28, Utilities vs. Texas Avenue; Aug. 29, Texas Avenue vs. Santa Fe.

Comparison

(Continued From Page One.)

have increasingly large deposits; several wholesale houses serve surround-

ing trade territory which includes twenty communities; tourist camps equipped to serve a heavy tourist traffic are located on the city's outskirts, and a modern steam laundry, a bottling plant, a mattress factory, a modern bakery and other important industries are located here.

There are several well established civic and fraternal organizations.

The city is surrounded by some of the finest farming land of the entire nation, and is due to enjoy a steady growth for many years.

Mesdames Brown And Caraway Hostesses

Mrs. E. B. Caraway and Mrs. Kirby Brown were hostesses to the Thursday bridge club and guests at a bridge luncheon held Wednesday at Mrs. Caraway's home.

There were five tables of bridge at the party.

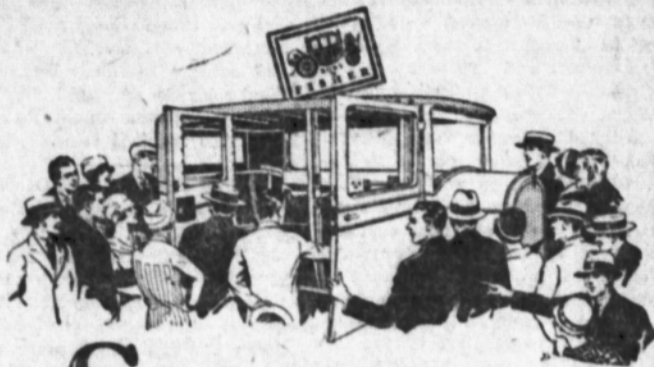

See for Yourself why Experienced Owners Demand Bodies by Fisher

In Oakland-Pontiac showrooms throughout the United States a special Fisher Body Demonstration opens Saturday, June 16. Co-operating with the Fisher Body Corporation, Oakland has arranged to demonstrate to automobile owners everywhere the reasons for the superiority and popularity of Fisher bodies.

Come to our showroom during the Fisher Body Demonstration. Learn how Fisher builds bodies and what high quality of materials is used. See for yourself why experienced owners demand bodies by Fisher. Don't miss this opportunity to gain a sound understanding of such an important part of your automobile.

Oakland All-American Six, \$1045 to \$1265. New Series Pontiac Six, \$745 to \$875. All prices at factory. Check Oakland-Pontiac dealers prices—they include license handling charges. General Motors Time Payment Plan available at minimum rate.

War Tax Removed—Delivered Prices Reduced

Martin Motor Company
At Green's Garage, Slaton, Texas

OAKLAND-PONTIAC
PRODUCTS OF *Cadillac* GENERAL MOTORS



Wearable Gifts for Dad

WHAT COULD DAD USE BEST RIGHT NOW?

Why—certainly—ACORN STORE Shirts, Ties, Hosiery, and so on, would, indeed, please him best!

We Save You Money On

New Summer Shirts 98c
Fine Broadcloths and Rayon Weaves—neat pattern . . \$1.89

Colorful New Ties 79c
Choice Silk Hosiery 48c

A Nation Wide Chain Department Store. Always Dependable Merchandise

Slaton, Texas

SITKA, Alaska.—Slaughtered by the thousands for the \$1 bounty, bald eagles have gradually learned to keep at a respectful distance from man's rifles, and it is reported here by fox farmers that the birds now Canadian territory. The crag the Alaskan range in British bria have become favorite ho the big birds.

SPECIALS FOR SATURDAY

GOOD QUALITY—10 POUNDS	
NEW SPUDS	?
TEXAS CROP—PER POUND	
FRESH TOMATOES	.12
GOLD BAR, NO. 2 CAN	
PINEAPPLE	.19
WITH SHAKER—A DELICIOUS DRINK—ONE CAN	
COCOMALT	.39
PER POUND	
GEM BACON	.18
SALTINE—15c SIZE	
CRACKERS	.10
MARKET DAY SPECIAL—4-LB. PKG.	
RAISINS	.34
PACKAGE	
POST'S BRAN	.11
FOLGER'S—2-EB. CAN	
COFFEE	\$1.08
PER POUND	
BULK FIG BARS	.14
PREPARED—QUART JAR	
MUSTARD	.24
3-POUND CAN	
BLUE RIBBON MALT	.59
2-POUND BOX STICK	
CANDY	.20
ANY FLAVOR	
EXTRACTS	.23

Market Specials

PER POUND	
VEAL LOAF MEAT	.24
PER POUND	
WILSON' TASTY MEAT	.34
SLICED—PER POUND	
ARMOUR'S STAR HAM	.38



SLATON'S PIONEER SELF-SERVING GROCERY

PIONEER M SYSTEM OF THE SOUTH PLAINS

WASH DAY—

Is a pleasure with one of our Gasoline Motor Washing Machines. We have just received a new shipment of these machines. You'll want to get one and use it to make these summer days a real vacation. Just the thing for the farm wife.

For That Camping Trip---

Come by and let us help you get the outfit ready to make the trip a success. Our prices will suit you.

See Our Complete Line of Utensils

For whatever you want in the Hardware Line, come to

...THE...

Slaton Hardware Co.

"The Winchester Store"

106 WEST GARZA

Thu