



★ HANSFORD COUNTY ★
THE REPORTER-STATESMAN

SCR2
 HANSFORD COUNTY LIBRARY
 0122 MAIN ST
 SPEARMAN TX 79081-2064
 COMP

THURSDAY,
 AUGUST 11, 2011

75¢

WWW.SPEARMANREPORTER.COM

CELEBRATING 104 YEARS OF SERVICE TO HANSFORD COUNTY
 HANSFORD COUNTY'S ONLY NEWSPAPER

VOLUME 104 • ISSUE 32

REPORTER@SPEARMANREPORTER.COM

COME TO THE GAME

Spearman
 VS
Gruver
 Scrimmage
 Aug. 13, 2011
 10 a.m.

High school football practice began Monday, August 1, 2011. The scrimmage will be held in Gruver at Greyhound Stadium.

by GasBuddy.com
TexasGasPrices.com
Weekly Update

Texas, August 8- Average retail gasoline prices in Texas have fallen 5.9 cents per gallon, in the past week, averaging \$3.55/g yesterday. This compares with the national average that has fallen 3.7 cents per gallon in the last week to \$3.66/g, according to gasoline price website TexasGasPrices.com.

Including the change in gas prices in Texas during the past week, prices yesterday were 94.5 cents per gallon higher than the same day one year ago and are 6.6 cents per gallon higher than a month ago. The national average has increased 4.6 cents per gallon during the last month and stands 88.6 cents per gallon higher than this day one year ago.

"We're watching an incredible decline in the price of crude oil and gasoline futures that will most certainly have an impact in the upcoming week at the pump. While motorists won't see large drops all at once, I most certainly expect declines in the days ahead," says Patrick DeHaan, GasBuddy.com Senior Petroleum Analyst. "Oil prices have shed nearly \$15 per barrel in just a week- a dramatic decline brought on by various concerns, but mainly a weak manufacturing report and concern surrounding a possible downgrade of U.S. credit ratings," DeHaan adds.

GasBuddy operates, TexasGasPrices.com, and over 225 other local gasoline pricetracking websites that follow prices at over 125,000 gasoline stations in the United States and Canada. GasBuddy also uses Facebook (facebook.com/gasbuddy), Twitter (twitter.com/gasbuddy), and phone apps to keep motorists ahead of changing gasoline prices.

Weather Forecast

THURSDAY NIGHT - Mostly cloudy with a 40 percent chance of showers and thunderstorms. Lows in the mid 60s. South winds 10 to 15 mph.

FRIDAY - Partly cloudy with a 20 percent chance of showers and thunderstorms. Highs in the mid 90s. South winds 10 to 15 mph.

FRIDAY NIGHT - Mostly cloudy with a 30 percent chance of showers and thunderstorms. Lows in the upper 60s.

SATURDAY - Mostly cloudy with a 20 percent chance of showers and thunderstorms. Highs in the lower 90s.

SATURDAY NIGHT - Mostly cloudy with a 30 percent chance of showers and thunderstorms. Lows in the mid 60s.

SUNDAY - Mostly cloudy with a 20 percent chance of showers and thunderstorms. Highs in the upper 80s.

SUNDAY NIGHT - Mostly cloudy with a 30 percent chance of showers and thunderstorms. Lows in the mid 60s.

MONDAY - Partly cloudy with a 20 percent chance of showers and thunderstorms. Highs in the mid 90s.

MONDAY NIGHT - Partly cloudy with a 20 percent chance of showers and thunderstorms. Lows in the mid 60s.

TUESDAY - Partly cloudy. Highs in the mid 90s.

Read <http://www.city-data.com/forecast/w-Spearman-Texas.html#ixzz0xgJ5WQkT>

Texas Crop & Weather

The following specific livestock, crop and weather conditions were reported by Panhandle Extension directors: The region remained hot and mostly dry. Some counties reported receiving from a trace to 1 inch of rain. Soil moisture continued to be mostly very poor, and crops were suffering. Producers were diverting water from corn to other crops and less acres. Cotton was in mostly poor to very poor condition. Rangeland and pastures continued to decline. Cattlemen were culling deeper into their herds and trying to find other states with grazing available, where they could ship their cattle.

AVAILABLE NOW!
E-SUBSCRIPTION
 to the
Hansford County Reporter-Statesman
 Delivered to your e-mail each Thursday for only \$35/year.
 Purchase online at www.spearmanreporter.com
 Call 806-659-3434 or e-mail reporter@spearmanreporter.com for details.

Districts Hit Hard by New Criteria

By **JACOB MAYER**, jacob.mayer@amarillo.com

New state accountability standards took their toll on school district ratings across the region as more Panhandle districts received unacceptable ratings than exemplary ratings.

The state rated five districts in the region academically unacceptable, including Boys Ranch Independent School District, a "special purpose" district that serves troubled youth.

Boys Ranch students improved their scores on the Texas Assessment of Skills and Knowledge tests in every subject from last year, but they still didn't meet the requirements for an academically acceptable rating, which requires 65 percent of students to pass the TAKS math test.

"We are overall, obviously disappointed with our ratings, but when you go in and look at our data, we are proud of the improvement we've shown over the last year," said Melissa Shaver, executive director of instruction at Boys Ranch.

The elimination of the Texas Projection Measure, which gave districts credit for students who did not pass a test but showed improvement, hurt Boys Ranch because it often enrolls low-performing students from across the country, Shaver said.

"A lot of times we've shown a lot of improvement with the kids, they just aren't quite where the standard is yet," she said.

Along with not using the projection measure, Texas Education Agency spokeswoman DeEtta Culbertson said the ratings decreased because the state required more students pass the science and math portions this year.

For example, 65 percent of a district's students must pass the TAKS math exam, while only 60 percent had to pass the test last year. Those standards also apply to each student group: African-American, Hispanic, White and economically disadvantaged.

It also included limited-English-speak-

ing student scores and completion rates as evaluation categories.

The number of exemplary schools in the Panhandle dropped from 20 to three.

Dumas ISD dropped from an exemplary rating to recognized this year.

Dumas Superintendent Mark Stroebel said he was pleasantly surprised the district still received a recognized rating in spite of the higher standards, but he knows there is room for improvement, particularly in science.

"Our curriculum directors are going to have a meeting each week with our campus administrators and just discuss curriculum," he said.

Stroebel also said the higher standards are a challenge because Dumas has seen an increase in economically disadvantaged students.

"We're having to teach them life skills along with being at grade level passing a test," he said.

"We don't have a problem with it. We're going to do it, but everybody has to be realistic when you look at the expectations."

Pampa ISD maintained its academically acceptable rating this year. However, the high school and junior high school received academically unacceptable ratings after being rated academically acceptable a year ago.

Pampa Superintendent Barry Haenisch said the higher standards and a growing number of economically disadvantaged students contributed to the schools' lower ratings.

Pampa students scored lowest in math and science. About 50 more economically disadvantaged students took the math and science TAKS tests than did the year before.

He also said the technical language in science questions may be more difficult for students to understand than questions in other subjects such as reading.

When a school is rated academically unacceptable, an outside consultant comes

in to work with the staff at the school to help make improvements in areas where the school is struggling, Haenisch said.

"They can bring in a different set of eyes, look at the work we're doing with a little bit different set of lens, and offer us some help and support," he said.

Haenisch said the district has worked to train teachers and design lessons that will help every type of student learn.

"It's not, 'You work with this group of children like this; you work with that type of children like that,'" He said.

"What we've been working with the last two years with our teachers is how to design engaging lessons that get the children involved in the work and get them to become a part of the work."

Stroebel said improvement on test scores will be vital to meet the standards for the State of Texas Assessments of Academic Readiness tests in the future.

"Our curriculum directors have gone through some extensive training, getting everything in line for the STAAR test," he said. "We feel this next year, with it being a benchmark, is going to set the standard of what's going to have to take place."

New state accountability standards contributed to ratings drops in some of the 63 school districts in the Texas Panhandle.

2010: Exemplary — 20, Recognized — 26, Academically Acceptable — 17, Academically Unacceptable — 0.

2011: Exemplary — 3, Recognized — 24, Academically Acceptable — 31, Academically Unacceptable — 5.



Spearman ISD welcomes the following new teachers for the 2011-1012 school year: (Front Row, L-R) Olivia Mendoza-Salgado (4th Grade Math), Lizet Olmos (5th Grade Social Studies), Pamela Smith (4th Grade Reading); (Back Row, L-R) Otis Chunn (HS English), Michael Rountree (HS Social Studies), Robin Stephens (JH/HS Band Director), Mollie Baker (JH/HS Choir Director).

submitted by Rod Sumner, Spearman ISD Superintendent

Hansford County Circle of Friends to Host Membership Party

The Hansford County Circle of Friends will host a membership party in support of The Don & Sybil Harrington Cancer Center on August 20, 2011 at 7:00 p.m. The party will be held at the O'Loughlin Center at 502 South Brandt in Spearman, Texas. The cost is \$20/single and \$35/couple. The party will feature a catered dinner by Richard & Wanda Wagner. There will also be a raffle, silent and live auction featuring some great items donated from Hansford County residents and businesses and surrounding community supporters.

The Circle of Friends is a non-profit organization dedicated to helping cancer patients and their families in times of need. Through its affiliation with Harrington Cancer Center, the Circle of Friends develops and implements fund raising activities to provide financial assistance and patient care and support programs for those affected by cancer. The Circle of Friends also works with Harrington Cancer Center to provide cancer educational opportunities for people throughout the region. Examples of Circle of Friends support of Harrington Cancer Center patients includes:

- Two furnished apartments for out-of-town patients to use when going through treatment
- Pediatric Patient/Family Gatherings (a day at Wonderland Park, Camp Alphonie)
- Supplies for weekly support groups
- Materials for chemotherapy classes, new patient books
- Refreshments for patients during treatment
- Assistance with patients' travel, insurance premiums, rent or mortgage payments, medication, nutritional supplements, utilities and breast prosthesis

For more information on the Hansford County Circle of Friends or if you are interested in attending and/or volunteering to help with the event please contact Holly McLain (806) 733-2268.



| SCHOOL DISTRICT | 2010 | 2011 |
|---------------------------|------------|--------------|
| Adrian | Exemplary | Recognized |
| Amarillo | Recognized | Acceptable |
| Booker | Acceptable | Recognized |
| Borger | Acceptable | Acceptable |
| Bovina | Recognized | Acceptable |
| Boys Ranch | Acceptable | Unacceptable |
| Bushland | Exemplary | Recognized |
| Canadian | Recognized | Recognized |
| Canyon | Recognized | Acceptable |
| Channing | Recognized | Acceptable |
| Childress | Recognized | Recognized |
| Clarendon | Acceptable | Acceptable |
| Claude | Recognized | Acceptable |
| Dalhart | Recognized | Acceptable |
| Darrouzett | Recognized | Unacceptable |
| Dimmitt | Acceptable | Acceptable |
| Dumas | Exemplary | Recognized |
| Farwell | Recognized | Recognized |
| Follett | Recognized | Recognized |
| Fort Elliott | Exemplary | Acceptable |
| Friona | Recognized | Acceptable |
| Grandview-Hopkins | Exemplary | Acceptable |
| Groom | Exemplary | Recognized |
| Gruver | Exemplary | Recognized |
| Happy | Exemplary | Recognized |
| Hart | Acceptable | Unacceptable |
| Hartley | Acceptable | Acceptable |
| Hedley | Recognized | Recognized |
| Hereford | Acceptable | Acceptable |
| Higgins | Acceptable | Acceptable |
| Highland Park | Recognized | Acceptable |
| Kelton | Acceptable | Acceptable |
| Kress | Recognized | Unacceptable |
| Lazbuddie | Recognized | Acceptable |
| Lefors | Acceptable | Acceptable |
| McLean | Exemplary | Recognized |
| Memphis | Recognized | Acceptable |
| Miami | Exemplary | Exemplary |
| Nazareth | Recognized | Recognized |
| Pampa | Acceptable | Acceptable |
| Panhandle | Recognized | Acceptable |
| Perryton | Recognized | Acceptable |
| Plemons-Stinnett-Phillips | Acceptable | Recognized |
| Pringle-Morse | Exemplary | Recognized |
| River Road | Recognized | Acceptable |
| Samnorwood | Acceptable | Recognized |
| Sanford-Fritch | Recognized | Acceptable |
| Shamrock | Acceptable | Unacceptable |
| Silverton | Exemplary | Recognized |
| Spearman | Exemplary | Recognized |
| Spring Creek | Recognized | Acceptable |
| Stratford | Exemplary | Recognized |
| Sunray | Recognized | Acceptable |
| Texhoma | Exemplary | Recognized |
| Textline | Acceptable | Acceptable |
| Tulia | Recognized | Acceptable |
| Turkey-Quitaque | Recognized | Recognized |
| Vega | Exemplary | Recognized |
| Walcott | Exemplary | Exemplary |
| Wellington | Exemplary | Recognized |
| Wheeler | Acceptable | Acceptable |
| White Deer | Exemplary | Recognized |
| Wildorado | Exemplary | Exemplary |

WHEN DOES YOUR SUBSCRIPTION EXPIRE?
 SCR1
07/11 EXPIRES
 JOHN G. PUBLIC
 PO BOX 123
 SPEARMAN TX 79081

Expiration dates are printed on the top of all mailing labels. Our readers can help keep the cost of subscriptions down by mailing in renewals in the appropriate month.

Thank you, Catherine Smith
 THE HANSFORD COUNTY REPORTER-STATESMAN
 213 Main Street • Spearman, TX 79081
Annual Subscription Rates
 In Hansford County - \$30
 Out of County - \$40
 E-Subscription - \$35 (sent through e-mail)

Wolf Creek Heritage Museum Notes

by Virginia Scott
MUSEUM HAPPENINGS

Georgia and I left early Wednesday morning and traveled to Irving, TX (in between Dallas and Fort Worth). The trip down was rather sad. The entire state is in need of rain - the dry land crops were withering in the hot sun. Half way home we encountered a little rain and were encouraged that rain still existed.

We arrived home mid-morning on Sunday and shortly it started to rain here and we have had several wonderful showers, including Monday morning. Maybe this awful heat and dry spell is near an end.

Our meeting was the annual Texas Association of Museums meeting, when museums from all around the state meet to listen to what is new for museums, learn new techniques in creating exhibits and programs, and to network with each other. This year's group was smaller, probably due to our change in meeting times (we usually meet in March), but there was also an opinion that the economy was hurting a lot of our museums with reduced budgets, staffing, etc.

That is a plus on our area. Most of our museums are run by volunteers and you the visitors, are our source of revenue for exhibits, programs, etc. We use our funds for our buildings, permanent exhibits, and for planning for the future. An example of what museums in large cities do (that will

probably be reduced with today's economy) was the exhibit attended as an evening event at our conference. The exhibit was "Genghis Khan: The Exhibition," at the Irving Art Center. The exhibit was a traveling exhibit and cost the museum over \$1 million dollars to bring to Irving. There was a lot of discussion in various sessions about how the museum could have used that money differently. Times they are a changing.

The second night we visited the museum dedicated to the Boy Scouts of America. This museum is wonderful! It includes a beautiful exhibit of Norman Rockwell paintings about Scouts, the founding of Scouts, and the values of scouting and their various clubs, camps, and activities. It was an educational and entertaining evening. If you are in the area, it is a good family place.

From my desk and the other work surfaces in the museum, it looks like it was business as usual, however, our guest book reveals a wonderful number of visitors including a group of 4-Hers on a photography mission. Hope they had fun and got some great photos.

MUSEUM MUSINGS

One of my sessions was led by Edward T. Linenthal who has authored "Sacred Ground: Americans and their Battlefields", "Preserving Memory: The Struggle to Create America's

Holocaust Museum" and "The Unfinished Bombing: Oklahoma City in American History."

He presented an interesting conversation on how we tell, document, and study our history. He believes that revisiting our history is an indispensable and inevitable component of historical work and that revisionism is an essential component of that revisiting. Learning more of the truth of what actually took place in those historical moments.

Following his luncheon presentation, he lead a discussion about "Revisionism" and how it impacts our work in museums. There was a lively discussion on "Telling the whole truth" of historical events within our communities especially in areas of racism, political events, religious beliefs, etc. How do we present these events truthfully without offense? History versus Heritage also was discussed. A lot of food for thought and I would ask you on your next visit, are there stories in Lipscomb County history that we have not told that we should have.

We want to develop on the decades of county history, what stories should we tell at each decade? Let us know what you want to hear. How can we tell your story better?

I learned a lot this year and I hope I will be able to use it. I end this week with this thought used at the conference by one of the speakers

A mind stretched by new ideas never returns to the same shape.
Ralph Waldo Emerson

Wolf Creek Heritage Museum

Museum Hours: Monday thru Friday 10 a.m. to 4 p.m., Special hours upon request.

Museum Information: 13310 Hwy 305, PO Box 5, Lipscomb TX 79056; telephone: 806-852-2123; e m a i l : wolfcrk@amaonline.com; website: www.wolfcreekheritagemuseum.org

The Hansford County Reporter-Statesman is liable for errors and omissions in advertisements only when the newspaper fails to correct errors from the original layout and marked by the advertiser on a proof returned within the established time before publication. Liability of the newspaper for an alleged error in copy or publication shall not exceed the cost of the space occupied by the error.

Please report any errors in published advertisements immediately. Credit will be allowed for the first insertion only.

Notice of errors must be received in time for correction before the second insertion, or within three days of publication, or no claim for credit will be honored.

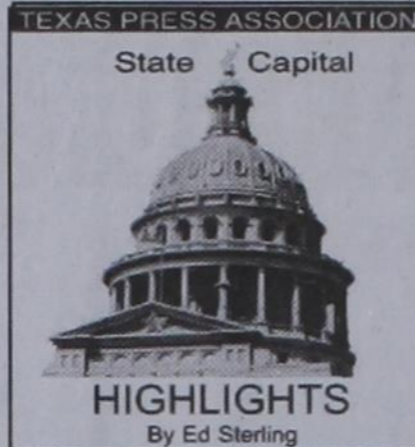

STATE CAPITAL HIGHLIGHTS



by Ed Sterling

Record-setting heat, lack of rain prompt actions

AUSTIN — Texas is suffering through the most severe one-year drought on record and experienced the hottest July in state history, Agriculture Commissioner Todd Staples announced on Aug. 4.

Drought-caused damage to the Texas economy "is already measured in billions of dollars and continues to mount," Staples said. "I cannot stress enough the critical need for forage to sustain the largest cattle herd in the nation. The suffering and desperate need for relief grows with the rising temperatures and record-breaking heat that continue to scorch Texas with each passing day."

The commissioner's words came after Texas A&M-based State Climatologist Dr. John Nielsen-Gammon confirmed Texas was in a worst-on-record drought situation. The state began to collect weather information in the 1890s. To those who remember the drought of 1950-57, this one is "shorter and sharper" Nielsen-Gammon said.

To help with cattle feeding, Gov. Rick Perry extended a hay transportation waiver at Staples request to Sept. 1 with the possibility of further extensions every 30 days as long as the drought continues.

With weeks of daily high temperatures topping 100 degrees, Texans have been using unusually elevated levels of electricity to cool their homes and businesses. Extreme temperatures resulting in extraordinary power usage prompted the Public Utility Commission, power grid-managing entity ERCOT and the governor, who said himself there is no relief in sight, to ask citizens to switch off unnecessary appliances and turn up air conditioning settings in order to avoid rolling blackouts.

Furthermore, the Texas Commission on Environmental Quality has in the works new rules that may allow the agency's executive director to suspend or adjust water rights during times of drought or emergency water shortages.

An Aug. 11 hearing at TCEQ headquarters in Austin was scheduled to include public input in advance of rulemaking on drought procedures and to define "drought" and "emergency shortage of water."

Perry takes part in 'Re-

sponse'

More than 30,000 people attended The Response, a Christian prayer meeting initiated, promoted and led by Gov. Perry and evangelical groups in Houston on Aug. 6.

Also, more than 80,000 web viewers watched the daylong event from their homes, organizers said.

Billed as an opportunity to pray publicly "for a historic breakthrough for our country and a renewed sense of moral purpose," the event was held at 75,000-seat Reliant Stadium.

In Houston and Austin, small groups of protesters criticized the governor's official connection and personal participation in The Response.

The Response was monitored by political commentators, some of whom expressed the notion that the event might be seen as an indicator or serve as a trigger for the governor's pending decision over whether to run for the presidency in 2012.

Online college is promoted

Texans now have what state leaders call "an affordable and flexible path to a higher education degree" through the accredited web-based Western Governors University-Texas.

Bachelor's and master's degrees in "key workforce areas" including nursing, education and information technology are offered, the governor's office announced.

Self-sustaining WGU-Texas does not collect

money from the state. Tuition reportedly costs about \$5,780 per 12-month year. Visit <http://texas.wgu.edu/> for more information.

The first paragraph of Gov. Perry's Aug. 3 executive order establishing WGU-Texas says, "although enrollment in all Texas institutions of higher education has increased 47 percent since 2000, there is still a significant need to provide adult learners with greater access to opportunities to obtain higher education degrees."

AYP report is released

Some 5,597 Texas schools met the Adequate Yearly Progress standards for the federal school rating system this year, the Texas Education Agency announced. This represents 66 percent of all Texas campuses.

Schools and districts must have 80 percent or more of their students in grades 3-8 and 10 pass the Texas Assessment of Knowledge and Skills reading or English language arts test and 75 percent must pass the TAKS mathematics test to meet AYP standards. They also must achieve a 90 percent attendance rate or a 75 percent graduation rate, depending on the grade levels they serve.

Under the federal No Child Left Behind law, the standards must reach 100 percent passing on both reading and mathematics assessments by 2014 which requires a substantial increase in ratings standards each year in order to meet this requirement, the state education agency noted.

Editors Note...

Freedom of speech is one of the guarantees of the First Amendment of our Constitution, so we encourage readers to express themselves, even if we don't agree with what is said. However, freedom involves responsibility. Therefore, the only letters we will consider publishing are from individuals who are willing for their names to appear with the letter. Letters must contain the telephone number, address and a personal signature of the writer (for verification purposes only).

We will not knowingly publish any letter containing libelous or slanderous statements, or factually incorrect information. Letters containing language or content that we feel is inappropriate will not be published.

Examples of content that will cause letters to be rejected include the following: Confusing or unclear points; Crude language; Poor taste; Disrespectful comments regarding a group's or individual's ethnicity, gender, religion, culture, sexual orientation or race; Other incendiary language or remarks; Endorsements for or complaints about individual named commercial products or services.

"Letters To The Editor," like all materials submitted to this newspaper, are subject to editing for space and clarity. The publication of any letter or article is the decision of the Editor and Publisher.

We welcome your input. You may write to us by using the online form, e-mail - reporter@spearmanreporter.com; fax - 806-398-9080; or regular mail - Letters to the Editor, c/o Hansford County Reporter-Statesman, 213 Main Street, Spearman TX 79081.

The Hansford County Reporter-Statesman

The Hansford County Reporter-Statesman

Mailing Address - 213 Main Street • Spearman TX 79081
Physical Address - 310 Barkley Street • Spearman TX 79081
Phone - (806) 659-3434 • Fax - (806) 398-9080
www.spearmanreporter.com • reporter@spearmanreporter.com
Mon.-Thurs. 9 a.m.-12 p.m., Mon.-Wed. & 1-5 p.m.
Closed Thurs. afternoon and all day Fri., Sat. & Sun.

Gary Smith - Publisher Catherine Smith - Editor
Contributing Writers: Dorothy Hudson, Jim Derington,
Merry Sparks, Cecil Biggers
Contributing Photographers: Charlie Johnson, Lisa Johnson
Tammy Batton, Bonnie Bergan

Subscription Rates

In Hansford County - \$30.00 • Out of County - \$40.00
E-Mail Subscription - \$35.00

The Hansford County Reporter-Statesman (USPS 529660) is published weekly in Spearman, TX. Periodical postage paid in Spearman, TX. POSTMASTER: Send address changes to: The Hansford County Reporter-Statesman, 213 Main Street, Spearman, TX 79081.

Publication Policy

The deadline to submit news and advertising to The Hansford County Reporter-Statesman is Monday at 5 p.m. Items submitted after the deadline will be published at a later date, as time and space permit. Publication of all items is at the discretion of the editor.

Advertising

Open Display rates are \$4.00 per column inch. Classified Ads are \$6 for the first 25 words and 10¢ per word for each additional word. (Additional charge for boxed classifieds.) There is a \$1 charge per week if billed.

Member of
Gruver Chamber of Commerce
Spearman Chamber of Commerce
Texas Press Association and Panhandle Press Association



WORLD CITIES

ACROSS

- Collect
- R&R hot spot
- Summit location
- Like Babe Ruth the pitcher, e.g.
- Broadcasting medium
- Gauntlet
- Pirate Black
- Start of a golf hole
- Senior
- Medium's seance state
- "Sex and the City" locale
- capita
- Gun shot sound
- Flat-muzzled little dog
- Belonging to you
- Uncivilized person
- Affirm solemnly
- Show of appreciation
- Trickeries
- " of thumb"
- Iron+nickel
- They're on Freddy's street
- Relating to illum
- Sign of a saint
- "It wasn't built in a day
- Holy Hindu
- Taunt
- Summer color
- code
- Not safe in baseball
- *aka Peking

DOWN

- Miranda rights occasion
- *One of the twin founders of 47 across
- First name of former child-actor turned director
- Small body of land
- Very angry
- The Doors' hit "The "
- "London Calling" band, The
- They're meant to get you in shape
- Like Buzz in "Toy Story 3"
- Hole for an anchor rope
- Priestly vestment
- " Me in St. Louis"
- At a great distance
- Bra holder?
- *Famous for its Opera House
- Fill to satisfaction
- Type of chart
- Madison Square Garden, e.g.
- USSR to USA during WWII
- Type of list
- Completed
- Company car, e.g.
- Cheap showy jewelry
- Crocus, pl.
- Half the width of an
- Virtuosity
- *Split by the Seine
- Palate lobe
- Extremely cold
- Bone in human forearm
- Contender
- Administer
- Fashion designer Kahng
- *Ruhr's industrial center
- Interpret writing
- "For" in Spanish
- Sweeney Todd's tool
- Daybed
- Coffee pot
- *A financial hub of Europe
- White heron
- Motors, maker of stylish electric cars
- Where pirates were often thrown
- Spooky
- Prayer leader in mosque
- Sticks out
- Artist Warhol, e.g.
- Shredded cabbage
- " of the d'Urbervilles"
- Lennon's wife
- Definite article

These games are brought to you by the Hansford County Reporter-Statesman

CROSSWORD

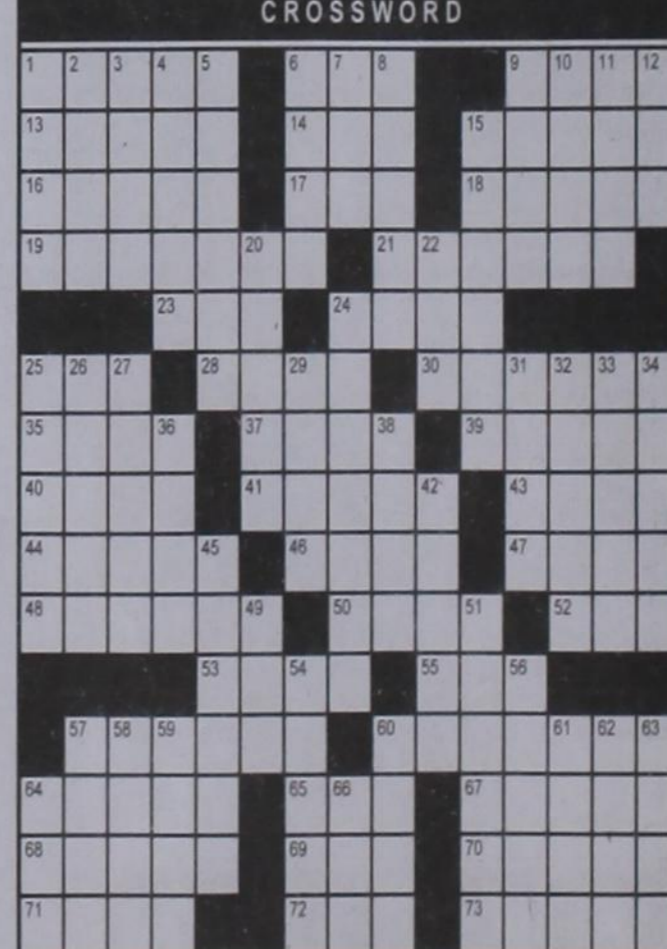

PRESENTED BY



© StatePoint Media answer on classified page

Happy Birthday!

August 11
Birthdays - Preston Miller, Autumn Bateman, Jake McCullough, Clint DeArmond, Jody Rex, Dean McLain, Tootsie Scroggs, Simon Nelson, Kam Taylor, Hank Sutterfield, Tammy Herndon, Tayshia James
Anniversary - M/M Gary Johnson, M/M Ervin Wright, M/M Junior Crossland

August 12
Birthdays - Hix Spivey, Norma Swink, Verna Gail Keim, Angela Gaitner, Judy Nelson, Randy Hargis, Julian Rodriguez Sr., Wade Nobles, Devonna Boyd, Janice Bannister, J.C. Harris
Anniversary - M/M Rudy Saldavar

August 13
Birthdays - Brendy Brown, Kirkland, Mike Coomer, Denise Karlin, Blake Trantham, Wanda Jones, Anne Foster, Adrian Robertson, Lorrie Bowen, Joe Dean Clement, Jim Miller, Crystal Boyd
Anniversary - M/M Gary Flowers, M/M Gerald TeBeest, Jeremy & Cindy (Flores) Burch

August 14
Birthdays - Leslie Latta, Jimmy Nicholson, Mike Pack
Anniversary - M/M Monty Lusby

August 15
Birthdays - Kelly Armes, Mary Jane Henson, Ryan Winger, Buddy Gaitner, Cole Umphress, Sara Butt, Vanessa Ortega, Dub Womble, John Booth
Anniversary - M/M Billy Baker, M/M David Hall, M/M Buddy Murrell, M/M Billy Ludgson Jr., M/M James Nicholson

August 16
Birthdays - Corky Chapman, Ed Fry, Ronny Womble, Wayne Burchard, Ben Dunaway, Sandra Younger, Felix Sandaval, Tyce Hergert, Teresa Cook, Sharon Ross, Jason Villines, Lillie Love, Kathy Love, Nicholas Vinson, Ruben Gomez, Donetta Greene, Carlos Hernandez, Alexander Davis
Anniversary - M/M Bill Sparks

August 17
Birthdays - Christy Brown, Guy Paul Hindergart, Allison Reid, Dean Sparks, Dodie Beedy, Delinda McLaughlin, Halee Rice, Bo Bensingary, Kimberly Boyd
Anniversary - Betty & Dub Womble, M/M Danny Jackson, M/M Don Allen,

August 18
Birthdays - Brenda Dahl, Carla Johnson, Heather Murrell, Jack Weldon, Tina Wilmeth, Jerry Beth Prachar, Tammy Welch, Bob Cook, Robbin Keetch, Pat Miller, Jeanie Bennett, Glen Ward, Andrew Correll, Janet Mayo
Anniversary - M/M David Link, M/M Dennis Baker, M/M Charles Deakin

August 19
Birthdays - Diana Bradshaw, Buddy Murrell, Kenton Odum, Linda Tidwell, Carey Bridges, Perry Dixon, Mary Lou Mathews, Chris Trout, Lisa Collins, Teddy Lynn Whitefield, Melissa Harvey, Joshua Miller, Jordan Fisher, Lenny Pecha
Anniversary - M/M Kelly Smith, M/M Larry Hicks, M/M Jim Bartimus

August 20
Birthdays - David Bergin, Joyce Messer, Joyce Lackey, Irene Snider, Tony Hart, Shelley Edenborough, Joe Olivarez, Derek Irbeck, Kathy Lewis, Jodi Hight
Anniversary - M/M Mike Grotgut, M/M Les Barkley, M/M Tommy Russell, M/M Larry Babbs

August 21
Birthdays - Lou Garrett, Lauren Hoel, Michael Lane Whitefield, Linda Lawson, Carolyn Mauldin, Brandon Babitzke, Joshua Bynum, Rick Harvey, Coy H. Kelly Jr, Shane Hill
Anniversary - M/M Dwayne Marrs

August 22
Birthdays - Amber Roberts, Autumn Roberts, Tony Hester, Michelle Davis, Tuesday Reed, Jonell Sheets, Roger Brown, Marge Papay, John Michael Sterling, Phil Garza, Kathrine Tope, Janie Perez, Garrett Griffin, Brian Robinson, Brett Winegarner, Janie Reza, Kay Snider
Anniversary - M/M Silva, Kenneth & Lisa Brown, M/M Pat Jackson

August 23
Birthdays - Ann Dorman, Reagan Baker, Eddie Reed, Donnie Mitchell, Sara Blackburn, Ralph Blodgett, Bill Jack Pittman, Kathy Lewis, Miriam Mendoza
Anniversary - M/M Billy DeArmond, M/M Chris Johnson, M/M Jimmie Veron

Our Sympathy

JOANN "JO" HURLEY
 GRAND FORKS, ND - Joann "Jo" Hurley, 86, of Grand Forks, passed away Wed, July 27 at Valley Eldercare in Grand Forks surrounded by friends and family.
 Joann Frantz started life in North Manchester, Indiana, born Sept 5, 1924, to Paul and Marie Frantz. Her brothers Donald and Richard (Nancy) Frantz, and sister Nancy Nicholson survive her.
 Joann received her nursing degree from Henry Ford Hospital in Detroit during WW II. She married a Marine Pilot 1st Lt. Charles Hurley in 1946. They lived in Grand Forks, Marion, and Devils Lake ND, before settling for good in Grand Forks. Charles retired from teaching chemistry at GF Central in 1985 and suddenly passed away in 1986. Joann loved geriatric nursing and was the Director of Nursing at Valley Memorial Almonte for 26 years, retiring in 1989.
 Retired didn't mean inactive for Joann as she traveled the world, biking and exploring many countries and serving on many mission trips. Her lake cabin at Maple Lake served as the site for summer family gatherings, and her home on Belmont Road was where family holidays were celebrated.
 Especially important to her was membership in Zion United Methodist Church where she was on many committees to serve her community and church and a member of Miriam Circle. She was a longtime season ticket holder and big fan of UND hockey. Her friends, scrabble and card groups, and PEO sisters meant a lot to her. Her radiant smile and endearing laugh was always with her. Jo was a friendly, cheerful, optimistic woman with a special way of making everyone feel welcome.
 She is survived by the families of five sons. Michael, of Grand Forks, his 3 daughters, Vicki (Earnest) Washington, Ruby (Chris) Carter, and Donna (Matt) Mulock, son Marlyn and grandchildren Onyx, Charles, Veronica (deceased), Naomi, Kevin Lommen, Kirsten, Casey, and great grand children Brooklyn, Kailen, and Selena. Timothy, of Sioux Falls SD has two sons Kevin and Ryan and his special friend, Rachel McCracken. Patric (Linda) of East Grand Forks and sons Patrick (Terra), and Mark (Staci), and granddaughter Hazel. Charles, of Bloomington MN. John, (Roxanne), of Grand Forks have daughters Katelyn (Josh) Salwey and Laura.
 Other surviving relatives include brother in law, Lawrence (Helen) Hurley and sister in law, Ada Mcleod and several nieces and nephews.
 She is preceded in death by her husband, Charles, her very special friend, Norman Neumann, sister in law, Jody Frantz, brother in laws James Nicholson and Walter Mcleod and grandchild, Veronica Hurley.
 A Celebration of Life service was held on Saturday, July 30, 2011 at 3:00 PM at Zion United Methodist Church in Grand Forks, ND.
 Your support during this difficult time has been greatly appreciated.
 Your memorials may be directed to Zion United Methodist Church, 1001 24th Ave South, Grand Forks ND 58201, or The Charles and Joann Hurley Memorial Fund of the Community Foundation 620 Demers Ave, Grand Forks ND 58201

Weatherford Construction
 Septic Systems
 Kirk Weatherford (806) 336-2820
 8125 FM 3395 Sanford, TX 79078 Toll Free: 1-800-585-6047
 Email: kirk@weatherford-construction.com

MONUMENTS
Boxwell Brothers Funeral Home
 519 Evans • Spearman
 659-3802
 Dear friends,
 When you buy a monument from us we make sure it is exactly what you want at a price you can afford. If it is not right, we will make it right. And you will not have to search the countryside to find us. We are here when you have a need.
 Sincerely,
 Bob Boxwell

Love's Travel Stops & Country Stores, Inc. is hiring...

Retail & Restaurant Team Members
 Tire Tech Maintenance/Technician
 All Shifts Available
 Competitive starting pay
 Must work a flexible shift including nights & weekends

Please apply at www.loves.com/jobs

EMPLOYMENT OPPORTUNITIES

Promotional Opportunities Available
 Competitive Compensation
 Salary Increases Available upon Completion of In-House Competency Training (rig-based positions)
 Exceptional and Affordable Benefits Package: Medical, Dental, Vision, Prescription Drug, 401(k), and more!

Actively seeking experienced candidates for:
Rig positions:
 Rig Electricians
 Electronics Technicians
 Subsea Specialists

Office positions:
 Drilling Superintendent
 Subsea Supervisor

To Learn More, Visit Us at www.diamondoffshore.com

Please fax your resume to:
 (281) 647-2295

Or mail your resume to:
 Diamond Offshore - Employment
 P.O. Box 4558, Houston, TX 77210-4558

TRUCK DRIVERS WANTED THROUGHOUT TEXAS

HOME DAILY OR WEEKLY
 Hiring Solo and Team Drivers in Dedicated, Intermodal, Tanker and Van (OTR, Regional) Divisions
 Sign-on Bonus May Apply - Ask Your Recruiter!
 Experienced Drivers and Recent Driving School Grads Welcome

Paid orientation/training | Comprehensive, low-cost benefits plan including medical, dental, vision and 401(k) plan available

Apply at schneiderjobs.com/newjobs
 Call 1-800-44-PRIDE for more information

Direct TV
 Direct Sat TV
 1-800-360-1395
 Local Installers!

Package Start At
\$29.99 Mo.
 NFL SUNDAY TICKET™
 Included at No Additional Cost
GUARANTEED!
 PLUS
HBO SHOWTIME starz cinemax
FREE FOR 3 Months
 with CHOICE XTRA™ or Above

Family Pool Fun.com

Our pools create Generations of Memories everyday, vacations never end!
 Aboveground & Inground pools at WHOLESALE PRICING
 SIMPLE DIY Pool Kit Assembly
 SAVE MONEY on All Pool Supplies & Accessories. Ships Fast

call today! 800-950-2210

dish NETWORK AUTHORIZED RETAILER

FREE 2 ROOM HD DVR Upgrade (1 HD DVR + 1 SD DVR)
 (Metro DVR service fee applies)

1-800-336-7043 WWW.INFINITYDISH.COM

Go Painlessly™
THERA-GESIC
 Pain Relieving Creme
 Go painlessly with Thera-Gesic

Great Value, Great Results.

Replenish the seed of faith through . . .

DAILY BIBLE READING, PRAYER & REGULAR CHURCH ATTENDANCE

Spearman
Apostolic Faith Church
 822 S. Dresden • 659-2870
 Sunday School: 10 a.m.
 Worship Service: 11 a.m.
 Sun. Eve.: 8 p.m.
 Wed. Prayer Mtg.: 7 p.m.
 Pastor - Jack Cornell

First Assembly of God
 401 N. Bernice • 659-2295
 Sunday School: 9:30 a.m.
 Worship: 10:40 a.m.
 Evening Worship: 6 p.m.
 Wed. Worship: 7 p.m.
 Wed. Youth: 7 p.m.
 Pastor - Brad Smith

First Christian Church
 (Disciples of Christ)
 29 S. Bernice • 659-2036
 Sunday School: 9:45 a.m.
 Worship: 10:50 a.m.
 Minister -

First Baptist Church
 123 N. Bernice • 659-5557
 Sunday School: 9:45 a.m.
 Worship: 11 a.m.
 Evening Worship: 7 p.m.
 Men's Bible Study - Wed., 7 a.m.
 Children's Choir - Wed., 6 p.m.
 Adult Choir - Wed., 7 p.m.
 Wed. Bible Study: 7 p.m.
 Pastor - Jim Medley

Church of Christ
 121 S. Haney • 659-3244
 Sunday Bible Class: 9:45 a.m.
 Worship: 10:30 a.m.
 Evening Worship: 6 p.m.
 Bible Study Wed.: 7:30 p.m.

Sacred Heart Catholic Church
 901 Roland • 659-2166
 Sat. Night Mass: 5:30 p.m.
 Sun. Mass: 9 a.m. - English
 Sun. Mass: 11:30 a.m. - Spanish
 Rev. Gregory Bunyan

First United Methodist
 407 S. Haney • 659-5503
 Sunday School: 9:45 a.m.
 Worship: 8:30 & 11 a.m.
 Jr. High Youth: 5 p.m. Sunday
 High School: 6 p.m. Sunday
 Kids Club: 3 p.m. Wed.
 Pastor - Toni Bailey

Grace Presbyterian Church
 (Worships with Faith Lutheran Church)
 1101 Bernice • 659-2033

Faith Lutheran Church (ELCA)
 1101 Bernice • 659-2252
 Sunday School: 9:45 a.m.
 Worship: 11 a.m.
 (Worships with Grace Presbyterian Church)
 Pastor - Cecil Biggers, PLM

Union Church
 31 S. Endicott • 659-2644
 Sunday School: 10:00 a.m.
 Worship: 11:00 a.m.
 Bible Study: 7 p.m. Wed.
 Youth Service: 6 p.m. Wed.
 Pastor - Don Baltazor

Fellowship Baptist
 1102 S. Archer • 659-2783
 Sunday School: 10 a.m.
 Worship: 11 a.m.
 Sun. Evening Worship: 6 p.m.
 Sun. Evening Spanish Worship: 7 p.m.
 Youth/Adult Service: 7:30 Wed.
 Pastor - Phillip Hudson

Primera Mision Bautista
 502 E. 7th • 659-3991
 Sunday School: 9:45 a.m.
 Worship: 11 a.m.;
 Evening: 6 p.m.
 Wed. Prayer Meeting: 7 p.m.
 Thurs. Visitation: 7 p.m.
 Pastor - Joe Garcia Jr.

El Aposento Alto U.P.C.I.
 1105 S. Roland
 Domingos: Escuela-Domical - 10 a.m.
 Culto Evangelistico - 7 p.m.
 Jueves: Oracion - 8 p.m.
 Mier. Estudio Biblico - 7 p.m.
 Pastor - A.G. Martell
 (806) 659-2153

Gruver United Methodist
 Broadway & Garrett
 733-2651
 Sunday School: 9:45 a.m.
 Worship: 8:30 & 10:50 a.m.
 Eve. Worship & UMY: 6 p.m.
 Pastor - George Price

Spanish Cristo Redentor Church
 Hwy 15 806-659-2166
 Gruver, TX
 Sun. Mass. 1:30 p.m. - Spanish
 Rev. Gregory Bunyan

He has showed you, O man, what is good. And what does the LORD require of you? To act justly and to love mercy and to walk humbly with your God.
 Micah 6:8

This feature is made possible through the sponsorship of these civic minded businesses:

| | | | |
|---|--|--|---|
| <p>Deakin ELECTRIC OILFIELD • RESIDENTIAL • COMMERCIAL 321 S. MAIN • SPEARMAN 1-800-999-1506 Chris Deakin (806) 659-5016 President</p> | <p>Bartlett's Lumber & Hardware 105 W. Broadway • Gruver, TX (806) 733-2404</p> | <p>BERRY CLEANERS Ann & Vernon Pipkin - Owners Phone 659-3122 • P.O. Box 1017 207 Main St. • Spearman, TX</p> | <p>Morse Implement & Auto Supply "Join us in church" Tom Dortch 733-2668 Box 89 • Morse, TX 79062</p> |
| <p>PRAIRIE MOTORS INC. Hwy. 207 South • P.O. Box 430 Spearman, TX 79081 • (806) 659-2541 www.prairiemotors.com</p> | <p>MurMur's Cafe 100 Roland St Spearman, TX. 659-3580</p> | <p>Hansford County Reporter-Statesman "Proudly Serving Hansford County Since 1907" (806) 659-3434 310 Barkley • Spearman, TX</p> | <p>INTERSTATE BANK, sssb www.interstatebank.net 322 Main • P.O. Box 146 Spearman, TX • 659-2559</p> |

HWI

FOR YOUR INFORMATION

Medical Fund Established At FNB for Dynell Moore
Shawn and Dynell Moore, children of Johnny and Brenda Vera and Terry Moore of Spearman, have recently relocated their family to the Dallas-Fort Worth area. In March, Dynell was diagnosed with stomach cancer. She will be receiving treatments at MD Anderson in Houston and Baylor Medical Center in Fort Worth. After the birth of their second child, three tumors were discovered, two of which contained malignant cells. The tumors were safely removed at Mary Washington Hospital in Fredericksburg, VA. At which time, Dynell began oral oncology treatment to keep the cancer from spreading. The Moore's made the decision after consulting with their physician to continue an aggressive treatment program at MD Anderson Cancer Center in Houston as well as their sister facility in Fort Worth. There has been a Medical Fund established for the Moore family at First National Bank in Spearman to aid in treatment expenses. The Moore's feel extremely blessed with the early diagnoses of Dynell's condition and the support they have received from family and friends.

Farmers Market in Spearman Each Wednesday
Spearman has its own Farmers' Market on Wednesdays from 7 a.m.-noon in the old Celebrate building, 203 Main. Growers are welcome to sell their produce. Call Linda Venneman at 806-882-4635 if you are interested in being vendor. e. Bring a friend. Bring a salad for the noon luncheon.

Stationmaster's House Museum Garage Sale
The Stationmasters House Museum in Spearman, TX is sponsoring a garage sale Saturday, September, 10th from 9 am to 4 pm at the Museum Annex Building, 2nd Ave and Archer St. in Spearman. Anyone that wishes to donate, please bring your items by the museum during normal business hours Tuesday - Saturday 1 pm to 5 pm or call the museum at 806-659-3008 or Reba at 806-733-2786.

Rushing Wind Emmaus Community
The Rushing Wind Emmaus Community will meet on Saturday, August 13 at 6 p.m. at the Waka Christian Center, beginning with a potluck supper, followed by sponsors training and a praise and worship service! We welcome all of our members as well as families and friends to the monthly community meetings. A nursery will be provided.

BBBS Big Fun Run
The 4th Annual Big Fun Run benefitting Big Brothers Big Sisters in Perryton, Spearman, and Gruver will be held on August 20. The 5K Race will be held at the Perryton High School parking lot and begins at 8:00 a.m. with the Family Fun 1 Mile Walk following at 8:30 a.m. Cost for the race is \$25, which includes a t-shirt. Special discounts for several runners clubs and runners who participated in the Spearman 5K Leg are listed on the registration form. Family Fun Walk Packages are \$90 and include t-shirts and registration for 4 participants. Pre-registration is highly recommended, but you can register on race day also. For more information, or to register, please contact the Big Brothers Big Sisters office at 434-0016.

Make Parenting a Pleasure
Make Parenting a Pleasure Parent Training for parents of children from birth through age 6 will be held on Thursday nights beginning September 8, 2011 through November 10, 2011 from 6-8 p.m. at the TPC Children's Services Building, 1500 S. Taylor Street, Amarillo TX 79101. Sponsored by S.T.A.R. (Services-To-At-Risk Youth & Their Families) Instructor: Janice James, MA, QMHP, UCAP Coordinator (Must attend full class for certificate) NO CHARGE Call 359-2005 to register. Limited seating available. No Childcare

Spearman Booster Club
If you would like to become a member of the Spearman Booster Club please contact any club member. This money helps the Spearman Booster club award scholarships to many athletes each year. Please call Kellye Buchanan 330-0364 or 659-5102 or mail membership to P.O. Box 343 Spearman.

Gruver Blood Drive
The Coffee Memorial Blood Center is hosting a blood drive on Tuesday, August 23, 2011 from 2-7 p.m. in the Gruver State Bank LaCasita Room. Vote for your favorite local hero. Every eligible donor who presents to donate will receive a free Boots vs. Badges t-shirt. Photo ID or Donor Card Required to Donate. MUST BE 17 YEARS OLD TO DONATE. For appointments, please call 331-8800 or 1-877-574-8800. ALL BLOOD TYPES ARE CURRENTLY NEEDED! The need is real. There is no substitute for blood. It can only come from volunteer blood donors. Please support the patients of the High Plains Region... Give the Gift of Life!

Spearman High School Registration
SHS students may pick up their 2011 - 2012 class schedules on Tuesday, August 16, 2011, according to the following schedule: **9th Grade** (Fish Camp) - All incoming 9th graders will need to plan on being at the high school from 8:30 - 10:30; **10th Grade** - 10:30 - 11:00; **11th Grade** - 11:00 - 11:30; **12th Grade** - 11:30 - 12:00. Students new to the district may register from 1:30 - 3:00 pm on Tuesday, August 16, as well. New students need to bring a copy of their shot record and a current transcript.

"Back in Control" Parenting Workshop
S.T.A.R. (Services-To-At-Risk Youth & Their Families) brings you "Back in Control" Parenting Workshop on Saturday, August 27, 2011 from 8:45 AM-4:00 PM in the TPC Children's Services Building, 1500 S. Taylor Street, Amarillo. Must pre-register by calling 359-2005. Instructor is Janice James, MA, QMHP. CEUs available for LPCs & MSWs; General CEUs available, also. (Must attend full class for certificate) NO CHARGE. Seating is limited. No Childcare is provided. STAR is a TDFPS funded program of TPC.

Tri-City Community Concert Association
Janie Kunselman is the representative for the Tri-City Community Concert Association of Borger and Liberal, and is selling memberships to attend concerts for the 2011-2012 season. Concerts are as follows: Borger - The Shangri-La Chinese Acrobats - September 22nd, 7:30 p.m.; Guy Penrod, February 13th, 7:30 p.m.; Shawn Belton-Miller - TBA. Season memberships are: Adults - \$40, Sr. Adult - \$35, Students - \$20, and Family - \$100. For information, call Janie Kunselman at 659-2631. Tickets purchased from Tri-City Concert Association admit members to concerts in Pampa and Plainview.



Golden Wedding Anniversary

Don and Mary Allen will celebrate their 50th wedding anniversary on Saturday, August 13th with a reception from 2-3:30 p.m. in the activity room at Hansford Manor. (No gifts please.)

Don Allen and Mary Frank were married on August 17, 1961 in Raton, NM.

Mary attended St. Mary of Nazareth School of Nursing in Chicago IL. She worked as an RN in Dalhart TX, Clayton NM, and in Spearman. She was a nurse in Spearman alone for 37 years, retiring in 1997.

Don was born and raised in Spearman and farmed all of his life.

Don and Mary had two children, Karen Woodward (deceased) and Mark Allen. They have three grandchildren, Travis Durham (and his wife, Liz), and Matt and Mallory Allen. They also have two great-grandchildren, Hudson and Evy.

You are invited to a **Baby Girl Shower** honoring **Mary Ellen Pearson** daughter of Anne Marie & Mark Pearson **Saturday, August 13, 2011** from 10:30 - 11:30 a.m. at the home of Shelly Beedy **1103 Archer St Spearman TX**

You are invited to a **Baby Boy Shower** honoring **Brandi (& Toby) Thompson** **Saturday, August 20, 2011** from 10:30 - 11:30 a.m. at the home of KiKi Connelly **805 Wilmeth Dr Spearman TX** Selections: Gordons Drug; Baby's-R-Us; Target

You are invited to a **Baby Boy Shower** honoring **Michelle & Jarick Howard** **Sunday, August 14, 2011** from 2:00-3:00 p.m. at the **Church of Christ Parlor** 121 Haney Spearman TX Selections: Gordons Drug; Baby's-R-Us; Target

Gordon's
Bridal Registry

Couples Currently Registered

- Ashley Lange & Clete Vanderburg - 7/30
- Justine Rosales & Skyler Sumner - 8/13
- Cara Gwin & Lance Baker
- Rossilyn Bulls & Andrew Reed
- Saylee Flowers & Ryan Renick
- Tabatha (Shields) & Matt Jones
- Dana Lewis & Cass Cooper
- Kendra Skarke & T Jay Sherrill
- Jenna McElroy & Chance Riggins
- Jenny McCloy & Clay Finley

Baby Registry

- Baby Boy of Michelle & Jarick Howard - 8/14
- Baby Girl of Nikki & Brady Hart
- Baby Boy of Jessica Bueno & Britt Fleetwood

Gordon's 659-2141
314 Main Spearman

Wheatheart of the Nation Celebration
August 14-21

Perryton, Texas

Block Party
Parade
Barn Dance
Rodeo
Demolition Derby
BBQ
5K Races
Pioneer Days
...and so much more!!!

A Texas Size Good Time

www.perryton.org 806.435.6575 pococ@ptsi.net

Sergio's Auto Sales
We appreciate your support!
Sergio Vargas
120 W Kenneth Ave • Spearman TX 79081
(806) 659-9971 - day • (806) 330-0173 - night
Canyon Location Phone Number: (806) 231-8388

SERGIO'S AUTO SALES
SERGIO VARGAS
120 W. KENNETH AVE. SPEARMAN, TX 79081
806 659 9971 CEL. 806 330 0173

Willimon Working on Eagle Scout Project



Connor Willimon (right) is pictured above with Jim Derington (left) in front of the Pavilion behind the dam at Palo Duro Lake.

To Whom It May Concern: My name is Connor Willimon, and I am a Boy Scout in Troop 551 of Spearman Texas. I am 15 years old, and I am a Life Scout. I am currently working on my Eagle Scout Project. For my project, I am installing a flagpole and two new benches at Palo Duro Lake near the Pavilion behind the dam. The Pavilion is a place the River Authority put there for family and community get-togethers. The pavilion is a very popular place for families especially in the summer and around holidays.

This project will benefit the public because the flagpole and benches will be of use for family and community get-togethers. It will be functional for flag ceremonies, and the board of directors at Palo Duro Lake believes this project will enhance the park area. This project will help install a sense of pride in the United States of America, and add aesthetic value to the park. Seeing the American flag flying gives people a sense of patriotism and makes us think of the people that are out there giving their lives to protect ours, and our freedoms.

To complete my project, I need to raise approximately \$2,000. I am asking you to contribute to this project.

All donations are tax deductible. If you would like to make a contribution, please complete the form below and mail with your donation to Palo Duro River Authority by August 19, 2011. Thank you, Connor Willimon

Name: _____
 Address: _____
 City, State & Zip: _____
 Contribution Amount: _____
 Remit to: Palo Duro River Authority Make Checks payable to: Palo Duro River Authority
 P.O. Box 99
 Spearman, TX 79081

Words from Faith & Grace

by Cecil R. Biggers, Lutheran Lay Minister



In the ninth week of Pentecost we study Isaiah 56: 1, 6-8, Psalm 67, Romans 11: 1-2a, 29-32 and Matthew 15: 21-28.

The exiles in Babylon hear a message of hope from Isaiah. Isaiah sees God gathering the faithful of all nations to his holy mountain. Isaiah says that God will have a place for eunuchs (who were not treated well in this society) and for foreigners (non-Jews) who believe. We can see that God hears the prayers of all who love him, regardless of their origin. This was a radical statement for Isaiah's day and it is radical to some today. Prayer unites the people of faith in the one God.

The Psalmist sings a song of public worship. "Let all peoples praise you, God!" The theme is God's 'blessing'. The first verse echoes Numbers 6: 24-26 which reads, "The Lord bless you and keep you; the Lord make his face to shine upon you and be gracious to you; the Lord lift up his countenance upon you, and give you peace." God's blessing is given so that the believer may act in mission.

Paul continues to struggle with the greatest part of the people of Israel not accepting Jesus as The Messiah. Paul asks, "Has God rejected his people?" Paul answers with an emphatic (perhaps even a little coarse) No! God keeps his promises, his covenants. God is faithful. Paul rationalizes that perhaps the hearts of his people are hardened so that the Gentile world can be won to Christ, but Paul is certain that God will redeem Israel also. Today some Christians and all of Islam consider that the Jews have 'forfeited' their status as God's people. Paul did not believe this was so and I do not so believe. Salvation is in God's hands, not ours. And a study of scripture will lead you to see that God's purpose is one of salvation. The ways and means we may not understand but God's love for us is steadfast.

Jesus is traveling in Gentile territory after the death of John the Baptist and the feeding of the five thousand. In the area of Tyre and Sidon a Canaanite woman greets him as "Son of David", a political title connecting Jesus with King David. Her daughter is possessed of a demon and she begs Jesus to help her. Her plea is similar to our liturgy, Kyrie Elieson (Greek for "Lord Have Mercy"). Her persistence causes the disciples to implore Jesus, Apolyson (Greek for "Away with Her!"). Jesus tells the woman that he is sent for the lost of Israel and it would be unfair to give the children's food to the dogs. The woman counters that even the dogs eat the crumbs from their masters' tables.

Jesus tells her, "Great is your faith" and her daughter is healed. Jesus broadens the boundaries of his kingdom to include a non-Jewish woman and her child. Jesus recognizes the woman's 'great' faith when only a little while before he had criticized Peter with "O you of little faith". God gathers to his kingdom all who are faithful to his name.

May the Holy Spirit enable your faith in Jesus The Christ that you too may enter his kingdom and 'gather on his holy mountain.'

NOTICE OF PUBLIC MEETING TO DISCUSS BUDGET AND PROPOSED TAX RATE

The Gruver ISD will hold a public meeting at 7:00 PM, August 29, 2011 in Gruver ISD Administration Board Room. The purpose of this meeting is to discuss the school district's budget that will determine the tax rate that will be adopted. Public participation in the discussion is invited.

The tax rate that is ultimately adopted at this meeting or at a separate meeting at a later date may not exceed the proposed rate shown below unless the district publishes a revised notice containing the same information and comparisons set out below and holds another public meeting to discuss the revised notice.

| | |
|--------------------------|---|
| Maintenance Tax | \$1.038000/\$100 (proposed rate for maintenance and operations) |
| School Debt Service Tax | \$0.000000/\$100 (proposed rate to pay bonded indebtedness) |
| Approved by Local Voters | |

Comparison of Proposed Budget with Last Year's Budget

The applicable percentage increase or decrease (or difference) in the amount budgeted in the preceding fiscal year and the amount budgeted for the fiscal year that begins during the current tax year is indicated for each of the following expenditure categories.

| | |
|----------------------------|-------------------|
| Maintenance and operations | -16.61 % decrease |
| Debt Service | 0.00 % increase |
| Total expenditures | -16.61 % decrease |

Total Appraised Value and Total Taxable Value

(as calculated under Section 26.04, Tax Code)

| | Preceding Tax Year | Current Tax Year |
|--|--------------------|------------------|
| Total appraised value* of all property | \$397,342,068 | \$399,834,313 |
| Total appraised value* of new property** | \$1,326,106 | \$943,173 |
| Total taxable value*** of all property | \$392,829,609 | \$387,182,670 |
| Total taxable value*** of new property** | \$1,299,583 | \$933,741 |

*Appraised value is the amount shown on the appraisal roll and defined by Section 1.04(8), Tax Code.
 ** "New property" is defined by Section 26.012(17), Tax Code.
 *** "Taxable value" is defined by Section 1.04(10), Tax Code.

Bonded Indebtedness

Total amount of outstanding and unpaid bonded indebtedness* \$0

*Outstanding principal.

Comparison of Proposed Rates with Last Year's Rates

| | Maintenance & Operations | Interest & Sinking Fund* | Total | Local Revenue Per Student | State Revenue Per Student |
|--|--------------------------|--------------------------|------------|---------------------------|---------------------------|
| Last Year's Rate | \$1.038000 | \$0.000000* | \$1.038000 | \$6,675 | \$8,123 |
| Rate to Maintain Same Level of Maintenance & Operations Revenue & Pay Debt Service | \$1.035770 | \$0.000000* | \$1.035770 | \$8,680 | \$5,633 |
| Proposed Rate | \$1.038000 | \$0.000000* | \$1.038000 | \$8,698 | \$5,720 |

*The Interest & Sinking Fund tax revenue is used to pay for bonded indebtedness on construction, equipment, or both. The bonds, and the tax rate necessary to pay those bonds, were approved by the voters of this district.

Comparison of Proposed Levy with Last Year's Levy on Average Residence

| | Last Year | This Year |
|---|------------|------------|
| Average Market Value of Residences | \$53,934 | \$54,510 |
| Average Taxable Value of Residences | \$28,147 | \$28,608 |
| Last Year's Rate Versus Proposed Rate per \$100 Value | \$1.038000 | \$1.038000 |
| Taxes Due on Average Residence | \$292.17 | \$296.95 |
| Increase (Decrease) in Taxes | | \$4.78 |

Under state law, the dollar amount of school taxes imposed on the residence homestead of a person 65 years of age or older or of the surviving spouse of such a person, if the surviving spouse was 55 years of age or older when the person died, may not be increased above the amount paid in the first year after the person turned 65, regardless of changes in tax rate or property value.

Notice of Rollback Rate: The highest tax rate the district can adopt before requiring voter approval at an election is \$0.040000. This election will be automatically held if the district adopts a rate in excess of the rollback rate of \$0.040000.

Fund Balances

The following estimated balances will remain at the end of the current fiscal year and are not encumbered with or by a corresponding debt obligation, less estimated funds necessary for operating the district before receipt of the first state aid payment.

| | |
|--|-------------|
| Maintenance and Operations Fund Balance(s) | \$3,800,000 |
| Interest & Sinking Fund Balance(s) | \$0 |

AVAILABLE NOW!
E-SUBSCRIPTION
 to the
Hansford County Reporter-Statesman
 Delivered to your e-mail each Thursday for only \$35/year.
 Purchase online at www.spearmanreporter.com
 Call 806-658-3434 or e-mail reporter@spearmanreporter.com for details.

MITCHELL THEATRES.COM
 GUYMON, OK • LIBERAL, KS • NEWTON, KS

NORTHRIDGE 8
 Guymon, Oklahoma
www.northridge8.com
 580-338-3281

SOUTHGATE 6
 Liberal, Kansas
www.southgate6.com
 620-624-5573

SEQUOYAH 8
 Garden City, Kansas
www.sequoyah8.com
 620-275-2760

CHISHOLM TRAIL 8
 Newton, Kansas
www.chisholmtrail8.com
 316-283-0555
FRESH POPCORN EVERYDAY!
-PARTY ROOM & ARCADE-

Just in Time for **Back to School**

Get your new tablet at PTCI!

BlackBerry® Playbook™ Tablet
 OR
Motorola XOOM™ Tablet

Ask about our 12-month payment plan and discounted prices!

PLUS: **FREE Installation of High-Speed Internet!**

PTCI
 Communication & Broadband Solutions

www.ptci.net
 721 W 7th in Spearman 800-562-2556

Services not available in all areas. Some restrictions apply. Offer good thru Sept. 30.

Agriculture Secretary Vilsack Announces Changes to CRP to Assist Producers Impacted by Severe Drought Conditions

Agriculture Secretary Tom Vilsack today announced that the Farm Service Agency (FSA) is modifying its Conservation Reserve Program (CRP) policies to help those affected by sustained drought conditions. Throughout this year of extreme weather, USDA has supported and delivered assistance to farmers, ranchers, and rural communities across the country.

"We continue to do all we can to help thousands of farmers and ranchers in the southwestern United States who are struggling from drought," said Vilsack. "Many ranchers have been or will be forced to sell livestock due to drought and USDA will do what we can to help our farmers and ranchers during these challenging times."

The policy changes influence FSA rules governing emergency grazing. The period normally allowed for emergency grazing lasts through Sept. 30, 2011. FSA is permitting farmers

and ranchers in drought stricken states who have been approved for emergency grazing, including those in Colorado, Kansas, New Mexico, Oklahoma and Texas, to extend the emergency grazing period to Oct. 31, 2011, without an additional payment reduction.

Producers wishing to participate in emergency grazing must first request permission from the FSA county office by indicating the acreage to be grazed.

As a second condition designed to help livestock producers, FSA will allow producers nationwide to utilize harvested hay from expiring CRP acres when those acres are being prepared for fall seeded crops. Prior to this modification, all mechanically harvested hay was required to be destroyed. This change enables livestock producers to feed the hay that is mechanically harvested to their own livestock or to sell or donate hay. Consistent with existing policy for

managed or emergency haying and grazing of eligible CRP acres, rental payments will be reduced by 25 percent for those utilizing this option.

"We are eager to do all we can in the face of this drought crisis across the southern plains," said FSA Administrator Bruce Nelson. "This has been one of the worst dry and hot spells since the Dust Bowl era of the '30s."

For further information about the Conservation Reserve Program and Emergency Haying and Grazing, producers are encouraged to visit their USDA Service Centers or go online to www.fsa.usda.gov. Search under Conservation Programs and Disaster Assistance.

USDA is an equal opportunity provider, employer and lender. To file a complaint of discrimination, write to USDA, Assistant Secretary for Civil Rights, Office of the Assistant Secretary for Civil Rights, 1400 Independence Avenue, S.W., Stop 9410, Washington, DC 20250-9410, or call toll-free at (866) 632-9992 (English) or (800) 877-8339 (TDD) or (866) 377-8642 (English Federal-relay) or (800) 845-6136 (Spanish Federal-relay). USDA is an equal opportunity provider and employer.

USDA Makes Funds Available to Meet Urgent Credit Needs of Producers

Agriculture Secretary Tom Vilsack announced today that a high demand for guaranteed farm ownership and direct farm operating funds has prompted USDA to transfer appropriated funds between programs as authorized by law, to meet the urgent credit needs of producers, including beginning and minority farmers and ranchers.

"Demand is strong for direct operating loans and guaranteed farm ownership loans, while demand for subsidized guaranteed operating loans has stabilized," said Vilsack. "With these funds, we can help thousands of producers establish and maintain their family farming operations and obtain long-term credit assistance through a commercial lender."

The transfer will make an additional \$100 million in

loan funds available for the direct operating loan program, providing 1,600 small, beginning and minority farmers with resources to establish and maintain their family farming operations. In addition, \$400 million in loan funds will be made available for the guaranteed farm ownership loan program giving an additional 1,000 family farmers access to commercial lending backed by USDA. Both programs had run out of funds resulting in a backlog of approved but unfunded loan applications.

This measure will allow all of the backlogged loans to be funded and provide sufficient funds to meet the needs of new loan applicants for these programs while at the same time leaving sufficient funding for the subsidized guaranteed farm operating loans pro-

gram to meet the expected demand for fiscal year 2011. Producers needing additional direct operating or longer term guaranteed farm ownership loans funds are encouraged to make application at their local Farm Service Agency office.

USDA is an equal opportunity provider, employer and lender. To file a complaint of discrimination, write to USDA, Assistant Secretary for Civil Rights, Office of the Assistant Secretary for Civil Rights, 1400 Independence Avenue, S.W., Stop 9410, Washington, DC 20250-9410, or call toll-free at (866) 632-9992 (English) or (800) 877-8339 (TDD) or (866) 377-8642 (English Federal-relay) or (800) 845-6136 (Spanish Federal-relay).

Panhandle Assn. of SWCDS to Meet

The Panhandle Association of Soil and Water Conservation Districts (PASWCDS) will meet Tuesday, August 16, beginning at 9:00 a.m. in Wellington at the historic renovated Ritz Theatre located at 902 East Avenue.

During the business session speakers from the Texas State Soil and Water Conservation Board, Association of Texas Soil and Water Conservation Districts, and the USDA Natural Resource Conservation Service will update SWCD directors on state and national soil and water conservation programs and issues.

Twenty-five soil and water conservation districts in the Panhandle region of the state are members of the PASWCDS. Counties which the SWCDS serve include Dallam, Sherman, Hansford, Ochiltree, Lipscomb, Hartley, Moore, Hutchinson, Roberts, Hemphill, Oldham, Potter, Carson, Gray, Wheeler, Deaf Smith, Randall, Armstrong, Donley, Collingsworth, Parmer, Castro, Swisher, Briscoe, Hall, and Childress Counties.

See us for:
 AUTO • HOME • CROP HAIL •
 FARM & RANCH • MULTIPERIL •
 LIVESTOCK

INSURANCE



BORT AGENCY, INC.
 510 Main St. • Gruver, TX
 (806) 733-2456

Hotline for Priority Seating - 435-3945

MONEY'S

BBQ & STEAK HOUSE



Stan and Donna Zepp

We Are THPLC-2-B

14 SE 3rd Ave
 Perryton, TX

New, Updated Menu Same Great Service

Prices Good Thru 9/3/11

IT'S BACK TO SCHOOL

WE HAVE EVERYTHING YOU NEED FOR A TASTY LUNCH, INCLUDING YOUR FAVORITE SNACKS, CHIPS, CANDY AND COOKIES!

ASSORTED OSCAR MAYER LUNCHABLES



\$2.49

FRUIT PUNCH CAPRI SUN 8 PACK



2 \$6 FOR

BAR-S ASSORTED DELI STYLE MEATS



2 \$5 FOR

ALLSUP'S SANDWICH BREAD 89¢ EACH OR

2 \$1.49 FOR

BUY ONE RICE KRISPIES BIG BAR 2.6 OR 3.2 OZ. GET ONE FREE



JACK LINK'S ORIG. OR TERIYAKI SASQUATCH STEAK 2.4 OZ.



2 \$5 FOR

ALLSUP'S WHEAT BREAD \$1.09 EACH OR



BUY ONE VANILLA ICE CREAM 1/2 GALLON



2 \$6 FOR

ASSORTED FLAVORS PEPSI 12 PACK



\$3.79

BUY 12 GALLONS OF FRESH ALLSUP'S MILK GET ONE FREE!



ASSORTED FLAVORS BRISK TEA 1 LITER



99¢

ASSORTED COKE 20 OZ.



2 \$2.50 FOR

WESTERN FAMILY BATH TISSUE 4 ROLL PKG.

\$1.09

WESTERN FAMILY PAPER TOWEL 2 PLY ROLL

79¢

305 W. Kenneth Spearman • 659-3135
 101 Main Ave. Gruver • 733-2953

Hansford County Library Has Spectacular Summer Reading Program

Hansford County Library's summer reading challenge, "Tour de Library," crossed the finish line at 4 p.m. on Friday, August 5th. With over 440 tickets in the raffle, the highlight of the program occurred when winners were selected.

Grand prize winners of bicycles were Rene Dominguez and Anabel Aguilera. In second place, MP3 players were presented to Sam Turner and

Emma Franklin. Movie and pool passes were awarded to Tristan Ellsworth, Shad Whiteley, Nicholas Carbajal, Oscar Barajas, Zane Walls, Kaddy McCubbin, Caleigh Wood, Maggie Davis, Andrea Baca and Hanna Cervantes.

"The staff and I want to take this opportunity to congratulate our winners who have worked diligently all summer to improve their reading skills," commented library director Margaret

Ruttman. "Staff member Liz Miser was responsible for creating this program, which was conducted June 1st to August 5th and was well supported by children, parents, and interested citizens of the community.

"We were thrilled to have such great participation," added Ruttman.

Expect another great Reading Challenge in the summer of 2012!

PTCI Serves Watermelon in Spearman

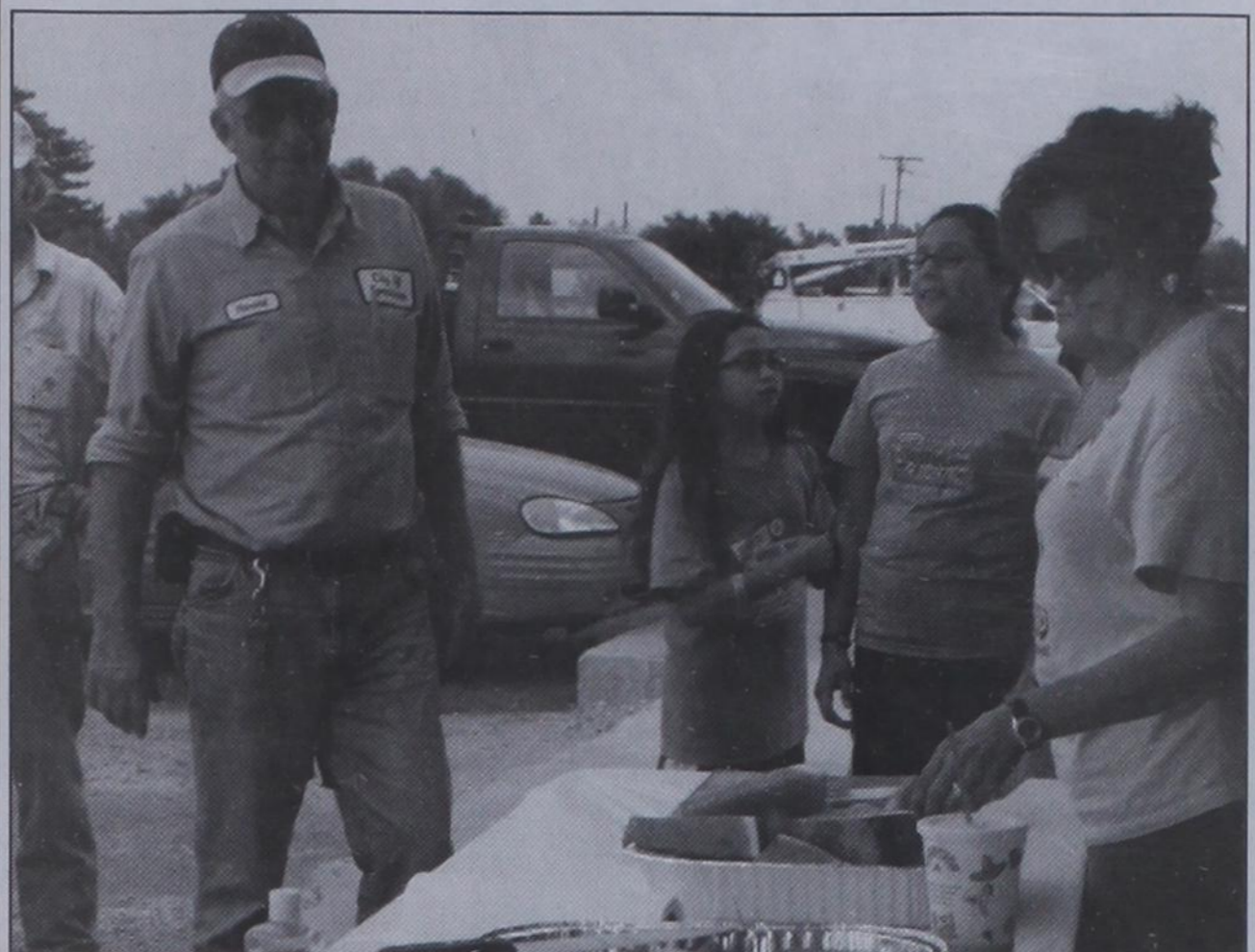

PTCI Public Relations Representative Carol Grider (far right) serves up crisp, cool watermelon on a recent hot day outside the PTCI Spearman office on 7th Street. Kids to seniors turned out for the event and a good time was had by all.

Time to Renew Brands in Texas

In accordance with Article 144.044 of the Agriculture Code, Wednesday August 31, 2011 Hansford County Clerk's Office will begin the process of re-registering your brand. You will have until Wednesday, February 29, 2012 to renew your registration. On Thursday, March 1, 2012, all brands that have not been re-registered will become "open brands" for the general public.

Every 10 years, Texas requires that brands be re-registered in the county or counties in which you operate. Brands must be registered in the county or counties in which you operate.

Texas does not have a statewide brand registry database. Texas counties may have county-level brand archives. This website is a service to the livestock producers of Texas to learn about the brand registration process and laws in this state.

The fee to register or re-register a brand will be \$16

per brand and one location. If you are registering the same brand in multiple locations on the same day, it will be an additional \$5 per location.

If you have brands registered in other counties in the State of Texas, it will be necessary for you to contact the County Clerk in those

counties to re-register your brand.

Please call 1-800-242-7820, and speak with the TSCRA law enforcement department for more information, or Kim Vera, Hansford County/District Clerk, 806-659-4110.

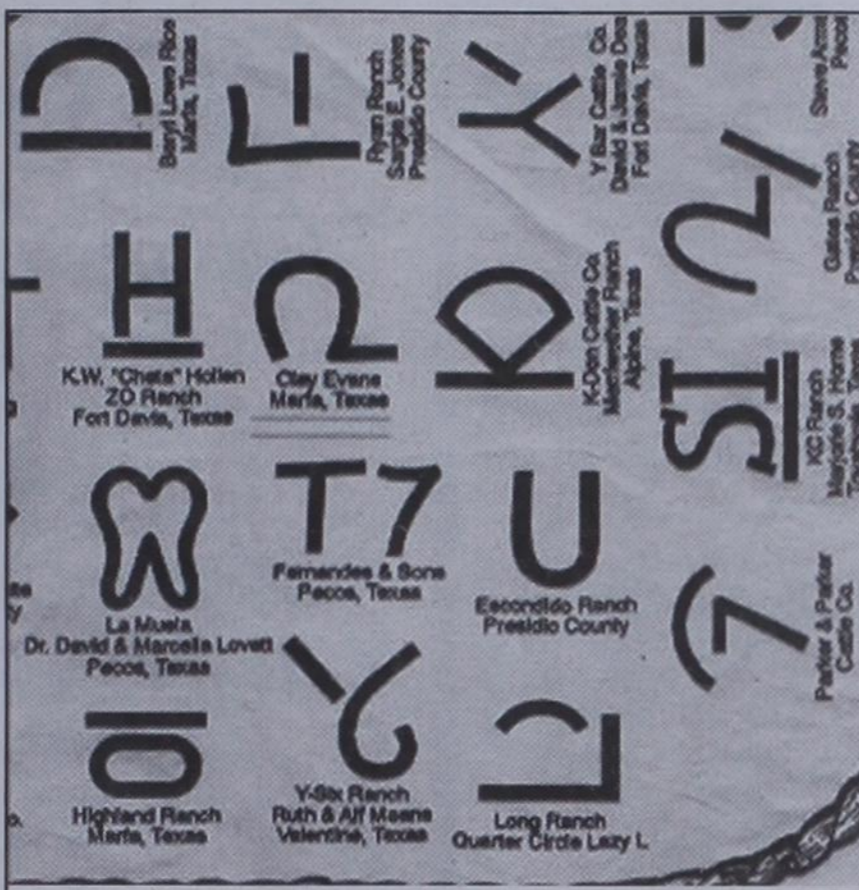

Brand locations:

- Left or right: shoulder, side, rib, flank, hip, loin, or thigh
- Jaw, face, tail, back, leg, or nose
- Sometimes, multiple locations may be used for one record
- Ear marks must be designated right or left and registered with the brand

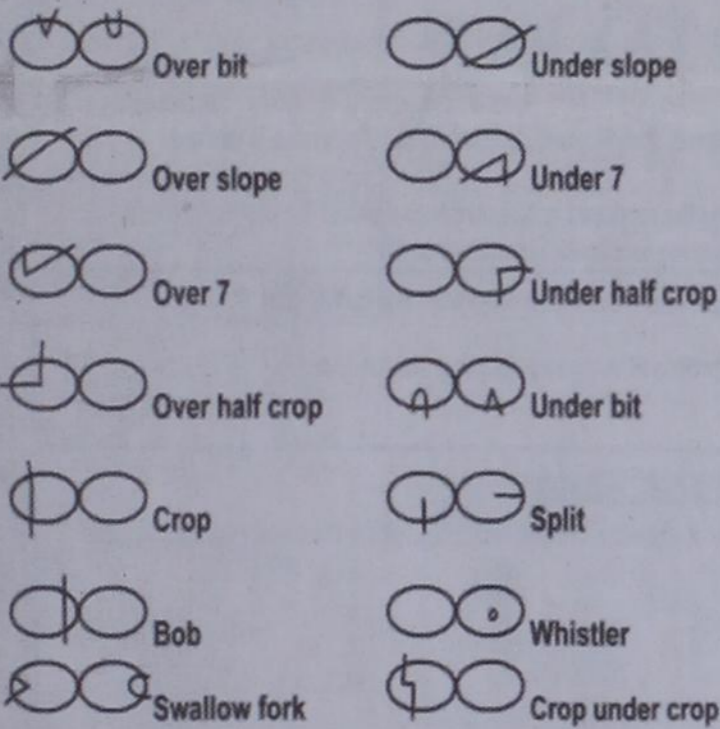

WANTED

We are looking for a few good dogs!

If you have a well mannered dog that you would agree to show at Hansford Manor, call the Activities Dept. (659-5849) by Monday, August 15th.

We are looking for dogs to organize a dog show at the Manor on Friday, August 19th at 2:30 p.m.



NOTICE OF PUBLIC MEETING TO DISCUSS BUDGET AND PROPOSED TAX RATE

The Pringle-Morse CISD will hold a public meeting at 7:00 P.M., August 29, 2011 in Pringle-Morse CISD Board Room. The purpose of this meeting is to discuss the school district's budget that will determine the tax rate that will be adopted. Public participation in the discussion is invited.

The tax rate that is ultimately adopted at this meeting or at a separate meeting at a later date may not exceed the proposed rate shown below unless the district publishes a revised notice containing the same information and comparisons set out below and holds another public meeting to discuss the revised notice.

| | |
|--------------------------|---|
| Maintenance Tax | \$1.040000/\$100 (proposed rate for maintenance and operations) |
| School Debt Service Tax | \$0.000000/\$100 (proposed rate to pay bonded indebtedness) |
| Approved by Local Voters | |

Comparison of Proposed Budget with Last Year's Budget

The applicable percentage increase or decrease (or difference) in the amount budgeted in the preceding fiscal year and the amount budgeted for the fiscal year that begins during the current tax year is indicated for each of the following expenditure categories.

| | |
|----------------------------|-----------------|
| Maintenance and operations | 0.87 % increase |
| Debt Service | 0.00 % increase |
| Total expenditures | 0.87 % increase |

Total Appraised Value and Total Taxable Value

(as calculated under Section 26.04, Tax Code)

| | Preceding Tax Year | Current Tax Year |
|--|--------------------|------------------|
| Total appraised value* of all property | \$245,773,870 | \$264,470,912 |
| Total appraised value* of new property** | \$31,944 | \$486,369 |
| Total taxable value*** of all property | \$245,323,580 | \$262,050,039 |
| Total taxable value*** of new property** | \$31,625 | \$481,916 |

*Appraised value is the amount shown on the appraisal roll and defined by Section 1.04(8), Tax Code.
 ** "New property" is defined by Section 26.012(17), Tax Code.
 *** "Taxable value" is defined by Section 1.04(10), Tax Code.

Bonded Indebtedness

Total amount of outstanding and unpaid bonded indebtedness* \$0

*Outstanding principal.

Comparison of Proposed Rates with Last Year's Rates

| | Maintenance & Operations | Interest & Sinking Fund* | Total | Local Revenue Per Student | State Revenue Per Student |
|--|--------------------------|--------------------------|------------|---------------------------|---------------------------|
| Last Year's Rate | \$1.040000 | \$0.000000* | \$1.040000 | \$12,724 | \$3,752 |
| Rate to Maintain Same Level of Maintenance & Operations Revenue & Pay Debt Service | \$0.950410 | \$0.000000* | \$0.950410 | \$10,613 | \$4,153 |
| Proposed Rate | \$1.040000 | \$0.000000* | \$1.040000 | \$12,703 | \$2,920 |

*The Interest & Sinking Fund tax revenue is used to pay for bonded indebtedness on construction, equipment, or both. The bonds, and the tax rate necessary to pay those bonds, were approved by the voters of this district.

Comparison of Proposed Levy with Last Year's Levy on Average Residence

| | Last Year | This Year |
|---|------------|------------|
| Average Market Value of Residences | \$26,600 | \$28,869 |
| Average Taxable Value of Residences | \$6,280 | \$8,095 |
| Last Year's Rate Versus Proposed Rate per \$100 Value | \$1.040000 | \$1.040000 |
| Taxes Due on Average Residence | \$65.31 | \$84.19 |
| Increase (Decrease) in Taxes | | \$18.88 |

Under state law, the dollar amount of school taxes imposed on the residence homestead of a person 65 years of age or older or of the surviving spouse of such a person, if the surviving spouse was 55 years of age or older when the person died, may not be increased above the amount paid in the first year after the person turned 65, regardless of changes in tax rate or property value.

Notice of Rollback Rate: The highest tax rate the district can adopt before requiring voter approval at an election is \$0.040000. This election will be automatically held if the district adopts a rate in excess of the rollback rate of \$0.040000.

Fund Balances

The following estimated balances will remain at the end of the current fiscal year and are not encumbered with or by a corresponding debt obligation, less estimated funds necessary for operating the district before receipt of the first state aid payment.

| | |
|--|-------------|
| Maintenance and Operations Fund Balance(s) | \$1,958,952 |
| Interest & Sinking Fund Balance(s) | \$0 |

*Congratulations, Cristina,
on your Quinceañera!
We are so proud of you!*
Gary & Cathy



*"Thank you God for letting my parents
guide my steps to you full of happiness"*
Raymundo Y Alicia Muñoz
*We have the Honor to invited you to
the ceremony XV Aniversario
Saturday August 13, 2011 1:00 p.m.
Church Sacred Heart of Jesus,
oficiating Father Gregory Bunyon
Escort Juan Carlos Lopez
Padrinos of Honor
Victor Hugo Y Rosa Mayte Prieto O.
Spearman Tx, August 2011*

- | | |
|------------------|------------------|
| Susy Flores | Bryan Campos |
| Brooke Walker | Valentin Trajo |
| Zianga Hernandez | Hector Juarez |
| Lupita Flores | Jose Carbajal |
| Evelyn Jaquez | Beau Brown |
| Paola Prieto | Alexis Avila |
| Callie Yarbrough | Jahir Rodriguez |
| Marglyn Almanza | Javier Rosendo |
| Sidney Hawkins | Javier Caro |
| Jayne Pack | Gerardo Enriquez |
| Belle Werner | Omar Mendoza |
| Emily Oela | Ramon Ortiz |
| Kelvi Summer | Aron Morales |
| Stade Garnett | Cameron Wolf |
- Party favors
Dagana Prieto
&
Daniela Sofia Perez
Shoes
Michelle Muñoz*

Gruver Pee Wee Football

It is that time again to start thinking about football! Gruver Pee Wee Football League is having 2011 Season Registration on Saturday, August 13, 2011 from 2-4 p.m. at the Dairy Queen in Gruver. If your child plans on playing Pee Wee football this year, they MUST show up to fill out registration forms. If you are not available that day, then contact one of the Coaches prior to August 13th. Gruver will have a 3rd/4th grade team and a 5th/6th grade team. Head Coach for 3rd/4th is Pyne Gregory and Head Coach for 5th/6th is Chris Spivey.

Please come be part of the fun! Pee Wee football not only teaches basic fundamentals of football, but also sportsmanship and discipline to the young players. These lessons are vital to learn correctly at an early age to produce a productive football athlete for later years of school.

The cost of the registration is \$50. This covers insurance and fees to the league. If your child needs to rent equipment, then there are additional fees. Helmet rental is \$50 and shoulder pad rental is \$50. You only have to write a deposit check for rentals and at the end of the season your check will be returned once the equipment is returned in good condition.

The one-time registration fee of \$50 is due on day of weigh-ins. Weigh-ins and physicals will be in Perryton at the Perryton Activity Center on August 29th at 6 p.m. Your child must be present to play football.

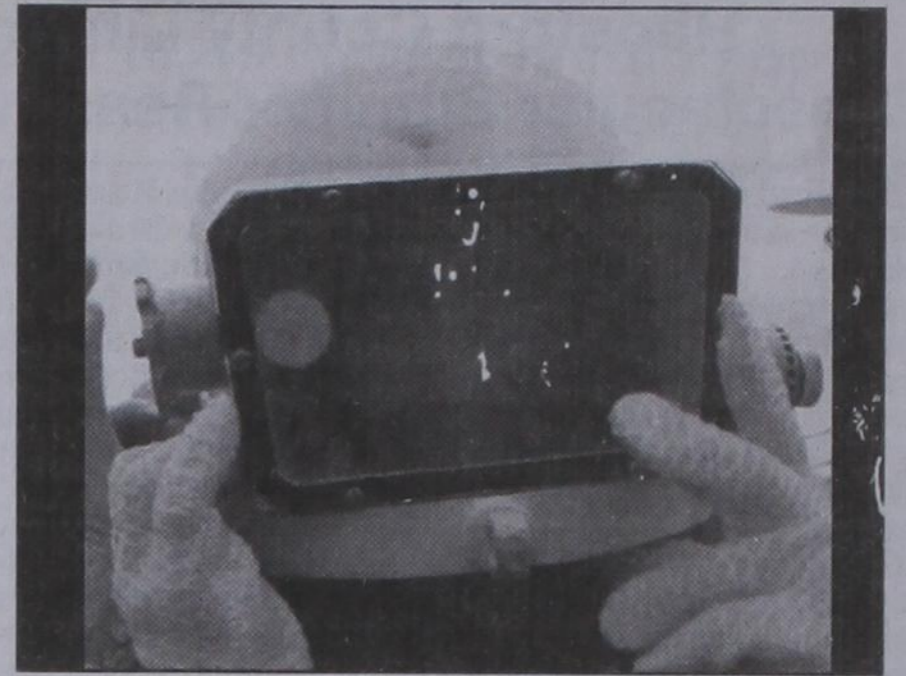

Casey Robert Cator recently graduated from The Ocean Corporation in Houston Texas. He was in the class of UDT-412. Ultimate Diver Training (UDT) - Graduates of the UDT program are certified as commercial divers. They work offshore and inland performing search, salvage, NDT inspections, underwater welding and burning, etc. Most major underwater projects are completed by certified commercial divers.

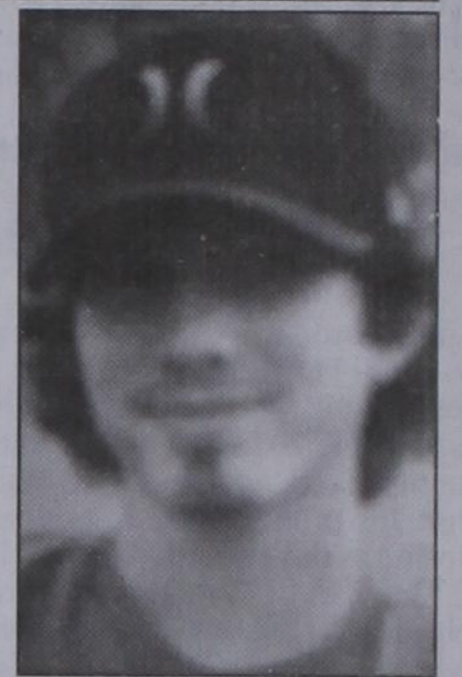

PTCI Honored with Independent Community Service Award

PTCI was recognized for their community service in the July 2011 issue of CableFax The Magazine. PTCI believes that being local and supporting the communities it serves is an important part of doing business.

According to CableFax, PTCI proves that localism matters. Today's communication service market is fierce with national companies extending their reach into more rural areas.

Not only does PTCI provide advanced telecommunication services that rival larger markets, it pours tens of thousands of dollars into the communities it serves every year through support of EMS/Police/Fire Departments, College Scholarships, Economic Development, Boy and Girl Scouts, Youth Sports Teams, Town Celebrations and many, many others.

CEO Ron Strecker was quoted in CableFax as saying "This community has been good to PTCI, and we want to do our part and give back to it. You hope it is something a customer will think about before they consider another provider who does not participate in the community."

Staying connected with the community is important to PTCI, whether it be serving up hamburgers and watermelon or constantly updating its Facebook page. PTCI invites you to visit them at ptc1.net or on Facebook, or stop by any office located in Beaver, Boise City, Guymon, Laverne, Perryton or Spearman.

Peaches Tell your friends!

Colorado Peaches from Palisade!
Straight from grower to you! Tree ripe, juicy and bursting with flavor. From tree to box, to bring you the BEST quality available. Refrigerated fresh.

Cunningham Peaches - 970-314-1469
www.CunninghamPeaches.com

August 13th - Dalhart, Alco
August 16th - Pampa, Hwy 60, 1 Blk E from Doug Boyd Motors
August 18th - Perryton Equity Town & Country, Hwy. 83 South

NOTICE OF PUBLIC MEETING TO DISCUSS BUDGET AND PROPOSED TAX RATE

The Spearman ISD will hold a public meeting at 07:00 PM, August 29, 2011 in Spearman High School Library, 403 E 11th Avenue, Spearman, TX 79081. The purpose of this meeting is to discuss the school district's budget that will determine the tax rate that will be adopted. Public participation in the discussion is invited.

The tax rate that is ultimately adopted at this meeting or at a separate meeting at a later date may not exceed the proposed rate shown below unless the district publishes a revised notice containing the same information and comparisons set out below and holds another public meeting to discuss the revised notice.

| | |
|--------------------------|---|
| Maintenance Tax | \$1.040000/\$100 (proposed rate for maintenance and operations) |
| School Debt Service Tax | \$0.206040/\$100 (proposed rate to pay bonded indebtedness) |
| Approved by Local Voters | |

Comparison of Proposed Budget with Last Year's Budget

The applicable percentage increase or decrease (or difference) in the amount budgeted in the preceding fiscal year and the amount budgeted for the fiscal year that begins during the current tax year is indicated for each of the following expenditure categories.

| | |
|----------------------------|-------------------|
| Maintenance and operations | -12.52 % decrease |
| Debt Service | 0.03 % increase |
| Total expenditures | -11.55 % decrease |

Total Appraised Value and Total Taxable Value

(as calculated under Section 26.04, Tax Code)

| | Preceding Tax Year | Current Tax Year |
|--|--------------------|------------------|
| Total appraised value* of all property | \$453,225,766 | \$459,241,120 |
| Total appraised value* of new property** | \$1,679,192 | \$2,638,250 |
| Total taxable value*** of all property | \$388,369,158 | \$406,306,581 |
| Total taxable value*** of new property** | \$1,527,896 | \$2,611,867 |

*Appraised value is the amount shown on the appraisal roll and defined by Section 1.04(8), Tax Code.

** "New property" is defined by Section 26.012(17), Tax Code.

*** "Taxable value" is defined by Section 1.04(10), Tax Code.

Bonded Indebtedness

Total amount of outstanding and unpaid bonded indebtedness* \$10,185,000

*Outstanding principal.

Comparison of Proposed Rates with Last Year's Rates

| | Maintenance & Operations | Interest & Sinking Fund* | Total | Local Revenue Per Student | State Revenue Per Student |
|--|--------------------------|--------------------------|------------|---------------------------|---------------------------|
| Last Year's Rate | \$1.040000 | \$0.184400* | \$1.224400 | \$7,021 | \$4,745 |
| Rate to Maintain Same Level of Maintenance & Operations Revenue & Pay Debt Service | \$1.050690 | \$0.206040* | \$1.256730 | \$6,285 | \$5,112 |
| Proposed Rate | \$1.040000 | \$0.206040* | \$1.246040 | \$6,226 | \$4,821 |

*The Interest & Sinking Fund tax revenue is used to pay for bonded indebtedness on construction, equipment, or both.

The bonds, and the tax rate necessary to pay those bonds, were approved by the voters of this district.

Comparison of Proposed Levy with Last Year's Levy on Average Residence

| | Last Year | This Year |
|---|------------|------------|
| Average Market Value of Residences | \$48,743 | \$67,430 |
| Average Taxable Value of Residences | \$28,869 | \$45,687 |
| Last Year's Rate Versus Proposed Rate per \$100 Value | \$1.224400 | \$1.246040 |
| Taxes Due on Average Residence | \$353.47 | \$569.28 |
| Increase (Decrease) in Taxes | | \$215.81 |

Under state law, the dollar amount of school taxes imposed on the residence homestead of a person 65 years of age or older or of the surviving spouse of such a person, if the surviving spouse was 55 years of age or older when the person died, may not be increased above the amount paid in the first year after the person turned 65, regardless of changes in tax rate or property value.

Notice of Rollback Rate: The highest tax rate the district can adopt before requiring voter approval at an election is \$1.246212. This election will be automatically held if the district adopts a rate in excess of the rollback rate of \$1.246212.

Fund Balances

The following estimated balances will remain at the end of the current fiscal year and are not encumbered with or by a corresponding debt obligation, less estimated funds necessary for operating the district before receipt of the first state aid payment.

| | |
|--|-------------|
| Maintenance and Operations Fund Balance(s) | \$1,512,757 |
| Interest & Sinking Fund Balance(s) | \$128,666 |

AVAILABLE NOW!

E-SUBSCRIPTION

to the
Hansford County
Reporter-Statesman

Delivered to your e-mail each
Thursday for only \$35/year.
Purchase online at
www.spearmanreporter.com

Call 806-659-3434 or e-mail reporter@spearmanreporter.com for details.



ATTENTION 2011 Summer Clearance Sale

Sale Prices Good from August 9-21

**NO SALES TAX ON PURCHASES MADE
FRIDAY & SATURDAY, AUGUST 15 & 27**
(Excludes jewelry, buckles, wallets, and any items selling for \$100 or more)

• 30% OFF •

- Men & Boys Summer Clothing
- Men Summer Pullover & Sport Shirts
- Men Tabasco & Chili Wear Shirts
- Men Shorts & Swim Suits
- Men Summer Tallman Pullover & Sport Shirts
- Men & Boy Western & Fashion Straw Hats
- Boy Summer Clothing - Shirts & Shorts
- Men & Boys Adidas & Reebok Shoes

20% OFF

Boys Jeans
(Levi, Wrangler, Cinch,
20X & Carhartt)

Boys Shirts
(Cinch, 20X)



Come visit us at:
221 Main Street
Spearman, TX
(806) 659-3426

- Men Fashion Jeans - \$39⁹⁵
- Men Cinch Black Label Jeans - \$39⁹⁵
- Men Cinch Green Label Jeans - \$34⁹⁵
- Men Levi 550, 560, 501 PW Jeans - \$32⁹⁵
- Men Riata Pants - \$29⁹⁵
- Boy Fashion Jeans - \$29⁹⁵

Store hours: Monday-Saturday, 9 a.m.-6 p.m.

REAL ESTATE

FOR RENT: 1BR & 2BR furnished apartment. All bills paid. Call 659-2247. TFN(6/2/11)B

HELP WANTED

HELP WANTED: Experienced automotive technician needed. Good working environment, holiday pay, health insurance. Also service department helper needed. Apply in person at Prairie Motors in Spearman. (806) 659-2541 or 1-800-692-4657. TFN(12/2/10)B

HELP WANTED: CDL Drivers - Relocate for Great Paying Texas Frack work! Great company! Paid benefits! Must have bulk pneumatic trailer experience. 800-397-2338. 3(7/28/11)P

HELP WANTED: Mission Petroleum Carriers. Immediate Openings! Crude Oil Drivers. Safety & performance bonus quarterly, paid every Friday, paid vacation/holidays/jury duty. Company benefit package: medical/dental/vision/life, 401K with company match; paid orientation/training; referral bonus; Class A-CDL-X req.; 2 yrs tractor/trailer exp. in the last 5 yrs or 1 yr exp. w/ accredited semi-truck driving school diploma. Minimum age: 23. Contact DeAnna Bales@ 1-800-737-9988 ext 1207 or Christy Lawrence at 1-800-737-9973 or visit us at www.mipe.com Monday-Thursday 8am-3pm. EOE 2(8/11/11)B

HELP WANTED: Experienced Natural Gas Compressor mechanic needed. Good driving record and drug test required. Competitive pay and benefits. Fax resume to (806)669-7399, email to arios@logistik.com, or mail to PO Box 501 Pampa TX 79066. Call (806)669-7499 for an application. 2(8/11/11)B

HELP WANTED: Spearman Cattle Feeders is now hiring open riders. Benefits. Please call 806-659-2577. 2(8/11/11)B

HELP WANTED: Wolf Creek Feedyard, located in Perryton, TX is accepting applications in our Cattle working department and General Feedyard labor. Experience is not required. We will train the right applicant. 2(8/11/11)B

Blankenship Real Estate
659-3052 - 670-3774

LET US HELP YOU
SELL YOUR HOME.

3BR, 2 1/2B, 2 living areas, dining area, brick, close to schools.

NEW LISTINGS WANTED!

Eulalia Blankenship - Sales
Eschold Blankenship - Broker

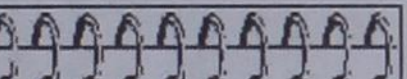

We NEED listings!
Call us now
to help YOU sell
your home for top dollar!

1016 S Barkley - Spearman:
4,081 sq ft, 4 bed, 4 bath 3 lvg areas, 2 Att gar, Fireplace, Corner Lot! **REDUCED AGAIN!**

Shirley Howard, Broker/Owner
806-886-6536, Cell
806-648-4444, Work
Melinda McCullough, Realtor
(806) 733-5678

We would **LOVE** to sell
your **HOUSE!**
CALL US!

Check our websites
for other properties.

SHERMAN CO., TX - 627 acres, choice land, four 1/4 mile sprinklers, fully developed, one 1/4 mile off Hwy. 287 on paved CR - CC, 3 phase electricity, new irrigation well drilled in 2010.

AMARILLO, TX. - 4 MI. N. OF LOOP 335 - development potential (wind energy, comm., res.) 4872.8 ac. +/- of beautiful ranch country, pvt. on four sides. Deer, quail & dove. 50% MINERALS!

CASTRO CO., TX. - on pvt., 1845.6 ac +/-, sprinklers, irr. wells, employee housing, barns, cattle pens w/covered working area, hydraulic chute & truck/cattle scale.

WEST OF DUMAS on pvt. 606 ac. +/-, 17 tower sprinkler, four irr. wells, excellent location for residential or commercial development.

BUDDY CLINE ROAD - Moore Co., TX. - 1/2 section choice land, two wells (one new) and sprinklers.

MOORE CO., TX - 800 ac. with 1/2 section irrigated for sprinkler plus 480 acres of CRP, 1 1/2 miles out of Dumas with pvt. on two sides.

1200 SOW FALLOW TO FINISH OPERATION - Moore Co., TX. - New 5 yr. lease with major hog company. Two separate units, can be divided - Please contact broker for info package and price.

www.scottlandcompany.com
www.texascrp.com
Shawn Gillispie 806/922-5532
Ben G. Scott, Broker
1-800-933-9698 day/eve
TFN(8-11-11)

We offer a competitive wage, benefits include health insurance and a retirement plan. Please call 435-5697 or come by the office to fill out an application. 2(8/11/11)B

SERVICES

HOOCHY POOCHY PARLOR
Call us for all your pet's grooming and boarding needs. Call now for reservations! 806-273-2724. TFN(11/2/07)B

TIRED OF GARAGE SALE PRICES? Let me buy your good used furniture! 2nd Chance Antiques & Furniture, Don 806-648-1480; 806-202-1391 cell. TFN(1/20/11)B

GARAGE SALE

GARAGE SALE - SPEARMAN: 114 S Barkley Street; Friday, August 12th; 8 a.m.-? Ref. air unit, tools, decorative items, purses, clothes, knickknacks. TFN(11/2/07)B

PUBLIC NOTICE

PUBLIC NOTICE
Applications are being taken for a part-time custodian at Hansford County Courthouse, with thirty hour week with retirement benefits.

Applications are to be picked up from Donna Farris, County Court Administrator, and dropped off with her. Applications will be received until August 29, 2011 at 4:00 p.m.

Benny D. Wilson
Hansford County Judge
2(8/11/11)B

INVITATION FOR BIDS

Sealed proposals addressed to the Honorable Mayor and City Aldermen of the City of Spearman, Texas, for the construction of a lift station, approximately 3,800 linear feet of 15-inch sewer main and associated appurtenances, entitled: **WASTEWATER COLLECTION SYSTEM IMPROVEMENTS REPLACEMENT OF MAIN LIFT STATION & REPLACEMENT OF OUTFALL LINE FROM LIFT STATION TO INTERSECTION OF 1ST AVENUE AND COBLE/ARCHER ALLEY** will be received at the office of the City Manager of the City of Spearman at City Hall, 30 Southwest Court, Spearman, Texas, 79081 until: **SEPTEMBER 8, 2011 at 11:00 AM.**

A cashier's check, certified check or acceptable bidder's bond, payable to the City of Spearman in an amount equal to not less than five percent of the bid submitted, must accompany each bid as guarantee that, if awarded the contract, the Bidder will, within fifteen days after receipt of Contact Documents, enter into a contract with the City of Spearman and will execute bonds on the forms provided in

the Contract Documents. Any bid received after the time and date listed above will be returned unopened and will not be considered.

Bidders are expected to inspect the site of the work and inform themselves regarding all local conditions. A **MANDATORY PREBID CONFERENCE** WILL BE HELD AT 10:30 A.M., **SEPTEMBER 1, 2011 AT CITY HALL, 30 Southwest Court, Spearman, Texas.** Bidders must attend the prebid conference to be eligible to bid.

Contract Documents are on file and may be examined in the office of the City of Spearman, City Hall, 30 SW Court Street, Spearman TX 79081-2649, phone (806) 659-2524.

Plans and Specifications may be obtained from the Engineers, Brandt Engineers, 4537 Canyon Drive, Amarillo, Texas 79110, phone (806) 353-7233 in the following manner:

Cost: One Hundred Dollars (\$100.00), non-refundable, for each set of plans and specifications.

Performance and Payment bonds shall be set forth in the Contract documents.

The Owner reserves the right to reject any or all bids and to waive any informalities in the bidding. In case of ambiguity or lack of clearness, the Owner reserves the right to adopt such interpretations as may be most advantageous or to reject the bid as informal. No bid may be withdrawn until the expiration of 30 days from the bid opening date.

**BRIAN GILLISPIE, MAYOR
CITY OF SPEARMAN, TX
2(8/4/11)B**

INVITATION FOR BIDS

Sealed proposals addressed to the Honorable Mayor and City Aldermen of the City of Spearman, Texas, for the construction of a lift station, approximately 3,800 linear feet of 15-inch sewer main and associated appurtenances, entitled: **WASTEWATER COLLECTION SYSTEM IMPROVEMENTS REPLACEMENT OF MAIN LIFT STATION & REPLACEMENT OF OUTFALL LINE FROM LIFT STATION TO INTERSECTION OF 1ST AVENUE AND COBLE/ARCHER ALLEY** will be received at the office of the City Manager of the City of Spearman at City Hall, 30 Southwest Court, Spearman, Texas, 79081 until: **SEPTEMBER 8, 2011 at 11:00 AM.**

A cashier's check, certified check or acceptable bidder's bond, payable to the City of Spearman in an amount equal to not less than five percent of the bid submitted, must accompany each bid as guarantee that, if awarded the contract, the Bidder will, within fifteen days after receipt of Contact Documents, enter into a contract with the City of Spearman and will execute

| | | | | | | | | | | | | |
|---|---|---|---|---|---|---|---|---|---|---|---|---|
| S | A | B | O | T | J | L | A | P | A | L | E | |
| P | R | I | M | E | O | E | R | S | A | L | O | N |
| O | C | T | A | L | C | O | O | P | I | O | U | S |
| T | H | E | H | U | L | K | M | A | I | L | E | D |
| A | G | O | M | A | I | D | | | | | | |
| D | A | M | U | G | L | I | D | E | R | I | V | E |
| I | M | A | M | I | O | N | S | R | E | N | A | L |
| A | M | M | O | C | R | A | W | L | V | E | G | A |
| N | A | B | O | B | D | R | A | Y | S | P | U | N |
| A | N | O | D | A | L | E | N | D | S | T | E | D |
| T | E | S | T | I | O | | | | | | | |
| A | N | E | M | I | A | C | A | P | T | A | I | N |
| G | U | A | V | A | L | E | U | P | E | N | N | I |
| O | L | S | E | N | A | W | L | E | R | N | S | T |
| A | D | A | R | D | E | L | D | I | E | T | S | |

| | | | | | | | | |
|---|---|---|---|---|---|---|---|---|
| 1 | 7 | 9 | 3 | 6 | 8 | 4 | 5 | 2 |
| 3 | 6 | 5 | 4 | 2 | 7 | 9 | 8 | 1 |
| 2 | 8 | 4 | 1 | 9 | 5 | 7 | 6 | 3 |
| 5 | 4 | 7 | 2 | 8 | 9 | 1 | 3 | 6 |
| 8 | 1 | 2 | 6 | 3 | 4 | 5 | 9 | 7 |
| 6 | 9 | 3 | 5 | 7 | 1 | 8 | 2 | 4 |
| 4 | 3 | 8 | 9 | 1 | 2 | 6 | 7 | 5 |
| 9 | 2 | 1 | 7 | 5 | 6 | 3 | 4 | 8 |
| 7 | 5 | 6 | 8 | 4 | 3 | 2 | 1 | 9 |

hchd
Hansford County Hospital District

Dietary Assistant: Preparing nutritional meals for residents, patients and HCHD employees. Assisting with all aspects of the dietary department.

Information Technology Assistant: Maintain daily system data backups, perform routine desktop backups, add users to domain, monitor AV log reports and/or any assigned duties by the IT Director.

Home Health/Hospice RN: Provide general nursing care to patients in resident setting. Interacts with patients and patient's families, Medical Staff members and other departments of HCHD on a continuous basis.

Great working environment and staff, quality facility providing opportunities for professional growth. Great Benefit package. Apply at 707 S Roland, Spearman, TX or contact Jackie Nelson, HR 806-659-5841. Download application at hchd.net EEOE (7/28/11)

bonds on the forms provided in the Contract Documents. Any bid received after the time and date listed above will be returned unopened and will not be considered.

Bidders are expected to inspect the site of the work and inform themselves regarding all local conditions. A **MANDATORY PREBID CONFERENCE** WILL BE HELD AT 10:30 A.M., **SEPTEMBER 1, 2011 AT CITY HALL, 30 Southwest Court, Spearman, Texas.** Bidders must attend the prebid conference to be eligible to bid.

Contract Documents are on file and may be examined in the office of the City of Spearman, City Hall, 30 SW Court Street, Spearman TX 79081-2649, phone (806) 659-2524.

Plans and Specifications may be obtained from the Engineers, Brandt Engineers, 4537 Canyon Drive, Amarillo, Texas 79110, phone (806) 353-7233 in the following manner:

Cost: One Hundred Dollars (\$100.00), non-refundable, for each set of plans and specifications.

Performance and Payment bonds shall be set forth in the Contract documents.

The Owner reserves the right to reject any or all bids and to waive any informalities in the bidding. In case of ambiguity or lack of clearness, the Owner reserves the right to adopt such interpretations as may be most advantageous or to reject the bid as informal. No bid may be withdrawn until the expiration of 30 days from the bid opening date.

**BRIAN GILLISPIE, MAYOR
CITY OF SPEARMAN, TX
4(8/4/11)B**

PUBLIC NOTICE

North Plains Electric Cooperative, Inc. (NPEC) intends to secure a Certificate of Convenience and Necessity (CCN) amending its certificate to construct a new 69 kV transmission line within Hansford County, Texas. The project will be a radial tap from an existing 69 kV transmission line starting at the intersection of County Road 28 and County Road T to a distribution sub-

station just North of FM 759 that will provide additional distribution capacity within the immediate area and cause the cooperative to lift load growth restrictions presently on four adjacent substations and their feeders. The proposed project will initially shift 2,900 kW of load from Waka Substation that is located in Ochiltree County 7 miles east and 3 miles north of the proposed site and 1,200 kW of load from Sub A located 4 miles east and 7 miles south of the proposed site. Additionally, 3,000 kW of load will be shifted from Spearman Substation that is located 7 miles west and 4 miles north of the proposed substation site. The proposed substation will consist of a new 69/12.47 kV - 10 MVA transformer along with four feeder terminals. A preferred route has been chosen and easements have been obtained due to the limited length of the line.

The proposed transmission line project will be approximately two miles in length. NPEC plans to construct the line with single pole wood structures on all tangent structures and direct burial stressed concrete structures on all angles and dead-end structures. Wood structures were chosen over steel structures because of low capital cost, adequate strength of the line during adverse conditions, and the chosen span lengths. The proposed transmission line will be constructed on new right-of-way consisting of a proposed easement width of 50 feet. The estimated total cost of the project, including transmission line and substation costs, is approximately \$2,200,000.

Landowners along the proposed route may be directly affected. If the preferred route is approved by the Public Utility Commission of Texas (PUC), NPEC will have the right to build a facility which may directly affect your land. The PUC docket will not determine the value of your land or the value of an easement if one is needed by NPEC to build the facility.

A brochure entitled "Landowner and Transmission

Line Cases at the PUC" that provides basic information about how you may participate in the docket when issued and how you may contact the PUC is available at the NPEC headquarters upon request. The brochure includes sample forms for making comments and for making a request to intervene as a party in the docket. In addition to the contacts listed in the brochure, you may call the PUC's Customer Assistance Hotline at (888) 782-8477. Hearing- and speech-impaired individuals with text telephones (TTY) may contact the PUC's Customer Assistance Hotline at (512) 936-7136 or toll free at (800) 735-2989. If you wish to participate in this proceeding by becoming an intervenor, the deadline for intervention in the proceeding is 45 days after the date the application is filed with the PUC, and the PUC should receive a letter from you requesting intervention by that date. NPEC will furnish a letter to all affected landowners and government entities with details of the filing when that filing has been issued a Docket Number.

Mail the request for intervention and 10 copies of the request to:

Public Utilities Commission of Texas
Central Records
Attn: Filing Clerk
1701 N. Congress Ave.
PO Box 13326
Austin, TX 78711-3326
Persons who wish to intervene in the docket must also mail a copy of their request for intervention to all parties in the docket and all persons that have pending motions to intervene, at or before the time the request for intervention is mailed to the PUC.

A copy of the complete application when filed will be available for review at the North Plains Electric Cooperative headquarters located at 14585 North Highway 83, Perryton, TX, 79070. Persons who have questions about the transmission line should contact Randy Mahannah or Bill Carson at 806-435-5482. 2(8/11/11)B

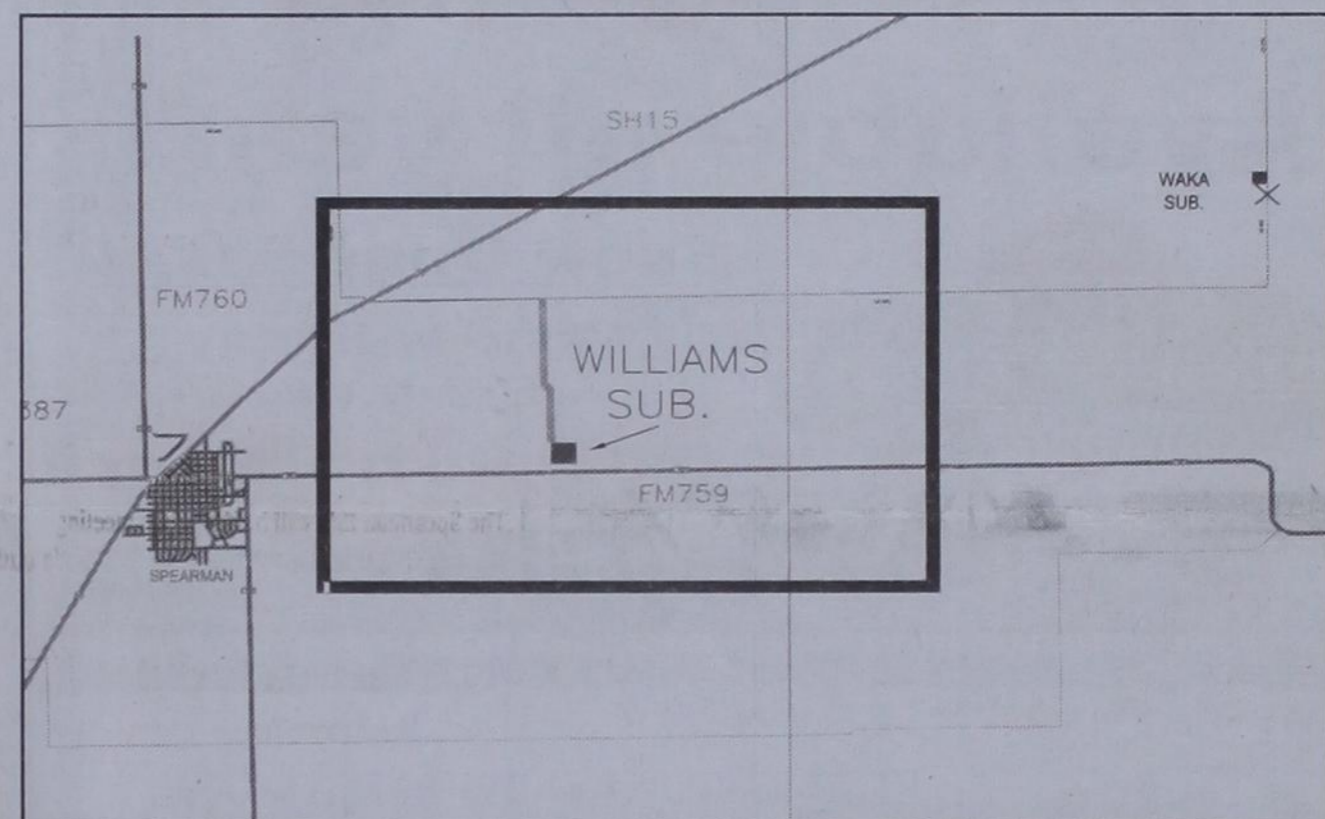

TEXAS STATEWIDE CLASSIFIED ADVERTISING NETWORK
TexSCAN

TexSCAN Week of August 7, 2011

ADOPTIONS
ARE YOU PREGNANT? Considering adoption? Childless married couple seeking to adopt and provide loving home, education and travel. Financial security. Expenses paid. Lisa and Raymond, 1-888-517-0112

DRIVERS
CDL DRIVERS - Relocate for tons of great paying Texas Frac work! Great company/paid benefits. Must have bulk pneumatic trailer experience. Call today! 1-888-880-5918
DRIVER SW REGIONAL lanes. Get home every 7-10 days! No touch freight. Average 2,300 miles/week. Up to 40¢ cpm. CDL-A, 6 months recent experience. 1-800-483-5182; www.LKAM.com
DRIVERS GET MILES & Home weekends. Southwest regional! Top pay/benefits! Paid orientation and training, 6 month OTR and CDL required. 1-800-545-1351; www.cypresstruck.com
DRIVERS - NO EXPERIENCE - No Problem. 100% Paid CDL training. Immediate benefits. 20/10 program. Trainers earn up to 49¢ per mile! CRST VAN EXPEDITED 1-800-326-2778; www.JoinCRST.com
DRIVERS-OWNER OPERATORS and Fleet drivers Texas and Oklahoma with CDL-A. \$3,000 Sign-on bonus! \$1.30 per mile. Return to Texas every 6-8 days. Call 1-800-765-3952
HOUSTON INTERSTATE CARRIER: Regional Owner/Operators and Company drivers; 2 years OTR, usual background and MVR expectations, Fuel surcharge for O/O's. Also interviewing P/T weekend local drivers. 1-888-441-1771
TOP PAY on excellent runs! Marten just raised pay/rates! Regional runs, steady miles, frequent hometime, new equipment. CDL-A, 6 months experience required. EEOE/AAP; 1-866-322-4039 www.Drive4Marten.com

YOU GOT THE drive, we have the direction. OTR drivers, APU Equipped, Pre-Pass, repo just \$17,900 cash price, will consider EZ-pass, Pets / passenger policy. Newer equipment. 100% NO touch. 1-800-528-7825

EDUCATION
HIGH SCHOOL DIPLOMA graduate in 4 weeks! Free brochure! Call now! 1-866-562-3650, ext. 55. www.southeasternHS.com

FINANCIAL
\$500 LOAN SERVICE; No credit refused, fast and secure. Easy on the budget. Payments spread out over three months. Toll free: 1-855-626-4373. LoanHere.com

JOB TRAINING
AIRLINES ARE HIRING Train for high paying aviation career. FAA approved program. Financial aid if qualified, job placement assistance. Call Aviation Institute of Maintenance, 1-877-523-4531

REAL ESTATE
\$106 MONTH BUYS land for RV, MH or cabin. Gated entry, \$690 down, (\$6900/10.91¢/7yr) 90 days same as cash, Guaranteed financing. 1-936-377-3235
ABSOLUTELY THE BEST VIEW Lake Medina/Bandera 1/4 acre tract, central W/S/E, RV/motor home/house, OK only \$830 down \$235 month (12.91¢/10yr), Guaranteed financing, more information call 1-830-460-8354
AFFORDABLE RESORT LIVING on Lake Fork. RV and manufactured housing OK! Guaranteed financing with 10% down. Lots starting as low as \$6900, Call Josh, 1-903-878-7265
10.1 ACRES, Duval County. Mesquite and brush. Deer, hogs, quail. Private roads, locked gate, \$29,500. Toll-free 1-866-286-0199. www.westernexasland.com
NEW MEXICO - New offer lender short sale. Sacrifice, 140 acres just \$59,900. Spellingbird ranch at 6,000 ft elevation. Mature tree cover, beautiful physical characteristics on year-round road with electric. Special financing offered by lender as low as 2.75% fixed. Call NMRS: 1-866-414-0535

HOT DEAL 3 Bedroom, 2 bath repo sale. Bank financing. Call: 1-830-755-4922; RB#33557

WEST TEXAS - Mule deer. Brewster County, 334+ acres, \$88,584. White tail, Terrell County, 240+ acres, shared well, \$84,231. Owner financed, 1-210-734-4009; www.westernexasland.com

RVS FOR SALE
SELL YOUR RV FAST Online at RVT.com. Millions of RV shoppers, thousands of RV's sold, serving RV traders since 1999. www.RVT.com or call 1-888-347-7570

STEEL BUILDINGS
DISPLAY BUILDINGS NEEDED & Steel buildings, 30 yr warranty, 100% usable space -highest wind loads in the industry. Call now! 1-800-991-9251; www.cavalierbuildings.com

TV SERVICES
AT&T U-VERSE for just \$29.99/month! Save when you bundle Internet+Phone+TV and get up to \$300 back! (Select plans). Limited time call now! 1-877-577-4394

Run Your Ad In TexSCAN!
Statewide Ad\$500
301 Newspapers, 942,418 Circulation
North Region Only\$230
98 Newspapers, 263,811 Circulation
South Region Only\$230
101 Newspapers, 366,726 Circulation
West Region Only\$230
102 Newspapers, 311,881 Circulation
To Order: Call this Newspaper direct, or call Texas Press Service at 1-800-749-4793 Today!

Extend your advertising reach with TexSCAN, your Statewide Classified Ad Network.

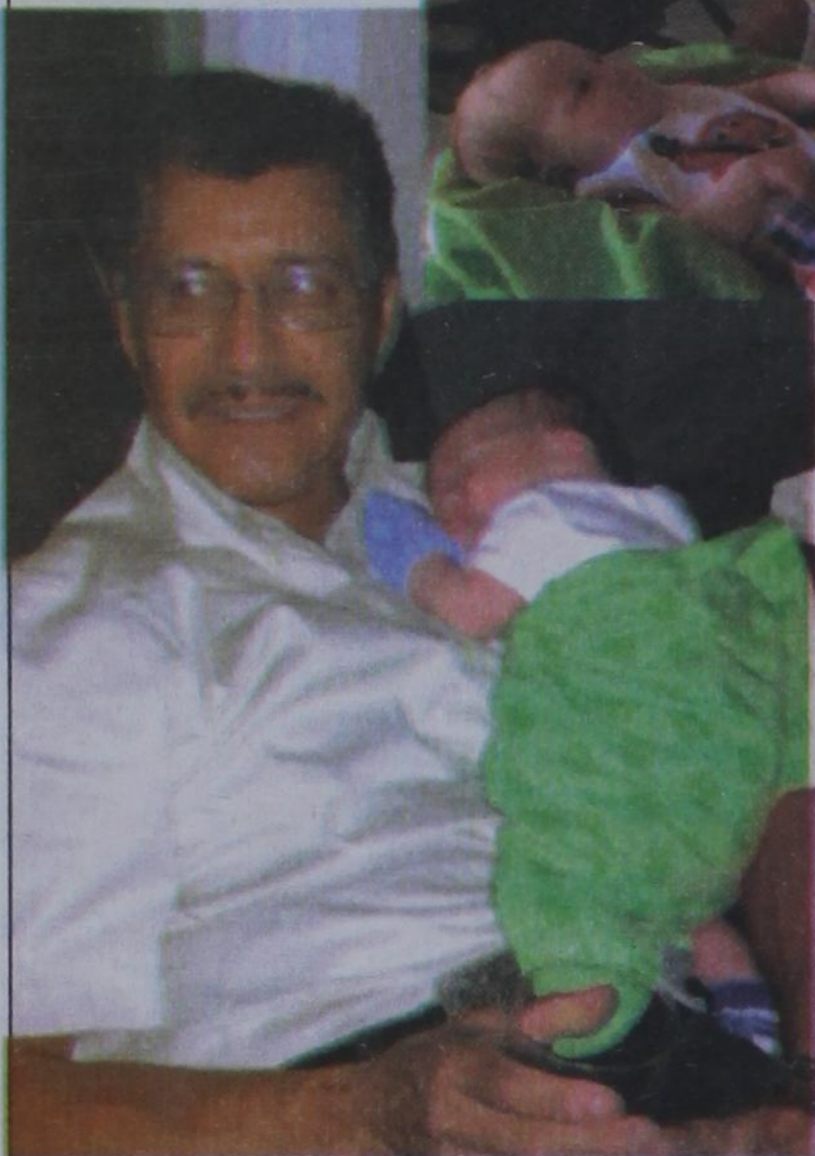

Christina and Aaron Huffaker wish to announce the birth of their son, Nicolas Keith Huffaker Alvarado. Nicolas was born on July 13, 2011 in Amarillo.

Christina y Huffaker Aaron deseo de anunciar el nacimiento de su hijo Nicolás Keith Huffaker Alvarado. Nicolás nació el 13 de julio de 2011 en Amarillo.

by Jim Derington

Out at the Lake

Jim Derington
Palo Duro River Authority
P.O. Box 99
Spearman, TX 79081
806-882-4401
pdra@dishmail.net



A bald eagle in the trees at Palo Duro Lake.

Lake Level--August 8, 2011--36.52 (-0.31)

The drop in the lake level this week was slowed to just under 4 inches by the four rains over the office gauge. Two of them were

just under a quarter of an inch each and the other two raised the total rain to .63 inch.

Mandy Derington had a slight accident last Friday on the office road. Seeing a doe up ahead she slowed, but the deer smacked into the side of the car. However, the doe was able to run off. Jim hasn't seen the doe with the triplets this week, so he is afraid she might be the one with possible injuries.

One of the regular fishermen that come over from Stratford told Jim that he had a good catch of catfish this weekend. There were five of them from 19 to 21 inches long. He had also caught 2 crappie that were too small to be keepers.

On the weekend there was a camper on each side of the dam. Monday morning though two campers had come in.

Cougar in Connecticut
Daughter Nancy Sambaeuw brought me a July 27, 2011 New York Times

story on a wild cougar that had traveled east 1,500 miles from South Dakota to Connecticut. This trip was over two times the longest dispersal period for cougars ever recorded.

As the presence of a mountain lion in Connecticut had not been recorded for over a 100 years, the first reports of one being seen were dismissed. When an S.U.V. struck and killed a cougar June 11, 2011 on the Wilbur Cross Parkway in Milford, Conn., there was no doubt that the stories were true. A necropsy on the cat found from the DNA that the lion matched the cougar population of the Black Hills in South Dakota. It also matched with DNA from the scat of a lion that had been tracked across Minnesota and Wisconsin in 2009 and 2010.

The travels of a young lion are a familiar pattern called dispersal in which young males look for mates. But they seldom travel more than 100 miles.

2011 Property Tax Rates in City of Spearman

This notice concerns the 2011 property tax rates for City of Spearman. It presents information about three tax rates. Last year's tax rate is the actual tax rate the taxing unit used to determine property taxes last year. This year's effective tax rate would impose the same total taxes as last year if you compare properties taxed in both years. This year's rollback tax rate is the highest tax rate the taxing unit can set before taxpayers start rollback procedures. In each case these rates are found by dividing the total amount of taxes by the tax base (the total value of taxable property) with adjustments as required by state law. The rates are given per \$100 of property value.

Last year's tax rate:

| | |
|-----------------------------|------------------|
| Last year's operating taxes | \$385,828 |
| Last year's debt taxes | \$0 |
| Last year's total taxes | \$385,828 |
| Last year's tax base | \$72,660,640 |
| Last year's total tax rate | \$0.531000/\$100 |

This year's effective tax rate:

| | |
|--|------------------|
| Last year's adjusted taxes (after subtracting taxes on lost property) | \$384,087 |
| + This year's adjusted tax base (after subtracting value of new property) | \$72,435,036 |
| = This year's effective tax rate | \$0.530250/\$100 |

(Maximum rate unless unit publishes notices and holds hearings.)

This year's rollback tax rate:

| | |
|--|------------------|
| Last year's adjusted operating taxes (after subtracting taxes on lost property and adjusting for any transferred function, tax increment financing, state criminal justice mandate, and/or enhanced indigent healthcare expenditures) | \$502,136 |
| + This year's adjusted tax base | \$72,435,036 |
| = This year's effective operating rate | \$0.693223/\$100 |
| x 1.08 = this year's maximum operating rate | \$0.748680/\$100 |
| + This year's debt rate | \$0.000000/\$100 |
| = This year's total rollback rate | \$0.748680/\$100 |
| - Sales tax adjustment rate | \$0.160699/\$100 |
| = Rollback tax rate | \$0.587981/\$100 |

Statement of Increase/Decrease

If City of Spearman adopts a 2011 tax rate equal to the effective tax rate of \$0.530250 per \$100 of value, taxes would increase compared to 2010 taxes by \$3,694.

Schedule A - Unencumbered Fund Balance

The following estimated balances will be left in the unit's property tax accounts at the end of the fiscal year. These balances are not encumbered by a corresponding debt obligation.

| | |
|---------------------------|---------|
| Type of Property Tax Fund | Balance |
| Maintenance & Operations | 473,353 |

Schedule C - Expected Revenue from Additional Sales Tax

In calculating its effective and rollback tax rates, the unit estimated that it will receive \$118,049 in additional sales and use tax revenues.

This notice contains a summary of actual effective and rollback tax rates' calculations. You can inspect a copy of the full calculations at 709 W 7th Ave Spearman, TX.
Name of person preparing this notice: Sonya Shieldknight
Title: Chief Appraiser
Date Prepared: 08/05/2011

The **Jays** of Summer
Available all year!

SNOW CONE STAND
Monday-Friday
2-8 p.m.
MURMUR'S CAFE
100 S. Roland - Spearman
659-3580

PTCI® LIFELINE SERVICE, LINK-UP PROGRAM, AND UNIVERSAL SERVICES

PTCI
Communication & Broadband Solutions

Lifeline Service is a program designed to make basic telephone service available at reduced rates to eligible residential customers. Customers' eligibility to receive the discount must be renewed annually. Link-Up is a program designed to offer eligible residential customers a reduction in installation charges for telephone service equal to one-half of the service connection charges or \$30.00, whichever is less.

Who Qualifies?
To be eligible for Lifeline and Linkup, a customer's annual household income must be at or below 150% of the federal poverty guidelines, or a customer must receive benefits from or have a child in the household who receives benefits from at least one of the following programs:

- * Federal Public Housing Assistance/Section 8
- * Supplemental Nutrition Assistance Program (SNAP a/k/a Food Stamps)
- * Medicaid
- * Low Income Home Energy Assistance Program (LIHEAP)
- * Supplemental Security Income (SSI)
- * Children's Health Insurance Program (CHIPs)

You will save up to \$13.50 on your monthly local telephone bill. These benefits apply to your local telephone service charges that you purchase as a flat rate service. These benefits will also cover your subscriber line charge.

Lifeline customers can also subscribe to optional services at the same rate offered to other customers.

What Universal Services are available to all customers? Universal Services are offered to all customers of PTCI®. Universal Services available include:

- * Voice grade access to the public switched network
- * Unlimited local calling (used to say "Local Usage")
- * Dual tone multi-frequency signaling or its functional equivalent
- * Single-party service or its functional equivalent
- * Access to emergency services
- * Access to operator services
- * Access to interexchange services
- * Access to directory assistance
- * Toll limitation for qualifying low-income consumers

Unlimited local calling is \$17.50 for residential service and \$29.99 for businesses. Emergency 911 service fee is \$0.50 per line.

Lifeline Texas plan benefits are only applicable on one phone line at the customer's principal place of residence. The Lifeline discount applies only to the residential basic exchange access line. The discount does not apply to optional services, long distance, connection charges, taxes, or other miscellaneous charges. The Lifeline discount is not available on a retroactive basis. Only the State of Texas or its vendors can approve a customer's eligibility.

How do Telephone Customers and Applicants for Telephone Service Apply for Lifeline and Link-Up Programs? Customers may request enrollment forms from the PTCI® business office.

How to Apply for Telephone Service? If you do not have telephone service and wish to obtain telephone service and you are in the PTCI® service areas, or if you have telephone service and you move and you qualify for the Link-Up Program and you are in the PTCI® service areas, please call our office number 1-800-562-2556 or 580-338-2556, and we will be glad to assist you.

Additional information may be obtained by contacting the Low-Income Discount Administrator (LIDA) at 1-866-454-8487 (1-866-4-LITE-UP).

1-800-562-2556 222 S. Amherst - Perryton 721 W 7th - Spearman
www.ptci.net

PTCI® Panhandle Telecommunication Systems, Inc.