



**CLEAN-UP WEEK CHAIRMAN KEITH AULDS**  
...looks at example of job facing volunteers Saturday.

# IOWA PARK LEADER

VOL. X, NO.35

THURSDAY, MAY 3, 1979

IOWA PARK, WICHITA COUNTY, TEXAS 76367

**20 CENTS**

## Saturday to climax Clean-Up Week

Saturday will be the climax of Iowa Park's annual Clean Up Week. Through the week, all property owners have been encouraged by the Chamber of Commerce and City to clean up debris around their homes and businesses, in the alleys, and vacant property.

Organizations and individuals are being asked to contribute their time Saturday to help pick up trash along roadsides and in parks.

Workers are being asked to meet at the Chamber of Commerce office at 8:30 a.m. Saturday, from where they will be directed to areas of responsibility.

Keith Aulds is chairman of this year's Clean Up Week.

The Chamber will be serving refreshments to all workers Saturday.

Aulds says he hopes to have the work. Residents who have items too large to be placed in trash containers are encouraged to contact the Chamber office, 592-5441, and a city truck will

be dispatched to pick it up.

The city, as has been the practice the past number of years, will hold the sanitary landfill open all day Saturday, where residents can haul their own debris. No fee will be charged that day.

The sanitary landfill is east of the dam at Buffalo Lake, and can be reached by entering the lake area from

the east side. Signs mark the landfill location route.

"I hope we can have a good turnout Saturday," commented Aulds. "We need to get the trash picked up in the ditches and in the parks before the weeds get too high. We've always had good participation on this project in the past because Iowa Park people are proud of their community, and how it looks to visitors."

## Burglaries increase

Incidents of burglary have jumped, according to Iowa Park police reports.

Police investigated a report Monday that a burglar had broken into a home at 809 N. Jackson.

Police received a report Saturday from Bill James, who said salvage title car receipts had been taken from a

wrecker parked at 100 S. Wall.

Charlie Helms reported the theft of gasoline Friday at the city barn, where someone broke the back of a gas tank and stole the fuel.

On the same day Andy Arrington, 1107 N. Second, reported the theft of a water pump and electric motor.

Last Thursday police received a report from Lawrence Wedel, 1023 Foley, who said the hubcaps had been stolen from his car parked in front of his residence.

Police received a report around midnight last Wednesday from Curtis Wheeler, 109 James, who came home to discover his front door open and the kitchen window and screen removed. Police said nothing appeared to have been stolen in the burglary.

On Monday night police investigated two apparent domestic disputes, although no charges were filed in either case, police said.

## Fuller, Crittenden qualify for state

Hawk senior discus hurler Kip Fuller will be returning to the state track meet for the third time in his high school career, and just like last year, he'll have company.

### School trustees to meet Tuesday

Iowa Park school trustees will hold their regular monthly board meeting at 7 p.m. Tuesday in the administration building.

Other than regular reports, items on the agenda will likely be: discuss insurance on hail damage at Valley View and tax building; discuss converting the track to metric distances; discuss gym construction; dirt for football fields and other areas; discuss sale of Building Trades house; and budget amendments.

The husky Fuller placed second at the Region I meet in Odessa Saturday, as did miler Anthony Crittenden. The state meet will be Friday night of next week, in Memorial Stadium on the campus of the University of Texas at Austin.

The third athlete from Iowa Park competing at Odessa was high jumper Dennis Dillard. He had trouble adjusting to the approach area, and couldn't get any higher than 5-10, far below his normal for the season.

Fuller, though disappointed he couldn't beat Sweetwater's entry, had a good day in the circle. His throws all ranged from 166 feet to his best toss of 172-2.

The Hawk strongman was also standing third in the shot put, but was disqualified along with two other athletes in the event after a protest was lodged about their uniforms. His 54-foot toss would have stood him third had he not been disqualified.

Crittenden ran his second best time of the year, 4:29.34, but was second to Burkburnett's Andrew Daniels, who turned in a 4:25.8 clocking.

This will be Crittenden's first time in the state AAA championship meet, but Daniels was there last year, though he failed to place.

Coach Jim Arnold said Crittenden is working hard for the Austin trip, experiencing his two best workouts of the entire year early this week. He said the senior miler is feeling good and feels he can do quite a bit better at

### Local business place is sold

Ownership of one food establishment and management of two others were changed this week in Iowa Park.

Michael D's Pizza has been sold to Ken's Pizza, owned by Richard Hasley of Oklahoma City. Following remodeling work, the business will be re-opened May 15.

Nearest Ken's Pizza is located at Burkburnett.

Raymond Copening, who has been manager of Iowa Park Dairy Queen for a number of years, has been named manager of Harvey's Hamburgers, Everett Boulware, owner, announced.

Copenig has been replaced at the Dairy Queen by Jim Smith of Wichita Falls.

### Lions to hold broom sale

Members of the Noon Lions Club will hold their annual broom and mop sale Saturday, from 8 a.m. to 6 p.m. in the parking lot at Park West Shopping Center.

According to John Sibley, project chairman, a full display of all household items to be sold will be at the sales site.

All items, from brooms and mops to brushes, pot holders and doormats, to list a few, are hand made by Lighthouses for the Blind of Texas.



**DISCUS THROWER KIP FULLER**  
...returning third time to state.

## April good month for construction

Two new homes helped boost the building permits for April over the \$100,000 mark, according to figures reported by the city hall.

April permits were \$104,112, which gave the year's total \$379,057.

After an early slump in the winter, permits are now running at about the same levels of 1977 and 1976, but are

only slightly more than half of this time last year.

The four-month total for 1978 was \$628,385; 1977 was \$384,322; and 1976 figure for the same period was \$327,210.

Permits issued during April were: Grace Baptist Church, 509 S. Colorado, alteration, \$12,000; Mando Trejo, 918 Foley, conversion, \$3,512;

George Roy Sr., 410 W. Bank, general repair, \$1,000; Edward Anderson, 1329 Sunset, storage building, \$400;

Glen Durham, 606 W. Cornelia, boat shed, \$50;

Ralph Beall, 822 N. Park, addition, \$4,250;

Dennis Roach, 300 S. Victoria, addition, \$8,000;

Rip Smith, 46 Surrey, new residence, \$39,900;

Phil McDonald, 14 Surrey, new residence, \$35,000.

### Weather Report

Weather reports are officially compiled for Iowa Park at the Texas Experiment Station, southeast of town.

Rainfall for week	.26
Total for month	.26
Total for year	9.61
Total last year	5.84

### Choirs set concerts

Iowa Park high school and junior high school choirs have spring concerts scheduled today and next Thursday.

The junior high choir's spring concert is slated for 7:30 p.m. today in the high school auditorium.

The high school acapella choir's spring concert will be at 7:30 p.m. May 10.

Admission for each event will be \$1 for adults and 50-cents for students. Both concerts will include selections of pop and religious music.

### Purchases proposed for called meeting

A called meeting of the Iowa Park city council will be held at 7 p.m. Monday in council chambers.

On the agenda will be three proposals for purchases:

\* Request permission to purchase

60, three-cubic yard trash containers;

\* Request bids on backhoe for water and sewer department;

\* Request authorization for four-band radio for civil defense coordinator.

Join your neighbors  
working in Iowa Park's

Clean  
Up  
Week





# 30th anniversary observed by Epsilon Eta Chapter

Epsilon Eta chapter of Epsilon Sigma Alpha celebrated its 30th anniversary Saturday afternoon in the Fellowship Hall of First Christian Church. The theme of the affair was "Those Were the Days".

Those who attended the celebration included out-of-town guests, charter members, members at large, active and inactive members.

Scrapbooks, histories and pictures taken during the years were on display. An anniversary cake baked by Mrs. Richard Hicks, one of the newest members, was served during the afternoon.

Committee chairmen in charge of arrangements were Mmes. Buster Reaves, name tags; Jim Dyer, registration; Allen Gilstrap and Frank Harlin, refreshments; Raymond Cope, invitations; Charles Dudley, entertainment; and Luther Shaw, place.

Epsilon Eta chapter No. 1094 of Epsilon Sigma Alpha was chartered April 30, 1949 with 20 members. These were Ardith Bell, Claydean Bell, Raydean Brown Mattis, Ferne Corder, Jane Gauntt, Frances George, Edna Ruth Good, Annie Lee Hill, Roberta Hill, Mary Ellen Johnson, Sue Jones, Kay Kildow, Bonnie Metz Medlinger, Maye Mitchell (first president), Mary Miles Mixon, Mary Ann Shook, Ela Simmons, Audra Tanner, Mildred Traylor and Martha Zeck.

Through the efforts of an ESA representative and Mrs. Audra Tanner, the chapter was formed in Iowa Park. The late F.E. Hill, president of State National Bank, provided the directors' room for the meeting place.

The chapter began to build immediately on the foundation of self-improvement and service to others and that has been the goal through its existence. The chapter has also kept in mind the three-fold purpose of ESA International, that is celebrating the 50th anniversary this year: education, social and service.

Epsilon Eta programs have been varied and have included personality, fashions, foreign countries, famous women, arts and crafts, cake decorating, foods, State of Texas, self-protection, cancer, birth defects, child abuse and many others suiting the choice of the education director for the year.

The service projects have been many and varied, reaching from local to district, state and national participation. Some of these include contributions to an iron lung and respirator station for a nursing home, sponsoring and participation in door-to-door drives for March of Dimes, Heart Fund, United Way and assisting with local visits of Red Cross Bloodmobile.

The current projects include responsibility of the local Jerry Lewis Telethon and Easter Seal Telethon for North Texas Rehabilitation Center. Epsilon Eta has also held bike rides for St. Jude Research Children's Hospital in Memphis, Tenn. for the past six years.

Many of the projects have benefited Iowa Park to the extent that when people are looking for an organization that will see a good will done, their thoughts turn easily and naturally to ESA. Some of their most outstanding projects have been providing tables, benches and revamping the City Park during the chapter's early years; having



CHARTER MEMBERS of Epsilon Eta chapter organized in April, 1949. Seated on floor in front of table, Maye Mitchell, first president, unidentified visitor who installed officers, Bonnie Metz Medlinger; seated behind table, Mildred Traylor, Annie Lee Hill; back row, Claydean Bell, Mary Miles Mixon, Mary Ellen Johnson, Audra Tanner, Ela Simmons, Martha Zeck, Raydean Brown Mattis, Roberta Hill, Ferne Corder, Jane Gauntt, Frances George, Edna Ruth Good, Kay Kildow and Mary Ann Shook.

Mixon, Mary Ellen Johnson, Audra Tanner, Ela Simmons, Martha Zeck, Raydean Brown Mattis, Roberta Hill, Ferne Corder, Jane Gauntt, Frances George, Edna Ruth Good, Kay Kildow and Mary Ann Shook.

**1/2 Price Sale**  
your choice  
**19.99** reg. 39.99

Diamond earrings set in 14 kt. gold, 15" chains

**Louis' Distinctive Jewelry**  
408 W. Park 592-5942

QUALITY IN EVERY DETAIL  
**MAGNAVOX**  
VALUE-PRICED  
COLOR TV

This fine MAGNAVOX Console...

- AUTOMATIC FINE TUNING
- ADVANCED 100% SOLID-STATE CHASSIS
- 100" IN-LINE PICTURE TUBE
- FINER FURNITURE STYLING

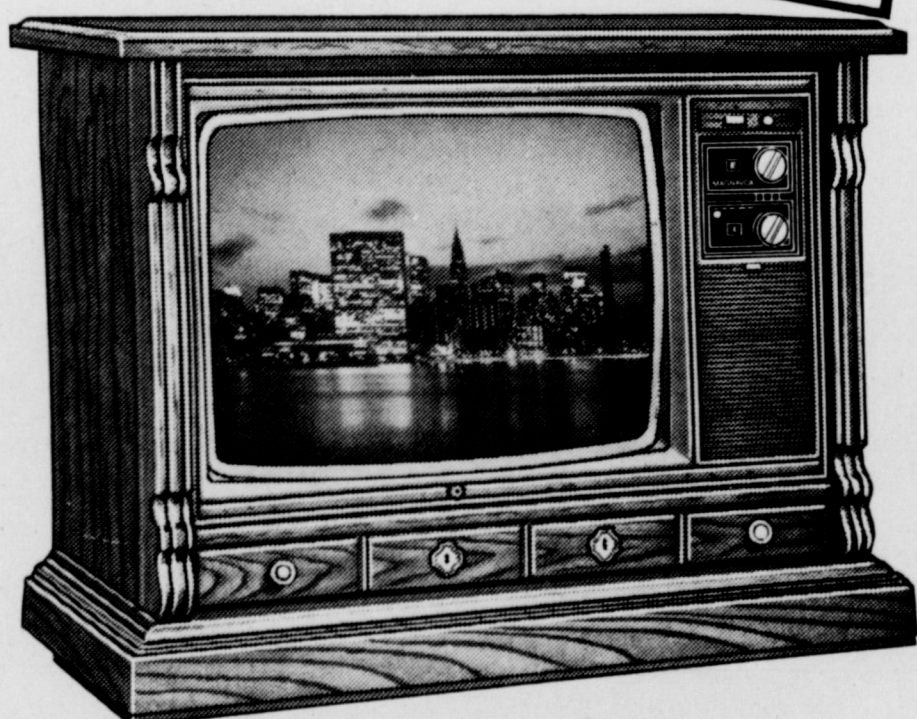

Model 4526 — Mediterranean styling with 25" diagonal screen — offers you fine furniture craftsmanship and outstanding viewing at a budget-pleasing price.

**\$479<sup>95</sup>**

will bring you accurately tuned color pictures on any channel

This value-priced Magnavox offers you hours of viewing pleasure, and will let you watch your favorite programs in beautiful life-like color. Special circuitry "locks-in" station signals to bring you accurately tuned pictures on UHF or VHF channels. Other features include a highly reliable 100% solid-state chassis, a precision in-line picture tube and electronic voltage regulation to provide stable operating conditions — even in "brownout" situations.

**MAGNAVOX**  
QUALITY IN EVERY DETAIL

**PARKWAY**  
FURNITURE *True Value* HARDWARE

592-5512 200-206 West Bank 592-4681



STEVE LANE and DEE LYNN SMITH

## Garden wedding planned

The betrothal of Miss Dee Lynn Smith and Steve Lane is being released today by the young lady's parents, Mr. and Mrs. Rip Smith. A garden wedding August 18 is

being planned by the couple. Parents of the groom-elect are Mr. and Mrs. Frederick D. Lane.

Miss Smith and her fiancé were both graduated from

the first concession stand at the Little League baseball games. The latter project was handled by members serving from the back of pickups or cars until the late Bill Burnett built a concession stand at Burnett Field.

The city parks have been of special interest to the sorority since its inception. Putting special interest on Pace Park in recent years where they built two tennis courts, the chapter member report that the lights at the courts are now ready to be mounted and they have plans to add to the playground equipment they have already placed in the park.

Continuing the list of projects, Epsilon Eta sponsored the first Blue Bird group in Iowa Park and continued with the girls through Camp Fire. They sponsored a girl through nursing school, built gates at Highland Cemetery, furnished some shelves for the Iowa Park Library, and provided tables for the Youth Center

and city parks.

Epsilon Eta contributed \$2,000 to the Bicentennial Swimming Pool and sponsors the Outstanding Youth award for junior high school students each year.

Many of the members have served as president of District VI and held other responsible offices in the district and state. The fun times have included participating in volleyball and basketball games, Lion Club shows, school and city parades.

During the reunion Saturday, members recalled with pride how the chapter had been able to touch and enrich many lives through the years and pledged themselves to continue their efforts through love for the sisterhood and its goals to achieve happiness by making others happy.



TAMARA THOMPSON and FRANK TROTTER

CINDY and MICHAEL JORDAN

Park Pharmacy  
115 W. Park

flowers for Mother. . . .



Mother's Day Arrangements

Corsage or Vase

from **8<sup>50</sup>**

Orchid **4<sup>95</sup>**

**Petal Pushers**  
flower & gift shop

592-2641  
309 N. Wall

Buy Now and Save Big!

**RCA**  
END-OF-MODEL-YEAR

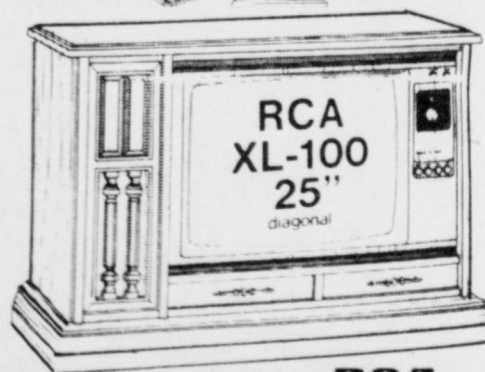

RCA GC748

RCA 25" diagonal XL-100 color TV with 100% solid state XtendedLife chassis and SignalLock electronic tuning. Colonial Pine and Maple also available.

**\$599<sup>95</sup>**

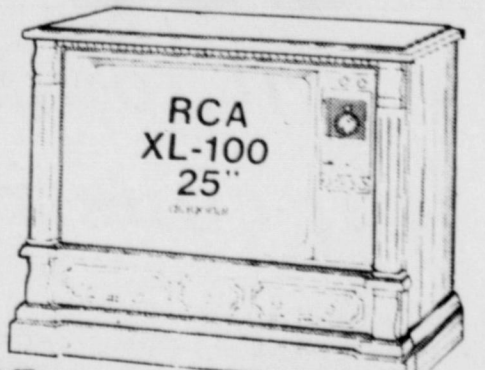

RCA GC688

Save on this 25" diagonal RCA XL-100 Color Console with electronic tuning. Colonial Pine and Maple also available.

**\$599<sup>95</sup>**

IOWA PARK  
**WHITES** Home & Auto  
Park West Shopping Center 592-4186



# Cook of the Week



Shower  
Selections  
For:

TAMARA THOMPSON  
and  
FRANK TROTTER

Parkway  
True Value

200 - 206 W. Bank

Laura (Mrs. Gerard) Raymond is one of the many cooks that appreciate casserole dishes and refrigerator desserts and consider them a boon to working homemakers. Her Easy Casserole recipe sounds like it is not only easy but nutritive as well. The ingredients are beef, corn, potatoes, butter and seasonings.

Corn is one of the most popular and versatile foods today. It is typically American and is surrounded by mystery and legend. The Indians believed it to be the gift of the Great Spirit. It grew wild in the highlands of southern Mexico and the pre-Columbian Indians "tamed" it and brought it north where

it now satisfies the most cultivated taste.

In considering the popularity of corn today it is interesting to know that the ladies of the 18th century French, La. once staged a "petticoat" rebellion because they ate too much of it. They were accustomed to fancier meals they had back home in France.

The Raymonds moved to Iowa Park from Guam three years ago. He has retired from the Air Force and works as supervisor for Flake Industries. A native of Omaha, Neb., Mrs. Raymond finished high school there and worked for the First National Bank in that city before her marriage. She is currently

employed as a nurses' aide at Wood Convalescent Center. She enjoys bowling and watching baseball.

The couple's children are Joe, who works for Truman's Auto Parts, Terri, a high school junior, and Mike, a freshman. Their faith is Catholic. During the years in the Air Force the family lived in Hawaii, Goose Bay, Labrador and Guam.

## EASY CASSEROLE

1-1/2 lbs. ground beef  
1 large can cream style corn  
8-9 potatoes

1/4 cup butter or margarine  
Brown ground beef in pan. Pour off grease. Prepare potatoes into mashed. Butter bottom of medium size casserole dish. Place ground beef in bottom of dish, then corn and place potatoes on top. Dot with pieces of butter. Bake in 350 degree oven for 30 minutes or until light brown on top. Serves 4-5.

## ICE BOX CAKE

2 boxes vanilla pudding (instant or regular)  
2 boxes chocolate pudding (instant or regular)  
10-12 marachino cherries  
10-15 graham crackers

Prepare puddings as directed on boxes. Set aside. Place one layer of whole graham crackers side by side in approximately 5x8 oblong dish. Pour chocolate pudding on top. Arrange another layer of the crackers on chocolate pudding and top with vanilla pudding mix. Garnish with cherries. Chill. Serves 6.

## YANKEE POTATO SALAD

10-15 medium potatoes  
6-8 eggs  
2 T relish  
1 medium onion  
1/2 cup mayonnaise or preferred salad dressing  
2 T vinegar  
Salt, pepper, celery salt to taste  
2 T mustard  
2 T milk  
Peel potatoes and cube. Boil until tender. Hard boil the eggs. Chop up onions. Mix potatoes, onion and chopped eggs in medium size casserole dish. Sprinkle with salt, pepper, garlic salt and vinegar and set aside. Mix mayonnaise, mustard and milk in small bowl, then pour into potato mixture. Toss until well coated. Garnish with paprika and pickles if desired.

## EASY CHILI

1-1/2 lbs. ground beef  
2 large cans tomatoes  
2 large cans tomato sauce  
2 large cans dark kidney



Mrs. Gerard Raymond

beans  
Chili powder, salt and pepper to taste

Brown ground beef in large pan; pour off grease. Add tomatoes, tomato sauce and kidney beans. Season with chili powder, salt and pepper. Simmer 30-45 minutes. Serves 6-7.

## LASAGNE

1-1/2 lbs. ground beef  
2 large cans tomato sauce  
2 large cans tomato paste  
1 box lasagne noodles  
1 pkg. mozzarella cheese  
Salt, pepper and garlic salt to taste  
Small amount of Parmesan

cheese  
Brown ground beef in large sauce pan, pour off grease. Add tomato paste, tomato sauce, salt, pepper, garlic salt and small amount of water. Simmer one hour, stirring occasionally. In the meantime, prepare lasagne noodles as directed on package. Line a 5x8 baking dish with layer of noodles, pour on sauce. Put on strips of cheese. Continue layering until baking dish is full, then finish last layer with tomato sauce mixture. Sprinkle with cheese. Bake in 350 degree oven until bubbly on top. Serves 4-5.

The first stewardess, Ellen Church, carried baggage, helped pull the airplane out of the hangar, cleaned the plane's interior and refueled it.

## Singleton T.V.

Sales & Service

505 W. Hiway

592-5552

Specially Priced



Limited Quantities

Special

12" Black & White

\$79.95

We have  
Weather Alert Radios

Prices start at \$24.95

Bargains on Used T.V.s

## Proclamation Of Epsilon Sigma Alpha Week

Whereas, Epsilon Sigma Alpha was founded in 1929, the first non-collegiate sorority in America, as an organization in which women could learn, grow and serve together; and

Whereas, Epsilon Sigma Alpha this year is observing its fiftieth anniversary as a sorority of service and education, now with membership in seven countries encompassing 33,000 women; and

Whereas, the women of Epsilon Sigma Alpha are continually working together to aid the handicapped and meet community needs while engaged in a full program of education, leadership training and social activities; and

Whereas, Epsilon Sigma Alpha has achieved a position of high esteem for providing hope, assistance and answers in areas of need; and

Whereas, Such important contributions made by Epsilon Sigma Alpha have become an integral part of our communities;

Now, therefore, I, Johnny Crawford, Mayor of the city of Iowa Park, Texas, do hereby declare the week of May 1-7, 1979, as Epsilon Sigma Alpha Fiftieth Anniversary Week, and do urge all citizens to join me in commending the good works of this organization and its service to our community.

In Witness Whereof, I have hereunto set my hand and caused the Seal of the City of Iowa Park to be affixed on this 1st day of May, 1979.

## Microwave Cooking School

See What A Microwave  
Can Do For You  
... And Taste The Results!!!

LITTON  
Microwave Cooking



A Litton Microwave Oven Specialist  
will be on hand to demonstrate the  
time and energy saving features of  
Litton microwave cooking!

Date: Tuesday, May 8

Time: 7:30 p.m.

Place: Iowa Park Whites Home & Auto

Bring your friends and learn how easy it is to cook a variety of foods  
on Litton Microwave Ovens... and taste the results yourself!

IOWA PARK

**WHITES** Home  
& Auto

Park West Shopping Center

592-4186

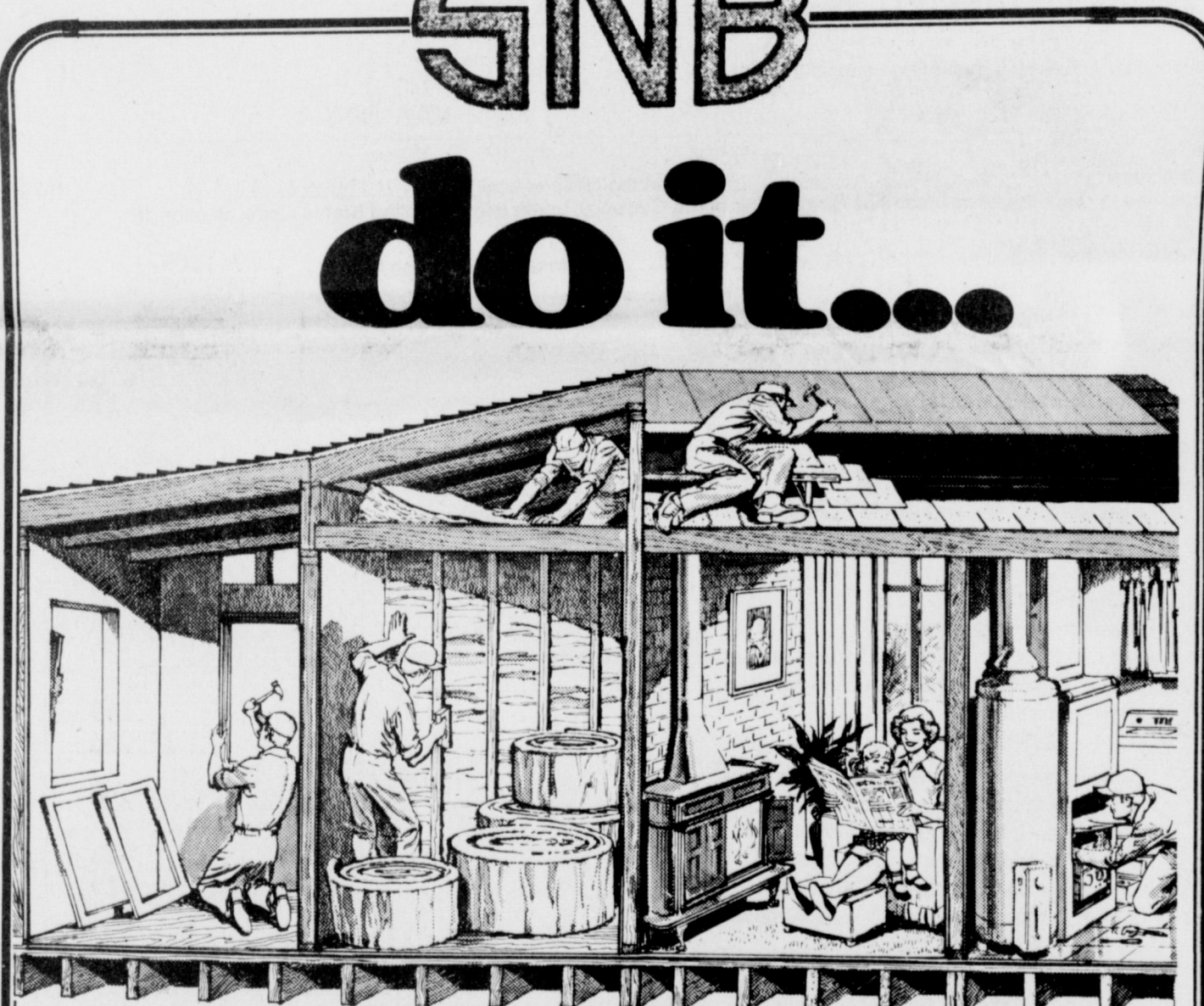

# do it... with us!

No energy wasted here. If you're concerned with the energy problem ... and your own rising fuel bills ... and want to do something about it, we'll fix you up with an Energy Saving Loan! On approval, you'll have the cash you need to make energy saving home improvements or repairs. And here's the good part. Just think, you'll be saving energy and saving on your fuel bills. So don't waste another second ... see us right away!

Locally Owned

## OFFICERS

Stanley Williamson, President & Chairman  
of the Board  
H.M. Nipper, Executive Vice President  
Robert Hill, Vice President and Cashier  
David Parkey, Senior Vice President  
Bert Williamson, Assistant Vice President  
Jean Hopkins, Assistant Cashier  
Janis Latimer, Assistant Cashier

## DIRECTORS

Fred Dwyer - Farmer-Rancher  
O.N. Newman - Attorney  
Fred Parkey - Mgr. Red River Water Authority  
Luther F. Shaw - Automobile Dealer  
W.R. Steger - IPCISD Tax Assessor/Collector  
Stanley Williamson - Farmer, Rancher, Banker

**GNB**

**STATE NATIONAL BANK**  
IOWA PARK, TEXAS  
Member F.D.I.C.



### Band Boosters slate meeting

The Band Booster Club will meet Tuesday at 7:30 p.m. in the high school band hall.

New officers for the 1979-80 school year will be install-

ed. Projects to be paid for from money earned this year will be voted on. Reports on the band's trip to Greater Southwest Music Festival in Amarillo will be given.



### Summer Classes Now Enrolling

to include

**Jazz, Disco and  
Baton Twirling.  
Also Modeling.**

For information  
call 592-2431,  
322-3816, 766-1258

Introducing  
**KAREN  
GAUTHIER**  
New Instructor

**404 1/2 West Park  
Park West Shopping Center**

**Iowa Park School of Dance**  
Tammy Joyce, Owner



**PEOPLE'S CHOICE** - Mrs. Michael Hodson's entry in the Iowa Park Garden Club's annual flower show Friday earned her a silver tray prize. Second place winners were Mmes. David Parkey, Frank Harlin and Charlie Lee. Mrs. Myrl Cabe placed third.

### LOOK WHO'S NEW

Shelly Dianne, a five-pound, two-ounce daughter, was born to Mr. and Mrs. Bob Evans April 27th. Mrs. Evans is the former Carolyn Chesser.

Grandparents are Mr. and Mrs. Cornell Evans of Wichita Falls and Mr. and Mrs. Earl Chesser of Iowa Park. The great-grandmothers are Mrs. C.C. Morris and Mrs. J.E. Evans of Wichita Falls and Mrs. Mamie Chesser of Iowa Park.

### ESA plans Hold-Up

Plans were finalized for the CB Hold-Up Saturday during the Tuesday evening meeting of Epsilon Eta chapter of Epsilon Sigma Alpha in the home of Mrs. Bill Hrnckrik with Marty Maxwell serving as co-hostess.

The CB Hold-Up, which is a fund-raising project for St. Jude's Children Hospital will be held at the rest stop on Highway 287 beginning at noon. To signa. the start, chapter members will release 500 helium-filled yellow balloons with ESA printed on each one. The releasing of the balloons will be an effort supported by other chapters in the state commemorating

the 50th anniversary of ESA. Mrs. Charles Dudley presented the program on "The Beginning Life of ESA".

Announcement was made that the annual banquet will be held May 29 at the Trade Winds Bounty Room and that Epsilon Eta would host the District VI meeting in June. Sixteen members were in attendance.

### New Meter Connections

Eddy Dickerson - 302 W. Emerald  
Pam Widders - 707 W. Jackson  
Jim Franklin - 1327 Edgehill Trail  
Larry Knightstep - 812 Vogel  
Marion Criswell - 317 S. Wall  
Ethel M. Griffin - 510 E. Alameda  
Bobby Hodges - 704 N. Wall  
Mike McGuire - 1205 S. Wall  
Jack Stafford - 412 W. Washington  
Johnnie Johnson - 621 W. Washington  
Ralph McCann - 1006 Louisa  
David B. Voyles - 618 W. Louisa

### Day camp dates set

Mrs. William Proctor from Wichita Falls Camp Fire office attended the

meeting of the Camp Fire Leaders Association of Iowa Park Thursday.

She distributed prizes to the leaders for the candy sale and gave a report on Day Camp which will be held at Harrell Park in three one-week sessions beginning June 11.

Mrs. Jimmy Chaffin presided over the business meeting. Final plans were made for the Father-Daughter banquet. Announcement was made of the Art Show and Fun Day to be held May 5 at 11 a.m. at the Recreation Activities Center for all Iowa Park Camp Fire Girls and Blue Birds.

### TOPS, KOPS name queens

Mrs. Lloyd Lowe was named KOPS Queen and Mrs. Randy Heidrich was named TOPS Queen Monday night at the TOPS Club meeting.

Mrs. Don Wynn gave a reading on "Be a Good Loser" for the program.

Mrs. Robert English conducted the business when it was voted to make a monetary love gift to the area supervisor who lost her home in the April 10 tornado. Members drew names for secret pals.

Twelve members weighed in.

### Municipal Court Records

Results of municipal court held here last Thursday were:

Armando Baeza, public intoxication, \$28.50;  
Randy Rohrbough, public intoxication, \$28.50;  
Larry Gene Ayres, disobey stop sign, \$28.50;  
Jeffrey D. Clifton, operating vehicle wrong way on a one-way street, \$28.50;  
Michael Roy Feltman, negligent collision, \$28.50;  
Jeff Doyle Posey, no driver's license, \$28.50;  
John Edward Routh, speeding, \$40.50.

### COUNTER TOPPING

FORMICA WILSON-ART MICARTA  
"BUY FROM THE OLD PRO"  
T.S. THOMAS, CABINETMAKER  
1516 Beverly Wichita Falls Ph. 723-6523

### REPORT OF CONDITION

Consolidating domestic and foreign subsidiaries of the

THE STATE NATIONAL BANK

of IOWA PARK

Name of Bank

City

In the state of TEXAS

at the close of business on March 31, 1979

published in response to call made by Comptroller of the Currency, under title 12, United States Code, Section 161.

Charter number 13614

National Bank Region Number 1119-1109-1

Statement of Resources and Liabilities

Thousands of dollars

ASSETS	Cash and due from depository institutions	2,171
	U. S. Treasury securities	395
	Obligations of other U. S. Government agencies and corporations	175
	Obligations of States and political subdivisions in the United States	2,814
	All other securities	9
	Federal funds sold and securities purchased under agreements to resell	850
	Loans, Total (excluding unearned income)	10,566
	Less: Allowance for possible loan losses	64
	Loans, Net	10,502
	Lease financing receivables	None

LIABILITIES	Bank premises, furniture and fixtures, and other assets representing bank premises	190
	Real estate owned other than bank premises	None
	All other assets	149
	TOTAL ASSETS	17,256
	Demand deposits of individuals, partnerships, and corporations	6,390
	Time and savings deposits of individuals, partnerships, and corporations	6,473
	Deposits of United States Government	19
	Deposits of States and political subdivisions in the United States	2,506
	All other deposits	13
	Certified and officers' checks	276

MEMORANDA	EQUITY CAPITAL	Total Deposits	15,676
		Total demand deposits	7,269
		Total time and savings deposits	8,407
		Federal funds purchased and securities sold under agreements to repurchase	None
		Interest-bearing demand notes (note balances) issued to the U. S. Treasury and other liabilities for borrowed money	None
		Mortgage indebtedness and liability for capitalized leases	None
		All other liabilities	190
		TOTAL LIABILITIES (excluding subordinated notes and debentures)	15,866
		Subordinated notes and debentures	None
		Preferred stock	None

MEMORANDA	EQUITY CAPITAL	Common stock	50
		No. shares authorized	50
		No. shares outstanding	50
		Surplus	200
		Undivided profits and reserve for contingencies and other capital reserves	1,090
		TOTAL EQUITY CAPITAL	1,390
		TOTAL LIABILITIES AND EQUITY CAPITAL	17,256
		Amounts outstanding as of report date:	
		Standby letters of credit, total	None
		Time certificates of deposit in denominations of \$100,000 or more	1,627

We, the undersigned directors attest the correctness of this statement of resources and liabilities. We declare that it has been examined by us, and to the best of our knowledge and belief is true and correct.

I, Roberta Hill

Name

Vice President & Cashier

Title

of the above-named bank do hereby declare that this Report of Conditions is true and correct to the best of my knowledge and belief.

Directors

Signature

April 25, 1979

Date

# NOTICE

## TEAL MUSIC of Wichita Falls

Wayne Teal of Teal Music in Wichita Falls is asking

### !!!YOUR HELP !!!

All Remaining

## PIANOS and ORGANS

Must be sold for balance due our bank

immediately. Included FREE, when available,  
will be Bench, Books & Head phones.

This is warehouse stock, undamaged by tornado,  
in perfect condition with full warranty.

Because the mall is closed we will be temporarily located  
in the Teal Video School of Music in the Strip Shopping  
Center by Bonanza at 2605 Seymour Hwy.

No Telephones Available

**OPEN MONDAY THROUGH SATURDAY 9 to 6  
SUNDAY 1 to 6**

Bring Your Trucks & Trailers — And A Few Encouraging Words.





## Humor 'n Whimsey

By JOE RIORDAN

During my salad days as a reporter I encountered a covey of unforgettable characters on the average of twice a month. At least I thought they were unforgettable when I met them. Actually, they were easier to forget than they were to remember.

All but one of the names and faces faded like cigarette smoke in the west Texas wind. That one name, one face, one really unforgettable character imprinted his image so firmly on my memory, the meeting might have taken place yesterday instead of 25 years ago.

He was a native born Swede with the build of a lumberjack and the patience of a trout fisherman. His voice was as deep as the sound of a cannon fired in a rock quarry. Yet, it had softness and warmth that reminded you God didn't reserve gentleness for women, only.

We didn't meet by chance. My city editor told me to write a feature story on the local contingent of the Salvation Army. Major Nils Johnson, Swedish by birth, American by choice, and a man of God by vocation, met me as I walked into Salvation Army Headquarters.

"Interview me as I work."

The command was delivered in a stentorian tone as he began to take giant steps that reminded me of playing, "Mother, may I?"

I spent the next 14 hours following Major Nils Johnson. When we took a 15 minute break for sandwiches and coffee he told me he usually did not stop for lunch, but this was a slow day.

I faded into the background and watched him as he worked, counseling others, and encouraging all to place

their faith in God.

When the day ended, I stuffed my notebook into my pocket and tried to stretch the fatigue from my body.

"Major, was this really an easy day?"

"Oh, yes. A much shorter day than I usually work."

"In that case, I wouldn't have your job for a million dollars."

He smiled with a relaxed look of a man at peace with God and the world.

"You know something, young man? I wouldn't either."

## Letter to the Editor

Dear Sirs:

Thank you so much for a copy of your paper of April 19, 1979 containing the article and picture relative to the Memorial service of my wife, Cue. I have asked some friends to save me some copies of the excellent article. I shall always have fond memories of that fine community and the beautiful friends we have there. I lived there from 1930 to 1938. My wife lived there from 1933 to 1938. You have one of the best small towns in the state of Texas. Thanks again for your courtesy. God bless you.

Sincerely  
R. Clyde Boulware

## As I See It....



I'm convinced what saved most of the lives of Wichita Falls residents April 10 was the fact that a tornado had hit Vernon three hours earlier and one was sighted west of here about 45 minutes before the city was struck.

There's no question in my mind that most of the people in Wichita Falls were conscious of tornadoes, because of news reports about Vernon and Iowa Park, and people were concerned about the weather.

With them sitting on edge after hearing the earlier reports, they were receptive to hearing the sirens, and were ready to react.

Otherwise, possibly as many as 1,000 could have been killed by the

giant twister.

Of course the education they had received in the past, about what to do in case of a tornado, saved their lives also. But had they not been mentally alert of the possibility of tornadoes, it could have been much more disastrous.

There seems to be one common denominator among the majority of stories from people who rode out the storm in their homes. Wherever they sought safety, that was the part of the house which remained standing after the storm passed over.

I can't let one point on which I'm skeptic pass at this point.

An organization of home builders in Wichita Falls has been alerting residents of the pending cost of letting just anybody from outside the area to do their repair or rebuilding for them.

This assurance would lead you to believe whomever belongs to the organization is fine and dandy and can be trusted to the fullest.

Well, there are three or four

members I know of that I wouldn't let build a dog house for me. That judgement is based both on quality of work and cost charged in the past.

Of course, there are some very good builders in the organization, too.

I've never heard a president of the United States speak so badly of a segment of our nation than has Pres. Carter about the oil industry.

He certainly didn't talk like that about any of the OPEC nations when they were raising their oil prices in the past, and future.

And when it comes to "windfall profits", have you heard anything from the President concerning the profits financial institutions are making on home mortgages these days?

If I were a betting man, I'd say Carter's odds on getting re-elected now stand at 5-to-2 against winning.

I've got to give him the two, considering there are still people who vote for party instead of record or individual.

## REMEMBERING...

By BILL D. BROOKS

### Building A Raft

After reading the book, "Huckleberry Finn," my brother and I were so impressed with Huck's adventures we decided to have some of our own. We took our trusty, but dull, hatchet and one of Dad's handsaws and set out to a spot down on the creek where a large grove of willows grew.

We would cut down a few trees, build ourselves a raft and the next time the creek flowed we would ride the stream clear to the coast (only about five hundred miles away). No telling what we might see or do or what might happen to us. It was so exciting. We would take along a little food but we would live mostly off the land. We would fish the streams or hunt wild animals along the banks with our Red Rider B.B. gun.

It took about a week of hard labor just to get the trees cut and to chop them into logs the right length. We didn't mind the hard work, besides, it would all be worth it when we set sail.

We connected all the logs together with boards and nails, some old rope and bailing wire. Though it was probably not as pretty as Huck's, it did look seaworthy. We added a mast, rigged up a sail made from an old bedsheet and made a pole rudder to guide her with. We were proud when we had finished. We made further voyage plans and looked at the sky, hoping it would come a "gully washer" soon. It didn't.

After about a month we decided it might never rain again and we just had to try that raft out. There was a large stock tank about a quarter of a mile away so we decided to take it over there for a trial run. We tried to pick it up but quickly decided it must have grown to the ground. We finally budged it a little by using poles for levers but it took us all day to go about ten feet. We abandoned the stock tank idea and decided to just wait for the rain.

When the rain finally came we rushed down to the creek

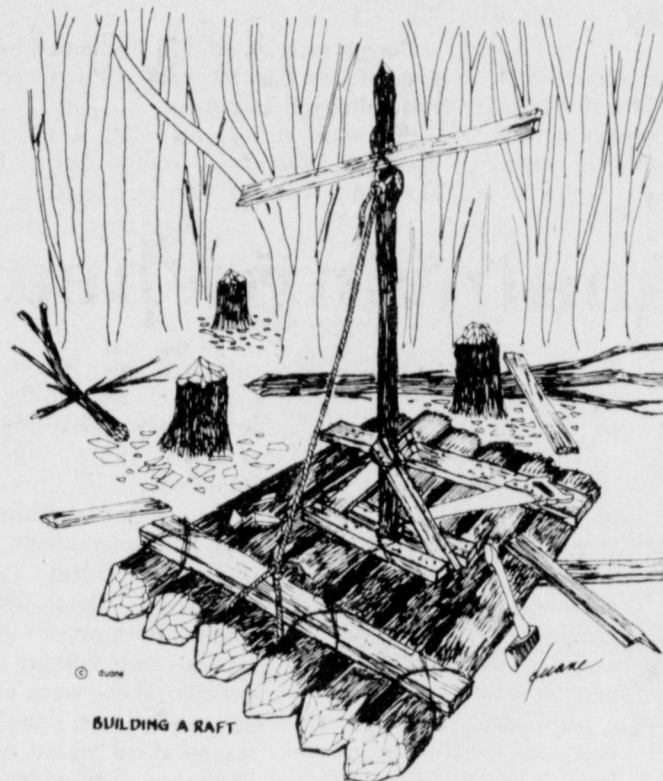

BUILDING A RAFT

to shove it in. We used our poles to work it into the water. Green logs are not good to make rafts with as Huck could have probably told us. The raft bobbed up and down just under the surface of the water, hardly able to float itself, much less two eager adventurers and their provisions. Sadly we

watched the raft bob pathetically as it floated out into the swift muddy current. It hadn't gone more than a hundred yards down stream when it bumped into a tall tree and was reduced to splinters in a few seconds. If we had headed toward the coast, it would have been a short trip.

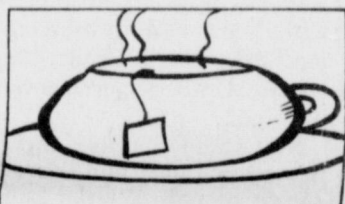

Some people believe that beech tree leaf tea will cure rheumatism.

# IOWA PARK LEADER

Bob Hamilton ..... Editor - Publisher  
Dolores Hamilton ..... Assistant Publisher  
Lewis Simmons ..... News Editor  
Oliver Black ..... Reporter

The IOWA PARK LEADER is published every Thursday. Offices are located at 112 W. Cash, Iowa Park, Texas, 76367. Telephone: 592-4431. Second class Postage Paid at Iowa Park, Texas, 76367. Subscription rates are \$6 in Wichita and Archer Counties; \$8 in Texas and Oklahoma; \$10 elsewhere, all payable in advance. Classified advertising rates are 10 cents per word first insertion, 5 cents per word thereafter. Any erroneous reflection upon the character, standing, or reputation of any person, firm, or corporation which may appear in the columns of this newspaper will be corrected upon being brought to the attention of the publisher.

MEMBER

## TEXAS PRESS ASSOCIATION

# the Savings are Delicious

<div style="border: 2px solid black; border-radius: 50%; padding: 10px; text-align: center;"> <p>Covered Wagon</p> <h2>Bacon</h2> <h1>75¢</h1> <p>Lb.</p> </div> <p>Carl's <b>Sausage</b> 2 Lb. Roll <b>\$2.73</b></p> <p><b>Celery</b> Large Stalk <b>33¢</b></p> <p>Ruby Red <b>Grapefruit</b> Lb. <b>19¢</b></p> <p>Yellow <b>Onions</b> Lb. <b>19¢</b></p> <div style="border: 1px solid black; padding: 5px;"> <p>Iceberg <b>Lettuce</b> 3 Heads <b>\$1</b></p> </div>	<p>Heavy Beef <b>Round Steak</b> Lb. <b>\$1.73</b></p> <p>Heavy Beef Blade Cut <b>Chuck Roast</b> Lb. <b>\$1.33</b></p> <p>Heavy Beef Seven Bone Cut <b>Chuck Roast</b> Lb. <b>\$1.53</b></p> <p>Heavy Beef Seven Bone Cut <b>Family Steak</b> Lb. <b>\$1.59</b></p> <p>Heavy Beef Lean <b>Short Ribs</b> Lb. <b>73¢</b></p> <div style="border: 1px solid black; padding: 5px; text-align: center;"> <p>Sunnydell <b>Milk</b> 1 Gal. <b>\$1.89</b></p> <p>Oven Gold <b>Bread</b> 1 1/2 Lb. Loaf <b>43¢</b></p> <p>Every Day Low Price</p> </div> <p>Shurfine <b>Shortening</b> 3 Lb. Can <b>\$1.59</b></p> <p>Best Maid <b>Bar-B-Q Sauce</b> 16 Oz. <b>69¢</b></p> <p>Gladiola Mexican <b>Cornbread Kit</b> <b>5/\$1.00</b></p>	<p>Stop Food From Sticking <b>Pam</b> Big 13 Oz. <b>\$1.25</b></p> <p>Thrft King <b>Towels</b> <b>39¢</b></p> <p>Shurfine Bathroom <b>Tissue</b> 8 Roll Pkg. <b>\$1.39</b></p> <p>Thrft King <b>Detergent</b> 32 Oz. <b>59¢</b></p> <p>Our Darling <b>Corn</b> 17 Oz. <b>3/\$1.00</b></p> <p>Double Luck <b>Green Beans</b> 16 Oz. <b>4/\$1.00</b></p> <p><b>Pinto Beans</b> Lb. <b>29¢</b></p> <p>Oak Farms <b>Ice Cream</b> Square Carton 1/2 Gal. <b>\$1.09</b></p> <div style="border: 1px solid black; padding: 5px; text-align: center;"> <h2>DISCOUNT FOODS</h2> <p>107 WEST PARK</p> </div>
---	--	---



# Obituaries

## Mrs. Patsy Ruth Boker

Funeral service for Mrs. Patsy Ruth Boker of La Marque was Wednesday in Owens and Brumley Funeral Home. The Rev. Lloyd Riddles, pastor of First Baptist Church of Holliday, officiated. Burial was in the Highland Cemetery in Iowa Park. A 10-year resident of La Marque, she was born Feb. 18, 1940 in Wilbarger County.

She is survived by her husband; a son, Troy Wayne Martin of Wichita Falls; four stepdaughters, Mrs. Elizabeth Asher of La Marque, Mrs. Alice Burleson of Humble, Mrs. Kathy Simons of Kemah and Betty Jean Boker of Huntsville; her father, Clyde Evans, and her mother, Mrs. Lanora Wikel, both of Wichita Falls; two sisters, Mrs. Jeannie Barnard and Mrs. Sue Pinson, both of Wichita Falls; and a brother, Charles D. Evans of Holliday.

Burial was in Wilbarger Memorial Park under direction of Sullivan Funeral Home. Mrs. May was born Feb. 13, 1935 in Vernon and married June 30, 1956. She was a member of First Baptist Church.

Survivors include her husband; three daughters, Mrs. Charlotte Hawley of Iowa Park, Kathy May and Lindi May of Vernon; her parents, Mr. and Mrs. C.B. Box of Vernon; two sisters, Mrs. Kathryn Greene of Charlotte, N.C. and Mrs. Virginia Welborn of Pampa; two brothers, Derral C. Box and Jerry Box of Granbury; and one grandchild.

## Albert Maeckel

Service for Albert Maeckel, 85, who died Monday in a Wichita Falls hospital, will be Friday at 2 p.m. in Tanner-Aulds Funeral Home. The Rev. Ernest Quillen, pastor of Good Shepherd Lutheran Church, will officiate. Burial will be in Highland Cemetery.

Born March 20, 1894 in Nechanitz, he had lived in Iowa Park 50 years and was a retired self-employed carpenter.

Survivors include his wife, Anna; three brothers, Jesse of La Grange, Lee of Eagle Lake and Willie of Corpus Christi.

## Mrs. Calvin May

Services for Mrs. Calvin May, 44, of Vernon, mother of Mrs. Charlotte Hawley of Iowa Park, were Tuesday afternoon at First Baptist Church in Vernon, with Dr. Rufus Sprayberry, pastor, officiating.

**FENCES CUT** - A.L. Bohannon inspects results of vandals who, sometime Sunday night, cut fences in twelve places along Smith Road west of town. Bohannon's five-strand fence was cut in seven places; Thomas Moore, five strand one time; Bill Roberson four strand four times; and Lee Lovell, four strand two places. Bohannon is offering \$100 for identification of the vandals.

## Insects pose threat to maturing wheat

Greenbug and winter grain mite infestations are light; however conditions are right for an armyworm outbreak. Wheat crop prospects are excellent. Moisture is adequate in most areas of the county as wheat is in the booting and heading stage. Well fertilized fields are looking particularly good.

Wheat in some areas of the county is suffering from lack of moisture. An area about midway between Punkin Center and Burk Burnett is experiencing a moisture deficit. Bill Brockriede says, "Some of our wheat is going downhill everyday due to a lack of moisture. There is a strip through here which has missed nearly all of the rain showers. This is the same strip which seemed to catch every shower during the two previous years."

There is little possibility of damaging levels of greenbugs and grain mites for the remainder of the year; however, growers will want to watch their fields for armyworms and fall armyworms. Adult armyworm moths have been observed around lights. These moths lay their eggs in masses. Larvae begin to feed upon the foliage when they hatch. Since the larvae feed at night, damage may go unnoticed for several days. Heavy feeding prior to the dough stage can significantly decrease yields.

Greenbug populations are light throughout the area, according to Tim Goetz, wheat insect scout for Wichita County. Populations are ranging from only 1 to 6 per foot of drill row. Winter grain mite populations are decreasing from the previous week. Producers can inspect those fields which have been in wheat or other small grains for several years to evaluate the winter grain mite situation. Beneficial insect populations are controlling greenbugs in most fields. Predators now attacking greenbugs are primarily lady beetles, lacewings, spiders, pirate bugs, and nabids. Lady beetle and spider populations are averaging up to eight tenths per foot of drill row.

The County livestock committee is considering the possibility of sponsoring a tour for small swine producers or those considering a small swine operation. This proposed tour would visit two swine operations which feature excellent management in minimum investment facilities.

Three producers, Don Gibbs, Mac Reeves, and Mike Mitchell, have already indicated an interest in a one-day tour. Anyone else interested in the tour can contact the county extension office. We will visit a 12-sow operation of Paul Winkler and a 250-sow farm of Kermit Miller near Gatesville. Incidentally, Miller was a vocational agriculture student under Earl Sargent several years ago at Jonesboro.

Two grain sorghum hybrid demonstrations have been established in the northwest region of the county. Both are up to good stands and making rapid growth. These were planted as early as the soil temperature would permit. They were planted when the soil temperature reached 55-60 degrees. The early-as-possible planting is aimed at getting ahead of the hot, dry summer days.

Joe Koehler planted his test on April 21. Approximately 1 1/2 acres were planted to each hybrid. Carl and James Brockreide planted their demonstrations on April 14. Both sites are exceptionally good land near the Red River, and they were fertilized with about 60-80 pounds of nitrogen per acre. Varieties included were Taylor Evans TE Y101, TE 66B, Warner 839T, W664, W665, McNair 535, Dekalb B39, and Dekalb C42Y. Yields will be measured with a combine since these are field size plots.

## Blue Birds in fly-up

Blue Birds from third grades at Bradford and Kidwell Elementary schools were presented in a fly-up ceremony during the annual Camp Fire Dad-Daughter banquet Saturday evening at Recreational Activities Center.

The Bradford Sunshine Blue Birds who received scarves were Lisa Hodges, Christy Cravens, Barbara Heidrich, Dee Dowell, Keva Gunter, Sheri Cravens, Stacy Boren, Deidre Sadberry, Jerri Brown and Sheila Moore.

The Foxy Blue Birds from Kidwell who received scarves were Lorre Moser, Stacy French, Karie Davis, Shelia Staggs, Lisa Cook and Nanette Mathews.

The program was presented by two leaders and two co-leaders, Mmes. Moser, Hodges, French and Cravens.

Scarves, ties and adventure books were provided for all girls by the Evening Lions Club.

## Ayres team runner-up

The Ayres Tire Company fast pitch softball team defeated teams from Fort Worth, Dallas and Graham before losing out in the finals of the losers bracket in last weekend's tournament in Graham.

In coming weeks, the Ayres team will be playing in tournaments in Jacksboro and Fort Worth.



FOUR TOP SELLERS in the annual Camp Fire Girls candy sales for 1979 are pictured. Seated from left: Lisa Hodges who sold 120 boxes and Christy Cravens with 125 boxes to her credit. Standing are Jody Beavers, who sold 208 boxes to win first place, and Peni Lee with 118 boxes.

## Envelopes to meet standard

"Use up your small and undersized envelopes and cards before July 15," Jack D. Watson, sectional center manager and postmaster, reminds customers. That is the date when the Postal Service's new size standards become effective.

The Fort Worth postmaster said that after July 15, envelopes and cards measuring less than 3 1/2 inches high or five inches long will be returned to the sender if mailed.

Postmaster Watson said that because the envelope and greeting card industries have had more than three

years to prepare for the new standards, few retailers should still be selling undersized pieces.

"Many customers, however, are likely to still have smaller envelopes and cards in their supply of stationery," Watson said.

The regulations also prohibit flimsy cards. In the future they must be at least seven-thousandths of an inch thick. An official postal card, for instance, has a thickness of nine thousandths of an inch.

Undersized pieces and flimsy cards are being banned because they can become trapped in other mail, tear and jam mail processing machinery. As a result, the letters of others can also be damaged.

The standards also affect oversized and odd-shaped pieces of mail, Watson said. For first class mail weighing one ounce or less, there will be a surcharge of seven cents for pieces more than 6-1/8 inches high or 11-1/2 inches long.

## Finnell bill passes house

Rep. Charles Finnell Friday won passage of legislation which would decrease the paperwork for farmers who must file unemployment compensation reports.

The bill, H.B. 2109, which changes the current statute to allow for farmers to file full reports on their employees quarterly now passes to the Senate where it must also be approved.

"A bill such as this would cost the people of this state nothing," said Finnell, "yet it will save the agricultural employer time now lost in a tangle of bureaucratic red tape."

The bill had previously been passed unanimously by the House Committee on Agriculture and Livestock.

## Warren employees slate reunion

Warren Company employees will hold a reunion in Holliday June 2.

Chairman of the event is Mrs. Roy Cannon. The reunion will be held at the Holliday High School cafeteria.

**TRINITY LUTHERAN CHURCH**  
8 1/2 miles north FM 368  
1 1/2 miles west FM 1813  
Sunday School: 9:45  
Worship: 10:30  
Welcome!

**-WELCOME-**  
Assembly Of God  
S. Yosemite  
9:45 S.S./6 P.M.  
Wed. 7 P.M. Service  
Rev. Charles Hensley,  
Pastor

**WELCOME**  
Come Grow With Us  
**IOWA PARK BAPTIST CHAPEL**  
410 Park West Shopping Center  
Sunday School - 9:45 a.m.  
Morning Worship - 11 a.m.  
B.T.C. - 6:00 p.m.  
Evening Worship - 7 p.m.  
Wednes. Evening - 7 p.m.  
Pastor, Larry Washburn  
Phone 592-4288

**FIRST CHRISTIAN CHURCH**  
[Disciples of Christ]  
Rev. Clyde Markee  
105 E. Cash 592-4513  
You are cordially invited to worship with us each Sunday.  
Church School 9:45 a.m.  
Worship 10:55 a.m.  
YOUTH PROGRAM 6:00 p.m.

**Grace Baptist Church**  
511 S. Colorado - 592-5632  
Come Let Us Reason Together Saith The Lord  
Sunday School ..... 10:00 A.M.  
Morning Worship ..... 11:00 A.M.  
Evening Worship ..... 6:30 P.M.  
Wednesday Service ..... 7:30 P.M.  
Jimmy Johnson, Pastor

**YOU ARE ALWAYS WELCOME**  
SUNDAY BIBLE STUDY 9:30  
PREACHING 10:30 & 6:00  
WEDNESDAY EVENING 7:30  
**Keep In Touch**  
Phone 592-2541  
...for information relative to members of the congregation. Bible reading suggestions. Short devotional. Information changed daily.  
**CHURCH of CHRIST**  
300 EAST PARK  
**IOWA PARK**  
[Call office - Ride one of our buses]  
**592-5415**

## Here's what fuel means on your electric bill.

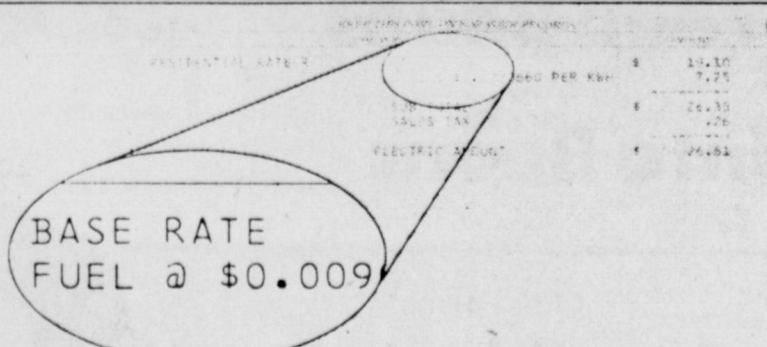

The cost to provide your electric service is divided into two parts: base rate and fuel. The base rate covers the cost of bringing electricity to you - things like the miles of lines, substations, power plants and the Texas Electric employees to make it all work are included in the base rate.

But the other part of your bill, fuel, is what some people don't understand.

The "fuel" amount on your bill is what we must pay to buy the natural gas, oil or lignite coal that we use to make your electricity.

Without that fuel, all the other things that make up your electric service system would be

useless. We must burn fuel to make your electricity. How much we use each month to make your electricity is shown by the fuel amount on your bill.

At Texas Electric, we want you to understand what you're paying for.



W. N. HOUSE, Manager, Phone 592-4149



## Iowa Park band wins at Greater Southwest

By Shirley Banks

The Iowa Park Band left Friday morning at 2:45 a.m. with three chartered buses filled with live but sleepy bandmembers, two band directors, five sponsors and three very nice drivers headed out for Amarillo, Texas to prove their music and marching ability.

The Greater Southwest Music Festival is held annually and is among the toughest in the state. Getting a one or even a two there is very difficult.

The first order of competition for the bands was concert playing. Each band played two selections. The Honors Band, under the direction of Mr. David Mooney received a first division and the Symphonic Band, under the direction of Mr. Mar, Cartwright received a Third Division. They next competed in sightread-

ing, which is a selection of music which is usually not familiar to the band nor the director. They have a short time to look over this music, which is usually a very difficult piece even if it could be played several times. After this very brief period and no practice, they are judged on the first sounds that come from all the students instruments for the first time. The Honors Band Symphonic received a Three.

In the afternoon solo and ensemble played and competed for their awards, and would now see if all the hours of work would pay off for them. Results of these are: First Division: Dave & Mike Perry, Russell Shawver, and Chuck Thompson - Brass quartet; Mary Lynn McElroy, Michelle Miller, and Vanessa Stucki - Flute Trio; Mike Lunney - Trumpet Solo; Tony Bartow - Sax Solo; Lynette Flick and Deann Patterson - Drum Major Duet; Tim Adcock and Denny Anderson - Piano Solos. Second Division: Sherry McDonald - Flute Solo; Eric Birk - Piano Solo; Rosa Soell - Trumbone Solo; and Pam Forman - Piano Solo. Third Division:

Connie Heard - Piano Solo.

While the individuals played their selections, the rest of the band members stretched their legs in the parking lot. At this point, if an unofficial award could have been given without any judges, Charlie Parks and David Horsky would have won the outstanding acting award without any doubt. If Steve Anderson does not make it in the music field, he should try being a make-up artist.

The two bands combined in the evening for the marching contest to be held at West Texas State University Stadium in Canyon. On the way over, the members felt togetherness in a great way; we rode on two buses instead of three. That's togetherness! The Band placed first in 3AAA Division and brought home a three foot trophy and two plaques. Winning this showed that each member had done his best and combined together to bring honors to the entire band program. There were tears, hugs, and happiness. That's togetherness! The citizens of Iowa Park congratulate the Band.

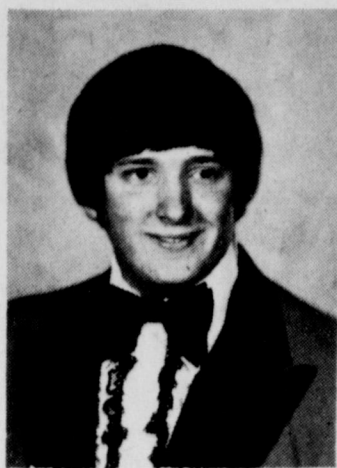

MARC HILDEBRAND

### Hildebrand is chosen

The Iowa Park Opti-Mrs. Club held its annual Student of the Year banquet Monday evening at First Presbyterian Church. Marc Hildebrand, son of Mr. and Mrs. Harold Hildebrand, was selected Student of the Year. He was chosen for his outstanding ability in band and received a \$25 savings bond. A senior at Iowa Park High School, he plans to pursue a career in law upon graduation.

Other students honored on the occasion were those that had been selected Student of the Month during the year as March had been. These included Sherry McDonald, Jill Koonce, Travis Little, Vicki Krum, Michael Davis, Teresa Kibler, Jeff Nolen and Irene Arredondo.

Mrs. Thomas Green, club president, presented the awards and introduced Clifford O'Neal, Senior Enlisted Advisor at Sheppard Air Force Base, who was the guest speaker.

### Annual banquet held

The Iowa Park Chapter of Office Education Association held the annual appreciation banquet Tuesday evening at Luby's Cafeteria in Wichita Falls.

Penny Morgan, Co-op president, presided. Karla Friday, chaplain, gave the invocation and Cheryl Wright, first vice president, introduced the officers.

The program featured vocal numbers by Coy Lee and a slide presentation "Happiness Is -- Trucking with OEA" by Celeste Glenn, lab first vice president, and Lauri Long, lab president.

Angela Martinez and Penny Morgan received awards for being the top candy salesmen of the year. Angela also received the prize for the highest amount of pledges for the Rock-a-thon which was sponsored by the chapter this year for the benefit of the Special Olympic games.

## Little League results

### MAJOR LEAGUE STANDINGS

Dodgers	3-1-0
Pirates	2-1-0
Giants	1-2-0
Yankees	1-2-0
Astros	1-2-0

### Pirates 14, Dodger 13

Eventhough the Dodgers out-hit the Pirates 14-6 at the plate, the Pirates were able to outscore the Dodgers, thanks to 17 walks. Pirate Donnie Dietrichson went

three for three at the plate, while Dodger Ronnie Lewis was four for four.

### Yankees 2, Astros 1

The Yankees found play a little tougher than their 18-3 season opener, but pulled the game out of fire with a score in the fifth inning when Wayne Kenyon hit a hard grounder to left field. Donald Young, who was on first base, ran all the way to score the winning run.

strong relief help and gave up two runs before striking the last two batters out for a 13-11 save in the third inning. Adams hit a bases-loaded home run in the second inning.

### Cubs 21, Bears 11

Jimmy Harper pitched his first complete game, giving up three hits and 11 runs while winning. Stephen Hudson knocked in 12 runs with four home runs.

### Cubs 24, Reds 12

Pitcher Van Hedrick picked up his third win in as many starts, fanning 11 batters while giving up only one run off two hits in the last inning. Jerry Allen led Dodgers with a double. Kendall Hill and Brian Fowler were credited with the two Yankee hits.

### Cubs 29, Oilers 13

Game was called after two and a half innings on time limit. Robert Adams took the mound in relief in the second inning to help win the game.

### Dodgers 10, Yankees 1

Pitcher Van Hedrick picked up his third win in as many starts, fanning 11 batters while giving up only one run off two hits in the last inning. Jerry Allen led Dodgers with a double. Kendall Hill and Brian Fowler were credited with the two Yankee hits.

### MINOR LEAGUE

#### Indians 23, Cards 11

Game was called due to time limit after the third inning. Randy Boutwell, Indian shortstop, had a home run and triple; Brett Hale, winning pitcher, had a home run and single; Gary Kissner had a triple and scored four runs. Lynn Lanford of the Cards was on base three times and scored twice.

### SENIOR LEAGUE

#### A's 8, Twins 6

The game was called after four innings due to time. A's posted a pair of double plays, and stole nine bases.

#### A's 6, Angels 5

Keith Daulton hit two stand-up doubles and Randy Brown had a triple for the A's, who are now 2-1 for the season.

### White Sox 14, Indians 6

A seven-run third inning proved to be the big one for the White Sox, handing the Indians their first loss. John Wood and James Mitten had a pair of singles for the Sox. Indian Brett Hale had a home run and triple.

### Cubs 13, Oilers 11

Stephen Hudson pitched two and a third innings, giving up nine runs, before Robert Adams came in with

**GOLFERS**  
Enjoy the beauty & excitement of Skyline

**GREEN FEES**  
\$3.00 WEEK DAYS  
\$5.00 SATURDAYS  
SUNDAYS AND HOLIDAYS  
PUBLIC WELCOME  
Complete Pro Shop  
Facilities

**RALPH MORROW**  
GOLF PROFESSIONAL  
(Lessons By Appointment)  
**SKYLINE C.C.**  
N. BEVERLY PHONE 855-0771



IPHS HORTICULTURE CONTEST WINNERS  
...Mike Costello, Cindy Dodson and Rocky Combs

### Horticulture team places second at state

Iowa Park High School's horticulture team took second place in the Texas FFA nursery and horticulture contest last Saturday at Texas A&M University.

Horticulture team members who brought home the second place honor were Rocky Combs, Cindy Dodson and Mike Costello.

Costello was judged the third high individual of the contest, and Miss Dodson

placed fifth on an individual basis.

The IPHS nursery team placed seventh in the nursery division at the state contest. Team members included Randall Schram, Jeff Crenshaw and Bo Kickerson.

### Clip & Save

#### Iowa Park School Menu

**Friday** - BBQ on Bun, Meat & Cheese Sandwich, Soup, Sweet Relish, French Fries, Chilled Peaches, Chocolate & Plain Milk, Oatmeal Cookies.

**Monday** - Corn Dogs & Peanut Butter Sandwich, Meat & Cheese Sandwich, Soup, Macaroni & Tomatoes, Blackeyed Peas, Chocolate & Plain Milk, Brownies.

**Tuesday** - Italian Spaghetti, Meat & Cheese Sandwich, Soup, Mashed Potatoes, Green Beans, Garlic Toast & Butter, Chocolate & Plain Milk, Poor Boy Cake.

**Wed.** - Cheeseburgers, Meat & Cheese Sandwich, Soup, Lettuce, Tomatoes, Pickles, & Onions, Potato Chips, Beans, Chocolate & Plain Milk, Ice Cream Bars.

**Thursday** - Tacos with Cheese, Meat & Cheese Sandwich, Soup, Buttered Corn, Lettuce & Tomato Salad, Fruit, Chocolate & Plain Milk, Peanut Cluster.

**Barbour Insurance Agency**

**Charlene Barbour**  
Ph. 592-4173  
900 West Highway



## CORN DOGS

2 for

**99¢**

Specials good thru Sunday



805 West Highway

FOR TAKE OUT ORDERS  
CALL 592-4731

**True Value**  
HARDWARE STORE

**TOOL VALUE**

OF THE MONTH

Master MECHANIC now **4.99**

White Supplies Last

**25-FT. POWER TAPE**  
High-impact styrene case. Positive toggle lock holds tape firmly. Black markings on yellow steel tape. Self-adjusting end hook.  
MMP325  
Quantities Limited

**PARKWAY True Value**  
200 - 206 West Bank

**Iowa Park Tennis Association/Booster Club**

Non-profit organization to promote tennis in Iowa Park.

— For All Ages —

Membership Information 592-2016

**Sell It With Classifieds**

## Need a job with flexible hours?

**Ken's Pizza could be just what you need. We have openings for daytime, nighttime and weekend, weekday, short shifts, long shifts. You could work for 15 to 41 hours per week, at \$2.90 to \$3.25 per hour.**

**Check at Michael D's Pizza, and if not there, contact at Ken's Pizza, in person to fill out application, 900 Sheppard Road, Burkburnett, across from Mathis Chevrolet.**

### Now TWO Barbers



MARY HALL

MARY MARROW

The barbership that cuts BOTH men's and women's hair.

Open 9 a.m. - 6 p.m. Tues. - Fri.  
8 a.m. - 4 p.m. Saturday

**Mary's Haircutting**

Next to Cabe's on West Hiway





# LIONS CLUB ANNUAL BROOM and MOP SALE

## Saturday

### Park West Shopping Center

PRODUCT SELECTED:	STOCK NO.	SUGGESTED PRICE EACH	5% SALES TAX SUGGESTED
<b>BROOMS:</b>			
RAINBOW PLASTIC BROOMS	215	3.20	3.37
FLOR ADORA BROOM	6140	3.20	3.37
POLY SWEEP BROOM	600	2.00	2.10
POLY SWEEP REFILL	3600	1.00	1.05
HOUSE BROOM	205	4.25	4.46
TOY BROOM	209	1.75	1.84
WAREHOUSE BROOM	201	4.75	4.99
WHISK BROOM	208	1.75	1.84
<b>BRUSH HANDLE INCLUDED:</b>			
18" TAMPICO FLOOR BRUSH	1000	8.75	9.19
24" TAMPICO FLOOR BRUSH	1000	10.00	10.50
18" PLASTIC FLOOR BRUSH	3000	8.75	9.19
24" PLASTIC FLOOR BRUSH	3000	10.00	10.50
14" GARAGE BRUSH	1008	7.50	7.88
18" GARAGE BRUSH	1008	8.75	9.19
24" GARAGE BRUSH	1008	10.00	10.50
EXTRA BRUSH HANDLE:	1009	2.25	2.36
GRILL BRUSH BAR-Q	168	3.50	3.69
DE LINTER BRUSH (LINT)	111	2.50	2.62
GONG BRUSH	1052	2.00	2.10
BOWL BRUSH	1030	1.25	1.31
BOTTLE BRUSH	602	.75	.78
<b>COMMERCIAL DUST MOP:</b>			
18" DUST MOP	155	10.50	11.03
18" DUST MOP REFILL	3155	4.75	4.99
24" DUST MOP	155	12.95	13.60
24" DUST MOP REFILL	3155	5.75	6.04
36" DUST MOP	155	16.75	17.60
36" DUST MOP REFILL	3155	8.00	8.40
<b>MOP AND MOP-HEAD:</b>			
HOUSE MOP (RAYON)	103-8	2.10	2.20
HOUSE MOP (COTTON)	102	3.50	3.69
FLAT WAY MOP 10-OZ.	X1	2.55	2.70
FLAT WAY MOP REFILL	X2	2.00	2.10
SPONGE MOP	623	4.50	4.73
SPONGE MOP REFILL	633	1.35	1.41
TOY MOP	103-3	1.50	1.57
24-OZ. COTTON MOP HEAD	3101-24	3.50	3.68
16-OZ. RAYON MOP HEAD	3102-16	3.25	3.41
COMMERCIAL MOP-HANDLE	1611	4.75	4.99
WAREHOUSE MOP	101-24	5.00	5.25
WAX APPLICATOR	601	1.75	1.84
WAX APPLICATOR REFILL	3601	.75	.79
SQUEEGE	242	2.75	2.89
<b>OUTDOOR ITEMS:</b>			
SMALL GRASS MAT	747	4.50	4.73
LARGE GRASS MAT	747	8.50	8.93
SMALL RUBBER MAT	970-1	4.50	4.73
LARGE RUBBER MAT	970-3	8.50	8.93
LAWN RAKE	303	3.75	3.94
<b>TEXTILES:</b>			
DISH CLOTHS 4/PKG.	421	2.00	2.10
DISH TOWELS 2-PKG.	420	2.50	2.63
DUST CLOTHS	450	.60	.63
IRONING BOARD COVER	401	2.25	2.36
IRONING BOARD COVER & PAD	4011	3.00	3.15
WASHING MACHINE BAG	455	2.50	2.63
OVEN MITTS	410	2.50	2.63
POT HOLDER	411	.65	.68
HOUSE HOLD DUST MOP	X6	4.00	4.20
HOUSE HOLD DUST MOP-REFILL	X7	2.50	2.63
<b>SPECIALTY ITEMS:</b>			
DUST PAN	451	1.00	1.05
FLY SWATTER	459	.35	.37
PET DISH	636	1.00	1.05
RUBBER GLOVES	434	1.75	1.84
SCOURING PAD	435	2.50	2.63
SCRUBBER	603	1.50	1.58
UTILITY SPONGE	940	1.00	1.05
MOPETTE	951	.75	.79
THERMOMETER	707	1.50	1.58
DEODORANT BLOCK	X3	1.00	1.05
CLOTH PINS	X4	1.50	1.58
PUSH BROOM CLAMP	X5	2.00	2.10
SKILCRAFT DETERGENT 16-OZ	X9	1.25	1.31
PEN	X10	.80	.84

## PUBLIC NOTICE

### THE STATE OF TEXAS COUNTY OF WICHITA In the Name and by the Authority of The State of Texas

To: Bernice H. Reid, Executrix under the Will of Julia Jones, whose residence is unknown, L.L. Blackburn and W.H. Free, Co-Executors under the Will of Aline Harral, whose residence is unknown, Lucile H. Davis, Carolyn L. Harral, Madge E. Anderson, Cora Capps, and Mary G. Trent, whose residence is unknown, and the respective unknown heirs and legal representatives of all the above named parties, the unknown owner or owners of the hereinafter described property and their heirs and legal representatives, whose names and places of residence are unknown, and any and all other persons, including adverse claimants, owning, or having, or claiming any legal or equitable interest in or lien upon the hereinafter described property delinquent to plaintiffs herein for taxes.

**YOU ARE HEREBY NOTIFIED** that suit has been brought and is now pending in the Honorable District Court, 78th Judicial District, Wichita County, Texas, wherein The City of Wichita Falls, joined by the Wichita Falls Independent School District, the Wichita Falls Junior College District, and the City of Wichita Falls both for itself, and as successor to all property and assets of any kind of the Wichita County Water Control and Improvement District No. 1, State of Texas and County of Wichita are plaintiffs; and all those first named in this Writ and to whom the same is directed are defendant, by the filing by said plaintiffs of a petition on the 16th day of February, 1979 and the file number of said suit being No. 35,908-B and the nature of which is a suit to collect delinquent ad valorem taxes on the following described property to-wit: Lots No. Ten (10), Eleven (11), Twelve (12), Thirteen (13), Fourteen (14), Fifteen (15), Sixteen (16), Seventeen (17), Eighteen (18), Block No. Thirty-four (34) of the Kemp Addition to the City of Wichita Falls, Wichita County, Texas, together with interest, penalties, costs, charges, and expenses of suit which have accrued and which may legally accrue thereon.

The amount of taxes due each plaintiff, exclusive of interest, penalties and costs is as follows: The City of Wichita Falls, \$63.49; Wichita Falls Independent School District, \$63.81; Wichita Falls Junior College District, \$62.21; The City of Wichita Falls both for itself, and as successor to all property and assets of any kind of the Wichita County Water Control and Improvement District No. 1, \$2.25; State of Texas, \$13.08; County of Wichita, \$38.32; TOTAL, \$187.16.

The names of all taxing units which assess and collect taxes on said property not made party to this suit are None.

Plaintiff and all other taxing units who may set up their tax claims herein seek recovery of delinquent ad valorem taxes on the property hereinabove described, and in addition to the taxes all interest, penalties, and costs allowed by law thereon up to including the day of judgment herein, and the establishment and foreclosure of liens, if any securing the payment of same, as provided by law.

All parties to this suit, including plaintiff, defendants, and intervenors, shall take notice that claims not only for any taxes which were delinquent on said property at the time this suit was filed but all taxes becoming delinquent thereon at any time thereafter up to the day of judgment, including all interest, penalties, and costs allowed by law thereon, may, upon request therefor, be recovered herein without further citation or notice to any

parties herein, and all said parties shall take notice of and plead and answer to all claims and pleadings now on file and which may hereafter be filed in said cause by all other parties herein, and all of those taxing units above named who may intervene herein and set up their respective tax claims against said property.

You are hereby commanded to appear and defend such suit by filing a written answer at or before 10 o'clock a.m. on the first Monday after the expiration of forty-two (42) days from and after the date of issuance hereof, the same being the 4th day of June, A.D. 1979 (which is the return day of such citation), before the honorable District Court of Wichita County, Texas, to be held at the courthouse thereof, then and there to show cause why judgment shall not be rendered for such taxes, penalties, interest and costs, and condemning said property and ordering foreclosure of the constitutional and statutory tax liens thereon for taxes due the plaintiff and the taxing units parties hereto, and those who may intervene herein, together with all interest, penalties, and costs allowed by law up to and including the day of judgment herein, and all costs of this suit.

Issued and given under my hand and seal of said court in the City of Wichita Falls, Wichita County, Texas, this 16th day of April, A.D. 1979.  
WAYNE WIGGINS  
Clerk of the District Courts  
Wichita County, Texas  
78th Judicial District.  
By /s/ Carolyn Rich  
Deputy

### THE STATE OF TEXAS COUNTY OF WICHITA In the Name and by the Authority of The State of Texas

To: W.B. Richardson, whose residence is unknown, and the respective heirs and legal representatives of all the above named parties, the unknown owner or owners of the hereinafter described property and their heirs and legal representatives, whose names and places of residence are unknown, and any and all other persons, including adverse claimants, owning, or having, or claiming any legal or equitable interest in or lien upon the hereinafter described property delinquent to plaintiffs herein for taxes.

**YOU ARE HEREBY NOTIFIED** that suit has been brought and is now pending in the Honorable District Court, 30th Judicial District, Wichita County, Texas, wherein The City of Wichita Falls, joined by the Wichita Falls Independent School District, the Wichita Falls Junior College District, and the City of Wichita Falls both for itself, and as successor to all property and assets of any kind of the Wichita County Water Control and Improvement District No. 1, State of Texas, \$13.08; County of Wichita, \$38.32; TOTAL, \$187.16.

The names of all taxing units which assess and collect taxes on said property not made party to this suit are None.

Plaintiff and all other taxing units who may set up their tax claims herein seek recovery of delinquent ad valorem taxes on the property hereinabove described, and in addition to the taxes all interest, penalties, and costs allowed by law thereon up to including the day of judgment herein, and the establishment and foreclosure of liens, if any securing the payment of same, as provided by law.

Water Control and Improvement District No. 1, \$1.23; State of Texas, \$32.20; County of Wichita, \$83.16; TOTAL, \$483.98.

The names of all taxing units which assess and collect taxes on said property not made party to this suit are None.

Plaintiff and all other taxing units who may set up their tax claims herein seek recovery of delinquent ad valorem taxes on the property hereinabove described, and in addition to the taxes all interest, penalties, and costs allowed by law thereon up to including the day of judgment herein, and the establishment and foreclosure of liens, if any securing the payment of same, as provided by law.

All parties to this suit, including plaintiff, defendants, and intervenors, shall take notice that claims not only for any taxes which were delinquent on said property at the time this suit was filed but all taxes becoming delinquent thereon at any time thereafter up to the day of judgment, including all interest, penalties, and costs allowed by law thereon, may, upon request therefor, be recovered herein without further citation or notice to any parties herein, and all said parties shall take notice of and plead and answer to all claims and pleadings now on file and which may hereafter be filed in said cause by all other parties herein, and all of those taxing units above named who may intervene herein and set up their respective tax claims against said property.

You are hereby commanded to appear and defend such suit by filing a written answer at or before 10 o'clock a.m. on the first Monday after the expiration of forty-two (42) days from and after the date of issuance hereof, the same being the 4th day of June, A.D. 1979 (which is the return day of such citation), before the honorable District Court of Wichita County, Texas, to be held at the courthouse thereof, then and there to show cause why judgment shall not be rendered for such taxes, penalties, interest and costs, and condemning said property and ordering foreclosure of the constitutional and statutory tax liens thereon for taxes due the plaintiff and the taxing units parties hereto, and those who may intervene herein, together with all interest, penalties, and costs allowed by law up to and including the day of judgment herein, and all costs of this suit.

Issued and given under my hand and seal of said court in the City of Wichita Falls, Wichita County, Texas, this 16th day of April, A.D. 1979.  
WAYNE WIGGINS  
Clerk of the District Courts  
Wichita County, Texas  
30th Judicial District.  
By /s/ Carolyn Rich, Deputy

### THE STATE OF TEXAS COUNTY OF WICHITA In the Name and by the Authority of The State of Texas

To: Alma J. McCormick, whose residence is unknown, Bill Potts, whose residence is unknown, and the respective unknown heirs and legal representatives of all the above named parties, the unknown owner or owners of the hereinafter described property and their heirs and legal representatives, whose names and places of residence are unknown, and any and all other persons, including adverse claimants, owning, or having, or claiming any legal or equitable interest in or lien upon the hereinafter described property delinquent to plaintiffs herein for taxes.

**YOU ARE HEREBY NOTIFIED** that suit has been brought and is now pending in the Honorable District Court, 89th Judicial District, Wichita County, Texas, wherein The City of Wichita Falls, joined by the Wichita Falls Independent School District, the Wichita

Falls Junior College District, and the City of Wichita Falls both for itself, and as successor to all property and assets of any kind of the Wichita County Water Control and Improvement District No. 1, State of Texas and County of Wichita are plaintiffs; and Alma J. McCormick and Bill Potts are defendants, by the filing by said plaintiffs of a petition on the 16th day of February, 1979 and the file number of said suit being No. 35,906-C and the nature of which is a suit to collect delinquent ad valorem taxes on the following described property to-wit: Lot No. Eighteen (18), Block No. Six (6) of the Hillcrest Addition to the City of Wichita Falls, Wichita County, Texas, known as 1232-32nd Street in said City, together with interest, penalties, costs, charges, and expenses of suit which have accrued and which may legally accrue thereon.

The amount of taxes due each plaintiff, exclusive of interest, penalties and costs is as follows: The City of Wichita Falls, \$117.15; Wichita Falls Independent School District, \$140.08; Wichita Falls Junior College District, \$7.27; State of Texas, \$16.05; County of Wichita, \$44.17; TOTAL, \$324.72.

The names of all taxing units which assess and collect taxes on said property not made party to this suit are None.

Plaintiff and all other taxing units who may set up their tax claims herein seek recovery of delinquent ad valorem taxes on the property hereinabove described, and in addition to the taxes all interest, penalties, and costs allowed by law thereon up to including the day of judgment herein, and the establishment and foreclosure of liens, if any secured the payment of same, as provided by law.

All parties to this suit, including plaintiff, defendants, and intervenors, shall take notice that claims not only for any taxes which were delinquent on said property at the time this suit was filed but all taxes becoming delinquent thereon at any time thereafter up to the day of judgment, including all interest, penalties, and costs allowed by law thereon, may, upon request therefor, be recovered herein without further citation or notice to any parties herein, and all said parties shall take notice of and plead and answer to all claims and pleadings now on file and which may hereafter be filed in said cause by all other parties herein, and all of those taxing units above named who may intervene herein and set up their respective tax claims against said property.

You are hereby commanded to appear and defend such suit by filing a written answer at or before 10 o'clock a.m. on the first Monday after the expiration of forty-two (42) days from and after the date of issuance hereof, the same being the 4th day of June, A.D. 1979 (which is the return day of such citation), before the honorable District Court of Wichita County, Texas, to be held at the courthouse thereof, then and there to show cause why judgment shall not be rendered for such taxes, penalties, interest and costs, and condemning said property and ordering foreclosure of the constitutional and statutory tax liens thereon for taxes due the plaintiff and the taxing units parties hereto, and those who may intervene herein, together with all costs of this suit.

Issued and given under my hand and seal of said court in the City of Wichita Falls, Wichita County, Texas, this 16th day of April, A.D. 1979.

WAYNE WIGGINS  
Clerk of the District Courts  
Wichita County, Texas  
89th Judicial District  
By /s/ Carolyn Rich  
Deputy



## Bynum elected P-TA president

Jo Bynum was elected president of the Holliday P-TA.

Other officers include Carol Parker, first vice president; Lorita Allen, second vice president; Ann Bills, third vice president; Linda Carr, secretary; and Linda Beavers, treasurer.

Chairmen include Vicki Rivkin, parliamentarian; Patsy Shawver, historian;

Connie York, yearbook; Janice Loftis, cultural arts; Dana Crabbs, nursery; Marty McClendon, projects; Joyce Rasmussen, publicity; and Linda Rogers, telephone.

Members of the nominating committee were Vicki Rivkin, Ann Bills, Sandy Finnell, Lorita Allen and Linda Rogers.

Dr. Barbara Brewer, director of counseling for

Electra public schools, spoke at the April 23 Holliday P-TA meeting.

She presented a film, "Kids, Parents and Peer Pressure" and conducted a

round table discussion.

Dr. Brewer holds degrees from Baylor University, Midwestern State University and Western Colorado University.

## Beginners to register

Students who will be entering Holliday's kindergarten next year will register and spend their first day in the classroom May 14, said Dan Owen, principal.

New students and their parents are asked to report to the kindergarten room at 8 a.m. May 14. Regardless of whether they will be attending the first or second semester, all new kindergar-

ten students are urged to attend.

According to Owen's outline, the new students will spend the entire day on campus before being dismissed at 2:30 p.m.

They will be oriented in first grade classrooms. Regular first grade students will be allowed a holiday during the orientation for kindergarten students, Owens said.

## Absentee vote opens

Holliday residents have until May 16 to cast absentee ballots in the coming special election for mayor and Place 5 councilman.

Absentee ballots may be cast from 8 a.m. until 5 p.m. weekdays at Holliday City Hall. Regular voting will be May 22.

Candidates who are seeking the mayor's post are Mary Nell Killian, Leo Chappell, Mary Denney and Tom Hall.

The Place 5 city council runoff will be between John Goforth and Rodney Hodgkins, who both received 123 votes in the regular election.

## PUBLIC NOTICE

**NOTICE OF CITY OFFICERS' ELECTION**  
(Aviso De Eleccion De Funcionarios De La Ciudad)

**HOLLIDAY, TEXAS**

Notice is hereby given that a City Officers' Election will be held on the 22nd day of May, 1979, in the above named city for the purpose of electing the following officers for said city: Mayor, Alderman, Place 5. Said election will be held at the following polling places in said city: In Election Precinct No. 1, at Community Center Building.

The polls at each of the above designated polling places shall on said election day be open from 7:00 o'clock a.m. to 7:00 o'clock p.m.

The absentee voting for the above designated election shall be held at City Hall Building, in said city, and said place of absentee voting shall remain open for at least 8 hours on each day of absentee voting which is not a Saturday, Sunday or an official State holiday, beginning on the 20th day and continuing through the 4th day preceding the date of said election. Said place of voting shall remain open between the hours of 8:00 o'clock a.m. and 5:00 o'clock p.m.

Dated this the 23rd day of April, 1979.

(Se da aviso por la presente que se llevara a cabo una Eleccion de Funcionarios de la Ciudad el dia 22 de May de 1979, en la ciudad arriba mencionada para el proposito de elegir a los siguientes funcionarios para dicha ciudad: Alcalde, Concejales, Place 5 Comisionados. Dicha eleccion se llevara a cabo en los siguientes lugares de votacion en dicha ciudad: El Precinto Electoral Num. 1 en el Edificio Community Center.

Los sitios de votacion arriba designados para dicha eleccion se mantendran abiertos en el mencionado dia de elecciones de las 7:00 a.m. a las 7:00 p.m.

La votacion ausente para la eleccion arriba designada se llevara a cabo en el Edificio City Hall, en dicha ciudad, y dicho lugar de votacion ausente se mantendra abierto por lo menos ocho horas en cada dia de votacion ausente no siendo sabado, domingo o dia festivo oficial del Estado, principiando 20 dias y continuando hasta el cuarto dia anteriores a la fecha de dicha eleccion. Dicho lugar de votacion se mantendra abierto de las 8:00 a.m. a las 7:00 p.m.

Fechado esta dia 23 de April de 1979.)

James W. Virdell  
Mayor (Alcalde) Pro-Tem

## HHS Who's Who are announced

Outstanding students in 11 areas of academics have been selected to Holliday High School's Who's Who for 1978-79.

Listed according to field of accomplishment, they are:

**ENGLISH**—Clay Morgan, Suzan Dillard, Terry Moser, Julie Lemons, Lucretia Halencak, Doug Peters, Carla Lear, Kent Lilley, Kelly Morgan, Jody Collier, Teresa Bryan, Ellen Parker, Katie Williams and Gary McKay.

**HISTORY AND CIVICS**—Cindy Davis and Dennis Holt.

**SCIENCE**—Cindy Davis, Kelly Morgan, Gary McKay, Neil White, Joel Mankins and Angie Tinsley.

**MATH**—Kent Lilley, Kelly Morgan, Joel Mankins, Teresa Borton, Ellen Parker, Julie Baggett, Lisa Talley and Gary McKay.

**SPEECH**—Jamie Honea.

**DRAMA**—Kip Wood and Karen Wilkison.

**SPANISH**—Cheryl Cunningham.

**JOURNALISM**—Larry Denney, Teresa Bryan, Tammie Wylie and Kelly Morgan.

**BAND**—Kelly Morgan, Katie Williams, Larry Henry and Bill Holton.

**BUSINESS**—Kristi Lucy, Penny Parnell, Clay Morgan, Teresa Borton, Tammie Wylie, Jody Collier, Gary McKay and Steve Parnell.

**HOMEMAKING**—Brenda Flatt and Judy Sebastian.

## HOLLIDAY NEWS

**STATE BOUND**—Holliday's Lady Eagles sprint relay team will venture to Austin for Saturday's 1 p.m. running of the Class A state finals. The state bound turf burners are, from bottom to top, Laura Holt, Cathy Halencak, Nancy O'Neal and Suzan Dillard with Coach Cody West. Lonnita Moore also will make the trip as an alternate.

## High school, junior high honor rolls

Honor rolls for Holliday High School and junior high have been released by Bill Crabbs, principal.

**Seniors**—Stanley Craddock, Cheryl Cunningham, Larry Denney, Dennis Holt, Laurie Mauldin, Gary McKay, Judy Sebastian, Katie Williams, Julie Baggett, DeDe Leonard, Lisa Talley.

**Juniors**—Jody Collier, Kelly Morgan, Paula Sanders, Donna Walker, Karen Wilkison, Beth Barry, Teresa Borton, Contessa Guthrie, Cathy Halencak, Mindy Lowder, Cindy Martin, Lonnita Moore, Ellen Parker, Lou Thomas, Gregg Tinsley.

**Sophomores**—Lucretia Halencak, Laura Holt, Carla Lear, Kent Lilley, Doug Peters, Angie Tinsley, Sheryl Boyd, Kristi Lucy, Carl Martin, Jo Marushia, Susan Wylie.

**Freshmen**—Cindy Davis, Suzan Dillard, Brad Hardin, Julie Lemons, Brad Harmon, Joel Mankins, Clay Morgan, John Pearson, Pam Rogers, Terri Moser, Ronald McDaniel, Susan Parker.

**Eighth Grade**—Jeff Belcher, Kay Flatt, Gil Gilbert, Barry Hardin, Debbie Long, Kendall Stone, Johnny Trainham, Kristi Carlton.

**Seventh Grade**—Guy

Gilmore, Tony Gomez, Darrin Hawley, Susan Lowe, Leslie Mankins, Melissa Parish, Robert Rasmussen, Stephen Snider, Jay Burks, Deborah Noll, Pat O'Brien, Annette Wilhelm.

## Track meet is Tuesday

The Holliday elementary track meet is scheduled to begin at 12:45 p.m. Tuesday, said Dan Owen, principal.

Owen said there would be about 350 entries from Holliday's kindergarten and elementary schools in the meet to be held on the high school track.

## Lioness Club

Women interested in helping organize a Lioness Club here are asked to meet at the Holliday Lions Club Building at 7:30 p.m. Monday.

## Cheerleaders are selected

Next year's varsity cheerleaders for Holliday High School were selected during student elections Monday.

Penny Parnell, a junior, was picked head cheerlead-

er. Other cheerleaders include Kim Addison, senior; Carla Cottrell, sophomore; Carla Lear, junior; Debbie Long, freshman; Kristi Lucy, junior; and Lonnita Moore, senior.

# EARN \$483.82

## IN 182 DAYS

By depositing \$10,000 in a  
**Parker Square Savings 6-Month  
Money Market Certificate at**

# 9.570% PER ANNUM

At the end of 182 days, your \$10,000 Money Market Certificate is worth \$10,483.82

Rates subject to change at maturity. Substantial penalty if withdrawn prior to maturity. Federal regulations prohibit compounding of interest during the term of the account.

Fully Insured.

## PARKER SQUARE Savings

ESLIC

ONE PARKER SQUARE  
WICHITA FALLS

111 S. Main, Henrietta  
301 N. Wall, Iowa Park

315 S. Ave. D, Burk Burnett  
Southwest Pkwy., Rhee Rd.



**WICHITA WESTERN WORLD**  
3709 Call Field Rd. — One Blk. West of Sikes

# GRAND Re-Opening SALE

**TUESDAY—MAY 1**

**DAMAGED MERCHANDISE DRastically REDUCED**

TO MAKE ROOM FOR NEW ITEMS!

**HUGE SAVINGS**

IN EVERY DEPARTMENT

**DISASTER VICTIMS** WILL RECEIVE ADDITIONAL **10% DISCOUNT** THIS WEEK ON ALL SALE AND REGULARLY PRICED MERCHANDISE! **SAVE!**

Men's & Ladies  
**Tony Lama BOOTS \$39.95**

PLEASE, NO REFUNDS, EXCHANGES OR LAY-A-WAY ON SALE ITEMS!

**STORE IS REPAIRED AND COMPLETELY RESTOCKED!**

**LADIES & BOYS & MENS CLOTHING**

**REDUCED 50% TO 75% LOTS OF LADIES**

**BLOUSES, PANTS & SUITS**

**SPECIAL COWBOY TORNADO DODGER BOOTS \$16.95**

**"Cowboy Boot Headquarters"**

**WICHITA WESTERN WORLD**

3709 Call Field Road  
WICHITA FALLS, TEXAS





### Iowa Park Chapter 42 Order of Eastern Star

Stated meetings 2nd & 4th Tuesday  
700 W. Washington 7:30 p.m.

### PLANTS

Quality • Variety • Service  
Reasonable Prices  
Herbs - Good Selection

## BAKER'S Greenhouse

On Bell Rd. mile south of Old IP Road  
(Experiment Farm Rd.)

### Iowa Park Equipment Co.

301 W. Lafayette 592-5979

Building Pipe & Rods: 1 inch thru 10 inc. 2 3/8 & 2 7/8  
inch ODEUE 8-round Testing Tubing. 1 1/4" - 2" OD &  
2 1/16" OD Injection Lines. 100 Barrel Salt Water  
Tank. 5/8, 3/4, 7/8 Down Hole Sucker Rods.

Take Notice -- New Shop Phone is

592-4242

## Scholarship for Foster

Christopher Lee Foster of Iowa Park, a Texas A&M University sophomore, has been awarded the W.J. "Bill" Hubbell Memorial Scholarship in Agriculture. Foster, son of Jimmie F. Foster, Rt. 2, Iowa Park, was selected for the award on the basis of his academic record, leadership, financial need and continuing interest in the meats industry. He has a grade point ratio of 2.7 on a four-point scale. He is an animal science major at Texas A&M, the state's oldest public university with the world's largest college of agriculture.

### IOWA PARK LODGE No. 713 A.F. & A.M.

700 W. Washington 592-5506  
Stated Meeting 7:30 P.M. 2nd Thursday  
Chester Morrison W.M. . . . . 855-6420  
Taylor George Sec. . . . . 592-5234



Richard C. Carver D.D.S.

### General Dentistry

315 N. Wall Phone 592-5141  
Iowa Park, Texas

## Improvements set for area highways

The State Highway and Public Transportation Commission has approved \$238 million program of highway rehabilitation and improvement in every part of the state.

The program includes rehabilitation work, safety improvements and general betterment of U.S. and State Highways and Farm to Market Roads.

A total of 845 projects in 203 counties are involved

with more than 72 percent of the work scheduled for state and federal numbered highways.

Altogether, the program will result in improvements on 5,253.5 miles of the 71,000 mile state maintained highway network.

District Engineer Bob Schleider of Wichita Falls said projects included in the program in Wichita County are:

...On Loop 370 from Johnson Road in Iowa Park to FM

1814, a distance of 2.4 miles, seal coat at a cost of \$30,600.

...On Loop 370 from Loop 11 to the Scott Street Railroad Overpass, a distance of 2.0 miles, additional surfacing at a cost of \$98,200.

...On SH 240 (in Wichita and Wilbarger Counties) from US 287 to SH 25, a distance of 6.2 miles, seal coat at a cost of \$48,700.

...On FM 368 at Antelope Creek near FM 1206, a distance of 0.3 miles, widen

bridge and reconstruct approaches, at a cost of \$85,500.

...On FM 368 from SH 258 to FM 1206, a distance of 2.7 miles, seal coat at a cost of \$19,800.

...On FM 2326 from SH 25 to the Wilbarger County Line, a distance of 4.1 miles, seal coat at a cost of \$31,000.

...On FM 1180 from the Wichita River to the Archer County Line, a distance of 3.6 miles, seal coat at a cost of \$24,200.

**All Realtors have to offer is service. We pledge equal effort, interest and fairness to both buyer and seller.**

**MEMBER: Multiple Listing Service**  
Wichita Falls Board of Realtors



Full Time Professionals

# WHISNAND REALTORS 592-2153

404 West Park in Park West Shopping Center

L.S. WHISNAND  
Broker  
592-2365

BOBBY WHISNAND  
Manager  
592-2413

CHARLES QUICK  
Sales Associate  
592-5194

RANDY HARRIS  
Sales Representative  
692-0878

CLETYS STILES  
Sales Representative  
592-5785

PAT CARTER  
Sales Representative  
592-5417

BILLY L. McDONALD  
Sales Representative  
592-4338

**We have rural acreage - 32 acres and up - and will build to your specifications -**

### 209 E. Garden

- Year Old
- 3 Bedroom
- 1 1/2 Baths
- Central Heat/Air

Sales Price \$29,500



### 410 E. Ruby

Over 1,500 sq. ft., 2 bedrooms, 2 full baths, huge living and den combination, central H/A, big screened back porch, lots of big trees, all built-ins, workshop & storage area, completely fenced, on 2 1/2 lots.

Appraisal Value \$30,000



### 907 Park Plaza

- 3 Bedrooms
- 1 1/2 Baths
- All tile
- Central Heat/Air
- New central unit

Sales Price \$28,000



### Home On LAKE KICKAPOO

Beautiful house with beautiful view. 2 large bedrooms, large kitchen, dining area. Large den with fireplace. 2 baths. Double car garage. Completely furnished, all furniture and appliances less than one year old. Fenced. Boat storage with electric wrench.

Sales Price  
**\$33,000**

**For A Quick Sale - Call Us - We Buy Equities**

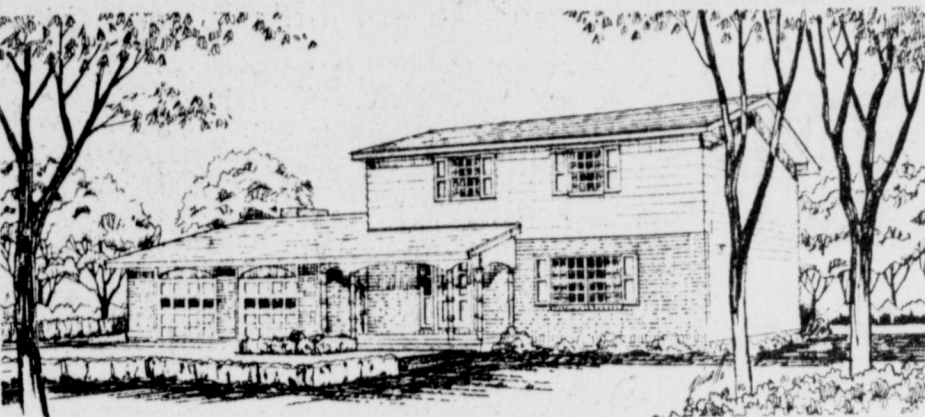

**Model R16-9**  
From 1673 sq. ft. to 1862 sq. ft.

Traditional two-story elegance that features three spacious bedrooms and two one-half baths. Den converts easily to fourth bedroom, nursery or library. Lots of living space in the Kingsberry Reading. Available in basement foundation too.

**Model R12-17**  
From 1200 sq. ft. to 1365 sq. ft.

Three bedrooms, private master bath - efficient "L" shaped kitchen - convenient living area - large family room with double closet for extra storage - separate laundry room - modern ranch style exterior with decorator bay window are just a few of the many features designed into making this a family styled "Home". See your Kingsberry builder today!

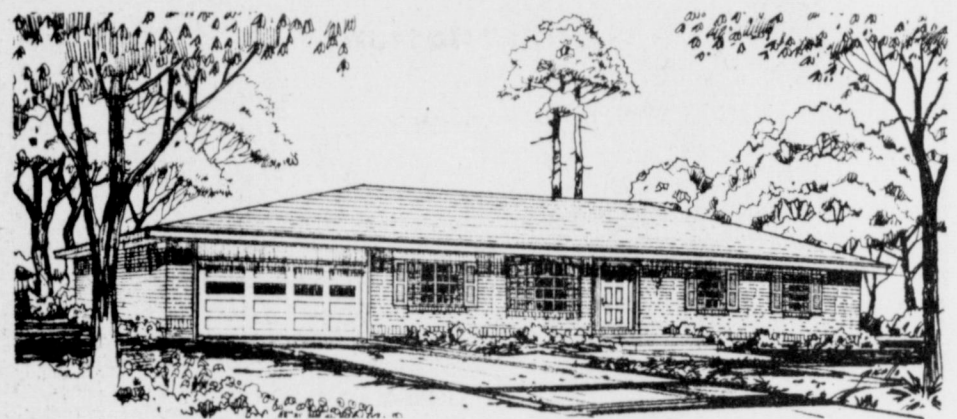

**Model N13-9**  
From 1385 sq. ft. to 1435 sq. ft.

Truly a "house of good taste" is the Kingsberry Norwood, combining features usually found in higher priced homes, at a price to suit your budget. Three spacious bedrooms, entry foyer, rear-set living room and a seventeen foot long family room promise easy, care-free living for your family. Various options let you "plan" the Norwood to suit your every need and want. Optional basement foundation.



**Model B16-4**  
From 1612 sq. ft. to 1657 sq. ft.

The praise-winning design of the Bordeaux features total livability throughout. As you enter through the large foyer you'll notice the beautiful raised ceiling. The large 1600 square foot-plus floor plan centers around the huge family room. Three bedrooms - including an extra large master suite, and 2 baths and many other features, give the Bordeaux the look and feel of luxury at an affordable price. Basement version available.

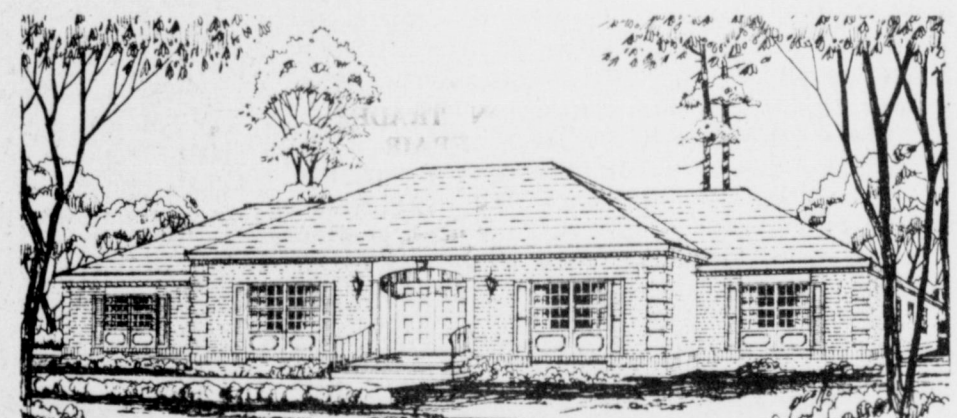

**....built by Range Construction and offered exclusively by Whisnand Realtors.**

All bricked, central heat and air conditioning, double thick glass and R-26 factor insulation. Meets FHA, VA, Farmers Home Adm. and HUD specifications.

**Kingsberry Homes Speak for Themselves.**

#### WITH QUALITY

Kingsberry Homes are designed under the supervision of architects and engineers, and manufactured under conditions of rigid quality control. A high degree of automation insures every piece fits exactly the way it should. Precision tools practically eliminate error and result in maximum strength and stability. And our quality control also includes close checks on and constant testing and evaluation of the quality of all materials. That's why a Kingsberry Home, with its superior materials and workmanship, is more home for your money and a great help when it comes to financing.

#### WITH OPTIONS

Our wide variety of options lets you tailor a Kingsberry Home to fit your taste, and your budget. We give you a choice from the ground up and the inside out. Beginning with flexible floor plans that you can adjust to suit your needs. On most models, you can choose from crawl space, slab, pier or basement foundations. Eight-panel to sliding glass doors. All sorts of windows, lighting fixtures and hardware. Designer cabinets for bath. And, of course, brand name appliances. We offer a variety of popular exterior sidings. Everything from redwood to full, or half brick veneer. Optional decks, patios, garages and carports also add special outside touches. So, you see, a Kingsberry Home really is your own personalized creation.

#### ENERGY SAVING

It's been part of every Kingsberry Home for decades. For instance, they've offered batt fiberglass wall insulation since 1965 and insulated metal doors since 1970. Today, you have almost as many energy saving options available as you do beautiful Kingsberry Homes to choose from. Kingsberry Homes are engineered with Boise Cascade's experience - and built with ours - for your energy efficient living. So listen to the Kingsberry Homes Energy-Mizer, when it comes to energy saving, come to us.



Full Time Professionals

# WHISNAND REALTORS 592-2153

404 West Park in Park West Shopping Center



# person-to-person want ads really work!

## DEADLINES:

10 A.M. WEDNESDAY  
[Word Ads Only]

4 P.M. TUESDAY, DISPLAY ADS  
[With Borders]

## DIAL 592-4431

— SAVE 5' FIRST INSERTION BY PAYING WITH COPY —

## RATES:

10' PER WORD FIRST INSERTION

5' PER WORD EACH REPEAT

**Dietrichson Construction Co.**  
"Remodeling - Alterations - Additions"

Dick Dietrichson  
Iowa Park, Texas  
592-2414

Free  
Estimates

Don Dietrichson  
Iowa Park, Texas  
592-2232

**COOLER IN SUMMER  
WARMER IN WINTER**

## INSULATION!

### HoJak Insulation

★ Attic & Wall Insulation

★ Norco Storm Windows

15% Tax Credit

Call Now for Free Estimate

HOGYE HOGLE 495-2770  
ELECTRA

JACK KERR 592-9040  
IOWA PARK

## Looking for Help?

We have students available for part-time work after school, on weekends, and during the summer vacation. Some of the Senior Class will be available for full-time employment at the end of May, while others will be attending college this fall and are looking for full-time employment this summer and part-time starting in September. If you need part-time or full-time help in any of the following areas, give us a call:

**AUTO MECHANICS -- YARD WORK -- STOCK CLERKS -- BABY SITTERS -- PAINTERS -- WELDERS -- CLEAN-UP WORK -- WAREHOUSE WORKER -- RETAIL SALES -- CLERICAL WORKERS -- HOUSE CLEANING -- ALL BUILDING AND CONSTRUCTION TRADES -- HORTICULTURE -- AUTO BODY REPAIR -- OIL FIELD WORKER -- AGRICULTURE WORKER -- SERVICE STATION ATTENDANTS -- LICENSED COSMETOLOGIST -- OR if you have needs in other areas, we might be able to help.**

The Placement Coordinator has interviewed 195 students seeking employment and recorded their training abilities, work experience and interest. Their attributes will be matched with request from employers for needed workers for both full-time and part-time work, and one or more students will be referred to the employer for final selection. This is a free service.

If the Placement Service can be of any help to you, please telephone Richard Davis at 592-2371.

**Iowa Park High School  
Job Placement Service**

"Dedicated to bring employer and employee together"

**Nearby 1 Acre** - 5-room house. New wiring, new plumbing. Gorgeous garden, fruit orchard. Several out buildings. In Wichita Falls - \$14,500.

**3 Bedroom**, double fireplace, formal living & separate den, dining, corner lot. Office or nursery. 3 years old. Builder's home, beautifully decorated, 2000 sq. ft. living area. \$60,000.

**Burkburnett** 1700 sq. ft. living area, 3 bedroom, ready to move into. New roof, new air conditioning unit, corner lot, double car garage, fruit bearing trees. The house is in excellent condition, painted inside & out. Assume 8 1/2% loan. Balance, \$35,000.

**Older Home** - Over 1700 sq. ft. of living area. Huge living, formal dining - French doors, fireplace, lots of cabinets, lots of closets. Lots of fruit trees. Great potential. Iowa Park - \$26,500.

**5 Bedroom** - 2 story, 1 car garage, double carport, formal living room, separate formal dining, 2 full baths, fireplace in den, all built-ins, beautifully decorated. Immediate possession, 2200 sq. ft. living area, 2 storage buildings in back. Close to schools. \$60,000.

**2 Bedroom** - Insulated siding, large paneled living, separate dining, double carport, corner lot. \$14,500.

Charles Chandler, Realtor  
691-1420 3500 McNeil

**Century 21**

**SHIRLEY RAINS**  
Sales Associate

Call Me - 592-4248 - Anytime

Each office is independently owned and operated.

## 4-H NEWS

Would your family and you like to stay home and help build world understanding? Then become involved in the 4-H International Foreign Exchange Program (IFYE) according to Nancy Lehman, Area 4-H and Youth Specialist with the Texas Agricultural Extension Service.

Between the middle of May and the end of November, Texas 4-H families have an opportunity to host IFYE delegates from the Netherlands, United Kingdom, Switzerland, and France. This includes young men from France, Switzerland, and the United Kingdom, and a young woman from the Netherlands. Families will have an IFYE as a family member for two to three weeks.

County Extension Agents have more information about the IFYE's and host application blanks. Indicate your interest by becoming involved. Your family will grow and share through the experience.

"The Out-of-Doors - A New Dimension" is the theme of camps for all ages of 4-Hers that will be held at Texas 4-H Center this summer. Program activities will include canoeing, archery, fishing, and outdoor cooking, according to Nancy Lehman. There will be additional recreation, song-fests, campfire activities, and skits.

The modern lodges will be filled with 4-Hers of different ages at different times: July 15-18, 15 and over; July 18-20 and August 1-3, 11 and under; July 22-25 and July 29 - August 1, 12 to 14 year old 4-Hers.

The Texas 4-H Center is located high on a wooded hill overlooking Lake Brownwood. During summer camp, boys and girls will have a chance to meet 4-Hers from across the state of Texas.

The staff will include college age past 4-Hers, adult leaders, county Extension agents, and resource people. Adult leaders still are needed for the various camps. You will be a coordinator in lodges and assist with program activities. Leaders will receive food and lodging free of charge and round trip mileage or 12c per mile.

Cost for 4-Hers is \$48.75 for those ages 12 and over and \$33.75 for the younger campers. Registrations will need to be sent in earlier along with a \$10.00 fee.

**FREE ESTIMATES**  
438-2876

**WOLFE CONSTRUCTION**

\*Painting \*Roofing  
\*Remodeling \*Additions

**BATTERIES**  
for most

**HEARING AIDS**  
and  
**TIMEX WATCHES**  
at  
**PARK PHARMACY**  
115 PARK

**TROPHY TAVERN**  
Billy and Jessalea Toft

**TROPHIES  
RIBBONS  
PLAQUES**

We guarantee faster service, cheaper prices.

**723-8109 - 723-2673**

## HOME SERVICES

**CUSTOM ROTOTILLING**, leveling, mowing and post-hole digging; new tractor and equipment. Danny Conley 592-2374.

5-3-1tp

**HOUSE PLANS** 592-9365.

4-19-6tp

**WILL DO** housework. Phone 592-4964.

5-3-1tp

**CHILD CARE** in my home, references, reasonable rates, good meals, fenced yard. 592-4312

4-12-5tp

**PHOTOGRAPHY** by Chris. Weddings, family reunions, home portraiture. 438-2367.

4-12-22tp

**WANTED ALTERATIONS** men or women. Years of experience. Reasonable price, fast service. 592-2057.

4-26-4tp

**AMWAY PRODUCTS**

592-2298.

4-26-4tp

**MARY KAY COSMETICS**, Allie Girard, consultant, 109 W. Poe, 592-4217.

4-5-tfe

**HOUSE PAINTING** - Call for free estimate, John D. Fecher. Phone 592-4472.

12-30-tfe

**RELIABLE PLUMBING** and Heating Repair. Harry Skinner, Owner. 592-5674. Complete sewer cleaning and repair.

11-9-8tp

**ROTOTILLING** and lawn mowing 592-2542.

4-26-4tp

**MORAN MONUMENT** Works, Vernon, Texas, Old Highway 287, near East View Cemetery. A good selection of granites, cemetery lettering, grass markers, vases of bronze and marble.

9-30-tfe

**PRIVATE FENCE** sales and installation. Charles Skelton, phone 592-5190.

6-22-tfe

**ROOFING** - Wolfe Roofing Co. Phone 438-2876.

5-5-tfe

**NEED FILL SAND?** - Call Donald Hallum. 592-4365.

804 N. Wall, Iowa Park.

11-25-tfe

**JERRY'S VINYL REPAIR**, recoloring, auto, furniture, commercial. Free estimates. 438-2243.

2-23-tfe

**POODLE GROOMING** - Call 592-4766 for appointment. Tom Barnett, 520 W. Alameda.

3-3-tfe

## HOME FOR SALE.

UNDER construction in Iowa Park. Farmers Home Financing. Low down payment; payments based on income. 3 bedrooms, 1 1/2 baths, garage, heat-air, built-in cook stove, carpeted. SWAN CONSTRUCTION, 692-8788.

2-1-tfe

## MISC. FOR SALE

**GARAGE SALE** - 716 W. Texas. Thursday through Saturday. Furniture, men, women and children's clothing, bedspreads, curtains, dishes. Lots of misc.

5-3-1tp

**FIVE FAMILY** carport sale Thursday, Friday. 304 W. Diamond St.

5-3-1tp

'66 MUSTANG, automatic, new tires and paint job. Excellent condition. Ph. 592-5523.

5-3-2tc

**1968 FORD** sedan \$250. Call after 5, 592-5293.

5-3-1tp

**FOR SALE** Spanish style sofa. Beautiful woodwork. Needs upholstery. \$75. Call 592-5518.

5-3-1tp

## BUSINESS

**SHOTGUN** reloading components. CCI primers - \$11.25 thousand, Red Dot powder - \$4.95 lb., AA wads - \$2.45 bag. Black powder guns and accessories, powder - \$3.85 lb. Ye Ole Gun Shack, 409 W. Washington Ave., 592-5430.

3-15-tfe

## NOTICE

**\$100 REWARD** for identification of person or persons who cut barbed wire fences on Smith Street on West side of Iowa Park. Contact A.L. Bohannon.

5-3-1tc

**LOST** - brindle boxer, ears and tail clipped, child's pet. Please return. Contact Theresa at JRB's in Iowa Park. Reward.

5-3-1tp

**PUPPIES** looking for a home. Free. 592-5456.

4-26-2tc

**NEW LISTING** Wichita Falls, lovely two bedroom, den, plus all extras. Priced to sell. **RE/MAX REALTORS** 691-1212

La'daele 692-1766

## HELP WANTED

**CARPENTER'S** helper needed 592-5083.

4-19-4tp

**HELP WANTED** - Applications being accepted for cooks, carhops and fountain workers at Sonic Drive-In. Apply in person only at 719 W. Hwy.

4-19-tfe

**ADULT HELP** (25 or older) for nights and weekends. Apply in person, Iowa Park Dairy Queen.

4-27-tfe

**DAY & NIGHT** help needed. Apply in person, Harvey's Hamburger's.

3-29-tfe

**TRUCK DRIVER** for City of Iowa Park sanitation department, and two laborers. Apply at city hall.

5-3-1tc

## FOR RENT

**LARGE FENCED** mobile home lot for rent. Will take up to 80-foot mobile home. 592-5060.

5-3-2tp

**Monty's Plumbing**

Complete Service  
592-4928 - 592-5539

Electric sewer machine; water heaters; water, sewer, and gas line digging and installing. Monty Britt, owner, operator.

**IOWA PARK AIR CONDITIONING & HEATING**

**Carrier** SERVICE ON ALL MAKES ENGINEERING SALES 607 W. BANK FRANK GUYETTE

**PHONE 592-5891**

Free Estimates on your **Swimming Pool** call

**A-B-A Pools, Inc.**  
concrete - gunite constructed pools and pre-built fiberglass pools.  
**691-2231**

**E&S EXXON**

**592-4897**  
**612 W. Highway**

**EXXON**

Life, Health, HR10 and all IRA Plans

Contact the **DENNIS GEORGE Insurance Agency**

592-4978 or 322-5772

Representing Great Southern Life Insurance Co.

We service all makes of washers, dryers, freezers, refrigerators and window air conditioners.

**POSEY'S APPLIANCE SERVICE**

208 James **Ph. 592-5452** Iowa Park

**79 CAMARO**  
2-DOOR SPORT COUPE  
The sleek, FUN car to drive as low as **\$4479**

**IN STOCK**  
**1979 EL CAMINOS**  
Discounted  
Up To \$1500

**'79 NOVA**  
2-DOOR COUPE  
If you like solid value in a car, you'll love the Nova! as low as **\$3979**

**'GIANT' DEALS on USED CARS**

**BOB MENGEL'S LONGHORN CHEVROLET**

1125 Red River Expressway  
Phone 723-4631

OPEN TIL 8:00 P.M.