

Commissioners reluctantly redistrict



COUNTY COMMISSIONERS make last minute adjustments on the re-districting plan. Left to right are Bob Jarrett, Mark Turnbough, statistician; Judge Cholsie Smith and Ben Ayers, Democratic chairman.

The County Commissioners Court in a special session that was continued from Monday through Tuesday have adopted a tentative redistricting plan slightly changing the precinct lines in Floyd County.

Texas counties which have an unbalanced population in voting precincts as shown in the 1980 census have until November 30 to present a redistricting plan to the Secretary of State in Austin. "We don't like it a darn little bit," stated County Commissioner Bob Jarrett, "but that's beside the point. We've got no choice."

Jarrett was referring to the fact that several surrounding counties have had suit brought against them by a group called Southwest Voter Registration and Education Project, based in San Antonio.

The group is dedicated to the protection of the voting rights of the minorities. This group is very active in the South Plains according to Mark Turnbough whose company, Southwest Polimetrics, prepared the redistricting plans.

Costly court fees and the precinct lines being drawn by non-residents are a reality in Crosby and Castro counties. Hockley and Gaines Counties have been filed on. There have been reports of court costs of over \$50,000 and of precinct lines being drawn with seemingly little regard for any county business except the shuffling of voters numbers.

In order to satisfy the Justice Department and thus to stave off the possibility of being filed against, the redistricting must be done on a one-person, one-vote basis. And there must be one minority precinct with about two-thirds of the minority population in it.

This assures the minorities of a chance to elect a minority representative if they choose to do so as a block vote.

Since Floyd County has a total minority percentage of 38%, one precinct must have over 65% minority population in it.

The one-person, one-vote qualification means that all precincts must have equal population figures according to the latest census. The Justice Department uses only the census figures according to Turnbough.

With some adjustments in the precinct lines in Lockney and Floydada the population and minority specifications have been achieved with little disruption of other county functions.

In fact the new plan has equalized the road miles in each precinct. For instance, precinct three has been given some of the extra miles and population that precinct two has had.

Because Floyd County Commissioner chose to go ahead with their own plan of redistricting they have achieved an almost perfect plan of equalization, not only of road miles but of population.

"I haven't done one that came this close," Turnbough said. The total deviation of the proposed plan is 0.5%, which is remarkably close.

The Justice Department does not like the deviation to be over 4%. At the present time the deviation in Floyd County is 74%.

The total population of Floyd County is 9834. Divided equally between the four precincts would give an ideal size of 2458 people in each precinct.

Under the tentative plan: Precinct 1 would have 2465 population whereas at the present time it has 2249 people; Precinct 2 would have 2457 in population, and they now have 2578; Precinct 3

Continued On Page 2

Clark explains financing

When Sylvia Clark, South Plains Association of Government (SPAG), met with Floyd County business and civic leaders in August it was to set up a Board of Directors for the issuance of Industrial Revenue Bonds.

That Board has been chartered. The Revenue Bonds are a long term issue for \$1 million up to \$10 million. "There is a need for long term issues of amounts less than \$1 million," Clark said. "A loan of \$500,000 at 15% for five years will mean a \$150,000 payment per year. Whereas, that same \$500,000

at the same 15% interest spread over 20 years would be repaid at \$80,000 per year."

The local banks cannot afford to make the repayment schedule for more than five to seven years, Clark said.

Caprock Local Development Company was formed as a spin off of SPAG to help communities take advantage of the SBA 503 program which is to stimulate the growth and expansion of small businesses within a defined area of operation.

The Development Company, whose papers are in the final stages of processing, will be authorized to sell debentures.

These debentures will carry an SBA guarantee, and must be used only for land, building, and equipment costs for small business expansion.

These debentures will form only 40% of the loan amount, not to exceed \$500,000, needed for the small business. The owner must put up 10%. The remaining 50% would be provided by a

Downtown Halloween carnival

At least seventeen downtown merchants are now getting their games, prize and concession booths ready for the big carnival to be held in the individual participating stores from 4 to 6 p.m. on Halloween - this Saturday.

The parade will begin at 3:00. Judges for best costume in two age categories, (11-18 and 10 and under) will be Nancy Marble, Parnell Powell and Roger

Garms. Prizes are \$20 for first place, \$10 for second and \$5 for third.

Tickets for the carnival may be bought at the Chamber of Commerce's ticket booth on the square for five cents apiece.

Merchants participating are: Sears, Lovell-Collins Jewelry, Gene's Cleaners, Hale's Department Store, Hesperian, Anderson's Department Store.

Area lawmen attend seminar

For two days last week, Floydada resembled the location site for the movie production "Sugarland Express." Except that the block-long line of patrol cars parked in front of Lighthouse Electric were the real thing and their drivers represented every branch of law enforcement on the South Plains.

The peace officers were attending a seminar sponsored by area prosecutors and held in Floydada at the invitation of

District Attorney Randy Hollums.

Approximately 100 area law enforcement personnel and prosecutors attended one of the two sessions of the workshop which was offered on consecutive days to accommodate as many participants as possible.

Topics covered at these workshops were the elements of crime, effective report writing, and the do's and don'ts of testifying in court.

Stitchin' Pretty, Floyd County Museum, Roye's Merle Norman, KKYN, Sue's Gifts, Script Printing, City Auto, Azteca Cafe, Kirk and Sons, Collins Appliance, Parker Furniture, and Thompson's Pharmacy.

See ad in this issue of the Hesperian to see where you can do what! Don't forget - kids 10 and under must be accompanied by an adult.

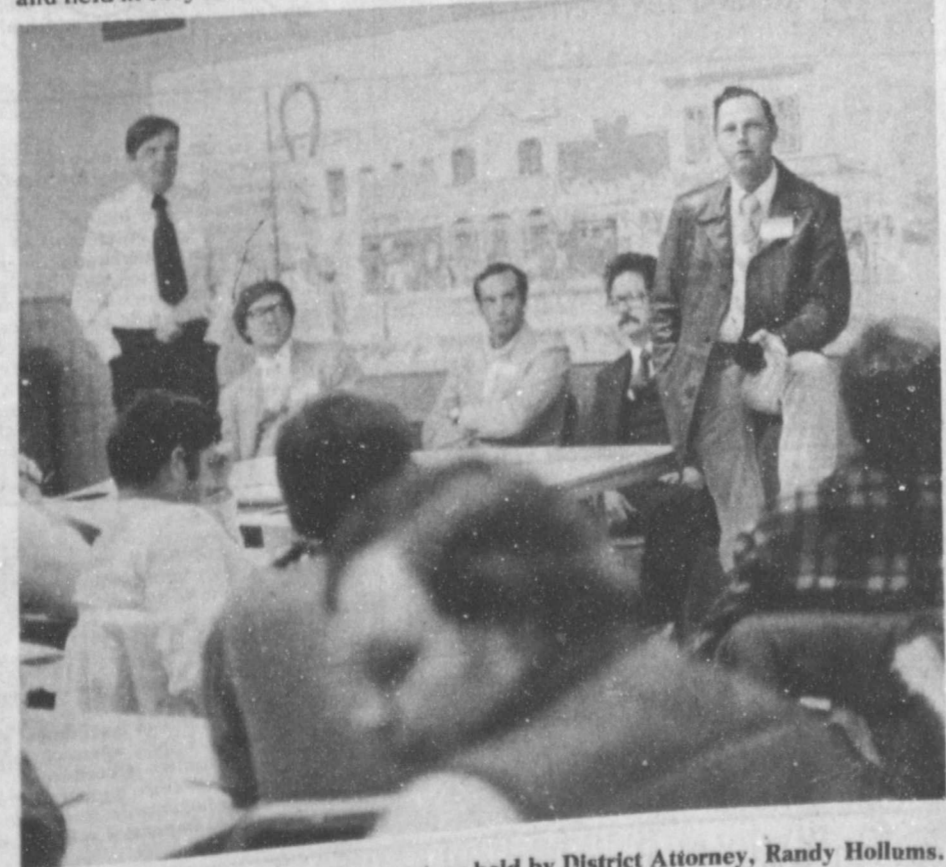

PEACE OFFICERS attended a seminar held by District Attorney, Randy Hollums. On the panel were [l-r] Andy Shuval, executive director of the Prosecutor Council; Bill Randy Hollums, Floyd, Briscoe, Motley and Dickens District Attorney; Richard Moore, Hale Heathly, Cottle, Knox, Baylor and King District Attorney; Richard Moore, Hale Heathly, Cottle, Knox, Baylor and King District Attorney; and Joe Thigpen, Haskell, Stonewall, and Kent Swisher District Attorney; and Joe Thigpen, Haskell, Stonewall, and Kent Swisher District Attorney.

Crawford hired as new Floyd County librarian

The protracted search for a qualified person to head up the Floyd county library system came to an end Monday as the county commissioners court unanimously passed a resolution to hire Mrs. Sandra Crawford to the position.

Mrs. Crawford will replace long-time head librarian Jackie Walls who recently resigned with an effective date of November 1. She is presently a resident of Plainview and has been employed in Floydada for the past five years in the office of local attorney Ben Ayres.

The new librarian, who attended Texas Tech University for two years meets all the requirements of the Texas Library Association and the West Texas Library System and will enable the library to enjoy all the benefits of membership in those two organizations. She will be required to be re-certified each year.

Mrs. Walls, at the request of the commissioners court, has agreed to continue on the job until November 20, on which date she estimates that Mrs. Crawford, who has had no previous library experience, will be trained and broken in to her new duties.

Mrs. Crawford has the commissioners court approval to work half days at



SANDRA CRAWFORD

the library and a half day for Mr. Ayres until the November 20 date so as to give the attorney ample time to find a replacement for her.

When asked for a comment on her appointment, Mrs. Crawford could only say that "I am very happy to be selected for this position and look forward eagerly to the new challenge."

She is married to James Crawford, who is a farmer, and the couple have no children.

Vote for on Four Amendment rundown

Floyd countians will join other Texans Tuesday in voting on seven Constitutional Amendments which are designed to alleviate some of the state's most pressing and long standing problems.

The thrust of the seven proposals are side in scope and range from tax exemptions to cure urban blight, formation of a state financial management committee, establishing increased tax exemptions for homesteads, increasing the veterans land fund program to the use of half of the state's surplus funds for a wide spectrum of water development projects.

Of the seven, Proposition Four is undoubtedly of the greatest interest to West Texans, as it deals with our most limited and most precious resource—water. It is a very rare occasion when West Texans have the opportunity to express their desires through the ballot on this all-important issue.

The last time a constitutional amendment was proposed for a West Texas water import plan was in 1969 when it was narrowly defeated by less than 6,000 votes with the margin of defeat being attributed to East Texas voters generally and Harris county (Houston) particularly. It is expected that this proposal will be contested that closely again this time and it will take an especially heavy turnout of voters in the western half of the state if it is to be successful this time.

Amendment four creates a state water trust fund, which would set aside half of the surplus state revenues (over and above the spending limitations of the state government) for the purpose of development of existing and new water sources. The population of Texas is expected to nearly double within two decades and nearly all parts of the state must have additional sources of water to assure continued progress and prosperity, according to the proponents of the proposal.

It goes without saying that the farmers and ranchers of the West Texas area are in dire need of new sources to replace the water being taken from the rapidly depleting and non-replenishable Ogalalla Aquifer which is their only source at the present time. This amendment has been far and away the most publicized of the seven in this area, probably due to the backing given it by its chief sponsor and

Continued On Page 3

October 22, 1981
Johnny Fever to move in...
700 CLUB
CFL FOOTBALL
THE FIGHT...
THE FACTS OF LIFE...
SPECIAL MOVIE...
WORLD OF FANTASY...
SHOWTIME THE...
TBS NEWS...
HBO SNEAK PREVIEW...
SING OUT AMERICA...
LARRY JONES...
APPLE POLISHERS...
ON LOCATION...
NASHVILLE...
DICK CAVETT SHOW...
TO ANNOUNCING...
BARNEY MILLER...
BENNY HILL...
SPORTS TONIGHT...
ALL IN THE FAMILY...
SCIENCE-FICTION...
ANOTHER LIFE...
SPORTS CENTER...
ABC CAPTIONED...
M.A.S.H...
SATURDAY NIGHT...
MAUDE...
THE TONIGHT SHOW...
NEWSDESK...
CBS LATE MOVIE...
MOVIE (ADVENTURE)...
MCHALE'S NAVY...
COLLEGE FOOTBALL...
HARD CHOICES...
JIM BAKKER...
ALL IN THE FAMILY...
MOVIE (ADVENTURE)...
MOVIE (DRAMA)...
JACK BENNY...
ABC NEWS...
MOVIE (DRAMA)...
TOMORROW...
TO-COAST...
SHOWTIME MOVIE...
PEOPLE TONIGHT...
BACHELOR FATHER...
GOD'S NEWS...
LIFE OF RILEY...
JIM BAKKER...
JOE FRANKLIN SHOW...
NEWS...
SPORTS UPDATE...
MOVIE (ADVENTURE)...
COMEDY TONIGHT...
OVERNIGHT DESK...
NIGHTBEAT...
MCHALE'S NAVY...
SPORTS CENTER...
SPELL LUNDSTROM...
MOVIE (DOCUMENTARY)...
Vanishing Africa...

# Reluctantly redistrict

Continued From Page 1

would have 2457 in population and they now have 1905, (this is also the precinct that will have a 65.2% total minority population under the new plan); Precinct 4 will have 2456 population and now has 2146 persons.

In order for all resident of the county to fully understand the changes and how it will effect them personally, there have been two public hearing scheduled in the county on November 5.

There will be a public hearing in Floydada in the county court room at 5 p.m.

There will be a public hearing that same day, November 5, at the City Hall in Lockney at 6:30 p.m.

The meeting will be conducted by Turnbough and his partner, Bob Bass. Bass is an attorney, formerly Hale County Attorney.

Turnbough is a professor of government and public administration at Wayland Baptist College. Both men live in Plainview. Bass writes the legal submission and Turnbough does the statics and map work for the company.

The company has recently done the redistricting plan for Hale and Terry Counties. Hale has been approved and Terry is close to approval. They will also prepare the plan for Swisher and Deaf Smith Counties.

Other consideration in the new precinct lines were the hospital districts and the voting boxes.

The changed precinct lines do not effect the hospital districts nor will it effect the tax base.

Since the proposed changes occur mostly in the cities of Lockney and Floydada the new precinct lines will have very little impact on voter precinct lines. None of the small rural boxes will be changed.

Ben Ayres, Democratic Chairman, was informed of the changes during court meeting Tuesday, and he indicated that he was satisfied that the changes would not work a hardship on the rural voters.

Court members and Turnbough expressed the need for residents of the county to attend the public hearings on November 5. "It will allow the citizens an opportunity to examine the proposal and ask questions," Turnbough said.

After the hearings on Thursday, the Court will vote to adopt the redistricting plan at the regular court session Monday, November 9.

The plan will then be sent to the Justice Department for pre-clearance. The county will be notified when the plan has been approved.

The county will then submit the plan to the Secretary of the State of Texas for filing.

Turnbough, who had worked most of Monday night drawing in the changes made by the commissioners to his first draft, said "The commissioners have

been very cooperative in a very difficult task. They have been very helpful," and then he added almost as an aside, "Much more so than most."

Motion was made by Sam Spence and seconded by Bob Jarrett that the following election judges and alternate judges be appointed. All in favor.

### ELECTION JUDGES

Precinct No. 1, Southwest Floydada at Massie Activity Center; Judge, Jack Stansell, Floydada; Alternate, Wilson Fowler, Floydada.

Precinct No. 3, Allmon at Allmon Grain Office; Judge, Marvin Shurbert, Petersburg; Alternate, R.G. Morris, Petersburg.

Precinct No. 4, Sandhill at Barwise; Judge, Cecil Jackson, Floydada; Alternate, Edwin Nutt, Floydada.

Precinct No. 5, East Lockney at City Hall; Judge, J.D. Copeland, Lockney; Alternate, Lloyd Wofford, Lockney.

Precinct No. 7, Providence at Lutheran Church; Judge, D.K. Jackson, Lockney; Alternate, Mrs. Helmuth Quebe, Lockney.

Precinct No. 8, Lone Star at Lone Star Baptist Church; Judge, H.E. Frizzell, Lockney; Alternate, G.B. Johnston, Lockney.

Precinct No. 9, South Plains at South Plains School; Judge, Mamie Wood, South Plains; Alternate, Mrs. Nell Pritchett, Floydada.

Precinct No. 11, Cedar Hill at Cedar Hill Baptist Church; Judge, Mrs. D.M. Cogdell, Lockney; Alternate, Mrs. W.R. Ware, Lockney.

Precinct No. 13, Baker at Producers Elevator, Boothe Spur; Judge, C.O. Lyles, Floydada; Alternate, A.C. Pratt, Floydada.

Precinct No. 16, Harmony at Harmony Community Center; Judge, Mrs. Phil Dunavant, Floydada; Alternate, David Battey, Jr., Floydada.

Precinct No. 17, Goodnight at Fairmont Baptist Church; Judge, Mrs. Jack Pigg, Quitaque; Alternate, O.P. Clark, Quitaque.

Precinct No. 18, West Lockney at Lockney Methodist Church; Judge, C.L. Mooney, Lockney; Alternate, Mrs. Chester Mitchell, Lockney.

Precinct No. 19, Northwest Floydada at Fire Department Building; Judge, Mrs. J.W. Day, Jr., Floydada.

Precinct No. 20, Dougherty at Dougherty School Building; Judge, Mrs. Ruth Daniel, Dougherty.

Precinct No. 22, McCoy at McCoy Store; Judge, Mrs. Craig Edwards, Floydada; Alternate, Turner Hunter, Floydada.

Precinct No. 23, Southwest Floydada at County Court Room; Judge, Bill Cagle, Floydada; Alternate, Drew Lloyd, Floydada.

Precinct No. 24, Northeast Floydada at North End of Hall in Courthouse; Judge, Mrs. Wayne Bramlet, Lockney; Alternate, Mrs. Keith Marble, Floydada.

Special Canvassing Board: Ben P. Ayres, Chairman; Arthur P. Barker, Jr., Paul Teuton, Alton Higginbotham.

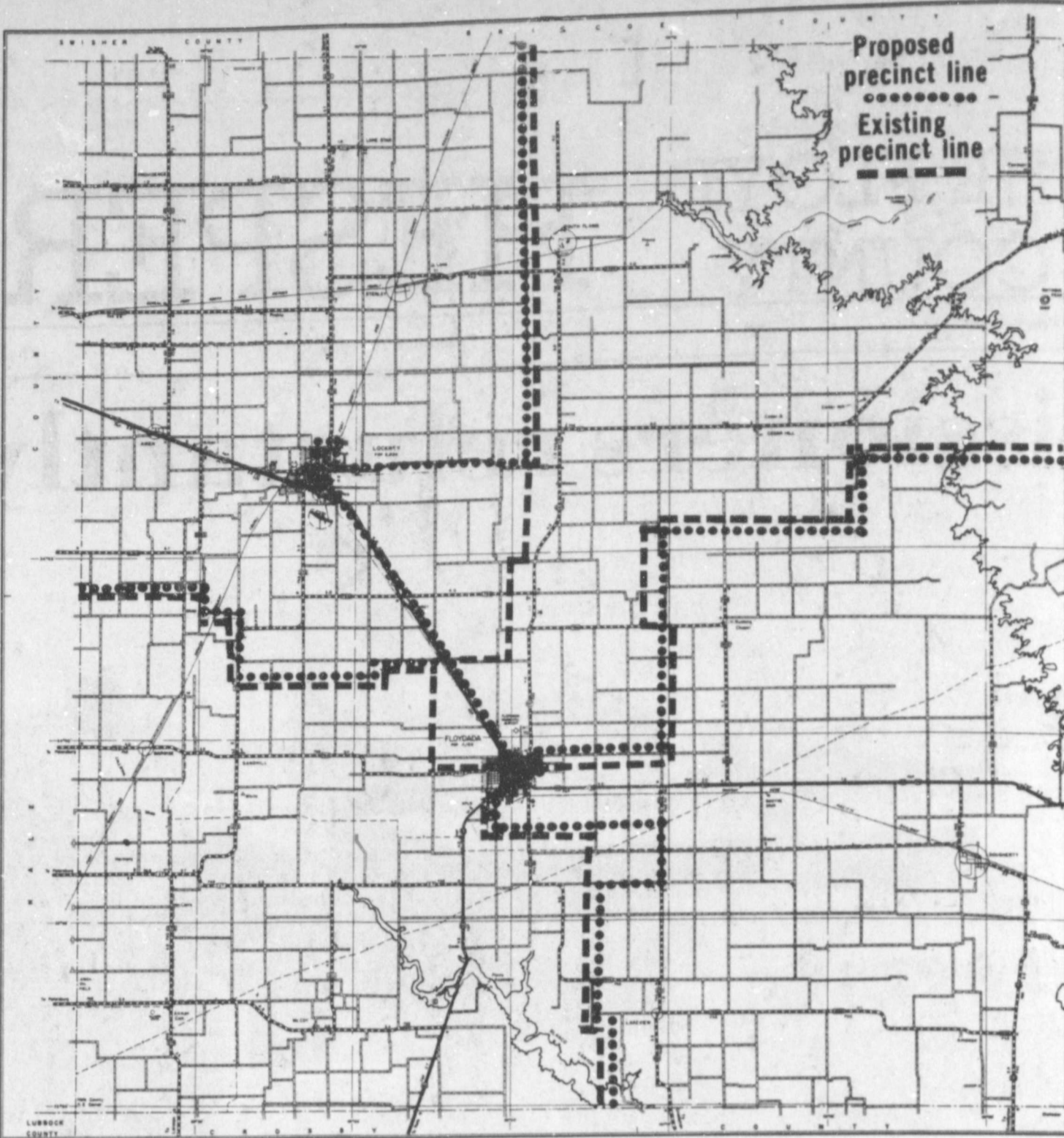

## Existing precinct lines and proposed precinct lines of County redistricting

### Courthouse news

**Deed Records**  
Flo Ella Jarboe to Malvin A. Jarboe, 3 tracts.  
Marvin A. Jarboe to Flo Ella Jarboe, Lots 16, 17 and E. half of 18, Blk. 9, Texas Add'n., Floydada.  
Ray C. McDonald to Don Daniel, et ux, Lots 21-25, Blk. 70, original Floydada.  
Lenora L. Smith, et al, to Clarence Ansley, Lots 6 and 7, Blk. 6, Muncy Add'n., Lockney.  
J.R. Folkes, et ux, to Randall C. Roberts, et ux, et al, N/2 of Sur. 122, Blk. D-2.  
R.F. Stovall, Executor, to Eunice Johnson Bell, Lots 29, 30, and W. 17 ft. of Lot 28, Blk. 93, original Floydada.  
Golden Louise Nabors, et al, to Roger

L. Garms, et al, E. 45.36 ft. of Lot 37, Blk. 2, Steen Place Add'n., Floydada.  
Donna Maxine Lipham to Mac W. Gallagher, et ux, Lot 3, Blk. 138, original Floydada.  
Jim H. Jackson, et ux, to Ernest W. Jones, et ux, tract of 40 acres, being the NE/4 of NW/4 of Sur. 26, Blk. 1.

**Probate Docket**  
Mattie Readhimer, will & appl. to probate, 10-13-81.  
Edd Muncy, will & appl. to probate, 10-22-81.  
**Marriage Licenses**  
Guadalupe Martinez, Flor Estela Rodriguez  
Jose S. Perez, Georgia Espinosa

**No.16301 CONSTITUTIONAL AMENDMENT ELECTION (ELECCION PARA ENMENDAR LA CONSTITUCION)**  
(Condado de) Hale County, Texas  
November 3, 1981 (3 de noviembre de 1981)

### OFFICIAL BALLOT (BOLETA OFICIAL)

INSTRUCTION NOTE: (NOTA DE INSTRUCCION):  
Place an "X" in the square beside the statement indicating the way you wish to vote. (Marque con una "X" el cuadro de la frase que indica la manera en que usted quiere votar.)

No. 1	<input checked="" type="checkbox"/> FOR (A FAVOR DE) <input type="checkbox"/> AGAINST (EN CONTRA DE)	"The constitutional amendment to authorize cities, towns, and other municipalities to encourage the improvement, development, or redevelopment of their communities through property tax relief and the issuance of bonds and notes." "La enmienda constitucional que autoriza a ciudades, pueblos, y otras entidades municipales para mejorar o desarrollar de ciertas áreas por medio de la reducción de los impuestos sobre la propiedad y la emisión de bonos y notas."
No. 2	<input checked="" type="checkbox"/> FOR (A FAVOR DE) <input type="checkbox"/> AGAINST (EN CONTRA DE)	"The constitutional amendment authorizing the commissioner of the General Land Office to issue patents for certain public free school fund land held in trust under color of title for at least 50 years as of November 15, 1981." "La enmienda constitucional que autoriza al comisionado de la Oficina General de Tierras para emitir patentes para ciertos terrenos del fondo por las escuelas públicas que se encuentran en buena fe bajo título aparente durante por lo menos cincuenta (50) años a partir del 15 de noviembre de 1981."
No. 3	<input checked="" type="checkbox"/> FOR (A FAVOR DE) <input type="checkbox"/> AGAINST (EN CONTRA DE)	"The constitutional amendment to allow the legislature to grant to a certain management committee the power to manage the expenditure of certain state funds." "La enmienda constitucional que permite a la legislatura otorgar a un comité estatal de administración financiera la autoridad de administrar ciertos fondos apropiados."
No. 4	<input checked="" type="checkbox"/> FOR (A FAVOR DE) <input type="checkbox"/> AGAINST (EN CONTRA DE)	"The constitutional amendment authorizing the use of a portion of the revenues of the state for water development, water conservation, flood control, flood enhancement, and flood control purposes; authorizing the use of the revenues not to exceed five hundred million dollars, to guarantee the financing of such purposes; increasing the interest rate that may be paid on such purposes; providing but unissued state bonds; and authorizing a program to receive and provide but unissued state bonds." "La enmienda constitucional que autoriza el uso de una porción de los ingresos del estado para el desarrollo, la conservación y el uso de una porción de los ingresos del estado para el control de inundaciones, que autoriza el uso de los ingresos del estado, no en exceso de quinientos millones de dólares, para garantizar el financiamiento de ciudades, condados, pueblos, y otras entidades municipales para el financiamiento de proyectos dedicados a tales fines, que aumenta la tarifa máxima de interés que se puede pagar por bonos estatales preemitidos aprobados que autoriza un programa para pagar bonos."
No. 5	<input checked="" type="checkbox"/> FOR (A FAVOR DE) <input type="checkbox"/> AGAINST (EN CONTRA DE)	"The constitutional amendment to provide for the inclusion of poultry with farm products as exempt from taxation." "La enmienda constitucional que permite incluir el ganado y las aves con los productos agrícolas en los impuestos."
No. 6	<input checked="" type="checkbox"/> FOR (A FAVOR DE) <input type="checkbox"/> AGAINST (EN CONTRA DE)	"The constitutional amendment authorizing a political subdivision to provide tax relief for owners of residence homesteads and changing the tax administrative procedures." "La enmienda constitucional que autoriza a una subdivisión política proveer auxilio en los impuestos de los propietarios de hogares de residencia y que cambia ciertos procedimientos administrativos en los impuestos sobre la propiedad."
No. 7	<input checked="" type="checkbox"/> FOR (A FAVOR DE) <input type="checkbox"/> AGAINST (EN CONTRA DE)	"The constitutional amendment authorizing the issuance of additional allowable veterans' land program and to increase the maximum amount of the issuance of bonus additional bonds." "La enmienda constitucional que autoriza la emisión de bonos adicionales para financiar el programa de tierras para veteranos y que aumenta la tarifa máxima de interés que se permite en el fondo de terrenos para veteranos."

## County residents benefit from library

Statistics for 1980-81 recently released by the West Texas Library System show that Floyd County residents benefitted greatly from library resources and services made available

to their public library through the West Texas Library System, a program funded by the State of Texas to help local public libraries.

Films made available at the Floyd

County Library were seen by 21,360 people. Statistics indicate that these West Texas Library System films were shown 378 times in Floyd County in 1980-81. In addition, 399 people saw West Texas Library System filmstrips, which were shown 21 times. Books specially selected for young adults by library consultants at the West Texas Library System were checked out a total of 268 times during the year from the Floyd County Library.

Besides making film, filmstrips and young adult books available, the West Texas Library System allocated \$2,381 in 1980-81 to the Floyd County Library to purchase and lease new books for the library's collections. In the course of the year approximately 261 new books were purchased.

In addition to realizing benefits from the West Texas Library System, another state-funded program, the Interlibrary Loan service, provided for library patrons materials not available at the local library. The Floyd County Library requested 108 books and magazine articles from the Interlibrary Loan service, most of which were located at the Major Resource Center in Lubbock or from other such centers in the state or even from libraries outside of Texas. A special computer system is used by Interlibrary loan to locate books and articles requested by the people who use the Floyd County Library. There is no charge for this service.

The Interlibrary Loan Office at the Lubbock Major Resource Center processed over 6,000 requests for interlibrary loans from the West Texas region in 1980-81. During the same period, over 500,000 people viewed films from the West Texas Library System, and a total of 13,100 new books were leased and purchased with state funds for West Texas Public Libraries.

**Texas Migrant Council, Inc.**  
announces the sponsorship of the child care food program, all children in attendance will be offered the same meals with no physical segregation or other discrimination against any child because of race, color, sex, national origin or ability to pay.



This statement applies to the center and/or day home listed below:

**Texas Migrant Council, Inc.**  
702 2nd Street  
Floydada, Texas 79235  
Phone 983-5701

## Amendment positive step

Ken Campbell of Douglas County, Cattle Chairman of Floyd County, has announced support for proposed Constitutional Amendment Five, saying that passage of Amendment Five would be a positive step in keeping a viable livestock industry in Texas.

Proposition Five proposes to exempt livestock and poultry products already exempt from (ad valorem) taxes, and is now proposed Constitutional Amendment to be considered by Texas voters on November 3.

Those products are exempt inconsistently across the state of a 1976 Attorney General's opinion that livestock and poultry are "products." Texas is the only state among the large cattle-producing states which allows such a tax.

"Any producer of any product recover the cost of production taxes, and shoe some profit, if they stay in business," Ken said. "The passage of Proposition Five would remove property taxes on stock and poultry, some producers conclude that they cannot remain in that business. There is a drop in production which will hurt our local economy."

## Postage increase effective Nov 1

The cost of mailing a First-Class letter will rise to 20-cents beginning Monday, November 1 when new rates go into effect, Postmaster Ward Wester reminded customers.

The 20-cent First-Class rate increases for other classes of mail proved last month of the Government Postal Service, take effect at 7 a.m. local time on November 1. "However," Postmaster Wester said, "customers should not wait a week to make their stamp purchases. Now is the time to buy to avoid necessary lines once the new rates come effective."

A new "C" stamp is on sale at a denomination and has a postage of 20 cents, the new rate for the First-Class domestic mail. The brown and white stamp features an eagle with the legend "US Postage" beneath it. The letter "C" appears on the eagle.

Continued From...  
W. DAY JR.,  
Mrs. Sue Lo...  
Hinsley; Britis...  
Wenda Wilson.

Continued From...  
Postage incre...  
effective Nov...  
The cost of mailing...  
ter will rise to 20-cents...  
day, November 1 when...  
rates go into effect, Post...  
ward Wester reminded...  
customers.



# Amendments....

Continued From Page 1

drafter, Speaker of the House Bill Clayton of Springlake. He was also chief architect of the measure that was barely defeated in 1969.

In addition to Clayton, amendment four has the strong backing of Governor Bill Clements who says "Contrary to some deliberately misleading propaganda, this is not a proposal designed to favor some parts of the state over others. In the near future this state must have additional sources of water; to assure our continued growth and prosperity and expanded opportunities for future generations of Texans. I endorse all seven of these amendments, but consider number four so important as to warrant additional emphasis."

He went on to state that Amendment 4 would set aside half of surplus state revenues, which, otherwise would be eaten up by current spending demands, to build up the kind of water projects adequate to the needs of our ever-growing population. The amendment also allows the use of the state's credit to guarantee local water project bonds, creates a state bond retirement program and increases interest rates to make authorized but unused, state bonds marketable. The proposal would raise the interest rate from six to twelve percent to make the bonds more attractive to investors.

In an effort to curb residential tax increases and head off so-called homeowners' "tax revolts," Amendment 6 would authorize local jurisdictions to exempt a percentage of the market value of residence homesteads. The amendment would also allow the Legislature to change some current property tax administrative procedures, including the "truth in taxation" notice requirement. The amendment would make it easier for those on low or fixed incomes to buy and keep a home.

It is worth mentioning that other amendments to be voted on November 3 would authorize an additional \$250 million in Veterans Land Bonds at marketable interest rates; authorize issuing patents for school lands held in good faith for a half century; make property tax relief available to encourage redevelopment or improvement of blighted areas; and include livestock and poultry with farm products exempt from taxation.

Among the most important of all, Amendment 3 provides significant budget execution authority subject to limitations imposed by law. The finance management committee and procedures to be set up by Proposition 3 are now needed urgently. The committee—to be composed of the Governor, Lieutenant Governor, House Speaker, two key Senators and two Representatives—will provide the vehicle for allocation of tremendous sums in federal block grants anticipated to flow into the State, without the necessity of a special legislative session.

In the future, subject to legislative direction, the committee may become an effective mechanism for meeting other unexpected financial emergencies when the Legislature is not in session, may significantly improve budgeting of State funds and save millions in tax dollars.

# Chamber Clips

BY SUSAN GARMS

Be sure to seek and find the ad-list of merchants participating in the Halloween Carnival downtown this Saturday. We hope to have a good turn-out for the parade that begins at 3:00 p.m. for ages 11-18 and 10 and under. No floats, no bands, just spooks, goblins, and creatures and characters. Even the judges will be in costume! Come to town. Play a game. See a spook!

Other merchants not listed in the carnival area downtown are dressing up for Halloween. Have you seen Taste Freeze's windows?

The Women's Division of the Chamber of Commerce will meet at the Chamber office at 5:30 p.m. Monday, November 2.

A workshop to aid small businesses (with employees) and employers of household labor with preparation of federal quarterly and annual payroll reports has been tentatively set for November 30. Forms 940, 941, 942 and 943 and the quarterly report for Texas Employment Commission will be included along with tips in filling in forms W-2, W-3 and W-4. For new businesses or first time employers — How to Get Federal Identifying Numbers. Other items to be covered include family employment and timely deposits of withheld payroll taxes. Pre-registration

through the Chamber of Commerce will be required.

Several local businesses are filming commercials to be broadcast during the Whirlwind football games on Saturdays at 1:00 p.m. on Cable Channel 2. It's hard to tell who's having the most fun, the sponsors, the videotapers or the viewers. Some people want to just watch the rebroadcast of those good football games, some just want to watch the super band at halftime and others tune in just to watch the commercials! True! Latent Hollywood-type personalities are coming to the fore! So far those filmed are: City Auto, Consumers, Thompson's Pharmacy, Sue's Gifts, Ponderosa, Kirtley's Market, Lovell-Collins Jewelry, and Sears. These businesses are also to be commended for also supporting the rebroadcasts by sponsoring radio-type spot announcements: Sam Spence Insurance, Floydada Insurance and Real Estate, Hale Insurance and Real Estate, Tommy Assiter Insurance, Oden Chevrolet, Tipton Oil, The Loft, Evelyn's Beauty Salon, Pat Walker's Figure Studio, Anderson's Department Store, Cornelius Conoco, Consumers, City Auto, Thompson's Pharmacy, Sue's Gifts, Kirtley's Market and Lovell-Collins Jewelers and individuals Gary Pate and R.G. Dunalp.

FLOYD COUNTY HESPERIAN

(USPS 202-680)

Published weekly each Thursday at 111 East Missouri Street, P.O. Box 700, Floydada, Texas 79235. Second class postage at Floydada, Texas 79235. SUBSCRIPTION RATES: Local \$11.50 per year, out-of-trade area \$12.50 per year

Shelly Harris Publisher, Editor  
Marjorie Holcomb Business Manager  
Tom Burns Advertising Manager  
Rosemary Gonzales Society

Any erroneous reflections upon the character, standing or reputation of any person, firm or corporation will gladly be corrected when such occurs in the columns of this newspaper and are brought to the attention of the management.

The Publisher is not responsible for copy omission, typographical errors, or any unintentional error that may occur other than to make corrections after being brought to attention. Advertising accepted on this basis only.



DAY JR., right, was the winner of the 45 piece set of Naritake China Mrs. Sue Lovell, left, during the Lovell-Collins Jewelry Grand Opening. Mrs. Lovell's prizes included a clock, won by Mrs. Richard Hale; a key holder won by Mrs. Betty; British Sterling cologne won by Mrs. Susan Garms, John Cockrell, and Mrs. Wilson.

## Bank explains financing

Continued From Page 1

source, generally the local bank loan would be on bank interest rates. The bank would hold the collateral but would only

mailing a First-Class stamp on the 20-cents beginning on November 1 when new effect, Postmaster reminded customers

First-Class rate other classes of mail month of the Governor service, take effect on November 1. Postmaster West should not wait until term of a loan will make the time to buy to suggest once the new rates

stamp is on sale and has a postage of the new rate for one domestic mail must be bankable, must be

approved by both the bank and the SBA. Representatives of both Floyd County banks were at the meeting.

## Delegates to attend TSTA meet

Local Association Delegates will transact the business of the district at the District XVII House of Delegates, beginning at 8:00 p.m. Members are welcome to attend and observe the House of Delegates. Local delegates to

the convention are Audrey Spence, Norma Feuerbacher and Tom Powell.

The Floydada Local Unit membership numbers eighty-six in a state-wide membership of ninety-five thousand. Officers for the 1981-82 year are Audrey Spence, President; Berneice Walters, President-Elect Pro Tem; Joe Willis, Treasurer; and Carol Bell, Secretary. These officers are supported by capable faculty representatives and committee chairpersons.

The Texas State Teachers Association—the state's largest and most influential teachers' organization—is not perfect, but it has represented the teaching profession well and its thoughtful, moderate policies have been instrumental in preventing instances in Texas of the chaos, confusion and damage to the educational process visited upon other regions by the actions of more selfish and militant groups.

Today local educators, including professional and support personnel, will be attending the annual District XVII Convention of the Texas State Teachers Association.

The theme for the convention is, "We Teach the Children." All sessions will

be held in Monterey High School. Sectional meetings in various curricular areas are scheduled from 4:30 to 6:00 p.m. A banquet for all personnel will be from 6:00 to 8:00 p.m. It will feature a special address by Joyce Juntune, Executive Director for the National Association for Gifted Children.

## REPORT OF CONDITION

Consolidating domestic subsidiaries of the

First National Bank in Lockney of Lockney

In the state of Texas at the close of business on September 30, 1981 published in response to call made by Comptroller of the Currency, under title 12, United States Code, Section 161.

Charter number 14604 National Bank Region Number 11

Statement of Resources and Liabilities		Thousands of dollars	
<b>ASSETS</b>			
Cash and due from depository institutions		2,060	
U. S. Treasury securities		3,112	
Obligations of other U. S. Government agencies and corporations		6,390	
Obligations of States and political subdivisions in the United States		909	
All other securities		9	
Federal funds sold and securities purchased under agreements to resell		600	
Loans, Total (excluding unearned income)	12,225		
Less: Allowance for possible loan losses	288		
Loans, Net		11,937	
Lease financing receivables		None	
Bank premises, furniture and fixtures, and other assets representing bank premises		125	
Real estate owned other than bank premises		None	
All other assets		1,021	
<b>TOTAL ASSETS</b>		<b>26,163</b>	
<b>LIABILITIES</b>			
Demand deposits of individuals, partnerships, and corporations		3,515	
Time and savings deposits of individuals, partnerships, and corporations		18,293	
Deposits of United States Government		12	
Deposits of States and political subdivisions in the United States		1,580	
All other deposits		40	
Certified and officers' checks		110	
Total Deposits		23,550	
Total demand deposits	3,905		
Total time and savings deposits	19,645		
Federal funds purchased and securities sold under agreements to repurchase		None	
Interest-bearing demand notes (note balances) issued to the U. S. Treasury and other liabilities for borrowed money		None	
Mortgage indebtedness and liability for capitalized leases		None	
All other liabilities		762	
<b>TOTAL LIABILITIES (excluding subordinated notes and debentures)</b>		<b>24,312</b>	
Subordinated notes and debentures		None	
<b>EQUITY CAPITAL</b>			
Preferred stock	No. shares outstanding	None	(par value) None
Common stock	No. shares authorized	10,000	
	No. shares outstanding	10,000	(par value) 100
Surplus		200	
Undivided profits and reserve for contingencies and other capital reserves		1,551	
<b>TOTAL EQUITY CAPITAL</b>		<b>1,851</b>	
<b>TOTAL LIABILITIES AND EQUITY CAPITAL</b>		<b>26,163</b>	
<b>MEMORANDA</b>			
Amounts outstanding as of report date:			
Standby letters of credit, total		None	
Time certificates of deposit in denominations of \$100,000 or more		5,799	
Other time deposits in amounts of \$100,000 or more		295	
Average for 30 calendar days (or calendar month) ending with report date:			
Total deposits		24,160	

We, the undersigned directors attest the correctness of this statement of resources and liabilities. We declare that it has been examined by us, and to the best of our knowledge and belief is true and correct.

*[Signatures of Directors]*  
Directors

I, June Bybee  
Cashier

of the above-named bank do hereby declare that this Report of Condition is true and correct to the best of my knowledge and belief.

*[Signature of June Bybee]*  
October 15, 1981  
Date

Passbook savings  
Direct Deposit  
NOW accounts  
All savers certificates  
CD's

Don't be spooked by all the new types of bank services which are now available. Come in and let our friendly people help you answer any questions you might have.

"Helping you change things for the better"

# THE FIRST NATIONAL BANK OF FLOYDADA

Member F.D.I.C. Accounts Insured up to \$100,000



MR. AND MRS. KEN STEELE

## Double-ring ceremony unites Alice Moosberg, Ken Steele

Alice Moosberg and Ken Steele were united in marriage on Saturday, September 12, in the chapel of the First United Methodist Church in Lubbock. Doyle Gilliam of Lubbock officiated at the ceremony.

Gracing the altar for the double-ring ceremony were two brass candelabra adorned with fern and burgundy ribbon. Similar arrangements with fern and silk flowers graced the pews of the chapel.

Soloist Deon Zumwalt of Floydada presented vocal selections accompanied by Mrs. Bill Orman, also of Floydada, at the piano and organ. The vocal selections included "Could I Have This Dance?", "Lady," and "Color My World." Mrs. Orman provided music at the organ for the remainder of the service.

Members of the wedding party included Tim Riggs of Houston as best man, and Alan Dyess of Lubbock as groomsmen.

Attending the bride were her sisters; Mrs. Donny Winslow of Duncan, Oklahoma, as matron of honor and Mrs. Tommy Sherman of Lockney as bridesmatron. Shane Orman of Floydada was the candlelighter for the ceremony and Mrs. Oscar Santos of Floydada registered guests.

The bride's two attendants wore tea-length burgundy dresses featuring tucked shoulders and burgundy satin ribbon at the waist. They wore straw picture hats accented by burgundy ribbon at the crown and a nosegay of silk flowers at the back. They carried bouquets of preserved fern and silk flowers in blue, bur-

gundy, and grey; accented with burgundy ribbon.

The groom's attendants, the groom, and the candlelighter wore grey tuxedos.

The mother of the bride wore a two-piece street-length burgundy dress accented with beige accessories.

The groom's mother wore a navy street-length dress and navy accessories. Both mothers wore corsages of pink, white, and burgundy silk rosebuds.

The groom escorted each mother into the chapel for the ceremony.

Escorted to the altar by her father, the bride wore a white, tea-length dress with a white organza jacket accented by lace at the cuffs and neckline and a white satin ribbon tied at the waist. The bride's waist length veil fell from a white lace hat accented with flower appliques and pearls. She carried a bouquet of burgundy silk roses and white lily-of-the-valley with burgundy and white ribbon streamers.

As "something old", the bride carried her maternal grandmother's wedding ring tied in her bouquet; "something new" was her dress; "something borrowed" were her earrings, and "something blue" was her garter.

The bride presented her mother and the mother of the groom with a long-stemmed rose as she proceeded to the altar.

### RECEPTION

Following the ceremony, a reception was held in the Fellowship Hall of the church.

The four-tiered, heart-shaped wedding cake was decorated with pink, bur-

gundy, and grey silk flowers and a figurine of two white birds at the top.

Raspberry punch was served from a crystal punch bowl. Mints and nuts were served from blue crystal serving plates.

The bridal bouquet and two white candles in candlewick crystal candelabra centered the table. Silver appointments and burgundy napkins completed the setting.

Mrs. Monroe Shannon of Shamrock served the cake while Misti Orman of Floydada served the punch. Kristy and Stacey Dawdy of Floydada passed out rice and bird seed bags to the guests at the reception.

As the bride and groom left the church, the bride wore a blue and white striped skirt and jacket with a navy camisole top and navy accessories.

After a wedding trip to Orlando, Florida, the couple are now at home in Perryton, where Ken is employed by Halliburton Services and Alice is a homemaker.

### REHEARSAL DINNER

The rehearsal dinner hosted by the groom, was held at K-Bob's Steak House in Plainview. After the dinner, the bride and groom presented their attendant's gifts.

### OUT-OF-TOWN GUESTS

Relatives of the groom attending the wedding from out-of-town were his father, Ed Steele of Okinawa, his grandparents, Mr. and Mrs. Raymond Gilstrap of Neosho, Missouri, and his mother and her husband, Mr. and Mrs. Jim Becker of Yuma, Arizona. Other of his re-

## Harmony Homemakers learn to "energize"

The Harmony Extension Homemakers Club met in the community center October 26 with Juanita Pool as hostess. She read the devotional Isaiah 3:18-23. Roll call was answered by: Describe your wedding dress.

The program, Energize Your Wardrobe, was presented by Bess Carr. This was an interesting and informative program. Material referring to the program was passed out to the members to refer to as the need arises.

Ruth Scott resigned as council delegate. Bess Carr was elected as council delegate.

The next meeting will not be the regular meeting date November 9, but will be November 13 to make salads for the Christmas in November bazaar.

The hostess served refreshments to these members: Bess Carr, Anna Maude Hopper, Ruth Scott, Arvie Schultz and Blanche Williams.

## Layette shower honors Lutricks

Tobi Lynn and Tessa Lannette Lutrick, twin daughters born September 24 to Roby and Teresa Lutrick, of Hereford, were guest of honors Saturday October 24 at a layette shower in the home of Mrs. Fred Marble at South Plains.

Special guests besides the babies and their mother were the grandmothers, Mrs. Dean Stewart and Mrs. Buddy Lutrick. Great grandmothers attending were Mrs. Ruth Babb of Logan, New Mexico, Mrs. Pete Robison

of Abernathy and Mrs. Lottie Stewart of Lockney.

Over 50 friends and relatives registered or sent gifts.

Two highchairs were given by the hostesses: Margaret Kitchens, Pat Wood, Nina Upton, Mamie Lou Hartman, Bonnie Julian, Garnie Taylor, Mamie Wood, Peggy Roberts, Phyllis Johnson, Nancy Marble, Neta Marble, Sherre Holms, Nancy Hagood, Adeana Morris, Rhonda Stovall, Diane Meyers, Ruby Lee Higginbotham, and Carolyn Marble.

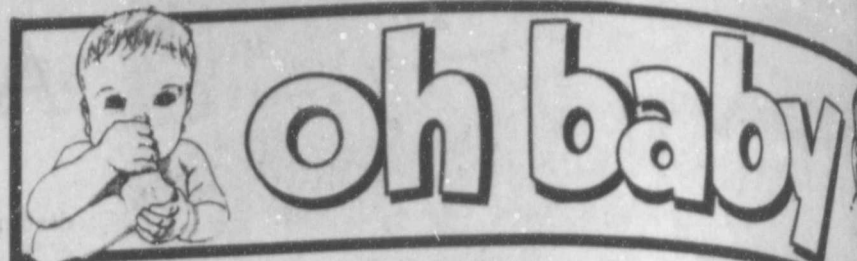

### HALL

Mark and Gay Hall of Seagraves are the proud parents of twin boys born October 15 at 8:00 a.m. in Methodist Hospital in Lubbock. Mathew Ross weighed 5 lbs., 9 ozs. and was 19 1/2 inches long. Max Ryan weighed 5 lbs., 1 oz. and measured 19 3/4 inches long.

Gay is the former Gay Miller. Mark is band director at Seagraves.

Grandparents are Mr. and Mrs. Curtis Hall of Petersburg and Mr. and Mrs. D.L. Miller of Barwise Community.

### PARR

Mr. and Mrs. Jerry Parr of San Marcos announce the birth Monday October 25 at 5:00 of their daughter Kristin Lee.

The 7 lb., 3 oz. infant was born in Hays Memorial Hospital in San Marcos.

Mr. and Mrs. Robert Patillo of Nixon and Mr. and Mrs. Travis Parr of Floydada are grandparents.

### ROURKE

Tom and Lynn Rourke of Mineral Wells, are parents of a daughter, Carly Marie. She was born October 21,

in Harris Hospital, Ft. Worth, weighing 7 lbs., 12 ozs.

Carly has an older sister, Erin, who is 2 1/2.

Grandparents are Thomas and Marie Rourke of De Soto, Texas, and Mack and Margie Fowler of Floydada. Carly also has a great-grandmother, Hatsue Shimizu, of De Soto, Texas.

### SHERMAN

Mr. and Mrs. Sherman are the proud parents of a son, Robert. Born October 13, he weighed 7 pounds and was 23 inches long. Grandparents are Mrs. Carl A. Sherman of Lockney.



**Sue's Gift Shop & Accessories**  
126 W. Calif. - Floydada  
983-5312

## Calvary Baptist ladies met to study Israel

Calvary Baptist Church ladies met in their study of Israel. Chairman Mrs. Cathy Hill called the meeting to order.

Some business matters were discussed on local missions. Prayer calender was by Mrs. Hazle Powell and the session on Israel was led by Mrs. Deota Odum and the

program Irene Wexler, Estelle Gilbreath, Hazle Powell and Mildred Haile.

Ten ladies present were Jo Payne, Cathy Hill, Irene Wexler, Hazle Powell, Mildred Haile, Mrs. Eula Meredith, Estelle Gilbreath, Arlene Holmes, Deota Adam, and Birdie Drummond.

# HALLOWEEN CARNIVAL and PARADE

## COME IN COSTUME AND WIN PRIZES!

- |                        |                        |
|------------------------|------------------------|
| 10 yrs. old and under  | 11-18 yrs. of age      |
| First place - \$20.00  | First place - \$20.00  |
| Second place - \$10.00 | Second place - \$10.00 |
| Third place - \$5.00   | Third place - \$5.00   |

Meet at the booth on the downtown square at 3:00 p.m. on Saturday and be in the parade! All in costume will march around the square twice and then prizes will be awarded. Carnival at the below listed downtown merchants will begin at 4:00 p.m.

- |   |                                  |
|---|----------------------------------|
| Sears - Horror House                      | Thompsons Pharmacy - Guess Who   |
| Lovell-Collins Jewelry - Prize Booth      | Gene's Cleaners - Treats         |
| Roye's Merle Norman - Surprise Booth      | Sue's Gifts - Grab Bag Booth     |
| Hale's Dept. Store - Go Fishin'           | Script Printing - Balloon Pop    |
| Hesperian - Spook House                   | Azteca Cafe - Balloon Throw      |
| Anderson's Dept. Store - Ring Toss        | Kirk & Sons - Bean Bag Toss      |
| Stitchin' Pretty - Surprise Balloon Burst | Collins Appliance - Dart Throw   |
| Floyd County Museum - Fortune Telling     | Parker Furniture - Stairway Game |
| KKYN Booth on the square - Apple Bobbing  |                                  |
| City Auto - Ball Throw & Ping Pong Pitch  |                                  |
- TICKETS to participate in booths are 5 cents each and may be bought at the booth on the square

**Sears**

**Come one & all!**

**"The Best Little Horror House in Texas"**

Complete with real witches!

**Carnival** ★ 4:00 - 6:00 p.m.

**Attention Moms & Dads!** All day Saturday

Burst your balloon for your special discount or gift - register for cakes & pumpkins

**October 31, 1981**

★ Children 10 and under must be accompanied by parents

Stitchin' Pretty

Welcome Little Ghosts & Goblins

**Carnival - Surprise Balloon Booth** 4:00 - 6:00 p.m.

**Attention Moms:** Come pick a balloon for your surprise discount or gift All day Saturday

**October 31, 1981**

## Penseroso Jr. Study Club met Oct. 22

The most important thing is communication. Never be afraid to be yourself and never be ashamed to get help. Sandy then answered questions. We were all a little better equipped to deal with stress following her talk.

After a very interesting roll call - My Greatest Weakness - the meeting was called to order. Minutes were read. Old business discussed and new business was brought forward.

Members voted to give a Valentine party to the residents of the Lockney Care Center.

The money earned at the planned December 12 breakfast will go toward buying a new color television for the Care Center. Il Penseroso is paying the balance. Members were asked to send recipes to the Care Center for their cookbook.

Quilt squares were passed out. They are due February 25.

The play Aladdin and His Magic Lamp will be presented the 17th of November.

Members present were Gayle Jackson, Kay Martin, Linda Marr, Cathy Barnett, Reeda Cay Smith, Lisa Mosley, Sandra Cummings, Treena Aston, Kim Lambert, Julie Hickerson, Janette Workman, Judy Jackson, Cynthia Bybee, Cindy Ford, Kelly Fortenberry, Ginger Mathis, Kathy Kellison, Anita Bigham, Lesca Durham, Charlanne Burson, Jessie Johnson, Linda Cunyus and guest Marilyn Biggs and Laura Wilson.



**ENGAGEMENT ANNOUNCED**—Mr. and Mrs. Edd Neff announces the engagement and approaching marriage of their daughter, Angela Kay, to Dale Stevens, son of Mr. and Mrs. R.A. Stevens of Morton. The couple plan a December wedding.

## Alpha Sigma hosts of Halloween social

Roll was called and minutes of the last meeting were read and approved.

Everyone welcomed new member Janice Poteet.

Treasurer Barbara Edwards gave report of the treasure and all bills will be paid.

There will be a Halloween social at Lighthouse Electric Saturday night at 8:00. All family members can attend and there will be a spook house with refreshments. There will also be an item to be raffled off at the party. Mary Emert is hostess.

## Gift tea honors Linda Sue Morris

A gift tea held Saturday afternoon in the home of Mrs. Warren Mitchell, south of Lockney, complimented Miss Linda Sue Morris of Slaton.

Miss Morris and Mike Ferguson of Lockney will be married Nov. 14 in Slaton.

Mrs. Mitchell greeted guests and presented them to the honoree, her mother, Mrs. O.D. Morris of Slaton, and Mike's mother, Mrs. James Ferguson.

Guests were registered by the prospective groom's sister, Miss Julie Ferguson of San Angelo. Special guests were Miss Morris' grandmother, Mrs. Berdie Yandell of Slaton, and Ferguson's grandmothers, Mrs. Hall Ferguson of Lockney and Mrs. M.D. Lacy of Lubbock.

The grandmothers, mothers and Miss Morris wore corsages of blue and white silk flowers.

Among the out-of-town guests was Ferguson's great-aunt, Mrs. R.L. Rawdon of Plainview.

Mrs. L.T. Cooper and Mrs. G.L. Hight alternated at the serving table which was covered with a white lace cloth over blue. A silver and crystal server was filled with white daisies and blue accents to form the table centerpiece. A silver service was used to serve coffee and hot apple juice. Also served were assorted cookies, ham roll-ups and nuts.

The hostesses gave the betrothed couple a set of cooking ware. On the hostess list were Mmes. Cooper, Hight, Mitchell, Richard Wiley, Keith Jackson, Jeff Terrell, Bill Race, Joe Nance, Ray Aston, Tom Duvall, Ray Ford, Glen Cooper, Delton Jack, Tom Johnson, Buck Ford, Tom Marr, David Frizzell, George Sparkman, Carolyn Whittington, Dub Mercer and Alice Mitchell.

## Alpha Sigma attend convention

Local merchants and a charm with this year's theme for members bracelet.

Saturday night around the campfire included chili, crackers, coffee, tea and dessert with live entertainment during dinner. Dean Yates in Concert was featured after dinner. Door prizes were drawn for. Everyone then adjourned to the Perryton Elks Lodge for the hospitality room.

Sundays activities were kicked off with a continental breakfast of coffee and donuts. Devotionals were held

and Jack Ross, Vice President of Beta Sigma Phi in Kansas City, Missouri held forums.

Lunch of chicken tetrazini, salad, green beans, rolls, coffee, tea and dessert were served. Luncheon entertainment was provided by Lawrence Ellzey of Post singing a country and western medley. The Dainty Darlings then gave a twirling performance.

More door prizes were given as they were through-out the two day activities.

Jack Ross presented a special message to all members from the International Office.

Awards for yearbooks, scrapbooks, those traveling the furthest, member in Beta Sigma Phi the longest and chapter with most members attending were given.

Three Amarillo Chapters bid for the 1982 convention. Members were asked for suggestions for a theme. Chapters will be contacted later as to the theme and dates.

Those attending from Floydada were June McLaugh, Rhonda Guthrie and Lynn Daniel.

## Wedding joins Ferguson, Ramirez

Mrs. Deral Ferguson announced the marriage of her daughter, David Ramirez, to a young man from Plainview.

The couple was married on October 14 at her home in Plainview, where they are now residing.

## Hosts Hulcy's

### Wedding shower Oct. 24th

A lamp was presented to Mrs. Hulcy by hostesses: Mmes. Carl Lee, Jr., Gene Collins, A.T. Moore, Austin Beedy, Larnce McCain, Homer Ragland, June Bybee, Dale Galloway, Donald Reecer, Fred Huggins, Georgia Galloway, Jack Frizzell, Edith Patterson, Kenneth Holt, Louis R. Stapp, and Kelton Shaw.

**FLOYD DATA**  
Mrs. D.L. (Jean) Miller is continuing treatment in Methodist Hospital in Lubbock. She had the misfortune of both legs breaking at her home, October 19. She is in room 228 and would appreciate cards and visits.

## Remember Now So You Can Remember Then.

### A Professional 8 x 10 Color Portrait For 88 Cents

All ages welcome - babies, adults, and families! Choose from our selection of scenic and color backgrounds. We'll select poses, and additional portraits will be available with no obligation. Satisfaction always, or your money cheerfully refunded.

88¢ per sitting. No charge for additional group subjects. One special per person. Backgrounds may occasionally change. Remember, children must be accompanied by parent.

**These Days Only Thursday, Friday & Saturday October 29-30-31**

Daily: 10 a.m. - 5:30 p.m.  
Saturday: 10 a.m. - 4:30 p.m.  
106 E. Calif. St. - Floydada

**PERRYS**



## Lockney Methodist to hold Harvest Festival

The public is invited to join members and friends of the First United Methodist Church of Lockney in activities of the third annual Harvest Festival to be held Saturday in the church fellowship hall.

A turkey and dressing meal will be served from 11:30 to 12:30. Tickets are \$3.50 for adults and \$2.50 for children 10 years old and under. Take-out plates may be picked up during the same time.

A Country Store for hand-made and homecooked items under \$25 will open at 10 o'clock, and remain open through the meal.

An auction of the larger items, including paintings, a quilt, an afghan, a mailbox, etc. will begin at 1 p.m. Jack Dulin of Hale Center is to be auctioneer.

Other items not listed will be available in both the Country Store and in the auction.

A special service, for shut-ins only, is delivery of the takeout plates. To request the delivery service, persons should call the church at 652-2193. Delivery will begin at 11 o'clock.

**Don't Be Tricked**  
Trick-or-treaters can cut down the chances of running into trouble by staying in their own neighborhoods. Children should be reminded that parents must inspect all unwrapped treats before they're eaten.

The time is here to plan your Christmas decorations and gifts. Let us design them for you.

Our "Do It Yourself" items are on display

**Christmas Gifts for every member of the Family.**

FREE Gift Wrapping

We accept Master Charge & VISA

**SCHACHT'S**  
Flowers, Jewelry & Gifts

*"Our Pleasure Is To Serve You"*  
112 W. Poplar - Lockney  
652-2385

3 Ways To Buy: Cash-Layaways-Master Charge or VISA

# ANDERSON'S

DEPARTMENT STORE

120 West California Floydada

We appreciate your patronage for the past 4 years and we hope you will continue to shop Anderson's for all your clothing needs.

**SPECIAL ON**

One Group of Bath Towels ONLY \$4.44 each

Reg. \$5.00 to \$6.00 values

ALSO

Stripe Size 24x60

**Rug Runners ONLY \$1.99**

Reg. \$3.29 values

**SPECIAL ON**

Ladies Winter Coats Asst. Styles - Short & Long

**Reduced 20%**

**SPECIAL ON**

One Group of Ladies Sportswear

NOW

**Reduced 33 1/3% off**

**SPECIAL ON**

Mens Fall Suits Sizes 36 to 48 - Reg and Longs

**Reduced 25% off**

Thursday - Saturday

**SPECIAL ON**

Girls Jeans Sizes 2 to 6x and 7-14

**Reduced 20% off reg price**

**SPECIAL ON**

Ladies and Jr. Jeans One Group of Asst. Styles

**Reduced 25% off reg price**

**SPECIAL ON**

Mens Colored Wrangler Jeans Reg. \$17.00 Values

ONLY **\$12.88**

Thursday - Saturday

**SPECIAL ON**

Bell Bottom Mens Sedgfield Jeans Reg. \$25.00 Values

ONLY **\$18.88** a pr.

**LOVELL-COLLINS JEWELRY**

102 S. MAIN FLOYDADA, TEXAS 79209

Stainless... The American-Made Tableware

## PRE-HOLIDAY SALE!

**33 1/3% OFF ON 20-PIECE SERVICE FOR 4**

Includes: 2 Place Forks, 2 Place Knives, 4 Place Spoons, 1 Teaspoon

HEIRLOOM STAINLESS \$146.66

COMMUNITY STAINLESS BY ONEIDA \$83.33

20-Piece Set (Reg. \$95.00) ... \$83.33

Complete your service with matching accessories sets.

4-Piece Hostess Set \$35.75

Contains: Grey Ladle, Cold Meat Fork, Dessert Server, Pierced Teaspoon.

4-Piece Serving Set \$27.50

Contains: Sugar Spoon, Butter Knife, 2 Teaspoons.

HEIRLOOM STAINLESS \$146.66

COMMUNITY STAINLESS BY ONEIDA \$83.33

20-Piece Set (Reg. \$95.00) ... \$83.33

Complete your service with matching accessories sets.

4-Piece Hostess Set \$35.75

Contains: Grey Ladle, Cold Meat Fork, Dessert Server, Pierced Teaspoon.

4-Piece Serving Set \$27.50

Contains: Sugar Spoon, Butter Knife, 2 Teaspoons.

MURPHY SALE ENDS NOVEMBER 28, 1981.

**ONEIDA**

... of age ... place - \$20 ... nd place - \$10 ... d place - \$8 ... 3:00 p.m. ... me will ... s will be ... merchants ... acy - Guess W ... Treats ... Bag Booth ... balloon Pop ... loon Throw ... an Bag Toss ... Dart Throw ... Stairway Game ... ach and ... re

# WE'VE DEFLATED THESE PRICES - JUST FOR YOU!

NOW'S YOUR CHANCE TO STOCK UP AT SUBSTANTIAL SAVINGS

10 oz. Cambells Chunky Old Fashioned Vegetable Beef SOUP **59¢**

17 oz. Our Darling Whole Kernel or Cream Style CORN **2/79¢**

19 oz. Campbells Chunky Steak & Potato SOUP **99¢**

Buddy's Grade 'A' Homo or Lowfat MILK **\$1.19** 1/2 gallon  
**\$2.29** gallon

32 oz. Liquid Detergent IVORY **\$1.69**

MARYLAND CLUB Coffee ALL GRINDS 3 lb **\$4.69** with coupon  
\$5.69 without coupon

USDA T-BONE STEAK **\$2.59** lb

Lean & Tasty PORK STEAK **\$1.39** lb

8 oz. Fisher Boy FISH STICKS **69¢**

Country Style SPARE RIBS **\$1.49** lb

USDA Fresh Daily GROUND BEEF **\$1.29** lb



USDA Boneless SIRLOIN STEAK **\$2.39** lb

USDA Boneless ROUND STEAK **\$2.29** lb



50 Count Hefty Foam PLATES **\$1.99**



Jumbo Roll Generic PAPER TOWELS **2/99¢**



19 oz. Nabisco Chips Ahoy COOKIES **\$1.49**

12 oz. Hi-C FRUIT DRINK **3/89¢**

32 oz. Refill Window Cleaner WINDEX **\$1.29**



SAVAGE 4 1/2 OZ. BTL. AFTER SHAVE **\$1.89**

12 OZ. BTL. LISTERINE MOUTHWASH **\$1.39**

## Fruits & Vegetables

"The FRESHEST in Town"



Bananas **5 \$1** LBS.

CHIQUITA GOLDEN RIPE

NEW CROP RED ROME Apples **LB. 49¢**

TEXAS NEW CROP Oranges **LB. 3/\$1**

EAST TEXAS FINEST YAMS **LB. 39¢**

New Crop Firm Green LETTUCE **head 39¢**

New Crop Texas Ruby Red GRAPEFRUIT **3 lbs \$1.00**

Heirloom quality European 24% Lead Crystal **FREE**

Collect our CASH SAVER COUPONS and save over \$287 on a complete 48-pc. service set.

It's so easy - just fill in the Cash Saver Card with Cash Saver Coupons. You'll receive one coupon with every purchase. For example, if you make a \$15 purchase you'll receive 3 coupons. Each coupon only takes 20 coupons to fill each card. Each completed card entitles you to your choice of 1 place setting. Collect a complete set of sparkling Sheffield crystal at unbelievable savings.

\*One Stemmed Water Glass, Cordial, Beverage or Champagne/Sherbet.

6-12 oz. Cans TAB OR COCA COLA **79¢** with coupon  
\$1.29 without coupon



Log Cabin Syrup **\$2.39** 36 OZ. BTL.  
Pancake Mix **99¢** 32 OZ. PKG.

Betty Crocker Cake Mixes **89¢** 18.5 OZ. PKG. ASSORTED  
Frosting **\$1.29** 16.5 OZ. READY TO SPREAD ASSORTED

6-32 oz. Bottle Carton TAB OR COCA COLA **\$1.19** with coupon  
\$1.29 without coupon plus deposit

28 Count PLAYTEX DEODORANT TAMPONS **\$1.99**

5 oz. Swifts VIENNA SAUSAGE **55¢**

14 oz. Contidina Whole TOMATOES **55¢**

10 lb 11 oz. Family Size TIDE **\$6.69**

2 Bar Pack DOVE SOAP **\$1.19**



Monday through Saturday 8 a.m. - 9 p.m. Sunday 9 a.m. - 8 p.m.

Double S&H Green Stamps on Wednesday with \$5.00 purchase or more

Values In This Adv Effective Thru Wednesday, November 4, 1981

# buddy's SUPERMARKET

220 South 2nd - Floydada

# STAMP PRICE SPECIALS

## More savings!

Remember what a penny could buy in the "good old days"? Well, take a good look at our good old thrifty Stamp-Price Specials! For just a few pennies... and a 1/4 Saver Book of Green Stamps (50 Big 10's)... it's happy days are here again!... every day! Stamp-Price Specials are just one more way we help you save money through Green Stamps. Every time you shop. Hurry in for your Stamp-Price Specials Saver Books. The more you shop... the more you save. Promise. Prices on these four Stamp-Price Specials effective through 10-31-81.

**STAMP PRICE SPECIAL**

3 lb White Swan Pure Vegetable **SHORTENING**  
With One Filled S&H Special Saver Book  
**99¢**  
\$1.59 Without Book

**STAMP PRICE SPECIAL**

1 lb Box White Swan Saline **CRACKERS**  
With One Filled S&H Special Saver Book  
**9¢**  
69¢ Without Book

**STAMP PRICE SPECIAL**

12 oz. Box Keebler **VANILLA WAFERS**  
With One Filled S&H Special Saver Book  
**29¢**  
89¢ Without Book

**STAMP PRICE SPECIAL**

21 oz. Comstock **CHERRY PIE FILLING**  
With One Filled S&H Special Saver Book  
**89¢**  
\$1.49 Without Book

15 oz. Cinch Spicy **CORN BREAD MIX** **59¢**

49 oz. Laundry Detergent **DASH**  
**\$1.59**

200 Count Crusader Filler **NOTEBOOK PAPER**  
**\$1.29**

17 oz. Princella Cut **YAMS**  
**59¢**

32 oz. Laundry Detergent Liquid **ERA**  
**\$1.49**

30 oz. Gebhardt's Jumbo **TAMALES**  
**99¢**

Gallon Rich n Ready **FRUIT OR ORANGE DRINK**  
**99¢**

What have S&H Green Stamps to do with the price of bananas?



**NOT A THING!**  
Stamps don't raise our prices! Shop! Compare! Be convinced!

32 oz. Black Burn Crystal **WHITE SYRUP**  
**89¢**

10 oz. Campbells **CHICKEN BROTH**  
**3/\$1.00**

Golden Ripe **BANANAS**  
**5 LBS / \$1.00**



**Double S&H Green Stamps**  
Thursday, Friday or Saturday  
With This Coupon and Purchase of \$20.00 or More  
Expires 10-31-81

**200 Extra S&H Green Stamps**  
With This Coupon and Purchase of \$20.00 or More  
Expires 11-4-81



Double On Wednesday With A \$5 Purchase Or More

**buddy's SUPERMARKET**

Values In This Adv Effective thru Wednesday, November 4, 1981  
220 South 2nd - Floydada



BRUCE WILLIAMS makes his way through the Lockney defense for a touchdown in Friday night game.



MICHAEL SAENS makes an outside sweep for more yardage in Thursday's game against Idalou.

# Winds blow Lockney away 42-0

By GAR FRY  
Herald Sports Writer

**LOCKNEY** — Floydada tailback Bruce Williams exploded for 205 yards rushing in 35 carries while the Whirlwind defense held Lockney's rushing attempt to 15 total yards as the Whirlwinds shut out the Longhorns 42-0 in District 3-3A rivalry competition here Friday night.

Williams put on an amazing performance in the clash sprinting to the goal line for three touchdowns as the Whirlwinds remained undefeated in district play after three games. Floydada holds the top spot in District 3-3A obtaining a 6-1 seasonal record, being defeated only by top-ranked Littlefield in a non-district clash.

Lockney quarterback Jeff McCormick again found the airway successful to complete five passes for 89 yards in 20 attempts. Meanwhile, the Longhorn secondary was able to hold the Whirlwinds to 38 yards passing as quarterback Todd Beedy completed four of nine attempts.

**THE INITIAL** score for Floydada was set up by a 6: yard punt return by Williams to the two-yard-line. It took only one play for

the touchdown as Beedy ran up the middle. The PAT attempt failed and the Whirlwinds had a 6-0 lead with 3:29 left in the first quarter.

Williams recovered a fumble on the Longhorn 43 and later capped the scoring drive with a two-yard-run with 7:07 remaining in the first half. Williams then sprinted into the endzone for two more points.

The following possession for the Whirlwinds resulted in the last score in the half as Floydada drove the ball 43 yards with Carlos Rainwater grabbing the scoring eight-yard pass from Beedy with 1:59 left on the clock. Donell Weeks booted the extra point to give the Whirlwinds a 21-0 lead at the half.

Lockney threatened to score just before the intermission as Jeff Reece intercepted a pass attempt on the Lockney 35 and sprinted 50 yards before being stopped at the 15-yard-line as time ran out.

**IN THEIR** second possession after the half Floydada drove the ball 75 yards for another TD as Williams sprinted 15 yards for the score. Weeks again booted the PAT with 3:43 left in the third period.

Lockney then fumbled on the kickoff return and

Calvin Coleman recovered the ball on the Lockney 30 for Floydada. The Whirlwinds moved the ball to the 14-yard-line, but Longhorn Jeff McCormick put an end to the drive by intercepting a pass attempt by his counterpart.

Whirlwind defender Ronnie Minner ended the succeeding scoring threat by Lockney by grabbing an interception on the Floydada 10. The Whirlwinds then drove the ball 88 yards as Williams broke for a 44-yard scoring sprint with 6:07 left in the competition. Weeks successfully booted the extra point putting Floydada on top 35-0.

On the next possession Floydada marched the ball 66 yards climaxed by a 22-yard sprint by Todd Beedy for the last touchdown of the evening. Weeks booted the PAT to cap the scoring for the Whirlwinds with only 36 seconds remaining in the clash.

"Our boys played real good football," commented Floydada Coach L.G. Wilson. "Lockney played tough but we eventually wore them down. We were able to make the big plays when we needed to."

In a clash of rivalries the competition was relatively free of penalties as both clubs were flagged on only

three occasions. The dominated possession they drove for 11 able to come up with seven.  
"I'm glad to see because you never what will happen to play them," said Wilson. "I think we definitely a contest district race, but we tough game against the next week. We have problems with the past and I think it's a good game."

The defeat gives a 2-5 record remaining district competition being defeated by their district opponent.

Keep Your Goblins Safe  
Sidewalk Safety  
Halloween provides a time to review pedestrian rules with children. They be reminded to always stay out of the street walk safely including not running, and ing to cross only at



Have a safe Halloween!

Long-term credit to buy or improve land.

The Land Bank

Close to the land and the people who work it

105 South Wall 983-2480

Floydada



This Beautiful Companion Memorial

Only \$595.00

CLINE MONUMENT CO.

400 Joliet Phone 296-2953 Plainview, Tx. 77461

Save Sales Agents Commission In Plainview

## JV declaw the Wildcats 28-12

The JV football team defeated Idalou 28-12 last Thursday.

In the first quarter Mark Hatley made a 1 yard run while a pass for the extra

points failed. Michael Seans, in the second quarter, scored on a 4 yard run. Mark Hatley

passed to Max Bearden for the PAT. Also in the second quarter Seans made a 3 yard run to make the score 21-0 with Bearden's kick for the PAT.

## Breezers make good show

The 7th Grade Breezers defeated Idalou last Thursday 38-0 making the 7th grade record an even 6-0.

Toney put more points on the score board with a 25 yard pass while Cortinas added two more points.

In the 8th grade Breezer game Idalou won 18-0, making the Breezers a 2-4 record. "Idalou had a tough team, we played them down," said Coach Pair. "we're proud of the way the boys played."

In the third quarter Carlos Baker scored on a 55 yard punt return with Bearden kicking for the extra points. In the fourth quarter, Idalou scored twice.

Johnny Davis scored on a 15 yard run with Willie Cortinas scored two points on the PAT. Again, Johnny Davis on a 48 yard run scored and came up with the PAT for two more points. James

Toney made a 75 yard run to score again but the extra points failed. Making the score 38-0. Shannon Barbeeran for 1 yard and Leif Younger scored 2 points defeating the Wildcats.

The next game will be at Abernathy with the 7th grade leading off at 5:00 and the 8th grade following.

The defeat of Idalou made the JV record 6-0. The next game will be here against Abernathy. Thursday, at 5:00.



Sponsored by... Ponderosa Meat Co. and Floydada Co-op Gins Inc.

## HALLOWEEN SPECIALS

24x40 Reg. \$3<sup>27</sup>  
**AREA RUGS** \$2<sup>49</sup>

36 oz.   
**THERMOS BOTTLE** Reg \$4<sup>77</sup> \$2<sup>99</sup>

**ENCYCLOPEDIAS** Reg. \$9<sup>88</sup> \$5<sup>88</sup>

**FF SUEDE & VELOUR** Reg \$2<sup>44</sup> \$1<sup>99</sup>

**TRASH CANS** Two Sizes Reg \$8<sup>44</sup> \$6<sup>99</sup>

**PERRYS**  
114 E. California  
VISA & Master Card Welcome







SHERYL WALTRIP

### Baptist Women met for Bible Study

Baptist Women of the First Baptist Church, Floydada, met in the home of Mrs. J.R. Turner, October 1, for Bible Study.

Mrs. G.W. Switzer was leader of the program about My Bible and Material Possessions.

Others present and assisting with the program were Mesdames W.H. Bunch, Bill Daniel, Floyd Lawson, W.B. Parrack, Anthony Latta, Alan D. Benson, T.L. Holland, J.S. Hale, Nettie Adams, Vada Meredith, Cleo Goins and May Garrett.

Refreshments of coffee, tea and cake were served by Mrs. Turner.

Mrs. Benson announced a Mission Book will be taught at the church in November.

### Waltrip to compete in pageant

Miss Sheryl Waltrip, age 16, daughter of Mr. and Mrs. Dean Waltrip of Enochs and niece of Mr. and Mrs. Don Chesshir of Floydada, has been selected to be a finalist in the Annual 1982 Miss Northern Texas National Teen-Ager Pageant to be held at Clarendon College, Clarendon, Texas, on May 14th, 15th and 16, 1982. The Miss Northern Texas National Teen-Ager Pageant is the

Official Regional Finals to the Miss Texas National Teen-Ager Pageant to be held in June, 1982.

Nancy Daniel of Hampshire, Texas, the 1981 Miss Texas National Teen-Ager will crown the new Queen.

The reigning Miss National Teen-Ager is Lisa Bell of Wapato, Washington.

Each contestant accepted will be requested to participate in the Volunteer Com-

munity Service Program of the National Teen-Ager Pageant. This program teaches teen-agers to share and to participate in school and civic affairs. A Mini-Modeling Charm Course will be given during the week-end of the Pageant.

The winner of the Miss Northern Texas National Teen-Ager Pageant will receive a Cash Scholarship, other prizes and will be fully sponsored to compete in the Miss Texas National Teen-Ager Pageant to be held at Texas Christian University in Fort Worth. Contestants will be judged on scholastic achievement, leadership, poise-personality and appearance. There is no swimsuit competition.

Each contestant will have a choice of either reciting a 100-word "Essay" on the subject, "What's Right About America" or a 2-minute talent presentation providing her own music and/or props.

Miss Waltrip is being sponsored by The Muleshoe Jaycees. Her hobbies include basketball, track, cooking and sewing.

### Senior Citizen Menu

Nov. 1-6

Monday — Pork chops, cream gravy, buttered spinach, roll, margarine, peach tapioca, milk, tea, coffee.

Tuesday — B.B.Q. beef tips, buttered rice, buttered peas and carrots, cornbread, margarine, raisin cookie, milk, tea, coffee.

Wednesday — Turkey pie with biscuit topping, green beans, lettuce, tomato, salad dressing, roll, margarine,

orange whip, milk, tea, coffee.

Thursday — Ground meat patties with mushroom sauce, hash brown potatoes, buttered cabbage, cornbread, margarine, canned plums, milk, tea, coffee.

Friday — Chicken fried steak, cream gravy, mashed potatoes, tossed salad with carrots and tomatoes, roll, margarine, peanut butter cake, milk, tea, coffee.

### Floydada School Menu

November 2-6

Monday: Breakfast: Juice, Cheese Toast, milk.

Lunch — Beef pizza with cheese, buttered corn, tossed vegetable salad with dressing, apple crisp, milk

Tuesday: Breakfast — Juice, long Johns, milk

Lunch — Chicken fried steak with gravy, whipped potatoes, green beans, fruit jello, milk

Wednesday: Breakfast — Juice, toast, bacon, jelly, milk

Lunch — Pigs in blanket with mustard, blackeye peas, dill pickle spears, sugar cookies, milk

Thursday:

Breakfast — Juice, pancakes, syrup, butter, milk

Lunch — Chicken pot pies, early June peas with carrots, pineapple and cheese salad, hot rolls, milk

Friday:

Breakfast — Juice, hot rolls, sausage, milk

Lunch — Chicken pot pies, early June peas with carrots, pineapple and cheese salad, hot rolls, milk

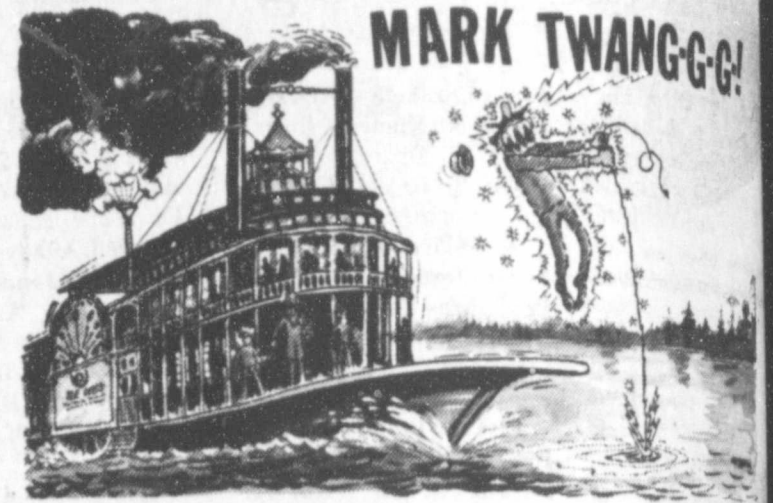

Turbines suspended in the Mississippi River current may one day provide electric energy. This possibility along with many others is being investigated today.

The electric cooperative is working with industry and government leaders in the exhaustive search for alternate, less costly energy sources to produce electricity.

But for the present we have only five ways to meet the demand; gas, coal, hydro, nuclear and conservation. Of these five, conservation, available nationwide, is the surest way to stretch kilowatts and save on your electric bill.

**LIGHTHOUSE ELECTRIC COOPERATIVE**

**SPECIAL**  
Every Wednesday

HAMBURGERS  
**3/\$3.00**

1 HAMBURGER, 1 FRY,  
& 1 SMALL COKE \$2.00

TACOS 60¢ each or 3/\$1.50

**ALLEN'S DIXIE DOG**  
410 E. Houston 983-5161

**FRIDAY DO SPECIAL**

**Complete CATFISH DINNER \$3.99**  
ALL YOU CAN EAT

*Including* Catfish with Tartar Sauce  
Red Beans • French Fries • Cole Slaw  
Onions • Jalapeno Peppers • Hush Puppies

**SERVED FRIDAY NIGHT**  
STARTING AT 5 PM & ENDING AT 9 PM

NO TO-GO ORDERS

at your **FLOYDADA Dairy Queen**

Simple reasoning will tell you — if saving stamps have a redemption value, some one has to be paying for the redeemed merchandise.

Ask yourself, "Who is paying for stamps?"

**WIN BIG DAILY**

**309 S. Wall** **Floydada, Texas**

EKCO ETERNA HEAVY DUTY ALUMINUM COOKWARE

# FRY PANS



THE FINEST NON-STICK SURFACE EVER DEVELOPED BY DUPONT

DUPONT SilverStone

Only **\$3.99** Regularly 5.00

This Piggly Wiggly Coupon Good For  
**\$2.00 OFF**  
 ON EKCO ETERNA Country Garden Cookware  
**8" SAUTE PAN**  
 Valid Thru Wednesday, Nov. 4, 1981. Limit One Per Family  
 8:00 a.m. to 8:00 p.m.  
 8:00 a.m. to 7:00 p.m.



EASY CLEAN PORCELAIN ALUMINUM FOLLOW THIS WEEKLY SCHEDULE

Week	Item	12.00 Off Coupon	Regular Price
Week 1	8" Saute (off pan)	\$ 3.99	\$ 5.99
Week 2	9" Saute (off pan)	7.99	9.99
Week 3	10" Saute (off pan)	8.99	10.99
Week 4	11" Omelet	9.99	11.99
Week 5	12" Saute (off pan)	11.99	13.99
Week 6	8" Open Skillet	6.99	8.99
Week 7	10" Open Skillet	9.99	11.99
Week 8	11" Griddle	9.99	11.99
Week 9	1 Qt. Open Saucepan	5.99	7.99
Week 10	1 1/2 Qt. Covered Saucepan	9.99	11.99
Week 11	2 Qt. Covered Saucepan	10.99	12.99
Week 12	3 Qt. Covered Saucepan	11.99	13.99
Week 13	4 Qt. Covered Skillet	14.99	16.99
Week 14	5 Qt. Covered Dutch Oven	14.99	16.99
Week 15	2 1/2 Qt. Tea Kettle	9.99	11.99

These advertised items is required to be readily available for sale at or below the advertised price in each store, except as specifically noted in this ad. We reserve the right to limit quantities. None sold to dealers.

**PORK CHOPS**  
 Center Cut Rib or Loin  
**1.89**  
 12 oz. **89¢**

**BONELESS HAMS**  
 Shurfresh  
 1/2 or Whole  
**\$2.19**  
 lb.  
**Bacon**  
 Shurfresh Sliced  
 16 oz. **\$1.29**

**BAKING HENS**  
 Shurfresh  
**67¢**  
 lb.  
**Cheese Spread**  
 Pimento or Jalapeno 7 1/2 oz. **99¢**

**BEEF STEAK**  
 Center Cut Chuck 7-Bone  
**\$1.79**  
 lb.  
**Ground Beef**  
 Lean  
 lb. **1.73**

**POTATOES**  
 10 lb. Russett No. 2's  
**\$1.29**

**BANANAS**  
**\$1**  
 3 lbs. for

Golden Delicious  
**APPLES**  
**\$1**  
 3 lbs. for

Borden's  
**ICE CREAM**  
 VANILLA  
**\$1.62**  
 2 gal.

32 oz.  
**COKE**  
**\$1.39**

Shurfresh  
**MILK**  
**\$1.99**  
 1 gal.

Always Fresh  
**BREAD**  
**99¢**  
 2 for

Large  
**EGGS**  
**59¢**  
 doz.

**CARROTS**  
 lb. **39¢**  
**Macaroni & Cheese**  
 Shurfine 7 1/2 oz. box  
**4/\$1**  
**Pork & Beans**  
 Shurfine 16 oz.  
**3/\$1**  
**Tomato Sauce**  
 Shurfine 8 oz.  
**4/89¢**

**GRAPEFRUIT**  
 Shurfine 12x25  
 lb. **29¢**  
**Aluminum Foil**  
 Shurfine 6 1/2 oz.  
 2 rolls **\$1**  
**Tuna**  
 Shurfine 13 oz.  
**79¢**  
**Evaporated Milk**  
**2/89¢**

Shurfine  
**SUGAR**  
**1.15**

Shurfine  
**COFFEE**  
 All Grinds  
**\$1.69**  
 1 lb.

Shurfine Cut  
**GREEN BEANS**  
**\$1**  
 16 oz. 3 for

Shurfine All Purpose  
**FLOUR**  
**79¢**  
 5 lb.

# Today's Lifestyles

By Marilyn Tate  
County Extension Agent



## TODAY'S BABY: AN \$85,000 BUNDLE

Shocking as the figures sound, current estimates place the cost of raising children at about \$85,000 from birth through 4 years of college at a public university. This is 33% higher than in 1977 when the figures were last updated. However, when you look at the cost of rearing a child as a percentage of your total income over the years—then that percentage—or chunk of your income has not changed all that much and it isn't expected to in the near future. But here are two estimated costs for 18 years of child-rearing (excluding the costs of childbirth and a college education) in the United States. It will cost a farm family in the South \$47,973 and an urban family about \$900 less. These figures only include direct maintenance costs for food, clothing, housing and medical care and education to age 18 in family that earns about \$18,000 a year. Families with higher after-tax income will have greater costs associated with child-rearing. For example, southern families with an after-tax income of \$22,500 to \$27,500 could expect costs to be \$71,478 (farm), and \$74,568 (urban). Add the costs of childbirth and a college education and the over-all cost approaches \$85,000. Averaged over 18 years, the cost of child-rearing takes about 19% of after-tax family income.

## SELF RELIANCE—BIG VALUE CHANGE ACROSS NATION

A "big" value change across the nation is underway — self-reliance, or "keeping down with the Jones," as some like to call it. It has lots of different characteristics, too: handwork is increasing in prestige, the simple life is "in" and conservation is "the Thing" to do.

Why? Inflation, nostalgia and a desire for a simpler, less-complicated lifestyle — long a disenchantment over quality of workmanship done by others and a larger chunk of leisure time — are some of the reasons.

How encompassing and different is the change from values and lifestyles of the past few years? Self-reliance seems to be sweeping the nation, and this rush to do things for one's self instead of paying someone else to do it reflects a substantial change in values.

Instead of ranking people by what they own, this emerging "prosumer" ethic (production for personal Consumption) is placing a status value on people for what they can do.

Handwork is increasing in prestige — whether it's to build one's own home, mend a fence, cook a great meal, make one's own clothes or

create a bountiful garden. What might have started as a hobby is becoming "personal Production" and it's likely to be economically significant as well as relevant to the molding of an individual's social character.

In fact, it appears likely that in the future human traits considered favorable by a large portion of society will include self-reliance: the ability to adapt and survive under difficult conditions and the ability to do things with one's own hands.

This "new" trend has an especially eager following in younger, more educated homeowners along with middle-income families — the two groups more prone to adopting the simplistic lifestyle, according to a California study.

Its findings report that such a lifestyle includes conservation through biking for transportation, self-sufficiency in services and goods, recycling of resources, such

as metal and glass, recycling of durable goods, such as furniture and clothes, and living productively with nature.

Implications for the next few years — and decades — to come are many.

Acceptance of voluntary simplicity — in addition to the changing values — could affect American society's consumption patterns, lifestyles and organization structure.

Some specific implications are these:

1. more widely accepted conservation.
2. an increased market for do-it-yourself products and recycled durable goods.
3. more interest in self-help programs, and
4. more control over individual quality of life with less concern for socio-economic status.

To say all this in just a few words: Simplicity is "in," and work, indeed is respectable.

## Lubbock to host state vet. reunion

The Texas Department of the China-Burma-India Veterans' Association (CBIVA) will hold its fall reunion at the Holiday Inn on October 30, 31, and November 1.

The CBIVA is made up of members of the Armed Forces who served in the China-Burma-India theater during World War II. There are a number of CBIVA servicemen, who live in West Texas area, but this reunion is statewide.

The meeting will be hosted by the Lubbock BASHA (Chapter), of which Harry Herber, 4503 78th Street, Lubbock (792-0303) is commander. There are approximately 30 members of the Lubbock BASHA (each chapter is named for the bamboo huts that were the barracks for most of the men who

served in this theater).

Of the more than 9,000,000 men who were in service in World War II, only about 400,000 served in the China-Burma-India Theater. This theater of war, often called the Forgotten Theater, was the supply line and support for the Republic of China, as all supplies and communications across the Pacific were blocked by the Japanese.

The American forces succeeded in tying up many divisions of the Japanese troops, which made the taking of the Pacific Islands much easier. American troops also built the famous Ledoburma Road that served as a supply route to China, once it was opened.

Prior to the opening of the road, all supplies were flown in and, at one time, Kun-

# Drivers must have proof of compulsory insurance

Beginning January 1, 1982, Texas drivers contacted by Department of Public Safety officers during traffic stops and vehicle accident investigations will be required to furnish proof of compulsory liability insurance law.

Under House Bill 197, an amendment to the Safety Responsibility Act approved this year by the Texas Legislature, all drivers must carry minimum liability coverage for medical expenses of \$10,000 per person (\$20,000 for two or more persons) and property damages of \$5,000.

Colonel Jim Adams, DPS director, said troopers will accept as evidence of insurance coverage the policy for the vehicle being operated or a document issued by the insurance company.

"Such a document must contain a statement that the liability coverage for the motor vehicle is the minimum prescribed by the law," Adams said. "The document must also include the name

of the insurance company, name of the insured person, policy period and policy number. This document may take the form of a letter or a card, depending upon the preference of the insuring company."

Adams pointed out that DPS troopers will be enforcing the provisions of this law along highways and rural roads.

"Local police officers and sheriff's deputies also have the authority to request this information from drivers," the DPS director said. "I am sure most law enforcement agencies in our state will also be enforcing this statute in their respective jurisdictions."

Drivers who do not maintain the specified coverage risk being fined at least \$75 for the first offense and a minimum \$200 for subsequent violations. In addition, a conviction under this new law will result in the suspension of the violator's driver license and motor vehicle registration unless the violator establishes and maintains proof of financial responsibility for five years from the conviction date.

Adams also said vehicles

which are to be used in the driving test by new driver license applicants must be covered by the minimum liability insurance specified by the law. Applicants will have to certify on the license application that the minimum coverage is in effect for the vehicle before they will be permitted to take the driving test.

The DPS director predicted that more Texans will obtain the required liability coverage when the new law goes into effect.

"Current figures show that approximately 74 percent of the drivers involved in accidents carry liability insurance," Adams said. "This indicates that a substantial number of people must secure the required coverage or face the possibility of heavy fines and loss of driving privileges."

Out-of-state, government-owned and self-insured vehicles are exempt from the insurance requirements of the new law. However, drivers of self-insured vehicles will be asked by DPS officers to produce evidence of self-insurance at accident scenes and traffic stops.

## Lubbock SBA disaster loan office moves

Phil O'Jibway, District Director of Small Business Administration's Lubbock District, announced recently that the processing office for SBA disaster loans, located at 720 Texas Avenue in Lubbock will move to the Federal Office Building effective October 28.

The office, which will be manned by a reduced staff, will be in Room 224 of the Federal Building located at 1205 Texas Avenue in Lubbock. The servicing office for existing disaster loans will continue to operate out of Room B-46 of the Federal Building, according to O'Jibway. The District Office is

located in Room 712, Federal Building. For additional information, call (806) 762-7481 or (806) 762-7462.

**PLAINVIEW Overhead Door**

**Genie Garage Door Openers**

**Don Terrell**

Residential • Commercial Sales • Service

DAY 293-8577 • NIGHT 3014 Dimmitt Hwy. Plainview

## Public Notice

FINANCIAL STATEMENT - August 31, 1981	
of the Dougherty T.S.D. No. 924	
I. Tax Rate 1980, \$ .70 per \$100.00 Valuation	
II. Assessed Valuation of District \$11,458,256	
Budget for 1980 - 1981	
RECEIPTS	
Balance on hand Sept. 1, 1980	\$ 23,956.88
State Funds	10,899.00
Local Taxes - Maintenance	119,897.46
County Available	62.94
Other Non-Revenue Receipts	62.94
Accounts Receivable	283.77
Total Receipts	134,796.99
Less Contingency Balance	11,458.26
EXPENDITURES	
Instruction & Administration	\$ 25,292.38
Operation of Plant	9,599.89
Maintenance of Plant	2,421.19
Transportation & Lunchroom	12,505.28
Fixed Charges (Ins. & Interest)	4,589.46
Out Going Transfers	13,588.25
Capital Outlay	19,349.02
Tax Collection-Evaluation	6,839.44
Accounts Payable-Prior Year	609.39
Accounts Payable-Current Year	( 529.81)
Total Disbursements	\$ 114,582.56

FINANCIAL STATEMENT - August 31, 1981	
of the South Plains T.S.D. No. 903	
I. Tax Rate 1980, \$ .51 per \$100.00 Valuation	
II. Assessed Valuation of District \$73,428,113	
Budget for 1980 - 1981	
RECEIPTS	
Balance on hand Sept. 1, 1980	\$ 27,447.32
State Funds	37,499.00
Local Taxes - Maintenance	90,807.11
County Available	106.47
Other Non-Revenue Receipts	238.34
Accounts Receivable	1,283.00
Total Receipts	157,573.24
Less Contingency Balance	38,283.90
EXPENDITURES	
Instruction & Administration	\$ 62,297.57
Operation of Plant	9,758.14
Maintenance of Plant	2,681.52
Transportation & Lunchroom	15,986.02
Fixed Charges (Ins. & Interest)	2,390.00
Out Going Transfers	11,452.05
Capital Outlay	7,533.87
Tax Collection-Evaluation	6,993.27
Accounts Payable-Prior Year	1,188.57
Accounts Payable-Current Year	( 1,805.95)
Total Disbursements	\$ 114,582.56

# Happy Birthday, Jennifer

from

**Robyn Dal**  
**Luke Bill**  
**Josh Melissa**  
**Dade & Murr**

**Lockney United Methodist Church**

invites you to attend the

**3rd annual Harvest Festival**

**Saturday**

**10 a.m. - Opening of Country Store**  
(small handcrafted & homemade goods)

**11:30 to 12:30 - Turkey & Dressing Lunch**  
\$3.50 for adults  
\$2.50 children under 11  
(Takeout plates available)

**1 p.m. - Auction of larger items**

Justin Payne, 14 months, son of Mr. and Mrs. Stanley Payne.

FOR SPECIAL CHRISTMAS GIFTING

Call today for your appointment

Chuck Wilson, M. Photog., CPP

**Wilson Photography**

552-3731

## More Classified

### Fully Reconditioned Used Farm Equipment

**SPECIAL PURCHASE—LOW PROFILE 4 WD TRACTORS WITH LESS THAN 100 HRS.**

1981 1190 Case 43 HP 53 Hrs.	WAS \$13,964.00	<b>SPECIAL</b>	\$ 8,320.00
1981 1290 Case 50 HP Four Wheel Drive	WAS \$20,575.00	<b>EXTRA SPECIAL</b>	\$13,000.00
1981 1390 Case 60 HP Four Wheel Drive	WAS \$22,824.00	<b>EXTRA SPECIAL</b>	\$14,850.00
1981 1690 Case 90 HP Four Wheel Drive	WAS \$31,412.00	<b>EXTRA SPECIAL</b>	\$21,600.00

**Lubbock Farm Tractors**

2870 Case Fwd 30.5L x 32 Tires	\$33,400.00
1977 Case 1570 Cab AC Duals, Radial Tires	<b>NEW</b> \$29,900.00
IHC 560 Tractor	\$22,500.00
1977 Case 1370 Cab & Air	\$20,500.00
1976 Case 1370 Cab & Air	\$19,500.00
1175 Cab Air, Low hrs.	\$17,900.00
Case 1370 Cab AC	\$17,500.00
1175 Case Cab & Air	\$12,500.00
1070 Case Cab & Air	\$11,000.00
1170 Case Cab	\$ 9,500.00
Case 930 Cab	\$ 5,250.00
830 LP	\$ 2,195.00
460 IHC w/Shredder	\$ 1,750.00
Big OX 7 Shank Ripper Plow	\$ 1,000.00
Moline 4 Row Planter	\$ 950.00

**Lamesa**

2590 Case w/Duals 900 hrs. Cab & AC	\$38,500.00
1978 4440 JD Cab AC Duals	\$29,900.00
1973 Case 1270 Cab & Air 20.8 x 38	\$13,500.00
Case 1090 Cab AC	\$ 8,800.00
IHC 806 Cab Duals w/IHC 90 Stripper	\$ 7,500.00

**Floydada**

1974 Case 1175 Cab & Air Radio	\$14,500.00
David Brown 880 1200 hrs.	\$ 7,900.00
Case 930 Cab	\$ 6,500.00
Case 1030 Cab AC	\$ 8,900.00
Ferguson TO 20 with Loader	\$ 2,500.00

**Case Power and Equipment**

Lubbock 3302 Slaton Hwy 745-4411  
Lamesa 902 S. Dallas 872-5881  
Floydada 101 South 12th 983-2838

**SH CO**  
**Real Estate**  
 SALE: Three bedroom house, large area. 983-376  
 SALE: Several good bedrooms, hot water, fireplace. Call W. Mi 983-215  
**BEDROOM b**  
 fireplace. Plenty of storage space. Call W. Mi 983-3573.  
**BEDROOM h**  
 able loan. Bond. 983-2151 - 983  
**BEDROOM b**  
 Avenue. Fire in patio. The loan can be for 4% interest. Wington 652-336  
**Bedroom, brick**  
 rental unit on paved lot. Call The Bank of Floyd 983-3288.  
**SALE: Several nice**  
 bedroom house can be arranged. Hale at Hale 1 983-3261.  
**BRICK HOUSE**  
 paneled der 2 baths. Lots of extra extras for appointment  
**BEDROOM BRICK**  
 bath, 105 J.B. A 983-3288.  
**HOUSE, oversi**  
 mately 2,000 air conditioning. Separate dining room. Available immediately. W. Georgia. Contact Jeff 983-1668 or (5  
**SALE: 3 bedroom**  
 2 baths at 4 Mississippi. Floydada 983-3288.  
**BEDROOM HOUSE**  
 effie. Fully ca led, storm w. tractor, washer, water cooler, fruit trees. \$15,000. Finance \$11,000. Call 983-3966  
**3 bedroom**  
 2 baths, 1 heat and air with storm party, Texas. New Savings at Lamesa Branch. 98  
**SALE: 2 bedr**  
 use in west I 983-32412  
**BEDROOM, re**  
 at 129 W. Je 983-3288.  
**FOR SALE**  
 playroom, st fireplace. 322 W. Mi by appointment  
**Pets**  
 NS to give old. Mixe 983-3560.  
**Lost & Fou**  
 pert chihu Light found close Call 983-26

# SHOP COMPARE

# WANT ADS ARE YOUR BEST BUY!

Notice  
 31, 1981  
 S.D. No. 906  
 Valuation  
 \$17,629,242  
 \$43,569.88  
 70,829.00  
 119,851.44  
 62.92  
 283.71  
 162.00  
 128,752.15  
 11,498.32  
 \$13,250.00  
 \$75,002.38  
 9,859.83  
 2,023.19  
 12,505.28  
 4,089.46  
 13,508.25  
 19,349.02  
 6,839.46  
 609.39  
 ( 529.50)  
 \$133,250.00  
 Dell Yandell, Bookkeeper  
 31, 1981  
 S.D. No. 903  
 Valuation  
 \$18,629,133  
 \$27,447.32  
 37,691.00  
 90,807.11  
 106.47  
 238.36  
 1,263.00  
 157,553.26  
 38,583.50  
 \$118,000.00  
 \$62,097.57  
 9,758.14  
 2,581.52  
 15,980.02  
 2,390.00  
 11,652.65  
 7,533.57  
 6,993.27  
 1,788.57  
 (1,805.85)  
 \$118,000.00  
 Dell Yandell, Bookkeeper  
 Case  
 Equipment  
 WD TRACTORS  
 \$ 8,320.00  
 \$13,000.00  
 \$14,850.00  
 \$21,600.00  
 \$33,400.00  
 \$29,900.00  
 \$22,500.00  
 \$20,500.00  
 \$19,500.00  
 \$17,900.00  
 \$17,500.00  
 \$12,500.00  
 \$11,000.00  
 \$ 9,500.00  
 \$ 5,250.00  
 \$ 2,195.00  
 \$ 1,750.00  
 \$ 1,000.00  
 \$ 950.00  
 \$38,500.00  
 \$29,900.00  
 \$13,500.00  
 \$ 8,800.00  
 \$ 7,500.00  
 \$14,500.00  
 \$ 7,900.00  
 \$ 6,500.00  
 \$ 8,900.00  
 \$ 2,500.00  
 745-445  
 872-586  
 983-283  
 Dallas  
 12th

**Real Estate**  
 Three bedroom, 983-3767, tfc  
 Several good two bedroom houses. Estate. Contact 983-2151 or tfc  
 BEDROOM brick, fireplace. 1 1/2 storage area. Call Wilson 983-2151 - 983-3573, tfn  
 BEDROOM brick, fireplace. The room can be trans- 1% interest. Call 652-3367, tfc  
 bedroom, brick home unit on large lot. Call The First Bank of Floydada, tfc  
 Several nice two bedroom houses. Call at Hale Ins. & 983-3261, tfc  
 BRICK HOUSE. 3 paneled den, fire- place. Lots of stor- age extras. Call for appointment. TFN  
 BRICK home. 105 J.B. Avenue. 12-31p  
 oversized lot. 2,000 sq. ft. conditioning and separate dining and kitchen immediate- ly. Georgia, Floyd- ada. Contact Jeff Kimble 983 or (512)327- 11-5c  
 3 bedroom house with 406 W. Floydada. Call 11-19c  
 HOUSE: 115 sq. ft. Fully carpeted, storm windows, washer, dryer, cooler. Nice trees. \$15,000.00. \$11,000.00. More 983-3966.  
 bedroom brick house, paneled, bath and air. 2 car garage, storm cellar. Texas. Contact Savings and Loan, Branch, 983-3725, tfn  
 2 bedroom, 1 in west Lockney. 652-2412, LTFC  
 remodeled 129 W. Jeff. Call \$ 9,500.00 \$ 5,250.00 \$ 2,195.00 \$ 1,750.00 \$ 1,000.00 \$ 950.00  
 FOR SALE: 3 bed- room, sun room, fireplace. 2800 sq. ft. W. Mississippi. Appointment. 983- tfn  
 give away. 2 Mixed colors. L10-29p  
**Pets**  
 chihuahua with light color. Fe- close to Dairy 983-2636. 10-29c  
**Found**  
 200 A IRRIGATED - part tile. 6-room house 9 miles west of Floydada. Contact J. Wo- mack, (214) 351-1690. 11-19p

**For Sale**  
 "WE SELL SLEEP" Direct Mattress Co. New or renovated, for appointment call City Trim Shop, 983-2332, Floydada. tfc  
 FOR PICTURE FRAMES call 983-2636. B and M Gregory. tfn  
 4 piece blonde bedroom suite. Solid wood. \$275.00. Call 983-5089 or 983-3767. tfn  
 FOR SALE: Refrigerator and dishwasher. Call 983-5064. 11-5p  
 FOR SALE: GE refrigerator, frost free. Call 983-2272. 11-5c  
 GUINEAS for sale. 983-2791. 10-29p  
 WHITE Sunray electric stove. Top works but oven does not. Asking \$40.00. Price negotiable. 983-3155. 10-29c  
 FOR SALE: 2 gas heaters. 2, like new, blue rib cord bedspreads - twin size, 8 track stereo and speakers. 652-3697. 10-29  
 GUITAR and chimney for Sears Franklin Stove. Call 652-3613. L10-29c  
 PORTABLE DISHWASHER. Chimney pipe for Franklin stove. Sears wall furnace. Upright vacuum cleaner and guitar. Sliding door unit. 652-3613. L10-29c  
 FOR SALE: Fresh local hon- ey. \$4.00 qt. 509 S. 5th. 983-3542. 10-29p  
 QUILTS AND QUILT TOPS. Double knit and prints. 618 S.W. 2nd, Lockney. L11-5p  
**FIREWOOD**  
 \$50.00 per Rick Producers Cooperative Elevator tfn  
**Fruits & Vegetables**  
 Green & Ripe TOMATOES FOR SALE  
 Picked, 20 cents a lb. Bring your own containers. Fred Lloyd, 983-2671.  
**Farm Items**  
 COMMERCIAL Cody alfalfa seed. 983-3362. tfn  
 FOR SALE: Round bale hay. 1/2 Hegari, 1/2 Red Top Cane. Call 983-2479. 10-29p  
**Farms & Acres**  
 160 acres north of Floydada. 2 small irrigation wells on highway. Floydada Insurance and Real Estate. 983-3284. 116 W. California, Floydada. 11-12c  
 FOR SALE: 160 Acres of ir- rigated land in the Irick Community. Contact W.R. Kirkpatrick, 312 Celina Street, Livingston, Tennes- see 38570. -TFN  
 200 A IRRIGATED - part tile. 6-room house 9 miles west of Floydada. Contact J. Wo- mack, (214) 351-1690. 11-19p

**Garage Sale**  
 INSIDE SALE: 613 South Main, Lockney. Wednesday, Thursday, Friday each week. Furniture. Will have sale for you. Elaine Hardy, 652-2570 or 652-2201. tfn  
 WEATHER permitting garage sale. Friday thru Sun- day, south of football field, Lockney. L10-29c  
 GARAGE SALE: Friday 9:00 a.m.: Saturday til noon. Yel- low building across from Calvary Baptist Church. Furniture, clothes, dishes and etc. 10-29p  
 SALE: Saturday, October 31, at 116 South Main, Lockney, all types of office equipment. L10-29c  
**ESTATE SALE: 424 E. Kentucky, Floydada Thursday, Friday, Saturday, October 29, 30, 31. Furniture, glassware, lawn mow- ers, tools, clothes and lots more. 10-29p**  
**Employment**  
 EXPERIENCED COOK needed. Apply at Travel Center Restaurant, Floy- dada. tfn  
 REGISTERED NURSE SUPERVISOR  
 Wanted to work for West Texas Home Health Agency in office to open in Floydada soon. For information call our Lubbock office, 747-2814 or the Plainview office at 293-4216.  
 Applications are being accepted for appraisal work, map drafting and general office work. Please contact Floyd County Central Appraisal District, Room 207, at the Courthouse. 983-5256, Shelia Faulkenberry.  
**WANTED**  
 Center Director wanted for Senior Citizens, Floydada, Texas. Call 983-2032.  
**LEGAL NOTICE**  
 Notice to Creditors  
 Notice is hereby given that original letters testamentary upon the Estate of Ethel Juanita Maze. Deceased was granted to Juanita Jean Maze Pebsworth on October 19, 1971, in the County Court of Floyd County, Texas. All persons hav- ing claims against said Estate are hereby requested to pre- sent the same to her within the time prescribed by law at the following address: Mrs. Juanita Jean Maze Pebsworth, Route 5, Tahoka, Texas 79373.  
 A regular meeting of the Board of Directors for Floyd County Central Appraisal District will be held on Novem- ber 4, 9:00 a.m. in the appraisal office board room, room 107, County Courthouse.  
**LEGAL NOTICE**  
 Public hearings regarding the re-districting of the Floyd County Commissioners precincts will be held on Thursday, November 5, at 5:00 p.m. in the Floyd County Courtroom and at 6:30 in the Lockney City Hall.

**For Rent**  
**ECONOMICAL STORAGE TRY BARKER'S Jewel Box-Mini Storage**  
 and save your time and money. Ph 652-2642.  
**Barker Building Main and Locust Lockney, Texas**  
**STORAGE SPACE**  
 BOATS, FURNITURE, ANYTHING, ETC. BY THE MONTH OR SIX MONTH 10% DISCOUNT.  
**West Texas Mini Storage**  
 CALL WILSON BOND 983-3573 OR 983-2151  
**Want To Buy**  
 WANTED TO BUY irrigated or dryland farm in Floyd or surrounding area. Write Box XRO, c/o Hesperian, Box 700, Floydada. tfc  
 WANT TO BUY a baby bed. Call 983-5750. tfn  
**Wanted**  
 LAND TO FARM near Lock- ney. Francis Montandon IV. 652-2412 or 652-3404. Lfc  
 HOUSE CLEANING. Refer- ences available. 652-2546. Lfc  
 LIVESTOCK HAULINGS sheep, cattle and wool. 847-2240. L11-5c  
**Employment**  
 POSITION AVAILABLE  
 Credit Union Assistant - manager trainee. Send resume giving personal infor- mation, education, experience, and beginning salary expected to FCS Federal Credit Union President, Rt. 2, 302 W. Ollie St., Floydada, Texas 79235 by November 6, 1981.

**Farm Services**  
 Land Leveling, terraces; bench leveling, and pump pits, all types of dirt work for soil and water conservation. Dewie Parson 983-2646. Fred Parson - 983-2074. tfc  
 CUSTOM Application of Herbicides. Bill Wisdom 652-3541, John Wisdom 652-3544. Lfc  
 Portable disc rolling Lawson Farm Supply Inc., Floydada 983-3940 tfc  
 Check with us for LIQUID FERTILIZER ANHYDROUS HERBICIDES  
 Rigs available for application  
 LONE-STAR CHEMICAL INC.  
 Office: 652-2761  
 Deanie Henderson: 652-3434 Lfc  
**POOL WELL SERVICE AND RADIATOR SHOP**  
 Irrigation, domestic, and windmill service. 407 E. Houston, 983-5610 or 983-2285. tfc  
**FLOYDADA IRON & METAL**  
 We buy Scrap Iron, Junk Cars, Aluminum Cans, Batteries, and sell new and used steel.  
 Location - East Ross  
 Call 983-2305  
 Script Printing & Office Supply  
 \*Commercial Printing  
 \*Office supplies & Furniture  
 \*Business Machines  
 108 S. Main  
 Floydada  
 983-5131 tfc  
**Misc.**  
**WATER FOWL and other bird mounts at reasonable prices. Can pick up and deliver.**  
 Call Idalou 892-2397  
 Silver bowls made to hold fruit or flowers need careful tending. Acid from decaying flowers or fruit can etch ugly little pit marks into silver that will be there forever.  
 certified-bonded  
**Locksmith**  
 983-3834  
**PRO-LOCK SHOP**  
 129 East Ollie Street  
 Floydada  
 Don Probasco  
**For Sale**  
 Nice 2 bedroom home on Washington St. \$4,000.00 down- payment with balance in 10 years at 12% interest. Monthly payment \$212.33 insurance and taxes not in- cluded in payments.  
 Duplex 2 bedroom each side with living room, kitchen, utility room and double garage. \$5,000.00 downpayment, balance in 10 years. 12% interest, payments \$286.94 insurance and taxes not included. Rent one side to help pay for your home and investment.  
 Contact Barker Realty, Barry Barker Broker Lockney. 652-2642

**Business Services**  
 Adams Well Service Com- plete Irrigation Service. All sizes submergible pumps in stock. One day service. 983-5003. tfc  
 "Carpet Need Cleaning?" Let me do the work for you. Dry foam, 10 cents sq. foot. Also home and auto upholstery. Call Jack Moore 983-3083, after 5 p.m. tfc  
**Insulation**  
 Installed & Guaranteed Free Estimates 22 Years This Area  
**Marr Insulation Lockney 652-3593**  
**Auto Accidents DO Happen...**  
 If one happens to you, be protected. Our car insurance offers cover- age to meet your spe- cial needs—repairs to personal liability.  
**Baker Insurance Agency**  
 127 W. California Ph. 983-3270  
**Business Opportunities**  
 Own your own Jean Shop. Offering all the nationally known brands such as Jordache, Vanderbilt, Calvin Klein, Sedgefield, Levi and over 70 other brands. \$12,500.00 includes begin- ning inventory, airfare for 1 to the apparel center, training, fixtures and Grand Opening Promotions. Call Mr. Lough- lin at Mademoiselle Fashions 612-835-1304.  
 Candy, Gum & Novel- ties vending business for sale in Floydada, good income 4 to 6 hours weekly total price \$1621. Write GSW Vending Co. 3831 Briarmore, San Antonio, Texas 78247 include your phone number.  
**Shop Floyd County FIRST!**  
**CUSTOM EXHAUST WORK**  
 Bruce Williams  
 Specializing in Glass Packs And Turbo Mufflers At  
**DAN'S AUTO SERVICE**  
 Lockney 652-2452  
**Hollis R. Bond Real Estate**  
 PHONE 983-2151  
 107 S. 5th FLOYDADA  
**J. P. WILLIAMS**  
 Ph. 652-2326  
**WEED CONTROL ON LAWNS**  
**INSECT CONTROL ON TREES AND SHRUBS**  
 CONTROL OF  
**BINDWEED, RAGWEED, BLUEWEED & JOHNSON GRASS ON FARMS**  
 C. A. LIC. NO. 22453 BUS. LIC. NO. 3108 LFC  
**TURNER REAL ESTATE**  
 983-2635 Farms/Ranches Floydada, Texas  
**Diamond Industrial Supply Co., Inc.**  
 Phone Days 296-7418  
 Nights 296-1200 or 296-7828  
 1014 Broadway Plainview, Texas  
 Chain Sprockets U joints  
 V belts Oil Seals  
 Sheave SKF BCA Timken Bower  
 Cotton Stripper Brushes & Bats  
 "We Appreciate Your Business More"

**Mobile Homes**  
 14'x71' ASTRO Mobile Home. 2 bedroom, 2 bath. Can assume 8% loan. Victor Smith. 983-2048. TFN  
**INSURANCE**  
 AUTO TRUCK MOTORCYCLE MOTOR HOME HOME RENTER'S LIFE HEALTH  
 YOUR Insurance AGENT SERVES YOU FIRST  
**Cates & Dawson Insurance Agency**  
 231 W. California Floydada Tx. 983-5322  
**DAN'S AUTO SERVICE**  
 DAN TEUTON, Owner  
 Specializing in Automatic Transmission, Motor Tune- Ups, Auto Air Conditioning.  
 General Repair We Have A BRAKE LATHE to handle all passenger car brake drums - See us for complete brake service.  
 Phone 652-2462  
**Auto Parts & Accessories**  
 E-Z RIDER SHOCKS by Monroe. Buy 3 and the 4th is FREE. Free Installation. Don's Muffler Shop, 123 W. California. TFC  
**Strickland's Auto Sales**  
 Hwy 70 in Lockney  
 1980 Chev. Citation, like new, low mileage, 4 speed trans., air conditioner, electric windows, electric door locks.  
 1976 Olds Cutlass Supreme. Sharp.  
 Call 652-2275.  
 77 Chrysler 4-dr \$2150  
 75 LTD 2-dr. \$2150  
 77 Malibu \$2150  
 72 LTD. 2-dr. \$1500  
 2-73 Nova, 4-dr. \$1500  
 75 Chev., 4-dr. \$2150  
 71 IHC Sta. wag. \$1050  
**W.B. Eakin Car Lot**  
 Ralls Hwy. 983-3616

**Automotive**  
 FOR SALE: 1974 Mustang II. 4 cylinder eng., standard shift, new tires, sun roof, has 51,647 miles. \$2,000.00 or best offer. Call 983-3861, 12:00-5:00; 983-2662. 5:30-10:00.  
 FOR SALE: 1976 Mercury 2-door Marquis. Light tan with everything on it. 983-2390. tfn  
 1975 MERCURY Marquis. 4 door, loaded. 983-3828 after 2 p.m. 10-29  
 FOR SALE: 1974 Ford pick- up. 983-5169. Power steer- ing, radio, air conditioner.

## Flood victims tax relief now available

The Internal Revenue Service advises victims of flooding caused by the recent heavy rains that they may be eligible to claim casualty losses on their 1981 returns. Losses to business property are generally deductible in full. Personal property loss deductions are limited to the amount of loss exceeding \$100 for each occurrence. To claim a casualty loss a taxpayer must be able to substantiate the loss. Victims should compile a list of those items damaged or destroyed and determine their value immediately before and after the loss occurred. Before-and-after photographs of

damaged property are important records to maintain, as are judgments of independent appraisers. Of course, any portion of a loss covered by insurance and subsequently reimbursed is not deductible. Further information for taxpayers is available by calling IRS toll free and asking for Publication 547, "Tax Information on Disasters, Casualty Losses, and Thefts," and Publication 584, "Workbook for Determining Your Disaster Loss." Call 742-2440 in Dallas, 335-1370 in Fort Worth and 1-800-492-4830 elsewhere in Texas.

## Aviation course at WBC

A course designed to meet the requirements for the written Federal Aviation Administration (FAA) Private Pilot Exam will begin next week at Wayland Baptist University. The course, which begins next Tuesday, October 27, will meet three hours each Tuesday and Thursday from 7 until 10 p.m. for six weeks in Flores Bible Building on the WBU campus. Also aimed at enhancing the skills and knowledge of the right-hand seat companion of the pilot, the course will be taught by Lance Henderson of Plainview. An experienced flight instructor and professional pilot, Henderson holds the private, commercial, instrument, SFI, and CFII certificates for single-engine aircraft. Cost for the course is \$40 per person for tuition, plus approximately \$9 more for books and other learning aids, which will be sold on the first night of class. Enrollment will be limited to the first 30 persons who register. Registration will be open until the limit is reached in

the Academic Services Office (Room 102, Gates Hall). If the limit has not been reached, new students will be accepted the first night of class. For more information contact Dr. Bill Hardage, assistant academic vice president, at 296-5521.

## OBITUARIES

**ORA CLEMMONS**  
Ora C. Clemmons, 74, of Lorenzo, sister of Mrs. Elbert Parks of Floydada, died at 10:20 p.m. Tuesday, October 20, in Highland Hospital in Lubbock. Services were at 2 p.m. Friday in Lorezo First Baptist Church. Burial followed in Lorenzo Cemetery by Carter-Adams Funeral Home of Ralls. A native of Clarksville, she moved to the South Plains in 1924. Mrs. Clemmons was a retired nurse and a member of Calvary Baptist Church in Floydada. Surviving also are a son, Johnny Sands of Honolulu, Hawaii; and three grandchildren.

Thursday in Caprock Hospital in Floydada. She was born in Dallas County and came to Olustee, Oklahoma Territory, with her parents in 1891. The family moved to the Hester community near Mangum in 1902 and she was married to Lonnie C. Kirby on August 5, 1905. The couple farmed in the Brinkman community from 1916 until Mr. Kirby's death in 1970, when Mrs. Kirby moved to Mangum. She was a member of the Mangum Church of Christ. Survivors include three sons, Cody of Tyler, Texas, Garvin of Santa Rose, California, and Kenneth of Granite; two daughters, Mrs. Eunice Hardy of Floydada and Mrs. Lavada Warner of Pampa; two sisters, Mrs. Edith Grimes of Childress and Mrs. Ruby Black of Lubbock; nine grandchildren and 12 great-grandchildren.

**LILLIE KIRBY**  
Services for Lillie M. Kirby, 95, of Floydada were at 3 p.m. Saturday, October 24, at the Church of Christ in Mangum, Oklahoma, with Norman Eastor, minister, officiating. Burial followed in Brinkman Cemetery under direction of Lovett Funeral Service of Mangum. Moore-Rose Funeral Home of Floydada handled local arrangements. Mrs. Kirby died at 10 a.m.

REMEMBER your loved ones with a living memorial to the Caprock Hospital Auxiliary Memorial Fund. Mrs. Ben Whitaker, Treasurer.

**Thursday DO BEAN DAYS**

ALL YOU CAN EAT for only **99¢**

Including RED BEANS and HUSH PUPPIES  
plus ONION HEARTS & JALAPENO PEPPERS

SERVED THURSDAYS FROM 11:30 A.M.  
UNTIL WE RUN OUT

at your **FLOYDADA Dairy Queen**

**NO TO-GO ORDERS**

# Satellite TV Demonstration

Saturday 10:00 till 6:00

## at City Auto Floydada

Complete System

**\$3995<sup>00</sup>**

plus tax and installation  
(basic installation \$200<sup>00</sup>)

Commodity or stock quotes in your office or home.

Call for prices. Write for free booklet or call for

home demonstration

Dealership is available

Satellite Receivers, Inc.  
Box 16127,  
Lubbock, Texas 79490  
(806) 745-7188

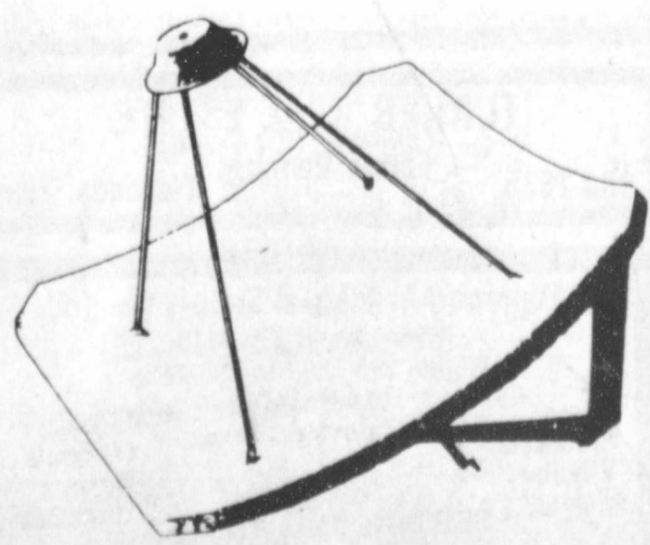

**Shur Fine America's Brand of Value SALE**

PRICES EFFECTIVE OCTOBER 26 THRU NOVEMBER 1, 1981 - WHILE SUPPLIES LAST

**SHURFINE ALL GRINDS COFFEE**  
1 LB. CAN **\$1.69**

BUY ANY SIZE SLUSH PUPPY AND RECEIVE A HALLOWEEN GOODIE BAG FREE!

**RATH ALL MEAT FRANKS** 12 OZ. PKG. **99¢**

**SHURFINE STRAWBERRY PRESERVES** 18 OZ. JAR **\$1.19**

**SHURFINE FANCY TOMATO JUICE** 46 OZ. CAN **89¢**

**SHURFINE FRESH SHELLLED PEAS** 2 15 OZ. CANS **69¢**

**SHURFINE GRANULATED SUGAR** 5 LB. BAG **\$1.15**

**SHURFINE FLOUR** 5 LB. BAG **79¢**

**SHURFINE PINK SALMON** 15 OZ. CAN **\$1.99**

**SHURFINE STRAINED CRANBERRY SAUCE** 2 16 OZ. CANS **\$1**

**SHURFINE PORK 'N Beans** 3 16 OZ. CANS **\$1**

**RATH BREAKFAST SAUSAGE** 1 LB. ROLL **89¢**

**SHURFINE EARLY HARVEST SWEET PEAS** 2 17 OZ. CANS **89¢**

**SHURFINE BLACK PEPPER** 4 OZ. CAN **79¢**

**SHURFRESH BUTTERMILK/SWEETMILK BISCUITS** 6 OZ. CAN **69¢**

**SHURFRESH QUARTERS MARGARINE** 2 1 LB. PKG. **79¢**

**BORDEN'S CHOCOLATE MILK** 69¢

**SHURFRESH AMERICAN CHEESE** 12 OZ. PKG. **\$1.49**

**ALLSUP'S ASSTD. ICE CREAM** 1/2 GAL. RD. CTN. **\$1.49**

**SHURFINE FROZEN ORANGE JUICE** 12 OZ. CAN **69¢**

**SHURFINE ASSORTED CAKE MIXES** 18 1/2 OZ. BOX **69¢**

**SHURFINE ASSTD. FLAVORS COLA** 2 LITER BTL. **89¢**

**SHURFINE ALUMINUM FOIL** 2 12x25 FT. ROLLS **\$1.99**

**SHURFINE CHUNK STYLE DRY DOG FOOD** 25 LB. BAG **\$3.99**

**SHURFINE FROSTED 60/75/100 WATT LIGHT BULBS** 2 CT. PKG. **69¢**

**SHURFINE CUT GREEN BEANS** 3 16 OZ. CANS **\$1**

**SHURFINE WHOLE KERNEL GOLDEN CORN** 2 17 OZ. CANS **89¢**

**SHURFINE CATSUP** 32 OZ. BTL. **99¢**

**SHURFINE SPINACH** 2 15 OZ. CANS **79¢**

**SHURFINE WAFFLE SYRUP** 32 OZ. BTL. **\$1.99**

**SHURFINE WHOLE PEELED TOMATOES** 2 16 OZ. CANS **59¢**

**SHURFINE SALTINE CRACKERS** 1 LB. BOX **59¢**

**SHURFINE TOMATO SAUCE** 4 8 OZ. CANS **89¢**

BUY A DELICIOUS BBQ BEEF SANDWICH **\$1.79** AND RECEIVE A 24 OZ. COKE FREE!

SHOP ALLSUP'S FOR TRICK OR TREATS WE HAVE A LARGE SELECTION OF CANDY!

**Floydada ALLSUP'S CONVENIENCE STORES**

**"THERE'S ONE NEAR YOU"**

# Christmas selections vary at Cogdell's Store

Old-fashioned ornaments in 1981, try popcorn and ornaments designed in 1980 two-story Col. C.C. White face

ter of The Museum of Texas Tech University. The 1981 ball depicts the Long S Two-Story dugout from the outdoor exhibit. The 1981 ornament is the fourth in a series of ornaments depicting structures at the center. A few of the second balls, made in 1979, and depicting the center's mid-1870s Jowell House, are

still available. The 1978 ornament, depicting the 1887 Masterson JY Bunkhouse, and the 1980 ornament, depicting the 1883 Harrell House, sold out. Each ornament comes with a description of the building and its historic significance. A Christmas card picturing the Masterson JY Bunkhouse is available at the store.

Other ornaments reflecting a traditional Christmas include old-fashioned foil-covered, chocolate Santas and cornucopia box ornaments—boxes decorated with Christmas scenes from yesteryear. They can be filled with candy or small toys. For the western or Texas Christmas tree, the store has leather cowboy boot and

cowboy hat ornaments and ceramic Texas ornaments including the map of Texas, stars, longhorns, armadillos, pioneer ladies and cowboys. White, crocheted angels, bells, snowflakes and hearts could add an elegant touch to a tree. Other items of decoration include cornhusk and cinnamon wreaths, stuffed wreaths complemented by lace and dried flowers and stuffed wreaths in a variety of shapes including one that spells J-O-Y.

Those looking for rare and unusual Christmas gifts will find a spaghetti measure, a boot-puller, reproductions of McGuffey's 1870s Electric Reader, tree-bark birdhouses and industrial artifact candle holders—spools and bobbins hand-crafted for a variety of spinning and weaving machines in the nation's textile mills.

For children, there are reproductions of antique pop-up-books "A Day In The Zoo" and "The Doll's House," wooden rocking horses, stuffed farm animals and doll furniture replicas of pioneer furniture.

Doll collectors will find cornhusk, clothespin, china and porcelain dolls and reproductions of 1924 Marcellles dolls, large and small. Large raffia dolls, made from the fiber of raffia palms, duplicate those hung on a garden fence by pioneer women who would pluck strands from the doll to tie their vegetables.

The store will participate in Lubbock's "Holiday Happening," November 19-21 at the Lubbock Civic Center and will be open both evenings of Candlelight at The Museum, December 2-3. Profits from the store, patterned after the old-time general store, go to the Ranching Heritage Association for support of the center.



KEY NOTES—Key Notes, a gospel trio from Perryton, will be singing in the First Baptist Church Sunday, November 1. The group is composed of [l-r] Esther Parker, Margaret Swinney, Charlotte Davis and Colleen Jones.

## Key Notes to appear in Floydada at First Baptist

A Gospel Trio from Perryton, Texas will be singing in First Baptist Church in the Adult 2 Sunday School department and in the Morning Worship Service on Sunday, November 1.

The group is composed of Charlotte Davis, who also plays guitar; Margaret Swinney, Colleen Jones, accompanist, and Esther Parker.

now of Floydada. The group began singing together in the 1960's—mostly at Key Heights Baptist Church, then began travelling in 1973 averaging 5,000 miles a year and including five states.

Church worship services, weekend revivals, banquets, civic clubs, and company parties were the varied places of service for their ministry. Two long-play record

albums (and tapes) were also made during this period and will be available.

The appearance here will be a reunion of the group which has not sung together since Esther Parker moved to Floydada in February.

You are cordially invited to hear the Key Notes this Sunday, November 1 at First Baptist Church in the 11:00 Worship Hour.

## Caprock Hospital Report

October 19-26  
Floydada, Tex. expired 10-22.

Hong. Ella Finley, Floydada, adm. 10-6, continues care, Hong.  
Rena Mae Baxter, Floydada, adm. 10-7, dis. 10-23, Acar.  
J.C. Griggs, Floydada, adm. 10-11, dis. 10-22.

Hong. Charles Epps, Floydada, adm. 10-11, dis. 10-21, Acar.  
Florence Simpson, Floydada, adm. 10-12, continues care, Hong.  
Ona Pesch, Floydada, adm. 10-12, dis. 10-19, Jordan.

Vena W. Hendricks, San Jon, New Mexico, adm. 10-13, continues care, Havasi.  
Lydia R. Cabello, Silverton, adm. 10-15, dis. 10-22, Hong.  
T.V. McClure, Silverton, adm. 10-16, dis. 10-23, Hong.  
Pablo Salquero, Lockney, adm. 10-18, continues care, Hong.

Diana Maldonado, Floydada, adm. 10-18, dis. 10-20, Hong.  
Francisco Benitez, Floydada, adm. 10-19, continues care, Hong.  
J.B. Henslee, Hale Center, adm. 10-19, continues care, Hong.

Ward R. Brooks, Floydada, adm. 10-20, dis. 10-21, Acar.  
Hiida Rodriguez, Floydada, adm. 10-20, continues care, Acar.  
Lenore DeLaCruz, Floydada, adm. 10-22, dis. 10-25, Hong.  
Barbara Hernandez, Floydada, adm. 10-22, continues care, Hong.

Stoney Chatman, Floydada, adm. 10-22, dis. 10-23, Jordan.  
Cynthia Trevino, Floydada, adm. 10-24, dis. 10-25, Acar.  
Gertrude Hollums, Floydada, adm. 10-25, continues care, Jordan.  
Mary A. Austin, Olton, adm. 10-25, continues care, Hong.

Vastie Sanchez, Floydada, adm. 10-26, continues care, Jordan.

## Aguiar participates in training

Sgt. Edward Aguiar, Carmen Aguiar recently participated in training and a course at the Marine Ground Company, Twenty-ninth member of the 1st 11th Marines, Camp Pendleton, California.

His unit participated in squad, platoon and company level tactics, desert operations and survival training. They conducted live-firing exercises with the M-16 rifle, M-60 machine gun, the light anti-tank assault weapon, mortars and other anti-tank weapons.

The training culminated with the participation in a "Combined Arms Exercise." The exercise is designed to emphasize fire support coordination between infantry, air, tank, artillery, mortar and anti-tank missile units.

Aguiar joined the Marine Corps in February 1975.

## Michigan returns from deployment

Chief Machinist's Mate Jarnigan, son of Florene Jarnigan, recently returned to deployment to the Pacific and the Indian crewmember

aboard the guided missile cruiser USS Bainbridge, homeported in San Diego. During the seven-month cruise, his ship operated as a unit of the 7th Fleet and participated in various training exercises with other 7th

Fleet ships and those of allied nations. Port calls were made to Korea, Thailand, Republic of the Philippines and Hong Kong.

The Bainbridge is 565 feet long and carries a crew of 500. It is outfitted with Harpoon cruise missiles, missile launchers, torpedos and anti-submarine rockets. A 1969 graduate of Floydada High School, Jarnigan joined the Navy in April 1971.

## Dougherty School Honor Roll

5th Grade  
Justo Arellano

1st Grade  
Zane Colston,  
Amber Poole.

2nd Grade  
Campbell,  
Noelia

3rd Grade  
Campbell, Chad  
Robertson.

4th Grade  
Noelia

5th Grade  
Campbell, Chad  
Robertson.

6th Grade  
Campbell, Chad  
Robertson.

7th Grade  
Campbell, Chad  
Robertson.

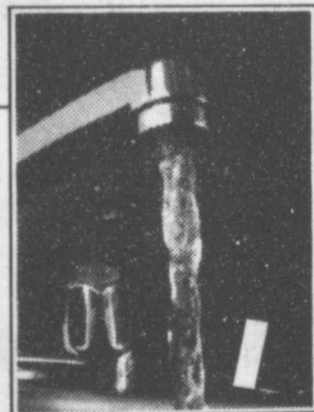

# LET'S KEEP THE WATER RUNNING IN TEXAS!

In cities and towns all across Texas, local water problems are threatening to erupt into one enormous statewide crisis. Countless communities are facing growing water supply, water treatment, sewage treatment and flood control problems estimated to cost a staggering \$50 billion over the next 25 years. To make matters worse, federal funds for water projects have recently been slashed.

But on November 3, Texans have the opportunity to adopt a plan, already passed by two-thirds of the Legislature, which would harness a portion of our state's budget surplus to help shoulder that heavy local burden.

### Passage of Amendment No. 4 would:

- Make possible the sale of more than \$200 million in authorized and urgently needed state bonds to address a backlog of needed projects.
- Create a loan guaranty program to enable local communities to save millions of dollars in issuing future bonds.
- Begin to build a "nest egg" for the future from a part of the state's budget surplus to assist local governments in financing future water and sewage projects.

Texas' water needs *must* be met, either now or in the future. We can act now, and save money... or pay the higher price later for our neglect, with possible increased taxes. Sensible action now makes much more sense for Texas.

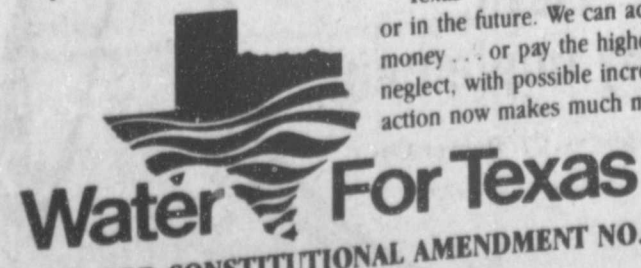

**Water For Texas**  
VOTE FOR CONSTITUTIONAL AMENDMENT NO. 4  
ON NOVEMBER 3!

Pol. Ad. paid by Water for Texas, 1011 Congress Avenue, Suite 400, Austin, Texas 78701, Phone 512-472-7872

# Floydada Methodist Church Bazaar

203 W. Kentucky

October 31st - Saturday

Turkey Dinner Buffet

11:30 a.m. - 1:00 p.m.

Tickets \$3.50 adults \$1.75 children under 12 meal to be served in the Fellowship Hall

Bazaar & Bake Sale

10:00 a.m. - 12:00 a.m.

**Kiddie Korner**  
(for kids only)

personalized gifts for  
parents, teachers.....  
no gift over \$2.50  
free gift wrapping

Auction of Items  
Not Sold at  
the Bazaar will be  
at 1:00 p.m.



PICTORIAL SERIES OF CARLOS BAKER making a touchdown for the JV against the Idalou Wildcats last Thursday.



As Carlos starts his journey down the field.



Carlos breaks away from a Wildcat.



With an open field ahead of him, Carlos Baker charges.



Wildcats stand in amazement as did most spectators as Carlos makes a touchdown, with what seemed to be the greatest of ease.

**Allen's Dixie Dog Drive-In**  
1. Dallas vs. 2. Philadelphia

**Browns Implement**  
3. Houston vs. 4. Cincinnati

**City Trim Shop**  
5. Cleveland vs. 6. Buffalo

**Tastee Freez**  
7. San Francisco vs. Pittsburgh

**Thompson Pharmacy**  
9. Dimmitt vs. 10. Muleshoe

**Script Printing & Office Supply**  
11. Tulla vs. 12. Childress

**Floydada Cooperative Gins, Inc.**  
13. Abernathy vs. 14. Lockney

**Cornelius Conoco Service Station**  
15. Slaton vs. 16. Roosevelt

**Martin & Co.**  
17. Tahoka vs. 18. Cooper



# FOOTBALL CONTEST

**HAVE FUN... WIN PRIZES...**

DEADLINE FOR ENTRIES - 5 P.M. FRIDAY IN HESPERIAN OFFICE OR POSTMARKED

**CONTEST RULES:**

Anyone can enter except the employees of the Hesperian. Three cash prizes are given each week - ties will split prize money. Members of the sports department are sole judges of the contest and their decision is final.

It is not necessary to indicate scores on all the games... But score must be indicated on the tie breaker game at right.

Simply circle the team you choose to win in each of the footballs. Deadline for submitting entries is 5 p.m. Friday - winners will be announced the following week. Enter as many times as you wish, print name and address plainly on blank below and mail or bring entire page to the Hesperian office.

Tie-breaker game will be considered only in case of ties. Limit One Winner Per Family Per Week.

**HESPERIAN**

\$20

**TIE BREAKER-Guess Total Points AND CIRCLE WINNER**

NAME	
ADDRESS	
CITY	

1ST PRIZE \$10.00  
2ND PRIZE \$6.00  
3RD PRIZE \$4.00

**Piggly Wiggly No. 265**  
19. Frenship vs. 20. Post

**Buddy's Foods**  
23. Wellington vs. 24. Shamrock

**Quality Body Shop**  
25. Crosbyton vs. 26. Petersburg

**Kirtley's Market**  
27. New Deal vs. 28. Spear

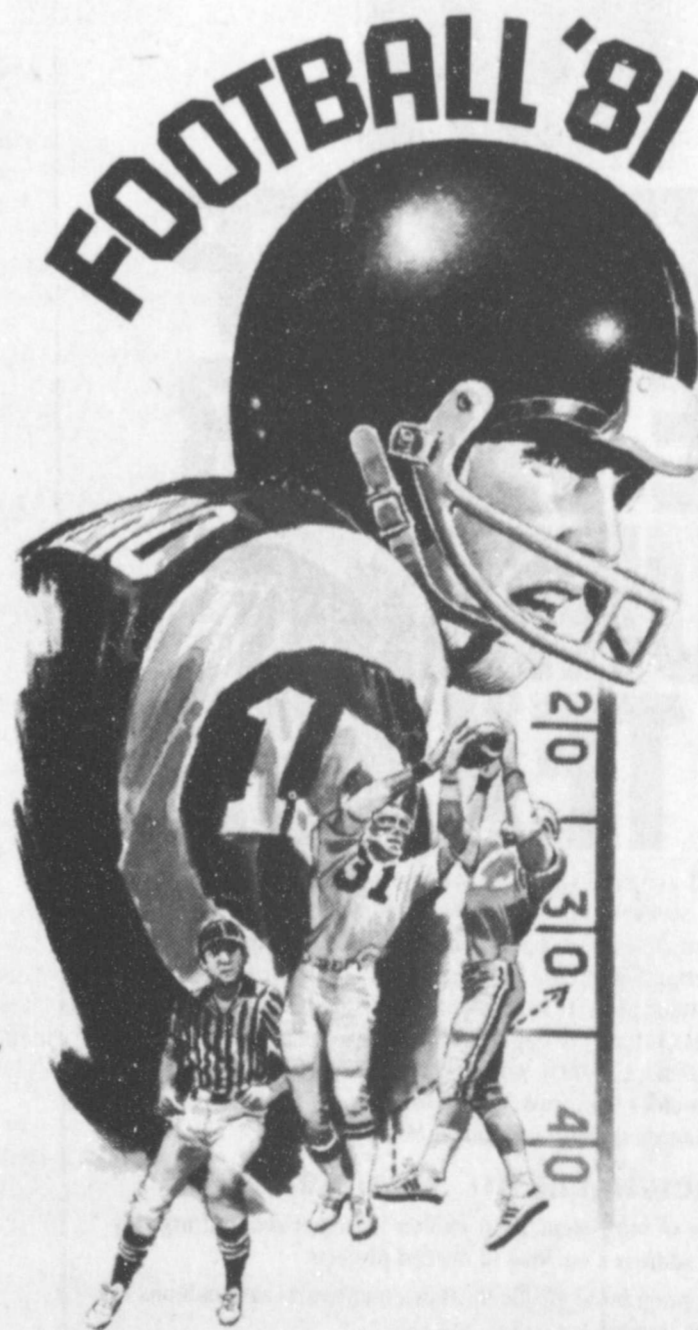

**Floyd County Implement**  
21. Seminole vs. 22. Denver City



Contin  
mer  
a serious  
this year  
were only  
a cotton ent  
Agricultural  
participants in  
Texas Agric  
ence in Lubbo  
ference, said  
ension into  
producers  
of the probl  
could amou  
but might h  
000 bales i  
hadn't been  
participants in  
the Lubbock  
also heard sp  
of hazardo  
use of grow  
pesticide r  
role of co  
ment and the  
country. The ed  
eared each y  
Agricultural C  
participants  
New M  
organization a  
Austin and F  
center with its  
agriculture.  
erson, who ha  
Farm Supply in  
as present  
award. He w  
years of  
graduate  
Garretso  
with the or  
to president  
ADA  
WELL S  
LAND  
Assoc  
RUSS  
EQUIPMEN  
Russ  
This spac  
call 983  
FLOY  
OPERAT  
CO  
ANSLE  
MAR  
COM  
SUN  
FERT



# Farm News

## Continuing bollworm threat demands farmers attention, conference told

A serious onslaught by bollworm this year, cotton yield losses were only half what they were last year, according to an entomologist with the Agricultural Extension Service in the 29th annual meeting of Agricultural Chemicals Institute in Lubbock.

Dr. James Leser, entomologist, is due to producers becoming more aware of the problem. Losses from bollworm might have reached more than 50,000 bales if effective control had been applied, he said.

In the two-day conference, Lubbock Memorial Civic Center speakers discuss the threat of bollworm, weed and growth regulators and the use of computers in farm management and the agricultural chemical industry. The educational program is held each year by the West Texas Agricultural Chemicals Institute participants from Texas, New Mexico and other states.

worked for Shamrock Oil Co. and was manager of Hale Center Butane Co. for several years before starting his farm supply business.

Garretson will be installed as president of the Texas LP Gas Association later this year. He also is a member of the Texas Oil Marketers Association, Texas Plant Food Institute, and has served two terms on the Hale Center city council.

Ivie is director of the agricultural and environmental sciences division of the Texas Department of Agriculture. He received the institute's award presented annually to a representative of a public institution.

The institute cited his leadership in grasshopper control and diapause boll weevil control programs, which saved thousands of acres of rangeland from devastation and limited the spread of the weevil. He also was lauded for working closely with industry representatives in getting federal designation of appropriate chemicals for state special local needs and for his active support for establishment of reasonable guidelines for aerial application of chemicals.

A native of Denison, he is a 1958 graduate of East Texas State College and has worked with TDA since his graduation. He served as an agricul-

tural inspector at Longview, assistant supervisor at Tyler, and district supervisor at both Odessa and Lubbock before assuming his current post in 1972.

Ivie is a member of the Texas Structural Pest Control Board, the Texas Boll Weevil Advisory Committee, the National Plan Board Advisory Council and the American Association of Pesticide Control Officials. He has served as secretary, vice chairman and chairman of the Southern Plant Board.

In the session on hazardous wastes, a Dow Chemical Co. representative, John Drenckpohl, predicted that future issues on hazardous wastes will be "cradle-to-grave". The person who starts a project will be responsible from beginning to end, said Drenckpohl, quality assurance manager for Dow's agriculture production department.

Dr. James Supak, cotton agronomist with Extension, reported on work being conducted with growth regulators. "Many people feel growth regulators will become as important to us as herbicides and insecticides," he said. Preliminary tests indicate some yield benefits, but the chemicals still are being researched to determine their effect on fiber quality and consistent results from specific applications, he said.



**SCHOLARSHIP RECIPIENT**—Texas Tech University senior agriculture engineering major Ricky Covington has received a \$1,000 scholarship from Farmland Industries. Present at a luncheon honoring Covington, son of Mr. and Mrs. Kent Covington of Floydada, and other scholarship recipients

were, from left, Dr. Fred P. Wagner, assistant dean of engineering; Dr. Robert L. Newell, associate dean of engineering; Covington; and Mike Goolsby, Farmland Industries members relations consultant for the southwest region. [TECH PHOTO]

## Covington is scholarship recipient

Four Texas Tech University students have been awarded \$1,000 scholarships from Farmland Industries.

Recipients of the scholarships are senior agricultural entomology major Brad Lance, son of Mr. and Mrs. Jimmy

Lance of Farwell; junior agricultural economics major Mark Moore, son of Mr. and Mrs. Jackie Moore of Lorenzo; junior management information systems major Janet Butler, daughter of Mr. and Mrs. Jim Medlock of Lorenzo;

and senior agricultural engineering major Ricky Covington, son of Mr. and Mrs. Kent Covington of Floydada.

On hand for a luncheon honoring the scholarship recipients were Agriculture Dean Samuel E. Curl, Business Dean Carl H. Stem and Farmland Industries representatives Michael Goolsby, member relations consultant for the southern region, and John Barstow, regional market representative in Amarillo.

Farmland Industries, one of the country's major farm supply companies, has been giving scholarships to Texas Tech students for 20 years.

## Brucellosis control will continue this year

The Texas livestock industry will continue its progress in brucellosis control during the coming year, John Armstrong, Kingsville, chairman, Texas Animal Health Commission, said.

He made that assessment following a study of proposed changes by the U.S. Department of Agriculture and recom-

mendations to them made at a recent meeting of the U.S. Animal Health Association in St. Louis. The changes are scheduled to go in effect January 1, 1982.

Armstrong noted these features of the Texas Plan will continue for 1982:

1. A two-area concept which rewards

progress in brucellosis control:

2. Incentives for Texas producers to clean up infection;
3. Emphasis on vaccination which reduces the number of tests for brucellosis on eligible cattle;
4. Certified brucellosis free herds.

"A great deal of progress has been

achieved in a short time by cowmen in this state with the present Texas Plan. We can see an increase in this effort as we have in place a program for Texas with which producers can and are cooperating," Armstrong said.

More than 98 percent of cattle herds in Texas are free of brucellosis. "Our Texas program is designed to be epidemiologically sound, yet one which will be flexible enough to allow as much free movement as possible for those cattle herds which are not infected with this disease. Proposed changes continue this positive program," Armstrong said.

USDA proposals for 1982 include a four status classification: Free, A, B, and C. Rates of infection will determine the status for the state or area within a state. Free means no herd infection; A means herd infection rates from 0 to .25 percent; B will be from .25 percent to 1.5 percent; C will be 1.5 percent herd infection rate and over.

"Preliminary data suggests that Texas will be in a B and C classification. The B area will generally be the western half of the state; the C area will be in the eastern half," he said. (They likely will coincide closely with the present brucellosis control areas.)

"The proposals carry on our Texas plan of rewards and incentives. As producers continue to clean up infection, the two-area plan will permit upgrading our status classification which will lead to fewer restrictions on movement of cattle.

"Producers in the western half of the state can receive the benefits of their labor by having a higher classification than the eastern half. And the plan will encourage producers in the eastern half of the state to increase their efforts to clean up the disease so they, too, can be faced with fewer restrictions as their progress continues," Armstrong explained.

Vaccination, he noted, is strongly emphasized in the proposals in that a vaccinated animal will be able to move more freely than one which is not vaccinated. "One of the main parts of the Texas Plan is vaccination with the reduced dosage of Strain 19. It is a key element in our total program," he said.

Armstrong also suggested that every cattle producer in the state, both registered and non-registered and beef and dairy, consider working towards a certified brucellosis free herd. "This will provide the producer with freest movement of cattle possible," he said.

Armstrong is vice chairman of the brucellosis committee of the U.S. Animal Health Association. That organization is nationwide in membership, and is made up of industry spokesmen and state and federal regulatory personnel. It reviews and recommends any changes that appear needed in regulations affecting animal diseases in the U.S. USDA proposes changes to USAHA for its advice.

## Range water vital to ranching

Plenty of good quality water well-distributed over a ranch is essential for balanced forage and livestock production, says Dr. Wayne Hanselka of Corpus Christi, a range specialist.

"Water is essential for the well-being of livestock," explains Hanselka, who is with the Texas Agricultural Extension

Service, Texas A&M University System. "Watering facilities contribute to daily grazing behavior and influence grazing distribution."

Water for livestock comes from three main sources, notes Hanselka. These are rain water, surface water and underground water. Developing the

sources includes drilling a well, constructing a tank or reservoirs or piping water.

Depending on the amount of rainfall and soil type, reservoirs, and stock ponds may or may not provide enough water during summer dry spells. When constructing water facilities, use care to provide as much water as possible while limiting the surface area to reduce evaporation," urges Hanselka.

Pumping is one of the most common means of obtaining water. However, problems may arise during the "dog days" of late summer when there is little or no wind.

"Use of PVC (polyvinyl chloride) and plastic pipe to transport water to livestock has become popular in recent years and has opened up a great deal of rangeland for grazing," explains the range specialist.

Location and number of watering facilities are important considerations for the rancher, adds Hanselka. Cattle should travel no more than two miles round-trip for water which should ideally be located in the center of the pasture. This distance should be less with rough or brushy terrain. If the pasture is continuously grazed, the specialist recommends one watering facility for every 50-60 head.

"Even though cattle and horses can travel greater distances for water than sheep and goats, they require water more often," notes Hanselka. "Water intake will be less on green forage in the spring when weather is cool. Minimum water requirements for a cow with a calf is 10 gallons per day, but this increases to 15-20 gallons during summer days."

Water is also a major concern to wildlife production, says the specialist, but it's generally sufficient for the needs of wild animals.

"One final consideration for ranchers is the quality of water for livestock. Good quality water is clear and odorless, contains no disease organisms, has no undesirable flavors and no objectionable gases. Even though water may not measure up to these standards, it may be suitable for consumption," adds Hanselka.

He suggests caution when using water from old oil bores perforated for use as water wells. Such water may be high in salts and gases and could be contaminated with caustic chemicals used in well drilling.

## Texas farms increasing while nation's total drops

While the total number of farms in the United States continues to decline, Texas is bucking the trend.

The most significant reason for the increasing number of farms in Texas is the division of medium-sized farms in East Texas, according to Dr. William E. Black, economist with the Texas Agricultural Extension Service, Texas A&M University System.

"But a relatively small portion of the total number of farms are now producing an increasingly larger share of agricultural products," Black notes. "This is called concentration."

According to the 1978 Census of Agriculture, about 2.8 percent of the Texas farms produced 60 percent of the value of farm cash receipts. This compares with about 2.8 percent of the U.S. farms producing about 36 percent of the nation's cash receipts from agriculture.

The U.S. Census Bureau defines a farm as "any place from which \$1,000 or more worth of agricultural products were sold or normally would have been sold in the previous year."

This general definition of a farm, which has been changed since the 1974 Census of Agriculture, is part of the reason for an increasing number of farms in Texas, adds Black. Along with this is the disappearance of medium-sized farms.

"In West Texas, medium farms are being consolidated to form bigger, more profitable farms," Black explains. "But in East Texas, medium farms are being subdivided into smaller farms to be used as weekend retreats by folks who have to live and work in the city during the week."

In 1974 there were about 174,000 farms in Texas and in 1978 the number

had increased to 194,253, according to Census Bureau figures. During the same period, the number of U.S. farms declined.

"Technical advances since the '50s, market pressures and growth in non-farm employment in rural communities are three reasons for the overall decline of this nation's farms," notes Black.

## Silverton Young Farmers meet

Silverton Young Farmers held their regular business meeting on Thursday October 22 with Brad Ziegler presiding.

The club will host an appreciation supper on Tuesday, November 3, for all people who helped the Young Farmers with the rodeo held in August.

February 20 was set for the annual Silverton Young Farmers Awards Banquet to be held in the Silverton school cafeteria. The banquet committee was appointed with Bill Reid, chairman, assisted by Donnie Perkins and Tobe Riddell.

Members discussed the upcoming halloween carnival to be held Saturday October 31 in the Briscoe County 4-H Barns. The club voted not to have a booth this year.

The Young Farmer Club voted to have an amateur rodeo in August, if the club can. Wayne Stephens was appointed to get prices from the rodeo producers.

Wayland Fitzgerald will get the guest speaker for the November 12 meeting.

ADAM'S WELL SERVICE



983-5003

FLOYD COUNTY FARM BUREAU



983-2480

RUSSELL'S IMPLEMENT & SUPPLY



983-3751

Space available call 983-3737

FLOYDADA COOPERATIVE GINS INC.



983-2884

WINSLEY & SON



652-3361

MARTIN & COMPANY

983-3713

SUN-VUE FERTILIZER



652-3362

RUCKER'S O.K. TIRE STORE



Floydada

983-3370

FLOYD COUNTY IMPLEMENT



Floydada

983-3732

CASE POWER & EQUIPMENT



Floydada

983-2836

FIRST NATIONAL BANK OF FLOYDADA



Floydada

983-3717

PRODUCTION CREDIT ASSOC.



Floydada

983-2454



# Blue Stamps



INTRODUCING  
CIRCLE W

AT KEETER'S GROCERY

118 N.E. 8th Street, Lockney, Texas 652-2191

**DOUBLE BLUE STAMPS ALL WEEK!**

PRICES EFFECTIVE October 22-28, 1981



**REDEEM YOUR STAMPS AT THE COMPLETE GIFT STORE...**

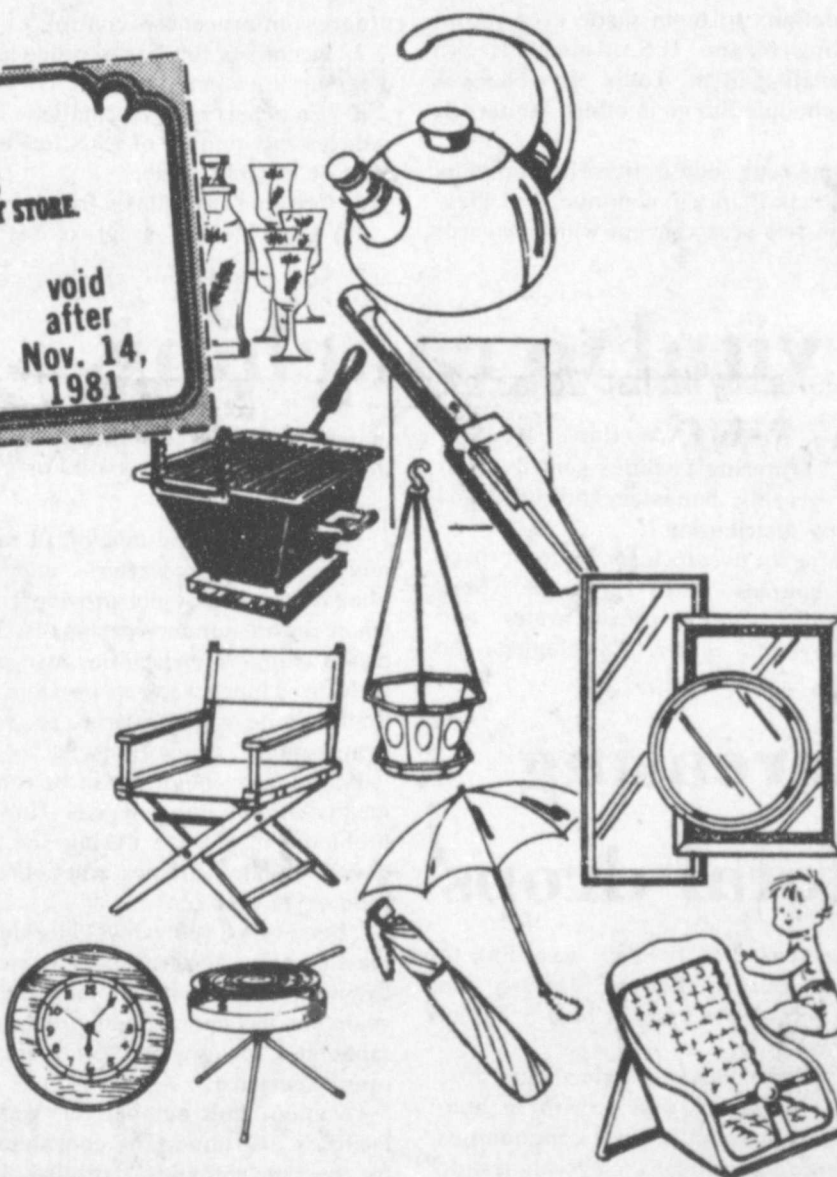

731 Broadway, Plainview, Texas

## Western Gift

STORE  
MANAGER:  
JOE HOLMES  
PHONE:  
293-4722

**STORE**

"HOME OF BLUE STAMPS"

STORE HOURS  
10 A.M. - 5 P.M.  
TUESDAY THRU  
SATURDAY

WESTERN GIFT STORES ARE LOCATED IN

- |                      |                       |                  |                       |
|----------------------|-----------------------|------------------|-----------------------|
| ANDREWS, TEXAS       | DALHART, TEXAS        | MEMPHIS, TEXAS   | PLAINVIEW, TEXAS      |
| BOISE CITY, OKLAHOMA | DUMAS, TEXAS          | MORTON, TEXAS    | ROTAN, TEXAS          |
| BORGER, TEXAS        | FRIONA, TEXAS         | MULESHOE, TEXAS  | SPEARMAN, TEXAS       |
| CANADIAN, TEXAS      | KERMIT, TEXAS         | PAMPA, TEXAS     | TUCUMCARI, NEW MEXICO |
| CANYON, TEXAS        | LITTLEFIELD, TEXAS    | PANHANDLE, TEXAS | WELLINGTON, TEXAS     |
| CHILDRESS, TEXAS     | LOVINGTON, NEW MEXICO | PECOS, TEXAS     | WHEELER, TEXAS        |
| CLOVIS, NEW MEXICO   | LUBBOCK, TEXAS        |                  |                       |

**REDEEM THESE VALUABLE COUPONS DURING THE NEXT FOUR WEEKS FOR ADDED SAVINGS**





# Entertainment

## "Candlelight At The Museum" to be held December 2nd and 3rd

Visitors to the 4th annual "Candlelight At The Museum." December 2-3 will walk down Christmas memory lane at The Museum of Texas Tech University and the Ranching Heritage Center.

Christmas scenes will include an austere 1840s Christmas at the El Capote Log Cabin, a traditional frontier German Christmas at the Hedwigs Hill Log Cabin and an elegant turn-of-the-century Christmas in the Barton House.

At The Museum, visitors will see "Holiday Excursions," demonstrating ways people travel during holidays, and "Collector's Treasures," with collections such as dolls, Christmas plates, nativity scenes, 1930s toys, toy lead soldiers and music boxes.

Focusing on the theme, "A Time for Remembering," "Candlelight at The Museum," will be 6-8 p.m. both Wednesday and Thursday. Admission is \$2 per family or 50 cents per person. The annual event is sponsored by The Museum.

Caroling, a Christmas puppet show by the Texas Tech Puppets, music by the South Plains College Country and Bluegrass Department, and refreshments served by the Women's Council of the West Texas Museum Association will be part of the festivities.

Volunteers and staff members of The Museum, dressed in pioneer attire, will be housed in the lighted buildings at The Ranching Heritage Center to demonstrate Christmas activities typical of the era and heritage of each building. Activities will

include baking, tree-trimming, wreath-making, gift-wrapping, needlework and whittling.

Corn grinding and corn-husk doll making will be part of the activities in the El Capote Log Cabin while a pinata will be the center of attention in the Picket and Sotol House.

The Victrola will be played in the Harrell House, the pump organ in the Box and Strip House and the piano in the Barton House, while guitar strumming and harmonica playing take place in the Masterson JY Bunkhouse and the Matador Half-Dugout.

A Christmas ball is planned in the Las Escarbasas

ranch headquarters.

Girl Scouts will make tree decorations and trim the tree in the Bairfield Schoolhouse. After "Candlelight At The Museum," the tree will be donated to a local nursing home.

Cowboys will be gathered around the campfire near the Reynolds-Gentry Barn, settlers will be feasting on Christmas goodies at the Jowell House and a cowboy will be awaiting the arrival of Christmas in the Long S. Two-Story Dugout.

Lanterns, candles and luminarias will light the paths of visitors during the event as firelight flickers in the fireplaces of several buildings and in the Edith McKanna Whatley Parlor.

## Parmer County Christmas Bazaar scheduled

Announcing! The Seventh Annual Christmas Bazaar sponsored by the Parmer County Family Living Committee is scheduled for Fri-

day and Saturday, November 20 and 21 at the Community Center in Friona.

This annual event promises to have something for

nearly everyone. Featuring arts and crafts exhibitors from the Panhandle, South Plains, Eastern New Mexico, Oklahoma and Kansas, the bazaar will be an excellent place to shop for unusual and unique gifts.

Special demonstrations scheduled during the two days include: "Gift Wrapsody", ideas for creative gift wrapping presented by Marilyn Tate, Floyd County Extension agent at 1:30 p.m., Friday, November 20.

"Holiday Fashions", a style show by Ruthies of Friona at 4 p.m. on Friday.

"Healthy Holidays", parties, dips, snacks, menus for holiday meals by Beverly Harder, Home Economist for Arrowhead Mills in Hereford

will be presented at 11:00 a.m. on Saturday, November 21.

"Christmas Candy", how to make your own molded candies for holiday gift giving by Martha Schueler, homemaker from Rhea at 1:00 p.m. on Saturday.

The Family Living Committee provides program leadership to the Texas

Agricultural Extension Service in Parmer County.

As with all programs sponsored by the Texas Agricultural Extension Service, this one is open to all people without regard to race, color, religion, sex, age or national origin.

For more information contact Laura Jacobs, Parmer County Extension agent at 806-481-3619.

## SPC to sponsor festival

Attention High School seniors on the South Plains! South Plains College, Levelland, is hosting an art festival and competition just for you! Winners will receive certificates, and art works will be displayed at SPC

during November. And there'll be a special reception for top artists and their families. Deadline to enter is November 7th! Contact Don Stroud, creative arts chairman at SPC, for more information: That's 806-894-9611!

## Turkey dinner to be served Nov. 1st

Sunday, November 1, the St. Joseph's Alter Society will hold their Annual Turkey Dinner at St. Joseph's Hall, 20th and Division, Slaton.

Serving hours will be from 11:00 a.m. till 3:00 p.m. Prices for adults will be \$4.00, children 10 and under will be \$3.00.

The menu will consist of turkey, dressing, German sausage, mashed potatoes, cole slaw, cranberry sauce, green beans, gravy, rolls,

cake, ice tea and coffee. Take-home plates will also be available.

Homemade German sausage will be sold by the pound.

The Catholic Daughters of America will also hold their Annual Bazaar Sunday at St. Joseph's School.

There will be a Country Store, Spinning Wheel, quilts and cedar chest to raffle off and games for all ages. Drawings will be at 4 p.m.

## Color photo course offered at SPC

South Plains College at Plainview will offer another in its recent series of photography courses beginning October 29, and meeting each Thursday night from 6:30 to 10:00 p.m. for seven weeks, excluding the week of Thanksgiving. Class will be held in room 104 of the Muncy Building, located at

708 Yonkers. Interested individuals may register in the Continuing Education Office and also at the first meeting on the 29th of October. The cost of the course is \$40.00, payable at registration.

Kevin Keeling will teach the seven week course entitled "Color Photography."

It will touch on the basics of camera handling, composition, use of light, creative use of filters and choice of film for best color effect. Besides classroom instruction, the students will be involved in shooting and developing their own slides.

Keeling is a freelance photographer and sales manager for a local photo shop. He is a member of the Society of Certified Photographic Counselors of the Photo Marketing Associ-

ation. His teaching experience includes adult continuing education classes at Wayland Baptist University, color and portrait classes for South Plains College at Plainview and numerous photo and yearbook workshops at area schools, including an adult education class for Tulia High School in basic photography.

Anyone needing additional information may contact Bill Polk at 293-3605.

## Classes to be taught on nursing in Crosbyton

The Crosbyton Independent School District, Western Texas College and Lubbock Methodist Hospital have announced a long-range plan to prepare students wishing to enroll in the hospital's school of nursing.

Classes will be taught in Crosbyton starting in the spring of 1982. Enrollment is open to adults beginning their study as well as to vocational nurses who would like to become registered nurses. The current series will run through the summer of 1983 and is then to be repeated for other beginning students. Upon completion of the program, students may apply for entrance to Lubbock Methodist Hospital's nursing school. Persons already licensed as vocational nurses may attempt to gain additional credit through the College Level Examination Program (CLEP).

Courses on the 1982 spring schedule are Microbiology (BIO 247), Child Growth and Development (PSY 232), and Composition I (ENG 132).

Attending the planning meeting for the new program in Crosbyton were Jerry Scott, superintendent of Crosbyton schools; Helen Payne, career counselor at Methodist Hospital; Marquita Montgomery, a prospective student; Dr. Duane

Hood, Dean of Student Services at Western Texas College, and Dr. Mary Hood, Director of testing and counselor at WTC.

Persons wishing additional information about the program may contact Scott in Crosbyton at AC 806 675-2611 or Dr. Duane Hood at WTC in Snyder, AC 915 573-8511.

Watch Out For The Little SPOOKS Saturday Night

Got Heating Or Plumbing Problems? Call Holmes Plumbing Austin Or Steve 983-2251 Call Day Or Night

**Farmers**  
With harvest here now is the time to let us delint, treat, and store your seed until planting time.

Give your cotton added protection from insects and disease by letting us apply Disyston and VitaVax to your seed.

We have installed new cleaning and grading equipment to give you the highest quality seed possible.

Remember call or have your ginner call Ralls Delinting Co. at 253-2613

"We appreciate your business"

**Ralls Delinting Co.**  
253-2613

# DRIVE THE NEW NUMBER ONE

Now there's a New Number One. And it's from International Harvester. The new International 50 Series tractors. The best performing tractors ever built. Here's why:

**THE NUMBER ONE ENGINE.** You'll find the New Number One in the size you need: 135, 160 or 185 TO horsepower. Each with the power and economy of a reliable IH-built diesel engine, proven in independent field tests to cover more acres per hour in less time, with less fuel. Now with exclusive Forward Air Flow for more efficient cooling, longer engine life.

**THE NUMBER ONE DRIVE TRAIN.** Discover the all-new advanced design drive train that features Synchro-Tri-Six™ shifting. Shifts with smooth, quiet precision. The only drive train with 18 fully synchronized forward speeds. And the speeds are ideally spaced to help you cover more acres per hour.

**THE NUMBER ONE HYDRAULIC SYSTEM.** High-capacity Power Priority hydraulic supplies 67 gallons of total flow. get 25 gallons for the hitch and rear alone—delivered where you need it only when you need it.

When you want tractor performance, productivity and reliability you need the New Number One. Ask your national 50 Series tractor.

**INTERNATIONAL AGRICULTURAL EQUIPMENT**  
Your I.H. Dealer  
**Brown's Implement Inc.**  
Ralls Highway



© by Lillian Bono

Week of November 1-6

### SAGITTARIUS

(November 23 - December 21) Put the interests of someone younger than you above your own if you wish to be a happier person.

### CAPRICORN

(December 22 - January 20) You may find out unexpected news relating to a subject you thought was closed and forgotten issue.

### AQUARIUS

(January 21 - February 19) Working could be the best way to put an incident in the past behind you. Avoid being spendthrift right now.

### PISCES

(February 20 - March 20) Being on your best behavior is not easy for you. Someone you are not fond of might be necessary for you.

### ARIES

(March 21 - April 20) A younger person may be developing a crush on you. While you should feel flattered there may be difficulties.

### TAURUS

(April 21 - May 21) You may have to make decisions without knowing all the facts. Avoid frivolous spending until you are paid.

### GEMINI

(May 22 - June 21) An attraction could begin between you and a person who lives nearby. This may become a romance you won't forget.

### CANCER

(June 22 - July 23) Feelings of indifference towards an acquaintance might prevent you from getting to know an individual anymore.

### LEO

(July 24 - August 23) Financial ventures may take a turn that could confuse you. Energy used without purpose might frustrate you.

### VIRGO

(August 24 - September 23) In order to get to the heart of a difficult situation you might have to take several people into your confidence.

### LIBRA

(September 24 - October 23) Having the assistance of a co-worker could prove useful with a project that may have lots of problems to solve.

### SCORPIO

(October 24 - November 22) A conflict could arise between you and a family member. An acquaintance may be able to introduce new ideas.

For your current, personalized astrological chart, send \$10 money order along with your name, address and birthday (day, month and year) to: Miss Lillian Bono, Box 123, Lyndhurst, N.J. 07071.

WOLFWALK OF OCTOBER 22-28

- OVER EASY
GENERAL HOSPITAL
BONANZA
GUIDING LIGHT
SHOWTIME SPECIAL
SUPER STATION FUN TIME
VILLA ALEGRE
CIRCUS
TEXAS
SHOWTIME MOVIE 'Revenge Of The Mysterians'

- MOVIE (COMEDY) 'Hopscotch'
MOVIE (DRAMA) 'Boardwalk'
MOVIE (DRAMA) 'The Shining'
MOVIE (HORROR) 'Night Creatures'
MOVIE (HORROR) 'The Exorcist'
MOVIE (HORROR) 'The Shining'

- MOVIE (COMEDY) 'Hopscotch'
MOVIE (DRAMA) 'Boardwalk'
MOVIE (DRAMA) 'The Shining'
MOVIE (HORROR) 'Night Creatures'
MOVIE (HORROR) 'The Exorcist'
MOVIE (HORROR) 'The Shining'

- MOVIE (COMEDY) 'Hopscotch'
MOVIE (DRAMA) 'Boardwalk'
MOVIE (DRAMA) 'The Shining'
MOVIE (HORROR) 'Night Creatures'
MOVIE (HORROR) 'The Exorcist'
MOVIE (HORROR) 'The Shining'

- MOVIE (COMEDY) 'Hopscotch'
MOVIE (DRAMA) 'Boardwalk'
MOVIE (DRAMA) 'The Shining'
MOVIE (HORROR) 'Night Creatures'
MOVIE (HORROR) 'The Exorcist'
MOVIE (HORROR) 'The Shining'

- MOVIE (COMEDY) 'Hopscotch'
MOVIE (DRAMA) 'Boardwalk'
MOVIE (DRAMA) 'The Shining'
MOVIE (HORROR) 'Night Creatures'
MOVIE (HORROR) 'The Exorcist'
MOVIE (HORROR) 'The Shining'

- MOVIE (COMEDY) 'Hopscotch'
MOVIE (DRAMA) 'Boardwalk'
MOVIE (DRAMA) 'The Shining'
MOVIE (HORROR) 'Night Creatures'
MOVIE (HORROR) 'The Exorcist'
MOVIE (HORROR) 'The Shining'

- MOVIE (COMEDY) 'Hopscotch'
MOVIE (DRAMA) 'Boardwalk'
MOVIE (DRAMA) 'The Shining'
MOVIE (HORROR) 'Night Creatures'
MOVIE (HORROR) 'The Exorcist'
MOVIE (HORROR) 'The Shining'

- MOVIE (COMEDY) 'Hopscotch'
MOVIE (DRAMA) 'Boardwalk'
MOVIE (DRAMA) 'The Shining'
MOVIE (HORROR) 'Night Creatures'
MOVIE (HORROR) 'The Exorcist'
MOVIE (HORROR) 'The Shining'

- MOVIE (COMEDY) 'Hopscotch'
MOVIE (DRAMA) 'Boardwalk'
MOVIE (DRAMA) 'The Shining'
MOVIE (HORROR) 'Night Creatures'
MOVIE (HORROR) 'The Exorcist'
MOVIE (HORROR) 'The Shining'

- MOVIE (COMEDY) 'Hopscotch'
MOVIE (DRAMA) 'Boardwalk'
MOVIE (DRAMA) 'The Shining'
MOVIE (HORROR) 'Night Creatures'
MOVIE (HORROR) 'The Exorcist'
MOVIE (HORROR) 'The Shining'

- MOVIE (COMEDY) 'Hopscotch'
MOVIE (DRAMA) 'Boardwalk'
MOVIE (DRAMA) 'The Shining'
MOVIE (HORROR) 'Night Creatures'
MOVIE (HORROR) 'The Exorcist'
MOVIE (HORROR) 'The Shining'

- MOVIE (COMEDY) 'Hopscotch'
MOVIE (DRAMA) 'Boardwalk'
MOVIE (DRAMA) 'The Shining'
MOVIE (HORROR) 'Night Creatures'
MOVIE (HORROR) 'The Exorcist'
MOVIE (HORROR) 'The Shining'

- MOVIE (COMEDY) 'Hopscotch'
MOVIE (DRAMA) 'Boardwalk'
MOVIE (DRAMA) 'The Shining'
MOVIE (HORROR) 'Night Creatures'
MOVIE (HORROR) 'The Exorcist'
MOVIE (HORROR) 'The Shining'

- MOVIE (COMEDY) 'Hopscotch'
MOVIE (DRAMA) 'Boardwalk'
MOVIE (DRAMA) 'The Shining'
MOVIE (HORROR) 'Night Creatures'
MOVIE (HORROR) 'The Exorcist'
MOVIE (HORROR) 'The Shining'

- MOVIE (COMEDY) 'Hopscotch'
MOVIE (DRAMA) 'Boardwalk'
MOVIE (DRAMA) 'The Shining'
MOVIE (HORROR) 'Night Creatures'
MOVIE (HORROR) 'The Exorcist'
MOVIE (HORROR) 'The Shining'

Friday

OCT. 30, 1981

- EVENING
INSIDE THE NFL
TO BE ANNOUNCED
SPORTS CENTER
OVER EASY 'Alcoholism' Hosts: Neil Patrick Harris, Jim Hartz

Saturday

OCT. 31, 1981

- MORNING
BACKYARD
SPORTS CENTER
JIM BAKER
CARTOONS
NEWS
SHOWTIME SHOWTIME IN HOLLYWOOD

Sunday

NOV. 1, 1981

- MORNING
BACKYARD
SPORTS CENTER
JIM BAKER
CARTOONS
NEWS
SHOWTIME SHOWTIME IN HOLLYWOOD

Monday

NOV. 2, 1981

- MORNING
BACKYARD
SPORTS CENTER
JIM BAKER
CARTOONS
NEWS
SHOWTIME SHOWTIME IN HOLLYWOOD

Tuesday

NOV. 3, 1981

- MORNING
BACKYARD
SPORTS CENTER
JIM BAKER
CARTOONS
NEWS
SHOWTIME SHOWTIME IN HOLLYWOOD

Wednesday

NOV. 4, 1981

- MORNING
BACKYARD
SPORTS CENTER
JIM BAKER
CARTOONS
NEWS
SHOWTIME SHOWTIME IN HOLLYWOOD

Thursday

NOV. 5, 1981

- MORNING
BACKYARD
SPORTS CENTER
JIM BAKER
CARTOONS
NEWS
SHOWTIME SHOWTIME IN HOLLYWOOD

11:35
MOVIE-(COMEDY) \*\*\* "Gong Show Movie" 1979 Chuck Barris, Jaye P. Morgan. Get ready for laughs as you see all the acts and crazy skits they couldn't show on the Gong Show series. (Rated R) (99 mins.)

12:00
TO BE ANNOUNCED
PTL PROGRAM (SPANISH)
MOVIE-(HORROR) \*\*\* "Thirsty Dead" 1974 John Considine, Jennifer Bilingstey. A bizarre cult depends upon human blood for sustenance female blood. (2 hrs.)

EVENING AT THE IMPROV
NEWS
12:10
MOVIE-(MYSTERY) \*\*\* "He Ran All The Way" 1951 John Garfield, Shelley Winters. A girl hides a fugitive cop killer, but doublecrosses him once her family is safe. (90 mins.)

UNIVERSITY OF MICHIGAN FOOTBALL
COLLEGE FOOTBALL
California vs Oregon State (3 hrs.)
STYLE
SHOWTIME MOVIE-(ROMANCE) \*\*\* "It's My Turn" 1980 Jill Clayburgh, Michael Douglas. A funny love story of a woman whose life of independence seems ideal until she meets and falls in love with a former sports hero during a whirlwind weekend in New York. (Rated R) (90 mins.)

WESTBROOK HOSPITAL
NEWS
SPORTS
1:05
GREAT AMERICAN GHOST TOUR Richard Kiley hosts this tour of mediums, mystics and ghostly ghouls; plus, a unique exploration of some real American ghost stories.

THE LESSON
HERE'S HOW
NEWS
MOVIE-(COMEDY) \*\*\* "Top Banana" 1954 Phil Silvers, Rose Marie. A TV comic is about to lose his sponsor, his girl and his peace of mind. (65 mins.)

MOVIE-(MYSTERY) \*\*\* "The Thirty-Nine Steps" 1980 Robert Powell, David Warner. Remake of the classic Hitchcock mystery about a man who accidentally becomes involved in a murder. (Rated PG) (87 mins.)

700 CLUB
MOVIE-(DRAMA) \*\*\* "In Search Of Dracula" 1975 Christopher Lee. The screen's reigning "Count Dracula" chronicles the Dracula legend, including the real-life counterparts of the number one vampire. (2 hrs.)

NEWS WRAP-UP
MOVIE-(SCIENCE-FICTION) \*\*\* "Saturn 3" 1980 Kirk Douglas, Farrah Fawcett. Futuristic space adventure aboard the U.S. ship Saturn 3. (Rated R) (90 mins.)

ON LOCATION: 3rd Annual Rich Little And The Great Pretenders! Impassioned entertainment from the MGM Grand Hotel in Las Vegas, with Rich Little, Thom Brenner and Julie Bess.

LARRY JONES
LONE RANGER
NFL '81 Host: Bryant Gumbel. INSIDE BUSINESS
THE NFL TODAY NFL news and other highlights of the day with Brent Musburger, Phyllis George, Irv Cross and Jimmy "The Greek" Snyder.

ON LOCATION: 3rd Annual Rich Little And The Great Pretenders! Impassioned entertainment from the MGM Grand Hotel in Las Vegas, with Rich Little, Thom Brenner and Julie Bess.

LARRY JONES MINISTRY
SPORTS CENTER
WILD KINGDOM
HERE'S BOOMER When a blind man sees eye to eye with a blind woman, they find a way to get a replacement. Boomer helps him through the frame by getting the next best thing. (Closed-Captioned; U.S.A.)

MOVIE-(DRAMA) \*\*\* "Town Without Pity" 1961 Kirk Douglas, E. G. Marshall. The story of gang rape and its repercussions on a German community, incensed over the fact that the rapists are American G.I.'s and the victim a local girl. (2 hrs., 10 mins.)

MOVIE-(COMEDY) \*\*\* "Room Service" 1938 The Marx Brothers, Lucille Ball. He is the electrician, she is the producer and his aides take meekies to keep from being kicked out of a hotel. (90 mins.)

MOVIE-(COMEDY) \*\*\* "The Three Stooges Go Around The World In 10 Days" 1958 Three Stooges, Jay Sheffield. Three zany travel around the world to win a bet. (2 hrs.)

MOVIE-(ADVENTURE) \*\*\* "The Vikings" 1958 Kirk Douglas, Tor Curtis. A Viking King and his son kidnap a Welsh princess and hold her for ransom. (2 hrs.)

NATIONAL FOOTBALL LEAGUE GAME Houston Oilers at Cincinnati Bengals.
MEDICINE AND YOUR HEALTH
NATIONAL FOOTBALL LEAGUE GAME San Francisco 49ers at Pittsburgh Steelers.

TEXAS TECH FOOTBALL
NEWS-WEATHER-SPORTS
MOVIE-(SUSPENSE) \*\*\* "Arabesque" 1966 Gregory Peck, Sophia Loren. An American exchange professor, in England, kidnapped by a Middle East prime minister, escapes in a thriller of the real-life counterparts of the number one vampire. (2 hrs.)

MOVIE-(WESTERN) \*\*\* "Dawn Rider" 1935 John Wayne, Marion Burns. Action western as the "Duke" battles evil. (70 mins.)

MOVIE-(COMEDY) \*\*\* "The Day After Tomorrow" 1954 John Ford, Linda Darnell. Story of Wyatt Earp and Doc Holliday. (2 hrs.)

MOVIE-(COMEDY) \*\*\* "The Day After Tomorrow" 1954 John Ford, Linda Darnell. Story of Wyatt Earp and Doc Holliday. (2 hrs.)

MOVIE-(COMEDY) \*\*\* "The Day After Tomorrow" 1954 John Ford, Linda Darnell. Story of Wyatt Earp and Doc Holliday. (2 hrs.)

MOVIE-(COMEDY) \*\*\* "The Day After Tomorrow" 1954 John Ford, Linda Darnell. Story of Wyatt Earp and Doc Holliday. (2 hrs.)

MOVIE-(COMEDY) \*\*\* "The Day After Tomorrow" 1954 John Ford, Linda Darnell. Story of Wyatt Earp and Doc Holliday. (2 hrs.)

MOVIE-(COMEDY) \*\*\* "The Day After Tomorrow" 1954 John Ford, Linda Darnell. Story of Wyatt Earp and Doc Holliday. (2 hrs.)

MOVIE-(COMEDY) \*\*\* "The Day After Tomorrow" 1954 John Ford, Linda Darnell. Story of Wyatt Earp and Doc Holliday. (2 hrs.)

MOVIE-(COMEDY) \*\*\* "The Day After Tomorrow" 1954 John Ford, Linda Darnell. Story of Wyatt Earp and Doc Holliday. (2 hrs.)

MOVIE-(COMEDY) \*\*\* "The Day After Tomorrow" 1954 John Ford, Linda Darnell. Story of Wyatt Earp and Doc Holliday. (2 hrs.)

MOVIE-(COMEDY) \*\*\* "The Day After Tomorrow" 1954 John Ford, Linda Darnell. Story of Wyatt Earp and Doc Holliday. (2 hrs.)

MOVIE-(COMEDY) \*\*\* "The Day After Tomorrow" 1954 John Ford, Linda Darnell. Story of Wyatt Earp and Doc Holliday. (2 hrs.)

IN TOUCH
ROBERT SCHULLER FROM CRYSTAL CATHEDRAL
TARZAN
DAVE AND GOLIATH
REX HUBBARD
NEWS-WEATHER-SPORTS

ANIMALS, ANIMALS, ANIMALS: SCHOOL ROCK
REX HUBBARD
JIMMY SWAGGART
WEEK IN AGRICULTURE

TO BE ANNOUNCED
SPORTS CENTER PLUS
KING IS COMING
FIRST BAPTIST CHURCH
CISCO KID
ROBERT SCHULLER FROM CRYSTAL CATHEDRAL
FOR THE FANS
TOMLANDRY SHOW

HBO SNEAK PREVIEW: NOVEMBER
NOVEMBER Jerry Stiller and Anne Meara highlight the upcoming movies, sports and specials on HBO in November.

LARRY JONES
LONE RANGER
NFL '81 Host: Bryant Gumbel. INSIDE BUSINESS

THE NFL TODAY NFL news and other highlights of the day with Brent Musburger, Phyllis George, Irv Cross and Jimmy "The Greek" Snyder.

ON LOCATION: 3rd Annual Rich Little And The Great Pretenders! Impassioned entertainment from the MGM Grand Hotel in Las Vegas, with Rich Little, Thom Brenner and Julie Bess.

LARRY JONES MINISTRY
SPORTS CENTER
WILD KINGDOM
HERE'S BOOMER When a blind man sees eye to eye with a blind woman, they find a way to get a replacement. Boomer helps him through the frame by getting the next best thing. (Closed-Captioned; U.S.A.)

MOVIE-(DRAMA) \*\*\* "Town Without Pity" 1961 Kirk Douglas, E. G. Marshall. The story of gang rape and its repercussions on a German community, incensed over the fact that the rapists are American G.I.'s and the victim a local girl. (2 hrs., 10 mins.)

MOVIE-(COMEDY) \*\*\* "Room Service" 1938 The Marx Brothers, Lucille Ball. He is the electrician, she is the producer and his aides take meekies to keep from being kicked out of a hotel. (90 mins.)

MOVIE-(COMEDY) \*\*\* "The Three Stooges Go Around The World In 10 Days" 1958 Three Stooges, Jay Sheffield. Three zany travel around the world to win a bet. (2 hrs.)

MOVIE-(ADVENTURE) \*\*\* "The Vikings" 1958 Kirk Douglas, Tor Curtis. A Viking King and his son kidnap a Welsh princess and hold her for ransom. (2 hrs.)

NATIONAL FOOTBALL LEAGUE GAME Houston Oilers at Cincinnati Bengals.
MEDICINE AND YOUR HEALTH
NATIONAL FOOTBALL LEAGUE GAME San Francisco 49ers at Pittsburgh Steelers.

TEXAS TECH FOOTBALL
NEWS-WEATHER-SPORTS
MOVIE-(SUSPENSE) \*\*\* "Arabesque" 1966 Gregory Peck, Sophia Loren. An American exchange professor, in England, kidnapped by a Middle East prime minister, escapes in a thriller of the real-life counterparts of the number one vampire. (2 hrs.)

MOVIE-(WESTERN) \*\*\* "Dawn Rider" 1935 John Wayne, Marion Burns. Action western as the "Duke" battles evil. (70 mins.)

MOVIE-(COMEDY) \*\*\* "The Day After Tomorrow" 1954 John Ford, Linda Darnell. Story of Wyatt Earp and Doc Holliday. (2 hrs.)

MOVIE-(COMEDY) \*\*\* "The Day After Tomorrow" 1954 John Ford, Linda Darnell. Story of Wyatt Earp and Doc Holliday. (2 hrs.)

MOVIE-(COMEDY) \*\*\* "The Day After Tomorrow" 1954 John Ford, Linda Darnell. Story of Wyatt Earp and Doc Holliday. (2 hrs.)

MOVIE-(COMEDY) \*\*\* "The Day After Tomorrow" 1954 John Ford, Linda Darnell. Story of Wyatt Earp and Doc Holliday. (2 hrs.)

MOVIE-(COMEDY) \*\*\* "The Day After Tomorrow" 1954 John Ford, Linda Darnell. Story of Wyatt Earp and Doc Holliday. (2 hrs.)

MOVIE-(COMEDY) \*\*\* "The Day After Tomorrow" 1954 John Ford, Linda Darnell. Story of Wyatt Earp and Doc Holliday. (2 hrs.)

MOVIE-(COMEDY) \*\*\* "The Day After Tomorrow" 1954 John Ford, Linda Darnell. Story of Wyatt Earp and Doc Holliday. (2 hrs.)

MOVIE-(COMEDY) \*\*\* "The Day After Tomorrow" 1954 John Ford, Linda Darnell. Story of Wyatt Earp and Doc Holliday. (2 hrs.)

MOVIE-(COMEDY) \*\*\* "The Day After Tomorrow" 1954 John Ford, Linda Darnell. Story of Wyatt Earp and Doc Holliday. (2 hrs.)

MOVIE-(COMEDY) \*\*\* "The Day After Tomorrow" 1954 John Ford, Linda Darnell. Story of Wyatt Earp and Doc Holliday. (2 hrs.)

MOVIE-(COMEDY) \*\*\* "The Day After Tomorrow" 1954 John Ford, Linda Darnell. Story of Wyatt Earp and Doc Holliday. (2 hrs.)

MOVIE-(COMEDY) \*\*\* "The Day After Tomorrow" 1954 John Ford, Linda Darnell. Story of Wyatt Earp and Doc Holliday. (2 hrs.)

MOVIE-(COMEDY) \*\*\* "The Day After Tomorrow" 1954 John Ford, Linda Darnell. Story of Wyatt Earp and Doc Holliday. (2 hrs.)

MOVIE-(COMEDY) \*\*\* "The Day After Tomorrow" 1954 John Ford, Linda Darnell. Story of Wyatt Earp and Doc Holliday. (2 hrs.)

MOVIE-(COMEDY) \*\*\* "The Day After Tomorrow" 1954 John Ford, Linda Darnell. Story of Wyatt Earp and Doc Holliday. (2 hrs.)

MOVIE-(COMEDY) \*\*\* "The Day After Tomorrow" 1954 John Ford, Linda Darnell. Story of Wyatt Earp and Doc Holliday. (2 hrs.)

WRESTLING
MOVIE-(COMEDY) \*\*\* "Loving Couples" 1980 Shirley MacLaine, James Coburn. Two couples, one married, one not, take a stab at some unconventional regrouping. (Rated PG) (97 mins.)

AMERICAN TRAIL
EMERGENCY MEDICAL SERVICE: THE CALL FOR LIFE
YEP ELLIS
POP GOES THE COUNTRY
BATTLESTAR GALACTICA
WILKINGDOM

THE WEEK IN REVIEW
GEORGE
PHOTO SHOW "It's About Time" Host Jonathan Goell demonstrates short, long and long exposure and the effects they have on subjects in motion.

ABC NEWS
LITTLE HOUSE ON THE PRAIRIE
NBC NEWS
INTERNATIONAL WEEK IN REVIEW

NICE PEOPLE
PRIORITY ONE
INTERNATIONAL
COSMOS "Blues for a Red Planet" Using special effects and elaborate models, "Cosmos" shows us the illusion of being on the planet Mars, and speculates on the future when vehicles have combed and explored the planet's entire surface. (Closed-Captioned; U.S.A.) (60 mins.)

EVER INCREASING FAITH
CODE RED
ENTERTAINMENT THIS WEEK

SPORTS SUNDAY
60 MINUTES CBS News Correspondents Mike Wallace, Morley Safer, Ed Bradley and Harry Reasoner are the on-air editors of this weekly news magazine. (60 mins.)

MOVIE-(COMEDY) \*\*\* "Three Stooges Go Around The World In 10 Days" 1958 Three Stooges, Jay Sheffield. Three zany travel around the world to win a bet. (2 hrs.)

LARRY JONES MINISTRY
SPORTS CENTER
WILD KINGDOM
HERE'S BOOMER When a blind man sees eye to eye with a blind woman, they find a way to get a replacement. Boomer helps him through the frame by getting the next best thing. (Closed-Captioned; U.S.A.)

MOVIE-(DRAMA) \*\*\* "Town Without Pity" 1961 Kirk Douglas, E. G. Marshall. The story of gang rape and its repercussions on a German community, incensed over the fact that the rapists are American G.I.'s and the victim a local girl. (2 hrs., 10 mins.)

MOVIE-(COMEDY) \*\*\* "Room Service" 1938 The Marx Brothers, Lucille Ball. He is the electrician, she is the producer and his aides take meekies to keep from being kicked out of a hotel. (90 mins.)

MOVIE-(COMEDY) \*\*\* "The Three Stooges Go Around The World In 10 Days" 1958 Three Stooges, Jay Sheffield. Three zany travel around the world to win a bet. (2 hrs.)

MOVIE-(ADVENTURE) \*\*\* "The Vikings" 1958 Kirk Douglas, Tor Curtis. A Viking King and his son kidnap a Welsh princess and hold her for ransom. (2 hrs.)

NATIONAL FOOTBALL LEAGUE GAME Houston Oilers at Cincinnati Bengals.
MEDICINE AND YOUR HEALTH
NATIONAL FOOTBALL LEAGUE GAME San Francisco 49ers at Pittsburgh Steelers.

TEXAS TECH FOOTBALL
NEWS-WEATHER-SPORTS
MOVIE-(SUSPENSE) \*\*\* "Arabesque" 1966 Gregory Peck, Sophia Loren. An American exchange professor, in England, kidnapped by a Middle East prime minister, escapes in a thriller of the real-life counterparts of the number one vampire. (2 hrs.)

MOVIE-(WESTERN) \*\*\* "Dawn Rider" 1935 John Wayne, Marion Burns. Action western as the "Duke" battles evil. (70 mins.)

MOVIE-(COMEDY) \*\*\* "The Day After Tomorrow" 1954 John Ford, Linda Darnell. Story of Wyatt Earp and Doc Holliday. (2 hrs.)

MOVIE-(COMEDY) \*\*\* "The Day After Tomorrow" 1954 John Ford, Linda Darnell. Story of Wyatt Earp and Doc Holliday. (2 hrs.)

MOVIE-(COMEDY) \*\*\* "The Day After Tomorrow" 1954 John Ford, Linda Darnell. Story of Wyatt Earp and Doc Holliday. (2 hrs.)

MOVIE-(COMEDY) \*\*\* "The Day After Tomorrow" 1954 John Ford, Linda Darnell. Story of Wyatt Earp and Doc Holliday. (2 hrs.)

MOVIE-(COMEDY) \*\*\* "The Day After Tomorrow" 1954 John Ford, Linda Darnell. Story of Wyatt Earp and Doc Holliday. (2 hrs.)

MOVIE-(COMEDY) \*\*\* "The Day After Tomorrow" 1954 John Ford, Linda Darnell. Story of Wyatt Earp and Doc Holliday. (2 hrs.)

MOVIE-(COMEDY) \*\*\* "The Day After Tomorrow" 1954 John Ford, Linda Darnell. Story of Wyatt Earp and Doc Holliday. (2 hrs.)

MOVIE-(COMEDY) \*\*\* "The Day After Tomorrow" 1954 John Ford, Linda Darnell. Story of Wyatt Earp and Doc Holliday. (2 hrs.)

MOVIE-(COMEDY) \*\*\* "The Day After Tomorrow" 1954 John Ford, Linda Darnell. Story of Wyatt Earp and Doc Holliday. (2 hrs.)

MOVIE-(COMEDY) \*\*\* "The Day After Tomorrow" 1954 John Ford, Linda Darnell. Story of Wyatt Earp and Doc Holliday. (2 hrs.)

MOVIE-(COMEDY) \*\*\* "The Day After Tomorrow" 1954 John Ford, Linda Darnell. Story of Wyatt Earp and Doc Holliday. (2 hrs.)

MOVIE-(COMEDY) \*\*\* "The Day After Tomorrow" 1954 John Ford, Linda Darnell. Story of Wyatt Earp and Doc Holliday. (2 hrs.)

MOVIE-(COMEDY) \*\*\* "The Day After Tomorrow" 1954 John Ford, Linda Darnell. Story of Wyatt Earp and Doc Holliday. (2 hrs.)

MOVIE-(COMEDY) \*\*\* "The Day After Tomorrow" 1954 John Ford, Linda Darnell. Story of Wyatt Earp and Doc Holliday. (2 hrs.)

MOVIE-(COMEDY) \*\*\* "The Day After Tomorrow" 1954 John Ford, Linda Darnell. Story of Wyatt Earp and Doc Holliday. (2 hrs.)

NEWS
CONTACT
CONTEMPORARY HEALTH ISSUES
AN EVENING AT THE IMPROV
ENTERTAINMENT THIS WEEK

MOVIE-(ADVENTURE) \*\*\* "Fighting Kentuckians" 1949 John Wayne, Vera-Elaine. A Kentucky finds time to combat land-grabbing criminals and court the daughter of a French General. (2 hrs.)

OPEN UP
MOVIE-(MUSIC) \*\*\* "Times Square" 1960 Robin Johnson, Trini Alvarado. Two young girls meet in a psychiatric hospital and agree to jump into Times Square and become the infamous "Sleaze Sisters." (Rated R) (111 mins.)

MOVIE-(COMEDY) \*\*\* "When A Stranger Calls" 1979 Carol Kane, Colleen Dewhurst. Every woman's nightmare becomes real with this thriller. (Rated R) (2 hrs.)

MOVIE-(COMEDY) \*\*\* "Baby Blue Marine" 1976 Glynnis O'Connor, Jan-Michael Vincent. A boot camp dropout during WW II is mistaken for a hero by residents of a small town in Colorado. (Rated PG) (90 mins.)

MOVIE-(COMEDY) \*\*\* "Paper Lion" 1968 Alan Alda, Lauren Hutton. The story of a writer's experiences when he becomes an honorary member of the Detroit Lions. (2 hrs.)

MOVIE-(ADVENTURE) \*\*\* "Final Countdown" 1980 Kirk Douglas, Martin Sheen. The crew of the U.S.S. Nimitz, a nuclear aircraft carrier, enters a storm which turns them into a time warp, dropping them at Pearl Harbor the day before the Japanese attack. (Rated PG) (102 mins.)

NASHVILLE
APPLE CAVETT SHOW
PRIORITY ONE
INTERNATIONAL

BARNEY MILLER
BENNY HILL
NEWS
SPORTS TONIGHT
SHOWTIME MOVIE-(ROMANCE) \*\*\* "It's My Turn" 1980 Jill Clayburgh, Michael Douglas. A funny love story of a woman whose life of independence seems ideal until she meets and falls in love with a former sports hero during a whirlwind weekend in New York. (Rated R) (90 mins.)

MOVIE-(COMEDY) \*\*\* "The Day After Tomorrow" 1954 John Ford, Linda Darnell. Story of Wyatt Earp and Doc Holliday. (2 hrs.)

MOVIE-(COMEDY) \*\*\* "The Day After Tomorrow" 1954 John Ford, Linda Darnell. Story of Wyatt Earp and Doc Holliday. (2 hrs.)

MOVIE-(COMEDY) \*\*\* "The Day After Tomorrow" 1954 John Ford, Linda Darnell. Story of Wyatt Earp and Doc Holliday. (2 hrs.)

MOVIE-(COMEDY) \*\*\* "The Day After Tomorrow" 1954 John Ford, Linda Darnell. Story of Wyatt Earp and Doc Holliday. (2 hrs.)

MOVIE-(COMEDY) \*\*\* "The Day After Tomorrow" 1954 John Ford, Linda Darnell. Story of Wyatt Earp and Doc Holliday. (2 hrs.)

MOVIE-(COMEDY) \*\*\* "The Day After Tomorrow" 1954 John Ford, Linda Darnell. Story of Wyatt Earp and Doc Holliday. (2 hrs.)

MOVIE-(COMEDY) \*\*\* "The Day After Tomorrow" 1954 John Ford, Linda Darnell. Story of Wyatt Earp and Doc Holliday. (2 hrs.)

MOVIE-(COMEDY) \*\*\* "The Day After Tomorrow" 1954 John Ford, Linda Darnell. Story of Wyatt Earp and Doc Holliday. (2 hrs.)

MOVIE-(COMEDY) \*\*\* "The Day After Tomorrow" 1954 John Ford, Linda Darnell. Story of Wyatt Earp and Doc Holliday. (2 hrs.)

MOVIE-(COMEDY) \*\*\* "The Day After Tomorrow" 1954 John Ford, Linda Darnell. Story of Wyatt Earp and Doc Holliday. (2 hrs.)

MOVIE-(COMEDY) \*\*\* "The Day After Tomorrow" 1954 John Ford, Linda Darnell. Story of Wyatt Earp and Doc Holliday. (2 hrs.)

MOVIE-(COMEDY) \*\*\* "The Day After Tomorrow" 1954 John Ford, Linda Darnell. Story of Wyatt Earp and Doc Holliday. (2 hrs.)

MOVIE-(COMEDY) \*\*\* "The Day After Tomorrow" 1954 John Ford, Linda Darnell. Story of Wyatt Earp and Doc Holliday. (2 hrs.)

MOVIE-(COMEDY) \*\*\* "The Day After Tomorrow" 1954 John Ford, Linda Darnell. Story of Wyatt Earp and Doc Holliday. (2 hrs.)

MOVIE-(COMEDY) \*\*\* "The Day After Tomorrow" 1954 John Ford, Linda Darnell. Story of Wyatt Earp and Doc Holliday. (2 hrs.)

MOVIE-(COMEDY) \*\*\* "The Day After Tomorrow" 1954 John Ford, Linda Darnell. Story of Wyatt Earp and Doc Holliday. (2 hrs.)

MOVIE-(COMEDY) \*\*\* "The Day After Tomorrow" 1954 John Ford, Linda Darnell. Story of Wyatt Earp and Doc Holliday. (2 hrs.)

MOVIE-(COMEDY) \*\*\* "The Day After Tomorrow" 1954 John Ford, Linda Darnell. Story of Wyatt Earp and Doc Holliday. (2 hrs.)

MOVIE-(COMEDY) \*\*\* "The Day After Tomorrow" 1954 John Ford, Linda Darnell. Story of Wyatt Earp and Doc Holliday. (2 hrs.)

MOVIE-(COMEDY) \*\*\* "The Day After Tomorrow" 1954 John Ford, Linda Darnell. Story of Wyatt Earp and Doc Holliday. (2 hrs.)

MOVIE-(COMEDY) \*\*\* "The Day After Tomorrow" 1954 John Ford, Linda Darnell. Story of Wyatt Earp and Doc Holliday. (2 hrs.)

MOVIE-(COMEDY) \*\*\* "The Day After Tomorrow" 1954 John Ford, Linda Darnell. Story of Wyatt Earp and Doc Holliday. (2 hrs.)

MONDAY NIGHT FOOTBALL
Minnesota Vikings vs Denver Broncos. (Closed-Captioned; U.S.A.)

SOLID GOLD
MOVIE-(DRAMA) \*\*\* "Flamingo Road" 1949 Joan Crawford, Zachary Scott. A tough carnival dancer finds herself loving two men, and matching wits with a corrupt politician. (2 hrs.)

MONDAY NIGHT AT THE MOVIES "To Be Sold" 1981 Stars: Lynda Carter, Harold Gould, Ed Nelson. A determined social worker risks personal danger to uncover an illegal baby-selling ring, after a teenage client pleads to keep her child. (2 hrs.)

M.A.S.H. The 407th becomes involved with three wounded soldiers who arrive from the front with unusual problems to solve.

MOVIE-(THRILLER) \*\*\* "When A Stranger Calls" 1979 Carol Kane, Colleen Dewhurst. Every woman's nightmare becomes real with this thriller. (Rated R) (2 hrs.)

EISENSTEADT: GERMANY Frequently described as the father of political journalism, Alfred Eisenstaedt was one of the original photographers for "Life" magazine. This program documents his return to his native Germany in 1960.

HOUSE CALLS After a romantic house calls a bit of wine Charley proposes marriage to Ann and she accepts. (Season Premiere)

HOLocaust: THE SURVIVORS GATHER: A LOOK BACK This documentary profiles the World Gathering which took place in Israel during mid-June, 1981. Highlights include opening ceremonies at Yad Vashem, the Holocaust Memorial Center, ceremonies honoring the one and a half million children slain by the Nazis, and an address by Prime Minister Begin. (60 mins.)

NEWS
FREEMAN REPORTS
LOU GRANT Billie gets a marriage proposal from baseball scout Ted McCovey but is too busy on a story to take the time to accept. (Season Premiere; 60 mins.)

SING OUT AMERICA
THIS IS THE LIFE
TBS NEWS

MOVIE-(ADVENTURE) \*\*\* "Final Countdown" 1980 Kirk Douglas, Martin Sheen. The crew of the U.S.S. Nimitz, a nuclear aircraft carrier, enters a storm which turns them into a time warp, dropping them at Pearl Harbor the day before the Japanese attack. (Rated PG) (102 mins.)

NASHVILLE
APPLE CAVETT SHOW
PRIORITY ONE
INTERNATIONAL

BARNEY MILLER
BENNY HILL
NEWS
SPORTS TONIGHT
SHOWTIME MOVIE-(ROMANCE) \*\*\* "It's My Turn" 1980 Jill Clayburgh, Michael Douglas. A funny love story of a woman whose life of independence seems ideal until she meets and falls in love with a former sports hero during a whirlwind weekend in New York. (Rated R) (90 mins.)

MOVIE-(COMEDY) \*\*\* "The Day After Tomorrow" 1954 John Ford, Linda Darnell. Story of Wyatt Earp and Doc Holliday. (2 hrs.)

MOVIE-(COMEDY) \*\*\* "The Day After Tomorrow" 1954 John Ford, Linda Darnell. Story of Wyatt Earp and Doc Holliday. (2 hrs.)

MOVIE-(COMEDY) \*\*\* "The Day After Tomorrow" 1954 John Ford, Linda Darnell. Story of Wyatt Earp and Doc Holliday. (2 hrs.)

MOVIE-(COMEDY) \*\*\* "The Day After Tomorrow" 1954 John Ford, Linda Darnell. Story of Wyatt Earp and Doc Holliday. (2 hrs.)

MOVIE-(COMEDY) \*\*\* "The Day After Tomorrow" 1954 John Ford, Linda Darnell. Story of Wyatt Earp and Doc Holliday. (2 hrs.)

MOVIE-(COMEDY) \*\*\* "The Day After Tomorrow" 1954 John Ford, Linda Darnell. Story of Wyatt Earp and Doc Holliday. (2 hrs.)

MOVIE-(COMEDY) \*\*\* "The Day After Tomorrow" 1954 John Ford, Linda Darnell. Story of Wyatt Earp and Doc Holliday. (2 hrs.)

MOVIE-(COMEDY) \*\*\* "The Day After Tomorrow" 1954 John Ford, Linda Darnell. Story of Wyatt Earp and Doc Holliday. (2 hrs.)

MOVIE-(COMEDY) \*\*\* "The Day After Tomorrow" 1954 John Ford, Linda Darnell. Story of Wyatt Earp and Doc Holliday. (2 hrs.)

MOVIE-(COMEDY) \*\*\* "The Day After Tomorrow" 1954 John Ford, Linda Darnell. Story of Wyatt Earp and Doc Holliday. (2 hrs.)

MOVIE-(COMEDY) \*\*\* "The Day After Tomorrow" 1954 John Ford, Linda Darnell. Story of Wyatt Earp and Doc Holliday. (2 hrs.)

MOVIE-(COMEDY) \*\*\* "The Day After Tomorrow" 1954 John Ford, Linda Darnell. Story of Wyatt Earp and Doc Holliday. (2 hrs.)

MOVIE-(COMEDY) \*\*\* "The Day After Tomorrow" 1954 John Ford, Linda Darnell. Story of Wyatt Earp and Doc Holliday. (2 hrs.)

MOVIE-(COMEDY) \*\*\* "The Day After Tomorrow" 1954 John Ford, Linda Darnell. Story of Wyatt Earp and Doc Holliday. (2 hrs.)

MOVIE-(COMEDY) \*\*\* "The Day After Tomorrow" 1954 John Ford, Linda Darnell. Story of Wyatt Earp and Doc Holliday. (2 hrs.)

MOVIE-(COMEDY) \*\*\* "The Day After Tomorrow" 1954 John Ford, Linda Darnell. Story of Wyatt Earp and Doc Holliday. (2 hrs.)

MOVIE-(COMEDY) \*\*\* "The Day After Tomorrow" 1954 John Ford, Linda Darnell. Story of Wyatt Earp and Doc Holliday. (2 hrs.)

MOVIE-(COMEDY) \*\*\* "The Day After Tomorrow" 1954 John Ford, Linda Darnell. Story of Wyatt Earp