

Base Lockington  
P.O. Box 2550  
Amarillo, Tex. 79105

# The Lockney Beacon

Number 45 Volume 80

Thursday November 5, 1981

22 Pages In Three Sections

## Constitutional amendments

### Mountains give six eyes one naye

17 Floyd county voting boxes counted on the seven amendments voted on by a substantial majority of them and a definite one.

Amendment Four, Water development plan, 955 For and 100 Against.

Amendment Five, Farm product tax exemption, 682 For and 236 Against.

Amendment Six, Home owners tax exemption, 529 For and 364 Against.

Amendment Seven, Veterans land program, 504 For and 391 Against.

Amendment Four, designed and sponsored by Texas House Speaker Bill Clayton, which would have set aside half of the state's surplus revenues after budget financing for a fund to develop water projects throughout the state, was an overwhelming favorite of Floyd county voters, as it was expected to be over the entire West Texas area, as the local vote indicated approval by a nine-to-one margin.

The proposal appeared to be losing by a large margin state-wide, however, as the East Texas—and the Houston area vote particularly—was being counted after the polls closed Tuesday night. According to a Texas Election Bureau report, with 233 of 254 counties reporting, 205 complete, showed Amendment Four being defeated by 234,946, or 43%.

Amendment Three, Spending plan, For 197,347, or 37%; Against 330,946, or 63%.

Amendment Four, Water development plan, For 234,946, or 43%; Against 316,279, or 57%.

Amendment Five, Farm product tax exemption, For 373,123, or 68%; Against 176,120, or 32%.

Amendment Six, Home owners tax exemption, For 378,101, or 70%; Against 165,811, or 30%.

Amendment Seven, Veterans land program, For 349,730, or 64%; Against 193,189, or 36%.

See the accompanying chart for a complete rundown of the Floyd county vote by precinct and voting box.

How Floyd Countians Voted	Voting Box Number	Constitutional Amendments													
		No. 1		No. 2		No. 3		No. 4		No. 5		No. 6		No. 7	
		For	Against	For	Against	For	Against	For	Against	For	Against	For	Against		
Southwest Floydada	1	141	108	195	52	101	141	236	24	179	75	143	103	142	104
Allmon	3	7	7	10	4	6	8	13	3	16	0	8	5	6	8
Sandhill	4	16	3	16	3	8	11	20	1	20	1	13	7	12	9
East Lockney	5	17	18	23	12	13	22	42	2	28	9	22	17	18	19
Providence	7	11	17	10	19	10	17	29	0	21	7	19	9	9	20
Lone Star	8	8	7	6	9	2	13	13	4	8	6	10	3	6	8
South Plains	9	7	28	21	14	9	23	36	3	36	2	18	17	10	25
Cedar Hill	11	5	17	14	10	8	14	19	6	18	4	14	8	10	11
Baker	13	5	17	16	6	5	17	21	2	20	2	11	11	9	13
Harmony	16	15	8	15	8	10	13	24	0	23	0	16	7	13	9
Goodnight	17	4	15	16	3	2	16	11	8	17	1	9	9	15	4
West Lockney	18	95	99	151	43	65	125	186	20	135	66	101	91	100	92
Northwest Floydada	19	36	19	42	13	20	34	52	8	36	20	34	23	42	14
Dougherty	20	16	19	25	12	10	24	33	4	32	4	22	14	22	14
McCoy	22	7	1	6	2	4	3	11	0	8	2	9	0	10	0
Southeast Floydada	23	59	42	72	27	43	53	93	11	75	28	64	35	64	35
Northeast Floydada	24	5	8	8	5	2	11	11	2	9	4	10	4	11	4
Absentee	-	6	1	6	1	6	1	5	2	1	5	6	1	5	2
Totals		460	434	661	234	324	546	955	100	682	236	529	364	504	391



**LADY HORNS** OF 1981-82—The LHS girls varsity basketball team's formal photograph taken for the 1981-82 season. Squad members front row, L-R, are Irene Medina, Patricia Torres, F; and Karyn Foster, F. Rear, L-R, Kim Carthel, Post; Karen Mathis, P; Connie Coffman, F; Jerri Ann McCormick, P and Kay Ray, F. The girls will begin season play November 17 and district competition January 15.

## Lady horns exhibit confidence

Lockney High School Lady Horns varsity basketball squad was into shape this week as they practiced in preparation for season opener against Lubbock Coach Sheri Haynes appeared pleased with the progress made by her young squad, even though they have had only a limited amount of work this far. Lockney has been picked for third in District 3-AAA behind Idalou in first and Abernathy in second, by a regional magazine, and the coach expressed strong confidence that they will do at least that good if some of her younger players come along rapidly.

The Lady Horns were second in district last year with a 23-7 win-loss record. They were beat out for the district championship by Abernathy

Continued On Page 3

## This Week

Christmas Fund has been started to raise money for presents for several children in foster care in Floyd County by the Floyd County Child Welfare Department.

Amount of contribution to the fund would help brighten Christmas for children who otherwise would receive no gifts.

Lockney call Jerry Klein at 652-3803 and in Floydada call Tom Powell at 2406.

Reception honoring Helene Holt, Lockney branch librarian, will be held at the library at 224 S. Main, Sunday, November 8 from 2 to 3 p.m. The program is being sponsored by the Lockney Friends of the Library and the library is cordially invited to attend.

Holt served as librarian for twelve years prior to her retirement this summer.

## UIL announces new region 1 district alignments

The new district alignments for UIL Class 5A announced by the Interscholastic League early this week, the Lockney Longhorns met two new foes on the gridiron to add to two old ones. Post will enter District 3-AAA and Idalou will move over to District 2-AAA. Friona, Littlefield, Muleshoe in District 2-AAA. New District 3-AAA alignment consists of the same number of schools in the past and will include Lockney, Floydada, Idalou, Pampa, down from 5A to 4A. Olton, down from 3A to 2A, and Vega, Forsan and Ropes, who all dropped from 2A to 1A.

While announcing the new UIL alignments locally, Lockney Schools Superintendent Dub Hallmark also released the planned 1982 football schedule for the coming 1982 season, which is as follows:

Non-district games—September 3: Tulia; Sept. 10, Petersburg; Sept. 17, Olton; Sept. 24, Ralls and October 1, Abernathy. District games and locations are: Oct. 8, Floydada, there; Oct. 15, Idalou, home; Oct. 22, Slaton, there; Oct. 29, Post, there; Nov. 5, Childress, home and Nov. 12, Bi-district.

Following is the Region 13A lineup by districts:

District 1-AAA -- Amarillo River, Perryton and Spearman.

District 2-AAA -- Abernathy, Dimmitt, Friona, Littlefield, Muleshoe and Tulia.

District 3-AAA -- Childress, Lockney, Floydada, Idalou, Post and Slaton.

District 4-AAA -- Denver City, Lubbock-Cooper, Lubbock-Roosevelt, Seminole, Tahoka and Frenship.

District 5-AAA -- Alpine, Canutillo, Fabens and Kermit.

District 6-AAA -- Ballinger, Coahoma, Colorado City, Crane, Ozona and Sonora.

District 7-AAA -- Abilene Wylie, Breckenridge, Clyde, Electra, Merkel and Stamford.

District 8-AAA -- Brady, Burnett, Coleman, Marble Falls, Comanche and Llano.

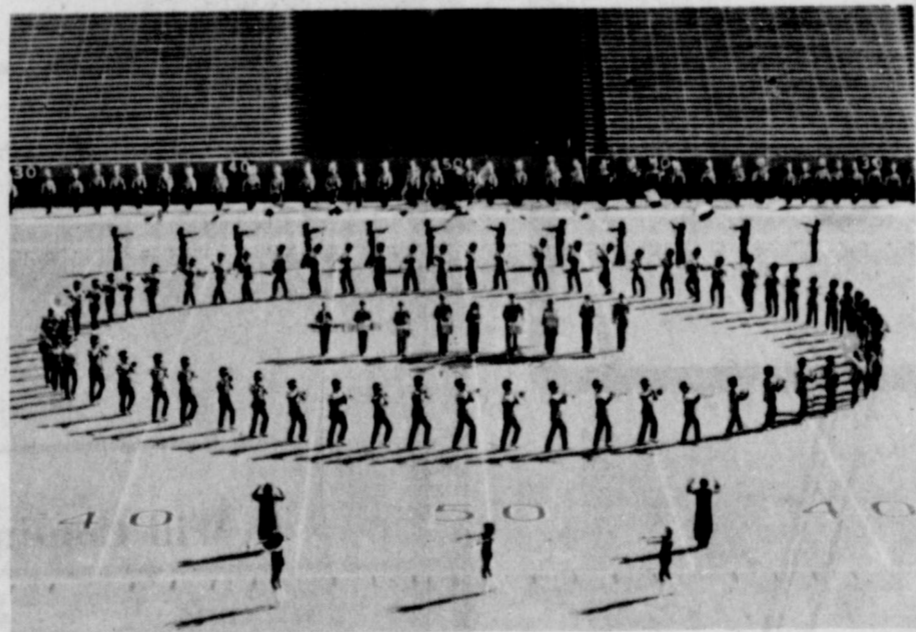

**THE LOCKNEY LONGHORN BAND** won a II rating at UIL Contest in Lubbock yesterday. There were seventeen bands competing.

## 'Christmas in November' gives Christmas spirit

Take time now, before the rush of the holiday season, to get a little bit of that Christmas spirit! "Christmas in November" sponsored by the Floyd County Family Living Committee, will be Saturday, November 14, at Duncan Elementary School in Floydada.

This event promises to have something for nearly everyone. The Christmas Bazaar, featuring area arts and crafts exhibitors, will be an excellent place to shop for unique gifts for everyone on your list.

Special demonstrations will be presented every hour, beginning at 9:30 a.m. and concluding at 6:30 p.m. Programs planned include:

"Crafts for Christmas" — ideas for home decorating and gift-giving with crafts you can make, presented at 9:30 a.m. by Nell Finney of 'Country Crafts and Ceramics' in Tulia.

"Gifts from Your Kitchen" — program on 'Make or Bake' holiday gift ideas presented at 10:30 a.m. by Linda Pittman, Lubbock County Extension Agent.

"Toys for Little Tykes" — tips for toy selection and ideas for making them yourself, given by Pearle Wheeler of Synder at 11:30 a.m.

"The Story of Christmas" — entertainment provided by Virginia Taylor of Tulia at 12:30 p.m.

"Christmas All Sewin Up" — ideas for everyone on the seamstress gift-giving list, presented by Betty's Fashion Fabrics of Plainview at 1:30 p.m.

"Christmas Treats with the Blender" — ideas for holiday treats, presented at 2:30 p.m. by Betty's Fashion Fabrics of Plainview.

Continued On Page 3

Jeffrey Land, An  
the land beyond the

ay

NG

NCED

ENTER

east Actor Larry  
Martin and Jim  
et. U.S.A.

ERG SHOW

BRIT

NETT AND

PREVIEW:  
Miller and Anne  
coming movies,  
on HBO in

REPORT

HIRLEY AND

ENTAINMENT

TELEVISION

ON

11:00  
3 MAHALE'S NAVY  
3 SPORTS CENTER  
3 FOOTSTEPS  
3 ALL IN THE FAMILY  
3 HARNESS RACING FROM  
YONKERS RACEWAY

11:30  
3 MOVIE (COMEDY) \*\*\* "Baby  
Blue Marine" 1976 Glynnis O'Connor,  
dropped during WW II, is mistaken for  
hero by residents of a small town in  
Colorado. (Rated PG) (90 mins.)

3 JACK BENNY  
3 FOOTSTEPS  
3 ABC NEWS NIGHTLINE  
Anchored by Ted Koppel

12:00  
3 COMEDY \*\*\* "Bachelor  
Party" 1957 Don Murray, Carolyn Jones. After  
a night's carousing at bachelor party, a  
bookie who has just learned he is  
about to become a father returns home  
with deeper respect for his wife. (2  
hrs., 30 mins.)

10 MOVIE (DRAMA) \*\*\* "Man on a  
String" 1971 Christopher George, Joanne  
Whalley-Kilmer. Government undercover  
agent maneuvers two rival mafia families  
into a confrontation. (90 mins.)

11 TOMORROW  
TO-COAST Guests: rock group Devo.  
SHOWTIME MOVIE (MUSICAL)  
\*\*\* "Fame" 1980 Eddie Barr, Irene  
Cara. Eight students attending the New  
Arts Experience grow up, falling in love  
and grabbing for stardom. (Rated R) (2  
hrs., 30 mins.)

12:00  
3 MY LITTLE MARGIE  
3 COLLEGE FOOTBALL  
REVIEW

1 IN TOUCH  
3 FANTASY ISLAND Two women  
desire to return to prehistoric times when  
women were totally dominated by  
primitive men, and Mr. Roark gives a  
blind detective his eyesight so that he  
can locate the missing woman who is the  
love of his life. (Repeat, 70 mins.)

12 PEOPLE TONIGHT  
12:30  
3 BACHELOR FATHER  
3 BEST OF THE NFL

1:00  
3 LIFE OF RILEY  
3 JIM BAKKER  
3 JOE FRANKLIN SHOW  
3 NEWS  
3 SPORTS UPDATE

1:20  
3 MOVIE (DRAMA) \*\*\* "Life at  
the Top" 1966 Laurence Harvey, Jean  
Simmons. Ten years after marrying a  
socialite and fighting his father-in-law's  
business methods, a young husband has  
an affair not knowing his wife is doing  
the same. (2 hrs., 30 mins.)

1:30  
3 COMEDY TONIGHT  
3 SPORTS CENTER  
3 NIGHTBEAT  
3 OVERNIGHT DESK

2:00  
3 MAHALE'S NAVY  
3 THIS WEEK IN THE NHL  
3 GOOD NEWS  
3 MOVIE (DOCUMENTARY) \*\*\*  
"North Country" 1980 Two men,  
each living off the land in the remote  
Alaskan wilderness face danger and  
adventure without the help of modern  
technology. (105 mins.)

10 MOVIE (WESTERN) \*\*\* "Run  
of the Arrow" 1957 Rod Taylor, Brian  
K. Smith. Filled with bitterness, an  
ex-confederate private joins the Sioux  
nation still fighting the United States. (2  
hrs.)

SHOWTIME WACKY WORLD OF  
JONATHAN WINTERS

**Wednesday**  
NOV. 4, 1981

6:00  
3 TO BE ANNOUNCED  
3 SPORTS CENTER  
3 OVEREASY Hearing Hosts: Mary  
Martin and Jim Hartz. (Closed-  
Captioned)

6:30  
3 NEWS  
3 BARNEY MILLER  
3 YOU ASKED FOR IT  
3 MONEYLINE

6:05  
3 CAROL BURNETT AND  
FRIENDS

6:30  
3 COUNTRY MUSIC: A FAMILY  
AFFAIR Tammy Wynette and Roger  
Miller host this lively jamboree featuring  
country music's most famous kinfolk.

3 ANOTHER LIFE  
3 MACHIEL LEHRER REPORT  
3 M.A.S.H.  
3 NBA BASKETBALL Boston  
Celtics vs Chicago Bulls (2 hrs., 30  
mins.)

11 ENTERTAINMENT  
TONIGHT  
12 SPORTS AND TELEVISION  
TONIGHT  
3 JOKER'S WILD  
6:35  
3 NBA BASKETBALL Atlanta  
Hawks vs New Jersey Nets (2 hrs., 15  
mins.)

7:00  
3 NATIONAL GEOGRAPHIC  
SPECIAL  
3 SPORTSTALK  
3 BOSTON SYMPHONY'S  
CENTENNIAL CELEBRATION As  
the high point of nearly two years of  
special events leading up to the  
orchestra's centennial, this stirring  
concert at Boston's Symphony Hall will  
feature the Boston Symphony and Music  
Director Seiji Ozawa, plus a special  
Parimar, Leonora Price, Matias  
Rostropovich, Radolph Serkin and Isaac  
Stern (2 hrs.)

3 LOWE LUNDSTROM  
3 GREATEST AMERICAN HERO  
When an automatic missile system goes  
haywire at the hands of an ultra-militant  
general, Ralph and Bill take a well-  
summoned by the aliens to another eerie  
desert encounter and launched on a  
frantic race to halt the explosive start of  
WWIII (60 mins.)

3 HOCKEY Pittsburgh Penguins vs  
New York Rangers (2 hrs., 30 mins.)

3 REAL PEOPLE A visit with Ben  
Gross, a 65 year old loving landlord in  
Venice, California, and a Derby Line,  
Vermont family that watches television  
America and cooks in Canada. (60  
mins.)

3 PRIME NEWS-120  
3 MR. MERLIN Zac is seated when he  
sees his girlfriend, Sheila, out on a date  
with his best friend, Leo, and begs Max to  
concoct him an antidote to friendship.

## Deer season outlook is promising

The upcoming deer season promises to be everything that last year wasn't.

Good forage and better than normal weather conditions should result in better quality deer than a year ago and more of them, according to a Texas Agricultural Extension Service wildlife specialist.

Hunters can even expect better antlered deer from the improved nutrition which is a major contributing factor to their condition.

"Last year's drought effectively reduced the deer numbers in over-populated areas," explains Dr. Dwight Guynn. "This year there is more food for each animal which translates into good antler growth for bucks and higher fawn crops for does."

Higher fawn crops generally means the deer herds are immediately beginning a population increase. Hence, Guynn stresses that landowners and hunters can work toward a larger female

harvest this year in order to keep down the increasing deer population where desired.

"Failure to harvest more does in the past seasons led to over-populated conditions in many parts of the state that results in large die-offs similar to what happened when the drought hit last year," Guynn says. "Historically, deer harvests in the Hill Country have been about 10% of the population per year. However, we recommend that 20-25% of the deer population be harvested annually just to compensate for reproduction and keep the population from increasing beyond the food supply."

Guynn, a certified wildlife biologist, says it's getting harder each year to predict the type hunting season that hunters can expect. Weather conditions and food availability are major considerations. With a good acorn crop and lush green forage available, deer will

feed mostly at night and bed down during the day, making hunting more difficult.

He says an early frost or scarce food conditions during the season usually cause deer to roam more during daylight hours to seek food. Deer would then be more visible and available to hunters. They could also be more easily drawn to baited stands.

Guynn reminds landowners that deer

census techniques and spotlight counts can be used to better determine deer populations and evaluate proper harvest levels. More can be learned about these techniques along with aging methods, harvest record systems and harvest recommendations through local county Extension agents or Texas Department of Parks and Wildlife officials.

Deer season opens in most Texas counties at sunrise on November 14.

### Pioneer Corporation honors employees

## Residents to be presented awards

Pioneer Corporation (NYSE) will honor 222 of its employees for periods of service ranging from five to 45 years during the corporation's annual series of award dinners which begin Monday (November 2) in Amarillo and will continue the following week on consecutive evenings in Midland (November 10) and Lubbock (November 11).

A fifteen-year award will be presented to William C. Mercer Jr., of Lockney. Five-year awards will be presented to Wilma L. Gowens and Joe S. Martinez, both of Floydada.

K. Bert Watson, president and chief executive officer of the corporation, will present each of the 222 honorees with his or her respective service award.

In addition to corporate personnel the employees represent five of the corporation's eight principal companies including Pioneer Production Corporation, Pioneer Gas Products Company, Pioneer Nuclear, Inc., Energas Company and Westar Transmission Company. Employees being honored are employed

in 30 cities and towns and at eight remote facility locations in three states. The corporation recognizes each employee's service anniversary at five year intervals.

### Christmas fund begun for children

A Christmas Fund has been started to raise money for presents for several children in foster care in Floyd County by the Floyd County Child Welfare Board.

Any amount of contribution to the fund would help brighten Christmas for a child who otherwise would receive no gifts.

In Lockney call Jerry Klein at 652-3803 and in Floydada call Tom Powell at 983-2406.

A group of 131 Amarillo area employees with between five to 45 years on the job were honored at the first of the three dinners Monday evening at the Country Squire Dinner Theatre. The Amarillo area includes all of the Panhandle north of a line extending between Hereford and Dimmitt. Also attending the Amarillo dinner will be employees from operations in Oklahoma and Louisiana.

The following week on November 10, Watson will recognize 27 Midland area employees whose Pioneer careers span from five to 40 years. The Midland area includes the cities of Midland, Odessa and Big Spring. Ranchland Hills Country Club will serve as the site for the gathering.

On November 11, 64 employees with between five to 40 years of service will be honored at the final awards dinner to be held at the Lubbock Country Club.

Pioneer Corporation is a diversified energy-oriented corporation headquartered in Amarillo with operations or interests in 18 states.



"CHRISTMAS IN NOVEMBER"—This group planned and is sponsoring "Christmas In November." They are members of the Family Living Committee, pictured are (l-r) Vikki Yearly, Floydada; Marilyn Tate, County Extension Agent; Regi

Gross, Floydada; and Juanita Brock, Floydada. The dolls, made by Juanita Brock, Christmas bazaar.



CLYDE B. SPANN

### Spann named emeritus in Oklahoma

Clyde B. Spann, who pastored the Calvary Baptist Church, Floydada, 1957-59, was honored Sunday, October 25, by being made pastor emeritus of the First Baptist in Thackerville, Oklahoma where he has served as pastor twelve years. Steve Montalvo is now pastor. Spann completed the B.A. degree at Wayland Baptist College 1959, the M.R.E. at Southwestern Baptist Theo-

## Perspectives

BY MICHAEL  
The American Family is under attack. The liberals reply. Who is right? The Census, it would seem, has solved the dilemma of the 1970's - persons of opposite sex sharing a living in sin. The number of note is that it is also up. The reason cited is basically that both phenomena are more acceptable. The idea of putting his folks in a residential much less accept one as a "ma'am", and never use near their parents. Some of these changes are sometimes cannot, and travel in search of a job. But the fact is they were even fifty years ago to me that we accept things that fall and the result of sin in the concerned people to quit accepting change. The first step in that process is to live our convictions in spite of progressive, and any other terms against us. The family is under assault, we must stand firm, and become less accepting.

## Christmas

From Page 1  
"Food Processor" — tips and recipes for preparing quick and easy holiday meals — presented by Joy Parnell of Western Public Service. Lubbock 7:30 p.m.  
"Wrap-sody" — ideas for wrapping gifts creatively and inexpensively. Presented by Marilyn Tate, Floyd County Extension Agent at 3:30 p.m.  
"Time for the Holidays" — tips on

Ask the Land about money to improve your land. Farmers today are looking to increase their productivity. Whatever way you choose, the Federal Land Bank can provide credit to help. So when you're looking for a specialist at your Land Bank.

On exhibit in our lobby

# PAINTINGS

by

## Carolyn Whittington Lockney

"Helping you change things for the better"

# THE FIRST NATIONAL BANK OF FLOYDADA

Member F.D.I.C. Accounts Insured up to \$100,000

# BEEF SALE

## Milk Fed BABY BEEF SALE

Cut, Wrapped & Quick Frozen

Half Beef only	\$1 <sup>19</sup> lb	Hindquarter	
Forequarter only	\$1 <sup>09</sup> lb	only	\$1 <sup>39</sup> lb

## HEAVY GRAIN FED BEEF

Half Beef		only	\$1 <sup>39</sup> lb
Cut, Wrapped & Quick Frozen			

Call Keeters for Custom Slaughtering & Processing  
Kill Days Tuesday & Thursday

## MARKET MEAT SPECIALS

Nice-n-Lean HAMBURGER lb	\$1 <sup>29</sup>	Chuck ROAST lb	\$1 <sup>39</sup>
Arm ROAST lb	\$1 <sup>59</sup>	Club STEAKS lb	\$1 <sup>98</sup>

Our Shurfine Sale  
Will Continue through Saturday, November 7th

6-12 oz. cans	99¢	5 lb Bag Shurfine SUGAR	\$1 <sup>39</sup>
3 lb can Shurfine		1 lb Can Shurfine	\$1 <sup>39</sup>
SHORTENING	\$1 <sup>59</sup>	COFFEE	
3 lbs.		10 lb Bag	\$1 <sup>39</sup>
BANANAS	\$1 <sup>00</sup>	POTATOES	

# KEETERS GROCERY

7:30 a.m. - 7:30 p.m. 652-2191

We Redeem Food Stamps & WIC Cards  
We Reserve The Right To Limit Quantities

Compared \$226 per year heat pump comparing other heating systems. At Enermost for you with good con

## Rev. Michael O'Connor's Perspectives

BY MICHAEL O'CONNOR

"The American Family is under attack," the conservatives cry. "Pish," the liberals reply. Who is right? Judging from the reports being released on the Census, it would seem that the conservatives are right. Statistics were released last week which are appropriate for making a point. First, it was reported that the number of couples living together is significantly from 1970. By the way, the government, in its infinite wisdom, has solved the dilemma of what to call these people. They are "opposite-sex persons of opposite sex sharing living quarters. And to think, we call it living in sin.

Another number of note is that the number of children born out of wedlock is also up. The reason cited in both the AP articles reporting the statistics is basically that both phenomena are "more acceptable."

Things are more acceptable these days. Used to be that no one would put his folks in a rest home; we didn't even say the word "retard" and "ma'am", and never used their first name: kids tended to call their parents "Dad" and "Mom."

Some of these changes are valid - rest homes provide care that sometimes cannot, and travel and economics have forced people to look out in search of a job. But the fact remains that families are not the same as they were even fifty years ago.

It seems to me that we accept things too easily. I suppose that trait is part of the result of sin in the world. The time has arrived, however, when we need to quit accepting the situation and begin trying to change it. The first step in that process is to quit saying, "Well, that's the way it is, and we'll just have to live with it."

The next step will be to examine changes that come to us as progress and determine whether the change reflects proper biblical values. Finally, we will live our convictions in spite of charges of being old fogies, retrogressive, and any other term of disparagement which might be directed against us.

As the family is under assault, we must recognize that we are part of the assault, and become less accepting. Then we shall see a renaissance of the family.

## Christmas In November" set

From Page 1

"Processor" — tips and recipes for making quick and easy holiday gifts presented by Joy Parnell of the Public Service, Lubbock.

"Wrap-sody" — ideas for wrapping gifts creatively and inexpensively. Marilyn Tate, Floyd County Extension Agent at 3:30 p.m.

"Lunch for the Holidays" — tips on

making the most of every minute during the busy holiday season, presented by Lynda Fogerson, Briscoe County Extension Agent at 4:30 p.m.

"Decorating for Christmas" — creative ideas for beautiful home decorating during the holiday season, presented by Laura Jacobs, Parmer County Extension Agent at 5:30 p.m.

Lunch will be served by the Floyd County Extension Homemakers Council.



THE LOCKNEY LONGHORN BAND won a rating of II in the Regional Band Contest held at Jones Stadium in Lubbock. Seventeen bands competed with only three receiving a rating of I.

## Farm production costs to rise

The cost of producing 11 major U.S. crops (excluding land costs) is projected to rise about 15.4 percent per acre in 1981, the same as the estimated rise in 1980, the department states.

In a summary of a report on the cost of producing selected crops in the United States, the agency said it will cost an average of \$2.38 per bushel to grow corn in 1981, excluding land costs, compared to an estimated \$2.36 in 1980. Wheat will cost \$4.13 per bushel to produce, excluding land, compared to

an estimate of \$3.62 in 1980, it said. USDA forecast soybeans will cost \$4.97 per bushel to raise in 1981, a slight decrease from an estimated \$5.02 in 1980.

Sorghum production costs will also fall slightly to \$2.87 per bushel, excluding land, compared to \$3.19 in 1980.

The report said that per bushel costs for more crops rose sharply in 1980, as there was less production over which to spread costs, due to drought conditions.

During 1980, USDA said per unit nonland costs rose by an average of more than 40 percent for all crops.

ranging from 30 percent for oats to 89 percent for peanuts, USDA said.

USDA said per acre costs, however, were little affected by the drought, rising about 15.4 percent in 1980.

The report said the increases were due to a 38 percent fuel price increase, a 28 percent fertilizer cost increase and a 20 percent interest rate cost increase.

Following are the USDA estimates of 1980 and 1981 production costs, in dollars, given first excluding land costs, then including land costs. Costs per unit are in bushels, except rice and sunflowers in hundredweights and peanuts and cotton in pounds.

COMMODITY	COST PER ACRE		COST PER UNIT	
	1980	1981	1980	1981
Corn	213.54	246.12	2.36	2.38
Wheat	277.83	320.43	3.07	3.11
Soybean	108.13	123.52	3.62	4.13
Sorghum	144.12	159.20	4.82	5.32
Cotton	131.47	149.71	5.02	4.97
Rice	192.05	223.01	7.33	7.41
Barley	138.31	159.35	3.19	2.87
Oats	177.04	201.28	4.07	3.62
Peanuts	349.03	405.86	.954	.898
Sunflower	395.28	455.51	1.080	1.007
Rice	384.76	444.06	8.92	9.94
Soybean	449.41	514.43	10.42	11.51
Wheat	106.63	122.61	11.20	9.34
Sorghum	135.37	153.61	14.22	11.70
Corn	460.24	546.49	.307	.213
Peanuts	568.12	656.13	.3798	.255
Barley	129.09	147.71	3.00	3.19
Oats	165.94	184.56	3.84	3.98
Wheat	99.02	113.00	2.17	2.19
Soybean	136.80	151.46	3.00	2.94

## Lady Horn's

Continued From Page 1

which went on to become AAA state champions.

There were seven seniors last year, all of whom graduated, leaving the first year head coach with a young and inexperienced squad. "We have only two girls on the squad with any varsity experience. They are Connie Coffman, a Junior Forward and two-year letterman with an 18 point average last year, and Sophomore Point Guard Shawnda Brock, a one year letterman.

Over all the squad contains one senior, Patricia Torrez, Forward; five juniors, Irene Medina, Forward; Robin Hardy, Point Guard; Karen Mathis, Post; Connie Coffman, Forward; and Kay Reay, Forward; and four sophomores, Shawnda Brock, Point Guard; Karyn Foster, Forward; Kim Carthel, Post and Jerri Ann McCormick, Post. The squad's average height is 5 feet 7 inches.

The season begins for the Lady Horns when they meet Lubbock Cooper on November 17 and District 3-AAA play begins January 15 when they meet the Abernathy Lady 'Lopes.

## Shop Floyd County

### For Christmas

#### LOCKNEY BEACON

[USPS 317-220]  
Published weekly each Thursday by Floyd County Publishing Co., 220 South Main St., Lockney, Texas 79241. Second class postage paid at Lockney, Texas. Subscription rates: local \$11.50 per year, out of trade area \$12.50 per year. POSTMASTER: send address changes to the Lockney Beacon, P.O. Box 187, Lockney, Texas 79241.

Shelly Harris Publisher  
Bill Sayers Managing Editor  
Tom Burns Advertising Manager

The Publisher is not responsible for copy omission, typographical errors, or any unintentional error that may occur other than to make corrections after being brought to attention. Advertising accepted on this basis only.

planned and is Gross, Floydada; and Juanita Broesch, Lubbock. The dolls, made by Juanita Broesch, will be at the Christmas bazaar.

Spann named past emeritus in Oklahoma

Clyde B. Spann, who pastored the Calvary Baptist Church, Floydada, 1957-59, was honored Sunday, October 25, by being made pastor emeritus of the First Baptist in Thackerville, Oklahoma where he has served as pastor twelve years. Steve Montalvo is now pastor.

Spann completed the B.A. degree at Wayland Baptist College 1959, the M.R.E. at Southwestern Baptist Theological Seminary, M. Ed. at Southern State University.

Mr. Spann has been a Southern Baptist for twenty years and evangelized years he taught English and psychology. He was English teacher at Cooke County College and at 1102 Asperado, Lubbock, Texas.

# SALE

## QUICK FROZEN BEEF SALE

Hindquarter only \$1.39 lb

## QUICK FROZEN BEEF

Quick Frozen only \$1.29 lb

or Custom Slaughtering & Processing  
Days Tuesday & Thursday

## MARKET MEAT SPECIALS

Chuck ROAST lb \$1.39

Club STEAKS lb \$1.98

Shurfine Sale through Saturday, November 7th

5 lb Bag Shurfine SUGAR \$1.15

1 lb Can Shurfine COFFEE \$1.69

10 lb Bag POTATOES \$1.29

# WALSH'S GROCERY

652-2191

Postage & WIC Cards  
Right To Limit Quantities

Ask the Land Bank about... money to buy land or improve your farm.

Farmers today are looking at ways to increase their production... buying or improving land... building or remodeling facilities.

Whatever way you choose to grow, the Federal Land Bank can provide long term credit to help.

So when you're looking to buy or build, stop in and talk to the long term farm credit specialists at your Land Bank Association.



105 South Wall  
983-2480

The Land Bank Association

# ENERGAS

## Gas heating saves \$226 per year!

Compared to the heat pump, gas heating can save you \$226 per year on your utility bills. So if you hear that a heat pump is "more economical", remember, that is comparing it to other electric heating... not to gas! No other heating system even comes close to gas for economy. At Energas, we are committed to help you get the most for your heating dollar. Gas heating, combined with good conservation practices, saves energy, too.

**ENERGAS**  
Efficient Gas Energy for West Texas

# Do you need...

A fast way to pay your bills?  
A safe way to carry your money?  
A permanent record for tax purposes?  
A better control on your budget and expenses?

Everyone needs a checking account at the friendly

# First National Bank in Lockney

MEMBER F.D.I.C. Look for this symbol. We've got the answers.

Accounts insured up to \$100,000.

Floyd County's Progressive Bank  
652-6355

# Society Features

## Floydada Nursing Home Happenings

**BY DOROTHY NEFF**  
Mrs. Willie Mae Russell is home from the hospital and doing fine.  
Mrs. Ella Finley is still in the hospital. I visited with Mrs. Finley Wednesday and she was in good spirits and ready to come home.  
We would like to thank Stewart and Sharon Smith for the bell peppers and to-

matoes. The residents have enjoyed the tomatoes sliced and stuffed peppers this week.  
We want to thank the Sunshine Sunday School class for the bananas, and cookies. Mrs. Ruth Duncan visited with the residents as we gave each a banana. The cookies were given to each resident Friday during the

movie.  
The residents who ride the Senior Citizens bus and myself would like to wish Grady Freeman a quick recovery. We really miss taking that outing each Wednesday.  
We didn't have a big winner in bingo this week, however, Mrs. Vera Duke won two games. Mrs. Una Clark,

Geneda Roberts, Olie Miranda, Emmitt Lawrence, A.G. Eubanks and Mr. W.C. Cates all won one game each.  
I would like to thank the nurses aids for decorating the home for Halloween and giving a party for the residents Halloween night. Everyone enjoyed the little spooks. Employees were dressed in their costumes and served pumpkin pie to the residents.  
We want to thank Bama Coward and her G.A. girls of the First Baptist Church for treating of residents with candy Thursday afternoon. The twelve girls came in Halloween costumes and visited with the residents as they treated them.  
We want to thank Mrs. Ham Smith for the pink and red geranium plants and Worth Howard for the pots to put them in. They look so nice in our lobby.  
We have a new resident in our home, Mrs. Florence Simpson, lives in room six, down the west wing. Mrs. Simpson will need your visits.

## Greetings From Friends

To Helen and R.G. Dunlap, who on Wed., Oct. 28 became members of the worldwide "Grandparents Club."  
Sometimes this club is known as the "spoilers" because of the tendency to let grandchildren do as they please.  
Just give this little fellow a bit of your time  
And he will repay you by

making your lives sublime  
You can teach him to wink  
and to clap his hands  
You will feel great pride,  
when on two feet he stands  
Helen will love him dearly,  
he'll do her good.  
She'll quickly adapt to grand-motherhood.  
She'll warn his bottle, he'll be a great feaster  
She can tell him all about her girlhood in Peaster.

R.G. will encourage him, to rub his bald head  
And he'll whistle a tune as he puts him to bed  
He'll start early in his life to explain soil conservation  
Of what soybeans and farm products mean to our nation  
They have waited so for this dream to come true  
We join you in thanking the Good Lord for Roger Mathew.

## Alpha Mu Delta enjoy social

Members of Alpha Sigma Upsilon Chapter of Beta Sigma Phi and their families enjoyed a Halloween social Saturday, October 31 at Lighthouse Electric.  
Costume judging was held and Chip Daniel won best boys costume for his scarecrow. Shonda Guthrie won the girls contest as an elf. Chad Guthrie won the dunk-

in' for apples for not getting one. Cody Nichols won the pin the nose on the witch game.  
Big and little spooks alike enjoyed refreshments of cola, popcorn balls, cookies, celery and carrot sticks, crackers, dip, sausage balls and beef stick.  
Those attending were Danny and Lynn Daniel, Ronnie,

Chip, Hollie and Ashely, Weldon and Mary Emert, Brad and Carrie, Max and Vikki Yeary, Charla and Mandy and O. Bryan Barker, Bud and Barbara Edwards, Rusty and Tyson, Larry and Rhonda Guthrie, Shonda and Chad, Jan Nichols and Cody, Jimmy and June McLaugh, and Wayne and Janice Poette.

## Studio South honors students

Open house was held last Sunday afternoon in the Studio and home of Sara and Don Probasco, 129 E. Ollie St., for students of Studio South's recently completed Beginner's Stained Glass

classes.  
It was a time of sharing between members of the three classes. Each guest brought some of their completed work to show to the others. Although this event

marked the end of the Beginner's classes, many of the students have enrolled in classes for more advanced instruction in "Leaded Glass Design" and in "Free-form Ornament Construction."  
Those attending were: Mildred Shurbet of Petersburg; Betty Edwards of McCoy; Carol and Don Williamson of Abernathy; Dartha and Paul Westbrook, Nancy Graham, Peggy Colston, Sharron Vickers, Joy and Dale Lawson, and Jana Lawson, all of Floydada. Five class members were unable to attend.

## Brewer honored with shower

Mrs. Terry Brewer, nee Susie Probasco, was guest of honor at a shower given to her in the home of Mrs. J.M. Ratliff on October 24.

Among guests were Mrs. Vera Rogers and Mrs. Velma Hammond, grandmothers of the couple and Oddie Probasco, mother of the honoree, and Mrs. Dowell Brewer, the groom's mother.  
Cassie Probasco, sister of the bride, registered arriving guests.  
Refreshments were served by Mrs. A.M. Hanks, Peggy Nance, and Barbara Ellison, from a party table covered in blue and over-laid with an ecru lace cloth and centered by a blue silk floral arrange-

ment. Silver and crystal appointments complimented the setting.  
Paula Edwards and Diane Brewer presided in the gift room.  
A vacuum cleaner was presented to Mrs. Brewer by hostesses, Mrs. J.M. Ratliff, Mrs. Judy Griffith, June Bybee, Peggy Nance, Dorothy Thomas, Viki Green, Mrs. June Hanks, Paula Edwards, Barbara Ellison, Nina Teuton, Marvis Reecer, Peggy Roberts, Margaret Kitchens, Georgia Galloway, Eddie Douglas, Dorothy Stapp, Delinda Glasson, Doyleene Dipprey and LaDora Auliff.

"A man should keep his friendship in constant repair."  
Samuel Johnson

When you decide to lose weight, call Diet Center!

NO SHOTS • NO DRUGS  
NO CONTRACTS  
983-2224

HOW TO WIN AT THE LOSING GAME  
DIET CENTER®

Geneva Giesecke  
983-5708  
Ralls Highway

**Gibson APPLIANCES**

Optional Automatic Icemaster  
Model RT17F9

**Frost\*Clear KIRK & SONS**  
NORTH SIDE SQUARE  
FLOYDADA 983-3280

**THEY LAST**

## Oct. meetings held by Alpha Mu

The first regular meeting of the month was held by Texas Alpha Mu Delta on October 6, at 7:00 p.m. at the home of Sharron Fulton, with all members repeating the Opening Ritual.

Recording secretary, Barbara Anderson, called the roll and read the minutes from the previous meeting.

Janice McCandless read the chapter correspondence. Treasurer Tonya Marble then gave the financial report.

Social chairman, Janice McCandless, reminded everyone of a Halloween masquerade party to be held October 31 at the home of Bill and Sharron Fulton.

Ways & Means chairman, Tonya Marble, reported that they would be making Christmas ornaments to sell at the Christmas in November Bazaar to be held at Duncan Elementary on November 16.

The business meeting was adjourned at this time.

The program was given by Tonya Marble on "Child Rearing." Group discussion followed. Hostesses for this meeting were Barbara Anderson and Sharron Fulton.

At this time Barbara Anderson presented the Chapter with a box of candy announcing her pregnancy.

All members repeated the Closing Ritual.

The second regular meeting of Texas Alpha Mu Delta was held October 20th, at 7:00 p.m. at the home of member Sherry Smith.

Pledges Barbara Anderson, Holly Hendrix, LaNell McCandless, Mitzi Nixon, Wendy Pierce and Tana Probasco participated in the Ritual of Jewels ceremony.

After the Ritual of Jewels ceremony, recording secretary, Barbara Anderson, called the roll and read the minutes from the October 6 meeting for approval.

Treasurer Tonya Marble then gave the financial report.

Barbara Anderson then read the minutes from the Executive Board meeting which was held October 13 at the Farm Bureau office. Officer's present at this meeting were Sharron Fulton, Donna Anderson, Tonya Marble, and Barbara Anderson. Several topics were discussed at this meeting.

Service chairman Duffy Hinkle reported that she had contacted the Children's Welfare Service here and they informed her they were always in need of donations and clothing especially

around Christmas time.

Tana Probasco reminded everyone of a Spook-house to be held October 30 at 5:00 p.m. for our children and their friends. The spook-house will be in the studio behind the home of member Janice McCandless.

Yearbook chairman Donna Anderson passed out the new yearbooks to all members at this time.

The business meeting was adjourned.

Member Mitzi Nixon intro-

New Christmas  
★ Hand Braided Nylon Beads only \$20  
One size fits all - 1" wide, super good of colors to choose  
THE LO...  
517 East Houston

## Appreciation dinner given by Rebekahs

An appreciation dinner was given for several guests at Floydada Rebekah lodge on Tuesday night, October 27.

After lodge closed the guests were invited in for a bountiful dinner of fried chicken and all the trimmings.

The hall was decorated in a Halloween motif and the

tables were decorated with Halloween lanterns.

After the meal, Halloween games were played by the group.

The invited guests were Mr. John Farris, Bob Gilliland and boys, Michael, and Brandon, Mrs. Ruth Gilliland and Fay Hart.

Everyone enjoyed the evening festivities.

In order to reduce our jewelry inventory we are offering exceptional values on items perfect for Christmas, anniversary or birthday gifts.



Wedding bands

- Ladies two-toned Reg. \$198<sup>00</sup>
- Ladies white gold Reg. \$85<sup>00</sup>
- Ladies yellow gold Reg. \$155<sup>00</sup>
- Gents yellow gold Reg. \$215<sup>00</sup>
- Gents yellow gold Reg. \$175<sup>00</sup>
- Gents yellow gold Reg. \$130<sup>00</sup>



Matching wedding bands

Buy the gents band - ladies band free.

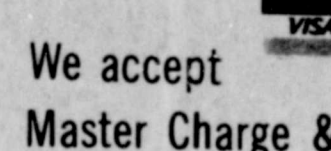

Bridal sets

Buy the diamond engagement ring - wedding band free.



Gents diamond rings

- 5 diamond Reg. \$800<sup>00</sup>
- 3 diamond Reg. \$700<sup>00</sup>
- 1 diamond Reg. \$475<sup>00</sup>

Ladies dinner rings

- 28 diamond round cluster Reg. \$1265<sup>00</sup>
- 19 diamond tear drop Reg. \$1037<sup>00</sup>
- 25 diamond oval Reg. \$750<sup>00</sup>
- White gold emerald & opal Reg. \$125<sup>00</sup>
- Yellow gold diamond & ruby butterfly Reg. \$342<sup>00</sup>

Other diamond items.

Ladies, gents & boys, birthstone rings 1/2 price.  
Earrings values from \$8.00 to \$30.00 - \$5.00 and \$15.00.

**SCHACHT'S**  
Flowers, Jewelry & Gifts  
"Our Pleasure Is To Serve You"  
112 W. Poplar Lockney

## Today

by M...  
County  
diners...  
quite exp...  
make you...  
The al...  
trays can...  
most gro...  
you have...  
TV dinner...  
duty alum...  
try into...  
sure to la...  
Freeze it...  
Homem...  
should be...  
degrees...  
The leng...  
depend on...  
a casserol...  
how much...  
your wallet?...  
recent poll, a...  
number of women...  
But to make...  
money, be...  
all your finan...  
not only what's...  
to time, every...  
single...  
financial inven...  
through what...  
what to keep...  
and what to...  
completely. That...  
plans can be...  
to get your...  
in focus...  
present...  
back your bank...  
money jargon...  
cash posi...  
upon cir...  
should have...  
months worth...  
investment that...  
degree of safety...  
turned quickly...  
as a savings...  
low-risk mutual...  
your insurance...  
for today's...  
about other...  
you know the...  
of your house?...  
investments -...  
common stocks or...  
You can find...  
re worth by...  
newspaper's fi...  
What's the...  
car, jewelry...  
Also, investi...  
values of...  
and pen...  
together a per...  
statement...  
as a busi...  
on one...  
ood, ordinary...  
Don't for...  
payments...  
and bills, trans...  
and entertain...  
Many people put...  
in their bud...  
ments, insur...  
s. They con...  
ems to be...  
to be paid...  
ber bills...  
side, list your...  
Don't over...  
dividends...  
from all family...  
financial obliga...  
family circum...  
also be re...  
factors will...  
and future...  
gram...  
stock of your...  
ory, you'll be...  
fine financial...  
wiser invest...  
- and get...  
work for you!...  
mutual fund...  
or financial...  
sugget invest...  
into your...  
...  
OWN!  
that you pur...  
grocery store...  
a blessing on...  
when your fam...  
all seem to be...  
different times...  
these purchased...  
They w...  
100-150...  
mile radi...  
about nine...  
modules...  
The Ces...  
meeting...  
Chuck Wilso...  
Wilson

repeated the around Christmas time. Tana Probasco reminded everyone of a Spook-house to be held October 30 at 5:00 p.m. for our children and their friends. The spook-house will be in the studio behind the home of member Janice McCandless.

Yearbook chairman Donna Anderson passed out the new yearbooks to all members at this time.

The business meeting was adjourned.

Member Mitzi Nixon introduced Sara Probasco as a guest speaker for the program. Mrs. Probasco presented several pieces which were very interesting and showed several photos which were taken during the year.

Hostesses for the evening were Tana Probasco, Tana Frod, and Tana Frod. They were joined by several other members.

All members were invited to the Closing Ritual.

of Jewels being secreted, called read the October 6

Marble financial re-son then from the meeting October 13 at Office. Office meeting on, Donna Marble, Mrs. Sevcerson. Sevcerson at an Duffy she had children's here and they were donations specially

**New Christmas items**

**★ Hand Braided Nylon Belts**

only \$20<sup>00</sup>

One size fits all - 1" wide

1 1/2" wide, super good selection of colors to choose from.

**THE LOFT**

517 East Houston

jewelry inventory we are offering items perfect for Christmas, party or birthday gifts.

Red Reg. \$198 <sup>50</sup>	Sale \$100.00
Gold Reg. \$85 <sup>00</sup>	42.50
Gold Reg. \$155 <sup>00</sup>	77.50
Gold Reg. \$215 <sup>00</sup>	140.00
Gold Reg. \$175 <sup>00</sup>	87.50
Gold Reg. \$130 <sup>00</sup>	65.00

adding bands

as band - ladies band free.

**Bridal sets**

Buy the diamond engagement ring - wedding band free.

\$1265 <sup>00</sup>	Sale \$759.30
\$37 <sup>00</sup>	622.20
	450.00
\$125 <sup>00</sup>	75.00
Butterfly Reg. \$342 <sup>50</sup>	205.50

the rings 1/2 price.

0 - \$5.00 and \$15.00.

**WACHT'S**

Jewelry & Gifts

Is To Serve You"

Lockney

**Today's Lifestyles**  
by Marilyn Tate  
County Extension Agent

**FINANCIAL**

how much in your wallet? To a recent poll, a number of women the right answer—\$1.00. But to make of your money, be with all your finan—not only what's one to time, every married or single, a financial inven- through what she ter what to keep, ter and what to completely. That does plans can be

how to get your picture in focus. Analyzing present Check your bank in money jargon, your "cash posi- depending upon cir- you should have months worth of an investment that a degree of safety earned quickly such as a savings low-risk mutual ew your insurance. quate for today's

what about other you know the of your house? investments common stocks and ds? You can find they're worth by newspaper's fi- tion. What's the our car, jewelry, are? Also, invest- ment values of policies and pen-

together a per-sonal statement. yourself as a busi- expenses on one food, ordinary items. Don't for- loan payments, count bills, trans- and entertainment Many people put in their budget vestments, insur- savings. They con- these items to be also - to be paid other bills.

other side, list your ces. Don't over- ment dividends from all family

financial obliga- family circum- should also be re- these factors will assets and future program.

ing stock of your inventory, you'll be to define financial make wiser invest- and get sts to work for you! ber, mutual fund ve or financial suggest invest- fit into your ture.

ERS? OUR OWN! bers that you pur- the grocery store be a blessing on when your fam- all seem to be different times, es these purchased

dinners are disappointing in terms of taste and some are quite expensive! Solution — make your own.

The aluminum TV dinner trays can be purchased in most grocery stores. When you have leftovers, fix up a TV dinner. Cover with heavy duty aluminum foil or slip the tray into a freezer bag. Be sure to label your dinner. Freeze it for future use.

Homemade TV dinners should be reheated at 350 degrees until the food is hot. The length to heat will depend on what you have — a casserole will take longer than fried chicken.

Some foods are not suitable for reheating in a home-made TV dinner. Broccoli that is completely cooked is a good example. Cabbage and other leafy greens will develop stronger flavors. Usually, corn on the cob will become hard if fully cooked and frozen. Do not try to freeze tossed salad. You can make a fresh one while your home-made TV dinner is cooking.

Breads freeze well. It is better to package biscuits, rolls, muffins and other quick breads separately. Sprinkle the bread lightly with water and wrap tightly in aluminum foil. Reheat at 350 degrees and serve.

Make your own entrees. Small aluminum pans can be purchased. When you have one or two servings of your main dish left — freeze it. You will find it is a real time saver when you need a quick meal for your husband while you go to a meeting or for the children when you enjoy a night on the town.

Home-made TV dinners or frozen entrees usually taste better and are liked better because "Mama made it!"

**Congratulations Lockneyites**

**Happy Birthday**

Nov. 5 — David Mojica Jr., Miguel A. Guerrero, Cosme Gonzales Sr., Ewald Quebe

Nov. 6 — Edythe Clark, Freda Davis, Barbara Carthel, Michelle Gomez, Vincent Villalon Jr.

Nov. 7 — Jean Sparkman, Mrs. David (Pat) Frizzell, Judy Mangum, Cecil Jones, Brent Cook, Earl Hill

Nov. 8 — Amy Gonzales, Opal Blount, Eustolia Gonzales, Dena Casey, Randy Reecer, Linda Cunyus, Edith Patterson, Felix Villarreal, Octavio Trevino, Jim Pinner, Santos Gonzales

Nov. 9 — Breck Record, Mary Lou Gonzales, Estefana Gatica, Ramon Martinez

Nov. 11 — Adam Rodriguez, Jennifer Pierce, Lane Turner, Tobi Ann Carthel, Pam McMahan, Cleatis Hayes, Oscar Palomin Jr., Tom-

**Willis hosts Homebuilders**

The Homebuilder's Extension Club met October 27 in the Kenneth Willis home.

The meeting was opened with Mrs. Willis reading the devotional, Isaiah 3:18-23.

Blanche Williams gave the program "Energize Your Wardrobe." Some suggestions for keeping comfortable in the winter were to wear dark colors, and wear sweaters, full length slips, pant liners, high necklines, close fitting hats or caps, gloves, and shoes with enclosed heel and toe.

For summer weather, wear light colors, loose fitting garments, short sleeves, and sandals.

A refreshment plate with the Halloween theme was served to one new member, Doris Tinsley, and Lela Mae Burns, Eunice Hong, Evelyn Latta, Muri Mayfield, Ruth Trapp, Blanche Williams, Wilma Colston, Gladys Widenner, and the hostess Barbara Willis.

**Bradley elected to board**

Floyd C. Bradley, pastor of First Baptist Church in Floydada, was elected to the Executive Board of the Baptist General Convention of Texas (BGCT) during the BGCT annual meeting in Waco October 27-29.

The Executive Board, composed of laymen and ordained church leaders, conducts the business of the 2.2 million-member BGCT between annual sessions.

The BGCT owns and operates eight colleges and universities, an academy, eight hospitals and four children's homes.

This work is supported by the Convention's 4,400 churches and missions, which will give more than \$45.4 million this year through the Cooperative Program to help share Christ's love throughout the world.

Besides the institutions, the Convention helps support the work of more than 5,000 missionaries in the United States and almost 100 foreign countries.

**Harmony Comm. wants to strip cotton**

The men in the Harmony Community are looking for cotton to strip as a money making project for the Center.

If you have cotton ready to strip, or know someone that does, please contact Ronnie Hopper 983-3004, James Hale 983-3840, Jerry Bartlett 983-2053 or Phil Dunavant 983-3650.

They would like to have 100-150 acres within a 15 mile radius. They will have about nine strippers and four modules ready to go.

The Center has its regular meeting and elected officers for the coming year. Everett Miller was elected president, Phil Dunavant, vice-president, Martha Williams, Secretary, and Novice Bartlett, reporter. Elmer Dean Williams was elected to serve as a trustee.

**FOR SPECIAL CHRISTMAS GIFTING**

Call today for your appointment

Mr. and Mrs. Glen Kinard, Sandhill

Chuck Wilson, M. Photog., CPP

**Wilson Photography**

652-3731



**Lakeview News**

**Oil searching continues at Lakeview**

BY JOYCE WILLIAMS

Seven geo-science trucks were thumping along the edge of Blanco Canyon this week next to land belonging to Edmund Brown, Norman Muncy, Judge Choise Smith and Q.D. Williams. A former Lakeview resident, now in the oil business, said a look at our oil company's map showed proposed drill sites solid from Blanco Canyon to South Plains for Floyd County. Most leases in this community will expire in early 1982.

Holt Bishop supplied the fish for a big fry Saturday at the home of his son, Mr. and Mrs. Howard Bishop. His daughter, Shirley, and husband, Jim Peggram of Dimmitt and their daughter, Kimberly, were also guests. Kimberly's roommate from Wayland University was present. Other diners included Miss Roseanne Ford, Mike Bishop and Greg Bishop.

Mrs. Lucille Custer attended a formal dinner and reunion at Slaton last weekend at the home of her mother-in-law, Mrs. J.C. Custer.

Mrs. Q.D. Williams was in Lawton, Oklahoma for the weekend with her sons, James and Monte, and their families. All enjoyed a steak barbecue supper at Mr. and Mrs. James Williams Saturday night, honoring Monte on his twenty-fourth birthday. Mr. and Mrs. Monte Williams had them all over to their house after church for Sunday dinner. She also visited her father, Edgar Jones, in Truscott before returning to Floydada.

Mr. and Mrs. Wayne Ap-

pling visited Mr. and Mrs. Olin Watson Thursday evening.

Mrs. Viola Brown ate lunch Tuesday in Floydada with Mr. and Mrs. A.M. Dorsey.

Mr. and Mrs. Weldon Hammonds visited in Vernon last Friday and Saturday with her sister, Mrs. George Davis. They also visited in Thalia and Crowell with Mr. and Mrs. Meryl Moore, Mr. and Mrs. Robert Hamonds, and Mr. and Mrs. Bobby Hammonds.

Mr. and Mrs. Bill Gofford and Otis Gofford visited the men's sister, Mrs. Weldon Hammonds last week.

The Mt. Blanco Club met with Mrs. S.G. Appling last Thursday for Achievement Day. All reported home improvements, food preserved by canning or freezing, sewing and handwork accomplished during the year. Those present included Mesdames Viola Brown, Glenna Watson, Iva McCurdy, Gladys Wheeler, Jane Latta and children, Georgia Mae Erickson, Donna Fields, and baby and the hostess. Refreshments were pumpkin pie and whipped cream, popcorn, pickles, coffee and tea.

Mrs. Howard Bishop accompanied her sister, Mrs. Flourine Teal and their father, Sid Brown, to Plainview Saturday afternoon.

Mrs. Norman Muncy was hostess for a shower planning party Thursday afternoon. Among those present were Mesdames Dee Adams, Harold Bertrand, Odell Breed, Smoky Quilantan, Oscar Santos and Q.D. Williams from Lakeview.

**Happy Anniversary**

Nov. 5 — Charlanne and Garry Burson, Octavio and Esther Trevino, Doyle and Doris Poole, Mr. and Mrs. Shorty Hartman

Nov. 6 — Ewald and Cathy Villarreal, Felix and Anna Dell Quebe

Nov. 11 — Mr. and Mrs. Ben Molina, Mr. and Mrs. Roy Nolan

**Bridal selections for Rozanne Ford bride-elect of Mike Bishop**

**Sue's Gift Shop & Accessories**

126 W. Calif. Floydada

983-5312

**Start a Chain Reaction with Speidel 14 Kt. Gold Overlay.**

**30% Off**

**LOVELL-COLLINS JEWELRY**

806/983-3240 102 S. MAIN FLOYDADA, TEXAS 79235

**HALE'S DEPARTMENT STORE**

**GIN WHISTLE SALE**

Sale Values Thursday, November 5th through Monday, November 9th

**Misses & Junior Long & Pant COATS 20% off**

**Girls COATS Toddler-4x-7-14 20% off**

**Entire Stock Womens Hi-Heel DRESS SHOES 20% off**

Naturalizer, Socialites, Connies, Gigi. Breezy, Red Cross and Others LOTS OF COLORS Reg. \$19.98 - \$43.98

**Mens & Boys Denim Jeans**

Levi Shrink to Fit & Saddleman Reg. \$18.98 NOW \$16.99

Mens Wrangler Boot Flare & Cowboy Cut Reg. \$18.98 NOW \$16.99

Student Cowboy Cut & No-Fault Flare Reg. \$17.00 & 18.00 NOW \$13.99

Boys Perma Press Wranglers Reg. \$11.00 NOW \$8.99

Boys Wrangler No Fault Flares Reg. \$14.00 NOW \$10.99

Mens Sedgfield Boot Flares Reg. \$24.00 NOW \$19.99

Student Sedgfield Boot Flares Reg. \$22.00 NOW \$17.99

Boys Sedgfield Boot Flares Reg. \$18.00 NOW \$14.99

**Fancy Jeans**

Levi Mens Cut Stretch Denim 3 Colors - reg. \$29.50 NOW \$23.99

Sedgfield Uncut Corduroy reg. \$32.00 NOW \$25.50

Levi Uncut Corduroy reg. \$28.00 NOW \$22.50

Young Mens Stretch Denim reg. \$33.00 NOW \$25.99

Young Mens Fancy Stitch Denim reg. \$26.00-28.00 NOW \$21.99

**Saddleman Jeans**

Levi Stretch Denim Saddleman reg. \$23.00 NOW \$18.50

Wrangler or Levi 100% Polyester Stretch Denim Look-3 colors reg. \$21.50 NOW \$16.99

Levi 100% Polyester Stretch Saddleman Jeans reg. \$23.00 NOW \$18.50

**200 Pair of Men's, Women's and Children's BOOTS Now In Stock!**

**Mens Insulated COVERALLS \$5.00 off**

**Mens Unlined Work COVERALLS \$5.00 off**

**All Mens UNDERWEAR Hanes-Munsingwear-Jockey 20% off White & Colors**

**Entire Stock Mens Western Shirts SHIRTS 20% off**



**Start a Chain Reaction with Speidel 14 Kt. Gold Overlay.**

**30% Off**



# Tentative County Redistricting Lines

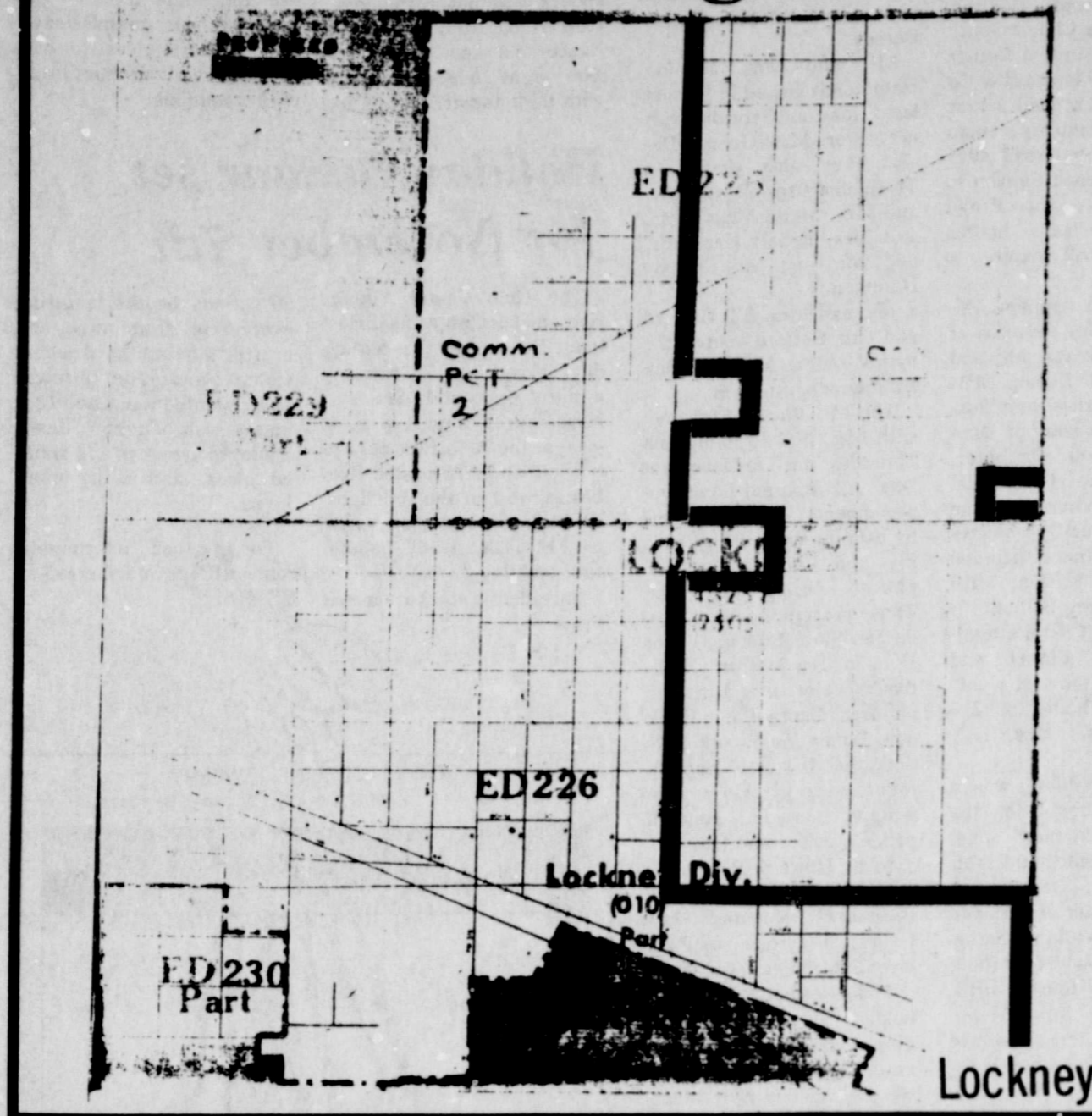

In order for all resident of the county to fully understand the changes and how it will effect them personally, there have been two public hearing scheduled in the county on November 5.

There will be a public hearing in Floydada in the county court room at 5 p.m.

There will be a public hearing that same day, November 5, at the City Hall in Lockney at 6:30 p.m.

The meeting will be conducted by Turnbough and his partner, Bob Bass. Bass is an attorney, formerly Hale

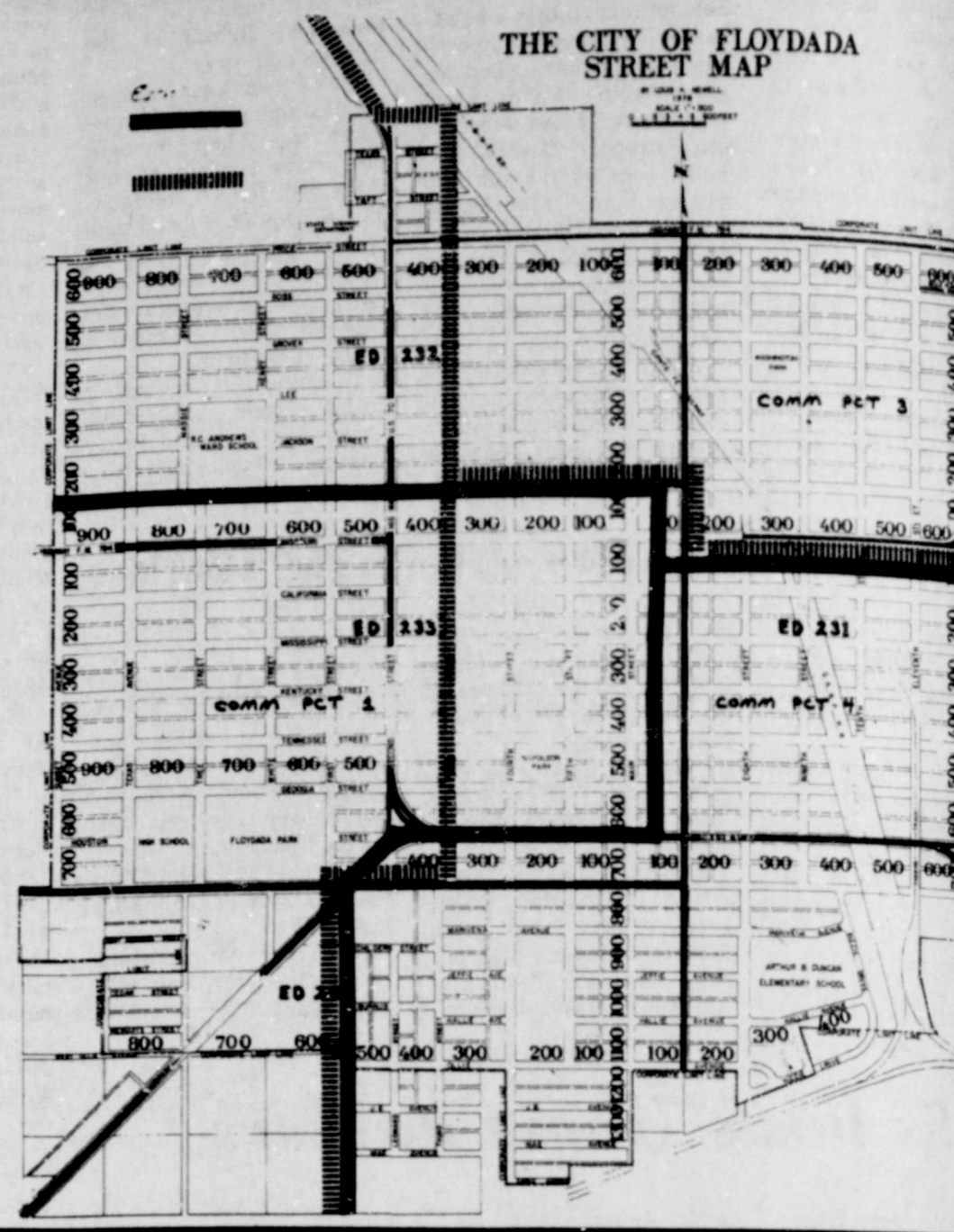

## Illegal immigrants to receive benefits U.S. and welfare programs

States and local communities may soon have to give illegal immigrants all the benefits and welfare programs they give to U.S. citizens, if two cases currently before the Supreme Court are not overturned.

FAIR, the Federation for American Immigration Reform, has entered these cases by filing an amicus curiae (friend of the court) brief supporting the State of Texas in the cases of Plyler vs. Doe and In Re Alien Children, to try to prevent such a conclusion. The cases of Plyler vs. Doe and In Re Alien Children

were brought by lawyers representing children who are illegal aliens. The lawyers contended that illegal aliens were Constitutionally entitled to receive free public education in the United States. The United States Court of Appeals for the Fifth Circuit has upheld their contention, and the State of Texas is appealing to the Supreme Court.

The importance of these cases have not yet been fully understood by much of the public. FAIR argues in its brief that free public education is the wedge which could

open all public services and welfare to illegal immigrants whose very presence in the United States is against the law. It also argues that offering public services such as free education will entice even more people to come illegally to the United States in the future.

The lawyers for the appellees have said that the case involves a narrow issue, that it applies only to education at public expense for illegal immigrants. But in their arguments they claim that illegal are protected under the "equal protection"

clause of the Constitution. This clause has been used to prevent states from excluding some groups of American citizens from social welfare programs unless there is what the Supreme Court has called a "rational basis" for their exclusion.

American minority groups have achieved equal access to education, welfare, health services, public housing, and so on, through the "Equal protection" clause of the Constitution. If illegal immigrants are also covered, they too cannot be denied these programs unless the states have a "rational basis" for such a denial. And the fact that illegals are in the U.S. against the law, that they have no right at all to be here, or that including them in social programs would mean that some American citizens would not be able to receive the programs, would not be considered a "rational basis" for exclusion.

Joseph Zengerle and Marc Rearrdon, FAIR's lawyers, wrote in the brief filed before the Supreme Court: "The dilemma presented by the cases now before this Court is symptomatic of the quandary in which current circumstances place the entire country. No one wishes to deny these claimants an education for their children. But lines must be drawn to secure respect for the law, because otherwise the opportunity for the country to respond effectively to (illegal immigrants) can be critically handicapped at precisely the moment when national lead-fashion policies appropriate to the times.

"These cases thus come to the Court as the President and the Congress are on the brink of devising new federal policies to deal with illegal immigration. A decision that illegal aliens who establish residence in this country are constitutionally entitled to an education at public expense could handicap these efforts for two reasons.

"First, it could increase illegal immigration directly. Migration results from the complex interaction of 'push' and 'pull' factors. If overpopulation and underdevelopment are the 'push,' job opportunities, high wages, and available government benefits are the 'pull.' A guarantee of a free education in the United States for their children would not only be added incentive to millions of parents throughout the world but would also encourage illegal aliens who might otherwise return home after a temporary period of employment to bring their families and settle.

"Second, such a decision could, at the very least, open to legal challenge state and local government efforts to prevent illegal aliens from utilizing various government programs other than education. A likely consequence of such challenges would be...a resultant increase in the utilization of state and locally

provided benefits by illegal aliens already here, at the very time governments at those levels are cutting back in response to taxpayers initiatives and shrinking federal assistance.

"The decisions of the lower courts, if sustained, would validate for the first time the claim of illegal aliens to important public services. It would increase the pull factors which draw illegal aliens to this country and almost surely increase the incidence of their use of government services even if their numbers do not grow. At stake in



ROBERTA HARDIN, Floydada, was the winner of a television set at the October 29 at the TSTA convention in Lubbock. Roberta's ticket to the dinner was the winning number. "This is the biggest thing I've ever won. It was exciting," she said.

expected, McCormick QB quarterback Max Riley coming out with 180 yards and one interception through the air for 183 yards and two touchdowns on the ground to lead the team to a 36-14 victory over the Longhorns.

McCormick's performance was a key factor in the team's success. He completed 12 of 22 passes for 220 yards and two touchdowns. His accuracy and ability to find the open field were crucial in the team's offensive strategy.



The Harmony Extension Homemakers Club will have a booth displaying handmade Christmas gifts at the Extension sponsored Bazaar to be held November 14 at Duncan Elementary School. Doors will open at 9 a.m. A salad luncheon will be served starting at 11:30 a.m.

**Thursday DO BEAN DAYS**  
ALL YOU CAN EAT for only **99¢**

Including RED BEANS and NUSH PUPPIES plus ONION HEARTS & JALAPENO PEPPERS

SERVED THURSDAYS FROM 11:30 A.M. UNTIL WE RUN OUT

at your Dairy Queen

**NO TO-GO ORDERS**

**Happy Birthday**  
**Happy Anniversary**

George Love

Robyn, Luke, Josh.

**Furniture Auction**  
**November 8**  
**Sunday 1:30 P.M.**

**Ray's Furniture**  
**1000 Broadway**  
**Plainview, Texas**

Bedroom suits  
Dining room suits  
Sofas & sleepers  
Mattress sets

Bar stools  
Game tables  
Lamps, odd dressers  
Odd dressers

Lots of items too numerous to list  
Famous Name Brands

Terms of sale cash or approved credit  
Warehouse closeouts & overstocks  
freight damaged

**Travis Butler Auctioneer**

Or Steve  
2251  
Or Night

County Attorney Turnbough...  
Wayland...  
submission...  
statistics...

Longhorns finished the finish...  
Lockney Longhorns...  
stairwart defense...  
Abernathy Ante...  
Friday night but it was...  
defeat at the hands...  
adversaries...  
and outsized by...  
margin both in the...  
backfield, the Horns...  
not overcome the...  
advantage of their...  
losses...  
leaves the Long-...  
with an 0-2 record in...  
play and 2-6 on the...  
with two games re-...  
They probably...  
excellent chance of...  
their first district...  
Friday night as they...  
address, before clos-...  
the season at Idalou...  
Friday.

expected, Rick...  
Abernathy's man-...  
defensive tackle...  
successful all-out as-...  
Lockney quarterback...  
McCormick to the tune...  
totaling minus 79

now 6-2 on the...  
district play...  
at halftime...  
89 and 20...  
Pettit, Riley...  
Moss, respec-...  
Mark Riddell...  
at's following...  
scores.

back in the...  
in the third...  
Junior McDon-...  
leading rush-...  
yards on 10...  
on a 19-yard...  
sprinted in...  
to narrow...  
0-8.

right back to...  
yard dash a...  
half later and...  
Blm Dunn for a...  
on the first play...  
quarter to...  
win.

got its final score...  
would took a punt...  
25 and threaded...  
through a host of...  
to score and Mc-...  
over the conver-

dropped to 2-6...  
and are 0-3 in...  
Abernathy will...  
Floydada Friday in...  
defeated league...  
the district cham-...  
Lockney will at-...  
streak Friday...  
Childress.

First Downs	12
Yards Rushing	3
Yards Passing	122
Total Yards	119
Passes Comp/Att	7-16
Punts-Avg.	6-39.7
Fumbles-Yards	7-52
Fumbles Lost	1
Intercepted By	1

# Longhorn Sports

## Longhorns fight the finish

Lockney Longhorns mounted their stalwart defense against Abernathy Antelope tonight but it was as they went down to defeat at the hands of giant adversaries. Locked and outsized by the margin both in the backfield, the Horns did not overcome the advantage of their legs.

The Longhorns left the game with an 0-2 record in district play and 2-6 on the season with two games remaining. They probably have an excellent chance of winning their first district game Friday night as they close the season at Idalou on Friday.

As expected, Rick Abernathy's manful defensive tackle, successful all-out as Lockney quarterback McCormick to the tune of totalling minus 79

**SCORE BY QUARTERS**

Abernathy	7	13	7	7	34
Lockney	0	0	8	8	16

**SCORING SUMMARY**

**First Quarter**  
Abernathy — Alan Pettit 10 run. (Mark Riddell kick.) :03

**Second Quarter**  
Abernathy — Max Riley 89 run. (Riddell kick.) 7:52  
Abernathy — Kenneth Moss 20 run. (Kick failed.) 3:56

**Third Quarter**  
Lockney — Junior McDonald 19 run. (Jeff McCormick run.) 9:46  
Abernathy — Riley 40 run. (Riddell kick.) 8:15

**Fourth Quarter**  
Abernathy — Malcolm Dunn 44 pass from Riley. (Riddell kick.) 11:53  
Lockney — McDonald 75 punt return. (McCormick run.) 6:27



Victor Villalon

## Seniors looking at last season

Victor Villalon is one of the Senior Lockney Longhorn football players being honored this week.

He is the son of Mr. and Mrs. Vincente Villalon. He plays the position of guard on offense and linebacker on defense. He does the kicking for extra points and the kick offs.

He was named to the All-District team as a guard his junior year.

Besides playing football Victor participated in track his freshman, sophomore and junior years. He has

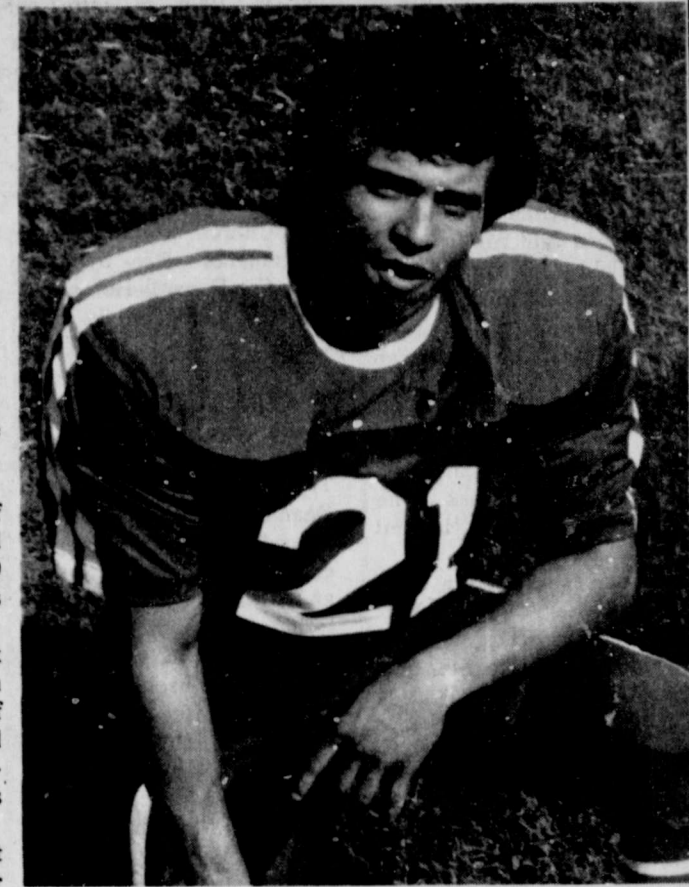

Isreal Guerra

is a 6-5, 220 senior, backs with younger Randy and David leading two each as was held to a minus rushing for the

ected, McCormick quarterback Max Riley coming out through the air 180 yards and one 183-yards and which would at night with 363 total offense. McCormick passed for 122

es, now 6-2 on the 30 in district play, 40 lead at halftime of 10, 89 and 20 Alan Pettit, Riley with Moss, respectively Mark Riddell the Pat's following no scores.

got back in the play in the third when Junior McDonald's leading rush-43 yards on 10 scored on a 19-yard McCormick sprinted in conversion to narrow to 20-8.

ame right back to a 40-yard dash a 30-second later and Malcolm Dunn for a TD on the first play fourth quarter to win.

got its final score McDonald took a punt to 25 and threaded through a host of to score and McCormick over the conver-

dropped to 2-6 loss and are 0-3 in district play. Abernathy will play Floydada Friday in an undefeated league game for the district championship. Lockney will attempt to snap their five-game winning streak Friday against Childress.

Lockney

First Downs	12
Yards Rushing	-3
Yards Passing	122
Total Yards	119
Plays Comp/Att	7-16
Points-Avg.	6-39.7
Fumbles-Yards	7-52
Fumbles Lost	1
Intercepted By	1

Got Heating  
Plumbing  
Problems?  
Call  
Holmes  
Plumbing  
Martin Or Steve  
983-2251  
All Day Or Night

Travis Butler, Auctioneer  
Lic. Tc50-124

Terms of sale cash or approved check  
Warehouse closeouts & slight freight damaged

Inside building

**CITY OF FLOYDADA STREET MAP**

NORTH - SOUTH STREETS  
Numbers begin with 100 & 200  
Street and corner map work for the

EAST - WEST STREETS  
Numbers begin with 300 & 400  
Street and corner map work for the

As you travel away from Idalou, the odd numbers are on the right and even numbers are on the left.

**Floydada welfare programs**

by illegal... validate for the first time the claim of illegal aliens to important public services. It would increase the pull factors which draw illegal aliens to this country and almost surely increase the incidence of their use of government services even if their numbers do not grow. At stake in this case is the power of our government to control migration and the borders, and, in a sense, its future.

**Furniture Auction November 8 Sunday 1:30 P.M.**

**Ray's Furniture 1000 Broadway Plainview, Texas**

Bedroom suits	Bar stools
Dining room suits	Game tables
Sofas & sleepers	Lamps, odd chest
Mattress sets	Odd dressers & more

Lots of items too numerous to list  
Famous Name Brands

Terms of sale cash or approved check  
Warehouse closeouts & slight freight damaged

**Travis Butler, Auctioneer**  
Lic. Tc50-124

Inside building

**GO LONGHORNS LOCKNEY**

Sponsored by  
**The Lockney Beacon**





## Small business tax workshop scheduled

The Division of Continuing Education at Texas Tech University will present an eight-hour Small Business Tax Workshop on Saturday, November 14.

Participants will meet in the Lubbock Room of the University Center on the Texas Tech Campus at 8:00 a.m. to begin this informative and helpful workshop. On-site registration will begin at 7:30 a.m.

The workshop is designed to identify available deductions, the function of the I.R.S., how to complete 1981 tax forms and methods of recordkeeping. Workshop leader is Mr. John Arland.

C.P.A. Co-sponsors for the workshop are Texas Tech University's Division of Continuing Education and Small Business Association.

The workshop fee includes a copy of the Income Tax Service's business tax workshop. For additional information, contact the Division of Continuing Education at Texas Tech University, Box 7422354, or the Small Business Association at (806) 795-3373.

## Floydada School Meets

November 9-13

**Monday:** Breakfast — Orange juice, dried cereal, milk  
Lunch — Baked ham, candied sweet potatoes, green beans, applesauce cake, hot rolls, milk

**Tuesday:** Breakfast — Juice, hot rolls, jelly, sausage, milk  
Lunch — Tacos with cheese, seasoned pinto beans, tomato, lettuce salad, pineapple delight, cornbread, milk

**Wednesday:** Breakfast — Juice, toast, butter, milk  
Lunch — Lasagna casserole, buttered corn, glazed carrots, jello with topping, hot rolls, milk

**Thursday:** Breakfast — Juice, hot rolls, bacon, jelly, milk  
Lunch — Italian spaghetti, tossed salad, butter peas.

pear halves, French milk  
**Friday:** Breakfast — Pancakes, syrup, hot rolls, milk  
Lunch — Ham with cheese, lettuce, dill pickles, tartar sauce, cobbler, milk

So says the V.A. VETERANS COLLEGE!

Contact member (check your phone book for a local veteran)

# SHOP / COMPARE / WANT ADS ARE YOUR BEST BUY!

**Real Estate**      **For Sale**      **Garage Sale**      **For Rent**      **Farm Services**      **Business Services**      **Mobile Homes**      **Automotive**

**Real Estate**  
Three bedroom, large area. 983-3767. tfc

Several good two bedroom houses. Call City Trim Shop, 983-2332, Floydada. tfc

FOR PICTURE FRAMES call 983-2636. B and M Gregory. tfc

FOR SALE: Refrigerator and dishwasher. Call 983-5064. 11-5p

FOR SALE: Admiral 12 inch TV. 983-3973. 428 White St. tfn

BRICK HOUSE. 3 bedrooms, fireplace, 1 1/2 bath. Call The First Bank of Floydada. tfc

Several nice two bedroom houses. Call Hale at Hale Ins. & Real Estate. 983-3261. tfc

BRICK HOUSE. 3 bedrooms, paneled den, fireplaces. Lots of storage. Call for appointment. TFN

ROOM BRICK home. 105 J.B. Avenue. 983-3288. 12-31p

HOUSE, oversized lot, approximately 2,000 sq. ft. air conditioning and separate dining and available immediately. W. Georgia. Floydada. Call Jeff Kimble 983-3268 or (512) 327-1688 or (512) 327-115c

3 bedroom house with baths at 406 W. 1st. Floydada. Call for appointment. 11-19c

ROOM HOUSE: 115 sq. ft. Fully carpeted, tiled, storm windows, water cooler, dryer, water heater. Nice lot trees. \$15,000.00. Call 983-3966. tfn

3 bedroom brick 2 1/2 baths, paneled, heat and air. 2 car with storm cellar. Call Savings and Loan Branch. 983-3725. tfn

2 bedroom, 1 bath house in west Lockney. Call 983-2412. LTFC

ROOM, remodeled 129 W. Jeff. Call for appointment. 983-3725. tfn

FOR SALE: 3 bedroom, playroom, sun room, fireplace. 2800 sq. ft. 222 W. Mississippi. Call for appointment. 983-3725. tfn

NICE 2 bedroom, central siding, electric stove opener, other 652-3392 after 5:00 L11-5c

ROOM, 3 bath house. Call Mrs. Fred Gross. 983-3648. tfc

ROOM HOUSE at 229 W. Jeff. Floydada. Call 983-3619. 11-5p

Agency is the last remaining... Oscar Wilde

**"WE SELL SLEEP"**  
Direct Mattress Co. New or renovated, for appointment call City Trim Shop, 983-2332, Floydada. tfc

FOR PICTURE FRAMES call 983-2636. B and M Gregory. tfc

TOPPER for long wide bed pickup. Cab high. Long wide pickup bed trailer. 983-3417. 11-5c

FOR SALE: Refrigerator and dishwasher. Call 983-5064. 11-5p

FOR SALE: Admiral 12 inch TV. 983-3973. 428 White St. tfn

BRICK HOUSE. 3 bedrooms, fireplace, 1 1/2 bath. Call The First Bank of Floydada. tfc

Several nice two bedroom houses. Call Hale at Hale Ins. & Real Estate. 983-3261. tfc

BRICK HOUSE. 3 bedrooms, paneled den, fireplaces. Lots of storage. Call for appointment. TFN

ROOM BRICK home. 105 J.B. Avenue. 983-3288. 12-31p

HOUSE, oversized lot, approximately 2,000 sq. ft. air conditioning and separate dining and available immediately. W. Georgia. Floydada. Call Jeff Kimble 983-3268 or (512) 327-1688 or (512) 327-115c

3 bedroom house with baths at 406 W. 1st. Floydada. Call for appointment. 11-19c

ROOM HOUSE: 115 sq. ft. Fully carpeted, tiled, storm windows, water cooler, dryer, water heater. Nice lot trees. \$15,000.00. Call 983-3966. tfn

3 bedroom brick 2 1/2 baths, paneled, heat and air. 2 car with storm cellar. Call Savings and Loan Branch. 983-3725. tfn

2 bedroom, 1 bath house in west Lockney. Call 983-2412. LTFC

ROOM, remodeled 129 W. Jeff. Call for appointment. 983-3725. tfn

FOR SALE: 3 bedroom, playroom, sun room, fireplace. 2800 sq. ft. 222 W. Mississippi. Call for appointment. 983-3725. tfn

NICE 2 bedroom, central siding, electric stove opener, other 652-3392 after 5:00 L11-5c

ROOM, 3 bath house. Call Mrs. Fred Gross. 983-3648. tfc

ROOM HOUSE at 229 W. Jeff. Floydada. Call 983-3619. 11-5p

Agency is the last remaining... Oscar Wilde

**Garage Sale**  
INSIDE SALE: 613 S. Main, Lockney. Wednesday, Thursday, Friday each week. Will sell for you. Elaine Hardy, 652-2570. tfn

GARAGE SALE: Friday 9 to 4, Saturday 9 to 12. Honda motorcycle, children and adults clothes, toys and misc. Ralls Highway. 11-5c

2 FAMILY GARAGE SALE: November 7, 8 to 5, 811 W. California. Carpeting, appliances, clothing, miscellaneous. 11-5p

GARAGE SALE: 714 West California. Friday and Saturday, 8 to 5. November 5 & 6. 11-5p

GARAGE SALE: 424 E. Kentucky. Floydada. Thursday, 5th; Friday, 6th; Saturday, 7th; TV, glassware, lawn-mower, tools, clothes and lots more. 11-5p

GARAGE SALE at 819 Cedar Thursday and Friday, Maple love seat, black and white TV, 2-3 speed bicycles, many other things. 11-5p

WEATHER PERMITTING: Stereo, clothes, and lots of miscellaneous. 1 mile north, 1 mile east of Providence Farm Supply. Friday, Saturday and Sunday. L11-5c

GARAGE AND HOUSE Plant Sale: Plants 25 cents - \$5.00; Draperies, fireplace, free standing; light fixtures; couch; knick knacks; ladies clothing; men's clothing, large; wine bottles. 5 cents-10 cents; miscellaneous. Friday and Saturday, November 6-7, 9:00-6:00. FM 378, 1 mile north of Sandhill. Telephone 983-5128. 11-5p

**For Rent**  
**ECONOMICAL STORAGE**  
**TRY BARKER'S Jewel Box-Mini Storage**  
and save your time and money. Ph 652-2642.  
**Barker Building**  
Main and Locust  
Lockney, Texas

**STORAGE SPACE**  
BOATS, FURNITURE, ANYTHING, ETC. BY THE MONTH OR SIX MONTH 10% DISCOUNT.  
**West Texas Mini Storage**  
CALL WILSON BOND 983-3573 OR 983-2151

**Want To Buy**  
WANTED TO BUY irrigated or dryland farm in Floyd or surrounding area. Write Box XRO, c/o Hesperian, Box 700, Floydada. tfc

WANT TO BUY a baby bed. Call 983-5750 or 983-3737 for Robyn. tfn

**Wanted**  
LAND TO FARM near Lockney. Francis Montandon IV. 652-2412 or 652-3404. L1fc

HOUSE CLEANING. References available. 652-2546. L1fc

LIVESTOCK HAULINGS sheep, cattle and wool. 847-2240. L11-5c

**Farm Services**  
Land Leveling, terraces; bench leveling, and pump pits, all types of dirt work for soil and water conservation. Dewie Parson 983-2646. Fred Parson, 983-2074. tfc

CUSTOM Application of Herbicides. Bill Wisdom 652-3541. John Wisdom 652-3544. L1fc

Portable disc rolling Lawson Farm Supply Inc., Floydada 983-3940 tfc

Check with us for LIQUID FERTILIZER ANHYDROUS HERBICIDES  
Rigs available for application  
LONE-STAR CHEMICAL INC.  
Office: 652-2761  
Deanie Henderson: 652-3434

**POOLE WELL SERVICE**  
IRRIGATION, DOMESTIC, AND WINDMILL SERVICE. 407 E. Houston, 983-5610 or 983-2285. tfc

**Business Services**  
Adams Well Service Complete Irrigation Service. All sizes submergible pumps in stock. One day service. 983-5003. tfc

"Carpet Need Cleaning?" Let me do the work for you. Dry foam, 10 cents sq. foot. Also home and auto upholstery. Call Jack Moore 983-3033, after 5 p.m. tfc

**Insulation**  
Installed & Guaranteed. Free Estimates. 22 Years This Area  
**Marr Insulation**  
Lockney  
652-3593

**Auto Accidents DO Happen...**  
If one happens to you, be protected. Our car insurance offers coverage to meet your special needs—repairs to personal liability.  
**Baker Insurance Agency**  
127 W. California Ph. 983-3270

Script Printing & Office Supply  
\*Commercial Printing  
\*Office supplies & Furniture  
\*Business Machines  
108 S. Main  
Floydada  
983-5131 tfc

**Mobile Homes**  
14'x71' ASTRO Mobile Home. 2 bedroom, 2 bath. Can assume 8% loan. Victor Smith. 983-2048. TFN

**Automotive**  
FOR SALE: 1974 Mustang II. 4 cylinder eng., standard shift, new tires, sun roof, has 51,647 miles. \$2,000.00 or best offer. Call 983-3861. 12:00-5:00; 983-2662. 5:30-10:00.

FOR SALE: 1976 Mercury 2-door Marquis. Light tan with everything on it. 983-2390. tfn

FOR SALE: 1974 Ford pickup. 983-5169. Power steering, radio, air conditioner.

1968 FORD SEDAN. Good condition. \$400.00. Call 652-2551 or 320 SW 2nd. L11-12c

77 Chrysler 4-dr \$2150  
75 LTD 2-dr. \$2150  
77 Malibu \$2150  
72 LTD. 2-dr. \$1500  
2-73 Nova. 4-dr. \$1500  
75 Chev., 4-dr. \$2150  
71 IHC Sta. wag. \$1050

W.B. Eakin Car Lot  
Ralls Hwy. 983-3616

**Auto Parts & Accessories**  
F-7 RIDER SHOCKS by Monroe. Buy 3 and the 4th is FREE. Free Installation. Don's Muffler Shop. 123 W. California. TFC

**INSURANCE**  
AUTO  
TRUCK  
MOTORCYCLE  
MOTOR HOME  
HOME  
RENTER'S  
LIFE  
HEALTH  
YOUR Independent AGENT SERVES YOU FIRST  
**Cates & Dawson Insurance Agency**  
231 W. California  
Floydada Tx.  
983-5322

**DAN'S AUTO SERVICE**  
DAN TEUTON, Owner  
Specializing in Automatic Transmission, Motor Tune-Ups, Auto Air Conditioning.  
General Repair  
We Have A BRAKE LATHE to handle all passenger car brake drums. See us for complete brake service.  
Phone 652-2462

**CUSTOM EXHAUST WORK**  
Bruce Williams  
Specializing in Glass Packs and Turbo Mufflers At  
DAN'S AUTO SERVICE  
Lockney. 652-7452

**Hollis R. Bond Real Estate**  
PHONE 983-2151  
107 S. 5th FLOYDADA

**Diamond Industrial Supply Co., Inc.**  
Phone Days 296-7418  
Nights 296-1200 or 296-7828  
1014 Broadway  
Plainview, Texas  
Chain Sprockets U joints  
V belts Oil Seals  
Sheave SKF BCA Timken Bower O rings Wisconsin  
Cotton Stripper Brushes & Bats  
"We Appreciate Your Business More"

**TURNER REAL ESTATE**  
983-2635 Farms-Ranches Floydada, Texas  
"Our chief want in life is somebody who shall make us do what we can."  
Ralph Waldo Emerson  
Rubber received its name when, in 1770, English chemist Joseph Priestly found it would rub off pencil marks.

**LEGAL NOTICE**  
LEGAL NOTICE  
Public hearings regarding the re-districting of the Floyd County Commissioners' precincts will be held on Thursday, November 5, at 5:00 p.m. in the Floyd County Courtroom and at 6:30 in the Lockney City Hall.

**COMMUNITY MEETING**  
1. South Plains Mental Health Provider is presently in the process of preparing its grants, application for the operation of Migrant Health Clinic in this area.  
2. A meeting for all persons interested in the operation of South Plains Health Provider for Floydada Clinic has been scheduled for 7:00 P.M. November 9, 1981 at 319 South Main, Floydada.  
The public is invited to participate in this meeting and offer suggestions for improving services to the community for the coming year.

## More Classified

Reconditioned Used Farm Equipment

**LOW PURCHASE—LOW PROFILE 4 WD TRACTORS WITH LESS THAN 100 HRS.**

Case 60 HP Four Wheel Drive \$22,824.00... EXTRA SPECIAL... \$14,850.00  
Case 90 HP Four Wheel Drive \$31,412.00... EXTRA SPECIAL... \$21,600.00

**Lubbock Farm Tractors**  
Case 2590 180 HP Rental Tractors complete with 18.5 x 16 Front Tires, front weights, 20.8 x 42 Rear Tires, Story Duals, Radio, Air Conditioned, 250 Hrs. suggested Retail... \$64,600.00  
Special Take Your Pick... \$49,500.00

Case 2590 180 HP Rental Tractors complete with 20.8 x 38 Rear Tires, 16 Front Tires, 20 Front Weights, Conditioner, Radio, 615 Hrs. suggested Retail... \$56,000.00  
Special Take Your Pick... \$43,500.00  
Fwd 30.5L x 32 Tires... \$33,400.00

1570 Cab AC Duals... \$29,900.00  
1700 Cab AC Duals... \$22,500.00  
1370 Cab & Air... \$20,500.00  
1370 Cab & Air... \$17,900.00  
Air, Low hrs... \$17,500.00  
1370 Cab AC... \$12,500.00  
1370 Cab & Air... \$11,000.00  
1370 Cab & Air... \$5,250.00  
Cab... \$2,195.00  
Shank Ripper Plow... \$1,000.00  
Low Planter... \$950.00

**NOW IN STOCK 5, 6 and 7 BOTTOM ROLL-OVER PLOWS \$6,000 TO \$13,000 PRICE RANGE.**

Lamesa  
WD Duals 900 hrs. Cab & AC... \$38,500.00  
JD Cab AC Duals... \$29,900.00  
1270 Cab & Air 20.8 x 38... \$13,500.00

Floydada  
1175 Cab & Air, Radio... \$14,500.00  
1880 1200 hrs... \$7,900.00  
Cab... \$6,500.00  
120 with Loader... \$2,500.00

Lubbock 3302 Slaton Hwy  
Lamesa 902 S Dallas  
Floydada 101 South 12th

**Firewood**  
\$50.00 per Rick  
Producers Cooperative Elevator tfn

**Farm Items**  
COMMERCIAL Cody alfalfa seed. 983-3362. tfn

5 JOHN DEERE COTTON trailers with springs. 1-4 row Rotorcycle shredder. E.A. Noland. 652-3144. 11-12p

**Farms & Acres**  
160 acres north of Floydada. 2 small irrigation wells on highway. Floydada Insurance and Real Estate. 983-3284. 116 W. California, Floydada. 11-12c

FOR SALE: 160 Acres of irrigated land in the Irick Community. Contact W.R. Kirkpatrick. 312 Celina Street, Livingston, Tennessee 38570. / -TFN

200 A IRRIGATED - part tile, 6-room house 9 miles west of Floydada. Contact J. Womack. (214) 351-1690. 11-19p

**For Lease**  
160 ACRE FARM for lease. Call Mrs. Fred Gross. 983-3648. tfc

**Misc.**  
PIANO LESSONS make great Christmas gifts! Call Jolene Cummings at 983-2803. Member of National Guild of Piano Teachers and Plainview Music Teachers Association. 11-12c

**Lost & Found**  
LOST: Female calico 3 color cat. Call Jerry Pearson. days 983-3554; night 983-5333. 11-5p

A golf ball's dimpled cover adds accuracy and distance to its flight.

**Country Garage Sale 3 Families**  
Box springs, mattress, bedspreads, washing machine, formal, portable typewriter, pictures, whatnots. Friday and Saturday, 9 to 5. 3 miles east of Providence on FM 788. Gale McPherson. 11-12p

**Classified Rates**  
CLASSIFIED ADVERTISING RATES: 20 CENTS PER WORK FIRST INSERTION; 15 CENTS PER WORD EACH SUBSEQUENT INSERTION. MINIMUM CHARGE \$2.50 FIRST INSERTION. MINIMUM CHARGE \$1.50 SECOND INSERTION. CLASSIFIED DISPLAY RATE: \$1.68 PER COLUMN INCH. CARD OF THANKS: \$3.00.  
983 3737  
652 3318

**Shop Floyd County FIRST!**  
CLASSIFIED ADS CALL 983-3737 BEFORE 3 P.M. ON TUESDAYS

**Wanted**  
HELP WANTED: Applications are being accepted for an experienced First Class Auto-Truck Mechanic. Interested persons should apply on or before November 13, 1981. Lighthouse Electric Cooperative, Inc., 201 W. California, Floydada, Texas 79235. 806-983-2814. An Equal Opportunity Employer. 11-12c

**Employment**  
HELP WANTED: Applications are being accepted for a Mechanic Helper by Light-house Electric Cooperative, 201 W. California, Floydada, Texas 79235. 806-983-2814. An Equal Opportunity Employer. 11-12c

**POSITION AVAILABLE**  
Credit Union Assistant - manager trainee. Send resume giving personal information, education, experience, and beginning salary expected to FCS Federal Credit Union President, Rt. 2, 302 W. Ollie St., Floydada, Texas 79235 by November 6, 1981.

**REGISTERED NURSE SUPERVISOR**  
Wanted to work for West Texas Home Health Agency in office to open in Floydada soon. For information call our Lubbock office, 747-2814 or the Plainview office at 293-4216.

**WANTED**  
Center Director wanted for Senior Citizens, Floydada, Texas.  
Call 983-2032.

**Real Estate**  
Nice 2 bedroom home on Washington St. \$4,000.00 downpayment with balance in 10 years at 12% interest. Monthly payment \$212.33 insurance and taxes not included in payments.

**For Sale**  
Duplex 2 bedroom each side with living room, kitchen, utility room and double garage. \$5,000.00 downpayment, balance in 10 years. 12% interest, payments \$286.94 insurance and taxes not included. Rent one side to help pay for your home and investment.  
Contact Barker Realty, Barry Barker Broker Lockney. 652-2642

**Investment 100% SECURED BY MODEL HOME**  
Individual selected must have ability to purchase or mortgage a \$17,000 model home. Call Mr. Sloan. 704-932-6151 COLLECT or write: L.L.H. Marketing, 1908-A North Main St., Kannapolis, N.C. 28081. 11-5p

# Fascinating Gift Ideas ...

## Spectacular Savings for You

Solid Gold by *Roberto Elmani*

### 14 Karat Solid Gold Chains

Choose one of six 16" styles and get a

### Free 14 Karat Solid Gold Heart Pendant



Pick the 14 Karat Solid Gold Chain of your choice & start saving our register



Chains shown are larger than actual size to show detail.

# \$199

each with \$100 in our special register tapes  
Regular \$39.99 Value

Specially priced without tapes only \$29.99

Here's all you do:

- Pick up your special save-a-tape envelope in store.
- Each time you make a purchase in your store, enter total value of tape in space provided on envelope and place tapes inside envelope.
- When you have reached a total of \$100 in tapes, turn envelope in at your store and purchase any one of the six beautiful 16" 14K Solid Gold Chains for only \$19.99 plus tax and receive your free 14K Solid Gold Heart Pendant.
- Only register tapes dated thru 11/30/81 will be honored.

Come in and up your tape envelope to

# IMARI 榮和 謹製

## Imported Porcelain

For centuries, fine Oriental Imari ware has been prized for its exquisite enamel overglaze and complex, jewel-like coloring. But like any work of art, the Imari style required great amounts of skill and time. Until recently this renowned porcelain style was the preserve of serious collectors.

Now, through a unique modern technique, the brocade beauty of Imari ware is available to you. This exclusive Imari Goshoguruma design includes pieces in all appropriate premium price ranges to delight you. Goshoguruma (Ricksha) is authentically patterned in 22 Karat gold of intricate Nishi-

kide brocade designs intermixed with floral designs. The Goshoguruma design depicts the Ricksha Cart used by the Emperor and Empress at the Imperial Palace in Kyoto, dating back nearly 1500 years.

### Coupon Savings on Feature Items each week

Week	Item	Savings
Nov. 5-11	Coffee Mug	\$2.89 with coupon
Nov. 12-18	8" Plate	\$3.99 (free holder) with coupon
Nov. 19-25	Dinner Bell	\$3.99 with coupon
Nov. 26-Dec. 2	Covered Box	\$3.99 with coupon
Dec. 3-9	Lotus Bowl	\$10.99 with coupon
Dec. 10-16	6" Plate	\$2.99 (free holder) with coupon
Dec. 17-23	Temple Jar	\$8.99 with coupon
Dec. 24-30	Ash Tray	\$5.99 with coupon
	2-pc. Flower Pot	\$9.99
	10" Flower Vase	\$14.99
	14" Plate	\$29.99 (free holder)
	6" or 8" Plate Holder	\$1.00
	Picture Frame	\$6.99

**SAVE \$1.00 THIS WEEK!**

**IMARI COFFEE MUG**

**\$2<sup>99</sup>**

WITH COUPON      Without Coupon \$3.99

Valid Thru Wednesday, Nov. 11, 1981



309 S. Wall  
Floydada, Texas

Open Daily 8:00 a.m. to 8:00 p.m.  
Sunday 9:00 a.m. to 7:00 p.m.



Cowboy wiv

benefit the handicapped. Happy Hill Home. In operation, er taken funding. B on the F Directors. "The p we've proce successful co favorite Co candid snu and their Mary Bre we've put t ly new kin family fitn Dallas Cov

ster News  
oler weath

J.E. GREEN  
Present the Hal Th birthday di Thomas S children. Mensc at Lubbock. A nephew of Kenneth E who arrive noon. Our fri Carpenter. Ashton of Home are fine. Mrs. Olg grandchild Joyce and often visit sits. Mrs. An ped in at M last week. Mrs. C. in Plainvie

Well-Bred Goose For Thank



succulent roast goose is becoming a holiday table. Today's well-bro juicier and save time and work sit heating. A few simple steps can insure a m nect oven temperature in two stage thermometer (should register 180° F oval of rendered fat. Thaw bird according to package instruc below for correct roasting times. 3 unstuffed, cooking time will be sl 45-to-Cook PLUS Time at 400° F. Time at 325° (Hours): 8 to 10 1 hour 1-1/2 to 2 10 to 12 1 hour 2 to 2-1/2

**WILD RICE STUFFING**

2/3 cup wild rice  
2 cups water  
1/2 teaspoon salt  
6 cups day-old white bread cubes  
1/2 cup finely chopped onions  
1 teaspoon powdered sage  
1/2 teaspoon salt  
1/3 cup melted butter  
Mix thoroughly. Bring to boil salt. Reduce heat and simm tender. Combine bread cubes rice. Add melted butter and to 10 pound bird.  
Tie neck with a skewer and tie

SHUGART CO  
Thursday Nov. 19

Mize Pharm  
102 S. 19  
W. COLO  
ASK About Our FREE 8 x 10 OFFER

## Cowboy wives donate proceeds to children

When volunteering stressed as at the national social solution to the wives of the cowboy football team third year in a row with a unique idea to help special children.

The direction of the "middle line" players' and wives have come up with a unique idea to help special children.

The Dallas Cowboy Family Fitness Guide and Nutritional Cookbook, proceeds from the book go directly to

benefit the special learning handicapped children of Happy Hill Farm Children's Home. In its six years of operation, the Farm has never taken state or Federal funding. Bob Breunig serves on the Farm's Board of Directors.

"The past two seasons we've produced a very successful cookbook, featuring favorite Cowboy recipes and candid snapshots of players and their families," said Mary Breunig. "This year we've put together an entirely new kind of book called a 'family fitness guide.'" The Dallas Cowboy Wives' Fam-

ily Fitness Guide contains helpful hints on how the Cowboy families maintain maximum health year-round. It features exercise routines, calorie-counting charts, a guide for measuring the effectiveness of various sports and exercises, and a variety of health tips. The book also contains information about the Cowboy families' exercise and sports activities, and candid pictures of the Cowboys and their wives and children.

"This year the cookbook section contains more salad and vegetable recipes, as well as some special health drinks and

whole-grain bread ideas," says Mary Breunig.

Their cookbook idea was quite successful, and more than 36,000 copies of the first two editions have been distributed to every state in the country.

Bob and Mary Breunig have worked with the Farm almost from its beginning, assisting the founder and director, C. Edward Shipman, and his wife, Gloria, in providing a home and vocational training center for a group of learning handicapped boys and girls.

Happy Hill is a 266-acre working farm on the edge of the Dallas-Fort Worth Metroplex. Their program contains a heavy emphasis on vocational training. The children may obtain a high school diploma, if they qualify, but all of them are learning practical job skills, such as auto mechanics, furniture building, and farming.

Happy Hill Farm Children's Home and the Academy are licensed by the appropriate state agencies.

The Farm is multi-denominational and has a strong emphasis on moral and spiritual values. Operating funds come from hundreds of individuals, churches and corporations from throughout the state. Several foundations have assisted the Farm in its capital program. A new

living unit for eight more children and a chapel have just been completed.

The Farm's Director, C. Edward Shipman, says that the Family Fitness Guide is certainly in keeping with the Farm's emphasis on a healthy, wholesome lifestyle. "We raise much of what we eat here on the Farm, and our animal herds provide us with our own meat, eggs, and milk," says Shipman. "I hope the book will encourage people to join with us in our campaign for better health and fitness." According to a Senate Select Committee on Nutrition and Human Needs, Americans are eating too much of the wrong kinds of foods. Six of the ten leading causes of death can be linked to diet.

The Dallas Cowboy Wives' Family Fitness Guide and Nutritional Cookbook is attempting to suggest, to those who will listen, some helpful ideas on exercise and nutrition—and while you're helping yourself, you will be helping the Farm's special boys and girls.

To get a copy of The Dallas Cowboy Wives' Family Fitness Guide and Nutritional Cookbook, order it directly from the Farm for \$9.95 each. Write: Dallas Cowboy Wives' Family Fitness Guide, Happy Hill Farm, Star Route, Glen Rose, Texas 76043.

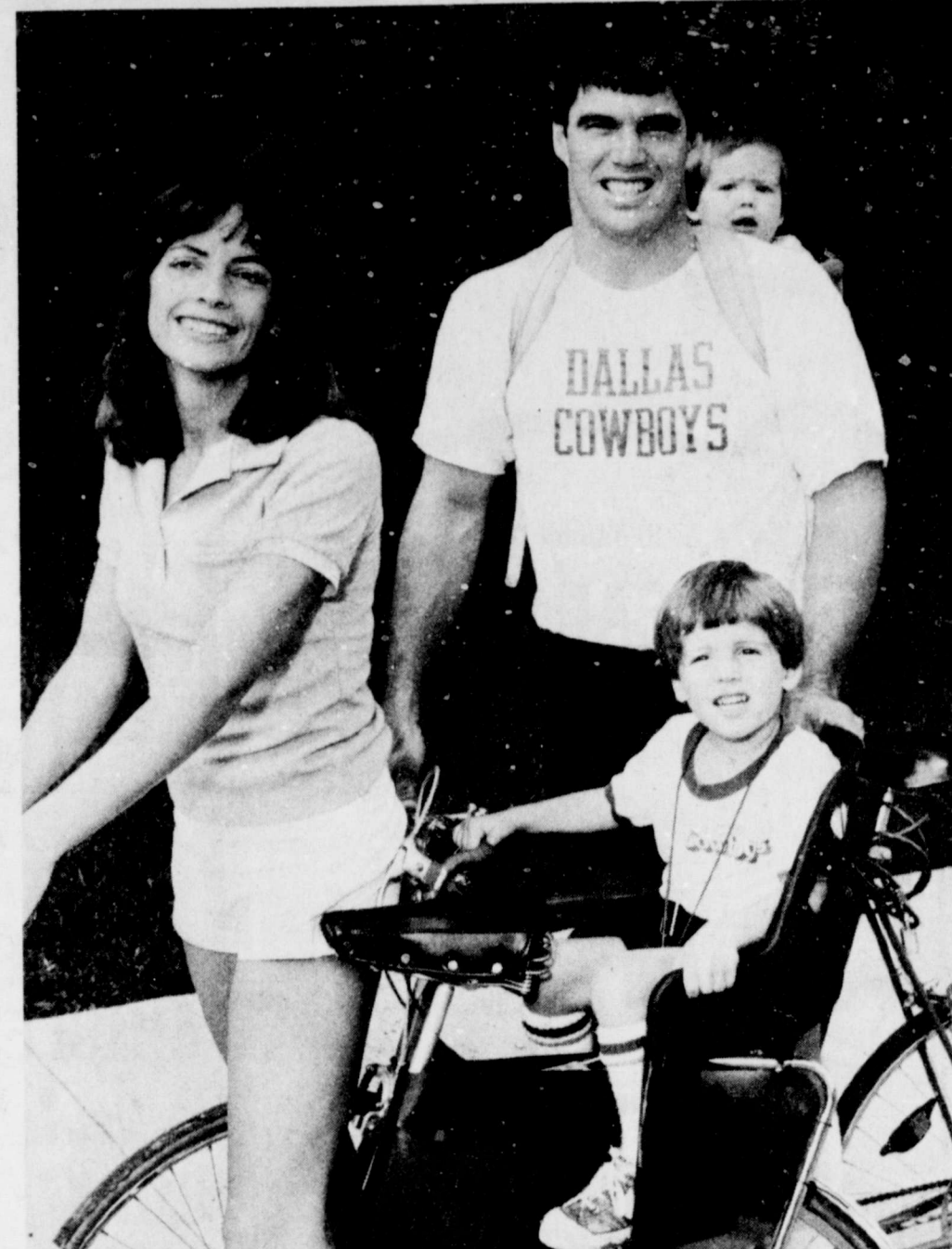

BOB BREUNIG—Dallas Cowboys' middle linebacker—his wife, Mary, and sons—Robert Jr., and Bart. The Breunigs participate in a variety of vigorous activities, including bike riding, in their efforts to stay fit as a family.

## Wilder weather hits Center

**MRS. J.E. GREEN**

Present for the weekend at the Hal Thomas home for the birthday dinner honoring Hal Thomas Sunday were their children, Sue and Milton Mensch and son David of Lubbock. Also present was a nephew of Mrs. Thomas, Kenneth Ellard of California, who arrived Saturday afternoon.

Our friends Mrs. Claud Carpenter and Mrs. Clarence Ashton of the Lockney Rest Home are reported doing fine.

Mrs. Ola Warren's great-grandchildren, those of Joyce and Jimmy Owens, often visit her. She also baby sits.

Mrs. Anthony Latta dropped in at Ma Greens one day last week.

Mrs. C.M. Meredith was in Plainview one day last week.

Wiley Rogers returned yesterday to his hospital room at St. Paul's in Dallas after a siege in intensive care - result of a car wreck weeks ago.

My sister, Mrs. Gertrude Massingill of Phillips, recently discharged from St. Anthony's, Amarillo, after surgery, is convalescing at home.

My son Clyde of Peralta, New Mexico has accepted a position of teaching German in a high school in Albuquerque. He and his wife are retired teachers of Alaska.

Friday is Homecoming at Wayland and the 30th anniversary of my Margaret's graduation there. All our children graduated from there. We are proud of that school - now Wayland University, Plainview.

Thanks to the city for repairing 14th St. in front of my house. After rains it got worse and worse.

## Well-Bred Goose For Thanksgiving



Well-bred roast goose is becoming a favorite of the holiday table. Today's well-bred birds are meatier and save time and work since the goose is stuffed.

Simple steps can insure a memorable meal—oven temperature in two stages, use of a meat thermometer (should register 180° F.), and frequent basting.

Follow the following for correct roasting times. If you cook the stuffed, cooking time will be slightly shortened.

Weight (lb.)	Time at 400° F. (Hours)	PLUS Time at 325° F. (Hours)	Total Roasting Time (Hours)
10-12	1 hour	1-1/2 to 2	2-1/2 to 3
12-14	1 hour	2 to 2-1/2	3 to 3-1/2

**WILD RICE STUFFING**

3 cup wild rice  
2 cups water  
2 teaspoon salt  
6 cups day-old white bread cubes (crusts removed)  
2 cup finely chopped onions  
1 teaspoon powdered sage  
2 teaspoon salt  
2 cup melted butter

Rice thoroughly. Bring to boil in saucepan with salt. Reduce heat and simmer 30 minutes or until tender. Combine bread cubes, onion, sage, salt and rice. Add melted butter and toss to mix. Stuff lightly in neck and body cavities. Makes enough to stuff a 10 pound bird.

Tie the neck with a skewer and tie legs together.

"You had a kindness shown? Pass it on."  
Henry Burton

## SHUGART COUPON

Thursday Nov. 19  
Mize Pharmacy

102 S. Main Street  
19¢

WALLET SIZE COLOR PORTRAITS 99¢

FREE 8 x 10 OFFER

Extra charge for GROUPS

Floyd County Implement Floydada

## Larry Hildreth promoted

Larry D. Hildreth, grandson of Mrs. J.E. Black of Petersburg, has been promoted in the U.S. Army to the rank of specialist four.

Hildreth is a medical records clerk in Aurora, Colorado, with the Fitzsimons Army Medical Center.

He is a 1975 graduate of Petersburg High School.

## LUNG CANCER IN MEN

Lung cancer is the number one cause of cancer deaths among men. In the last thirty years, there has been a 400 percent increase in women's lung cancer deaths. By the late 1980's, lung cancer is expected to be the number one cancer killer in women.

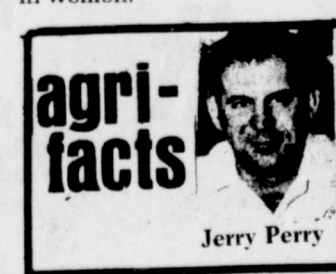

Another element for increased wheat yields is phosphorus. Increased use of nitrogen on fallow winter wheat, eco-fallow wheat and on continuous-cropped areas means growers should be highly attentive to the second most limiting element - phosphorus. Recently completed University of Nebraska research has indicated phosphorus-deficient soils can yield 8 to 12 bushels per acre less wheat than those fertilized, according to the recommendations of soil labs. Strict attention should be paid to the phosphorus content, according to the Nebraska agronomists. Phosphorus can increase tillering, improve winter hardiness by better root system development and generally advance plant maturity. Calculations also indicate higher yields are accompanied by lower production costs and higher net profits per acre.

Floyd County Implement Floydada

# WINTERIZE YOUR BACK YARD DURING OUR GAS GRILL SUPER SALE

Now, you can save 30% on a big selection of gas grills... bargains you'll relish year 'round. Where is it written that when the weather turns cold you can't enjoy the uniquely wonderful taste of food cooked outside? Your back yard can always be the center of fun and good eating with a gas grill. A dependable gas grill will broil hamburgers or steaks with a minimum of attention. Or, slow cook a roast or turkey while you sit inside. And, you can get big savings right now on a gas grill that will make year 'round outdoor cooking even more appealing. So, Fall into a great deal now... winterize your back yard with a gas grill and enjoy it for years and years.

<p><b>PATIO KITCHEN</b></p> <p>PK cast aluminum grills feature stainless steel burners — "H" shaped for maximum heat distribution... stainless steel for long trouble-free life, and heavy steel rod coal grates.</p> <p><b>PK Delta 1</b> Single burner model with 270 sq. in. chromed steel cooking grid. List Price \$150.50. <b>Now \$105.35</b> SAVE \$45.15!</p> <p><b>PK Regent 1</b> Dual burner and controls let you use one-half or all of burner. 308 sq. in. cast iron cooking grid. List Price \$221.00. <b>Now \$154.70</b> SAVE \$66.30!</p>	<p><b>DUCANE</b></p> <p>Ducane cast aluminum grills feature top-ported stainless steel burners, which last longer and save gas... and a unique coal grate designed to prevent flare-ups and grease collection at the bottom of the firebox. Some models have Rotis-A-Grate®, a separate vertical burner for roasting from behind the meat, and porcelainized-steel cooking grids.</p> <p><b>The Challenger 800</b> Single burner model with 305 sq. in. nickel-chrome plated grid. List Price \$216.00. <b>Now \$151.20</b> SAVE \$64.80!</p> <p><b>The Challenger 1500</b> Twin burners, dual controls — one for each side which saves gas when you don't need to use the total cooking surface. 405 sq. in. nickel-chrome plated grid. List Price \$347.00. <b>Now \$242.90</b> SAVE \$104.10!</p> <p><b>The Trophy 2000</b> Two burners — one with a 310 sq. in. porcelainized-steel cooking grid, the other a Rotis-A-Grate® vertical burner, rotisserie motor and spit, and electronic ignition. List Price \$440.00. <b>Now \$308.00</b> SAVE \$132.00!</p>	<p><b>JACUZZI JET CHEF</b></p> <p>Jacuzzi Jet Chef cast aluminum grills feature Char-Brown enamel finish, rust-resistant porcelainized cast iron cooking grid, cast iron and nickel alloy burner, and heat indicator on lid.</p> <p><b>Jet Chef 3010</b> Single burner and control with 340 sq. in. cooking surface. List Price \$269.00. <b>Now \$188.30</b> SAVE \$80.70!</p> <p><b>Jet Chef 4020</b> Larger grillhead with twin burner, dual controls and 454 sq. in. cooking grid. List Price \$349.00. <b>Now \$244.30</b> SAVE \$104.70!</p>
---	---	--

# ENERGAS

Gas Energy For West Texas

NOTICE: Add \$70 to prices shown for installation

BUT... DO HURRY!  
These prices are good only on grills in our warehouses... so buy now while the selection is good. No special orders. This sale ends December 15, 1981.

...as ...

# For You

## \$19.99

Plus Tax

each with \$10 in our special register tapes

Regular \$39.99 Value

Specially priced without tapes only \$29.99

all you do:

special save-a-tape envelope

make a purchase in your store, use of tape in space provided on place tapes inside envelope.

reached a total of \$100 in tapes, at your store and purchase any beautiful 16" 14K Solid Gold \$19.99 plus tax and receive your Gold Heart Pendant.

tapes dated

Come in and pick up your tape save envelope today.

start saving our register tapes

The Classic

The Gold Serpent

# Porcelain

PIGGLY WIGGLY

# Super Savings Everyday

always sensibly priced

2 lb Jimmy Dean Pork  
**SAUSAGE**  
**\$2.99**

Wilson Certified Boneless  
**HAMS** lb **\$2.59**



USDA Beef Bottom Round Boneless

**ROAST**  
**\$2.19**  
lb

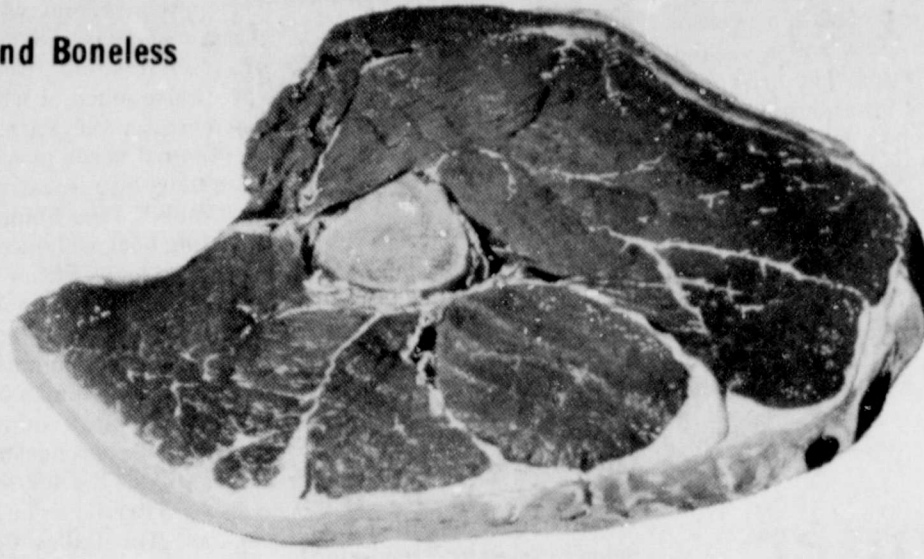

12 oz. Kraft American  
**CHEESE SINGLES** lb **\$1.79**

From Our Deli  
**HOT LINKS** 4/\$1



12 oz. Booth Battered  
**FISH PORTIONS** **\$1.79**

Family Pack  
**PORK CHOPS** **\$1.39**

From Our Deli  
10 Pieces Golden  
**FRIED CHICKEN** **\$3.99**

Keebler Fudge Marshmallow,  
Deluxe Graham, or  
Fudge Stripes  
**COOKIES** **99¢**



10 lb 11 oz. Family Size  
**CHEER** **\$6.39**



**HEALTH & BEAUTY AIDS**

SAVAGE MEN'S  
**Cologne** **\$2.29**  
4 1/2 OZ. BTL.

HILLS BROS.  
**Coffee**  
REGULAR ELEC PERK AUTO DRIP  
**\$1.89**  
1 LB. CAN



10 oz. Campbells Chunky  
**SOUP** Vegetable Beef **59¢**  
19 oz. Campbells Chunky  
**SOUP** Steak & Potato **99¢**

EARTHENWARE REG.-DRY 4 OZ. **\$2.59**  
**VITAMIN E CREAM**  
SUAVE BALSAM PROTEIN OILY-  
**SHAMPOO** NORM 16 OZ. BTL. **\$1.39**

4 lb Mortons  
**ROCK SALT** 3/\$1.00  
12 oz. Honey Bran  
**CEREAL** \$1.19  
40 oz. Signal  
**MOUTHWASH** \$3.89  
MILNOT 13 OZ. CAN  
**EVAP. MILK** 2/\$1

40 count Crubside  
**TRASH BAG** \$2.29  
12 oz. Hollywood Buttermilk  
**DRESSING** 99¢  
15 oz. Gebhardts  
**TAMALES** 59¢  
MAZOLA 1 LB. PKG.  
**MARGARINE** 79¢

Cheer  
DETERGENT  
**\$1.89**  
49 OZ. BOX



Crisco  
SHORTENING  
**\$2.19**  
3 LB. CAN



CASSAROLE  
**Pinto Beans** **69¢**  
2 LB. PKG.

WE KNOW YOU'LL BE PLEASED WITH OUR  
**Fruits & Vegetables**  
"The FRESHEST in Town"

**Grapefruit**  
TEXAS RUBY RED  
**4** LBS. **\$1**



Bulk Russett Baking  
**POTATOES** 4 lbs \$1.99  
1 LB. CELLO BAG  
**CARROTS** 3/\$1.99  
**RED DELICIOUS** or Rome  
**APPLES** 1 lb \$1.99  
Firm Green  
**CABBAGE** 1 lb \$1.99  
**PURPLE CLIP-TOP**  
**TURNIPS** 3 lbs \$1.99

Joy Liquid  
DETERGENT  
**\$1.29**  
22 OZ. BTL.



Marshmallows  
19 oz. Bonus Pack  
**MARSHMALLOWS** **69¢**



Monday through Saturday 8 a.m. - 9 p.m. Sunday 9 a.m. - 5 p.m.  
Double S&H Green Stamps on Wednesday with \$5.00 purchase

**buddy's**  
SUPERMARKET

Values In This Adv Effective Thru Wednesday, November 11, 1981

220 South 2nd - Floydada



Heirloom quality  
24% Lead  
**FR**

CASH  
and save  
complete

**STAMP**



**STAMP PRICE S**

Sunny Fresh Farm  
Grade A Medium  
**EGGS**  
With One Filled  
S&H Special Saver  
**29¢**  
do  
89¢  
Without Book

6-32 oz. Diet or Regular  
**DR PEPPER**  
**\$1.59**  
plus deposit



Sunny  
**LITTER**  
**1.59**

Gebhardts  
**FRIED**  
**NS** 2/9

84 oz. K  
**TID**  
**\$2**



15 oz.  
Glamorene  
**RUG**  
**FRESH**  
**\$1.19**



**Zesta**  
soft-crackers

**Heirloom quality European 24% Lead Crystal**  
**FREE**

Collect our CASH SAVER COUPONS and save over \$200 on a complete 48-pc. service set.

It's so easy - just fill in the Cash Saver Card with your name and address. You'll receive a coupon with every purchase. For example, if you make a \$15 purchase, you'll receive a coupon that only takes 20 coupons to cash in. Each coupon is good for one place setting (choice of 1 place setting or 2 place settings). Start today - collect a complete set of sparkling Shiraz and a complete set of unbelievable service.

\*One Stemmed Water Goblet, Stemmed Wine Goblet, Cordial Beverage or Champagne Shaker.

**STAMP PRICE SPECIALS**  
**More savings!**

**STAMP PRICE SPECIAL**

Sunny Fresh Farm Grade A Medium EGGS  
 With One Filled S&H Special Saver Book  
**29¢** dozen  
 89¢ Without Book

**STAMP PRICE SPECIAL**

1 lb Quarters Margarine PARKAY  
 With One Filled S&H Special Saver Book  
**19¢**  
 79¢ Without Book

**STAMP PRICE SPECIAL**

1 1/2 lb Soft n Lite BREAD  
 With One Filled S&H Special Saver Book  
**19¢**  
 79¢ Without Book

**STAMP PRICE SPECIAL**

1/2 Gallon Buddys Grade A Homo MILK  
 With One Filled S&H Special Saver Book  
**39¢**  
 99¢ Without Book

12 oz. Hi-C Fruit FRUIT DRINK  
**3/\$1.00**

6-32 oz. Diet or Regular DR PEPPER  
**\$1.59**  
 plus deposit

Cheer DETERGENT  
**\$1.89**  
 49 OZ. BOX

Johnny LITTER  
**1.59**  
 Cat Litter

9 lb 13 oz. Jumbo Size Laundry Detergent ALL  
**\$4.39**

1 lb Bag Fun Size Baby Ruth or Butterfinger CANDY BARS  
**\$1.99**

4 Bar Cashmere Bouquet SOAP  
**\$1.09**

12 oz. Body Buddies CEREAL  
**\$1.09**

23 oz. Princella YAMS  
**89¢**

Gebhardt's FRIED PANNS  
**2/99¢**

84 oz. King Size TIDE  
**\$2.99**

8 Count Chinat Dinner PLATTERS  
**\$1.09**

4 oz. Adams Best VANILLA  
**\$1.29**

11 oz. Lea & Perrins Chef MARINADE  
**\$1.29**

20 Count Hefty Extra Large Kitchen GARBAGE BAGS  
**\$2.39**

15 oz. Glamorene RUG FRESH  
**\$1.19**

19 oz. Gebhardt's "No Beans" CHILI  
**\$1.19**

7 oz. Original PLEDGE  
**\$1.29**

15 Count Hefty TRASH BAGS  
**\$3.19**

10 oz. Hills Bros. INSTANT COFFEE  
**\$3.19** with coupon  
 \$3.99 without coupon

10 oz. Frito BEAN DIP  
**69¢**

Automatic Dishwasher Detergent CASCADE  
 50 oz. **\$2.19**  
 25 oz. **\$1.79**

1 lb Zesta SALTINES  
**69¢** with coupon  
 89¢ without coupon

Double On Wednesday With A \$5 Purchase Or More

**buddy's SUPERMARKET**

Values In This Adv Effective thru Wednesday, November 11, 1981  
 220 South 2nd - Floydada

YOU'LL BE PLEASED WITH OUR **& Vegetables** FRESHEST in Town™

Bulk Russett Baking POTATOES 4 lbs **\$1.49**

1 LB. CELLO BAG CARROTS..... **3/\$1.49**

RED DELICIOUS or Rome APPLES..... lb. **49¢**

Firm Green CABBAGE lb **9¢**

PURPLE CLIP-TOP TURNIPS..... 3 lb. **\$1.00**

Monday 8 a.m. - 9 p.m. Sunday 9 a.m. - 8 p.m.  
 Specials on Wednesday with \$5.00 purchase or more

**buddy's SUPERMARKET**

Effective Thru Wednesday, November 11, 1981  
 220 South 2nd - Floydada

## Plenty of cotton calls for marketing strategies

COLLEGE STATION — Cotton, cotton everywhere—and what to do with it.

That's the dilemma facing Texas cotton farmers.

"Because of this year's bumper cotton crop, cotton supplies are plentiful, the demand is weak and prices are below the cost of production," points out Dr. Carl Anderson, economist in cotton marketing with the Texas Agricultural Extension Service, Texas A&M University System.

Thus farmers are trying to decide what to do with this year's crop—sell now, hold and hope for a higher price, or try to work a delayed pricing strategy.

"Deciding when and at what price to sell is not easy," says Anderson. "However, developing a 'feel' for the market and following a good marketing program can pay off big."

"With a current depressed cotton market, many farmers are trying to decide whether to place cotton under the government loan program or to try a delayed pricing strategy such as the seller's call contract," notes the economist.

Under the government loan, cotton comes off the market and provides some cash flow for farmers. But it costs about a cent a pound per month to hold cotton in the loan program. Eventually, it has to move to market, so the loan program may not help market prices that much.

Under the seller's call contract, the farmer's price for cotton is tied to the futures market price, explains Anderson. This gives the farmer an opportunity to actually establish a price for his cotton after delivery. However, the farmer must be sure to understand contract terms and conditions.

Here's how it works. The farmer agrees with a broker or buyer to deliver his cotton and to transfer ownership at that time. In Texas, terms of most seller's call contracts call for a cash advance to the farmer of an amount equal to the loan value at delivery time. Also, most contracts specify the loan value as a price floor.

"Once he delivers the cotton, the farmer has no further storage costs but he can participate in a market upswing," explains the economist. "The seller's call contract specifies that the farmer's price will be a certain number of points off a given futures month. The farmer decides the date for the price relationship to the futures contract month."

Anderson gives this example. Assume a farmer selects the March 1982 futures for his contract. If cotton in the March Strict Low Middling 1-1/16-inch futures contract is trading at 68 cents a pound and the farmer's current spot price is 58 cents for the same quality, his spot price is fixed 10 cents under the March futures contract if he signs a call contract. Thereafter, if the March futures goes up or down, the farmer's price will be 10 cents a pound less.

"A seller's call contract should allow for changing to a new contract month for a small fee," notes Anderson. "This allows the farmer to watch the market

and sign the call contract when the difference between the futures price and spot price is relatively small. In other words, the smaller the difference between the two market prices, the better off the farmer is."

To use the seller's call contract wisely, a farmer must follow changes and reasons for changes in both the futures and spot markets, emphasizes the economist.

"The key point to remember is that the farmer benefits from the call contract when prices increase," notes Anderson. "However, the spot price must have been fixed under the call contract or there would be no price protection in a falling market."

While both the loan program and the call contract can benefit a farmer if market prices increase, carrying costs tied to the loan can be excessive, depending on the length of storage. On the other hand, the call contract offers immediate transfer of cotton and gives farmers more flexibility in a changing market, believes Anderson.

## Around The County

By Jett Major

FLOYD COUNTY EXTENSION AGENT



### FALL FRUIT TREE SPRAYING CONTROLS DISEASES

Fall is often the time when fruit tree care is forgotten or neglected, but it's a critical time for controlling many peach and plum tree diseases to insure a good crop next year. Applying fungicide now can stop or reduce three of the six diseases that attack peach and plum trees in Texas. These are peach leaf curl, bacterial leaf spot and bacterial canker.

Puckered and distorted peach tree leaves that were either bright red or light green in diseased areas last spring were due to peach leaf curl fungus. The only time to effectively control this disease is in the fall with a copper-containing fungicide such as Kocide 101.

Timing of the fall spray is critical for effective control and for avoiding tree damage. Copper is a metal and may cause severe defoliation unless applied correctly.

Spraying should be initiated when 70

percent of the leaves fall off the tree. Spraying too early will cause leaf shed or cause the spray to be ineffective later.

Bacterial leaf spot and bacterial canker can be partially controlled by fall spraying with a copper fungicide, but again it's important to spray at the right time to prevent foliar burn.

Bacterial leaf spot affects both fruit and foliage. The infection causes fruit to crack and leaves develop angular spots drop out. Bacterial canker will kill trees slowly. Infected trees will have gum or wax forming on the trunk and main limbs.

Fall spray in the Panhandle-South Plains area of Texas is most often applied from late October to November 15.

Fall spraying is important to the health and production of fruit trees, because there's no other time when 50 percent of peach and plum tree disease can be controlled with one spray.

## Judges named to Fort Worth Stock Show

Judges for the variety of events scheduled during the 86th annual Southwestern Exposition and Fat Stock Show January 27 through February 7 have been announced by show president-manager W.R. Watt Jr.

Watt also reminded exhibitors of cattle, horses, sheep, swine, donkeys and mules that entry deadline is December 10, while exhibitors of poultry, pigeons and rabbits have until January 15 to enter.

Information on exposition entries as well as mail orders for Stock Show Rodeo tickets should be requested at P.O. Box 150, Fort Worth, Texas 76101. Tickets for all night and weekend rodeos are \$7 each, and Monday through Friday 2 p.m. matinees are \$5 each. When ordering by mail, include an extra \$1 per order for postage and handling.

Watt reported the livestock breeds and their judges include Hereford, Dr. Robert Kropp of Stillwater, Oklahoma; Polled Hereford, Dr. Stan Coley of Grovetown, Georgia; Shorthorn, Dr. Glenn L. Richardson of Longview, Texas; Angus, Jim Gillooly of Washington, Indiana; Brahman, Dr. Hollis Chapman of Baton Rouge, Louisiana; Santa Gertrudis, John Kiker of Rockport, Texas; Brangus, W.F. Wackman Jr. of Brenham, Texas; Charolais, Clarence H. Marek of New Ulm, Texas;

Chianina, Dan Hoge of Kewanee, Illinois; Devon, Dr. Randall Grooms of Overton, Texas; Maine-Anjou and Simmental, Dr. Miles McKee of Manhattan, Kansas.

Judging open dairy will be Richard Keene of Gilbertsville, New York; junior dairy, B.J. Shepherd of Bridgeport, Texas; open sheep, Rex Stultz of Del Rio, Texas; junior breeding sheep, Jack Groff of Kerrville, Texas; junior

lambs, Fred T. Wilkinson of Crane, Texas.

Judging open breeding swine will be Lauren Christian of Ames, Iowa; open barrows, Dr. Donald Orr of Lubbock, Texas; junior barrows and champions, Dr. T.D. Tanksley of College Station, Texas; junior steers, Bill Able of Manhattan, Kansas.

Junior heifer judges will be Hereford, Dr. Kropp; Polled Hereford, Dr. Coley; Shorthorn and Charolais, Dr. Richardson; Angus, Gillooly; Brahman and Santa Gertrudis, Dr. T.D. Rich of Kansas City, Missouri; Brangus, Dr. L.D. Wythe of College Station, Texas; Simmental, Dr. Grooms, and Limousin, Charles Rollins of Crowley, Texas.

Other judges include Poultry, John S. Garrett, Haynesville, Louisiana, Harold F. Halback, Waterford, Wisconsin, and J.B. Harrell, Jr. of El Dorado, Arkansas; Rabbits, Joe Frizzle, Johnstown, Ohio, and Gary Grimm, Marion, Iowa; Pigeons, Walker Graham, Dr. Jack Horn and A.J. Stratton, Fort Worth, Texas, and Fred Langridge, Dallas, Texas; Birmingham Roller pigeons, Merl Ed Emerson of Muskogee, Oklahoma, and Floyd L. Mayberry, Marlow, Oklahoma.

**RUCKER'S O.K. TIRE STORE**  
Floydada 983-3370

**FLOYD COUNTY IMPLEMENT**  
Floydada 983-3732

# Farm News

## Owning and grazing stocker calves not automatic profit

There's little good news about stocker cattle enterprises for this fall and winter.

"High costs relative to livestock prices offer a dim outlook for owning and grazing stocker calves," says Dr. Ashley Lovell of Stephenville, economist with the Texas Agricultural Extension Service, Texas A&M University System. "Such operations have exper-

enced substantial losses the past two years.

"When venturing into the stocker cattle business, accurate cost and return estimates are crucial," notes Lovell. "Valid decisions in choosing the most profitable combination of calves and grass are dependent upon accurate production cost estimates and correct expectations of the future cash market

## Don Marble selected to lead Target 2000

Dr. Don Marble of South Plains has been selected to help lead The Texas A&M University System into the 21st century as a member of the TAMUS Target 2000 Project Committee.

The Target 2000 Project brings together more than 250 prominent Texans and other friends of the university from around the nation to undertake a comprehensive study of the goals and objectives to be attained by the system by the turn of the century.

The Texas A&M University System, with an annual budget of \$528.6 million, includes four academic units — Texas A&M University, Prairie View A&M University, Tarleton State University

and Texas A&M University at Galveston; four agricultural agencies and services — the Texas Agricultural Experiment Station, the Texas Agricultural Extension Service, the Texas Forest Service and the Texas Veterinary Medical Diagnostic Laboratory; and three engineering services and agencies — the Texas Engineering Experiment Station, the Texas Engineering Extension Service and the Texas Transportation Institute.

The project includes task forces on academic institutions, agricultural agencies and services, and engineering services.

## Cotton industry tours planned by EOC

The development of the cotton industry on the South Plains will be explored through a series of tours planned by the Enrichment Opportunities Committee of the Women's Council of the West Texas Museum Association.

The first tour day, Wednesday, Nov. 11, will begin with a 9 a.m. coffee and a film on the cotton industry presented by the National Cotton Council at The Museum of Texas Tech University. After the film, the tour bus will leave for the fully automated Friendship Cooperative Gin in Wolforth. Cost of the tour is \$6 and reservations must be made by

Friday, November 6.

Other tours will be January 20 to the Littlefield Denim Factory, where the local cotton is converted into cloth, and February 17 to the Texas Tech University Textile Research Center.

Tours are limited so early reservations should be made by sending a check for \$6 for each tour to the Women's Council of the West Texas Museum Association, P.O. Box 4499, Texas Tech University, Lubbock, Texas 79409.

For additional information, contact the WTMA office at 742-2443.

## Government to plan set-aside program

With a lot of cotton being produced this year, prices are down. This dilemma may lead the government back into agriculture to create a cotton set-aside program—a program in which farmers would be paid not to grow cotton on a certain amount of their land.

"Interest in set-aside programs always increases when production is up and prices are down," says Dr. Ron Knutson, economist in marketing and policy with the Texas Agricultural Extension Service, Texas A&M University System. "Since Secretary of Agriculture Block recently announced a 15 percent wheat set-aside, interest has grown regarding a similar program for cotton."

Such a program would be optional for cotton farmers, explains Knutson. If they opted to participate, they could not plant cotton or any other crop for harvest on the deferred acres. Failure to set aside the acreage specified once in the program would result in the farmer losing any benefits from farm programs, including target prices and loans.

How much would a set-aside program help cotton prices?

"Based on past experiences with set-aside programs, a 15 percent set-aside would result in only a 3 to 5 percent decrease in production," points out

Knutson. "This reduced production would roughly increase cotton prices by 5 percent."

One reason why production would not be reduced more with such a set-aside program is that only one-half to two-thirds of the farmers normally participate. Also, those who do put their poorest land into the program and increase inputs on the remainder of their land to boost production.

So, cotton farmers and their organizations need to ponder the possible effects of a set-aside program as they study the issue, suggests Knutson.

### IT'S A FACT

Animal engineering is working to help improve the quality and quantity of mohair garments while boosting producer profits. Selective breeding demonstrations conducted by the Texas Agricultural Extension Service and ranchers are providing convincing evidence of the economic value of selecting breeding. Getting high producing, high quality Angora goats together through selective breeding systems increased last year's profits \$6.25 per head for at least 20 West Texas goat producers. This is another example of "The Extension Way—People Helping People."

**ADAM'S WELL SERVICE**



Floydada 983-5003

**FEDERAL LAND BANK ASSOC. OF FLOYDADA**



Floydada 983-2480

**RUSSELL'S EQUIPMENT & SUPPLY**



Floydada 983-3751

This space available call 983-3737

**FLOYDADA COOPERATIVE GINS INC.**



Floydada 983-2884

**ANSLEY & SON**



Lockney 652-3361

**MARTIN & COMPANY**

Floydada 983-3713

**SUN-VUE FERTILIZER**



Lockney 652-3362

**RUCKER'S O.K. TIRE STORE**



Floydada 983-3370

**FLOYD COUNTY IMPLEMENT**



Floydada 983-3732

**CASE POWER & EQUIPMENT**

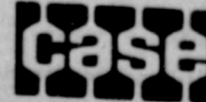

Floydada 983-2836

**FIRST NATIONAL BANK OF FLOYDADA**



Floydada 983-3717

**BROWNS IMPLEMENT**

**FLOYD COUNTY FARM BUREAU**

**FLOYDADA IMPLEMENT**

**CORNELIUS SERVICE**

**CONOCO**

**THE TYE COMPANY**

**MUNICIPAL ELEVATOR**

**CONSUMERS ASSOC.**

**COOP**

**PRODUCTION CREDIT**

ner swat  
are swathing  
feed and  
The weath-  
and dry.  
of Floydada  
at the Assem-  
Saturday morning  
parents. Mr.  
Foyus Fortenber-  
he had spent  
Traca  
who won  
ing school  
in the fi-  
picture w  
window  
office.  
The o  
Tuesday  
Hall of th  
Church v  
acting as  
Fortenber  
and Norm  
Shawna  
of the la  
killed Fri

### Follow-Up To



Thanksgiving turkey is a  
ment. What next? A "bren-  
case. Here's a rich but easy re-  
cipes for pumpkin and pie filling a  
Fashio your pie with pec-  
chill at least 2 hours. Fol-  
to become one of your "star-  
ell.

**Celestial Pumpkin Pie**

**1/4 tea-**  
1 cu-  
1 tab-  
1 cu-  
1 cu-  
1 cu-  
1 cu-  
1 cu-  
1 cu-

**1/2 tea-**  
1 cu-  
1 cu-  
1 cu-  
1 cu-  
1 cu-

**1/2 tea-**  
1 cu-  
1 cu-  
1 cu-  
1 cu-  
1 cu-

**1/2 tea-**  
1 cu-  
1 cu-  
1 cu-  
1 cu-  
1 cu-

**1/2 tea-**  
1 cu-  
1 cu-  
1 cu-  
1 cu-  
1 cu-

**1/2 tea-**  
1 cu-  
1 cu-  
1 cu-  
1 cu-  
1 cu-

**1/2 tea-**  
1 cu-  
1 cu-  
1 cu-  
1 cu-  
1 cu-

**1/2 tea-**  
1 cu-  
1 cu-  
1 cu-  
1 cu-  
1 cu-

**1/2 tea-**  
1 cu-  
1 cu-  
1 cu-  
1 cu-  
1 cu-

grazing stocker  
automatic profit

substantial losses the past two  
When venturing into the stocker  
business, accurate cost and return  
rates are crucial," notes Lovell.  
decisions in choosing the most  
able combination of calves and  
are dependent upon accurate  
ation cost estimates and correct  
ations of the future cash market

selected  
et 2000

exas A&M University at Gal-  
four agricultural agencies and  
the Texas Agricultural  
ent Station, the Texas Agricul-  
Extension Service, the Texas  
Service and the Texas Veterinary  
Diagnostic Laboratory; and  
Engineering services and agencies  
Texas Engineering Experiment  
the Texas Engineering Exten-  
Service and the Texas Transporta-  
tute.

project includes task forces on  
ic institutions, agricultural  
and services, and engineering

ry tours  
OC

November 6.  
tours will be January 20 to the  
Denim Factory, where the  
on is converted into cloth, and  
17 to the Texas Tech Univer-  
Research Center.  
are limited so early reserva-  
ould be made by sending a  
\$6 for each tour to the  
Council of the West Texas  
Association, P.O. Box 4499,  
h University, Lubbock, Texas

ditional information, contact  
A office at 742-2443.

o plan  
ram

"This reduced production  
hly increase cotton prices by

on why production would not  
more with such a set-aside  
is that only one-half to  
of the farmers normally  
Also, those who do put their  
nd into the program and  
puts on the remainder of  
o boost production.  
o farmers and their organiza-  
ponder the possible effects  
e program as they study the  
ests Knutson.

IT'S A FACT  
Engineering is working to  
the quality and quantity of  
ents while boosting pro-  
s. Selective breeding pro-  
s conducted by the Texas  
Extension Service and  
providing convincing evi-  
economic value of selecting  
ating high producing, high  
ra goats together through  
eding systems increased  
fits \$6.25 per head for at  
at Texas goat producers.  
ther example of "The  
Way—People Helping

T NATIONAL  
OF FLOYDADA



former swathing cane at Cedar Hill

farmers are swathing  
feeding feed and  
cotton. The weath-  
er and dry.

Harris of Floydada  
ch at the Assem-  
d Sunday morning  
grandparents, Mr.  
Cephus Fortenber-  
shom he had spent

Estimating livestock and  
duction costs is usually more  
than anticipating stocker  
shipping time next year. Mr.  
Lovell offers this example for  
the limited-profit picture for  
cattle operators. A 45-year-old  
would have to gain 250 pounds  
months on small grain pasture  
for 75 cents a pound to realize  
\$6.06 profit. Either a lower  
price, a lower rate of gain or  
average expenses would lower  
(This example is based on a  
purchase price of 68 cents a  
percent death loss, 16 percent  
rate and 1.25 acres of wheat  
costing \$101 per acre.)

ing Follow-Up To The Bird



the Thanksgiving turkey is gobbled up and the  
spend... what next? A "breather," then pumpkin  
course. Here's a rich but easy recipe that is enhanced  
flavor pudding and pie filling and prepared whipped  
mix. Fashion your pie with pecan halves (as shown)  
garnish of whipped topping. However you present it,  
to become one of your "star" desserts!

Celestial Pumpkin Pie

Stage (1-serving size) 1/4 teaspoon salt  
1/2 cup milk  
1 tablespoon butter or  
margarine  
1 can (16 oz.) mashed  
pumpkin  
1 cup prepared whipped  
topping  
1 baked 9-inch pie  
shell, cooled  
1/2 teaspoon pumpkin pie spice.  
the pie filling mix, sugar, spices and salt in saucepan.  
Add butter. Cook as directed on package for pie.  
from heat and blend in pumpkin. Then return to heat  
until mixture is bubbly, stirring constantly. Remove  
and chill at least 2 hours. Fold in whipped topping  
into pie shell. Chill at least 2 hours. Garnish with  
prepared whipped topping and pecan halves, if

Traca was among those  
who won places in the color-  
ing contest last week at  
school. She won third place  
in the first grade and her  
picture was displayed in the  
window at the Hesperian  
office.

The election was held  
Tuesday in the Fellowship  
Hall of the Cedar Hill Baptist  
Church with Martha Taylor  
acting as judge and Latrica  
Fortenberry, Grace Lemons  
and Norma Welch as clerks.

Shawna Wolfe, daughter  
of the late Cliff Gilly was  
killed Friday evening when

she and her husband Jaime  
Wolfe of Martinville were  
sponsoring a group of  
church rally on a hayride and  
the trailer was struck by a  
car. Shawna and Jaime were  
taken to the hospital in  
Indianapolis and Shawna  
died on the way. It was  
expected that Jaime would  
be dismissed Monday and  
funeral services would be at  
the Assembly of God church  
in Martinville where he pas-  
tors. Shawna was 31 Thurs-  
day. Her body will arrive in  
Floydada Thursday and fun-  
eral services will be at the  
Assembly of God Church  
Friday at 2 p.m. and inter-  
ment will in the Floydada  
Cemetery. She is survived by  
one sister Melonie Parsons of  
Floydada.

Edna Gilly went to Lub-  
bock Friday to attend to  
business.

Edna Gilly visited Malonie  
and Freddie Parsons in Flo-  
yadda Sunday. She visited her  
mother Ruthie Clark in Plain-  
view Thursday night.

Funeral services for Min-  
nie Irene Whitehead, 75,  
were held Saturday at 3 p.m.  
at the Davis Funeral Chapel  
in Georgetown with the Rev.  
Cecil Alexander officiating.  
She died Friday morning in  
Georgetown hospital after a  
lengthy illness. She was a  
long time member of the  
Cedar Hill Baptist Church  
when they lived in the com-

unity. She is survived by  
her husband Wayne Oliver,  
one son, Billy Ray of Green-  
ville, four daughters, Doris  
Marry Field of San Angelo,  
Marjorie Doss of Crosbyton,  
Mary Lou Shattuck of Thorn-  
ton, California and Corine  
Noblitt of Houston. 14 grand-  
children and 15 great grand-  
children; three brothers,  
Bonnie Cox and Frank Cox of  
Austin, Henry Cox of Corpus  
Christi; three sisters, Alice  
Johnson of Mathis, Mildred  
Schwartz and Florene Deni-  
son of Austin. She was a  
sister-in-law to J.B. and Ce-  
cil Whitehead of Floydada.  
Little Whitney Tucker, in-  
fant son of Bruce and Missy  
Conner was able to return  
home Friday after spending  
three days in the Lockney  
General Hospital. We trust  
he will have a speedy recov-  
ery.

Mrs. Peat Kelley and Nor-  
ma Welch visited Whitney  
Tucker Thursday.

Mr. and Mrs. Jim Conner  
visited J.B. and Cecil White-  
head in Floydada Friday  
afternoon.

Patsy Boone of Lubbock  
spent from Wednesday until  
Sunday with her parents,  
Tom and Gladys Fortenber-  
ry. Elwauna Taylor of Lock-  
ney visited with them Satur-  
day afternoon.

Many times the troubles  
that are the hardest to bear  
are those which never come  
at all.

Pie Booklet Released

Graham crusts and Baked  
Alaska and Dutch Apple  
Tarts. Seventy recipes are  
included in all.

In addition to good eating,  
the booklet offers a bonus of  
three 10-cents off coupons on  
the purchase of Ready-Crust  
Pie Crusts. Helpful hints for  
pie preparation and Micro-  
wave tips to make fast work  
of softening and melting  
ingredients are also fea-  
tured.

You can get this new  
Kebleer Ready-Crust dessert  
recipe book (a\$1.25 value) by  
sending 75 cents along with  
your name and address to:  
Ready-Crust Recipes - Dept.  
110, P.O. Box 868, Munde-  
lein, IL 60060.

8 REASONS  
Why It Pays To Rent From:  
CASE POWER AND EQUIPMENT



1. Wide selection of the world's most popular products and sizes — you get exactly what you need.
2. Favorable rates — check our rates, you'll find them very competitive.
3. Like new or new machines — our fleet of equipment is kept like new — always!
4. Ready to go right now — call for the machine you need, and by the time you're here, we can normally have it ready for you.
5. Pay for the actual days you work — bring it back and the time clock stops. No idle equipment.
6. Easy to operate — every operator is familiar with most Case products. You get into production — fast!
7. We stand behind our products — if you have a problem, we'll be there — pronto!
8. Test Case — good way to find out if you like Case equipment — give our equipment every test.

For more information and courteous service call  
**CASE POWER AND EQUIPMENT**

Lubbock 3302 Slaton Hwy, Lubbock, TX 79404 806/745-4451  
Floydada 101 South 12, Box G, Floydada, TX 79235 806/938-2836  
Lamesa 902 South Dallas, Lamesa, TX 79331 806/872-5861

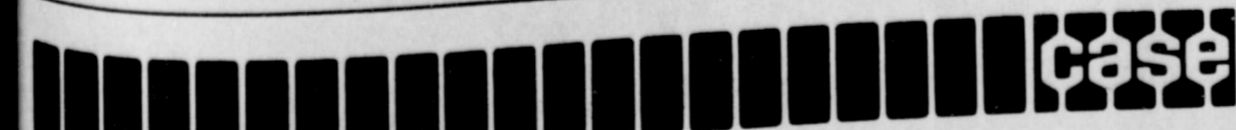

**America's Brand of Value**

**SALE**

SHURFINE FROZEN ORANGE JUICE **69¢**

6 btl. ctn. **COKES \$1.99**

32 oz.

SHURFINE DEVIL'S FOOD/WHITE/YELLOW CAKE MIXES **69¢**

SHURFINE CUT GREEN BEANS **3 18 OZ. CANS \$1.79**

SHURFINE BLACK PEPPER **79¢**

SHURFINE FRESH SHELLED BLACKEYE PEAS **69¢**

SHURFINE MARGARINE **79¢**

SHURFINE STRAWBERRY PRESERVES **\$1.19**

SHURFINE CHUNK STYLE DRY DOG FOOD **\$3.99**

ALL GRINDS SHURFINE COFFEE **\$1.69**

SHURFRESH BUTTERMILK/SWEETMILK BISCUITS **\$1.39**

SHURFRESH COLDY LONGHORN CHEESE **\$1.39**

SHURFINE FANCY TOMATO JUICE **89¢**

SHURFINE FROSTED 60/75/100 WATT LIGHT BULBS **69¢**

SUNSHINE COOKIES **\$1.29**

CHIP-A-ROO'S SHURFRESH AMERICAN FOOD CHEESE **\$1.49**

SHURFINE WHOLE KERNEL GOLDEN CORN **89¢**

ALL PURPOSE SHURFINE FLOUR **79¢**

ASSORTED FLAVORS BORDEN'S ICE CREAM **\$1.59**

Lockney's **ALLSUP'S** CONVENIENCE STORES

"THERE'S ONE NEAR YOU"

PRICES EFFECTIVE NOVEMBER 1 THRU 7, 1981 WHILE SUPPLIES LAST

GRANULATED SHURFINE SUGAR **\$1.15**

5 LB. BAG

CHUNK STYLE LIGHT SHURFINE TUNA **79¢**

6 1/2 OZ. CAN

SHURFINE PINK SALMON **\$1.99**

SHURFINE SALTINE CRACKERS **59¢**

BORDEN'S COTTAGE CHEESE **79¢**

SHURFINE ALUMINUM FOIL **\$1**

SHURFINE WHOLE PEELLED TOMATOES **\$1**

SHURFINE STRAINED CRANBERRY SAUCE **\$1**

SHURFINE CATSUP **99¢**

BUY A DELICIOUS **BBQ BEEF SANDWICH** FOR ONLY **\$1.79** AND RECEIVE A 24 OZ. COKE **FREE!**

SHURFRESH HONEY BUNS **59¢**

SHURFINE PORK 'N BEANS **\$1**

SHURFINE WAFFLE SYRUP **\$1.09**

SHURFINE ASSORTED FLAVORS COLA **89¢**

SHURFINE EARLY HARVEST SWEET PEAS **89¢**

SHURFINE SPINACH **79¢**

MORTON BEEF/CHICKEN POT PIES **\$1**

SHURFINE TOMATO SAUCE **89¢**

PEAK ANTI-FREEZE **\$3.99**

## Requirements set for food stamps recipient

The U.S. Department of Agriculture issued new rules requiring food stamp recipients in large metropolitan areas to show photographic identification when receiving their food stamps.

Secretary of Agriculture John R. Block said the new photo ID system "will play

an important role in joint efforts by the U.S. Department of Agriculture and Justice to crack down on abuse of the food stamp program."

Under the new rules, USDA will no longer replace food stamps reported lost or stolen. Block said these and

other major anti-fraud measures are part of the Reagan administration's overall effort to eliminate fraud and abuse in the federal food stamp program.

State welfare agencies will be required to institute photo ID systems within a year in food stamp project

areas with 100,000 or more recipients, unless they get an exemption from USDA's Food and Nutrition Service. Smaller food stamp project areas may also be required to install photo ID systems if the FNS and USDA Inspector General's office finds it useful to protect program integrity.

"The new photo ID system is principally designed to prevent the issuing of duplicate benefits," Block said. "For example, if a food stamp authorization card is stolen from the mail, the photo ID requirement can prevent an ineligible person from using the authorization card to obtain food stamps illegally. By recording and cross-checking ID numbers, the new system will discourage individuals from attempting to get a double allotment of food stamps by reporting their first authorization card lost or stolen and requesting a second."

"Individuals caught defrauding the government in this program are subject to both criminal and civil penalties. Further, under new legislation recently passed, individuals would be required to pay back any fraudulent benefits received by having future benefits reduced," Block said.

The City of New York, which has had a significant problem with duplicate food stamp issuance, will be the first to implement the new photo ID system. New York plans to begin using the ID system November 1, in conjunction with other new controls which have already cut the rate of authorization card replacements by two-thirds.

In New York and other areas where the photo ID card is mandated, all food stamp households will be required to have a member or an authorized representative of the household get and use the ID card as a condition of eligibility. Exceptions can be made for such cases

as an elderly or disabled person who is unable to come to the food stamp application office.

Other new rules will tighten procedures for replacing food stamp coupons and authorization cards which recipients report lost, stolen or destroyed.

Under the new rules, coupons reported lost by or stolen from recipients will no longer be replaced. However, in certain disaster situations such as floods or fires, destroyed coupons may be replaced once in a six-month period. In the past, any food stamp recipient could receive a replacement for their food stamps if they were reported lost or stolen. Such a policy has led to widespread abuse in some areas.

Limits will be placed on the frequency and condition under which local welfare agencies can replace authorization cards lost in the mails or destroyed in a fire or similar disaster.

Block said these new rules represent only the start of a number of new procedures the Food and Nutrition Service will be issuing in the food stamp program designed to reduce fraud, improve program management and assure that benefits go to those actually in need.

The new rules are published in today's Federal Register.



THESE GHOSTS WERE ROAMING the halls of R.C. Andrews Elementary before Halloween. They are left to right: Lady McBeth, Bill and the Shotgun Sal, Lady in Mink and Queen Cannon.

## A NEW COOK IN THE KITCHEN

There's a new cook in the kitchen... a cook who's preparing food for fewer people (often only himself or herself), has less time to spend over the stove and who can select from a multitude of food options other than "home-cooked" to get dinner on the table. This new cook is a reflection of the changing structure of the American household.

Since the beginning of the century, the average household size has declined from 4.76 to 2.81 and is expected to drop to 2.6 by 1985. While the female member of the family is still likely to do most of the cooking, she now has less time to spend in the kitchen. Today, 60% of women, ages 20 to 64, work outside the home. And 53% of these women also have children.

Today's consumer has the option of selecting from an increasing variety of convenience foods. In 1900, all bread was homemade. Frozen food made an entrance in 1929. And, the first cake mix was introduced only 30 years ago.

These changes mean families do less home cooking and, therefore, purchase staples, such as flour, in smaller packages. In 1930, the 25-pound sack of flour was the best selling size. Today, it's the 5-pound sack. Many consumers prefer even smaller sizes, such as the 2-pound sack and 13.5-ounce shaker of Gold Medal Wondra\* flour.

While home cooking hasn't ceased, recipes must be quick and easy. Here's one that makes good use of leftover turkey or chicken. A real time-saver comes from using Wondra flour, which lets you mix the creamy sauce in seconds because it dissolves instantly and lump-free in cold water.



TURKEY TETRAZZINI

- 1 package (7 ounces) thin spaghetti
- 2 cups turkey or chicken broth (cool)\*
- 2 cups half-and-half or milk
- 1/2 cup Gold Medal Wondra\* flour
- 1/4 cup margarine or butter
- 1/4 teaspoon salt
- 1/4 teaspoon pepper
- 2 cups cut-up cooked turkey or chicken
- 1 cup sliced pitted ripe olives
- 1/2 cup slivered almonds
- 1 cup shredded Cheddar cheese (about 4 ounces)

Cook spaghetti as directed on package; rinse under running cold water and drain. Heat oven to 350°. Mix broth, half-and-half, flour, margarine, salt and pepper in 3-quart saucepan. Heat to boiling over medium heat, stirring constantly. Boil and stir 1 minute. Stir in spaghetti, turkey, olives and almonds. Spread in ungreased rectangular baking dish, 12x7 1/2 x 2 inches. Sprinkle with cheese. Bake uncovered until hot and bubbly, 25 to 30 minutes. 6 servings.

\*Chicken broth can be made by dissolving 2 chicken bouillon cubes in 2 cups boiling water. Or use canned broth or broth from cooked chicken breast meat.

## Caprock Hospital Report

- October 26-November 2**
- Ramon Cuellar, Floydada, adm. 10-6, continues care.
  - Ella Finley, Floydada, adm. 10-6, continues care.
  - Florence Simpson, Floydada, adm. 10-12, dis. 10-29, Hong.
  - Vena W. Hendricks, San Jon, New Mexico, adm. 10-13, dis. 10-26, Havasi.
  - Pablo Salguero, Lockney, adm. 10-18, continues care.
- November 9-13**
- Monday: Beef stew with vegetables, cabbage slaw, green peppers, cornbread, margarine, apricot cobbler, milk, tea, coffee.
  - Tuesday: Fried chicken, cream gravy, buttered rice, buttered broccoli, roll, margarine, custard, milk, tea, coffee.
  - Wednesday: Seasoned pinto beans, ham cubes, buttered carrots, sliced tomatoes, cornbread, margarine, bread pudding with pineapple sauce, milk, tea, coffee.
  - Thursday: Macaroni, cheese, ham casserole, buttered green beans, lettuce, tomato salad, roll, margarine, cherry cobbler, milk, tea, coffee.
  - Friday: Oven fried fish, tartar sauce or catsup, potatoes au gratin, buttered mixed vegetables, roll, margarine, banana pudding, milk, tea, coffee.
- October 26-31**
- Francisco Benitez, Floydada, adm. 10-19, dis. 10-28, Hong.
  - J.B. Henslee, Hale Center, adm. 10-19, continues care, Hong.
  - Hilda Rodriguez, Floydada, adm. 10-20, dis. 10-27, Acar.
  - Barbara Hernandez, Floydada, adm. 10-22, dis. 10-29, Hong.
  - Gertrude Hollums, Floydada, adm. 10-25, dis. 10-28, Jordan.
  - Mary A. Austin, Oton, adm. 10-25, continues care, Hong.
  - Vastie Sanchez, Floydada, adm. 10-26, dis. 11-1, Jordan.
  - Teddy Jordan, Floydada, adm. 10-26, dis. 10-30, Hong.
  - Angelita Aguilar, Lockney, adm. 10-26, dis. 10-28, Hong.
  - Donna S. Yeary, Floydada, adm. 10-27, dis. 10-29, Jordan.
  - Deborah Martin, Matador, adm. 10-27, dis. 10-29, Hong.
  - Daniel M. Cortinas, Floydada, adm. 10-28, dis. 10-30, Hong.

## Sr. Citizen Menu

- November 9-13**
- Monday: Beef stew with vegetables, cabbage slaw, green peppers, cornbread, margarine, apricot cobbler, milk, tea, coffee.
  - Tuesday: Fried chicken, cream gravy, buttered rice, buttered broccoli, roll, margarine, custard, milk, tea, coffee.
  - Wednesday: Seasoned pinto beans, ham cubes, buttered carrots, sliced tomatoes, cornbread, margarine, bread pudding with pineapple sauce, milk, tea, coffee.
  - Thursday: Macaroni, cheese, ham casserole, buttered green beans, lettuce, tomato salad, roll, margarine, cherry cobbler, milk, tea, coffee.
  - Friday: Oven fried fish, tartar sauce or catsup, potatoes au gratin, buttered mixed vegetables, roll, margarine, banana pudding, milk, tea, coffee.

Simple reasoning will tell you — if saving stamps have a redemption value, some one has to be paying for the redeemed merchandise.

Ask yourself, "Who is paying for stamps?"

# PIGGLY WIGGLY

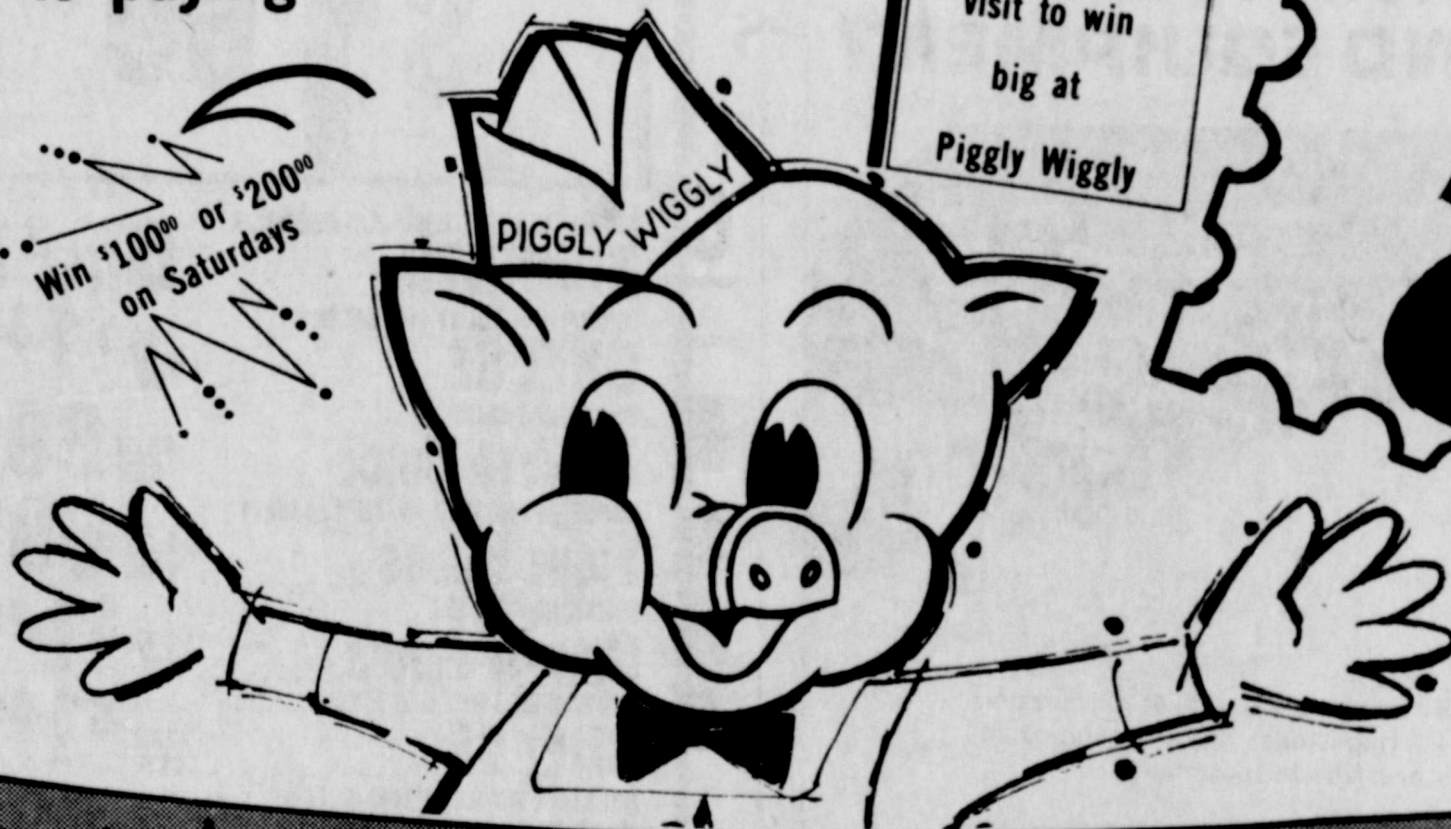

Win \$100<sup>00</sup> or \$200<sup>00</sup> on Saturdays

Win \$50<sup>00</sup> or \$100<sup>00</sup> each day

# WIN BIG DAILY

309 S. Wall

Floydada, Texas

**NELES MS** 2-4 lb. avg. weight Carv. Half

**2.1**

fresh Turkeys lbs. & up

Daily 8:00 a.m. to 8:00 p.m.  
Monday 9:00 a.m. to 7:00 p.m.

**PIGGLY WIGGLY**

effective Thurs. Thru W

5 lb.

2 lb. bag Imperial **POWDERED SUGAR**

16 oz. can **PMPKIN**

2-10" per **SHELLS** Campbell **CHIC**

Campbell's **Chicken Noodle SOUP**

4







# EXTRA

Hot Off The Press!

**EXTRA** Get the whole scoop on news, sports and entertainment... every day!

**EXTRA** We'll spread your word all over the community when you advertise with us!

**EXTRA** Get big buy lines in our classified pages!

It is our desire to give you a paper to be proud of. You can do that by helping us improve our service to you. If you would like to subscribe for the paper by mail, please fill out the coupon below and mail it to us. If for any reason your paper is being delayed because of an incorrect address, please fill out the coupon below and mail it to us for better service.

Thanks for your cooperation.

Check One . . .  New  Corrected

NAME \_\_\_\_\_

ADDRESS \_\_\_\_\_

## The Lockney Beacon

652-3318  
220 S. Main Street,  
Lockney, Texas 79241

**PLATTER**  
SALE PRICE **2.99** EACH  
SIZE 13 1/2" x 17 1/4"

4 Quart Size **15.44** EACH  
SALE PRICE  
HARVEST  
1-QUART SERVER

**HEADQUARTERS**  
WEST BEND **ELECTRIC**  
QUICK DRIP **POPCORN**  
COFFEEMAKER **POPPER**

**TOASTER**  
SALE PRICE **1.77**