

THE LOCKNEY BEACON

The Only Medium Covering The Rich Irrigated Section Of Floyd County.

VOLUME 47

LOCKNEY, FLOYD COUNTY, TEXAS, FRIDAY, JANUARY 21, 1949

NUMBER 20

Results Of The Sleet Storm



—Photo by Jay Ed Parsons

Pictured here are the results of the sleet storm which struck this area the first of last week. The roof over the main auditorium of the Lockney Baptist Church and the sidewalls collapsed dropping down upon the pews and other furniture. No one was in the building at the time. The

building was completely wrecked and the local congregation do not plan to try to salvage any part of it, it was indicated this week. Some idea of the weight on the roof may be taken from: The Spears gin scales are 10x60 feet, totaling 600 square feet. The sleet and ice on the scales weighed

6900 pounds as it fell, Mrs. Spears reported. This is 11½ pounds per square foot. The auditorium roof measured 50x60 feet, making a total of 3,000 square feet. At 11½ pounds per square foot the roof had 34,500 pounds or more than 17 tons of sleet and ice on it.

Road Meeting At Sterley Tuesday

A road meeting will be held at the Sterley Club house next Tuesday night weather and roads permitting. It was announced this week by Hugh Counts, commissioner of Precinct 2. The purpose of the meeting is to discuss the paving of a road from the Lone Star road into Sterley and a number of people interested in the roads are expected to be present.

Some members of the Commissioners Court as well as James F. Potts, highway resident engineer of Floyd County, will be present, it was reported. All people of the Sterley area are urged to attend.

Church Building Being Wrecked

The remains of the Lockney Baptist Church building is being wrecked this week and the lumber, brick and other usable material being salvaged. The roof of the church collapsed Wednesday night of last week under the weight of sleet and ice and the building was almost completely demolished.

Although no official action has been taken by the church membership as yet, most church officials were of the opinion that the building would be built back at the same location. There has been some talk of moving the building.

Plans are already being made for the new building and the building committee consisting of Edgar Hays, chairman, Horton Howell, C. O.

CONTRIBUTIONS ACCEPTED

Because of the fact that a number of friends of the Lockney Baptist Church have said that they want to contribute to the rebuilding of the church building. J. B. Allen, treasurer of the church has announced that he will be at The Beacon office on Friday, Saturday and Monday of this week end to accept money for this purpose.

Others who will accept money for this purpose are: Harmon Handley, Horton Howell, Leslie Ferguson, Edgar Hays, J. B. Seale, Sid Thomas, E. J. Cobb, Hugh Carroll, John Hedel, Hilburn Casey, Bert Bobbitt, Robin Byars, or other members of the church.

Roberts, Leslie Ferguson, Hugh Carroll, Harmon Handley and Mrs. Hilburn Casey, have had two meetings discussing the building needs and possibilities.

Meanwhile the church was also making plans to raise the necessary funds to construct the new building. Members laid down \$6,000 last Sunday morning toward the new building and other money has come in since in addition to the building fund the church already had.

Church officials are estimating that a new building to meet the needs of the church will cost probably \$100,000. The church has slightly less than one-fourth of that amount on hand at this time.

Help from outside sources has reached the church this week. A number of people of Lockney, not members of the church, have donated to the building fund. A letter containing a check from Rev. C. J. McCarty, former pastor of the church, now pastor at Calvary Baptist Church in Lubbock, was received the past week end. Rev. McCarty's letter follows:

"Dear Christian Friends:
"It grieved my heart to learn of the destruction of your splendid building. Enclosed is a check to help you on your building fund and I feel sure that the people will rally and go forward in a great way. I know that you can and will build again and that the Lord will bless you in so doing. I assure you of my love and my earnest prayers and I pray that the Lord's blessings may be upon each and everyone of you and upon the church as a whole.
Your brother in Christ,
C. J. McCarty"

A letter has also been received from Mr. and Mrs. Mitt Bullard of Lubbock and other friends of the church.

Church services are being held at the city auditorium.

Rates Of Pay Under 1949 ACP Announced

This week the rates of payment for the 1949 practices under the Agricultural Conservation Program were announced by Ray S. McEntire, Administrative Officer of the PMA. In announcing the program, he said: "In order for the farmer to take advantage of the offer of our Government to assist him to do additional conservation work needed on his farm in 1949, it is necessary for him to:

1. Apply to the county office for the amount of assistance he will need for carrying out each practice. The farmer must get county committee approval of assistance before beginning the practice.

2. Carry out the practice in accordance with the specifications. The detailed specifications for each practice are available at the county office.

3. Complete the practice and so inform the county committee or county office within the time fixed by the county committee.

The amount of assistance for each farmer will be determined by the county committee on the basis of conservation needs, the Congressional limit of \$750, and the amount of funds available to the county.

Requests for assistance may be made by contacting the county committee, or by writing, telephoning, or calling at the county office. The office is located in the Agricultural Building, Floydada, Texas. Telephone 306.

Written Approval Required

Subject to written prior approval and the \$750 limitation to any person under the 1949 program, the following practices are eligible for payment:

Terrace construction: Large ridge terraces—1½¢ per foot; Small ridge terraces—1¢ per foot; Diversion terraces—5¢ per cubic yard;

Subsoiling 12 inches or more for water penetration: \$1.50 per acre.

Deep plowing of sandy cropland at least 20 days prior to seeding: 12-15 inches, \$1.50 per acre; 15-18 inches, \$2.00; 18 over, \$2.50.

Leaving on land at least until January 1, 1950, stalks, not grazed: 25¢ per acre.

Control of bindweed: Continuous cultivation—\$7.50 per acre; Chemicals—2-4-D, \$1.60 per pound; sodium chlorate or calcium chlorate, 5¢ per pound.

Leveling for irrigation: 8¢ per cubic yard where 50 cubic yards or more earth moved; \$1.00 per acre (Routine floating will not qualify. Payment will not be made for leveling and that was leveled for payment under previous program.)

Reorganization of irrigation system: Permanent ditches—8¢ per cubic yard; Concrete construction—\$10 per cubic yard; Corrugated cul—(Continued on Page 4.)

Organ Programs Postponed Again

The Josey-Totzien musical program set for tonight (Friday) at the Methodist Church and the dedication program scheduled for Monday night have been postponed indefinitely. W. J. Griffith announced Thursday. The reason for postponement is the inclement weather and the fact that no favorable weather is in sight at this time.

It is planned now to hold the program later on probably in the early Spring.

Thursday Markets

Poultry	
Heavy Hens, 4 lbs. and over	26c
Light Hens, under 4 lbs.	24c
Cocks, pound	12c
Eggs, No. 1, dozen	37c
Cream	
Butterfat, No. 1, lb.	60c
Butterfat, No. 2, lb.	58c
Hides	
Hides, No. 1, pound	12c
Grain	
Wheat per bushel	\$2.09
Milo, per cwt.	\$2.10
Alfalfa Hay	
Trucker's price, No. 1 per ton, in barn	\$32.50
Cotton	
Spot cotton, middling, Dallas market	32.7
Cottonseed, per ton	\$70

Hammonds In Car Wreck

I. Hammonds, about 60 years old, farmer and stockman of Floyd County, was killed Sunday, when he lost control of his car on the Wells-Floydada road. The accident occurred on the Fork Ranch headquarters. Hammonds was driving west on the road. He was by himself. His body was found on the road by an unidentified motorist. The King County Sheriff's office is conducting an investigation of papers on the car. The sheriff determined that the car was a 1933 Ford. Sheriff Leland A. Hart. Hammonds' car was found wrecked near

Hammonds, the widow, lives in Mineral Wells, where she had been for the past six years. She was notified and arrived in Lockney yesterday afternoon.

Hammonds was in the farm implement business here and at Floydada for years until about three years ago when he moved to a residence in 1903, coming here from Oklahoma.

He is the widow, survivors include one daughter, Mrs. Dan Hammonds, who is in Germany with her husband, a member of the Army Air Corps; four sons, Hershel Hammonds of Pampa; Jimmie Hammonds of Pampa, a pilot with TWA; and several other children.

Domino Benefits and Dimes

Titles the March of Dimes here the Lockney Business & Commercial Women's Club will give a "42" and domino party in the Baker building on Monday, January 31, starting at 7 p. m. Admission of 50¢ each will be charged and everyone is invited to attend and enjoy the party.

Chevrolet Display At Sney Auto Sat.

Product of three years' development and more than a million dollars of engineering research, the Chevrolet goes on display in the Sney Auto Co. showrooms here

Friday. The new model has been completely redesigned. It is lower, wider and more distinctive than any previous model.

Not only does the design in the new Chevrolet show superior beauty to the lowest priced cars, but numerous body and interior improvements promise to add to the Chevrolet's reputation for comfort and convenience. A series of new Fleetline models, including the De Luxe, are included with the new Chevrolet. The line-up includes the new De Luxe, the new Fleetline, and the new Fleetline coupe.

Two and four-door sedans. This design is distinguished by tension of the roof line in an over sweep to the rear. Known as a "fast back," the new Chevrolet achieved great popularity on the two-door Aerosedan.

Two and four-door sedans, coupe, three-passenger business convertible, wood and all-weather wagons. Styleline sedans the "notch back." Here the rear of the roof meets the rear body belt line.

Both styling and performance. The new Chevrolet continues the "big car" tradition that has always been associated with Chevrolet. The design is substantial-looking with a bold, forward-looking appearance. Great strength is reported demonstrable in the new Chevrolet. The rugged under-valve-in-head engine fundamentally the same, but with increased compression, will increase appreciably the handling ease and owner's satisfaction.

First impression of the new cars is smart styling, structural rigidity and generous dimensions. The new passenger compartment is moved forward, lengthened, and lowered, affording a better balance in proportions. Rear front fenders have been moved into the body, their vertical bulk flush with the doors. The fenders have also been

(Continued on Page 3)

GO TO CHURCH SUNDAY

Annual Meet Of Co-op Hospital Set For Monday

The annual meeting of the membership of the Floyd County Co-operative hospital will be held at the City Auditorium in Lockney Monday afternoon starting at 2 o'clock. It was announced this week by J. D. Copeland, business manager.

The meeting will be an important one and all members of the hospital are urged to attend. Auditors for the hospital will make an annual report of the financial condition. Also two directors will be elected at the meeting. The terms of Bernard Harris and Ewald Quebe expire at this time.

Roscoe Snyder New President Of City National Bank

At the regular annual meeting of stockholders of the City National Bank of Plainview, directors elected M. Roscoe Snyder president, elevating him from a vice-presidency, to succeed John W. Murchison, who becomes a vice-president of the bank as he has done on occasion before. W. C. (Crofford) Heffelfinger was elected an assistant cashier and other officers were re-elected. The staff of officers are G. H. Shriber, chairman of the board; M. R. Snyder, president; J. W. Murchison, vice president; J. D. Scott, vice-president and cashier; H. M. Hamilton, vice-president; Inez Vaughn, assistant cashier; W. C. Heffelfinger, assistant cashier.

Snyder was also elected a director of the bank, the re-elected directors being A. S. Underwood, G. H. Shriber, J. W. Murchison, J. D. Scott and H. M. Hamilton.

(Continued on back page.)

(Continued on back page.)

JUST

Short Changed
Ticket Seller—You will have to change twice before you get to New York.

Lady — Goodness me; I have only this one traveling suit I'm wearing.

It All Depends
Kind Old Gentleman—What's your little brother's name?
Buddy—His name would be Jack if he was my brother, but he ain't, and her name is Ruth.

Thrown Over
"I haven't seen your brother lately."
"No, he's in a hospital. His girl threw him over."
"That shouldn't have made him go to a hospital."
"Oh, but she threw him over a cliff!"

Balanced Personality
"My friend," said the missionary, "are you traveling the straight and narrow path?"

In silence the man handed over his card. It read: "Signor Ballancio, Tightrope Walker."

More Than 300 Women Now Serve in State Department

There are upward of 300 women serving as staff officers with the state department's foreign service. They are scattered around the globe, with jobs ranging from administrative assistant to the more modest cultural attache.

GUARANTEED TO POP
ALWAYS CRISP TENDER-DELICIOUS

JOLLY TIME POP CORN

How To Relieve Bronchitis

Creomulsion relieves promptly because it goes right to the seat of the trouble to help loosen and expel germ laden phlegm and aid nature to soothe and heal raw, tender, inflamed bronchial mucous membranes. Tell your druggist to sell you a bottle of Creomulsion with the understanding you must like the way it quickly allays the cough or you are to have your money back.

CREOMULSION
for Coughs, Chest Colds, Bronchitis

Doesn't it seem more sensible?

ALL-VEGETABLE LAXATIVE

NATURE'S REMEDY (NR) TABLETS—A purely vegetable laxative which relieves constipation without the usual griping, sickening, perturbing sensations, and does not cause a rash. Try NR—you will see the difference. Uncoated or candy coated—their action is dependable, thorough, yet gentle as millions of NR's have proved. Get 25c box and use as directed.

Nature's Remedy
NR TO-NIGHT

FUSSY STOMACH?
RELIEF FOR ACID
INDIGESTION
GAS AND
HEARTBURN

TUMS
FOR THE TUMMY!

CHANGE of LIFE?

Are you going through the functional "middle age" period peculiar to women (38 to 42 yrs.)? Does this make you suffer from hot flashes, feel so nervous, highstrung, tired? Then do try Lydia E. Pinkham's Vegetable Compound to relieve such symptoms. Pinkham's Compound also has what Doctors call a stomachic tonic effect!

LYDIA E. PINKHAM'S VEGETABLE COMPOUND

Kidneys Must Work Well

For You To Feel Well
24 hours every day, 7 days every week, never stopping, the kidneys filter waste matter from the blood.
If more people were aware of how the kidneys must constantly remove surplus fluid, excess acids and other waste matter that cannot stay in the blood without injury to health, there would be better understanding of why the whole system is upset when kidneys fail to function properly.
Burning, scanty or too frequent urination sometimes warns that something is wrong. You may suffer nagging backache, headaches, dizziness, rheumatic pains, getting up at night, swelling.
Why not try Doan's Pills? You will be using a medicine recommended the country over. Doan's stimulates the function of the kidneys and help them to flush out poisonous waste from the blood. They contain nothing harmful. Get Doan's today. Use with confidence. At all drug stores.

DOAN'S PILLS



"YOUR HUSBAND REMEMBERED TO MAIL YOUR PARTY INVITATIONS THIS TIME ONLY HE FORGOT TO PUT STAMPS ON 'EM!"



"OH, HE'S JUST A CASUAL ACQUAINTANCE. I HAVEN'T MET HIM YET!"

SILENT SAM



By Jeff Hayes

LITTLE REGGIE



By Margarita

MUTT AND JEFF



By Bud Fisher

JITTER



By Arthur Pointer

REG'LAR FELLERS



By Gene Byrnes

SUNNYSIDE



by Clark S. Haas

VIRGIL

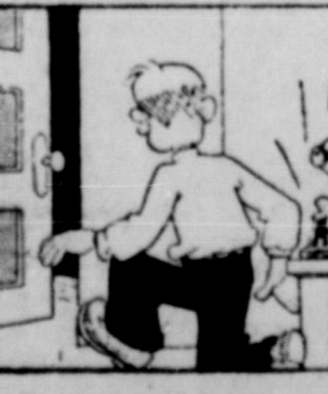
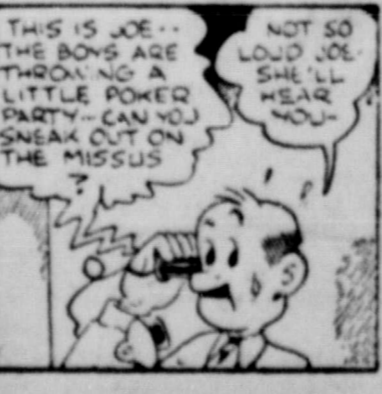

By Len Kleis

This Clown Wheel Will Please



TOYS that walk have been sure winners, why you will get as much making this clown who some youngster will have with it. The legs are fast with the wheel. As the wheel legs go up and down, tern offered below quick and easy method of this colorful toy. No special skill or materials are needed, pattern specifies exactly use and where to use each. A few pieces of wood, wire clothes hanger and dabs of paint is about need. In order to insure the clown properly, the ing guides on the pattern traced directly on the wood are then painted the color pattern suggests.

Send 25c for Clown Wheel No. 47 to East-Bild Patterns, Dept. W, Pleasantville, N. Y.

Cost of U. N. Is Low Compared With War

If the cost of maintaining United Nations and 12 of specialized agencies for were spread over the world, each person would pay about ten cents a year. Total cost of operation is \$35. This sum is only about thousandth of the annual cost of the second World war, thirds of the bill goes for refugees and displaced persons.

Getting Deaf

Thousands now know there is a way for letting deafness kill the joy of life. An amazing new radionic hearing has been perfected in the great Radio Laboratories—so simple—use it can be sent to you for 10 trial. Ready to wear, no fitting necessary. Accepted by the Medical Association, Council on Medicine. Come out of that silence. Write today for full details. Zenith Radio Corp., Hearing Division, Dept. 19-DL, 5801 Dick Chicago 39, Illinois. Made by the world-famous Zenith Radio Corp. Trial offer available on direct sales Radio Corporation of its subsidiaries.

BUY St. Jose

WHEN YOU WANT ASPIRIN AT THE

RELIEVE MISERABLE COLD

Thousands of satisfied users say you get quick relief of feverishness, aches, congestion. Try it yourself!

666

COLD PREPARATION

IN LIQUID OR TABLETS

SAME FAST RELIEF

DO YOU "RUN DOWN" AFTER 9 P. M.

Do late evening hours find you tired? Limp? Listless? Men and women especially over 30, often discover symptoms are due to blood-iron deficiency. When this is the cause, thousands of men and women with W. H. Bull's AND IRON. This amazing tonic-iron which helps enrich red blood cells. Other needed ingredients help stimulate, aid digestion. Try W. H. Bull's AND IRON—in tablets or liquid. Do any longer. Ask your druggist for details.

W. H. BULL'S HERBS and IRON

WNU-L

IF YOU WERE A WAC, MARINE or SP

Find out what Nursing offers you!

- an education leading to R. N.
- more opportunities every day in hospitals, public health, etc.
- your allowance under the G. I. Bill often covers your nursing course.
- ask for more information at the hospital where you would like to enter nursing.

Chevrolet—
 o fit more snugly into the
 d low, clean ensemble of the
 o add grace and protect body
 a partial rear fender has
 tained.
 the passenger's standpoint
 the chief improvement in
 is the immense increase in
 ea. All windows have been
 and widened. The windshield
 ll advantage of broader bod-

les, curving inward at the narrowed
 pillars to improve sideway as well
 as forward vision. On comparable
 models the gain in visibility over 1948
 has been as much as 30 per cent.
 Besides its intiuence on over-all
 balance in design, repositioning of
 the passenger compartment claims
 still other benefits. Rear seat passen-
 gers are now cradled in the comfort
 zone between the front and rear axles.
 (Formerly passengers rode over the
 rear axle.) Lowering of the compart-
 ment has reduced the center of grav-



THE GENERAL PATTON . . . Diminutive Mrs. George S. Patton Jr., with one hefty swing breaks a bottle of champagne over the new, low-slung tank named after her late husband, the famed general. During World War II, General Patton was a tough, hard-fighting, fearless armored force tactician and leader who continually demanded more and better armored equipment.

ty of the car, resulting in greater
 stability on curves and at higher
 speeds. Further, the lowered floor
 and wider doors permit easier en-
 trance and exit by passengers.
 Another important factor in better
 roadability is the adoption at the
 front and rear of direct double-acting
 absorbers, a type that proved itself
 in wartime service. Front suspension,
 which continues to feature the coil
 spring "Knee-Action" Chevrolet pioneered
 15 years ago, has been made
 sturdier.
 A new steering geometry will be
 found significant by drivers. The
 master arm is now located in the
 center of the chassis front end, equal-
 izing the effort of right and left turns.
 This type of steering, available pre-
 viously only in higher-priced cars, re-
 duces "wheel fight," any tendency
 of the car to "wander" and adds to

life.
 The gearshift is new. Recent de-
 velopments in shift linkage caused
 engineers to substitute the manual
 shift for the former vacuum-assisted
 mechanism. The lever remains on the
 steering column, but has been length-
 ened to equalize the effort of shifts.
 Although the six-cylinder valve-in-
 head engine is basically unchanged,
 several refinements have enhanced
 smoothness and service accessibility.
 The carburetor is improved and con-
 tains a "fast-idle" device. The ex-
 haust system has been "unitized" for
 improved sealing. A better hydraulic
 system and weight redistribution im-
 proves braking. Wheels are smaller
 and carry low-pressure tires.
 The atmosphere of luxury in the
 1949 Chevrolet interiors has been
 heightened by simplified seat con-
 struction, new fabrics and tasteful
 moldings, panelling and trim. Hard-
 ware is shaped close to the doors to
 prevent snagging of garments. Venti-
 pane handles have been eliminated
 by the adoption of push-pull window
 wings. New as well as is the method
 of door latching. Exterior door handle
 are solid with the release and lock
 mechanism built into a thumb button
 which extends from the truck of the
 handle.

Also notable is a new means of venti-
 lation. With the cowl vent omitted,
 fresh air is now drawn into the pas-
 senger compartment through ducts
 located between the front fender
 skirts and the radiator. These ducts
 lead to tubes ending at the dash. Air
 is metered by butterfly valves posi-
 tioned by manually operated knobs on
 the instrument panel.

In addition to the ventilation con-
 trols, the driver will find unusual
 features. The steering wheel is thin-
 ner and somewhat lowered to supple-
 ment the safe vision made possible
 by larger windows. Dials are grouped
 in a circular cluster on the face of
 the jumbo speedometer. Starting is
 by a button on the instrument panel.
 A nearby knob controls the windshield
 wiper, vacuumpowered and now es-
 pecially designed to hug the curvature
 of the glass. The emergency brake is
 a straight pull lever mounted below
 the dash at the right of the steering
 column.

While all of the other details of the
 1949 Chevrolet cannot be covered in
 a limited description, worthy of
 mention are: larger trunks equipped
 with automatic lock; rear compart-
 ment dome light doubled in candle-
 power; a concealed gasoline filler
 pipe, the tank now being located on
 the left side of the car; parking lamps
 built into the grille; a ball-bearing
 mounted front seat adjustment.

DARNELL GROCERY

Coffee White Swan 1 lb. can **49c**

Jello 2 for **15c**

Chocolates Sun Shine 1 lb. box **69c**

Razor Blades 3 10c pkgs. **19c**

leo Blue Bonnet Colored, quarters, lb. **43c**

MARKET

Sliced Bacon Pinkney's Pound **55c**

Sausage Pinkney's Pound **39c**

Beef Roast Choice Cuts Pound **53c**

Pork Chops Pound **49c**

Phone 128 for FREE DELIVERY

CELEBRATING OUR THIRD

Anniversary

THIS WEEK marks our THIRD ANNI-
 VERSARY in Lockney. During the three
 years we have been here we have made
 many friends and customers and we are
 deeply grateful to you for your reception
 of our business.

WE'RE BETTER EQUIPPED THAN EVER!

We are now better able to serve you both in
 equipment and personnel than ever before.
 Our complete service will meet your every
 need.

**CLEANING AND PRESSING
 ALTERATIONS AND REPAIR
 DYEING AND MOTH-PROOFING**

Made-To-Measure Suits

Let us measure you for a Made-to-Measure Suit in the new Spring
 styles. Our new samples will please you.

**Our Personnel
 IS ANXIOUS TO SERVE YOU!**

Mr. and Mrs. Claude Brown
 Bill Griffith
 Mrs. John Spradlin
 Raynita Martin

Brown's Cleaners

Phone 72

Aiken News

By Mrs. M. B. Salmon

Rev. and Mrs. Oran Smith visited
 Mr. and Mrs. Herman Stowe Monday
 night.

Mr. and Mrs. Bill Thompson made
 a business trip to Floydada Tuesday.
 Mr. and Mrs. L. T. Cox and Mr. and
 Mrs. Wiley Moore visited Mr. and
 Mrs. M. B. Salmon Wednesday.

Rev. and Mrs. Oran Smith visited
 friends at Amherst Wednesday and
 Wednesday night.

Mrs. Bill Thompson visited Mrs.
 Bill Wesley Thursday afternoon.

Mr. and Mrs. Fred Musgrove spent
 Thursday night a week ago with
 Mr. and Mrs. Herman Stowe.

Miss Leota and L. A. Compton visit-
 ed Mr. and Mrs. Vernon Campbell
 and Carolyn for awhile Wednesday
 night.

Mr. and Mrs. Arnold Langfeldt and
 Marion Ellen are proud owners of a
 new Plymouth.

Mr. and Mrs. Ivan Thompson and
 Mrs. Bill Thompson went shopping

in Lubbock Friday.
 Little Colene Thomas was ill last
 week. She was in Plainview Hospital
 for several days, but is home now and
 much improved.

Grandad Campbell has been moved
 from Blainview Hospital to his home
 in Plainview.

Mr. and Mrs. Fred Duval made a
 business trip to Plainview Friday.

Mr. and Mrs. Wiley Moore were
 guest Monday in the home of Mr. and
 Mrs. Arch Keys Jr. in Plainview.

Aiken Community received better
 than two inches of moisture last
 week.

Mr. and Mrs. Homer Starkie visited
 Mr. and Mrs. Jesse Starkie Monday
 night.

Lavon Howard was a guest in the
 home of Mr. and Mrs. Bill Wesley
 over the weekend.

Miss Virginia Compton of Lubbock
 was home Saturday night and Sunday.

Mr. and Mrs. K. W. Cook and son,
 Richard, spent last week in Bartles-
 ville, Okla., visiting his sister, Mrs.
 George Benson and family.

PARTY MINDED?

We have a new shipment of

Bridge Tallies

and

Paper Napkins

for all occasions

Valentine

George Washington's Birthday

Lincoln's Birthday

Pink and Blue Showers

Birthdays and

Party Pac's (paper table cloths and
 napkins)

For Children's Parties:

Plastic Animal Place Card Holders



YOUR DOCTOR IS CONCERNED!

Every prescription he writes is of vital concern to your
 doctor, who wants to be sure that it's filled exactly as written.
 We take any doctor's prescription and fill it accurately and
 expertly. For the utmost in professional skill bring every pre-
 scription here.

Powers Pharmacy

(Medical Center)

Day Phone 31

Night Phone 133-R

**NOTICE TO LOCKER
 BOX HOLDERS**

Your LOCKER RENT is now
 due and is payable during the month
 of January, 1949.

We will greatly appreciate it if
 you will let us know if you wish to
 turn your Locker Box back so we can
 pass the same on to someone on our
 waiting list.

All unclaimed boxes will be re-
 placed after February 1, this year.

Lockney Frozen Foods

**RADIATORS
 CLEANED AND
 REPAIRED**

Winter will soon be here and
 for protection of your car your
 radiator should be in good con-
 dition. Let us clean and repair
 it for you now before cold
 weather.

Parsons Radiator
 Service
 Rudd Parson, Owner

CITATION BY PUBLICATION
 THE STATE OF TEXAS
 TO: J. N. WATTS, and all persons claiming any title or interest in land under deed heretofore given to J. N. Watts of Taylor County, Texas, and the unknown heirs of the said J. N. Watts, if he be deceased, their heirs and legal representatives, Defendants, Greeting:

You are hereby commanded to appear before the Honorable District Court of Floyd County at the Court House thereof, in Floydada, Texas, at or before 10 o'clock A. M. of the first Monday next after the expiration of forty-two days from the date of the issuance of this citation, same being the 21st day of February A. D. 1949, then and there to answer Plaintiff's

Petition filed in said Court, on the 28th day of December, A. D. 1948, in this cause, numbered 3791 on the docket of said court and styled Charlie Smith, Plaintiff vs. J. N. Watts, et al, Defendants.

A brief statement of the nature of this suit is as follows, to wit: Suit by Charlie Smith as plaintiff against the persons first named and described in this writ, and to whom this writ is directed, as defendants, in trespass to try title, involving the following described premises situated in Floyd County, Texas: Lot Number Seven (7), in Block Twenty-three (23), Original Town of Lockney, Floyd County, Texas; plaintiff alleging that he was lawfully seized and possessed of such premises, claiming same in fee simple, on October 8, 1945, on which date defendants, unlawfully ejected plaintiff therefrom to plaintiff's damage in the sum of \$500.00, the reasonable rental value of the premises during the period of wrongful detention being \$500.00. Plaintiff praying for judgment for title and possession of the premises, for damages, costs, and general relief, as is more fully shown by plaintiff's petition on file in this suit.

The officer executing this process shall execute the same according to law, and make due return as the law directs. If this citation is not served within 90 days after issuance, it shall be returned unserved.

Issued and given under my hand and the Seal of said Court, at office in Floydada, Texas this 3rd day of January A. D. 1949.

Attest: Mary L. McPherson Clerk, District Court, Floyd County, Texas (SEAL) 18-4tc

Midas was given the power by the god Bacchus to turn all that he touched into gold.

Distance from the earth to the sun is 92,897,400 miles.

ACP Payments—

verts 14" to 18"—\$1 per foot; Concrete culverts 14" to 18"—50c per foot; (Other sizes will be approved at a proportional rate.)

Drilling water wells for range: 4 to 6 inch casing—\$2 per foot, 6 inch or over casing—\$3 per foot.

Construction earthen dams and reservoirs: 10c per cubic yard for dams and 8c per cubic yard for damless tanks.

Elimination of destructive plants on range land: limited to \$5 per acre.

Mowing weeds in pastures: 50c per acre.

Deferred grazing: 12c per acre. Constructing fireguards: 6c per 100 feet.

Seeding adapted pasture grasses or pasture legumes: (Inquire at office for rates.)

Growing a green manure or cover crop of summer legumes: (Inquire at office for rates.)

Application of superphosphate to alfalfa, other legumes, and pastures: 20%—\$1.02 per 100 lbs. (Inquire at office for other rates.)

Practices Limited to Dry Land Farms Only

Managing crop residues to protect summer fallowed acreage: 60c per acre.

Managing crop residues to protect cropland from wind erosion: 30c per acre.

Contour listing, chiseling, cross-slope chiseling, basin listing, or pit cultivation to protect summer fallowed acreage: 60c per acre.

Contour listing, chiseling, cross-slope chiseling, basin listing, or pit cultivation at least 30 days prior to seeding: 30c per acre.

Contour seeding drilled grasses, legumes, or small grains: .25c per acre.

Chiseling not on contour at least 30 days prior to seeding: 20c per acre. The amount earned on any one farm

for a combination of practices is limited to such limits as the ACA Committee may find necessary for proper distribution of county funds and also limited to \$750 per individual within the United States.

For further information and specifications of any practice contact the county office. IMPORTANT: WRITTEN PRIOR APPROVAL MUST BE OBTAINED FOR EACH PRACTICE BEFORE IT IS BEGUN.

NOW!

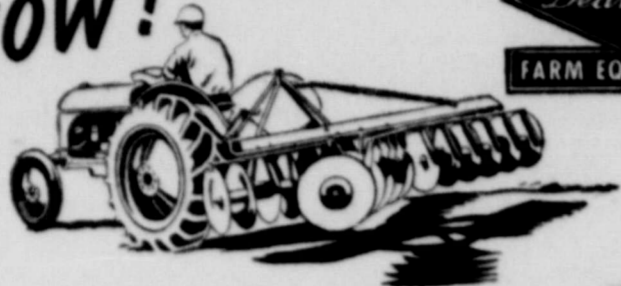

A FULL SIZE TANDEM DISC THAT Lifts and Lowers at a touch

This is the Dearborn Lift Type Tandem Disc for the Ford Tractor with Hydraulic Touch Control. The Ford Tractor can pick it up and carry it over roads at highway speed without blade damage. It lifts for fast short turns on headlands, for passing over grassed waterways, for backing into corners. It really pulverizes and levels the dirt.



Come in and see it! We are headquarters for Ford Tractors, Dearborn Implements, genuine parts and expert service.

DEARBORN WINDY SUB-SOILER

Come in and see a demonstration of this sub-soiler. It chisels from 12 to 16 inches deep, allowing water penetration up to 40 inches wide. This sub-soiler meets the approval of the District Soil Conservation Committee. Priced at—

\$55.00

Braselton Implement Co. Inc.

Your Authorized Ford Tractor Dealer
 Floydada, Texas

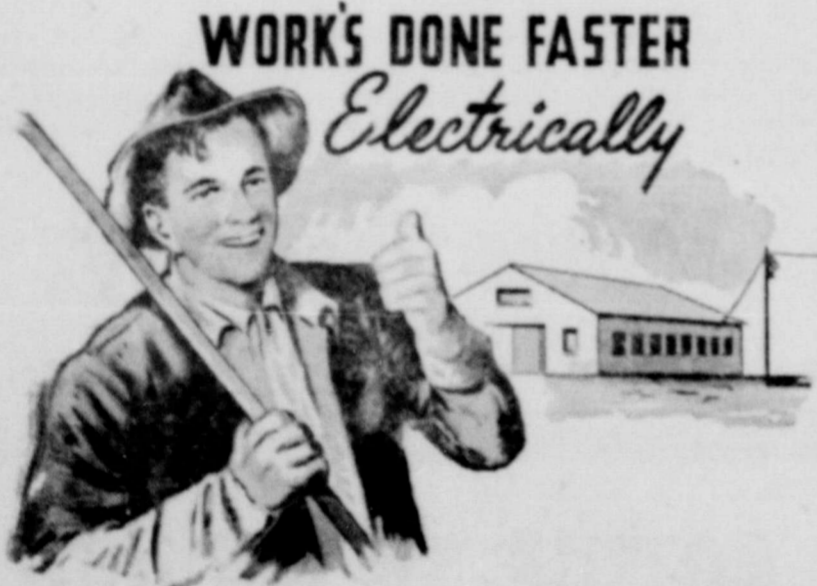

WORK'S DONE FASTER Electrically

ON THE farm and on the ranch work is done faster when electric service is effectively used.

Today more farms and ranches have electricity than ever before, and those who already have dependable electric service are finding more uses for it than ever before.

These progressive men are finding that electric lighting in the work areas, electric refrigeration, electric power tools for repairs and maintenance, electric milkers, brooders, incubators, choppers, and loaders all mean that more work can be done in a shorter period of time... at less cost.

When the time saved is compared with the low operating cost of modern electrical farm and ranch aids, the answer is obvious. That's why so many are using so much electric service. Check with your nearest county agent, REA or Public Service representative to see where electricity can help you.

SOUTHWESTERN PUBLIC SERVICE COMPANY
 24 YEARS OF GOOD CITIZENSHIP AND PUBLIC SERVICE

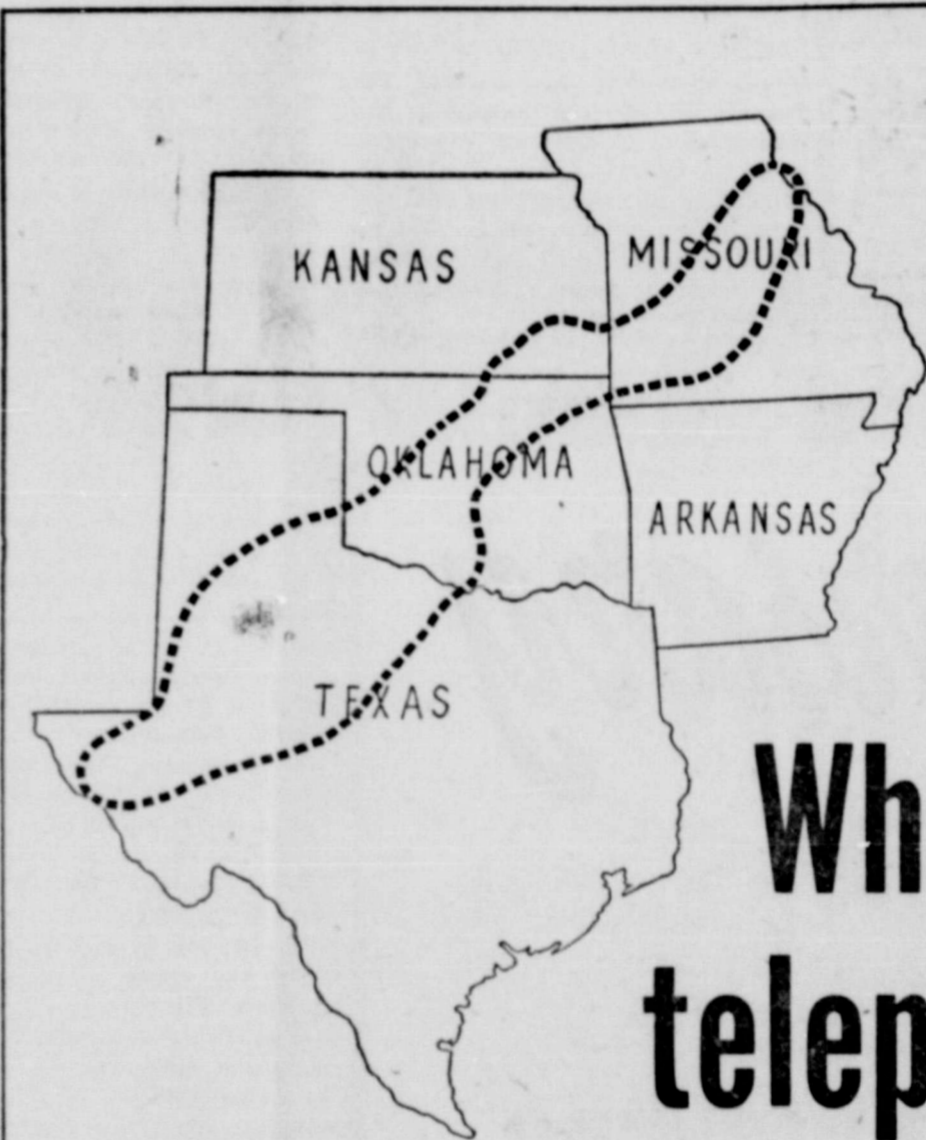

Where ice hit telephone lines

DAMAGE EXCEEDS \$2,300,000

Last week's ice and sleet storm struck telephone communications in the Southwest the hardest blow they'd received since 1937.

Damage to telephone lines exceeds \$2,300,000 in the area shown on the map above.

Telephone construction men, 3,000 of them, with their trucks and tools, moved into the storm region from all directions.

At the height of the storm 180 communities in four states had no outside telephone communications whatever.

The storm disrupted service for many thousands of telephone users for varying periods. We regret the interruption to service and we sincerely appreciate the patience people everywhere have demonstrated.

The size of the repair job that 3,000 telephone workmen are now tackling can be measured in the damage—108,000

wire breaks, 9,000 poles down, 2,600 long distance circuits out of service, 19,000 telephones temporarily silent.

By states, the money losses are \$600,000 in Missouri, \$380,000 in Kansas, \$570,000 in Oklahoma, and \$750,000 in Texas.

The poles, wire, crossarms, and all the other things needed to restore service are coming into the storm area by train and by truck. They're coming from Missouri, Texas, Alabama, Louisiana, Tennessee, Mississippi, Illinois, Pennsylvania, New Jersey, Maryland.

Telephone men began the repair job while the sleet still was falling. Long after emergency service is restored everywhere they'll still be at work until all damaged telephone equipment has been repaired and replaced, and everyone's service is back to normal.

 **SOUTHWESTERN BELL TELEPHONE COMPANY**

Tech Gridders Pro Contracts

Glenn Lewis, Quitaque, and Kelley, Idalou each winner football letters at Texas Tech, pro contracts with the Green Packers of the National Football League.

captain in 1947, while Kelley, an end is one of Tech's seven three-lettermen, winning Double T's in football, basketball and track in 1945-46. Fullback Walter Schlinkman and Halfback Ralph Earhart, former Tech players who starred with Green Bay last season, were present when Kelley and Lewis signed with Coach Curley Lambeau of the Packers.

Lone Star News

By Mrs. Harold Griffith

The weather has been quite a hindrance in getting the news written and delivered but we can look back on the few weeks this summer when the thermometer reads 100 in the shade and wish for a little of this cold weather.

Mr. and Mrs. A. O. Foster visited Mr. and Mrs. L. M. Readhimer and family Monday night.

Mr. and Mrs. W. T. Rankin visited with Mrs. T. S. McGehee in Plainview Thursday of last week.

Mr. and Mrs. Thurston Rankin entertained with a party in honor of their daughter Mary Ann's 13th birthday Saturday night January 8.

Those present were Glenda Ann Readhimer, Betty Sue Farish, Frances Nell Wells, Betty Ann Johnson, Loretta Peugh, Betty Ann Nance, Tom, Jim and Joe Nance, Garland Cox, Melvin Peugh, Bobby Clyde Baxter, Harold Dean Griffith, Pat Frizzell, Johnnie B. Griffin, Mary Ann and Jimmy Rankin.

Mr. and Mrs. L. M. Readhimer and girls visited in the Lowell Jarrett home Wednesday night.

Mr. and Mrs. Jack Frizzell and family with Mr. and Mrs. L. M. Readhimer and girls visited Mr. and Mrs. R. L. Knox Sunday afternoon and night.

Mr. and Mrs. Kline Nall and girls of Lubbock visited Mr. and Mrs. Walter Griffith last Sunday.

Mrs. Glen Smith of Lipan and Mrs. Bob Gafford of Lubbock visited Mrs. Jack Frizzell Saturday afternoon.

Glenda Ann Readhimer and David Frizzell spent last week-end in the Clyde Farish home.

Mr. and Mrs. Lowell Jarrett and Larry were dinner guests of Mr. and Mrs. L. M. Readhimer Wednesday night.

Mrs. Jack Frizzell spent Wednesday night with Mrs. R. L. Knox.

Mr. and Mrs. Floyd W. Jackson and Betty were guests of Mr. and Mrs. Buck Sams at a birthday dinner honoring Mrs. M. J. Sams Thursday. Other guests were M. J. Sams, Juanita, Janice, Barry and Bill Thompson.

Miss Mamey Lou and Bobby Dean Nance of Amarillo spent the week end visiting their parents Mr. and Mrs. W. D. Nance.

Mrs. Ben McGee spent the afternoon with Mrs. T. S. McGehee on Thursday.

Mr. and Mrs. J. B. Nance and Betty visited with their son Hugh Nance and family in Silvertown Sunday.

Mr. and Mrs. Floyd W. Jackson and Betty spent Sunday with Mrs. J. W. Jackson.

Mrs. Reed Lawson spent Monday with Mrs. Jack Frizzell.

Those enjoying 42 Thursday night in the Reed Lawson home were Mr. and Mrs. Howard Watkins and Sherry, Mr. and Mrs. L. M. Readhimer and Jo, Mr. and Mrs. Lowell Jarrett and Larry, Mr. and Mrs. Jack Frizzell and children and Mr. and Mrs. Harold Griffith.

Mr. and Mrs. C. E. Smith of Roaring Springs spent Saturday with their daughter Mrs. Bob Tiner and family.

Mrs. Ivy is back in our school lunch room cooking the same tasty meals as she always cooks. Mrs. Ira Graves cooked while she was absent last week.

Mr. and Mrs. J. E. Stoner, Mr. and Mrs. Bob Tiner and son and Mrs. Ivy visited Rev. and Mrs. G. C. Tiner Sunday night.

Betty Sue Farish spent Saturday night and Sunday with Glenda Ann Readhimer.

Mr. and Mrs. Geo. Long of Silvertown spent the week-end with Mr. and Mrs. A. E. Frizzell.

Garland Cox spent Thursday night with Pat Frizzell.

Those enjoying 42 at the L. M. Readhimer home Saturday night were Mr. and Mrs. Clyde Farish and children, Mr. and Mrs. Clyde Farish and children, Mr. and Mrs. Howard Watkins and Sherry, Mr. and Mrs. R. L. Knox, Mr. and Mrs. Harold Griffith, Mr. and Mrs. Reed Lawson and Sunny, Mr. and Mrs. Lowell Jarrett and Larry and Jack Frizzell and children.

Mr. and Mrs. Clyde Farish visited her parents, Mr. and Mrs. D. M. Marshall of Aiken Monday.

Mr. and Mrs. R. L. Knox were luncheon guests in the L. M. Readhimer home Sunday noon.

Mrs. A. E. Frizzell has been spending much of the time at the bedside of her father, Mr. Goins, of Floydada who has been critically ill.

Mr. and Mrs. Jack Frizzell and Sissy were luncheon guests of Mr. and Mrs. Lowell Jarrett Monday.

Mr. and Mrs. Harold Griffith spent Sunday with Mr. and Mrs. V. D. Harris in Lockney.

Mr. and Mrs. Lowell Jarrett visited in the home of her parents Mr. and Mrs. Lee Davenport of South Plains Sunday afternoon.

WTSC Registration Set For Feb. 1

CANYON—Registration for the spring semester at West Texas State College will be held February 1, announced Frank H. Morgan, registrar.

Freshmen and transfers will register from 8 a. m. until 4 p. m. in Burton Gymnasium. Classes begin February 2.

Cape Town is near the southern tip of Africa.

Announcing . . .

A new

Cotton Buying Service

for the Lockney Trade Territory.

We are in the market for all kinds of cotton. We have some excellent prices on cotton that in the government loan.

We have the Best Market in West Texas for selected grade and staple.

See us before you sell.

HORTON HOWELL

Office in The Lockney Beacon building. Phone 92

BIG CAR? YES!

Big Car Comfort! Seats as wide as sofas...up to 60.9 inches wide

Plenty of hip and shoulder room for 6 Big People.

Yes, a real "Mid-Ship" Ride in the smooth center-section.

New "Hydra-Coil"

Front Springs

New

"Para-Flex"

Rear

Springs

Big Car Visibility! "Picture Windows" all around.

Rear window alone 88% larger.

Big Car Safety! "Lifeguard" Body

of heavy-gauge steel... "King-Size"

Brakes that operate 35%

easier...lower center of gravity to

hold the road without

wander, even in a

cross wind.



Big Car Power! Your choice of 100 h.p. V-8 or a 95 h.p. Six. Up to 10% greater gasoline savings.

Take the wheel... try the Feel!



'49 FORD

Your Ford Dealer invites you to listen to the Fred Allen Show, Sunday Evenings—NBC Network. Listen to the Ford Theater, Friday Evenings—CBS Network. See your newspaper for time and station.

"WHITEY" BACCUS

Phone 200

Authorized Ford Dealer

Lockney

PLAINS THEATRE

Lockney, Texas

"Movies Are Your Best and Cheapest Entertainment"

SATURDAY MATINEE and NIGHT
JANUARY 22

Johnny Mack Brown and Raymond Hatton

—in—

"THE FRONTIER AGENT"

Also Comedy and Serial

Sunday Matinee & Night—Monday
JANUARY 23 AND 24

Loretta Young, Robert Mitchum and
William Holden in

"RACHEL AND THE STRANGER"

Also Cartoon and News

TUESDAY & WEDNESDAY
JANUARY 25 AND 26

"TARZAN'S NEW YORK ADVENTURE"

with Johnny Weissmuller and
Maureen O'Sullivan

Also Novelty Reel

THURSDAY & FRIDAY
JANUARY 27 AND 28

"THE BEST YEARS OF OUR LIVES"

with Myrna Loy, Frederic March,
Dana Andrews

Also Cartoon

REAL ESTATE

FOR SALE

Good Farms — Ranches and City Property. We make good loans on Farms and Ranches — at Low Interest Rate. Quick service — no red tape. List your property with us for quick sale.

First Door South of Jackson Tire Company

W. R. CHILDERS Phone 127 FAY PINNER

WILSON KIMBLE OPTOMETRIC CLINIC

Phone 254

FLOYDADA

Write Box 518

Specializing in Eye Care and
Visual Efficiency

We maintain a modern optical laboratory for the prompt and accurate filling of ophthalmic prescriptions.

DR. JOHN W. KIMBLE, Optometrist

FARMS FOR SALE

In the best irrigation belt in the United States. Improved and raw land from \$60.00 to \$200.00 per acre. For further information call or write.

SPEARS REAL ESTATE

Phone 61

Box 1026

Hobbs, New Mexico

Society News

Pollyanna Club Honors Allison

The Pollyanna Club honored Mr. and Mrs. Ollie Allison on Tuesday night with a covered dish luncheon at their home here. The occasion was the 17th wedding anniversary of the Allison. A gift of crystal was presented to them.

Moving pictures were taken by George Mizzell who later showed some previous pictures made of the club, as well as pictures from San Antonio and some from Australia. A social hour followed.

Members and husbands present were: Messrs. and Mmes. Charles Baxter, Lester Carter, Charlie Cross, Pont Darnell, Barney Manning, Joe Parrish, Albert Waldroup, Charlie Smith, Lloyd Wofford, Derrell Wood, and guests, Mr. and Mrs. George Mizzell.

The next meeting of the Club will be with Mrs. Charles Baxter, Tuesday, Jan. 25. Members are to bring "White Elephant" gifts.

William A. Atwood and daughter, Betty Jean of Carmichael, Miss., have been here visiting their son and brother, George Atwood and family. Mr. Atwood has returned to his home but Betty Jean will stay here for a longer visit.

Betty Jean Thomas Is Bride Of Billy Roach On Dec. 26

Miss Betty Jean Thomas, daughter of Mr. and Mrs. Valca Thomas of Lockney, and Billy Charles Roach, son of Mr. and Mrs. Stanley J. Roach of Plainview, were married December 26 at the First Baptist Church, Plainview.

Rev. Aaron Snaw of Happy, read the impressive double ring ceremony at an altar beautifully decorated with white chrysanthemums and greenery, flanked by white candles in tall candleholders.

Miss Jean Alger of Simonle, a former roommate of the bride, was the maid of honor. She wore a dress of amber satin and carried a cascade of tall-tall roses. Bridesmaids, Beth Roach of Plainview, sister of the groom, and Vera Jo Rogers of Lockney, cousin of the bride, wore beige satin dresses and carried bouquets of gladioli. Misses Leona Lane and Ronnie Mae Roach, flower girls, were dressed in pink and blue dresses with ruffled skirts and matching bonnets. They carried white baskets of rose petals.

LaVern Roach, brother of the bridegroom, was best man. Ushers were Ellis Kelley of Amarillo, Burton Stringer of Midland, Kenneth Echols and Raymond Dunnam.

Given in marriage by her father the bride approached the altar attired in an ice blue satin dress with a yoke of imported lace and a bustle back. Long sleeves pointed over her hands. She carried a white Bible topped with a white orchid with satin streamers.

Bill Woods, organist, played the traditional wedding marches for the ceremony and "Ave Maria", "Clair de Lune", "Indian Love Call" and "Always" as the guests assembled. He accompanied Buddy Moseley, who sang "Because".

A reception immediately following the ceremony in the annex of the church feted the bride and groom. The couple were assisted in the receiving line by their parents. Mrs. R. O. Boyter, aunt of the groom, served the cake and Mrs. Olive Lane poured coffee. Mrs. Frank Standefer presided at the bride's book.

The serving table carried out the bridal motif, violet and white, in decoration. Featured was a three-tiered wedding cake. Baskets of flowers were placed throughout the room.

Guests were present from Dallas, El Paso, Lubbock, Sherman, Lockney,

Hospital News

Dr. J. T. Guest of Plainview was dismissed Jan. 19 after two days medical treatment.

Mrs. E. L. Stapp and baby son were dismissed Wednesday.

Mrs. Mary Baggett was dismissed Jan. 19 after six days medical treatment.

Mrs. Gurra was dismissed Jan. 18 after two days medical treatment.

Aplala Gomez was admitted Jan. 17.

Dan Bailey was dismissed Jan. 18 after 8 days medical treatment.

Travis Young was admitted Jan. 15 and dismissed Jan. 17.

Jack Taylor was dismissed Jan. 17 after receiving 9 days medical treatment.

J. W. Hay was admitted Jan. 16, dismissed Jan. 19 after medical treatment.

Wesley Hay was hospitalized three days this week.

Patsy Gilbreath was admitted Jan. 14 and dismissed Jan. 15.

Mrs. Ora Williams was admitted Jan. 14 and dismissed Jan. 15.

Joe Page was admitted January 20 for medical treatment.

Kelly Webster was admitted Jan. 18 for medical treatment. He is doing nicely.

Mrs. R. E. Young was admitted Jan. 19 for medical treatment.

Mrs. Kendall Cummings was admitted Jan. 20 for medical treatment.

J. H. Johnson was admitted Jan. 19.

Mrs. Annie Parker was admitted Jan. 19.

Mrs. Melvin Griffith was admitted Jan. 18.

Mrs. V. D. Harris was admitted Jan. 19.

Mrs. E. C. Stapp was admitted Jan. 18.

A. B. Smith was admitted Jan. 18 and dismissed Jan. 20. He was injured in a tractor accident.

Memphis, Junction City, Kansas.

Both Mr. and Mrs. Roach are graduates of Plainview High School. They attended Wayland College and are students at Texas Technological College at the present. Mrs. Roach is a member of Las Vivarachas social club and the Future Teachers of America. Bill served 18 months in the armed services during the war. He was stationed in Japan.

For traveling the bride chose a Morocco rose gabardine suit with Navy accessories. After a wedding trip to Santa Fe, New Mexico, the couple will be at home at 3115 29th Street, Lubbock, where they will continue their studies at Tech.

Mrs. King To Head County Council

The Floyd County Home Demonstration Council will be headed this year by Mrs. C. L. King, Council Chairman. Mrs. King has been president of the Lone Star Club.

The Council membership is made up of a president, and delegate from each Home Demonstration Club in the county, Council officers, and some committee chairmen.

The membership of the Council is as follows: Chairman, Mrs. C. L. King of Lone Star; vice-chairman, Mrs. Lynn Miller of Sand Hill; Secretary-Treasurer Mrs. J. B. Smitherman of South Plains. The Reporter is Mrs. J. D. Eaves; Assistant Reporter is Mrs. A. M. Dorsey; and Parliamentarian Mrs. C. A. Caffee.

Council Representatives are as follows: (the first named as president and the second as Club Delegate)

Mrs. P. I. Roberts, and Mrs. Bill Dowdy, Baker;

Mrs. J. L. Helm and Mrs. Clyde Henderson, Center;

Mrs. Ruth Daniels and Mrs. Sam Lide, Dougherty;

Mrs. Lee Rushing and Mrs. A. H. Kreis, Friendship;

Mrs. Don Finkner and Mrs. Everett Miller, Harmony;

Mrs. J. D. Eaves and Mrs. O. G. Mayfield, Homebuilders;

Mrs. Wayne Russell and Mrs. S. V. Adams, Lakeview;

Mrs. M. L. Anderson and Mrs. W. L. Morgan, Lockney;

Mrs. Clyde Parish and Mrs. Herman King, Lone Star;

Mrs. A. M. Dorsey and Mrs. Leo Pope, Pleasant Valley;

Mrs. R. C. Matthews and Mrs. Charlie Boedeker, Providence;

Mrs. C. B. Carmack and Mrs. Lynn Miller, Sand Hill;

Mrs. J. B. Smitherman and Mrs. George West, South Plains;

Mrs. Paul Sparkman and Mrs. R. S. Harless, Starkey;

Mrs. Joe Reeves and Mrs. G. E. Patterson, Sterley;

Mrs. W. A. Lovell and Mrs. W. C. Sims, Sunnyside.

Mrs. Raymond Teeple of Lone Star is County Chairman of the Texas Home Demonstration Association.

County Needs \$2500 For March Of Dimes

Floyd County needs at least \$2500 in contributions in the present March of Dimes drive. County Campaign Director Guy Ginn said this week. The drive began January 14 and will continue through January 31.

The chapter has been delegated the responsibility of fulfilling the pledge to the National Foundation for infantile paralysis to assist every infantile paralysis victim to obtain the best available medical care and treatment. Based upon the patients-financial need, the following are paid for by your local chapter: doctor fees, hospital fees, physical therapy, and nursing charges, transportation, and costs of other care that may be prescribed by a recognized physician.

Inquiry about financial assistance for treatment of a poliomyelitis patient should be made by contacting A. H. Kreis, chapter chairman, or Clifford Tubbs, director at Floydada, or Edgar R. Hays, director at Lockney. Application for assistance may be made by a physician, the patient, any member of the family or interested individual.

Last year infantile paralysis struck again with tremendous force throughout the nation less than two years after the terrific epidemic of 1946, which was the second largest in the history of medical records. The 1948 epidemic began very early in the year down in the Rio Grande valley and by the end of the year over 2000 cases had been reported and treated in Texas. During the Texas epidemic the National Foundation sent over \$500,000 back to local chapters to meet emergency needs. Should an epidemic break out in our country and all local funds were expended the national organization would furnish funds and other supplies from their centrally located pool of epidemic equipment as long as funds were available.

The Floyd County chapter was able last year to send money to other areas where epidemics did break out. The county chapter spent \$686.07 for assistance to four county patients and then sent \$100.00 to the National organization to be used where the emergency existed.

Of the money raised in this county half of the funds will be kept here and the other half sent to the National Foundation.

Contributions may be given or sent to Guy Ginn, Floydada, Jewel Elza, chapter treasurer, Floydada, Joe Parrish, Lockney or Parnell Powell, Floydada. Mr. Parrish is the chairman for the Lockney drive.

Each community in the county also has a chairman, a list of which was published last week. These are also soliciting funds for the infantile paralysis drive.

BRASELTON TO MOVE TO NEW BUILDING

Braselton Implement Co., Inc. of Floydada expect to get into their new building by February 1. Troy Vaughn, manager said this week. The new building is nearly completed, he said.

Mrs. J. L. Miller of Marich, La., is here visiting her daughter, Mrs. Leon Wofford and family.

ALL RECORDS

3 for \$1.00

LIGHTING FIXTURES

We have just received a new shipment of beautiful lighting fixtures, both fluorescent and standard, for living room, bedroom, or kitchen. Come in and see them.

Armstrong Electric

V. E. (Doc) Armstrong
Phone 66

STOVALL-BOOHER RADIATOR SERVICE

1019-21 Bdw — Plainview

NEW AND USED

RADIATORS

For Cars Trucks and Tractors

Complete Service Dept.

Band Uniforms Arrive This Week

The long awaited uniforms for the Lockney High School band have arrived. The uniforms came in this week.

The shipment contained the band directors uniform, drum major uniform, nine majorettes uniforms, and 56 regular band uniforms.

The directors uniform is a solid gray trimmed in white.

The drum major's uniform is solid white trimmed in gold, with a gold citation cord. The head piece is a large shako, 18 inches high made from polar bear skin.

The majorettes uniforms are gray slacks with a wide maroon stripe and two white stripes down each leg, a maroon and white shako and a white rayon blouse.

The regular band uniforms have coats of solid maroon with white and gray trim, white citation cord, white Sam Brown belt, and caps of maroon with white bill. The trousers are solid gray with a large maroon stripe and two white stripes down each leg.

Director George M. Atwood said that the band expected to give a concert in February and probably would work in another concert this term.

T. J. HONEA BACK TO TEMPLE

T. J. Honea will return to Scott & White hospital at Temple this week and where he will undergo an operation there soon.

Card of Thanks

We wish to thank all in and around Lockney for courtesies extended to us bereavement.

H. B. Strickland and

Don Quixote was written de Cervantes.

DR. N. E. GREEN

Office Hours
9-12 a. m. 2-5 p. m.
Refractions by Appo

STAPLETON & JO

Lawyers
Courthouse

Notice

Commencing January will have the following hours:

Monday thru Saturday 9 to 12—1:30 to 5
Tuesday & Thursday from 7 to 8:30 P.

DRS. HUET & LEWIS
CHIROPRACTIC OFFICE
604 Broadway (over rock Cafe) Plainview.

GROCERIES PYLANT MEATS

Fruit Cocktail Del Monte No. 2 1/2 3

HOMINY No. 2 1/2 1

Whole Green Beans, No. 2 can, each

APRICOT PRESERVES, Pure 2 lb. jar

Walnuts Diamond Brand 1 lb. celo bag 3

Pure Lard 4 lb. carton 7

DREFT Large size box 2

MARKET

OLEO pound 31

T-BONE STEAK pound 5

SAUSAGE Pure Pork pound 3

Phone 71

OPEN AGAIN FOR BUSINESS!

I am again open for business and want to your Blacksmith Work. I will appreciate your patronage.

DAVID SECHRIST

THE BEST IN BARBER SERVICE!

Why not come to the Longhorn Barber Shop when need barber service. You will find that we give you the best service possible and we do appreciate your patronage. Our entire force are experienced barbers. Give us a trial.

LONGHORN BARBER SHOP

JOE ROGERS CHARLIE MOSES DALTON NEWT
Located First Door South of Darnell Grocery



ISN'T THERE SOMEONE YOU WANT TO THANK IN A "SPECIAL" WAY?

Send us your flowers from

Plains Floral Shop
Mrs. J. B. SEALE, Proprietor
Phone 163 LOCKNEY, TEX.

SPECIALS AT

LADY FAIR SHOP

Boys "Twigs" Flannel Shirts

Sizes 2 to 7

Priced at only \$1.98

"Twigs" Western Shirts

\$2.95 value for

\$2.15

"Twigs" Corduroy Jackets

\$3.95 value for

\$3.00

"Twigs" Corduroy Overalls

\$3.50 value for

\$2.95

NEW SPRING DRESSES

Just Arrived!

Lady Fair Shop

MRS. EDNA MAE HONEA, PROP.

WATCH, CLOCK AND JEWELRY REPAIR!

We offer you three to five day service on Watch and Jewelry repair.

Let us serve you!

DUMONT JEWELRY

Located in Baker Hotel Lobby

Classified Advertisements

For Sale

3-room house and on Highway 70 in south of Rayburn Spence at Thompson Service Station Eagle at Plainview Air- 20-4tp-tfc

For Sale

FOR SALE—One tandem disc, IHC, one side delivery rake on rubber, heavy duty IHC, one John Deere mower. See Billie Toney, 3 miles south of Lockney. 20-1tp

Wanted

WANTED—Full time farm hand. See O. J. Taylor. 20-1tp

County Council Has First Meeting

The Floyd County Home Demonstration Council had its first meeting of the year Saturday January 15. Mrs. Raymond Teeple served as chairman, due to the absence of the Chairman and vice-chairman.

Donations To Lockney Cemetery Association Need Is Very Good

Mrs. L. M. Honea reported this week that the response to the need of the Lockney Cemetery Association had been very good. She urges that those who have not made their contributions to Cemetery Association to do so soon. They may be sent to Mrs. Honea at Lockney.

H. Howard, \$5.00. J. B. Broyles, \$5.00. J. E. Black, \$2.00. HOSTS AT DINNER Mr. and Mrs. E. J. Thomas were hosts recently at a Sunday dinner for Mrs. Thomas' family.

For Sale

Two new M Farmall equipment, \$3950.00. Also 1941 Model H Farmall and new used Farmall 1948 model F-20 Farmall and Braselton Implement Co., Ada. 20-2tc

For Sale

FOR SALE—1948 International 4-row tractor, 1948 model H John Deere with 3-bottom lister and two planters. Perfect 160 acres on approved road. \$210. Pinner & Childers. 20-1tc

Wanted

WANTED—Sewing and alterations, Mrs. Ross Cooper, 7 blocks west and half block north of bank. 49-tfc

County Council Has First Meeting

The standing rules for 1949 were read and approved. Mrs. Raymond Teeple reported on the T. H. D. A. and the district meeting was discussed. Mrs. Bertran told how to keep account of books read by club members.

Donations To Lockney Cemetery Association Need Is Very Good

The following donations have been made recently: T. H. D. Whitaker, \$10.00. Mrs. J. S. Barnett, \$10.00. W. M. Martin, \$10.00. John Stalcup, \$10.00. Mrs. R. C. Bennett, \$10.00. Jim Harper, \$5.00. H. P. Reeves, \$5.00.

HOSTS AT DINNER

Mr. and Mrs. E. J. Thomas were hosts recently at a Sunday dinner for Mrs. Thomas' family. Those present were Mr. and Mrs. Will Sims, Mr. and Mrs. Guy Sams, Mr. and Mrs. Chas. Flack, Miss Anna Sims of Plainview, Mr. and Mrs. Revis Harris and children.

For Sale

Two 1/4 h. p. electric pumps 171-J. 19-3tp

For Sale

FOR SALE—Hand crocheted baby jacket, cap and bootie sets, in pink, blue or white. Mrs. H. Cunningham, 2 blocks east of grade school. 18-1tc

Wanted

WANTED—All kinds of windmill and pressure pump repair work. See F. G. Morrow at Bullman place, one block east of the ball park. 8-tfc

County Council Has First Meeting

Committees for 1949 are as follows: FINANCE—Mrs. Lee Rushing, Mrs. Ruth Daniels, Mrs. R. C. Matthews. EXHIBIT—Mrs. W. A. Lovell, Mrs. C. B. Carmack, Mrs. O. G. Mayfield. EDUCATION AND EXPANSION—Mrs. Herman King, Mrs. George West, Mrs. Lee Pope, Mrs. Don Finkner and Mrs. P. I. Roberts.

Donations To Lockney Cemetery Association Need Is Very Good

RECREATION—Mrs. Everett Miller, Mrs. Wayne Russell, Mrs. Clyde Farish. YEAR BOOK—Mrs. Lynn Miller, Mrs. Joe Reeves, Mrs. A. H. Kreis. CANNERY—Mrs. J. I. Heins and Mrs. R. S. Harless.

RETURNS HOME

Mrs. W. W. Miller returned to her home here Saturday after receiving treatment at the Lubbock Memorial Hospital for several days. She will go back to the hospital soon for further treatment.

For Sale

One 2-row SC Case 44 model, all equipment; tandem, 3-section harrow electric motor, horizontal Sid Thomas, 5 miles north of Lockney. 20-2tp

For Sale

FOR SALE—Smith & Barnes upright piano, good condition. See Mrs. Lewis Busby. 17-tfc

Wanted

WANTED—Custom work, one-way, ing, homeing, chiseling, Wayne Bybee. 17-tfc

County Council Has First Meeting

Parliamentarian—Mrs. C. A. Caffee. Reporter—Mrs. J. D. Eaves. Assistant reporter—Mrs. A. M. Dorsey.

Donations To Lockney Cemetery Association Need Is Very Good

Twelve Clubs were represented: Baker—Mrs. P. I. Roberts. Center—Mrs. Clyde Henderson. Dougherty—Mrs. Sam Lide and Mrs. C. A. Caffee.

SHAREHOLDERS MEETING

The shareholders of First National Bank in Lockney will hold their annual meeting in the bank on Tuesday, February 15, 1949, at 3 p. m. when the directors will be elected for the ensuing year. 19-4tc

For Sale

Two 1/4 h. p. electric pumps 171-J. 19-3tp

For Sale

FOR SALE—Entire stock of Duroc hogs, breeding stock and all. Bred sows and gilts for early Spring farrowing, bred to son of Tops. Several sows and gilts with pigs by side, 2 to 6 weeks old. Sows, pigs and boars 80 to 90 days old. Most of this stock subject to register and some already registered. Herd boar is son of Tops or line bred from Proud Wave Ace. One good boar ready for service. Victor Orion breeding. C. O. Roberts. 18-1tc

Wanted

WANTED—Sewing and alterations, Mrs. Ross Cooper, 7 blocks west and half block north of bank. 49-tfc

County Council Has First Meeting

Homebuilders—Mrs. O. G. Mayfield and Mrs. D. T. Maye. Lakeview—Mrs. Orvis Shearer. Lockney—Mrs. M. L. Anderson and Mrs. W. L. Morgan.

Donations To Lockney Cemetery Association Need Is Very Good

South Pains—Mrs. J. B. Smitherman. Sunnyside—Mrs. W. C. Sims and Miss Petty, agent. Visitors—Mrs. Bertran, Mrs. John Loyd, Mrs. G. N. Shirey, Mrs. D. D. Shipley and Mrs. Raymond Williams.

SHAREHOLDERS MEETING

The shareholders of First National Bank in Lockney will hold their annual meeting in the bank on Tuesday, February 15, 1949, at 3 p. m. when the directors will be elected for the ensuing year. 19-4tc

For Sale

Four rooms and baths, new bathroom fixtures, in cabinet. See George Jeff. 18-4tp

For Sale

FOR RENT—Two apartments, Phone 115. Mrs. A. B. Kenady. 19-tfc

Wanted

WANTED—Sewing and alterations, Mrs. Ross Cooper, 7 blocks west and half block north of bank. 49-tfc

County Council Has First Meeting

One of the buildings is a 25x48 lavatory building and will be used for a dressing room for athletes, it was indicated by school officials.

Donations To Lockney Cemetery Association Need Is Very Good

The other building is a 20x100 barracks building and will probably be used for a cannery building. The school was awarded the buildings at a 95% discount given all institutions with a priority. They will be moved here soon.

SHAREHOLDERS MEETING

The shareholders of First National Bank in Lockney will hold their annual meeting in the bank on Tuesday, February 15, 1949, at 3 p. m. when the directors will be elected for the ensuing year. 19-4tc

For Sale

One ton Ford Pick model. See Dorsey Baker. 14-tfc

For Sale

FOR SALE—Collie pups, 8 miles north of Aiken. Walter Sammann. 20-2tc

Wanted

WANTED—Sewing and alterations, Mrs. Ross Cooper, 7 blocks west and half block north of bank. 49-tfc

County Council Has First Meeting

They can still use more dishes if there is someone who has not donated and wishes to, Mr. Wilbanks said. The luncheon does not require a student to pay for dishes they break, although this is a common practice in most lunchrooms. It was said.

Donations To Lockney Cemetery Association Need Is Very Good

They can still use more dishes if there is someone who has not donated and wishes to, Mr. Wilbanks said. The luncheon does not require a student to pay for dishes they break, although this is a common practice in most lunchrooms. It was said.

SHAREHOLDERS MEETING

The shareholders of First National Bank in Lockney will hold their annual meeting in the bank on Tuesday, February 15, 1949, at 3 p. m. when the directors will be elected for the ensuing year. 19-4tc

For Sale

Good 80 acres up to of land, either irrigated or d. Will appreciate your listing and with us. We have quite a prospects coming in. Lockney State Co. 51-tfc

For Sale

FOR SALE—Collie pups, 8 miles north of Aiken. Walter Sammann. 20-2tc

Wanted

WANTED—Sewing and alterations, Mrs. Ross Cooper, 7 blocks west and half block north of bank. 49-tfc

County Council Has First Meeting

They can still use more dishes if there is someone who has not donated and wishes to, Mr. Wilbanks said. The luncheon does not require a student to pay for dishes they break, although this is a common practice in most lunchrooms. It was said.

Donations To Lockney Cemetery Association Need Is Very Good

They can still use more dishes if there is someone who has not donated and wishes to, Mr. Wilbanks said. The luncheon does not require a student to pay for dishes they break, although this is a common practice in most lunchrooms. It was said.

SHAREHOLDERS MEETING

The shareholders of First National Bank in Lockney will hold their annual meeting in the bank on Tuesday, February 15, 1949, at 3 p. m. when the directors will be elected for the ensuing year. 19-4tc

SPECIAL PRICE! All Woolen Piece Goods Plaids and Solids \$1.98 yard Lockney Dry Goods Mr. and Mrs. Cleotis Jeffcoat

E-Z-ON WEATHERSTRIP. SEE IT! So easily installed. Yet the best. R-O-W WINDOW UNITS Removable—Open easily. SEE THIS WINDOW AT OUR STORE SPECIAL—THIS WEEK! M-S Outside White House Paint \$4.95 per gallon This is Martin Senour No. 1 paint. Brunner Lumber Co.

REPAIR "Greatest Invention Since Radio" It cleans, purifies, deodorizes, humidifies, scrubs, sweeps, dusts, sanitizes, mothproofs, atomizes and shampoos rugs and upholstery. For FREE demonstration call or write MRS. C. E. CHILDERS, Phone 110 43-4tp

For Rent FOR RENT—Two apartments, Phone 115. Mrs. A. B. Kenady. 19-tfc

Miscellaneous NICHOLS AND BAXTER Memorial Company. Buy direct—Markers, Monuments, Coping. Box 454, Phone 342, Clarendon, Texas. 44-tfc

FARM AND RANCH LOANS FOR LONG TERMS at 4% interest. Pay off in advance at any time. Available to repair, rebuild improvements, finance purchase of farms and ranches. FLOYDADA NATIONAL FARM LOAN ASSOCIATION 32-tfc

Lost and Found LOST—A box containing 18 or 20 2x2 transparent 35MM. slides. Contact Douglas Dege at Consumers Fuel Assn. Reward. 20-1tc

GUERRA INFANT DIES The infant daughter of Mr. and Mrs. Guerra died soon after birth Monday and was buried Tuesday in the Lockney cemetery. Rev. N. S. Daniel was in charge of the services. Mr. Guerra is employed at the local alfalfa mill.

WATCH YOUR EXPIRATION DATE Lockney Chapter No. 379 Stated Convocation Fourth Tuesday M. L. Anderson, H. P. Herman King, Sec'y

Lockney Lodge No. 867 A. F. & A. M. Regular meeting third Tuesday night. FRANK MESSIMER, W. M. C. L. RECORD, Sec'y

DRS. CLOUGH & CLOUGH Optometrists & Orthoptists Clough Bldg. 111 West 7th Ph. 236 for Appointment Plainview, Texas

OU HAVE an unmarked grave for monuments or for coping. Dodson. 33-tfc

SALE—Heavy grain hegaris. See Doyle Casey, 7 1/2 miles east of Lockney. 19-4tp

SHOE REPAIR of all kinds. Also shoe strings and other supplies. CITY SHOE SHOP Located in Tomme Barber Shop

EXPERT TYPEWRITER AND ADDING MACHINE REPAIR Plus Typewriter Service Phone 620—Plainview—Collect Two Day Service Guaranteed

SHAREHOLDERS MEETING The shareholders of First National Bank in Lockney will hold their annual meeting in the bank on Tuesday, February 15, 1949, at 3 p. m. when the directors will be elected for the ensuing year. 19-4tc

Tech To Be Host At Regional Meet LUBBOCK—Texas Technological College will be host to the Region 1 high school interscholastic league meet April 23.

Mr. and Mrs. A. R. Meriwether will leave today for Los Angeles, Calif., where they will visit their daughter, Mrs. Manon Busiek. They will also visit Mr. Meriwether's sister in Pasadena. They expect to be gone several weeks.

Mr. and Mrs. Boyce Mosley are visiting his sister, Mrs. H. H. Hogue and family in El Paso.

Das Kapital was written by Karl Marx.

Bring Your CREAM and PRODUCE to us We pay highest Market prices. Alford Produce BILL ALFORD

QUICK RELIEF FROM Symptoms of Distress Arising from STOMACH ULCERS DUE TO EXCESS ACID Free Book Tells of Home Treatment that Must Help or it Will Cost You Nothing

SHAREHOLDERS MEETING The shareholders of First National Bank in Lockney will hold their annual meeting in the bank on Tuesday, February 15, 1949, at 3 p. m. when the directors will be elected for the ensuing year. 19-4tc

Tech To Be Host At Regional Meet LUBBOCK—Texas Technological College will be host to the Region 1 high school interscholastic league meet April 23.

Mr. and Mrs. A. R. Meriwether will leave today for Los Angeles, Calif., where they will visit their daughter, Mrs. Manon Busiek. They will also visit Mr. Meriwether's sister in Pasadena. They expect to be gone several weeks.

Mr. and Mrs. Boyce Mosley are visiting his sister, Mrs. H. H. Hogue and family in El Paso.

Das Kapital was written by Karl Marx.

Bring Your CREAM and PRODUCE to us We pay highest Market prices. Alford Produce BILL ALFORD

QUICK RELIEF FROM Symptoms of Distress Arising from STOMACH ULCERS DUE TO EXCESS ACID Free Book Tells of Home Treatment that Must Help or it Will Cost You Nothing

QUICK RELIEF FROM Symptoms of Distress Arising from STOMACH ULCERS DUE TO EXCESS ACID Free Book Tells of Home Treatment that Must Help or it Will Cost You Nothing

The LOCKNEY BEACON

Established 1902
PUBLISHED EVERY FRIDAY

EDGAR R. HAYS
Editor and Publisher

SUBSCRIPTION RATES:
In Floyd County, per year \$1.50
Outside Floyd County, per year 2.00
Either new or renewal subscriptions.

Entered April 14, 1902, as second class mail matter at the Postoffice at Lockney, Texas, under the Act of Congress of March 3, 1879.

Any erroneous reflection upon the character, standing or reputation of any person, firm or corporation which may appear in the columns of The Beacon will be corrected gladly upon being brought to the attention of the editor.



RETAILING ISN'T EASY

One of the highest rates of business mortality always exists in retail trade. Various reasons explain this. For one thing, running a store often looks receptively easy, and people try it without adequate resources in either money, experience, or aptitude.

There is nothing simple about retailing. Like any other worthwhile endeavor, it demands certain abilities and characteristics if a man is to succeed. He must be willing to study and learn. He must have a genuine desire to serve the public, and to please people so that they will come back again and again. Above all, he must have the competitive instinct—the instinct which makes him want to do a better job than the storekeep-

SCHOOL DAYS

By DWIG



er down the street or in the next town. He must never stand still, but must be constantly seeking ways and means to make his store more attractive to the public.

For those with the necessary resources, retailing offers great op-

portunities. No business gives the small operator a better chance to become the big operator. As an example, most of the chain systems are staffed, on their top executive levels, by men who began in minor jobs—clerks, truck drivers, warehousemen, and so on. That is true of the big department stores and other major retail outlets. These people started at the bottom of the ladder and climbed it through their own efforts.

Retailing is no place for the man who fears competition and has small faith in himself.

NO HOLIDAY TURKEYS

Among the resolutions adopted at the annual convention of the American Farm Bureau observed that we need to pay more attention to monetary, fiscal and credit policies if we are to take effective action to protect the purchasing power of the dollar.

There is nothing hard to understand in the case against price control. Basically, it can be summed up this way: no farmer or manufacturer could produce goods at a loss. No retailer could stock and sell those goods to the public at an arbitrary price which was too low to permit a profit. Under the free enterprise system, by contrast, production and distribution are encouraged, and we get abundance instead of scarcity. All concerned, generally speaking, earn a profit—yet that profit is kept small by the force of competition and has a relatively unimportant influence on the family budget.

These theories are fully borne out by the facts. A late example from England is of interest. The price of holiday turkeys, like almost everything else, was established by the government. But very few turkeys passed through the legal channels of distribution where price controls were in effect. The great bulk of them disappeared into the black market—and the price charged the consumer ranged as high as \$2.00 a pound. What this meant was that most English families couldn't afford to buy.

In the long run, only the black marketeer profits from price control. He becomes the main source of supply when stocks in legitimate stores dwindle and disappear. And he charges every last penny the traffic will bear.

With Our EXCHANGES

LIKES OR UNLIKES

A recent personal discovery revealed that most men today keep in the studios of their hearts, pictures of other men whom they strive to be unlike. Instead of striving to emulate an ideal, we strive to keep from imitating an obsession. It is perhaps, a healthy mental condition since in most instances the goal is to avoid character faults and infected ethics which shaped the life patterns being discarded. An honorable achievement might be to so live that no man would strive to be unlike me.—Trail Dust in Matador Tribune.

ADVERTISING

A fellow really has to keep on his toes, when times are dull—but a bunch of merchants over the country are doing a bangup good job of their advertising. Here are a few examples:

In an eastern grocery: "Apples you can eat in the dark."

In a California store: "We buy old furniture. We sell antiques."

On a Galveston bathing beach: "A coat of tan is yours for the basking."

In the window of a reducing specialist: "What have you got to lose?"

On a movie house: "Adam Had Four Sons, at 12:10, 3:00, 5:50, and 8:30."

In a Boston library: "Only low conversation permitted here."

In a barber shop: "During alterations patrons will be shaved in the back."

Southern Pacific Railway: "Spend the winter where the sun does."

In a Pennsylvania tavern: "If you must drive your husband to drink, head him this way."

In a restaurant: "Don't be afraid to ask for credit. Our refusals will be polite."

In a furniture store: "Notice To Employees: Excuses to absent, because of illness, funerals or wedding should be presented to the office the day before the game."—Post Dispatch.

Tales Manx cats come from the Isle of Man.

TALK ABOUT "FAST STARTS"

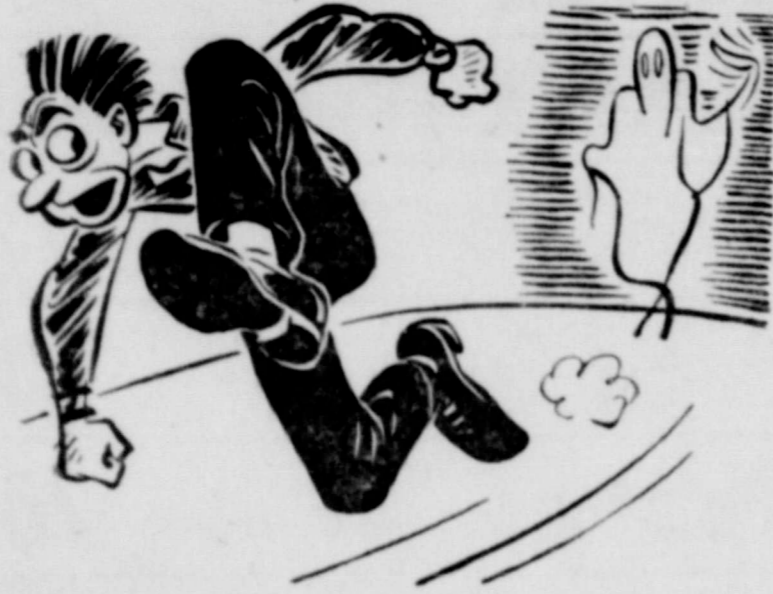

THIS GASOLINE'S GOT IT!

Phillips 66 is "CONTROLLED" To Give You Fast Action In Cold Weather or Hot!

If your car is a "sluggish starter"—look to the gasoline—it may be sluggish, too. Why not start with Phillips 66—now!

You see, Phillips 66 is controlled so you can get high quality performance from this fine fuel even at very low temperatures. Try a tankful and see for yourself!



*PHILLIPS 66 GASOLINE IS ESPECIALLY DESIGNED FOR UNIFORMLY HIGH-LEVEL PERFORMANCE ALL YEAR 'ROUND

PHILLIPS 66 GASOLINE



Plainview Sanitarium and Clinic 801-813 West Eighth Street PLAINVIEW, TEXAS

- | | |
|--|---|
| E. O. NICHOLS, M. D.
Surgery & Consultation | HUGH B. O'NEIL, M. D.
Internal Medicine, Cardiology |
| J. H. HANSEN, M. D.
X-Ray & Urology | LANDRIA C. SMITH, M. D.
General Medicine |
| E. O. NICHOLS, JR., M. D.
Surgery & Gynecology | C. C. JACKSON, M. D.
Ear, Eye, Nose, Throat |
| RANDALL E. COOPER, M. D.
Neurology & Psychiatry | WILLIAM H. TEAGUE, M. D.
House Surgeon |
| E. G. MCCARTHY, M. D.
Obstetrics & Gynecology | EDWARD T. DRISCOLL, M. D.
Orthopedics |
| WARREN W. EDDY, B. S.
Psychology | RALPH V. WILLIAMS, B. S.
Registered Physical Therapist |
| LEE B. SOUCY, M. T. (ASCP)
Chief of Laboratory | LENORE KRUSELL, B. S.
Registered Physical Therapist |
| SUSIE C. RIGGS, R. N.
Supt. of Nurses | H. M. SIMMONS
Business Manager |
- W. W. KIRK
Hospital Administrator

Annual Scout Banquet Set For Monday Nite

The Annual Meeting and Banquet of the South Plains Council, Boy Scouts of America, which was postponed due to the slippery roads, will be held on Monday January 24, at the Hilton Hotel in Lubbock.

The afternoon session for all Scout leaders will start at 4:00 p. m. Mr. Frank Runkles, Scoutmaster of American Legion Troop 8 in Lubbock will preside.

The Annual Business Meeting of the Council, for all Institutional Representatives, Board Members, and District Chairman will also meet at 4:00 p. m. Dr. F. B. Malone, Council President, presiding.

The address of the evening to be

given at the Annual starts at 6:45 p. m. Rev. Robert Bushen, Hemphill Presbyterian Church, Worth, Texas.

Reservations for the banquet should be made with the Scout Office at 2109 Avenue D. Tickets \$2.00 per plate. Friends of Scouting are cordially invited.

DR. WAYNE I. General De Business and Phone



FAY PINNER, Lockney Representative

DR. JOE E. WEBB OPTOMETRIST

Rooms 306-308, Skaggs Building
Telephone 1234

Plainview, Texas

DR. J. G. PRUITT Naturopathic and Chiropractic

Oxygen - Water - Therapy - X-R
a new Technique

208 W. Missouri Street—Phone 7
Floydada, Texas

Call for Your Appointment
"Where Nature Cures"

Krueger, Hutchinson and Overton C Lubbock, Texas

- | | |
|---|---|
| GENERAL SURGERY
J. T. Krueger, M. D.
J. H. Stiles, M. D. (Ortho.)
H. E. Mast, M. D. (Urology)
A. W. Bronwell, M. D. | INFANTS AND CHILDREN
M. C. Overton, M. D.
Arthur Jenkins, M. D. |
| EYE, EAR, NOSE & THROAT
J. T. Hutchinson, M. D.
Ben B. Hutchinson, M. D. (Limited to Eye)
E. M. Blake, M. D. | OBSTETRICS
O. R. Hand, M. D.
Frank W. Hudgins, M. D. |
| INTERNAL MEDICINE
W. H. Gordon, M. D. (Limited to Cardiology)
R. H. McCarty, M. D.
Brandon Hull, M. D. | GENERAL MEDICINE
G. S. Smith, M. D. (M)
R. K. O'Loughlin, M. D. |
| | X-RAY
A. G. Barsh, M. D. |
| | PATHOLOGY & MICROBIOLOGY
M. Gerundo, M. D., Ph |

BUSINESS MANAGER—J. H. Felton

SEE O. C. BAILEY MGR., BAKER PUMP COMPANY for

Irrigation Pumps

We are now distributors of the famous COOK PUMP which is the most durably constructed pump on the

4% Farm Loans—No Fee
At The

ALFORD PRODUCE BUILDING

Phone 199
Lockney, Texas

Or see Ira Graves at Lone Star For Well Casing.

or See Cecil Williams for Test Wells, 75c per foot. Doubtful Water Areas. Phone 130-R, Lockney, Texas

See R. K. SHIRLEY for Pump Bases and Motor Bases

WE CAN SAVE YOU MONEY

County Agent Gives Range And Livestock Report As Of Jan. 1.

Texas winter range feed deteriorated over practically the entire state up to January 1st, as droughty conditions continued, according to A. L. Hartzog, County Agent. Only in a limited area in east Texas were December rains sufficient to sustain growth of small grains, clovers and rescue grass. Dry range feed was short in all parts of the State except in some northern High Plains and some extreme southern counties where summer and fall rains were sufficient to produce a good growth of grass during the fall. Light rains, sleet and snow covered most of the Trans-Pecos country during the last week of December, but were generally too light to effectively break the drought in that area. Conditions of all range feed was reported at 68%. This is the lowest January 1 condition reported since 1935 when 52% condition was reported and is 9 points below the ten year average of 77%. However last week's rain, sleet, and snow fall will according to the Agent no doubt give some early spring pasture growth.

Cattle and calves are going through the winter in fair flesh, primarily because of the heavy supplemental feeding of roughage and cottonseed cake. Only a limited number of cattle are on wheat pasture in the important northern High Plains wheat country and these cattle generally are making only fair gains. Some farmers in that area are supplementing the wheat pasture with ground bundle feed because of the limited grazing. In spite of the summer and fall drought and short range feed, cattle marketings have been considerably lighter than in most recent years. Cattle marketed during the first eleven months of 1948 totaled 1,500,000 head which was the smallest number marketed during the same period since 1941 and substantially below the 1,985,000 head marketed during the same period in 1947. Calf marketings of 222,000 head during the first eleven months was the smallest number marketed during that period since 1936. Texas sheep and lambs are going through the winter in only fair flesh in spite of heavy supplemental feeding in much of the main sheep country. However, dry grass is fair to good in some southern Plateau counties and sheep and lambs in that favored area are carrying fair to good flesh. Because of mild, generally open weather during December, losses to date have been very light. Sheep and lambs were reported at 75% condition on January 1. This recorded a three-point decline during the past 30 days. Usually, condition of sheep declines only about one point during this period. The ten year average condition is 82%.

In western range states feed and grazing conditions during December 1948 were poor to fairly good. Much of the ranges and pastures from New Mexico north ward through the Great Plains and west to the Cascade Mountains were snowcovered by December and early January storms. Heavy early supplemental feeding was required over much of these northern

sections. The severe blizzard and storm in early January, covering eastern Wyoming, northeastern Colorado and the western parts of South Dakota, Nebraska, and Kansas, covered all feed and made livestock feeding impossible or difficult. Dry short feed conditions continued over southwest Oklahoma and much of Texas and parts of New Mexico. Rains gave some relief and improved range feeds in central and east Texas. December rains broke drought conditions in California, Arizona, and southwest New Mexico, but new feed growth was retarded by cold weather. In Washington, Oregon, Idaho, northern Nevada, and Utah, ranges and pastures were mostly snow-covered during December, with heavy earlier than usual supplemental feeding. Heavy supplemental feeding was required in much of Texas, with some feeding of livestock in parts of New Mexico and Arizona. Wheat pasture supplied but little grazing in western Kansas, Oklahoma, and the Texas Panhandle. The reported condition of winter range feed for January 1 was the lowest for that date since 1940. Cattle showed more than the usual decline in condition during December due to snow-covered ranges in the north and short range feed in Texas and the Southwest. The reported condition of cattle for January 1 was the lowest for that date since 1935. Heavy supplemental feeding was necessary in the snow-covered northern areas and dry sections of Texas and the Southwest. The early January blizzard and storm caused heavy shrinkage and some loss of cattle in the central Great Plains and along the east side of the Rockies.

December conditions for sheep and lambs were generally unfavorable due to the snow covering in the north and short feed in Texas. Most northern sheep ranges were snow-covered in late December 1948 with heavy supplemental feeding. Texas sheep show the lowest condition for January 1 since 1935, with fair conditions in the southern part of the sheep section and thin sheep in other areas. Sheep in the West are wintering in below average condition, with the lowest January 1 condition since 1935. In California early lambs developed slowly. There are reports of wool contracting in New Mexico, California, Utah, and western Colorado.

MOVING TO ARKANSAS
Mr. and Mrs. Joe S. Toney and family are moving next week to Leslie, Arkansas, where they will do stock farming. They have rented out their farm south of town to O. B. Patterson. The Toney's have lived here five years and their friends regret to see them move away.

A famous hole in the wall of the chamber of the Great Council in Venice was called the "Lion's Mouth." Through it anonymous accusations were passed in to the members.

BUILDING SUPPLIES

- Cedar Shingles, No. 1 and 2
- Composition Shingles
- Tie-On Shingles
- Sheet Rock
- Celotex
- Plywood, all thicknesses
- Rock Wool
- Insulation
- Pipe Insulation
- White Pine Mouldings
- Inside and Outside Doors
- Canvas
- Congowall
- Bath Fixtures
- Builders Hardware
- Cooks Paints and Varnish

LOCKNEY LUMBER & SUPPLY

Leon Wofford, Manager

NOW COMES THE LEADER WITH A 7-YEAR ADVANCE IN ONE!

CHEVROLET

is the only car bringing you all these fine-car advantages at lowest cost!

YOU'LL PREFER ITS "LUXURY LOOK"!

Chevrolet's new Leader-Line Styling is lower, wider, racier... with new Dyna-Cool radiator grille. Single-Sweep front and rear fender treatment, and fender-rocket lines all around... by far the most beautiful development of the new "functional form" for motor cars.

MORE BEAUTIFUL FROM EVERY ANGLE!

The new Beauty-Leader Bodies by Fisher (with push-button door openers outside) are true masterpieces by the master builder of fine coachcraft... with superb lines, extra-fine upholstery and a wide variety of alluring colors... much more beautiful from every angle—inside and outside—front, side and rear.

MORE ROOM AT EVERY POINT!

The new Super-Size Interiors featuring extra-wide "Five-Foot Seats" give you plenty of head, leg and elbowroom as well as extraordinary seating space for six full-grown passengers, and you'll also notice that the giant rear decks have what amounts to "trunk room" capacity.



SEE ALL! ENJOY ALL!

New Panoramic Visibility, with wider curved windshield, thinner windshield pillars, and 30% more window area all-around, permits you to see all and enjoy all, and to travel in maximum safety.



THESE ARE CARS THAT "BREATHE"!

Yes, you'll enjoy the additional pleasure of riding in a "car that breathes," for a completely effective heating* and ventilating system supplies warm air to every nook and corner of the interior—reheats stale air—and keeps glass clear in all weather. *(Heater and defroster units optional at extra cost.)

THE NEW RIDE'S A REVELATION!

A vastly improved Unitized Knee-Action Fld6, combined with new direct-acting airplane-type shock absorbers, front and rear, and extra low pressure tires, gives the stability, smoothness and road-safety you have always wanted.

THERE'S ONLY ONE WORLD'S CHAMPION ENGINE

You get the finer results of Chevrolet's sturdy Valve-in-Head Thrift-Master engine in all Chevrolet models... together with all of Chevrolet's money-saving economy of operation and upkeep... and this is the world's champion engine for miles served, owners satisfied, and years tested and proved.

JUST COUNT THE COMFORTS!

Push-Button Starter for simplest, easiest starting; Hand-E-Shift with Synchro-Mesh Transmission for maximum shifting ease; and Firm Foundation Box-Girder Frame for ride-stability and road-steadiness unsurpassed in the Chevrolet price range.



STOP MORE SWIFTLY AND SAFELY!

The new Car-Safe Hydraulic Brakes give even faster stops with safety... and assure the highest degree of effective braking action for you and your family.

YOU'LL SAVE MORE MONEY, TOO!

This new Chevrolet is designed, engineered and built to speed your miles and spare your pocketbook, for it brings you all these and many other important improvements at the lowest price and with extraordinary economy of operation and upkeep.

Plus NEW CENTER-POINT DESIGN!

A remarkable 4-way engineering advance exclusive to Chevrolet in its field, and consisting of Center-Point Steering—Center-Point Seating—Lower Center of Gravity and Center-Point Rear Suspension gives the new Chevrolet riding and driving results without precedent or parallel in low-cost motoring. That means a new kind of riding ease and a new kind of driving ease heretofore reserved for owners of more expensive cars. Remember—only new Center-Point Design can give you all these finer motoring results, and only the new Chevrolet brings you Center-Point Design at lowest cost!

Welcome the New CHEVROLET

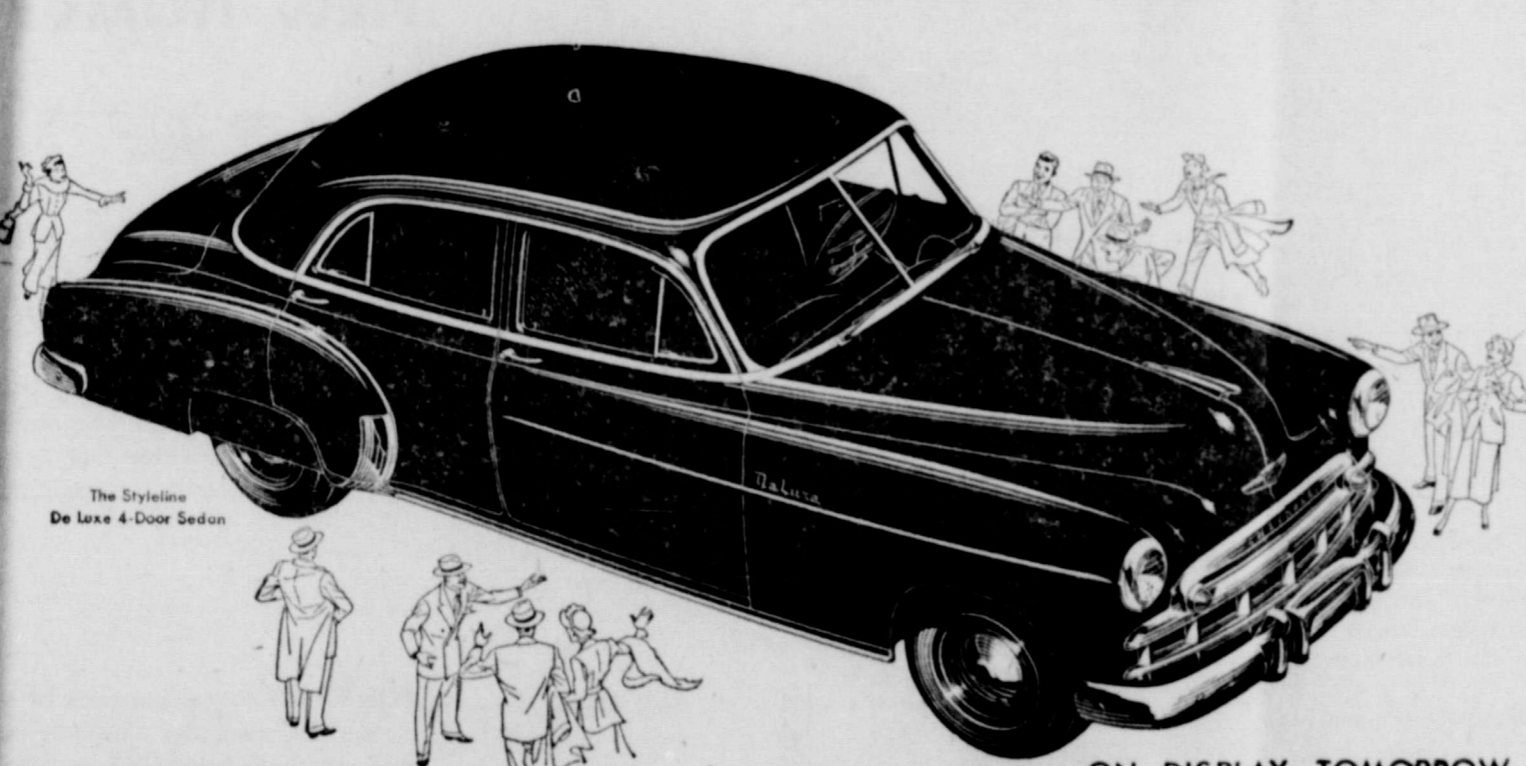

ON DISPLAY TOMORROW

The most Beautiful BUY of all

We cordially invite you to see the new Chevrolet for '49—the first completely new car the leader has built in more than seven years—and the most beautiful buy of all!

You'll find it's the most beautiful buy for styling, for driving and riding ease, for performance and safety, and for sturdy endurance born of quality construction throughout... because it alone brings you all these advantages of highest-priced cars at the lowest

prices and with the low cost of operation and upkeep for which Chevrolet products have always been famous.

Yes, here's the newest of all new cars—pre-tested and preproved on the great General Motors Proving Ground—and predestined to win even wider preference for Chevrolet as the most beautiful buy of all, from every point of view and on every point of value. Come in and see it!

First for Quality at Lowest Cost

AMERICA'S CHOICE **CHEVROLET** FOR 18 YEARS

LOCKNEY AUTO COMPANY

Phone 134

Chevrolet Dealers

Lockney

PLUMBING

9 years experience!
Have been at Liberal, Kansas. Also 1 year in Plainview.

All work fully guaranteed. My work has passed the most rigid city inspection.

Call me at
BRUNNIER LUMBER CO.
Day Phone 73
Night Phone 132-W or 173-W

J. P. THORNTON

ARTHUR B. DUNCAN ABSTRACT CO.
S. E. Corner Square — Floydada
Oldest and most complete abstract plant in Floyd County. Prepared to render prompt, efficient service on everything in the line of land titles.

MRS. MAUDE E. HOLLUMS
Manager

Allred & Boedeker
Lawyers
Conley Building—Lubbock
Phone 2-6670
Civil and Criminal Practice

HIGH & LOW BLOOD PRESSURE
successfully treated in your home without an examination with Boaz Tablets. Write
E. H. Boaz, M. D.
Morgan Hospital
Childress, Texas
or
SCOTT CHEMICAL CO.
Childress, Texas

Brighten the Home With
Bright, New, Crisp
WALLPAPER
A beautiful new pattern for every room of the home.

Select Yours Now

Headquarters for
COOK'S PAINTS
LONG-BELL

The mark on quality lumber
301 E. 5th Phone 163
Plainview, Texas

Providence News

The Home Demonstration Club will meet on Tuesday January 25 at two o'clock with Mrs. B. H. Quebe as hostess.

Mr. and Mrs. Bill Buth and children have just returned from an extended trip to the West Coast. They were accompanied on the trip by Mrs. Buth's parents, Mr. and Mrs. H. P. Parker of Lockney.

They spent the Christmas holidays with Mrs. Buth's sister, Mrs. H. M. Bennett, of San Fernando, Calif. then visited other relatives at San Diego and Alpine Calif. They also visited Old Mexico, and points of interest in Arizona and New Mexico.

Those visiting with Mr. and Mrs. M. C. Scheele on Sunday evening were Mr. and Mrs. Ted Boedeker and children and Mr. and Mrs. Harold McLaughlin and children.

Delores Sammann and Maebeth McLaughlin are back in school this week after being sick the past week.

Mr. and Mrs. M. C. Scheele and Marie spent last Friday visiting with Mr. and Mrs. Walter Sammann and girls.

Carolyn Jo Sammann is on the sick list this week.

Don McLaughlin is on the sick list this week.

Arline Matthews and Foncine Boedeker are back in school after complete recovery from the measles.

Mr. and Mrs. B. H. Quebe visited with Mr. and Mrs. E. M. Quebe on Sunday.

Mr. and Mrs. Earnest Sammann are visiting this week in Ruidoso, N. M. as guests of Mr. and Mrs. Ralph Brown. They made the trip by plane.

Rev. and Mrs. Anderson and Davey called in the home of Mr. and Mrs. Walter Sammann on Monday evening.

We wish to welcome into our community Mr. and Mrs. Robert Burkahl and family who moved here recently.

Card of Thanks

We wish to thank all our friends and acquaintances for the flowers, words of sympathy and other kindnesses shown us during our recent bereavement.

W. A. Rushing and Family

WATCH YOUR EXPIRATION DATE



NO HOOKEY PROBLEM . . . No scholar is likely to play hookey from the Sam Hughes public school in Tucson—at least not during "go western week", for school is more fun than a three-ring circus. Pupils don western garb, as do teachers, and the curriculum for the week includes lessons in rope spinning, technique of handling a six-shooter and other cow country folklore.

Don't Wait Too Long To Set Your Trees And Shrubs

COLLEGE STATION.—Don't wait too long.

That's the advice from Sadie Hatfield, extension landscape gardening specialist of Texas A. & M. College, for those who plan to set out new trees or shrubs around the yard this year.

This is the time of year to do that kind of landscaping job, so better begin working on it now. Before you know it, the sap will begin rising and the buds will begin swelling after a spell of mild weather. And once the trees have their leaves, your good plans may have to wait another year. Trees that are set out late don't stand as much drought as those set early.

Planting new shrubs or trees, or transplanting old shrubs, is best done right after a rain, says Miss Hatfield, and your plants in their new places should be well established before the leaves unfold. The leaves use up much of the plant's vitality.

When you put trees out, it's best to ball and burlap them to keep the roots from drying out. For the planting job itself, use a spade or a long handled shovel for digging the hole. Make it deep enough so that the trees will not be more than an inch deeper in the ground than they were in the nursery or the woods. Planting too deeply injures or kills the shrubs. Be sure the hole you dig is large enough to hold the plant's roots without crowding them in, or curling them up toward the surface.

After you've set the tree, pack moist topsoil firmly around the roots. A good watering will help settle the earth and get the tree off to a good start. Planting right after a rain is good management, reminds Miss Hatfield.

And when you have time and good weather, remember that winter is the best time for pruning shrubs, particularly the evergreens, shade trees and the shrubs that bloom in late summer.

Now is the time so don't wait too long.

Mrs. Bill Buth is in the Plainview Hospital for medical treatment this week. She was reported improving Tuesday. Her parents, Mr. and Mrs. H. P. Parker of Lockney, visited her Monday.

Mercury is used on the back of glass to make a mirror.

Rare Silver Given To Canyon Museum

CANYON.—A large collection of rare and beautiful silver was given to the Panhandle-Plains Historical Museum January 1 by Judge James D. Hamlin of Farwell. Judge Hamlin has given numerous gifts of art to the museum in the past.

The exhibit will not be on display for several weeks until other exhibits are moved to make room.

The collection includes toddy ladles with whalebone handles, forks made in Dublin in 1790, marrow scoops, pistol handle knives and forks, muffineer for powdered sugar and other spoon sets.

There are two tall Sheffield candlesticks, a silver chamber candlestick, and snuffer and a Sheffield chamber candlestick and snuffer. Waterford glass of five pieces with stand dated London, 1784. Besides cream pitchers, tea caddy, mustard containers and loving cup dated London, 1790, there are two vinaigrettes made in 1785 and 1730, wine strainers and coolers, snuff box, a Sheffield plate milk jug dated 1775.

Included in the donation was a collection of bells. One bronze bell, on a teakwood frame, was made of ancient metallic ore during the Han dynasty, 206 B. C. to 208 A. D. It was a temple piece for musical instruments.

Other bells in the collection are on Egyptian cow bell dated 1500; a Burma Buddhist bell, 1700; Spanish monastery bell, 1600; early Spanish Renaissance ecclesiastical bell designed as a church steeple with a cross, 1450.

Mrs. E. M. Whorton spent the Christmas holidays with her son, B. L. Whorton in Edinburg, Texas. She also visited her daughter in Dallas.

Samuel Morse invented the electric telegraph.

We want to buy your **PRODUCE CREAM HIDES and WOOL**

First Door North of Pennington motor Co.

Huggins Produce

Phone 100 Lockney

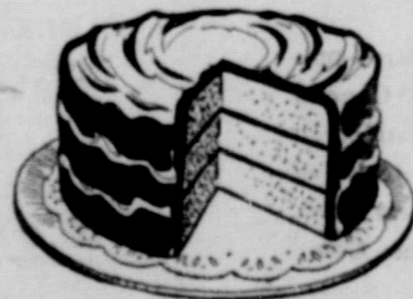

Tasty Treats

for the whole family!

at **McCLUNG'S BAKERY**

Whether it's pies, cakes, cookies, doughnuts, or bread we will be glad to fill your needs in the pastry line.

McCLUNG BAKERY

Located first door south of Newman Grocery Lockney, Texas

Plainview Jaycee Team Lose To Abilene

The Plainview Jaycee boxing team lost a match with the Abilene team on last Saturday night, Abilene winning eight to Plainview's four.

Lockney boys participating were Ted Livesay who lost to Johnny Marlett of Abilene by a decision; J. D.

Jeffcoat who lost to Boies of Abilene; his 20th consecutive cision over Don Barnes and Bill Thompson kayo to Denver Austin. Thomas Jefferson and both ex-presidents of on the same day, July



YOU AIN'T SEEN NOTHING YET!

No sir, you ain't seen nothing yet until you see service when a car drives into our station. We give you the kind of service that makes 'em want to come back. Why not drive your car out and let us service it for

- Phillips Gasoline and Oils
- Auto Accessories
- Tires and Tubes
- Batteries
- Cold Drinks and Candy
- Cigarettes and Tobaccos

COME ON OUT AND GIVE US A TRY

SPENCE & THOMPSON "66" STATION

On Highway 70—Lockney
Rayburn Spence George Thomas

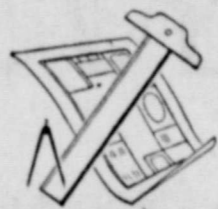

PLANNING A NEW HOME?

Make it all-gas

as thousands of others in this area are doing

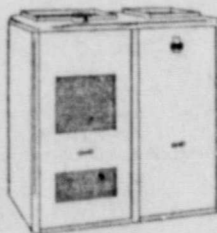

FOR HEATING, you will of course want to use natural gas, the economic, clean, healthful, effortless fuel. Buy the best heating equipment you can afford.



FOR FAST, easy preparation of delicious meals, you'll want a beautiful automatic gas range built to "CP" standards. Any range bearing the "CP" trademark is a good range.

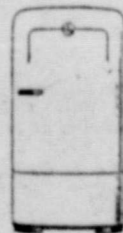

FOR YOUR "New Freedom Gas Kitchen" you'll want a dependable gas refrigerator. Plenty of room for fresh and frozen foods. Everlastingly silent. Amazingly economical.



AND DON'T FAIL to provide your family the inexpensive luxury of an adequately-sized automatic gas water heater. Plenty of hot water for all needs always.

FOR GAS APPLIANCES, PLEASE SEE YOUR DEALER

West Texas Gas Company

HELPING BUILD WEST TEXAS SINCE 1921

TRY BAKER'S!

- A. R. Wood Chick Brooders
- Electric Chicken Fountains
- Oil Burning Chicken Fountains
- Oil Burning Stock Tank Heaters
- Electric Stock Tank Heaters
- Blow Torches
- Electric Soldering Irons
- Electric Room Heaters
- Natural Gas and Butane Water Heaters
- Oil Heaters for your home
- Carpenter Tool Boxes
- Mechanics Tool Boxes
- Coleman Lanterns
- Heating Pads
- Infra-Red Lamps
- Door Mats
- Step-on Garbage Cans
- Ironing Boards.

Baker Hardware Co.



If your John Deere Equipment needs parts replaced, you'll find it pays to replace them with only *genuine* John Deere Parts.

Why? Because each John Deere Part is the identical twin of the part built into your equipment. It's made from the same high-grade materials . . . from the same patterns and dies . . . with the same quality workmanship as was the original part it replaces. *Genuine* John Deere Parts are made to fit right . . . to last longer.

Check over your John Deere Equipment now. Get it set to go when the next working season arrives. Place your order with us for *genuine* replacement parts for your John Deere Equipment the next time you're in town.

Lockney Implement Co.

WE USE ONLY *GENUINE* JOHN DEERE PARTS IN OVERHAULING YOUR FARM EQUIPMENT

NEEDLEWORK PATTERNS

ly Set in Graduated Sizes Embroidered Hat and Muff



5817

Hat and Muff Set

IT REQUIRES just six ounces of heavy wool to crochet this adorable little hat and muff set. Hearts and flowers are embroidered from odds and ends of brightly colored wool. Nice in white or bold colors for the older child.

To obtain complete crocheting instructions, stitch illustrations and embroidery color chart directions (Pattern No. 5817) send 20 cents in coin. YOUR NAME, ADDRESS AND PATTERN NUMBER.

SEWING CIRCLE NEEDLEWORK, 530 South Wells St., Chicago 7, Ill. Enclose 20 cents for pattern. Name: Address:

If Stuffy Nose Spoils Sleep Tonight. A little Va-tro-nol in each nostril quickly opens up nasal passages to relieve stuffy transient congestion. Invites restful sleep. Relieves sniffly, sneezy distress of head colds. Follow directions in the package. Try it!

VICKS VA-TRO-NOL

7 DAYS WILL DO IT



YES, in just 7 days... in one short week... a group of people who changed from their old dentifrices to Calox Tooth Powder averaged 38% brighter teeth by scientific test. Why not change to Calox yourself? Buy Calox today... so your teeth can start looking brighter tomorrow!

CALOX TOOTH POWDER. McKesson & Robbins Inc., Bridgeport, Conn.



Typewriter Doodling

No wonder everyone was looking forward to a happier New Year. Look at some of the things that happened during 1948. Ilse Koch of lampshade infamy had her life sentence commuted; pro-Fascist Serge Lifar staged a recital at NY's City Center; pro-ditto Kirsten Flagstad played Carnazi Hall five days after Pearl Harbor's ann'y; Dictator Franco was embraced by ex-New Dealer Jim Farley; Hjalmar Schacht, who financed the Nazi, was exonerated by a denazification court as not being a Nazi; and to top it all, our allegedly most upright magazine, Time, was being edited by an ex-Communist!

Another reason "Lend an Ear" is showkay is the amusing galivanting of Yvonne Adair. Very tomboy-strous... The understatement of the week was Rita and Aly's confession to reporters that "they are fond of each other." I suppose Romeo was merely fond of Juliet... Nothing as disgraceful as the un-American committee's attempt to smear the good name of Lawrence Duggan. That committee defames innocent and patriotic Americans—but hasn't done anything about the KKK. Shameful... Because of the Whittaker Chambers affair, Henry Luce's "March of Time" had to recall its Christmas cards. The cards featured a globe of the world (with film strips protruding), and it looked like a pumpkin.

The holier-than-thou goons who feign horror at reporters who publish gossip give us an opportunity to revive a statement that once appeared in a country weekly: "If you get born, marry, have a baby, die, or some other accident happens to you, please let us know—not that we give a darn, but most of our readers have a lot of curiosity." That explains our position expertly.

Wanna make a fortune in Movieville? Sell rose-colored specs. One producer insists that the depress there "is largely psychological." Oh, sure... Radio critics are wasting their brick-bats. Nine of the top 10 Hooper daytime programs are soap operas... The plot of the film christened "Whiplash" concerns an artist who becomes a pugilist and has his manager's wife fall in love with him. That's practically a replica of Odets' "Golden Boy." The "difference" is that in Odets' play the fighter was a violinist... Several days ago John Foster Dulles told reporters he recommended Alger Hiss for his job with the Carnegie Endowment for International Peace. Our listeners heard that a month ago.

Imaginative camera work and hep direction can be found in the film, "The Dark Past." It grips the attention despite the fact almost all of the action takes place in a single room... The NY Times editorialist apologized for a misleading headline and story on its front page—which was based on a statement by Cong. Mundt. But when a columnist's sources give him a bum steer belittlers holler like he had committed a crime. Hohum.

Here's another Heil-Hitlerism: Nazi Field Marshal Albert Kesselring is a convicted war criminal. He was given a death sentence by a British court, but it was later commuted to life imprisonment, of course. A fortnight ago the British allowed Kesselring to leave his cell and spend a 10-day holiday at a sumptuous Bavarian resort with his wife... Apparently, being convicted as a war criminal is almost as good as joining a country club.

Churchill knows how to take a bow gracefully. In his mem-wars Winston states: "I hope you will give full consideration to my words. I have not always been wrong"... So you want to be a writer, eh? Last year almost 2,000 novels were published. Only about a hundred were money makers. So stick to your bookkeeping job, Eimer... A touch of irony: Televish is a red-ink proposition. But networks can take the loss because of the huge profits they garner from the arch enemy of televish—radio... The President rates having his salary hoisted. The presidency is one job that hasn't had a raise in 40 years... The new charmer in the film, "Every Girl Should be Married"—Betsy Drake—has the star dust touch. She has a silky speaking voice that fits the ear like a kiss fits the lips.

Before Prentice-Hall agreed to publish Kay Summersby's book (on Gen. Ike) they wrote him asking if he objected. He replied he did not. But Gen. Eisenhower didn't read the book—in galley form or between covers—and told the publishers he did not wish to.

Household Hints

If you use waxed paper to roll dough on, moisten the tabletop first, then lay the paper on it. This prevents the paper from slipping.

Sprinkle baked custard with coconut and nutmeg before putting into the oven. Serve with peach sauce.

Try putting down on paper everything you are planning to serve for a week and work out how to use your leftovers to the best advantage.

Chopped pecans go well with the following kinds of cheese, as sandwich fillings; cream cottage, smoky, softened American cheddar.

Roll leftover pie crust thin, cut in small squares, and bake in pie pans. Serve hot with a dab of jam or marmalade on each square, with tea.

The preference of red salmon over pink salmon is based on eye appeal rather than on higher food value. Both kinds contain similar amounts of niacin and riboflavin.

If you have a tablespoon or two of tomato paste left in the can, add three times as much mayonnaise as you have tomato paste, a few grains of chili powder and a few drops of tabasco and, presto, a zingy new salad dressing!

It's a good idea when waxing floors to wax the feet of the furniture, too. Then, when furniture is moved around, it will be less likely to mar the floor and will reduce abrasion wear on rugs and carpets.

CLASSIFIED DEPARTMENT

BUSINESS & INVEST. OPPOR.

FOR SALE—200-head Karakul ewes with lambs. A bargain. A. G. GORRUCK, 245 N. 10th St., Wichita Falls, Texas.

STEP INTO YOUR OWN BUSINESS. Our complete plan from A to Z assures your success. We show you how you take orders from 1 out of 3 prospects who have written for information. You will have exclusive local territory in permanent business for yourself. Earnings limited only by your efforts. Betty Duce made \$152.00 her first week. Mr. Bridges averaged \$22.30 each working day. Mature men and women who like to sell top quality merchandise needed in every home will be successful. Approximately \$150 cash deposit sets you free.

THE FEATHER MERCHANTS, Katesville Bldg., P. O. Box 229, Dallas 1, Texas.

FARMS AND RANCHES. WANT FARMS AND RANCHES. All sizes this vicinity at market prices for immediate buyers. For fast personal sales attention write: ENTEX LAND EXCHANGE, 501 E. 10th St., 25, Dallas 8, Texas.

LIVESTOCK. FOR SALE—200-head Karakul ewes with lambs. A bargain. A. G. GORRUCK, 245 N. 10th St., Wichita Falls, Texas.

MISCELLANEOUS. ROLL DEVELOPED—Overnight Service. 8 High Gloss Prints, all sizes 25c. Prints, 3c each. Billings, Montana.

FOX STUDIOS. DON'T SWEAR—AT DULL KNIVES. New sharper that really works, saves food, saves money, small cost. Thousands delighted. Needed in a million kitchens. Write for details: FORTUNE SALES COMPANY, 509 1/2 Main St., Newton, Kan.

Bookkeeping Services. Income Tax Returns—by mail—using our simplified Advance Information Plan. Return this ad with 1 dime coin only. We mail you—plan—full explanation. Add it—Mail it—profit record and how we can keep your books by mail. SYM-FLEX COMPANY (A Texas Co. Covering Dallas) 208 Republic Nat'l Life Bldg., Dallas, Tex.

FOR SALE—One Model 900 Electric Addressograph, 2-drawer cabinet, with 30 trays, and 4,300 Addressology frames. Write or call R. M. Fry Lumber Co., Hugo, Okla.

SEEDS, PLANTS, ETC. HEAVY AZALEAS for yard planting, 10-inch diameter, \$1.75 each. Call anywhere where 10 for \$15. FORREST'S GREEN-HOUSES, Waxahatchie, Texas.

Buy U. S. Savings Bonds! A Safe, Sound Investment—

A SOOTHING DRESSING FINE FOR: MOROLINE BURNS AND CUTS. PETROLEUM JELLY 10c

FINE STRONG CHILDREN

You'll be proud of your strong, husky children when you give them Scott's Emulsion every day! Scott's is a "gold mine" of natural A&D Vitamins and energy-building natural oil. Helps children grow right, develop sound teeth, strong bones.

Helps ward off colds when they lack enough A&D Vitamin food. Many doctors recommend it. Economical. Buy today at your drug store. MORE than just a tonic—it's powerful nourishment! SCOTT'S EMULSION HIGH ENERGY TONIC

SEWING CIRCLE PATTERNS

Neatly Tailored Classic Style Two-Piece Frock is Flattering



Shirtwaist Frock. NEAT, attractive, wearable—the beloved shirtwaist frock that's adored by every age. Particularly appealing in a brightly striped fabric used crossways for yoke and brief sleeves.

Smart Two-Piecer. HERE'S a pretty style to give a lift to a junior wardrobe! An eye-catching two-piecer with keyhole neckline, pert flared peplum and a simple-to-sew gored skirt.

Check that Cough from a cold Before It Gets Worse—and get well quicker with the NEW FOLEY'S

The NEW FOLEY'S HONEY & TAR contains one of the most important cough treatment developments in years, one that ACTUALLY HELPS SPEED RECOVERY. Also soothes throat, checks coughing. Also delicious, non-narcotic, does not upset digestion. But most important, NEW FOLEY'S helps you get well quicker from cough due to cold. At your druggist.

Pattern No. 1594 comes in sizes 11, 12, 13, 14, 16 and 18. Size 12, 3 1/2 yards of 39-inch. Send an additional 25 cents for the latest FASHION. The new Spring and Summer issue offers a wealth of sewing information—free pattern printed inside the book.

SEWING CIRCLE PATTERN DEPT., 530 South Wells St., Chicago 7, Ill. Enclose 25 cents in coins for each pattern desired. Pattern No. Size Name Address.

Constipated? So Was This Woman

"I would go from one Sunday to the next, then take a harsh purgative. That's over now that I eat KELLOGG'S ALL-BRAN daily."—Mrs. Katherine Turner, Indianapolis, Ind.

If your diet lacks bulk for normal elimination, eat an ounce of KELLOGG'S ALL-BRAN every day in milk—and drink plenty of water. If not satisfied after 10 days, send empty carton to Kellogg Co., Battle Creek, Mich., and get DOUBLE YOUR MONEY BACK. GET KELLOGG'S ALL-BRAN NOW!



MOTHER, MOTHER, WHAT'S YOUR SECRET? WHAT MAKES ALL YOUR CAKES SO FINE? TELL ME, WON'T YOU, HOW YOU DO IT, SO I CAN BE PROUD OF MINE. BAKE THE CLABBER GIRL WAY MY DEAR, WITH CLABBER GIRL BAKING POWDER. Ask Mother, She Knows... Mother Girl is the baking powder with the balanced double action... Right in the mixing bowl. Light, from the oven.

CLABBER GIRL Baking Powder

IF PETER PAIN HITS YOU WITH NEURALGIC PAIN

Ben-Gay. Rub in Ben-Gay for fast-acting, gently soothing relief from neuralgic pain. Ben-Gay contains up to 2 1/2 times more methyl salicylate and menthol—two famous pain-relieving agents your doctor knows about—than five other widely offered rub-ins. Insist on genuine Ben-Gay, the original Baume Analgésique. It acts fast! Also for Pain due to RHEUMATISM, MUSCLE ACHE, and COLDS. Ask for Mild Ben-Gay for Children.

QUICK... RUB IN Ben-Gay

Vertical text on the left edge of the page, including 'DYE', 'lose', 'illness', 'executive', 'Don Hart', 'ampon', 'er Auth', 'frerson', 'dents of', 'day, July', 'YET', 'you see', 'We give', 'ne back', 'ce it for', 'ils', 'S A TH', 'APS', 'ON', 'oney', 'e Thom', 'G A', 'ME?', 'ire doing', 'vill of cou', 'e economic', 'fuel. Buy', 'u can affo', 'ation of de', 'eautiful aut', 'P" standard', 'P" tradema', 'm Gas Kiln', 'able gas', 'or fresh', 'ilent. Am', 'rovide your', 'xury of an', 'e gas water', 'for all needs', 'R DEALER', 'rany', 'ICE 192

MRS. STRICKLAND—

(Continued from Page 1)
afternoon at the Lockney Methodist Church conducted by Rev. E. J. Cobb, Baptist pastor. Interment was in the Lockney cemetery. Pallbearers were J. B. Allen, V. L. Webster, G. H. Pholis, Hugh Carroll, Leslie Ferguson, Harmon Handley.

Carter Funeral Home had charge of arrangements.

Baxter & Smith Grain Company

Phone 23—Lockney

We are in the market for your Ear Corn, seed type Hegari and other Field Seed.

DR. GREEN DENTIST

On Square - 121 1/2 E. 6th St. Over Eryan's Food Store
New Plastic False Teeth Crown and Bridgework, Fillings, Extractions, Fees Reasonable
1 Day Plate Repairs Examination Without Appointment.
Plainview, Texas

Corbin Selected For Committees

Austin, Texas—Senator Kilmer B. Corbin of the 30th Senatorial District along with ten other new members of the Senate took the oath of office at noon on January 11th. The Senate completed the organization on that date and is proceeding with legislation. Of the 31 members of the Senate, Senator Corbin is the youngest member.

Senator Corbin reports that the problems which will confront the 51st Legislature are many and varied. At the present time financial matters are principal among the topics of discussion among lawmakers.

Senator Corbin was selected to serve as the chairman of the Committee on Town and City Corporations; vice-chairman of the Committee on Aeronautics; and a member of the following committees: Agriculture; Civil Jurisprudence; Congressional Districts; Finance; Insurance; Oil, Gas, and Conservation; Public Printing; State Institutions and Departments; and Water Rights. Corbin and his wife and three children—Barry, 5; Blaine, 5; and Jane, 4—are living in Austin during the session.

In a recent letter to The Beacon Senator Corbin expressed his intention to keep the people of this area informed on legislative matters through the columns of this paper.

WANT ADS GET RESULTS

Ralls Basketeers Play Here Tonight

The Rail Jackrabbit basketball team will come here tonight (Friday) for a conference game with the Longhorns. The A team, B team and girls team will all play.

The Jackrabbits have a good team and will give the Longhorns plenty of competition.

The Lockney teams dropped three games Tuesday night to Abernathy, the A team losing 53-33, the B team 24-12 and the girls 33-13.

Ralls defeated Matador 28-20 in a game Tuesday night while Spur ran over Crosbyton 57-31.

The Longhorn game with Spur, postponed last week, will be played Feb. 9. Coach Metz Lafollette said this week.

New Location In Fisher Pool

A new location in the Fisher pool in Hale County has been announced this week.

The new test for oil in an area which has produced one oil well and 4 dry holes, will be drilled by Skelly Oil Company. It will be their No. 1 Fisher, 660 feet from the south and west lines of the northeast quarter of section 4, Block CL Skelly has about a block and a half in their block.

The test will be 1 1/2 miles northeast of the No. 1 Irish discovery test which was completed for a good oil well. Four dry holes have been drilled around the discovery well. Skelly's test will be 4 miles northwest of Petersburg.

Carrots Show Good Yield; No Market

Wilburn Tannahill, working with Jiggs Morrison, planted 9 1/2 acres of carrots the past year in an experimental tract. The yield was good, the carrots were delicious. The only trouble was that no market could be found for most of the carrots.

Wilburn reports that he dug three and a half acres and harvested 1195 crates of bunched carrots from this acreage. They received \$1 per crate for the carrots. But no market could be found for the remaining 6 acres and they are still in the field.

Earnest Tannahill planted 11 acres under the same arrangement and harvested some of them but, like Wilburn, most of them could not be sold. The trouble seems to be that the plains carrots come off just at the end of the harvest season and the market is glutted with South Texas and California carrots, Wilburn said.

Mary Baker Eddy founded the Christian Science Church.

J. A. Cornell New Telephone Manager This Area

John A. Cornell, communications supervisor of the Southwestern Bell Telephone Company at Fort Worth, has been appointed Manager for Lockney and six other exchanges in this vicinity, with headquarters at Plainview, according to A. O. Thomas, district manager of the company here.

Mr. Cornell will replace Coy A. Myers, local telephone manager for the past two and one-half years, who has been named communications supervisor at Wichita Falls. The change is effective immediately, Thomas said.

Mr. Cornell's telephone career began in Dallas in 1941 as a cable splicer in the Plant department. In 1942, he went to Waco, and shortly afterward was promoted to commercial representative in the company's Waco business office.

The following year, Cornell enlisted in the U. S. Navy and was assigned to submarine duty in the Pacific. During the war, he participated in many undersea patrols and assisted in the rescue of American flyers shot down at sea. The submarine on which he served was one of a chain of American U-boats stretching from Siapan almost to Japan, forming a "life-line" which saved the lives of many airmen forced down at sea during the intensive B-29 air raids on the Japanese mainland.

For this war service, Mr. Cornell holds the Asiatic-Pacific theatre ribbon and the Philippine Liberation medal.

At the end of the war, he was discharged with the rank of Seaman 1-c and returned to telephone work at Waco in 1946. He later served for a short period at Tyler, and in 1947 was transferred to the company's division headquarters offices at Fort Worth. In March of last year, he was promoted to communications supervisor there, his position until the present appointment.

Mr. and Mrs. Cornell and their two children, a daughter, 8, and a year-old son, will move to Plainview to make their home as soon as arrangements can be made.

Mr. Myers, who has been manager since July, 1946 here, has been a long-time resident of this vicinity. He came to Plainview in 1904 with his parents and resided there for 18 years. During his telephone career, which began in 1937, he saw service in Fort Worth and Wichita Falls, and during the war was Camp Telephone Manager at Sheppard Field. In 1946 he was appointed manager for Lockney and the surrounding exchanges, his position until the present time.

Mr. and Mrs. Myers will move to Wichita Falls soon.

Average Rainfall In County Last Year Was 14.46 Inches

Rainfall in Floyd County Soil Conservation District varied from 11.09 inches to 18.25 inches in 1948. The average of 12 gauges scattered over the District was 14.46 inches for the year. In general, the north and west part of the County had the most moisture. November was the driest month with an average of .96 reported from the various stations. The highest amount of moisture fell in June with reports averaging 3.76. The total precipitation includes all measurable amounts of moisture in the form of rain, snow, sleet and hail.

The average rainfall this year was about 6 inches under the long time average of around 29 inches. Some of the gauge stations reporting the most moisture had damaging rain and hail. There was a great deal of runoff and washing and the lakes were filled to capacity. The growing crops were severely damaged.

Watch Your Kidneys!

Help Them Cleanse the Blood of Harmful Body Waste

Your kidneys are constantly filtering waste matter from the blood stream. But kidneys sometimes lag in their work—do not act as Nature intended—fail to remove impurities that, if retained, may poison the system and upset the whole body machinery.

Symptoms may be nagging backache, persistent headache, attacks of dizziness, getting up nights, swelling, puffiness under the eyes—a feeling of nervous anxiety and loss of pep and strength.

Other signs of kidney or bladder disorder are sometimes burning, scanty or too frequent urination.

There should be no doubt that prompt treatment is wiser than neglect. Use Doan's Pills. Doan's have been winning new friends for more than forty years. They have a nation-wide reputation. Are recommended by grateful people the country over. Ask your neighbor!

DOAN'S PILLS

Rushing Infant Buried Friday

George Hogan, infant son of Mr. and Mrs. W. A. Rushing, passed away early Friday morning, soon after birth, and was buried Friday afternoon in the Lockney cemetery.

Rev. E. J. Cobb, Baptist pastor, officiated in graveside rites. Carter Funeral Home of Lockney had charge of arrangements.

Vegetables on the February plentiful list include cabbage, carrots, spinach, Irish potatoes, onions, dried peas and beans and canned corn.

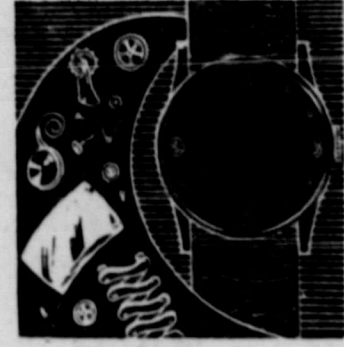

WATCH REPAIR

Dependable workmanship, tested for accuracy on the famous Watchmaster.

Let us do your repair work when your watch goes on the blink.

K. W. COOK Jeweler

Located in Lockney Drug

Singing At C Auditorium S

The regular Fourth will be held at the Sunday afternoon in the C Auditorium. It was announced that Hager. Everyone who is urged to attend to be warm.

INSURANCE

FIRE — HAIL — REAL ESTATE SURETY

MONEY TO ON FARMS and Low Interest

Next door to F

FRANK PE

Phone



H. G. Parker Fun

DRS. HUET & Chiropractic

604 Broad Over Shamrock

PALMER GRAD Specific Chiro

X-Ray Nueropyrom

Services still rigging

Services action tests

ick, offset

ick field of

tal depth 1

depth is 7

the project 1

600 feet fr

17, block I

Special

HONEY Burlesons Lone Star 5 lbs.

Compound Crustene 3 lb. carton

Flour Aunt Jemima 25 lbs.

Coffee Folgers pound 5

Cherries Brimfull Pic No. 2

MARKET

Cheese Longhorn 4

Weiners All Meat

NEWMAN GROCERY & MAR

MONEY TO LOAN

On Farms and Ranches 4% Interest

To put in Irrigation Wells—Pay off Higher Rate Loans Improvements.

R. E. FRY—FLOYDADA

Phone 65

First National Ban

F. L. BROW

Real Estate and Farm Loans City Property — Farm or Ranch Land

If you want to buy or sell, see me.

Located in Frank Perkins building—Lockney.

MAIN STREET CHURCH OF CHRIST

AN APOSTLE'S DESIRE OF HEART AND PRAYER TO GOD FOR SALVATION OF ZEALOUS PEOPLE IN RELIGIOUS ERROR

ROMANS 10:1-3:

"BRETHREN, my heart's desire and prayer to God for Israel is, that they might be saved. For I bear them record that they have a zeal of God, but not according to knowledge. For they being ignorant of God's righteousness, and going about to establish their own righteousness, have not submitted themselves unto the righteousness of God."

"For my thoughts are not your thoughts, neither are your ways my ways, saith the Lord." Isa. 55:8. Read Jer. 10:23, and Isa. 21:3, and 1 Jno. 3:7.

A CORDIAL WELCOME TO ALL

W. A. Record, Minister

Stretch Your Buying Dollar

Coffee Foigers Pound 52c

VEL Box 27c

CRACKERS 2 pound Supreme 43c

LARD 4 pound 79c

Grapefruit 8 pound bag 39c

APPLES Rome Beauty pound 14c

MAIER FOOD STORE

Phone 12—Free Delivery