

EASTLAND TELEGRAM

EASTLAND, TEXAS 76448: Today's CENTER for tomorrow's FUTURE!

Volume 104 Number 65

Thursday, August 16, 1973

Religious Rock, Folk, Gospel Concert At Kendrick Amphitheater August 18

A Religious Rock, Folk, and Gospel Concert will be held Saturday, August 18, in the Kendrick Amphitheater between Eastland and Cisco on U.S. Hwy. 80. The program will begin at 9:00 p.m. and will last approximately two hours.

There are five groups scheduled on the program. One group, The Purpose, from the Northside Baptist Church in Arlington, has just returned from a tour of Illinois and The Carpenter's Children, of the First Baptist Church in

Arlington, have just returned from a week-long tour of Kansas spreading the word of God. The Jubilation from the Highland Baptist Church in Arlington, just back from Chicago, will be performing. The Singing All Stars, of First

Baptist Church in Fort Worth, will also be here for the program Saturday. They will sing at the Men's Fellowship Bible Class of the First Christian Church Sunday morning. Also scheduled for the program is the "Sonlighters" from Abilene, which does a considerable amount of traveling over the states.

Each member of the groups scheduled for the program is a young person that has dedicated his life and talents to spread the gospel of Christ through the means of music. All ages will enjoy this program. It promises to be a very dedicated, soul-winning experience for those in attendance.

A free will offering will be the only admission charge.



Pictured above is the group, "Sonlight" from Abilene. These singers are appearing in the religious rock, folk, and gospel concert at Kendrick Amphitheater Saturday night.

Grand Entry Opens County Junior Rodeo

A colorful grand entry at 8 p.m. Thursday in Ranger Jaycee Arena will mark the opening of Eastland County Junior Rodeo. Performances will continue on Friday and Saturday evenings.

The large number of area contestants entered in all events is indicative of much spirited performance and youth and adults alike are looking forward to the occasion.

Special attention is called to

the downtown parade at 5 p.m. Saturday. Riders of all ages are encouraged to participate. Individuals will be joined by the Grant Town and Strawn Riding Clubs, Erath County Trail Blazers and others. Of special interest to the very young will be the bicycle contest which offers opportunity to decorate the wheels and handle bars, haul a pet, just let one's imagination be the guide.

All parade entrants are asked to assemble at Willows Park at 4 p.m. for instruction and formation, according to announcement of W.C. Tipton and John Wood, parade chairmen. Let's GO to the RODEO!

1973-'74 School Year Officially Begins Monday

KINDERGARTEN SUPPLIES
Three No. 2 pencils
1 large pkg. manila drawing paper
1 medium size bottle Elmer's school glue
1 box of 8 crayons
1 large pkg. construction paper
1 pair school scissors
1 box kleenex (200 count)

The 1973 - 74 School Year will officially begin in Eastland Monday, Aug. 20, when approximately eight hundred students are expected to report to classes in three schools and a Kindergarten.

The first day will be a full day of instruction with classes beginning at 8 a.m. at the Junior and Senior High Schools and at 8:15 in the Elementary School and Kindergarten.

The Kindergarten, first, second and third grades will be dismissed in the afternoon at 2:30 p.m. and the 4th, 5th and 6th grades at 3:15 p.m. High School and Junior High School students will be dismissed at 3:30 p.m.

Monday, September 3 (Labor Day) will be the first scheduled school holiday of the new school year.

Two teachers who will be new to the Eastland system have been named to the faculty for the coming year, Mrs. Linda Guttman, Speech Therapist, and Mrs. Loy's Allmand, elementary teacher.

NO INCREASE
All school cafeterias, under the direction of Mrs. Louise Stansell will be in operation on the first day.

No increase in the price of school lunches will be made at this time, although it is anticipated that a price increase will be forthcoming during the school year to offset the rising cost of lunchroom operation.

The following charges will be in effect at the beginning of the year:

Elementary Student...40c
Jr. High & High School...45c
BUS ROUTES SAME
School buses will be operated

FULLEN MOTOR CO. Laugh-A-Day

If you ever want to write something that has a chance of living on forever, sign a mortgage.

over the same routes as last year and will depart each morning at approximately 6:45 a.m. in order to deliver students to Junior High and High School by 7:55 a.m.

NEW DRESS CODE
At the regular monthly board meeting this month, the board approved a new Dress Code for students attending the Eastland Public Schools:

Students attending the Eastland Public Schools are expected to dress in a manner that is consistent with good grooming and proper taste.

Boys are not permitted to wear a beard, mustache or hair that is unreasonably long or unkempt.

Hair should not extend over the eyes in front, below the ear lobe on the side, or below the bottom of the conventional shirt collar in the back when the individual is in a standing position.

Sideburns should not be extreme in design nor should they extend beyond the bottom of the ear lobe.

Shorts and cut-off jeans are not regarded as proper school attire.

"Tank Tops", fishnet or similar attire are not regarded as proper unless they are worn with a suitable undergarment with sleeves.

"Halter - tops" or other garments exposing either bare midriff or bare backs are not acceptable.

Above the knee culottes, pedal pushers, and bermuda shorts are acceptable attire. The wearing of footwear is required.

PRINCIPALS TO DECIDE
The building principal is authorized to render decisions relative to school dress not specifically outlined in the code, and is authorized to temporarily suspend from school any student that, in his opinion, is not properly dressed.

NEW BOARD MEMBER
In other action the Board appointed Mrs. Katherine Germany to fill the unexpired one year term of Trustee Don Barron, who resigned last month when he moved with his family from Eastland.

FREYSCHLAG Insurance WEATHER REPORT

WEATHER: Continued warm, chance for showers.

Past Matrons Honored

The Past Matrons and Past Patrons Club of District 3, Section 4 were honored on the first anniversary of their organization with a Fish Fry in Dublin, Texas, on July 31, 1973. Members participating in the event were from Cisco, Eastland, Rising Star, DeLeon, Moran, Albany, Clyde, Baird and Dublin. Visitors attending included Mr. and Mrs. Wayne Cosby of Carlton, who furnished the Tartar sauce and Mr. and Mrs. Darrell Gent of Copperas Cove and Mr. and Mrs. Albert Stovall of Gatesville, who furnished and cooked the fish.

Officers elected to serve the club for the 1973 - 74 year were Mary Edwards, President; Celestine Carleton, Secretary - Treasurer; and Charles W. Nelson, Vice President.

Clinton McCain Celebrates 72 Birthday

Clinton McCain, a farmer and rancher of Eastland, celebrated his 72nd birthday August 7, 1973, with his twin sister, Mrs. Bennie Kidd of Sweetwater in Mrs. Kidd's home in the Capitola Community in Fisher County.

Mrs. Kidd has lived there all her life on the farms their father, the late J.W. McCain, settled in the 1880's. Mr. McCain lived there until several years ago when he moved to Eastland and became active in farming and ranching.

Several old friends and relatives called to visit during the day.

One of Mrs. Kidd's nine children, John Kidd, lives in Eastland.

Mr. McCain and Mrs. Kidd are the oldest living twins in Fisher County.

Funeral Thursday

Funeral services for Rayburn Miller, 80, father of Pat Miller, of Eastland, are expected to be held Thursday at the First Methodist Church in Troy, Texas, according to word received here.

Mr. Miller died suddenly of an apparent heart attack shortly after noon Tuesday in Temple. His wife preceded him in death about four years ago. Mr. Miller lived at Troy.

Survivors in addition to Mr. Miller of Eastland are another son, Ed of Belton, and a daughter, Mary Lou Miller of Troy; four grandchildren and three great-grandchildren.



(Photos by Lloyd Armstrong)

Ginger Whitacre of Erath County was crowned the 1973 Texas State Peanut Queen Saturday night.



IT WAS in '96 that gold was first discovered on this date in the Klondike. Folks find it every day in Eastland -- golden sunshine, golden climate and golden opportunities, to name a few.

TWO NEW faces downtown and mighty pretty are the "front-liftings" at the Texas Electric Service Co. Eastland Division office on E. Commerce, and at Bray's Department Store. The stone front at TESCO is a thing of beauty and most unusual. They tell us that the various slabs came key and numbered and went up, to be joint-filled, and now appear solid. And the ladies over at the Library (through their helpers) are certainly making attractive changes for that building.

EDDIE & Johnnie Gallagher left Sunday for a two-weeks outing at Gorman Falls (near Bend, Tex.). Accompanying them are Johnnie's mother, Mrs. Jewell Jones of Ballinger and Eddie's mother and brother, Eunice and Ralph Gallagher of Hyattsville, Maryland. Johnnie notes the catch of a 60-pound catfish by a Comanche man there recently.

An old time Country Musical will be held in the recreation room at Eastland Manor Nursing Home Friday evening at 7:30 p.m. Ray Harbin, Larry Mace, Boots Baber and other area musicians will be providing the music.

All friends and families of residents are invited to attend.

The Singing All-Stars, a religious group from the First Baptist Church in Fort Worth, will sing at the Men's Fellowship Bible Class Sunday morning at 9:45.

The Bullets, an Eastland men's softball team, will play a Breckenridge team Thursday night at 8:00 p.m. at Whitetop Stadium in Eastland.

Gorman Peanut Company Sells To American Cold Storage

Sale of the physical properties of Gorman Peanut Company and its affiliate, M&W Lumber and Supply Company, to American Cold Storage Corporation of Suffolk, Va., has been announced by M.E. and W.T. Shell, president and secretary-treasurer of

GPC and M&W. The sale occurred July 31, 1973.

Included in the sale were shelling plants at Gorman, Houston, and San Antonio, dryers at Carbon, Pearsall, Pleasanton, and Stockdale, a warehouse at Ranger, and dryers at Fort Cobb, Okla.

Texas operations of American Cold Storage Corporation will be headquartered in Gorman, with T.H. Birdsong, III, as manager.

N.C. Holland Funeral Held Saturday

N.C. Holland, 77, of Alba, Texas, father of Mrs. Pete Tindall of Eastland, passed away in his sleep Thursday. Funeral services were held at 2:30 p.m. Saturday in the First Baptist Church in Alba with burial in Sharp Cemetery in Hopkins County. Survivors include three daughters, two sons, nine grandchildren, 14 great-grandchildren, one sister, and two brothers.

Fire Destroys Home

Fire of undetermined origin destroyed an unoccupied two-story home owned by Bill Carleton at Carbon about 11:30 p.m. Sunday.

The home was known as the old Buck Tate place. Fire departments from Carbon, Eastland, Olden, and Gorman responded to the alarm.

Carleton and his family reside in Odessa, however, the house was furnished and had recently been remodeled to accommodate a beauty shop.



(Photos by Lloyd Armstrong)

Pictured from left to right are second runner up Cheri Lundquist of Colorado County and first runner up and "Miss Congeniality" George Ann Bettis, representing Eastland County.

Shamrock Service Station

Under New Management

Norman Davis And DeLos Santos

Managers

Emeterio Vasques, Jr. Assistant Manager

Gas-Beer-Wine-Ice

Highway 80 E. Ranger, Texas

Hours: Sun.-Thurs 7-11 Fri.— Sat. 7-11:30



SERVING WEST TEXAS

SINCE 1884

YOU ONLY BUY A MEMORIAL ONCE: WE CAN HELP YOU MAKE THE RIGHT CHOICE.

THE EXPERIENCE, ABILITY AND INTEGRITY OF RAWLINS MONUMENTS IS YOUR ASSURANCE OF THE VERY BEST IN DESIGN, WORKMANSHIP, AND MATERIAL.

AS TRAINED MEMORIAL CONSULTANTS, RAWLINS MONUMENTS WOULD LIKE TO AID YOU IN PLANNING AND DESIGNING A MEMORIAL TO A LOVED ONE OR A FAMILY. THIS IS PART OF OUR SERVICE...IT IS A SERVICE THAT PERMITS YOU TO PLAN SENSIBLY AND CORRECTLY A SUITABLE MEMORIAL OF EITHER MARBLE OR GRANITE. OUR 89 YEARS OF EXPERIENCE AND OUR SINCERE DESIRE TO SERVE YOU ARE YOURS FOR THE ASKING. CONVENIENT TERMS WITH NO INTEREST OR CARRYING CHARGES.

Roy Taylor, Local Representative WE ARE AN AUTHORIZED

"ROCK OF AGES" DEALER

RAWLINS MONUMENTS

500 E. 8th St. Call Collect 442-1127-Cisco

Machine Operators Needed

No Experience Needed

Apply in person,

Hollywood Vassarette

202 N. College

Eastland, Texas

Equal Opportunity Employer

NOW OPEN

★ ★ ★ Fontain, Blu ★ ★ ★

Formerly The Brown Jug In Gorman

Special Every Friday Night

CATFISH

Farm Raised

All You Can Eat Family Style

Hush Puppies, Cole Slaw, And All The Trimmings

Wednesday Nights

FRIED CHICKEN

Family Style

MONDAY NITE

MEXICAN FOOD

Come Have Sunday Lunch

LUNCHES

All The Time

1 Meat, Two Vegetables \$1.25

Salad, Desert

Private Party Room On Special Request

For Reservations

Call 817-734-5808

Managers

Jug And Vergie Dennis

Owner

Dub Ramsey

Open 6 A.M. To 10 P.M. Except Fridays & Saturdays

Till 12:00 Family Style Servings From 7-10

Thursday, August 16, 1973

Religious Rock, Folk, And Gospel Concert

You are invited to a RELIGIOUS ROCK, FOLK, AND GOSPEL CONCERT to be held Saturday, August 18, at Kendrick Amphitheater, on U.S. Hwy. 80. The program will begin at 9:00 p.m. and will last two to two and one-half hours. All ages will enjoy this program.

There are five groups scheduled on the program and it promises to be a very dedicated, soul-winning experience for those in attendance.

One group in the format, THE PURPOSE, from the Northside Baptist Church in Arlington, has just returned from a tour of Illinois and THE CARPENTER'S CHILDREN, of the First Baptist Church in Arlington, returned this week from a week-long tour of the state of Kansas spreading the Word of God. The JUBILATION from the Highland Baptist Church in Arlington is now in the Chicago area and will return just in time for the program. The SINGING ALL STARS, of First Baptist Church in Fort Worth, are in the State of Oklahoma this week on tour and will return in time for the program here. Also scheduled for the program is the SONLIGHTERS from Abilene, which does a considerable amount of traveling over the states.

Each member of the groups scheduled for the program is a young person that has dedicated his life and talents to spread the GOSPEL OF CHRIST through the means of music. Several members of the groups have full-time positions in various churches, such as choir directors, youth directors, pianists, organists,

educational directors, etc. and yet they find time in their schedules to also reach out to the youth through this type of program and tell them about CHRIST.

Make plans now to come, by yourself - bring a car - full - or bring a busload, but do come this way for an inspiring evening with CHRIST.

A free will offering will be the only admission charge.

Thoughts

From The Living Bible

Then Saul confessed, "I have done wrong. Come back home, my son, and I'll no longer try to harm you; for you saved my life today. I have been a fool, and very, very wrong." "Here is your spear, sir," David replied. "Let one of your young men come over and get it. The Lord gives his own reward for doing good and for being loyal, and I refused to kill you even when the Lord placed you in my power. Now may the Lord save my life, even as I have saved yours today. May he rescue me from all my troubles."

1 Samuel 26:21-24
Religious Heritage of America

The Eastland County Junior Rodeo Association will present its first annual open show August 16, 17, and 18 at the Ranger Jaycee Arena in Ranger, starting time 8:00 p.m.

The events are open to boys and girls through 19 years of age.



Pictured are three of the nine members of the Jubilation from the Highland Baptist Church in Arlington. This group of young people are just returning from a tour of Illinois where they spread the word of God through their musical talents to thousands. They will be one of the five groups on the Religious Rock, Folk and Gospel Concert at the Kendrick Amphitheater Aug. 18 at 9:00 p.m.

Dear Friends And Acquaintances

Of Lillian Horton

Please come to our party honoring Lillian Horton (Mrs. James) of Eastland, Texas at the Lone Cedar Country Club on August 26th from 4 to 6 P.M.

Horace and Gerry Horton

Jim and Toni Harris

James Horton, Donna Lyles

Choose

Between 2 Beautiful New And Modern, Nursing Homes which offer Every Thing You Desire To Really Enjoy Living

Beautifully furnished

Chapel with Piano &

Organ

• Midweek and

Sunday Worship Service

• CABLE T.V. in Every

Room

• Telephone Service

in Every Room

• Out Door Patios

• Daily Activities

Planned For Each

Individual Patient.

24 Hour Nursing Care Under

The Careful Supervision Of

Highly Trained & Skilled

Licensed Vocational Nurses.

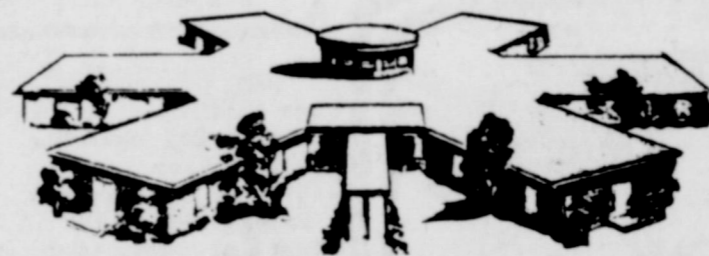

"dedicated to nursing care progress"

"We Care Enough To

Give The Very Best"

We Are Licensed By The State

Department Of Health And Vendor

Approved By The State

Department Of Public Welfare.

EASTLAND

Manor

1405 West Commerce

"It Cost No More To

Enjoy The Finest"

6 29-2686

Eugene Frost,

Administrator

We Can And Do Care

For All Types Of Patients

Including Ambulatory,

Semi-Ambulatory,

And Bedfast.

Valley View

Lodge

700 South Ostrom St.

629-1779

Shirley Frost,

Administrator

"Why Settle For Second Best"

All Our Patients Receive Tender, Loving Care!



GINGER RODGERS was named winner of the Miss Texas Rural Electrification Contest during the 33rd Annual Meeting of the State Association of Texas Electric Cooperatives in Houston. Miss Rodgers represented the electric cooperatives in the lower Rolling Plains section of Texas. The state winner is a graduate of Mozelle High School and is the daughter of Mr. and Mrs. R.V. Rodgers of Coleman. Miss Rodgers served as a member of the basketball, volleyball and track teams, as well as 4-H and Future Homemakers, and plans to attend Texas Tech. The new Miss TRE will represent Texas during the Miss National Rural Electrification competition next year in San Francisco.

ROOFING

Doyle Squires Contr. Olden, Tex. 653-2212 Call after 6 p.m. 12-29 TF.

Hospital Notes

Patients in Eastland Memorial Hospital Wednesday morning were:

Gilbert Womack, Ft. Worth
Emma Fox
Audean Comis
Marvin Martin, Cisco
Ira Hanna
Vestal Roberts, Cisco
Ura Samuels, Abilene
Claude Gillum, Ranger
Bessie Richardson
Alma Page, Ranger
Maudie Hardy, Rising Star
Burva McKelvin
Mazie Zellars, Comanche
Gaylon Byrd, Breckenridge
Margaret Lane, Cisco
Sara Barron, Gordon
Gladys Ricks, Cisco
Dawn Underhill
Ted Means
James Barnes, Ranger
Arlee Wigington, Gatesville
Dortha Roye, Gordon
Thomas Holland, DeLeon
Claude Chipman, Gordon
Della Russell
Marie Midkiff
Bessie Garrett, Carbon
Ruby Thomas
Ida Carter
Alma Keown, Gordon
Mrs. Bill McAlister, Cisco
James Miller, Austin
Edward Walters, Clyde
Maggie Christian, R. Star
Edna Ballew
Maxie Law, Ranger
Anna Squiers,
Daisy Motley, Ranzer
Marsella Dennis, Stephen-ville
Debra Casey
Sandra Allen, R. Star
Ollie Williams
Geneva England
Verda Eaves
Pauline Love
D.J. Walker
Darlene Harrell, R. Star
Geneva Linney, R. Star
Estelle Chew, Cisco
Jo White, Breckenridge
Floyd Allmond
Adrain Holloway

Eddie Walters, LClyde
Vera Hill, R. Star
Willie Jo Carter
Baby Girl England
Baby Boy Walters, Clyde

Patients in Ranger General Hospital Wednesday morning were:

Celia Vaughn
Eva Dunlap
Edna Pepper
John Anderson
H.G. Ramsey
Monica Stewart
Laura Shugart
Carrie Hightower
Lenie J. Simms
R.O. Buckley
Gary Arnold
Alex Ramirez
Lowell Morton
Guy Hill
Florence Robinson
Myrtle Templeton
Myrtle Douglas
Arthur Williams
Tom Fox, Jr.
Raymond Brown
Tommy Blackwell
Johnny Bethany
Robert A. Koerner
Steve Reibe
Alpha Owens
Billy Dossey
T.B. Morris
Jack Gilbert

Roof Garden To House Dance Education

The Roof Garden of the Village Hotel in Eastland is to house new school in Dance Education.

Ross Hancock, Dance Master, will be at the Village Hotel for auditioning and registering students for September opening of the school.

Mr. Hancock was for seven years Artistic Director and Director in residence for Denver Civic Ballet. More

County Rodeo August 16, 17, 18

PROCLAMATION
WHEREAS the livestock industry has long been a major source of revenue in Eastland County, providing both a means of livelihood for the rancher and a contribution to the stable economy of the area; and

WHEREAS Ranching is a family institution wherein all members may participate in production and perpetuation of the way of life which has the added benefit of recreation;

NOW, THEREFORE I, SCOTT BAILEY, County Judge of Eastland County, DO HEREBY PROCLAIM the week of August 12 - 18 as JUNIOR RODEO WEEK in Eastland County and I encourage residents to lend presence and support to the youth who will be competing in the Junior Rodeo to be held on August 16 - 17 118 in the Jaycee Arena in Ranger

IN WITNESS WHEREOF, I have hereunto set my hand on this the 11th day of August, 1973.

recently from Old Mexico, he was Soloist with Ballet Classico de Mexico, Palacio de Bellas Artes, Mexico City. For a number of years Mr. Hancock had his own school in both Fort Worth and Dallas. Taught at TCU and was performer and choreographer at TV Station WBAP, producing such shows as Pat Boom, Teen Canteen, The Empire Steel Show, Around the World with the Bartons and others.

Mr. Hancock has been a long time associate of Enrique Martinez, Ballet Master for American Ballet Theatre and guest Director for Ballet Classico de Mexico and Artistic Director at La Scala, Italy.

For many years Mr. Hancock has been in demand as guest Artist, teaching master classes and seminars and conservatories in major cities from San Francisco to Boston. Although classical and Modern Dance techniques will be stressed Musical Comedy, Tap and Acrobatics are a part of the curriculum. Tumbling and Gymnastics for Boys.

The registration date of Eastland's new Dance Arts Center, will soon be announced and application slips available.

Eastland Co. JUNIOR RODEO ASSOCIATION JUNIOR RODEO
August 16, 17, 18, 1973
Ranger Jaycee Arena

8:00 Grand Entry

BOYS
8-11 Under \$5.00 Per Event No Jackpot
Flag Race
Barrel Race
Bull Riding
Break-Away Roping
Bull Riding
Flag Race
Goat Tie

GIRLS
8-11 Under \$5.00 Per Event No Jackpot
Flag Race
Fole Bending
Barrel Race
Fole-Bending
Flag Race
Goat Tie

9-12 \$5.00 Per Event No Jackpot
Barrel Race
Fole-Bending
Flag Race
Goat Tie

13-15 \$10.00 Per Event Jackpot \$5.00
Barrel Race
Fole-Bending
Flag Race
Goat Tie

16-19 \$10.00 Per Event Jackpot \$5.00
Barrel Race
Fole-Bending
Flag Race
Goat Tie

Wild Steer Riding (3 Member Team) Boy or Girl Any Age
Limit 8 Teams Per Night - \$15.00 Entry Fee Jackpot \$7.50
Same Team May Enter All Three Nights- Ride 1/4th Losses Hope
Points will not count for All-Around.

Calf Scramble 12 & Under Each Night 3 Places \$5-\$3-\$2
Sterling Silver Buckles to All-Around in each age group. Two younger age groups to be figured on places and two older age groups to be figured on dollars won. Enter TWO events and place in two for All-Around. ALL AROUND OF SHOW BOY & GIRL WILL RECEIVE A \$75.00 RELSON BUCKLE. THE TWO OLDER AGE GROUPS WILL COMPETE FOR ALL AROUND OF SHOW. YOUNGER AGE GROUP WILL COMPETE FOR ALL AROUND IN THEIR AGE GROUP ONLY. YOU MAY MOVE UP IN AN OLDER AGE GROUP IF YOU SO DESIRE IN ORDER TO COMPETE IN JACKPOT AND FOR ALL AROUND OF SHOW. Age will be determined as of Jan. 1, 1973. Proof of age on request. Two younger age group will receive Trophy & Ribbons. Trophy for First, Ribbons thru 5th place, each event.

Entry blank must be mailed in no later than August 13th. Entry Fee must accompany entry that has been signed and notarized. No refunds after August 14, 1973. No telephone entries please. One go-around-lack after show each night. Contestants will be charged at Gate. Set-ups will be given if possible. Call 647-3236 for position to perform Wednesday, August 15, 6:47-1923 after 5:00.
Mail entries to Bradford's Bookkeeping & Tax Service
117 S. Bush
Ranger, Texas 76470

Contestant will not talk to Judge while working. Use of profane language or drinking will disqualify any contestant with no refund of money. Age groups will not be combined.

MEMBER'S RELEASE: In consideration of the acceptance of our above named child, I agree that in no way will I hold the Eastland Co. Junior Rodeo Ass'n, Ranger Jaycees, Ranger Chamber of Commerce, or its Officers, Directors or members, liable for any and all injury of said child or property. I hereby consent that my child may participate in the events marked above.

THE FOREGOING SIGNATURE HAS ADOPTED BEFORE ME OF THIS DAY OF 1973. MY COMMISSION EXPIRES

Notary Public
Signature of Parent



The Carpenter's Children of the First Baptist Church in Arlington is appearing in the religious rock, folk and gospel concert Saturday evening at Kendrick Amphitheater.

Used
24" x 36"
Aluminum
Printing Plates
25¢
each
At the
Telegram Office

Thursday,
August 16, 1973

MRS BAIRD'S

Baked with family pride.

For Professional Care in an Atmosphere of Family Living

Hickman Nursing Home

Offers You

- 24 hour nursing care supervised by a Registered Nurse
- Special diet management by an A.D.A. dietitian
- Full program of recreation and entertainment
- Private rooms

629-2624
411 West Moss
Eastland, Texas

WE CARE FOR YOU... WE CARE ABOUT YOU

Custom Built Homes

By H. & W. Development Co.

1201 W. Commerce
Eastland, Ph 629-1702

SEEDS FROM THE SOWER

By Michael A. Guido, Metter, Georgia

"But" is a conjunction with a difference. It does more than add information. It usually alters it.

For example, one says, "He is a good friend, but..." Trust him? Never. Another says, "That is a good idea, but..." Accept it? No. Abandon it? Yes.

In the study of the Bible, the "but" keeps butting in. And with the butting in comes a blessedness.

There were some folk who worshipped idols and wallowed in sin. They were enjoying prosperity and pleasure, while the people of God were enduring poverty and pain. So they asked in Psalm 115:2, "Where is now their God?"

They meant, "If God exists, He has abdicated. Where is His power and pity? Such a God cannot be trusted. Oh, He must be dead."

"But our God is in the heavens," they replied, "He hath done whatsoever He hath pleased."

God is in charge and He cares for His own. Our lives are neither the product of blind fate nor the result of capricious chance. He makes all things fit into a plan for good to those who love Him. Do you love Him?

ROOFING

Doyle Squares Contr. Olden
Tex. 653-2212 Call after
p.m. 12-29 TF.

Visiting Hours

Eastland Memorial Hospital
2:30 to 4 p. m.
7 to 8:30 p. m.

RANGER DRIVE-IN THEATRE
Show Starts at Dark

**BURT REYNOLDS
DYAN CANNON**

Shamus

LAST TIMES
WEDNESDAY
AUGUST 15th

PG PARENTAL GUIDANCE SUGGESTED

Five killers robbed the Valentine bank.
The lucky ones got caught.
The rest got Cahill.

**STARTS THURSDAY
AUGUST 16th**

JOHN WAYNE
IS
CAHILL
UNITED STATES MARSHAL

PG PARENTAL GUIDANCE SUGGESTED

Interstate's Fri. - Sat. - Sun
abc MAJESTIC Fri: Features
7:30 - 9:11

DOWNTOWN EASTLAND Sat - Sun
Features
2:30 - 4:11 - 5:52 - 7:33 - 9:14

**GIANT EXCITEMENT!
TERROR!**

The World's Most Terrifying Monsters
Fight For The Global Title In The
Mightiest Battle Ever Seen!

CAN A COUNTRY SURVIVE WHEN TWO GARGANTUAS BATTLE TO THE DEATH?

WAR OF THE GARGANTUAS

QUETTA'S

SPORTS WEAR BOUTIQUE

NOW OPEN

Mrs. David Coan -- Owner

Summer Merchandise

SLACKS TOPS DRESSES
AND SHORTS

Featuring Junior & Misses Styles
Next To Ramada Inn

QUETTA'S

Sports Wear Boutique

In The Fashion Barn Open 9:30 to 5:30 Monday-Saturday

Food Stamps To Be Issued November 1, 1973

The first food stamps in Eastland County will be issued November 1, 1973. But before the statewide food stamp program is implemented here, there is much work to be done.

Commodities is the food assistance program currently operating in this county. The 62nd Texas Legislature appropriated \$7.7 million for a statewide food stamp program to replace all county food stamp programs and com-

modity food distributions. By November 1973 the 254 counties in Texas will be operating the statewide program administered by the State Department of Public Welfare.

Before the first stamps are issued here, extensive preparation must be completed. Current commodity recipients will be notified that food stamps will replace the present food assistance program. Most commodity

recipients should be eligible for food stamps also as well as others who might not receive commodity foods.

Certification for food stamp eligibility will begin at a later date. All persons who don't make much money or who are unemployed are encouraged to apply at that time. Welfare recipients aren't the only ones who can qualify for food stamps.

Local issuance offices will

sell the food stamps to all who are certified eligible to receive them. Participating households will be able to buy their stamps at the issuance office nearest them and at their own convenience. The long waiting lines which are now a problem at commodity distribution centers should be eliminated.

Food stamps, which can be used for the purchase of most foods and food products, will be accepted by many of the local grocers. Payment is made by tearing the necessary amount

of food stamps from the coupon book at the time of purchase. Tobacco, alcoholic beverages and imported items cannot be purchased with food stamps.

Grocers can deposit food stamps just as they do money. Local bankers then send the stamps to the United States Department of Agriculture for redemption.

Food stamps are good for everyone. The community enjoys increased economic activity, new jobs are created and low-income households

Food And Nutrition Service To Be Held September 10

The United States Department of Agriculture, Food and Nutrition Service will conduct a meeting with all retail and wholesale grocery firms in Eastland and Callahan Counties according to Carl Speegle, Officer-in-Charge.

For more information about food stamps, contact the local welfare office at the Courthouse basement, Eastland, telephone number 629-1544.

of the Abilene and Wichita Falls Field Offices.

The purpose of the retail-wholesale grocery meeting is to familiarize the business owner-managers with the procedures and public laws which they will be expected to abide by once they are authorized by the United States Department of Agriculture to accept USDA Food Stamps.

Mr. Speegle encourages all retail grocers, bank representatives and Depart-

ment of Texas Welfare personnel to attend this meeting. Retail information kits have been mailed to retailers.

All retailers who have received these kits are encouraged to bring them to the meeting.

The meeting will be held September 10, 1973, District Courtroom, Eastland, at 7:30 p.m.

It is important that all retailers and wholesalers in Eastland attend this meeting.



Hen Turkeys 65¢

Young, Over 10-Lbs. USDA Grade 'A' —Lb.

Hindquarter 59¢ | Beef Patties 89¢ | Canned Hams \$6³²

Safeway Meats Are Guaranteed to Please!

Fresh Pork Roast \$1¹⁹

Fresh Pork Chops Family Pack \$1³⁵
Sliced Bacon Safeway #1 Quality 1-lb. Pkg. \$1²⁹
Link Sausage Park, Safeway 1-lb. Pkg. \$1⁰⁹
Armour Hot Dogs Armour Star 12-oz. Pkg. 89¢

Chipped Meats 39¢

Chopped Ham Safeway, Sliced 4-oz. Pkg. 79¢
Danola Ham Sliced, Delicious! 4-oz. Pkg. 79¢
Corn Dogs Bulk Pack 10-Ct. Pkg. \$1³⁹
Fish Sticks Pre-Cooked, Large Size —Lb. 69¢

Compare Variety and Quality!

Smoked Picnic 85¢

Firm and Lean! Flavorful! Whole—Lb.

Sliced Picnics Smoked, *Half or *Whole —Lb. 93¢
Turbot Fillets Greenland, Fresh-Frozen —Lb. 75¢
Flounder Fillets Raw, Fresh-Frozen —Lb. \$1³⁹



BRILLED FISH STEAKS OR FILLETS

Sprinkle fish steaks generously with lemon juice (about 1 hour before boiling gives better flavor). Place on greased broiler rack; sprinkle with salt and pepper; brush with melted butter and margarine. Broil in pre-heated broiler about 3 to 5 inches from source of heat (no turning, please) for 5 to 10 minutes or until fish flakes easily when pierced with a fork. Use spatula or pancake turner to remove to heated platter; garnish with chopped parsley. To add variety in flavor, try adding a pinch of one of the following herbs to the butter or margarine before broiling: oregano, thyme, basil, marjoram, mint, dill or tarragon.

WE ARE SHORT OF BEEF!

We are short of beef in our display cases because we have been unable to purchase USDA Choice Grade Beef at the packers' beef price ceilings in effect at the time ceilings were set on our retail beef prices. We are unable to pay in excess of a supplier's legal ceiling price, or resort to any other practice which would circumvent the intent of the meat price ceiling regulations.

TRY THIS TASTY RECIPE



Money-Saving Low Prices!

Pineapple Juice 29¢
Dole, Fancy Unsweetened 46-oz. Can
Safeway Special!

Pork & Beans 17¢
Van Camp's, Tasty! 16-oz. Can
Safeway Big Buy!

Tomato Catsup 22¢
Highway, Flavorful! 14-oz. Bottle
Safeway Big Buy!

Corn Chips 39¢
Party Pride, For Snacks! 11-oz. Pkg.
Safeway Big Buy!

Red Heart 12¢
Dog Food, Beef Flavored! 15.5-oz. Can
Safeway Special!



Gladiola Flour 57¢
Safeway Special!—5-Lb. Bag



Banquet Dinner 39¢

(Except Beef) Big Buy! —Reg. Pkg.

Cream Pies Bel-air Easy Desserts! 14-oz. Pkg. 29¢
Orange Juice Texsun, Concentrate 6-oz. Can 19¢
Popsicles Kiddies Delight! 6-Bar Pkg. 29¢
Lemonade Scotch Treat, Regular 6-oz. Can 10¢

Everyday Low Prices!

Salad Dressing 37¢
Piedmont, For Sandwiches! —32-oz. Jar

Tomato Soup 11¢
Town House, Zesty! 10.75-oz. Can

Pinto Beans 15¢
Town House, Dry 10-oz. Pkg.

Shop and Save!

Right Guard 89¢
Deodorant, Bronze Can—7-oz. Aerosol

Filler Paper 49¢
HYTONE, 2-Hole 300-Ct. Pkg.

See-Thru Binder \$1⁵⁹
Loose Leaf, 2-Ring —Each

Report Folder 19¢
With Pocket, 2-Prong —Each

Elmer's Glue-All 27¢
For School! 1.25-oz. Plastic

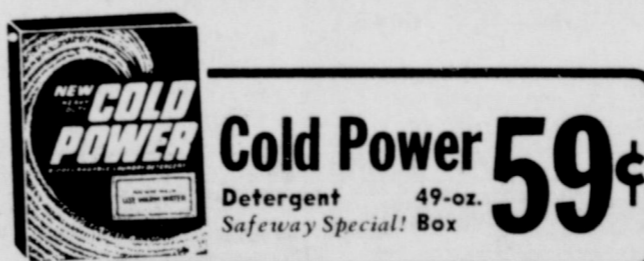

Cold Power 59¢
Detergent 49-oz. Box
Safeway Special!



Aurora Tissue 25¢
Toilet Tissue 2-Roll Pkg.
Safeway Special!

Dairy-Deli Values!

Potato Salad 39¢
Lucerne, Special! —16-oz. Ctn.

Large 'A' Eggs 89¢
Breakfast Gems, Large Size —Dox.

Margarine 10¢
Piedmont Patty 3-oz. Pkg.

Longhorn Cheese 99¢
Safeway Halfman —Lb.

Kraft Margarine 41¢
Miracle Margarine 16-oz. Pkg.

Fresh Bakery Values!

Crushed Wheat 35¢
Bread, Skylark, Special! —16-oz. Loaf

Burger Buns 30¢
Mrs. Wright's, or *Hot Dog Buns, 3-Ct. Pkg.

French Bread 38¢
Skylark, Full Wrapped 16-oz. Loaf

English Muffins 35¢
Mrs. Wright's —12-Ct. Pkg.

Prices Effective Thurs., Fri., Sat., Aug. 16, 17, 18 in EASTLAND
No Sales to Dealers.

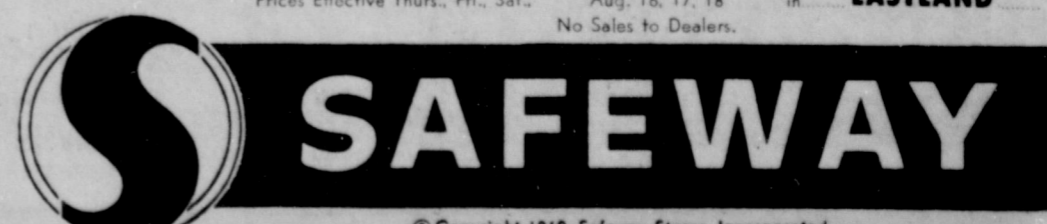

© Copyright 1960, Safeway Stores, Incorporated.

NOTICES

LEGAL NOTICE

THE STATE OF TEXAS
 TO: Charles H. Reily, Lea R. Ellis, Joe R. Henderson, Helen Grayson Reeves, Claude Grayson and Sue Grayson Jameson, and each of the unknown spouses, heirs, devisees, personal representatives, successors, and assigns of Charles H. Reily, Lea R. Ellis, Joe R. Henderson, Helen Grayson Reeves, Claude Grayson and Sue Grayson Jameson, Defendants.
 Greeting:
 YOU (AND EACH OF YOU) ARE HEREBY COMMANDED to appear before the 91st District Court Eastland, Texas of Eastland County at the Courthouse thereof,

in Eastland, Texas, by filing a written answer at or before 10 o'clock a.m. of the first Monday next after the expiration of forty-two days from the date of the issuance of this citation, same being the 17th day of September A.D. 1973, to Plaintiff's Petition filed in said court, on the 14th day of June A.D. 1973, in this cause, numbered 26,123 on the docket of said court and styled Ralph C. Hart, Et Al, Plaintiffs, vs. Charles H. Reily, Lea R. Ellis, Joe R. Henderson, Helen Grayson Reeves, Claude Grayson and Sue Grayson Jameson, and each of the unknown spouses, heirs, devisees, personal representatives, successors, and assigns of Charles H. Reily, Lea R. Ellis, Joe R. Henderson, Helen Grayson Reeves, Claude Grayson and Sue Grayson Jameson, Defendants.
 This suit is brought for the appointment of a receiver under Article 2320b R.C.S., to lease the oil, gas and mineral interests of defendants in the following described land, to-wit:

160 acres, more or less, being all of the P. Norton Survey, Abst. 684, in Eastland County, Texas.
 If this citation is not served within ninety days after the date of its issuance, it shall be returned unserved.
 The officer executing this writ shall promptly serve the same according to requirements of law, and the mandates hereof, and make due return as the law directs.
 Witness, Joe T. Gray, Clerk of the 91st District Court of Eastland County, Texas.
 Issued and given under my hand and the seal of said court at Eastland, Texas, this 3rd day of August A.D. 1973.
 Joe T. Gray, Clerk, 91st District Court Eastland County, Texas.
 By Mary Jane Rowch, Deputy.
 (8-9, 8-16, 8-23, 8-30)

assigns of Minette K. Unger, Ethel McCamey, John J. Sheerin, Abel Bliss, Geo. W. Wetherbee, Sarah Slagle, F.W. Clinkscales and Wilmine B. Wooldridge, Defendant.
 YOU (AND EACH OF YOU) ARE HEREBY COMMANDED to appear before the 91st Court Eastland, Texas of Eastland County at the Courthouse thereof, in Eastland, Texas, by filing a written answer at or before 10 o'clock a.m. of the first Monday next after the expiration of forty-two days from the date of the issuance of this citation, same being the 24th day of September A.D. 1973, to Plaintiff's Petition filed in said court, on the 9th day of August A.D. 1973, in this cause, number 26,170 on the docket of said court and styled Ralph C. Hart, Et Al, Plaintiff, vs. Minette K. Unger, Ethel McCamey, John J. Sheerin, Abel Bliss, Geo. W. Wetherbee, Sarah Slagle, F.W. Clinkscales and Wilmine B. Wooldridge, and each of the unknown spouses, heirs, devisees, personal representatives, successors and - or assigns of Minette K. Unger, Ethel McCamey, John J. Sheerin, Abel Bliss, Geo. W. Wetherbee, Sarah Slagle, F.W. Clinkscales and Wilmine B. Wooldridge.,

Defendant.
 A brief statement of the nature of this suit is as follows, to-wit: This suit is brought for the appointment of a receiver under Art. 2320b R.C.S., to lease the oil, gas and mineral interests of defendants in the following described land, to-wit:
 87.5 acres, more or less, out of the H.B. Sparks Survey (Abst. 690) and of the C.L. Lewis Survey (Abst. 1316).
 Beginning at the S.W. corner of said Sparks Survey; Thence North along W.B.L. of Sparks Survey 394.5 varas; Thence East 1250 varas to E.B.L. of said Lewis Survey; Thence South 394.5 varas along E.B.L. of said Lewis Survey; Thence West 1250 varas to beginning.
 If this citation is not served within ninety days after the date of its issuance, it shall be returned unserved.
 The officer executing this writ shall promptly serve the same according to requirements of law, and the mandates hereof, and make due return as the law directs.
 Witness, Joe T. Gray, Clerk of the 91st District Court of Eastland County, Texas.
 Issued and given under my hand and the seal of said court at Eastland, Texas, this 10th day of August A.D. 1973.
 Joe T. Gray Clerk,

EASTLAND NEWS:
 Mrs. Jackie Hurst of Fort Worth spent last week with her sister Mrs. Lelia Wyatt.
 Mrs. A.H. Lockhart had two of her daughters visiting her this week. They were Mrs. Ruby Nell Dolf of Cincinnati, Ohio, and Mrs. Willie Mae Hill of Odessa. A granddaughter, Mrs. Sue Thomas of Dallas also visited during the weekend.
 Mr. and Mrs. Warner Sims
 91st District Court Eastland County, Texas
 By Mary Jane Rowch, Deputy
 (8-16, 8-23, 8-30, 9-6)

and Sharon of Lubbock visited her parents Mr. and Mrs. C.P. Hastings during the weekend.
 Mrs. Ada Wright has returned from a visit with her daughters and families Mr. and Mrs. Elvis Vaughn of Midland and Mr. and Mrs. Rankin Bradshaw of McCamey.
 Mr. and Mrs. Parks Poe attended the Fiftieth Wedding Anniversary of Rev. and Mrs. Lawrence Trot.
 Mr. and Mrs. Donald Tow of Temple, Miss Jana Tow of Fort Worth and Mrs. Art Howard and Heather of Shreveport, Louisiana, have been visiting

their parents and grandparents Mr. and Mrs. Edgar Altom and Mr. and Mrs. Joe Tow.
 Mrs. Beulah Sheridan and daughter of Cisco spent Monday afternoon with Mrs. A.H. Rockhart.
 Thursday, August 16, 1973
AIR CONDITIONING

 FREE "STICK-ONS" Pick up yours today!

GREGORY PLUMBING & HEATING
 629-2844
 Res. 639-2340

TUNE UP
 Install Points, Plugs And Condenser (If Needed) Set Timing-Adjust Dwell-Adjust Auto Choke Adjust Idle- Check Fluid Levels **\$9.50** Plus Parts

FRONT END ALIGNMENT
 Adjust Camber-Casters-Toein Check Front Shocks Check For Worn Parts **\$9.50**

WHEEL BALANCING
 (Spin Balance) Each Wheel **\$1.50** Plus Wts.

CHARGE AIR CONDITIONER SYSTEM
 Check System For Leaks (Freon Extra) **\$3.50**

These are our everyday low prices
 Authorized State Inspection Station

Cadillac-Buick-Olds-Pont-GMC
Bruce Pipkin Motor Co.
 314 W. Main St. 629-2636

CITATION BY PUBLICATION
 THE STATE OF TEXAS
 TO: Minette K. Unger, Ethel McCamey, John J. Sheering, Abel Bliss, Geo. W. Wetherbee, Sarah Slagle, F.W. Clinkscales and Wilmine B. Wooldridge, and each of the unknown spouses, heirs, devisees, personal representatives, successors and - or assigns of Minette K. Unger, Ethel McCamey, John J. Sheerin, Abel Bliss, Geo. W. Wetherbee, Sarah Slagle, F.W. Clinkscales and Wilmine B. Wooldridge.,

Introducing:
THE HAIR-EM
 Eastland's newest salon now accepting appointments for all the latest in hairstyling. From Blow Drying and Iron Curling -Quick Service To Individualized permanent waves and the newest haircuts.
 Also accepting appointments Tuesday 5 to 7P.M. only for men's haircutting and hair styling.
 Call 629-8001
THE HAIR-EM
 1300 S. Seaman



PRESCRIPTIONS
 ECONOMICAL PRESCRIPTION SERVICE IS OUR SPECIALTY
 DRIVE THRU WINDOW SERVICE
629-1166
 HOSPITAL & CONValescent EQP
 RENT SELL
U-SAVE PHARMACY
 201 S. DAUGHERTY

THE REAL SHIRT AND PANTS LOOK!
 SHIRT \$6. Regular \$7.99
 PANTS \$10. Regular \$11.99

The real McCoy... to enjoy wearing day in, day out. No gimmickry to these classic clean lines. Keep fashion options open with a soft clingy machine washable 100% Acrilan jersey shirt that's ready when you are. Team with bold plaid 100% cotton brushed denim pants. Nattily cuffed, slash pockets, fly front, waist band, belt loops. Machine washable. The spiffiest for school!
 Shirt: 30/36,
 Pants: 3/4 - 13/14.

Other Knit Tops \$5.00

mode o'day
 INSERT ADDRESS HERE



THIS REPORT TO BE RETURNED TO
 DEPARTMENT OF THE TREASURY
 OFFICE OF REVENUE SHARING
 1900 PENNSYLVANIA AVE N W
 WASHINGTON, D.C. 20226

THE GOVERNMENT OF
 EASTLAND CITY
 HAS USED ITS REVENUE SHARING PAYMENT FOR THE PERIOD BEGINNING
 JAN 1, 1973 ENDING JUN 30, 1973
 IN THE FOLLOWING MANNER BASED UPON A
 TOTAL PAYMENT OF \$20,586
 ACCOUNT NO. 44 2 067 003
 EASTLAND CITY
 CITY MANAGER
 BX 745
 EASTLAND TEX 76448

PRIORITY EXPENDITURE CATEGORIES (A)	ACTUAL EXPENDITURES (B)	PERCENT USED FOR MAINTENANCE OF EXISTING SERVICES (C)	PERCENT USED FOR NEW OR EXPANDED SERVICES (D)	PURPOSE (E)	ACTUAL EXPENDITURES (F)	PERCENT USED FOR			
						EQUIPMENT (G)	CONSTRUCTION (H)	LAND ACQUISITION (I)	DEBT RETIREMENT (J)
1 PUBLIC SAFETY	\$ 1842.00	100 %	%	10 MULTI-PURPOSE AND GENERAL GOVT	\$	%	%	%	%
2 ENVIRONMENTAL PROTECTION	\$ 850.00	100 %	%	11 EDUCATION	\$	%	%	%	%
3 PUBLIC TRANSPORTATION	\$ 939.00	100 %	%	12 HEALTH	\$	%	%	%	%
4 HEALTH	\$ 397.00	100 %	%	13 TRANSPORTATION	\$	%	%	%	%
5 RECREATION	\$ 225.00	100 %	%	14 SOCIAL DEVELOPMENT	\$	%	%	%	%
6 LIBRARIES	\$	%	%	15 HOUSING & COMMUNITY DEVELOPMENT	\$	%	%	%	%
7 SOCIAL SERVICES FOR AGED & POOR	\$ 554.00	100 %	%	16 ECONOMIC DEVELOPMENT	\$	%	%	%	%
8 FINANCIAL ADMINISTRATION	\$ 601.00	100 %	%	17 ENVIRONMENTAL CONSERVATION	\$	%	%	%	%
9 TOTAL ACTUAL OPERATING MAINTENANCE EXPEN DITURES	\$ 5408.00			18 PUBLIC SAFETY	\$	%	%	%	%
(N) CERTIFICATION (Please Read Instruction F)				19 RECREATION CULTURE	\$	%	%	%	%
(O) TRUST FUND REPORT				20 OTHER(Specify) Water & Sewer Extention	\$	%	%	%	%
Revenue Sharing Funds Received Thru June 30, 1973	\$ 25,983.00			21 OTHER(Specify) \$ 17,308.00	\$	%	%	%	%
Interest Earned	\$			22 OTHER(Specify)	\$	%	%	%	%
Total Funds Available	\$ 25,983.00			23 TOTAL ACTUAL CAPITAL EXPEN DITURES	\$				
Amount Expended	\$ 22,716.00								
Balance	\$ 3,267.00								

Signature of Chief Executive Officer: *Lewis Tiner*
 LEWIS TINER City Manager
 NAME & TITLE PLEASE PRINT
 Eastland Telegram Thursday, August 16, 1973
 NAME OF NEWSPAPER DATE PUBLISHED

To: The peanut producers of the Southwest,

This is to notify you that we have sold our shelling plant, dryers, etc., to American Cold Storage Corporation of Suffolk, Virginia.

It has been your loyal support which enabled the business to grow through the years. We wish to express to you our sincere appreciation for your patronage from the day our plant opened in 1940 until now.

GORMAN PEANUT COMPANY
 M.E. Shell W.T. Shell

