



These are members of the Choraliers of Texas Woman's University, who will perform at an appreciation day ceremony honoring State Senator Tom Creighton on November 6, at Mineral Wells.

Top Entertainers To Perform At Creighton Event Thursday

MINERAL WELLS--The Choraliers of Texas Women's University will perform at a special appreciation day ceremony honoring State Senator Tom Creighton to be held at 5:30 p.m. on November 6, at the Downing Heliport of Municipal Airport at Mineral Wells.

Members of the Choraliers are a small, highly-select group of singers who perform music from the pops, jazz and musical comedy repertoire. The group has been chosen to make seven USO-Department of Defense

tours throughout the world in its twelve-year history.

Gov. Dolph Briscoe and Lt. Gov. Bill Hobby, along with State Comptroller Bob Bullock and others, will participate in the appreciation day festivities for Sen. Creighton. Some 3,000 people from the 17 counties comprising the 22nd State Senatorial District are expected to be on hand for the event.

Tickets for the event are \$5. Sen. Creighton was born and raised in Palo Pinto County, Texas, and is presently a

practicing attorney in Mineral Wells. After serving in the United States Navy during World War II, he was graduated from the University of Texas Law School in 1950. He is married to the former Sue Sparks of Fort Worth.

He began his political career when he was elected county attorney for Palo Pinto County, a position he held until 1960 when he successfully ran for the office of State Senator. He has established an outstanding record during his 15 years of service in the Legislature. Ranked fourth in seniority, he has served on most of the major committees of the Senate. He is Chairman of the Economic Development Committee, a member of the Natural Resources Committee and Vice Chairman of the Finance Committee. He has served on the Senate-House Conference Committee on Appropriations for the past six sessions.

The North Texas State University 1 O'Clock Lab Band, a dynamic force in the concept of jazz education and jazz performance for almost 30 years, will provide "easy listening music" for the Sen. Tom Creighton Appreciation Day Barbecue Thursday, November 6, at the Mineral Wells Municipal Airport.

The 1 O'Clock Lab Band will play a cross section of Americana, from cowboy tunes to modern jazz, as background music for the barbecue, said Leon Breeden, director of the NTSU Lab Band program. Also on the Lab Band program, which begins at 7 p.m., is a medley of patriotic music and some of the big bands of Glen Miller and Benny Goodman.

Since its inception in 1947, when NTSU became the first school in the nation to offer a bachelor of music degree with a major in dance band, the Lab Band program has been proven training ground for jazz performers and teachers. There are currently nine dance bands in the program, with the 1 O'Clock Lab Band being the most advanced and the most selective.

Former students in the 1 O'Clock Lab Band now play with Sian Kenton, Doc Severinsen, the First Edition, Ray Charles and Tom Jones, among others.

Bike-Hike Set Saturday

One of the main purposes of America is to do their part to improve the community. This Saturday, November 8, the Eastland High School chapter of the FHA will be helping out the Texas Association for Retarded Citizens by sponsoring a Bike Hike. At this time, we have 106 students that will ride a horse, a bike, or walk the 20 mile course. Each person has sponsors that have agreed to give a certain amount for each mile they complete. Junior High and High School students are participating.

Mr. Chris Brooks, Project Coordinator from Brownwood, will attend and kick off the hike.

In Eastland County alone, we have estimated 444 retarded persons. Each one of these people need your help. If you would like to contribute to make someone's life happier, contact Wynell Ensor, head of the project, or any other FHA officer: Jo Allman, Sherry Wheat, Judy Krantz, Julia Minchew, Claudia Bulgerin, Jenni Bradley and Brenda Adams. Sponsors of FHA are Kathy Reece, Mrs. R.P. Haun

EASTLAND TELEGRAM

Eastland, Texas 76448: Today's Center For Tomorrow's Future!

Thursday, November 6, 1975

Volume 46 Number 89

10¢ EACH

Mavericks To Meet Clyde Friday Nite

The Mavericks may be a little down, but don't ever think for a minute that they're out! Sure they've taken beaters the past two weeks, and they're physically bruised, but they're still ready to go again.

And go again they will Friday night when the Eastland SPIRIT moves to Clyde for an 8 p.m. District 2 - AA clash with

the potent Bulldogs.

Injury and illness plague the Mavericks, but Coach Dallas says he still sees that old Drive that makes the Mavericks winners.

THURSDAY ACTION

The Eastland Junior High will host Clyde Seventh and Eighth Grade teams here Thursday, for the last stanzas

of the year for the Dogies. Seventh kickoff will be at 5:30 and the Eighth at 6:45. (Schedule shows the Junior Varsity to be going to Clyde Thursday, but not so; they'll be playing the Mavericks in Clyde Friday night, Coach Dallas says.)

Clyde got beat by Comanche last week, but the Clyde team is

a ball mover with a fine back field with perhaps the No. Two and No. Three Backs in the district in Chipononi and Dunn, Dallas says. "They'll sweep and use power plays," he says, "and they've got a lot of people to call on."

Comanche and Coleman are tied, and Comanche rests this week in preparation for the final in Eastland on the 14th with the Mavericks. Eastland with the right support could easily be a district decider, and a win over Clyde would set the stage, so the Mavericks are ready to put together an upset, the likes of which they're known for.



Jimmy Hendricks presenting a check to Bill Morton, this weeks \$400 Jack pot Winner at Thriftmart.

Constitution Vote Down

"No, No, 21,874 Times No.!" That's how many times Eastland Countians joined their fellow Texans in voting down the proposed Constitution Tuesday.

Actually only 2,964 countians voted, but the ballot offered eight yes and no choices. In all, throughout the county there were 1,578 for votes.

Each of the eight propositions failed in every precinct, by whopping margins in nearly every case.

Guesses are that there are probably 8,000 eligible voters in the county, so less than half turned out to help decide the important question.

Texas vetoed the new document in the big cities and in the small towns. Guesses were that points like Houston and Dallas might go for the change, but returns showed even they voted against by margins of 2 to 1 and 3 to 1.

Vocal i opposing the Constitution change were Gov. Dolph Briscoe, Sen. Tom Creighton and the Eastland County Bar Association.

Turkey Shoot Set Saturday

Eastland Rifle and Pistol Club invites the public to a new range located on the Eastland Airport Property north of town. The club has invested and built an up-to-date modern facility featuring an automatic skeet machine and benches for rifle shooting 100 and 200 yard targets.

The club will be holding a turkey shoot Saturday, November 8, at 10:00 a.m. throughout the day. Frozen turkeys will be given away for winners of various competitive shooting events. So unlimber your "shootin' arms" and come win a turkey for Thanksgiving and tune up for the Deer Season.

FULLEN MOTOR CO.

PUNCH LINE OF THE WEEK

Father: "So you want to become my son-in-law?"
 Daughter's steady: "No, sir, not really. But if I marry your daughter, I don't see how I can avoid it."

November Starts With Wrecks

The first week of November has started out with wrecks in Eastland.

On Monday, November 3, at 8:50 a.m. there was a two-car collision at the corner of Main and Walnut. Damage coming to between \$1,200 and 1,400 was estimated on the 1974 Ford Mustang driven by Barbara Rogers of 305 S. Connellee.

Passengers of both cars were treated at the hospital and released.

Driving the second car, a 1967 Plymouth Fury I, was Dorothy Baker of DeLeon. Damage to her car is between \$700 and \$800. Jerry Rich was the officer on duty.

Tuesday morning at 10:45 at the corner of Commerce and Connellee, an accident occurred and no one was injured. In the 1972 Chrysler was Betty Pack of Rt. 4, Stephenville. Damage to

her car ran about \$700.

Driver of the second car, a 1971 Ford Galaxie, was Opal Sharp of 704 Ave. I, in Cisco. Approximately \$1,000 damages was estimated to her car. Investigating officer was Chief Morren.

Investigating a Wednesday morning accident was Chief Morren. At 8:50 a.m. at the corner of Commerce and Madera, a 1973 Ford Galaxie driven by Willis M. Vaden of Mingus and a 1973 Chevrolet Custom Pickup driven by Mrs. Ellen Justice of Cisco, collided.

Damages to Mr. Willis car are estimated at \$1,500. Mrs. Vaden, passenger, was admitted to the Eastland Memorial Hospital with minor injuries. She is under observation.

Damages to Mrs. Justice's pickup are estimated at \$1,500. She received no injuries.



The scene of an accident that occurred Monday morning at the corner of Main and Walnut. Both cars in the accident were towed away. (Photo by Jim Wortman.)

Services For C.L. Tyrone Thursday At 2

Cornelius L. Tyrone, 85, of Eastland, died at about 8 p.m. Monday in the Veterans Hospital in Big Spring.

Services will be in Arrington Funeral Home Chapel at 2 p.m. Thursday. George Hights will officiate. Burial will be in Eastland Cemetery.

Born May 29, 1890, in Yoakim, he was a retired railroad employee.

He was a World War I veteran. He married Teresa Bryant in March of 1920 in Falls County.

Rites For Mrs. Lassater Held Monday

Mrs. Ather (J.L.) Lassater, 86, of Eastland, died at 8:45 p.m. Saturday at Eastland Memorial Hospital after a long illness. Services were at 2 p.m. Monday at Arrington Funeral Home Chapel.

The Rev. A.J. Thomas, pastor of Mangum Baptist Church, officiated. Burial followed in Simpson Cemetery, east of Eastland.

Born April 3, 1889, in Texas, she lived in Eastland County since 1904. She was a member of the Primitive Baptist Church of Kokomo.

She married J.L. Lassater, and he preceded her in death. Survivors include a sister, Annie Bond of Eastland; two brothers, George Hallmark of Gorman and W.R. Hallmark of Breckenridge; and several nieces and nephews.

Mr. and Mrs. Bobby Walker of Stephenville visited Mr. and Mrs. Dave Fambrough on Thursday.

Tickets On Sale

Tickets are now sale by Eastland Lions for their Annual Pancake Supper to be held Friday, Nov. 14, (night of the Maverick-Comanche) game here.

The traditional feed will be held at Wendell T. Siebert Elementary Cafeteria from 5 to 7:30 p.m. Tickets are \$1.50 for adults and \$1.00 for children.

C.Y.H. To Sponsor Garage & Bake Sale

The Carbon Young Homemakers will sponsor a Community Garage and Bake Sale on November 8, from 9 a.m. until 7 p.m. in the Carbon School Cafeteria. The proceeds of this sale will be donated to the Carbon School System for use in remodeling the present school cafeteria. Items to be included in this sale are: Adult and children's clothing, furniture, household items, appliances, toys, plants, tires, home baked goods.

FREYSCHLAG Insurance

WEATHER REPORT

Clear to Partly Cloudy. High Near Middle 70's.

Grandparents Brag Corner

Jennifer Diane Wages
4 Months Old

Parents:
George and Debbie Wages

Grandparents:
Mr. and Mrs. Bill Anderson
Mr. and Mrs. Morris Wages

TABULATING FORM

PROPOSED CONSTITUTIONAL REVISIONS

VOTING BOX NAME	VOTING BOX NUMBER	SEPARATION No. 1 OF POWERS		JUDICIARY No. 2 PROVISIONS		VOTING No. 3 EXCEPTIONS		EDUCATION No. 4		FINANCE No. 5		LOCAL GOV. No. 6		GENERAL No. 7 PROVISIONS		AMENDMENTS No. 8		TOTAL VOTE
		FOR	AGAINST	FOR	AGAINST	FOR	AGAINST	FOR	AGAINST	FOR	AGAINST	FOR	AGAINST	FOR	AGAINST			
EASTLAND	1	40	702	50	694	41	699	50	692	38	706	45	698	41	701	37	702	762
OLDEN	2	0	72	0	72	3	67	2	69	1	70	2	70	2	70	2	72	74
RANGER	3	21	359	32	350	32	347	33	347	27	353	27	351	20	355	26	353	385
DESARONA	4	1	116	1	115	2	115	2	116	1	115	2	114	2	114	2	114	118
GORMAN	5	12	258	13	256	13	256	15	254	15	254	17	253	16	253	11	256	273
CARBON	6	3	91	3	89	4	90	2	91	3	91	3	89	5	89	5	91	96
RISING STAR	7	6	337	6	337	9	334	9	335	12	332	8	336	8	336	7	337	356
CISCO	8	68	716	66	708	73	704	70	702	64	712	72	704	63	709	71	705	781
LAKE LEON	9	4	59	4	59	4	59	5	58	5	58	4	59	5	58	6	57	63
ABSENTEE	10	3	53	5	50	6	50	3	53	5	51	4	52	3	53	4	52	56
	11	158	2763	180	2730	187	2721	191	2717	171	2742	184	2726	165	2728	171	2737	2968

CLASSIFIED ADS

THE EASTLAND TELEGRAM Thursday, November 6, 1975 629-1707

FOR SALE

FOR SALE--Like new Kodak 500 slide projector in tip top shape, complete with 17 36-slide Air-equip trays. All for \$50.00. Call 629-2413. t-f

FOR SALE--3 bedroom, 2 bath house. Call 629-1811 for appointment. t-f

FOR SALE OR TRADE--for Eastland home, nice 2 bedroom home in Abilene, Texas, 3325 S. 8th St. 672-5436. t-91

FOR SALE--RCA XL100 color TV, remote control. Call 629-2917 or 629-1259. t-f

FOR LEASE--2 bedroom house recently remodeled, fireplace, carpet, carport. Convenient west Cisco location. \$132.50 a month. Mrs. Ward, 629-1769. t-f

FOR SALE--19 1/2 ft. Travel Trailer Fully Self-Contained. Tandem Axle, Roof Top Refrigerated air, Electric Brakes. Towed less than 5,000 miles. 1973 Model. Mfg. by Terry of Waco. See to appreciate at 104 S. Hillcrest St., Eastland, 629-2189 after 4 p.m. t-89

FOR SALE -- NO regret, the best yet, Blue Lustre cleans carpet beautifully. Rent electric shampooer. Coats Furniture. t-90.

FOR SALE -- New Mobile Homes. FHA financing available. VA financing now available. Many models and sizes to choose from. Low down payment. Low monthly payments. Eastland Direct Factory Outlet, Olden, Texas. Office phone 653-2432 or home phone 629-2117. t-f

FOR SALE--1971 Datsun Series 400, low mileage, loaded and air. Call 629-2801. in Eastland. t-f

FOR SALE--Very large originally \$89 gym set. Need of some repair for \$35. Call 629-2413. t-f

FOR SALE -- Grade dairy goats, Nubian and Alpine. Young nannies \$35-\$50. Grown nannies \$40-\$60. Call 442-1370, Cisco, after 5 p.m. t-89

FOR SALE -- Used Norge dryer with instructions book. Needs repairs. \$35 cash. Call 629-2413. t-f

FOR SALE--Oversized - sleeping bags, 84 x 42, 4 lbs., insulated. \$35.00. Orders taken at 515 E. Main. Guaranteed. t-91

MEL'S BARBEQUE PLACE
For Sale or Lease. Will carry note if sold. Contact 647-3576. Personal reason for selling. t-f

FOR SALE--Couch and chair \$125; reclining rocker \$10; 1 coffee table and end table set \$75; 1 coffee and end table set for \$65. Also new Maytag gas dryer \$200. 610 Walnut St., Ranger. Call 647-1155. t-f

FOR SALE--62 Ford. Vinyl top, air, heater, radio. Bargain. 807 Halbryan, Eastland, Texas.

FOR SALE--Long Branch Polled Hereford Farm. Registered Bulls for sale and registered Durox - Bores. 817-249-1776. Will be at farm on weekends.

Factory made 2-horse trailer, covered and in good condition. To trade for peanut hay. 629-1683. t-94

FOR SALE BY ORIGINAL OWNER
Family vehicle extra-ordinary. Economical, comfortable, clean and still in style. 1971 Ambassador Brougham Station Wagon, loaded. Reclining seats, electric rear window, air conditioned. Big, good tires and big engine, vinyl interior with plush carpeting. Pretty blue with wood grain paneling. Has two-way rear door. Burns regular gas. Call 629-2413 to see. t-f

FOR SALE

FOR SALE
Extra fuel tanks complete hook-up 442-2289.

LAKE HOME FOR SALE
2 bedroom, fenced, good waterfront. 629-1803.

for sale--Insulated suite, water repellent. Sizes - small, medium, large, extra large. \$30. Orders taken at 515 E. Main. Guaranteed. t-91

FOR SALE -- Custom firewood. Call 629 - 1371 Monday thru Saturday except Tuesday from 9 to 5. t-94

FOR SALE--Nearly 5 acres unimproved land on Highway 6 at curve in Carbon. \$3,500. Also 3 1/2 acre place across road. 629-2742. t-96

MISC FOR SALE -- DON'T merely brighten your carpets... Blue Lustre them... eliminate rapid resoiling. Rent electric shampooer. Perry Brothers. t-90

FOR SALE--'73 Monte - Carlo, 350, two barrel, all power, factory tape deck and air, low mileage. Call now 629-2975. t-97

Used Sewing Machine. Straight Stitch. \$32.50. We also clean, oil and adjust all makes and models. 629-1604.

FOR SALE OR TRADE--for Eastland home, nice 2 bedroom home in Abilene, Texas, 3325 S. 8th St., 629-5436. t-90

FOR SALE--Firewood. Call 647-1417 after 5 p.m. t-97

FOR SALE--1 Model A Farmall Tractor with cultivator and planter. 1 mole board breaking plow, 1 two disc breaking plow, 1 one way 5 disc breaking plow. Call 639-2425. Carbon, W.E. Walker. t-97

GARAGE SALES

BIG SALE - Nov. 8th - 9:00 till 5:00. What's left of Estate Sale. Many new things added. Furniture, clothes, dishes. Old Avon bottles, books, rugs, antique and 6 room house with 4 lots. 511 Terrell St., Ranger, past red light East on Hwy. 80 read the signs. Bargain prices. t-89

GIGANTIC GARAGE SALE--Antique glassware, and miscellaneous items. Clothes all sizes, electric stove with self cleaning oven, Kenmore washer, bedroom suite and items numerous to list... 408 Crestwood. Eastland. 4:00 Thursday and Friday, all day Saturday. t-89

HUGE YARD SALE - Leftover from moving plus a collection from 3 families. Garden tools, push plow, and misc. items. Fri. and Sat., Nov. 7 and 8, from 8 to 5. t-89

3 FAMILY GARAGE SALE - 314 N. Daugherty. Wed. - Fri. from 9 to 5. Glassware, linens, lots of misc. items. t-89.

GARAGE SALE--1608 W. Plum -mer. Thursday-Saturday. 8 to 5:30. Gas heater, 2 lounge chairs, nice coats, clothes, shoes and misc. t-89

GARAGE SALE--917 W. Main. Thursday, Friday, Saturday, and Sunday. Everything priced to sell. t-89

5 FAMILY GARAGE SALE--Appliances, household items, clothes. Thursday, Friday, Saturday and Sunday. 515 Crestwood. t-89

SALE--106 N. Connellee, Wednesday, Thursday, Friday from 9-5. Dish rags, pin cushions, few dolls, pillow cases, cup towels and many, many hand made items. t-89

WANTED

HELP WANTED--E.L. Graham Memorial Hospital, Cisco, needs, R.N. shift supervisors for day and night shifts parttime. Superior working conditions. Contact Mrs. Cathy. t-82tfc

Connell Welding Service all Types of Farm and Shop Welding. 24 hr. Service. 647-3606. Rt. 1 Box 153

HELP WANTED--Full time employee wanted. Apply in person to Stereo Central or call 442-2745 during the day or at night call 629-2804. t-f

HELP WANTED--Experienced Mobil Home serviceman, material manager and storekeeper wanted. Fuqua Homes, Eastland. 629-1766. t-f

WANTED IN EASTLAND -- either 2 or 3 bedroom older type house. Preferably 3 bedroom. Terms. Write Box 535, Cisco. t-94

WANTED
Want to rent house out of city limits. Call 629-1574. t-91

WANT TO mow lawns, trim trees, do flower bed work. \$1.75 hour. 629-2826. t-92

HELP WANTED--Dairy Queen of Ranger needs mature person to train for shift supervisor. Must be willing to work any shift. Paid vacation, insurance and retirement program. Apply in person or phone 647-3001.

Order your personalized Christmas Cards now. A good selection for your viewing now at Eastland Telegram, south side of square.

HELP WANTED--Experienced secretary. Some shorthand. Need a flexible person who enjoys a variety of duties and meets people well. Start immediately. 629-1769. t-f

WANTED
Carpenter work, building or remodeling. All general carpenter work. Free estimates. Call 629-1654. U.V. Williams.

WANTED--LVN for 3 to 11 shift; better than average working conditions. Salary and other benefits. Apply in person or call Western Manor, Ranger. 647-3111. t-f

WANTED--LVN needed at Northview Center. Good salary and other benefits. 401 W. Moss, Eastland. t-f

WANTED
Light carpentry work. Small remodeling jobs. Call 629-8045. t-98

WANTED--A good baby bed and mattress. Call 758-2551. Desdemona. t-98

NOTICE

Will do sewing of any kind in my home. Phone 647-3048. 214 Cherry. St. in Ranger.

EASTLAND ROTARY CLUB
Mondays--
12 noon
Ramada Inn

NOTICE--For your aluminum storm windows, - screens, doors, window awnings, and carports, call Otis Coleman. 629-1644. t-f

Mercers Appliance Repair. Dishwashers, washers, - dryers, stoves, disposals, and ovens. G.R. Mercer. Olden, Texas. 653-2473

FOR RENT

Want to Sell-Buy-or-Trade? Put an ad in the Classifieds. Call 629-1707.

FOR RENT: Furnished private 3 room cottages with carports. Daily, weekly, or monthly. Pleasant Place Motel, west edge of Eastland. Call 629-887. t-f

FURNISHED OR UNFURNISHED APARTMENTS
RENT #
1, 2 or 3 Bed Apartments
1304 Royal Lane, Ciss
442-3232 t-f 442-2709

FOR RENT - 3 bedroom house with 2 baths. 702 W. Patterson. Check at 700 W. Patterson or call 629 - 2398. t-94

FOR RENT--Attractive 1 and 2 bedroom apartments. Also nice bedroom and bath. All bills paid including cable. Call 629-1731 or 629-2125. t-f

FOR RENT--Mobile Homes and mobile home spaces 653-2220. t-f

FOR RENT--Mobile Home Lot [near schools] Call 629-1188 after 6:00 p.m. t-92

DUPLEX FOR RENT--3 bedroom, 2 bath, fully carpeted, fenced yard, near schools. Business phone 629-1766. t-f

WANT TO BUY or lease, one to one and one-half acres outside city limits with access to highway. Tel. 647-3590 after 10 a.m. t-f

NOTICE

ROOFING
Doyle Squires, Cont., Olden, Texas. 653-2212. Call after 6 p.m.

White and Elna authorized sewing machine dealer. Repair all kinds, by factory trained mechanic. DAVIS FABRICS, 610 W. 2nd, Cisco. p-f

BOWER ELECTRIC
Residential, commercial - and industrial wiring. New or old construction, house power specialists. For 220 volt appliances. Eastland. Call 629-1003. t-f

All Types
Of Sewing
629-1371
From 9:00 a.m. - 5:00 p.m.
Janie Sanders

RESPONSIBLE...
RELIABLE...
READY-TO-GO
AMBULANCE
SERVICE
2504 AUG 71 M.P. 50

Assurance
... It Matters
Depend on us when there's a need for immediate ambulance service. Call us day or night for fast action.
Modest Rates
Arrington Funeral Home
Ph. 629-2611

WATKINS DEALER
Vera Sherrill
406 S. Bassett, Eastland
Leave name and address during day. Phone 629-8019

NOTICE

BUCK KNIVES
FAMOUS FOR HOLDING AN EDGE

Available At
H & R Lumber
715 West Main
629-2104

"We handle anything but litterbugs"
GOODE PEST CONTROL
Phone 629 - 1179 after 3:00
310 N. Ammerman

Roaches, Ants, Termites, Moths, Spiders. ALL GUARANTEED

Do our companies give Bumper Discounts; Driver Training Credit; National Safety Council's Defensive Driving Course Credit; Second Car Credit; Dividends and Easy Payment Plans for all eligible policy holders? You bet! Come see us. Freyschlag Insurance Agency on North Side of Square.

MORE
cars are insured with us than with any other company!
Find out why now!
James O. Wortman
705 W. Main St.
Eastland
Ph. 629 - 1096

STATE FARM
Mutual Automobile Insurance Company
Home Office: Bloomington, Illinois
FAMILY PROTECTOR
Call:
James O. Wortman
705 W. Main St.
Eastland Ph. 629 - 1096
State Farm Life Insurance Company

GREGORY
PLUMBING &
HEATING
629-2753
Res. 639-2340

JORDON WELDING
SERVICE
Shop or Field Welding
Otis R. Jordan, 629-1043,
207 S. College,
Eastland, Texas

MASONIC LODGE NO. 467
Meets second Thursday of each month at 7:30 p.m. in the Masonic Hall. Call Joseph Housson, W.M., at 629-1314 or L.E. Huckabay, Sec'y., at 629-1391 for information.

WIESEN'S MAGNETIC SIGNS
All Types
Tel. 647-1676 or 647-1665 in Ranger

City Cab
629-2812

J&F POODLE GROOMING
14 MILES SOUTH OF CISCO ON HIGHWAY 206.
PHONE 725-6540

Reasonable
SCOTT PAINT AND BODY WORKS
629-2372
300 W. Commerce
Sam Beggs-Owner

NOTICE

LOST - South of town on Hwy. 6 - Michelin 15" truck tire and rim. \$50 reward if returned to City Garage. t-90

Electrical Service Trouble Shooting AC or DC Motor and Generator Controls. Available Evenings and Weekends. 629-1835. t-f

Representative
Needed For
Lancer Mobil Homes & Sectional Homes
Contact
734-2418
Gorman

SENKEL'S CABINET SHOP
303 N. College
Phone 629-1269 after 5:00.
Custom Built Cabinets, Mobile Home Set-up, and Repair, Remodeling and General Carpentry Work.
Richard Senkel
Owner

ACOUSTICAL CEILINGS
Gold or Silver Glitter
[No Charge]
Phone 629-2189
For Free Estimate
Local or Rural

KURLY KORNER
Redkin Products
Call 629-1547.

NOTICE--Furnaces lit and cleaned. Heaters and cook stoves adjusted. Natural gas appliances repaired. Experienced. Reasonable rates. 629-2190. t-94

C.B. RADIOS From \$99.95

Antennas, Etc. In Stock
MONTGOMERY
WARD
Ranger

ALL SIZES
Wash jeans, corduroy and permanent press work - pants, \$2.50 pr. Ladies and girls shoes, choice \$2.00 pr.; 3 prs. for \$5. Ladies nylon horses, 4 prs. for \$1. CISCO ARMY SURPLUS. 1201 Ave. D. 442-3620.

FARM AUCTION SERVICE
Turn your farm equipment to CASH. Bramlett & Nichols Auction Service. Office 965-5154; 965-3480. James Nichols 445-2234

Donnie Bramlett
968-2305

Longer sewing machine Repair Center
Servicing all makes. New and Used for Sale. Complete line of parts. WRIGHT AUCTION COMPANY
106 S. Seaman 629 - 2468

NOTICE--Mattresses. Complete bedding made by Western Mattress Co., San Angelo. Best quality, low price, renovate or exchange new. Every other Wednesday. They're guaranteed. For home appointment call Lois Mezell, 629-2703. leave name. t-f

Complete Car Service...
Bring your car to us for any type of repair. We give you fast, quality service. Stop in.

Reasonable
SCOTT PAINT AND BODY WORKS
629-2372
300 W. Commerce
Sam Beggs-Owner

NOTICE

Representative
Needed For
Lancer Mobil Homes & Sectional Homes.
Contact
734-2418
Gorman

White Pine Electric Co. for all your residential, commercial and industrial - needs. 24 hour emergency service with licensed men on duty. Serving all of Eastland County. We do 220 and 440 Volt Work. Satisfaction Guaranteed. - Denver F. Stagner, Jr., owner 629-2881. t-f

So-Lo
Auto Parts
300 S. Seaman
629-2158
Open Sat. Till 4:00
Doug Lucas Mgr.

QUALITY IS NO ACCIDENT
Custom New Homes
Turn Key Service From Plans To Financing
B.G. BROWN CONST. CO., INC.
820 W. Main, Eastland
629 - 2404
Nights 629 - 8082

A-1 SALES
215 S. Walnut
Eastland, Texas
Phone 629-2102
Dale And Jerry Maston
Qualified And Experienced Carpenters
House Painting - Inside Or Outside
Paneling - Sheetrock - Texturing
Porches - Concrete Or Lumber
Awnings - Car Ports - Patios

We Can Completely Remodel Your Present Home - Or Make Any Type Additions You May Require

We Specialize In Roofing And Siding Offering VINYL - HAILGUARD-AND INSULATED SIDING
We Will Measure Your Home - Explain The Qualities Of Our Different Sidings, And Give You A Free Estimate As To Cost.

We Handle Vinyl Storm Windows And Vinyl Or Aluminum Storm Doors

Mobil Home Leveling And Underpinning
Mobil Home Roof Coatings
Mobil Home Porches - Awnings - Car Ports

Whatever Your Home Repair Needs - From Broken Window Panes To Leveling Or A New Roof - Call Us For

FREE ESTIMATE OF COST

CARD OF THANKS

THANK YOU NOTE

Words cannot fully express our deep appreciation for the loving kindness and sympathy extended to us by our friends at the loss of our loved one. Thank you from the bottom of our hearts for the beautiful flowers, cards, and food you brought to us.

The families of
James Harvey Ross

EASTLAND TELEGRAM
629-1707
110 W. Commerce
Eastland, Texas 76448

H.V. O'BRIEN

PUBLISHER AND EDITOR
Second Class Postage paid at Eastland, Texas, under Act of Congress in March, 1870. Published semi-weekly Thursdays and Sundays.

SUBSCRIPTION RATES: By carrier in city, 20 cents a week or 80 cents a month; one year by mail in county \$7.00; city P.O. boxes \$7.00; one year elsewhere in state \$10.00; out of state \$12.00 per year.

NOTICE: Any erroneous reflection upon the character, standing or reputation of any person, firm or corporation, which may appear in the columns of this newspaper will be gladly corrected upon being brought to the attention of the editor.

"This newspaper will not knowingly accept any advertising for real estate which is in violation of the law. Our readers are informed that all dwellings advertised in this newspaper are available on an "equal opportunity basis." "All real estate advertised in this newspaper is subject to Federal Fair Housing Act of 1968 which makes it illegal to advertise "any preference, limitation, or discrimination based on race, color, religion, sex, or natural origin, or an intention to make any such preference, limitation, or discrimination."

Saturday Bike-Hike Route

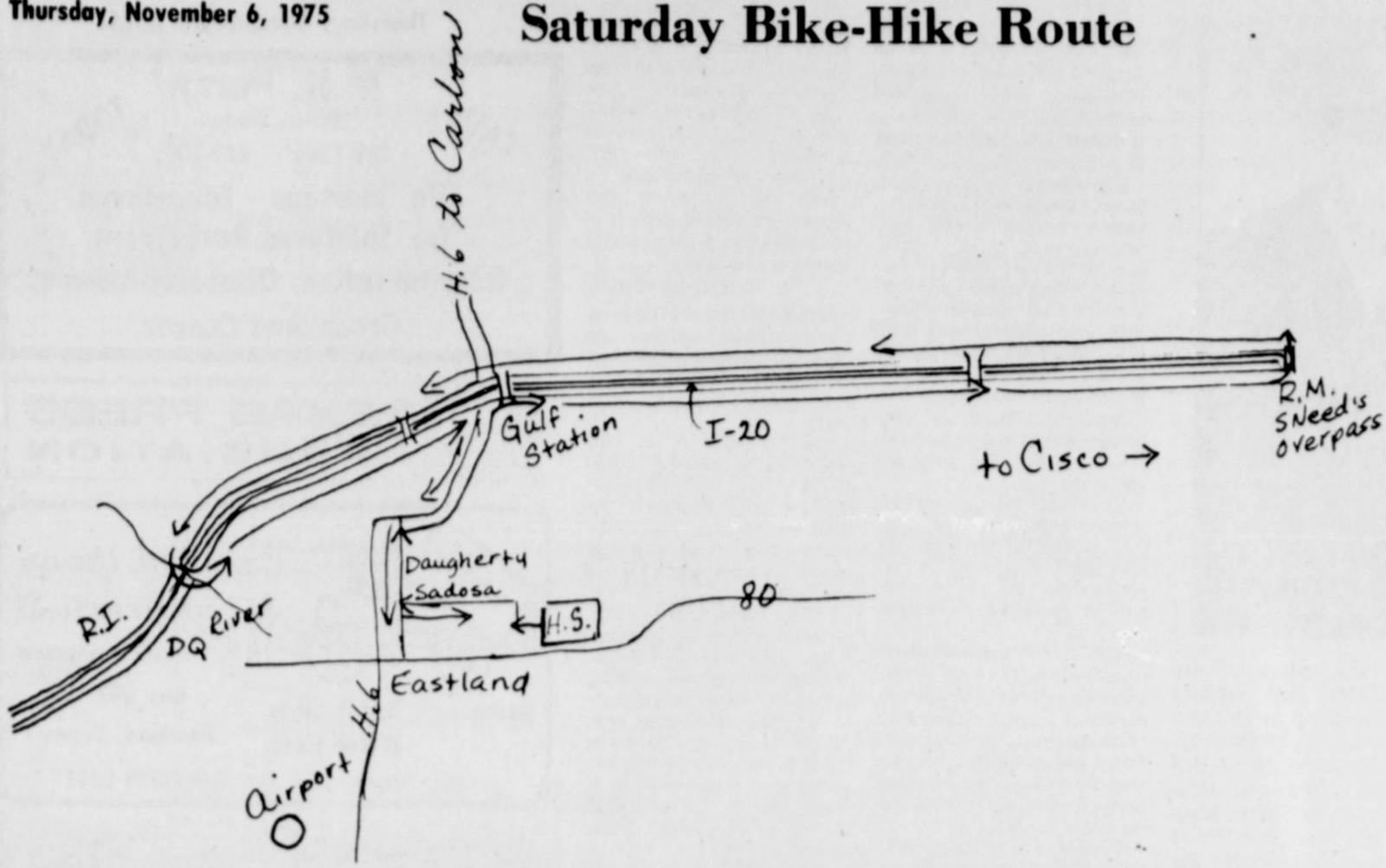

Wednesday's Wreck

(By Jim Wortman)



EHS Band Places 3 In U.I.L.

The Eastland High School Marching Band placed 3rd in the annual University Interscholastic League marching contest in Brady. The band is

directed by Mr. Bobbyingham. The band is made up of 63 students. Melissa Tankersley placed 1st in her twirling solo.

Placing in 2nd Division in both solo and ensemble were: Melody Bond, Gail Swift and Judy Krantz. Yvonne Wilson placed in 3rd Division.

County Tax Revenue \$2,141.16

Comptroller Bob Bullock recently reported that more than \$2.7 million is being sent to 188 counties and 297 cities across Texas as their share of the mixed drinks tax for the July-September quarter of 1975.

The share to cities is 15% of their total tax collected in each city and the 15% to the counties represents tax revenues for drinks sold outside any city's limits. The remaining 70%, \$6.5 million for this quarter, goes to the state general revenue fund.

The tax is 10% on all gross receipts.

This quarter's total local share was up slightly from the second quarter's \$2.5 million paid out, Bullock said. The \$9.2 million total tax receipts for the third quarter represented the 18th consecutive quarter that the total tax receipts increased.

The collection of the tax is administered by the Texas Alcoholic Beverage Commission.

The County Tax Revenue for Eastland County is \$2,141.16 with the County's 15% Remittance being \$321.17. The total city tax revenue for Eastland is \$482.74 with \$72.41 being the city's 15% remittance. Cisco's city tax revenue is \$807.60 with \$121.14 being the city's 15% remittance.

Governor Briscoe Approves Grant

AUSTIN - Governor Dolph Briscoe announced his approval of two grants, totaling \$42,226 to the West Central Texas Council of Government for continuation of regional law enforcement improvement projects.

The money comes from the Criminal Justice Division of the Governor's Office. CJD administers the state's block grant from the Law Enforcement Assistance Administration under the Crime Control Act of 1973.

A \$25,316 grant is for continuation of the WCTCOG law enforcement teletype network, which provides 21 law enforcement agencies with rapid access to computerized criminal information at state and national levels. Increased conviction and clearance rates, and rapid identification of stolen property are anticipated results of the project's continuation.

A second grant, of \$16,910 will continue the WCTCOG law enforcement training academy. Two 240 hour basic training courses, and at least 10 special courses will be offered to law enforcement officers from 19 counties. Texas A&M Police Training Division will instruct the basic courses, while the special courses will be taught by local instructors.

Survey Of Income Tax Bracket

NEW YORK - Because most Eastland County residents are earning more than they did in other years, and because more women are working and bringing home paychecks these days, many local families have moved into higher income brackets.

To the extent that the added cash helps them to cope with the never-ending rise in the cost of living, it is a good thing. To the extent that it puts them into more costly tax brackets, it is bad.

Some local families, whose earnings had previously been below \$8,000, have graduated to the \$10,000 and over level. Their former spots have been taken over, in the progression, by those who had been receiving less than \$8,000.

Just where they stand, currently, is brought out in a copy-righted report issued by Sales Management. It details, for every section of the county, the percentage of families that fall within each income bracket.

In Eastland County, it shows, 41.4% of the local households had disposable incomes in the past year, after payment of their personal taxes, of \$8,000 or more.

Drivers License Office To Be Closed Nov. 11

The Drivers License Office will be closed Tuesday, November 11, in observance of Veterans Day.

The purpose of the survey was to gain a better understanding of each community's purchasing power than was revealed solely through its average income figure.

It shows whether there are a small number of high-income families making up for a large number with small incomes or whether earnings are more equally distributed.

The breakdown figures for Eastland County show that 17.0 percent of the families had after-tax incomes of \$5,000 to

\$8,000 in the past year, that 9.8% were in the \$8,000 to \$10,000 bracket, 18.2% at the \$10,000 to \$15,000 level and that 13.4% had incomes above \$15,000. The remaining families had \$5,000 or less left after taxes.

Because the survey takes into account only cash income, it does not do full justice to farm communities, where income-in-kind and lower living costs are important factors, it is noted.

Although incomes have been on the rise for most Americans, so have living expenses. Nationally, there was a net loss of nearly 5% in buying power last year.

Eastland Pigeon Club To Race Oct. 19

The Eastland Racing Pigeon Club opened its young bird season with its first race from Big Spring, Texas, held October 19, 1975. Lofts from Eastland, Breckenridge, and Abilene were represented in the race.

Floyd Frady of Eastland was first in the A race with 1363.68 yards per minute. Second, Charles Bode of Breckenridge, with 1281.22 yards per minute; third, Thad Kelley of Breckenridge, with 1272.63 yards per minute; fourth, Kenny Kelley of Abilene, with 1228.49 yards per minute; fifth, Ricky Kelley of Abilene, with 1071.16 yards per minute; sixth, Curtis Young of Eastland, with 1070.80 yards per minute and seventh, Kenneth Gregg of Abilene with 984.56 yards per minute.

Ricky Kelley was first in the B race with 1344.82 yards per minute. Kenny Kelley, second,

with 1280.86 ypm; third, Curtis Young with 1214.21 ypm; fourth Charles Bode with 1197.90 ypm; fifth, Thad Kelley, with 1171.39 ypm. Frady and Gregg had no time on the B race.

Members of the newly organized Abilene Club include Kenny Kelley, Ricky Kelley, Kenneth Gregg, Wiley Walker, Hollis Phillips and Bill Wilkerson.

The second race of the season was flown from Big Spring on October 26, 1975. Results showed Thad Kelley first in the A race with 1249.31 ypm; Charles Bode, second with 1246.24 ypm; third, Floyd Frady with 1069.81 ypm; fourth, Kenny Kelley with 1018.70 ypm; fifth, Curtis Young with 888.84 ypm; sixth, Ricky Kelley with 860.70 ypm. No birds were clocked by Gregg, Wilkerson, Walker and Phillips.

Zeta Pi Chapter To Meet

October activities of the Zeta Pi Chapter of Beta Sigma Phi were:

Monday, October 6, the sorority met in the home of Sandi Alsip with the vice president, Mary Beaty presiding.

Several social and service events were discussed and planned, and preparations were made for the reading of a Ritual of Jewels for pledges.

Refreshments were served to Kay Bailey, Mary Beaty, and Pam White by the hostess.

On Wednesday, October 22, the Beta Sigma Phi Ritual of Jewels was held for pledges Mary Beaty and Pam White. The candlelight ceremony was read by president Joan Walker and was held in the community room of the Eastland National Bank.

During the business meeting following, members voted to send a donation to the Beta Sigma Phi State Project--the Jana Tinsley Fund, a Texas sorority sister whose long illness and death resulted in a financial burden on her family.

Members also discussed the State Convention to be held in Houston in June; planned a November social; and selected their 1976 Valentine Sweetheart. Her picture will be sent to the International headquarters for judging and she will be formally revealed to the sorority in February.

In other business, final preparations were made for providing floral arrangements for the Sunday, October 26, services at the First United Methodist Church in honor of their sponsor, Marene Johnson Johnson.

Refreshments were served to Sandi Alsip, Kay Bailey, Sharon Shanafelt, Joan Walker, and Pam White by the hostess, Mary Beaty.

ECAA To Meet

Eastland County Art Association will meet Thursday at 7:00 p.m. at Texas Electric Ready Room. Mrs. Myrtle Wilks, of Cisco, will present the program on getting start in Pastels. Members attending are reminded to bring a recent picture to be judged for the artist of the month award.

CB To Meet

Big Country CB Club met November 3, at TESCO Service Center. There will be a program on Civil Defense next meeting, November 17. All interested persons are invited.

There was a committee appointed on installing signs at various places pertaining to our club.

Our meeting time will remain at 7:30. November 10 there will be a meeting at TESCO Reddy Room for anyone interested in square dancing in learning or organizing a club. If you are interested in any way, be there.

We had a nice turn out and one new member.

H.E. Basham

Bakker
FUNERAL HOME
306 W. PLUMMER • EASTLAND • PH 629-1726

Dear friends,

A man told us of attending the funeral of his friend's father. Later the friend said to him, "It may sound strange to use the word happy, but there really was a kind of happiness in seeing you - nothing to do with being comforted, it was just that I was so glad you were there." He added, "I've been to many funerals, but I never knew until now how important it was to go."

Respectfully,

Oale O. Bakker

More For Less!

Feature for feature - dollar for dollar there is no finer home investment!

TREND-SETTING FEATURES:

- CENTRAL AIR CONDITIONING AND HEATING
- TWO CAR GARAGE
- Separate Utility Room
- Large Covered Overhang
- Drop In Oven and Range
- Hood and Fan in Kitchen
- Custom Styled Vanities
- Silent Light Switches

Eastland's Quality Builders
H & W Development Co.

Complete Building Service One Call Does It All

FHA-VA-CONVENTIONAL Financing Available
216 S. Seaman
629-1702

For Lease

- Approximately 500 Square Feet Of Office Space
- Large Reception Area With Two Small Offices
- Central Heat & Air
- Ground Level On Square.

RCG Leasing Building

101 West Commerce 629-8052 In Eastland

Brownwood Cattle Auction

Special Cow And Bull Sale

Saturday, Nov. 22, 1975

Bulls Sell At 10:30

Featuring All Breeds And All Bulls Will Weigh 1000 To 1500 Pounds And Be Fertility And Bangs Tested.

Cows Sell At 1:00

1000 To 1500 Head - Will Be Bangs Tested And Have Calf At Side Or Will Be Pregnancy Tested.

Brownwood Cattle Auction

2TC

Civic League To Sponsor Pilgrimage

The Cisco Civic League will again present a "Pilgrimage of Homes", to be held Sunday, Nov. 16, from 1 - 5 p.m. Homes to be viewed this year are those of Dr. and Mrs. Ayres Cermin, 1505 Simms; Mr. and Mrs. Richard Ward, 1409 Simms; Mr. and Mrs. Bobby Evans, 6 Country Club Ridge; Lt. Col. and Mrs. Morris White, Northwest of the city; and Mr. and Mrs. Winston Heidenheimer, 1300 Avenue N. Tickets are priced at \$2 for adults, and \$1 for children, and includes the complete tour of homes, and refreshments. Tickets are available now, and may be purchased from Youvonne McMillan at the State Farm Insurance office in Cisco. The first tour sponsored by the Civic League last year was very successful, and helped provide funds for the new swimming pool that was opened this summer. Maps will be available at each of the homes, and tickets may be purchased at the door of any of the homes.

Tony Lowrance Dirt Contractor

Sand & Gravel Hauling - Yard Grading & Leveling - Backhoe Service

Install Concrete Septic Tanks

Call 629-8191

LIVE FOR UNDER \$100.00 A MONTH

WITH FHA LOANS YOU DON'T HAVE TO PAY MORE!

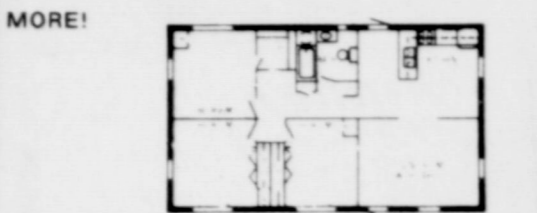

960 Sq. Ft. Lots and lots of living space!

3 Bedrooms Sheetrock Walls



14x65 3 Bedroom Furnished



14x56 2 Bedroom Furnished

Under \$86.00 a month

FHA LOANS FROM TEXAS' LARGEST DEALER

Abilene Mobile Homes

4618 N. 1st 672-6466



A Reception Sunday, Nov. 9, 1975, will mark the golden anniversary of Mr. and Mrs. H.S. (Buck) Weston of Carbon. Time will be 2 until 5 p.m. in their home.

Children of the Westons Mr. and Mrs. Bill (Dorothy) McCrum, DeLeon, Tex.; Mr. and Mrs. Mack Weston, Taylorsville, Calif.; Mr. and Mrs. Jack Weston, Clovis, New Mexico; Mr. and Mrs. Fred (Billie) Lightfoot, DeLeon, Texas will host the reception.

Mr. Weston was born in Kerville April 30, 1903. Mrs. Weston was born in Goldthwaite July 20, 1905.

The Westons met at a camp meeting near Mullin, Tex., in the summer of 1922. They were married Nov. 11, 1925 by the Rev. Victor D. Dow in the Ft. Methodist Church of Mullin.

They have been engaged in ranching all their married life and are semi-retired.

They are active members of the Ft. United Methodist Church of Carbon, Tex.

Their hobbies are gardening, visiting old friends and making new ones.

They have 12 grandchildren and 3 great grandchildren.

Members of the houseparty will be the grandchildren.

All friends and relatives are cordially invited to attend.

HOSPITAL NEWS

Patients in Ranger General Hospital Wednesday, November 5, 1975, were: Robert Crawford, Elsie Boyd, C.M. Swanner, Joe Todd, Grayson Townsend, Cordie Smith, Lawrence Rainey, Cora Moore

Johnny Hayes, Lucy Scott, Clarence Black, Claude Blacklock, R.W. Gordon, Clyde Campbell, Dave Morgan, Emma Hicks, Lula Canet, Oliver Grumbles, Eric Sharp, Manuel Gomez, Nettie Grison, Anna Eaton, Baby Boy Eaton, Letta Mae Willis

Patients in the Eastland Memorial Hospital Wednesday November 5, 1975, were:

Lorena Knipe, Ethel Alldredge, Lewis Starr, Adrian Cushman, Dale James, William Kilgore, Velma Holland, Maggie Christian, Amy Dodson, Belle Jones, Bessie Everton, Mrs. Eddie Tyrone, Bertrice Murphy, Kathryn Simpson, J.B. Downtain, Ben Bassett, Mary McCoy, Vera Pogue, Naomi Kanady, Edith Heck, Virginia Parr, Ruth Carter, Irene Cornelius, Alfonso Gaeta Jr., J.V. Garrett, James E. Wright, Julia Rhyne, Mrs. Eddie Turner, Robert Peasley, Betty Durham, Edith Stuckey, Olga Reich, Ella Garrett, Mary Jo Eaves, Marene Johnson, Juanita Neely, Sharon Rainey, Nona Tinney, Ola Morgan, Fannie James, Virgie Jarrett, Robertva Tuttle, Bart Boles, Keven Coplen, Stella Thurman, Sally Evans, Karen Perkins, Ella Ribble, Paula Ovalle, Petty Harris, Baby Boy Ovalle, Baby Girl Harris

BREAKFAST 6-11 A.M. 7 DAYS A WEEK RANGER DAIRY QUEEN

Police Dispatch 629-1728

4-H Fair To Be Nov. 15

The Eastland County Bicentennial Fair, sponsored by the Happy-Go-Getters 4-H Club, will be held November 15 in Eastland.

Divisions for the fair include baked goods, food preservation, sewing, crafts and hobbies, field crops, and a special bonnet contest for grandmothers' bonnets and new bonnets. Each division except field crops, and bonnets will have four categories: junior youth, 9-13; Senior youth, 14-19; Adult, 19-64; and Senior Citizen, over 65. Crafts and hobbies will have a division for children under nine years of age.

All exhibits must be entered between 9:00 a.m. and 1:00 p.m. on Friday, November 14. The fair will be open to the public from 8:00 a.m. to 5:00 p.m. on Saturday, November 15.

First, second, and third place ribbons will be given along with bicentennial silver dollars, half dollars, and quarters, respectively, as awards. Participation ribbons will be given to all participants and a Best of Show Award will be presented in each class.

Antiques will not be judged, but would be appreciated for display in local merchants; windows the week of the fair. Interesting stories may accompany antiques should be taken to the County Extension Office, Courthouse basement before noon on Monday, November 10.

There will also be a starving artist division in which local artists may display and sell art. No item should be priced over \$25. There will be no charge for displaying items, however ten

ANNOUNCEMENT: Community is invited to hear a guest speaker, Dr. W.R. Downs from LBJ Space Center, Houston, in a program on Space Chemistry and Our Future in the Ranger Junior College Auditorium on Tuesday evening, November 11, 1975 at 7:30 p.m. This program is co-sponsored by Ranger Branch, American Association of University Women, and Ranger J Junior College Chemistry Department. There is no admission charge and the program is open to the public.



Boxoffice Opens 6:30 Show Starts at 7:00

RANGER DRIVE-IN THEATRE

FRIDAY

SATURDAY SUNDAY

EVIL GROWS BEYOND THE DOOR!
Beyond this door the most terrifying event in the history of mankind is about to occur!



BEYOND the DOOR
demonic possession lives, and grows... and grows...and grows...and

JULIET MILLS as Jessica • RICHARD JOHNSON as Dimitri
with ELIZABETH TURNER • DAVID COLIN, Jr. Directed by OLIVER HELLMAN
Screenplay by RICHARD BARRETT color by DELUXE
An Edward L. Montoro Presentation of a Film Ventures International Release

Coming Next
BACK BY POPULAR DEMAND A RE-RELEASE
"BORN LOSERS" A RE-RELEASE THE ORIGINAL SCREEN APPEARANCE OF TOM LAUGHLIN AS BILLY JACK
An American International Release

percent of all sales will go to the Eastland 4-H Club.

An old fashioned box supper will be held at 7:00 p.m. on Saturday after the fair. Everyone is encouraged to attend and participate. Box suppers and baked goods will be auctioned by Mr. James Wright of Eastland.

For further information concerning the fair and a copy of the fair rules, contact the County Extension Office by calling 629-2222 or writing P.O. Box 387, Eastland, Texas 76448.

The Eastland 4-H Club would like to extend a special thanks to the Eastland Chamber of Commerce, the Eastland National Bank, and Victor Cornelius for their help to the 4-Hers in preparing for the fair.

NOTE: The fair will be held at the Cornelius building across from Fullen Motor Company on E. Main unless the building is rented. Please hold publicity on the place until a week or 10 days before to avoid confusion if it is rented in the near future and we have to change plans. If rented, the fair will be held at the Co. Livestock Show Grounds.



Engagement Announced

Mr. and Mrs. Luther F. Loudamy Jr., and Mr. and Mrs. Malcolm Williamson are proud to announce the engagement and approaching marriage of their children, Sherry Elaine and Bobby Dean. The wedding will be held December 14, 1975, at 2:30 p.m. in the First Baptist Church of Ranger.

Miss Loudamy is a 1972 graduate of Ranger High School and attended Ranger Junior College. Mr. Williamson is a 1971 graduate of Eastland High School and attended Howard Payne University. All friends and relatives are invited to attend.

Thursday, November 6, 1975

CALL M.H. Perry TODAY
104 N. Lamar
269-1566 629-1095
Life, Mortgage - Educational - Tax Sheltered Retirement Hospitalization, Disability Income, Group And Cancer

MEMBER TEXAS PRESS ASSOCIATION

Eastland Pump & Construction
H.L. "Hoot" Ferguson
Box 693 Eastland, Texas
817-629-2311
Backhoe Sewer Lines Water Lines Dirt Work

Chili Chili OF TEXAS, INC.
BOB CHELETTE General Manager
ITALIAN NIGHT
Spaghetti, Pizza, Garlic Bread Salad
Wednesday Nights
\$3.10 Drinks Included

Majestic Theatre

Eastland 629-1220

Thurs. Last Day See At 7:30 & 9:30 p.m.

No Passes

A true account of one of the most incredible journeys in American history.
A TRUE STORY
DOTY-DAYTON Presents
Seven Alone
a DOTY-DAYTON release

Starts Fri. See At 7:30 p.m.

Tommy
Roger Daltrey is Tommy

A Columbia Pictures and Robert Stigwood Organisation Presentation
Ann-Margret Oliver Reed Roger Daltrey Elton John
Eric Clapton John Entwistle Keith Moon Paul Nicholas
Jack Nicholson Robert Powell Pete Townshend
Tina Turner and The Who

Friday Late Show 11 p.m.

They gave their all for the team!

Not all the playing was on the football field!
They live their fantasies on & off the field!
The Swinging Cheerleaders



The Speaker Reports

by Bill Clayton
Texas House of Representatives

AUSTIN--When Texans go to the polls Nov. 4 I know they want to know as much about their new constitution as is possible.

Most have had the opportunity by this time to read and hear quite a lot about the proposed charter.

But, I have found many have been given only partial or false information about many areas of the document.

For the last two weeks I have made an effort to answer some of the more serious charges and present both sides of each question.

I would hope the following discussion on those questions will give voters a better perspective when it comes time to ballot.

1. Opponents say granting voting rights to ex-felons in the new constitution is a sign of permissiveness.

A. In reality, it tightens the strings attached to convicted felons being able to vote. The Legislature presently has authority under Article 6, Section 1 of the constitution to set any degree of restrictions it desires, even less stringent than those now imposed.

There is a shift in emphasis in the new constitution. No person convicted of a felony and who is in jail, on parole or on probation can vote. After the debt to society has been completely paid then voting rights are restored, but additional restrictions can be imposed.

The Legislature actually is more restricted in the new constitution in that it cannot allow a convicted felon to vote unless his debt is paid in full.

2. Opponents charge that under the new document the Legislature can abolish the Railroad Commission.

A. Anti-revisionists say this is one of the most 'ridiculous' things about the new constitution. If that's the case then the present constitution is also ridiculous because the commission could be abolished by the Legislature.

Article 16, Section 30 of the present constitution does not present a clear charge for a railroad commission. The present constitution only gives the legislature power to create a commission. It means we could wipe out the commission by passing a law, because what the Legislature has the power to create, it has the power to destroy.

3. Opponents charge local tax equalization boards would be abolished under the new constitution.

A. The only change in the tax equalization board is that the requirement that the county commission serve as a board of equalization would be deleted under the new charter.

The role would remain the same as presently under Article 7206 of the state's statutes. To do away with the

equalization board we would have to repeal the law. It could mean that instead of having an equalization board for every taxing organ in the county, that function could be combined under one local board.

4. Opponents are saying special purpose tax districts would proliferate under the new constitution.

A. The only special districts that will be created will be those the people within boundaries of a potential district want to have created.

While cities might create the districts on their own accord, no taxes could be levied unless the voters specifically approved the tax rate. Any debt that a special district creates must be approved by voters, too, along with the taxes necessary to retire that debt.

5. Opponents are saying a legislative salary commission will mean automatically higher salaries for legislators.

A. A thorough study indicates it would not mean salaries any greater than those the voters themselves want legislators to have.

The nine-member appointed commission would recommend salaries and keep a lid on allowances. Legislators could not approve any salary or allowance above the recommendation of the commission. It could approve a lower figure if it so desired.

Legislators' allowances are currently decided strictly by the legislators. Our new document removes this authority from the Legislature and puts it in the hands of the independent salary commission.

Before any salary or allowance hike could be approved, the members of the Legislature who voted for it will have to face a general election. It means if the salary is at a high level, voters will have the opportunity to

show their disapproval by voting those legislators out of office and sending to Austin replacements committed to a lower salary level.

6. Opponents of the proposed constitution charge the welfare ceiling would be eliminated and seriously affect the state if the new charter is adopted.

A. This is a furor over very little. The present \$80 million "ceiling" applies only to direct assistance grants for needy elderly, blind, disabled and families with dependent children.

Since 1974 the federal government has paid for the three adult categories. The state's only outlay is to assist families with dependent children. That does not begin to approach the ceiling. It is less than half.

In 1969, voters in a constitutional amendment election gave the Legislature authority to change that amendment at any time necessary so no federal funds would be lost. In effect, the ceiling means little.

7. Opponents say the new constitution gives the Legislature more power over our lives and businesses.

A. In the old constitution it specifically delegates law-making authority to the Legislature 330 times. In the new document that authorization is spelled out only 143 times.

The Legislature is going to have considerable power because it is the basic rule-making body in our society. However, there are at least 35 instances where the Legislature has new limitations placed on it that are not in the present constitution.

The new restrictions are imposed here previous experience has indicated that limitations are necessary; and increases authority where experience has shown that flexibility is needed.

8. Opponents are calling the Nov. 4 election an all or nothing election.

A. Voters can vote for or against each proposition on the ballot individually. Voters can pick and choose what they like and discard what they don't.

There are eight propositions on the ballot. All but proposition one

contain only one article each. Any of the eight can pass or fail without consequence to the others.

Find out how each of the propositions will affect you and your community. Then on election day vote your convictions.

CROSSWORD

- ACROSS**
- At the top
 - Barroom
 - Ice cream drink
 - Metallic rocks
 - King, for one
 - Tight
 - Stop
 - Zodiac sign
 - Sale notice
 - Trouble
 - Half ems (abbr.)
 - Telephone operators
 - Cause of joy
 - Othello's adviser (poss.)
 - Distribute
 - Genus of grass
 - Even (poet.)
 - Tantalum (sym.)
 - Realist
 - Box scientifically
 - Mistress (Ger.)
 - Tajons
 - Coin of Iran
 - hoops
 - A. confederate
 - Grows old
- DOWN**
- Into pieces
 - Narrated
 - Poems

ANSWER

1	2	3	4	5	6	7	8
9	10	11	12	13	14	15	16
17	18	19	20	21	22	23	24
25	26	27	28	29	30	31	32
33	34	35	36	37	38	39	40
41	42	43	44	45	46	47	48

Thursday,

November 6, 1975



Blown Acoustic Ceiling
[No Extra Charge For Glitter]
Spray Painting
Sheet Rock Finishing
ADEN ELMORE
629-2525 After 5
Eastland
Free Estimates

Eastland Rifle & Pistol Association
Will Hold A Turkey Shoot
Saturday - 9 A.M.
At The
Eastland Rifle & Pistol Range
North Of Eastland On Hwy. 6.
Starts At 9 A.M.
Skeet Shoot Rifle Shoot
Bow & Arrow For Turkeys

You Are Invited To An
Open House
At The All New
Young Age Shop
We Have A New Look And A New Name
Cactus & Calico
But We Are Still At The Same Place
120-A Main In Ranger
And Have The Same Fine Quality Merchandise

Also
It Is Time For Another
2 for 1 Sale
November 1st Through 15th
(No Layaways and No Charges, Please)
Register For
Gift Certificates
1st Prize - \$25⁰⁰ In Merchandise
2nd Prize - \$15⁰⁰ In Merchandise
3rd Prize - \$10⁰⁰ In Merchandise
The Drawing
Will Be November 15th At 5:00
You Do Not Have To Be
Present To Win.

HEIDENHEIMER'S
Your Family Store In Cisco

HUNTERS OUTER WEAR HQ

FLANNEL SHIRTS
by BIG BEN 100 Percent Cotton, sanforized with two pockets - - machine washable - - **\$4⁹⁵**

INSULATED COVERALLS
Blizzard proof one pc. coveralls in shorts, mediums and talls - - all sizes **\$29⁰⁹**

CPO JACKETS
Made of heavy flannel - - 2 big front pockets with button down flaps on the pockets - - **\$7⁹⁹** each.

MENS HUNTING BOOTS
by Fortone - - neoprene oil resisting soles, cushion insole, full grain leather, moc toe, 8" top and steel shank - - **\$27⁵⁰**

QUILTED VESTS
Walls quilted vests with dupont dacron 88 polyester fiber fill - - designed for cold weather - - **\$12⁹⁹**

THERMAL UNDERWEAR
MENS 2 pc. underwear, warmth without weight, keeps warm in and cold out 2 pc. sets **\$2⁹⁹** each pc.

HOODED SWEAT SHIRTS
Men's laminated thermal hooded jackets that are water repellent with two muff pockets, full zippers **\$8⁹⁵** each.

SHIRT JACKET
Men's LEATHER LOOK jacket that may be cleaned with a damp cloth - - sizes **\$19⁹⁹**
S M L XL - -

HAGGAR SOLID COMFORT
Men who know the value of a comfortable fit, mature fashion and a durable fabric will appreciate these Haggarr® slacks.
A look of soft linen comes in a wide range of solid colors of 100% Encron® polyester doubleknit that's machine washable and dryable.
With Haggarr's Comfort-Plus® styling that includes a straighter leg silhouette with hemmed bottoms.
So who says the cost of looking good is going up?
\$16

HAGGAR slacks
FROM
HEIDENHEIMER'S
OF COURSE

Courthouse NEWS

OCT. 29

NEW CAR REGISTRATIONS

Bobby - Olds - Ranger
Robert E. Day - Merc. - Eastland
Raymond Hart - Buick - Ranger
O. X. Rone - Chvy. - Gorman
BFW Const. Co. - Chev. - Temple
Mary Beth Cunningham - Chev. - Brownwood
Gorman Milling Co. - Ford - Gorman
Hood King Mt. Co. - Ford - Eastland
Richard R. Harrell - Chev. - Cisco
Bill Bralley - courier Pkp. - Canrizo Springs
Helga Tiner - Olds - Eastland
James E. Wright - Courier Pkp. - Eastland
Don Hallmark - Ford - Moran
Charlie Petner - Ford - Moran
Charlie Petree - Ford - Ranger
Bob Sessum - Ford Club Wag. - Mineral Wells
Marsha Wisdom - Ford - Desdemona
W.E. Carlisle - Olds - Harker Heights

MARRIAGE LICENSE

Calvin Henry Ingram and Janice Lee Tennison.
Robert Alton Soules and Jessie Carianne Johnson.
Terry Wayne Myers and Betty Sue Duke

INSTRUMENTS FILED

CO. CLERKS OFFICE
John T. Altringer to H. & L. Royalties - as on Toyalty Interest.
Tommie G. Amis and others to Pete Roberds and wife - Rel. VL and DT
M.L. Agnew and wife to James R. Agnew and others - Warranty Deed
Max Anderson and wife to C. C. Rose - 1st St. Bk. Ranger - MML asgn
Ascot Oil Co. - to Beasley Well Service - MML asgn
James Anderson, Trust test to James C. Anderson Trust test - MD
James Anderson - Test Trust to Jean Anderson Howorth - Test Trust MD

James Anderson - Test Trust to Carol Jane A. Feak - Test Trust - MD
Estell Bolding to Pete Roberds and wife - VL and DT
Thelma Jean Brady, dec'd to the public - certified copy probate
Baylor University to Rhodes Dr. Co. - OGLM
B.G. Brown Const. Co. to Jack Sullivan Brown and wife - Rel. MML
Eleanor Mary Byans and husband to L.U. Maynard and wife - Warranty Deed
B. G. Brown Const. Co. to Walter L. Maynard and wife - Warranty Deed
Robert Butler and others to 1st St. Bk. Ranger - Deed of Trust
Truett Been and wife to C.C. Rutherford - OGL
Jim Berge to Four-Tex Oil Co. - asgn OGL
Alton L. Buchanan, dec'd to the public - proof of heirship will attached
Virgie Minnie C. Carey and others to H.H. Satterwhite - Suit claim deed
Jim Cooper and others to Pete Roberds and wife - Rel. VL and DT
E.A. Connell to Connell Homes Inc. - Warranty deed.
Connell Home Inc. to Eastland Natl. Bk. - Deed of Trust
Cecil Copeland and others to Monte R. Williamson and wife - warranty deed
R. L. Copeland and wife, dec'd to the public - proof of heirship will attached.
E.Q. Connell to B.G. Brown Const. - Warranty deed.
Bill P. Coody to John H. Grew and others OGLM
George O. Carter and wife to Olney Sav. Assn. - Warranty Deed
Estate of E.D. Dillingham, dec'd to the public - certified copy probate
Ruby Nell Been Dairs and husband to C.C. Rutherford - OGL
A.D. Dunlap and wife, dec'd to the public - proof of heirship Margie Hill Earp to Pete Roberds - Rel. VL and DT
Eastland Natl. Bk. to Paul L. Norris and wife - Rel. deed of trust.
Eastland Natl. Bk. to Tri-Mark Dev., Inc. - Rel. Deed of trust.
Martha S. Earkens to James Kenneth Grice and wife -

warranty deed.
City of Eastland to Clarence Penn and wife - Cemetery deed
City of Eastland to Edison Landry and others - cemetery deed
Eastland Drilling Co. to the public - assumed name
First Natl. Bk. Cisco to Roy G. Edwards - Rel. Deed of Trust.
1st Natl. Bk. of New Jersey to Jack Muirhead, Jr. - Rel. Deed of trust.
1st St. Bk. Ranger to E.A. Connell and others - Par. Rel. Deed of trust.
W.E. Fussell and others to Rhodes Dr. Co. - MD
Four-Tex Oil Co. to Walter B. Hailey Jr. and wife asgn. OGL
Harry F. Finks, Sr. to Jack B. Benefield - OGLM
1st Natl. Bk. Cisco to Jim L. Webb - Rel. DT and VL
E.E. Files and others to Norman Park and others - Warranty Deed
Martha Graves to Gerald Winnett - Rel. Deed of trust
Eula Hill HGass to Pete Roberds and wife - Rel. VL and DT

91st DIST COURT

Maxine Evelyn Porter VS. Clyde William Porter - Divorce
Dorothy Jean Hunt VS. Jo Bailey Hunt - Divorce.
Mark Andrew Fox VS. Vicki Lee Fox - Divorce
George R. Brooks VS. Jimmy Annie Bernice Brooks - Divorce
Anita Alexander Cotton VS. Jimmy Alexander - Reciprocal Child Support
Karen Ann Carlton VS. Royce Darrel Carlton - Divorce
E.E. Ford, dba - Ranger Hill Serv. Sta. VS. L.W. Henson - Suit on check.

The following proceedings were had in the Court of Civil Appeals, Eleventh Supreme Judicial District of Texas:

AFFIRMED

Joe Ed Glover v. Bill Elliston dba Elliston-Archer Funeral Home (Opinion by Judge McClell) - Baylor
Sid Burton et al v. W.L. Farreil et al (Opinion Per Curiam) - Comanche
Sydell Berman et al v. City Products Corporation (Opinion by Judge Brown)-Nolan

MOTIONS SUBMITTED

Teddy Charles Herron v. City of Abilene et al. Appellant's motion for rehearing--Taylor
A.F. Conner and Sons, Inc. v. Tri-County Water Supply Corporation. Appellee's motion for



WASHINGTON

"As it looks from here"

OMAR BURLESON

Congressman
17th District

WASHINGTON, D.C. - WISHPUL TTHINKING SELDOM PAYS off but there are indications that political and economic conservatism is manifesting itself across the Country to a greater degree than has been the case in recent years.
AT THE MOMENT IT IS WIDENING THE BREACHES IN both political parties. In the months ahead this division may become more evident and highly visible.
NATIONALLY, MOST LIBERALS CONTINUE to talk in favor of big government, bigger spending, with no turning back. But some liberal Governors and Mayors are seemingly beginning to respond to public sentiment against massive bureaucracy, uncontrolled deficit spending, and government intervention.
ONE EXAMPLE RECENTLY SURFACED WAS A STATEMENT of the Governor of Wisconsin, a liberal in an historically liberal area. He said, "We are beginning to recognize that there are limits

extension of time to file briefs--Taylor.
MOTION GRANTED
A.F. Conner and Sons, Inc. v. Tri-County Water Supply Corporation. Appellee's motion for extension of time to file briefs.
MOTION OVERRULED
Teddy Charles Herron v. City of Abilene et al. Appellant's motion for rehearing--Taylor

The following proceedings were had in the Court of Civil Appeals, Eleventh Supreme Judicial District of Texas, October 31, 1975:

MOTIONS SUBMITTED

Joe Ned Lewis v. Republic National Bank of Dallas. Appellee's motion for rehearing--Dallas.

Eppler, Guerin, and Turner, Inc. et al v. Glenn Hawkins. Appellants' motion for rehearing--Taylor
MOTIONS OVERRULED
Joe Ned Lewis v. Republic National Bank of Dallas. Appellee's motion for rehearing--Dallas.

Eppler, Guerin, and Turner, Inc. et al v. Glenn Hawkins. Appellants' motion for rehearing--Taylor.
CASES SUBMITTED
Darrell Lynn Edmonds v. State of Texas--Taylor.
Pearson-Sibert Oil Co. of Texas v. O.L. (Jack) Burney-Scurry.
Inez Williams, Executrix v. W.M. Little--Comanche.
Cecil Brownlee et al v. Higginbotham Bros. and Company.--Eastland.

AS MENTIONED IN THIS SPACE LAST WEEK, THE PRESIDENT has thrown out a challenge which this Congress cannot ignore. The procedures for reaching the goal of reducing taxes and cutting Federal spending by an equal amount, are admittedly a problem but a lot of people want it done. Maybe the Congress is getting the message. Reduction in expenditures should come first and then a tax cut but this is not the specific point here. The point here is - have we reached the time when people are ready to choose between more government spending and high taxes or less spending and lower taxes? The issue might even more dramatized by the question as to whether we want independence - freedom - the right to choose - or a paternalistic government heading to a socialistic system.

IF THIS FORMER PROPOSITION DEVELOPS across the Country there may well be a clear issue in the elections next year - the competition could be over which candidate and which party can best be trusted to carry out such a policy.

Records Necessary

Many people are not aware of when they should file for social security benefits and what they should bring with them, according to Glyn Hammons, Social Security District Manager in Abilene.
Persons who wish to file for retirement benefits should file their claim three months before the month they want their first check to start. They should also bring with them the following things: their social security card, a record of last year's earnings, and a record of their age or date of birth.
For those who do not have a birth certificate, some records to consider are the old family Bible, a census record, school records, voter's record, marriage record or a child's birth certificate.
Hammons further stated that, "A record of last year's earnings is needed in many cases due to the length of time it takes to get earnings credited to a person's record. A self-employed person should bring a copy of last year's tax return; a wage earner should bring last year's Form W - 2. In addition, if a person filing has any unmarried children under age 18, between 18 and 22 attending school, or disabled, he should furnish the children's birth certificates.
Hammons stressed that early filing can save time and assure the individual of a better chance of getting that first check on time.
The Abilene office is located in 142 S. Pioneer; office hours are 9 a.m. to 5 p.m., Monday through Friday. If you do not live in Abilene, check at your local post office for a schedule of social security visits by a representative of the nearest social security office.



AUSTIN - Railroad Commissioner Ben Ramsey's decision to step down at the end of his present term Jan. 1, 1977, assured a wide open race for his position next year.
A large field already is forming.
Ramsey, 71, took many by surprise with the announcement he plans to return to law practice in San Augustine in a little more than a year.
His public service career dates back to 1931 when he first entered the House of Representatives. He served six terms as lieutenant-governor--longer than any Texan.
State Rep. David Finney of Fort Worth, Houston attorney Terence O'Rourke and Walter Wendlandt, an Austin attorney and former Commission division head, are announced candidates.
Secretary of State Mark White Jr. said last week he is seriously considering getting in the race. White is an appointee of Gov. Dolph Briscoe, and speculation favored him to replace Ramsey if the incumbent stepped down before end of his term.
Other possible contenders for the Commission--which regulates Texas oil and transportation industries--are Texas Legislative Council Executive Director Robert E. Johnson and State Rep. Lane Denton of Waco.

million for the last quarter, remains with the state general revenue fund.
COURTS SPEAK
The State Supreme Court upheld a Texas Alcoholic Beverage Commission ruling that a dry justice precinct remains dry even when the county around it votes wet.
In other recent opinions, the High Court declared:

- The son of a slain father must divide benefits with an "adopted son" who was never legally adopted.
- A \$43,400 judgment for the state in an air pollution case against a roofer must be erased and a new trial held.
- Killeen's moving, zoning and licensing ordinances are legal.

AG OPINIONS
A county judge is authorized by statute to reject competitive bids on county goods or supplies below \$3,000. Atty. Gen. John Hill stated.
In other recent opinions, Hill concluded:
•The Governor's desk calendar is not public information. Neither are notes on his appointments, but his flight log is.
•County law library fee may be taxed as costs in all probate proceedings except an action brought for the purpose of confining a person of unsound mind or a habitual drunkard.
•A small city can't pay a deputy sheriff to serve as town marshal.
•Harris County constables elected immediately following a redistricting of precincts in 1973 must stand for election in 1976 under the state constitution.

Lawyer Policies Due
State Insurance Board members are considering a new type of policy covering attorney's fees.
The State Bar and agents' representatives requested approval of a plan authorized by the 1975 Legislature. The Board must approve guidelines.
The Bar is prepared to distribute group policies through a non-profit corporation, a staff member stated. Insurance Company of North America and American National Insurance Company have applied to the Board for authority to sell the coverage. Fees are expected to run \$5 to \$7.50 per month for such coverage as wells, deeds, advice, defense against traffic charges and domestic cases.

Minority Gains Few
A state legislator claims state agencies have made no progress at finding jobs for blacks, Mexican-Americans and women.
Rep. Paul Ragsdale of Dallas said the number of black employees in 38 agencies increased only four-tenths of one per cent in the last year, the number of Mexican-American workers 1.1 per cent, and the number of women 3.7 per cent.

Tax Distributed
More than \$2.7 million is being remitted to 188 counties and 297 cities as their share of mixed drink taxes for July-September.
Cities get 15 per cent of the total tax collected in their boundaries, and counties 15 per cent. The remaining 70 per cent, \$6.5

Briscoe cited a 1975 law which required that such projects have approval of the Coordinating Board, Texas College and University System.
Attorneys for Jessen said court guidance is necessary to settle the issues for state officials and governing boards of all state universities.
Debate Rages On
Voter interest in the great debate over a new state constitution doesn't match that of ardent proponents and opponents.
Checks with key election officials over the state indicate a low turnout in the November 4 constitutional revision election, unless there is a dramatic pickup in citizens' concern during the last week of the blistering campaign.
Oil Allowable Set
For the 44th month, the Texas Railroad Commission set the oil allowable for November at a wide-open 100 per cent.
Production is running an average of 113,047 barrels daily less than in 1974. Imports averaged nearly 4.6 million barrels a day, during a recent four week period, which amounts to an increase of 824,000 barrels from early this year.
As a waste control measure, allowable for the East Texas field was limited to 86 per cent production.
Beach Force Named
Atty. Gen. John Hill appointed a "Beach Task Force" of five assistants to work with coastal county officials to assure open, clean and safe beaches.
Hill said his office is making a detailed survey of environmental protection needs on the Texas coast.
The five assistant attorneys general will be assigned to Jefferson and Chambers counties; Galveston county; Brazoria and Matagorda counties; Calhoun, Aransas, San Patricio and Nueces counties, and Willacy, Cameron, Kleberg and Kennedy counties. Attorneys from the Environmental Protection Division staff in Austin, Houston, San Antonio and McAllen will also be involved.
Session Feared
House Speaker Bill Clayton said banning school fees may cause a special legislative session.
Clayton referred to a recent attorney general's opinion that schools cannot require students to pay fees for driver education, workbooks, lab materials, band uniforms and other items unless the legislature authorizes the charges.
"This will put some of our school districts in a financial bind, and we may need a special session to help them out," the speaker said. "But I hope they can make it until 1977."
Clayton emphasized he is not "beating the drums for a special session."
Courts Speak
Only landowners who show 51 per cent of their income comes from farming or ranching are entitled to a constitutional agricultural tax exemption, the Supreme Court held.
Court of Criminal Appeals overruled a district court's order setting bail at \$75,000 for an Odessa man accused of killing his ex-wife.
The Supreme Court upheld a damage award to a Houston man who had money taken from his account by a bank to cover a loss from a forger's having signed his name on the back of a check.
The High Court affirmed a \$205,095 medical malpractice award to a Jasper man. In another malpractice suit, the Court upheld lower court rulings which rejected a charity patient's suit against three Houston doctors.
An Austin widow's suit claiming her husband's fatal heart attack was the result of shock from losing his city job was rejected by the Supreme Court, denying the workman's compensation benefits.
AG OPINIONS
Where a Teacher Retirement System member is murdered by his beneficiary, no benefits should be made until a constructive trust has been imposed by court order, Attorney General Hill held.

New Management!!

Shults Implement Company Of Rising Star, Texas

Wishes To Announce The Sale Of All Parts, Fixtures And Shop Equipment To Bramlett Implement Company Of Stephenville, Texas Who Will Operate The Implement Dealership Of John Deere, Lilliston And Other Lines As Before, And Who Will Look Forward To Doing Business With You.

All Accounts And Contracts Will Go On As Before And Bills May Continue To Be Paid At The Store Office To The Bookkeeper.

Shults Implement Thanks You For Your Past Favors And Business.

Bramlett Implement Company Welcomes Your Continued Patronage And Looks Forward To A Long And Pleasant Business Relationship.

JOB PRINTING

IDEAS-ART-

Reflect The Image You Want

We know how to make your mailers, brochures, letterheads look like you. Consult our expert designers.

See Your Local Newspaper

Oil News

S.B. Steed, operating from Cross Plains, will drill No. 1 J.W. Gage in the regular field five miles north of Rising Star. The planned 1,700 foot venture is located on a 160 acre lease.

Full Gospel

Fellowship To Meet Saturday

This month's meeting of the Full Gospel Business Men's Fellowship Meeting will be at 7:30 p.m. Saturday, November 8, at the Women's Club Building on Plummer Street.

We have two speakers this month. The first is Steve Henton, a pastor of the First Christian Church (Disciples of Christ) in Paducah, Texas. He graduated from T.C.U. with a B.A. and from Brite Divinity with an M. of Divinity.

Steve, 28 years old, relates how he wrestled with the intellectual dilemma and the Christian faith, nearly deciding to go into teaching philosophy. It was at that time that God intervened, filling him with his Holy Spirit, and confirming his calling with a flow of miracles in his ministry.

He ministers to the Paducah area with a weekly 30 minute TV program.

The second guest speaker is S. Clay Henton, from Arlington, Washington. He will briefly share his testimony. He is a born again Christian, and filled with the Holy Spirit for 45 years. He went around the world in 1968 witnessing for Jesus, with 18 others of the F.G.B.M.F.I.

Come and bring a friend.

It spots 1,180 feet from the south and 1,460 feet from the west lines of Section 36, Lavaca CSL Survey.

Medders Oil Co., Wichita Falls, No. 1 City of Gordon is a planned 4,200 foot wildcat for the area 2 1/2 miles north of Gordon.

Location is on a 475 acre lease, spotting 1,980 feet from the north and west lines Lot 22, Block 1, Burleson CSL Survey.

J.T. Williams Petroleum Corp. of Longview will drill No. 1 McClelland in the Lee Ray (Conglomerate) Field 10 miles northwest of Cisco in Eastland County.

The planned 4,000 foot venture is located on a 160 acre lease.

It spots 1,980 feet from the north and 3,475 feet from the west lines of Section 466, Sp. Survey, A-792.

West Artesia Transmission Co. of San Antonio will drill No. 1 Lowell D. Fambro as a proposed 4,000 foot wildcat in Stephens County.

Location is 16 miles northwest of Ranger on a 170 acre lease.

Drill site is 1,644 feet from the south and 840 feet from the west lines of Section 37, Block 6, T&P Survey, A-341.

L and I Producing Co. of Wichita Falls will drill No. 1-A G.R. Langford, et al, in the regular field 14 miles northwest of Ranger.

The planned 4,000 foot venture is located on a 160 acre lease. It spots 330 feet from the north and west lines of the northeast quarter of Section 63, Block 6, T&P Survey.

Hunters Warned Of Rattlesnakes County Pigeon Club Races

SAN ANTONIO--A veteran reptile authority here suggests that hunters and others who frequent the outdoors learn to avoid rattlesnakes by knowing their habits.

Joseph Laszlo, head of the San Antonio Zoo's reptile garden, says rattlesnakes have set patterns of activity, which can be anticipated, depending on the weather, time of day and season of the year.

He points out rattlesnakes take to cover during extreme hot and cold weather, but can be expected to be on the move at any time of the day or night when the surface temperature ranges between 70 and 88 degrees.

Laszlo cautions laymen to be especially alert in the early evening when the sun goes down, the rattlesnake's favorite time to search for food.

He warns that even when not moving rattlesnakes still may be encountered, particularly in dry country, lurking under cactus, Mesquite bush or tree, in high weeds or grass, behind a fallen log, in a roadside ditch, fence line, hedgerow or on a rocky ledge.

"Hikers and others who find it necessary to walk in these places should wear stout leather boots, knee-high leggings or snake-proof pants, and should never sit or climb without first checking the area carefully", Laszlo suggests.

He recommends that hunters use a flashlight in going to and from their deer stands in the early morning before daylight and in the evening after dark.

He also notes that where rats, mice and rabbits are plentiful, it is almost certain rattlesnakes will be in abundance, too.

Despite every precaution, a number of unwary laymen become snakebite victims every year. Fortunately, a San Antonio physician and surgeon has pioneered a new technique for first aid in the field, using crushed ice over the wound in place of the more painful "cut and suck" ordeal.

The ice cools the venom, without freezing the injured member, and slows down the poison until the victim can be brought to a proper medical facility.

The new first aid measure, which has been popularized by San Antonio's Emergency Medical Services technicians, has led to the introduction of a new first aid kit, named "Snake-bite Freeze", which contains chemical ice packs for use where ice is not always readily available.

The kit, which can be stored in hunting vehicles and camps, now is available at pharmacies, sporting goods stores, farm and ranch outlets or from Amerex Laboratories, 307 Nakoma, San Antonio, Texas, 78216.

Thoughts

From The Living Bible

"(Inside the Tabernacle), make a veil from blue, purple, and scarlet cloth, the fine-twined linen, with cherubim embroidered into the cloth. Hang this upon four acacia pillars overlaid with gold, with four golden hooks. The pillars are to rest in four silver bases. Hang the curtain from the hooks. Behind this curtain place the Ark containing the stone tablets engraved with God's laws. The curtain will separate the Holy Place and the Most Holy Place. Now install the mercy place—the golden lid of the Ark—in the Most Holy Place.

Exodus 26:31-34
Religious Heritage of America



In the B race Thad Kelley was first with 1348.92 ypm; Charles Bode, second with 1342.92 ypm; third, Floyd Frady with 1289.03 ypm; fourth, Kenny Kelley with 1248.11 ypm; fifth, Ricky Kelley with 1081.11 ypm; sixth, Curtis Young with 984.27 ypm.

Midland was the release point for the third race of the season, held November 2, 1975. Results in the A race put Floyd Frady first with 869.57 ypm. Second was Ricky Kelley with 865.62 ypm; third, Curtis Young with 795.04 yards per minute; fourth, Charles Bode with 783.40 ypm; fifth, Thad Kelley with 717.29 ypm and sixth was Kenny Kelley with 708.94 yards per minute.

Kenny Kelley was first in the B race with 1002.85 yards per

minute. Ricky Kelley was second with 987.91 ypm; third, Charles Bode with 876.38 ypm; fourth, Floyd Frady with 804.67 ypm; fifth, Thad Kelley with 731.93 ypm; sixth, Curtis Young with 723.97 ypm; and seventh, Kenneth Gregg with 720.31 ypm.

The next scheduled race for the club will be November 9, 1975 from Monohans, Texas.



R.C.G. Leasing, Inc.

104 W. Commerce - On The Square
Eastland, Texas 629-8052

Hospital Equipment & Sickroom
Supplies Sales & Rentals To
Care For Your Patient At Home

Hospital Bed & Rails
Wheel Chairs
Walkers
Bedside Commodes
Crutches

Inhalation Therapy Equipment
Wheelchair Cushions
Skin Care Pads
Under Pads

Medicare & Medicaid Approved

AMERICA'S BEST HOUSING BUY



Delivered And Set Up
On Your Lot. 60 x 24 Feet
Double Wide Home Only
3-Bedrooms
1 3/4 Baths
Living Room
Dining Room
Full Den
Plush Furniture
Monthly After Small Down Payment
FOR SALE ONE USED 14 x 70 MOBIL HOME
Eastland
DIRECT FACTORY OUTLET
1-20 Olden, Texas Phone 653-2432 Or 629-2119

CITIZENS REALTY

820 W. Main
Eastland
629-1769 or 629-2404
WE SELL FARMS - NOT JUST LIST THEM

8 acres - Near eastland, Nice two bedroom home, new carpet, City water.
40 ACRES - Edge of CILSCO - Pecan trees - coastal - water permit to irrigate. Excellent terms.
42 ACRES - Edge of CILSCO - Nice home - coastal fruit trees - pecan trees - City Water. Also has water wells, good spring fed tank.
49 ACRES - EASTLAND - Nice home, 175 pecan trees, cattle pens, good grass, close in.
134 ACRES - ERATH COUNTY - 54 ac pasture - 50 acres irrigated coastal - 30 acres irrigated cropland - Owner Financing.
143 ACRES - RANGER - excellent soil - three irrigation wells, lovegrass, coastal bermuda, 52 acre field. Very good terms.
48 ACRES - Gustine, COMANCHE COUNTY - Like new 14 x 70 mobile home - Good water well - improved grasses - out-buildings.
175 ACRES - EASTLAND COUNTY - Lots of Deer. 75 acres cultivation - peanut allotment. Good irrigation water in area.
487 ACRES - Lake Leon - good soil - cattle pens, like new fences, comfortable two bedroom home, City water, Good Terms.
640 ACRES - REAGAN COUNTY - All pastureland - Good investment property - Sandy Type Soil. ONLY \$106. per acre, \$6,580 down, stop by and see our pictures on this one.
184 ACRES - COMANCHE COUNTY, near Rucker. Spacious four bedroom home - plenty of water, six irrigation wells, 67 acre peanut allotment, Owner Financing.
123 ACRES - COMANCHE COUNTY - between DeLeon and Comanche, all in coastal, tanks, excellent fences.

RAY MOODY - ASSOCIATE
1-725-7279
Wayne Durham - ASSOCIATE
629-2743
B.G. BROWN - BROKER
629-8082

Peanut Marketing Seminar Dec. 16

ARLINGTON - The second annual Southwest Peanut Marketing Seminar for the Texas - Oklahoma peanut industry will be held Dec. 16 and 17 at the Inn of Six Flags here. Speakers from all over the country will discuss peanut market development and promotion.

The seminar will kick off with a reception at 6 p.m. the first day and will be followed by dinner, points out Dr. Russell McDonald, economist in marketing for the Texas Agricultural Extension Service. Joe Genske, manager of the Almond Control Board in Sacramento, Calif., will speak on "How Almonds are Marketed and Promoted."

The second day of the seminar begins with a buffet breakfast at 7 a.m. and introductory talks by Ross Wilson, chairman of the Southwest Peanut Research and Education Advisory Committee, and Ben Baisdon, director of the Marketing Division, Texas Department of Agriculture.

Morning speakers will update seminar participants on new product uses and promotion. Dr. Carl Cater, in charge of oilseed products research at Texas A&M University, and Paul Walter, regional manager with Associated Milk Producers, Inc., will speak on new product uses.

Peanut promotion will be discussed by Rudy Carlson of Smith - Bucklin Associates, Chicago, while James Lankford of the Foreign Agricultural Service, U.S. Department of Agriculture, and John Currier, president of the National Peanut Council, will speak on export market development.

The afternoon speakers will direct their remarks to domestic market development. Speakers include Jack Bauer, director of purchasing, Curtis Candy Co., Chicago; Bill Ritchie, president, All American Nut Co., Inc., Cerritos, Calif.; Dr. John Maselli, president Oz Food Corporation, Chicago; and Baisdon.

Safe-Dependable-Insured
Vernon's Mobile Home Towing
Local or Long Distance
F.V. Hayden
108 East Maple
817-559-3584
Breckenridge

Would Like To Announce Our New Location
211 South Rusk Ranger, Texas,
November 8, 1975
Our Usual Time 9:30 a.m., Close 5:30 p.m.
We Will Be Closed Friday November 7
Because We Will Be Moving.
Would Love To Have You Come By
And See Our New Store
Hope To See You Soon!
Sharon West Faye Wilson Mabel Stephens
Janet's
Tops And Bottoms
Ladies Sportwear
Phone 647-3515

Auction Sale

SATURDAY NOV. 8 - 1975 AT 10:00 A. M.
303 West 10th - Cisco, Texas

Household Furnishings of Mr. & Mrs. R. W. Roberts Will Be Sold At Public Auction.
ITEMS TO BE AUCTIONED WILL INCLUDE: -
Side By Side Refrigerator
Gas Range
Two Bedroom Suites
Dearborn Heater
Two Electric Fans
Rocking Chair
Couch
Lamps
Pictures
Recliner
Magazine Rack
Small Desk
Dinette Suite
Portable Sewing Machine
Tables
Electric Heater
Electric Clocks
Kerosene Lamps
Electric Blankets
Pole Lamp
Card Table
TV Set
Kitchen Appliances
Dishes
Mattresses and Box Springs
Bathroom Heater
Yard Tools
Three Burner Gas Range
Lawn Mower
Silverware
Pots and Pans

Plus Many Other Related Items
WRIGHT AUCTION CO.
JAMES T. WRIGHT, LICENSED AUCTIONEER
BUSINESS PHONE 817/629-2448 - RESIDENCE PHONE 817/629-1074
106 SOUTH SEAMAN STREET - EASTLAND, TEXAS 76448

Thursday,
November 6, 1975
Fall Greetings
2 New Luxurious Air Conditioned Homes
THE ULTIMATE IN NURSING HOMES
And Extended Care Facilities
Mr. & Mrs. Morris Shook-Coordinators
Private & Semi-Private Rooms
Full Time Social Activities Program
"We Invite Your Inspection"
24 HOUR NURSING SERVICE
Chapel
Lounge
Telephones
Beauty Shop
Cable TV
Barber Shop
Luxurious Dining & Recreation Room
Organ, Piano & Game Tables
EASTLAND MANOR
629-2686
1425 W. COMMERCE
VALLEY VIEW LODGE
629-1779
706 S. OSTRUM

CITIZENS REALTY
820 WEST MAIN STREET
EASTLAND COUNTY'S
VOLUME
RESIDENTIAL DEALER
629-2404

TOAST YOUR TOES around an open hearth fireplace in the twenty - six long living - den of the handsome three bedroom home soon to come into existence in WEST CISCO. Nothing down for Veterans so call today, get in on the ground floor, watch it going up, pick your own decor, begin NOW to build your dream house. FHA financing available.

WE'RE EXPECTING offers galore on this home and two acres north of EASTLAND. Wake up to a soft breeze and the nostalgic sounds of country living. Two extra large bedrooms, fully paneled, formal living room with an exquisite sunken den, including a beautiful log burning fireplace, city water, plenty room for pets and animals.

IT'S A NO NO, no painting, no fixing, just move right in, this large three bedroom home in RANGER is neat as a pin. Completely remodeled, paneling and carpet throughout, large utility room.

SCORPIO, October 23 to November 21, you're a tough one. You're shrewd, critical, suspicious and fond of luxuries, but you also love a bargain. All you want are the facts, and there they are, three bedrooms, two baths, large paneled den, carpet, central heat and air, Total Electric, the kitchen has all built - ins, nice lot in EASTLAND, with back entry drive.

NOT VANILLA, want a modern home in RANGER??? This one is not like all the rest. Owner transferred asking low equity and assume his loan. NO RED TAPE, just begin packing and move into this nice three bedroom, 1 1/2 bath home with central heat and air, won't last long.

RETIRING or ASPIRING, consider additional income with four rental units in CISCO. Ample storage for maintenance equipment, ten pecan trees, storm shelter, trailer hook - up. East Cisco, Good Financing, Good Investment.

LONG WINTER evenings will be a pleasure in this cozy den, adjoining kitchen. This lovely Total Electric brick home in CISCO has three bedrooms, hollywood bath, two car garage. Small equity required, assume existing loan, no credit check.

RELAXED COUNTRY LIVING, a short distance north of EASTLAND, two acres with a quaint, comfortable home, beside a small pecan orchard. Enough room to include animals and plan for a garden as well. Country quiet living, yet close in. Call today.

CAN YOU HANDLE THE CHALLENGE of a dream come true? The desire you have for your family to have a home that feels like home, a neighborhood they can call theirs!! New construction on a site superb of all RANGER. On a hill top, with exquisite view. Three large bedrooms coinciding with an ultra modern hollywood bath. Carpet, central heat and air, two car garage. FHA Financing available.

This is the space we're reserving for YOU, list your home with CITIZENS REALTY.....a "houseSold" name.

EXCELLENT commercial property in CISCO, high traffic flow, solid investment, no delay, owner financed. Call for details. SUPER LAKE VIEW from this comfortable three bedroom home on LAKE LEON, 1/2 acre, wide water frontage, city water, dock on lake, fenced yard.

LIKE HORSES?? You will have a beautiful place to ride and keep your own horses with this lovely two bedroom home just touching EASTLAND city limits. Freshly remodeled, it has an impressive double log burning fireplace to shut out the cold winter's night. Total Electric and on city water. This is excellent income property also, with 175 pecan trees and a small orchard, steel cattle pens, good grass, even a storm cellar. Call today for an appointment.

THE BEST THANKSGIVING YET, entertain your family and friends in this lovely Lake Cisco property. Mother can cook with ease in the spacious kitchen, water front lot with covered boat dock. Front and back yard completely curbed and fenced, three bedrooms and two baths, utility room.

FOR SALE OR LEASE in CISCO, recently remodeled, two bedroom home. Formal living room and dining room, new kitchen cabinets, utility hook ups. Wiggle your toes in luxurious shag carpet. Large shade trees, nice yard, carport, \$132.50 per month.

629-1769
B.G. BROWN - BROKER
629-8082
KARLA BROWN - BROKER
629-8082
Richard E. Ward - Associate
442-3524
Beth Ward - Associate
442-3524
CALL US - WE CARE
Doris Norton - Associate
653-2283

Carbon News

By Mrs. Bob Hastings 639-2517

We awoke to a gentle pattering on the roof Sunday morning. A nice rain fell here Saturday night and Sunday. On Monday the sun shined out and the world looks bright again.

The menu for Carbon School Cafeteria is as follows for the week November 11-14:

No school Monday due to teacher's workshop.

Tuesday: Johnny Knows It, peas, carrots, cornbread, butter, apple crisp, milk.

Wednesday: Turkey and dressing, green beans, cranberry sauce, fruit salad, hot rolls, butter, milk.

Thursday: Vegetable soup, sandwiches, crackers, cornbread, milk.

Friday: Hamburgers, lettuce, tomatoes, onions, pickles, french fries, peaches, milk.

Please note: The city commissioners request tax payers to mail payment of city taxes to City of Carbon, P.O. Box 633, Carbon, Texas, 76435. Mrs. Sandlin, City Secretary, says she will be at the local fire hall November 12, from 9 a.m. to 4 p.m. for those who wish to pay their taxes in person.

Major and Mrs. Mike Whitehorn and family of Colorado Springs, Colorado, visited their grandmother, Mrs. Ruth Craighead last Wednesday.

Mr. Bob Wright has been at the bedside of his sister, Mrs. Sybil Carlson of Denver, Colorado, who has been very ill. Mrs. Carlson passed away Wednesday night. Funeral was on Saturday in Denver.

Miss Esther McAlister of Sedona, Arizona, visited Mrs. Inus Stubblefield last week.

Mrs. Callic Vaughn spent

part of last week with her brother and family, Mr. and Mrs. Joe B. Martin. Also a niece and family, Mr. and Mrs. Spike Lewis of Uvalde.

Weekend visitors of Mrs. Ruth Guy were Mr. and Mrs. Lesley Tonn of Ropesville, Mr. and Mrs. Joe Bethany and family of Dallas, Mr. and Mrs. Jerry Buske and family of Abilene.

Mr. and Mrs. Lonnie McCurry of Houston spent the weekend with her parents Mr. and Mrs. Henry Hines.

Mr. and Mrs. Mack Stubblefield visited Mr. and Mrs. Doug Bryant and children of Amarillo last week.

Mrs. Dessie McCullough of Fort Worth visited Mrs. Opal Hays during the weekend.

Visiting Mr. and Mrs. I.O. Ross last week and attending the funeral of James Ross on Wednesday were Mr. and Mrs. Henry King and son Arnold Joe King of Houston, Mr. and Mrs. Edd Ross of Kellogg, Idaho; Mr. and Mrs. Bill Lewis, Mr. and Mrs. D.L. Lewis of Anthony; Mr. and Mrs. Ord King, Mrs. Bud King of Athena, Oregon.

Mr. and Mrs. Ralph Grun of Houston visited Rev. and Mrs. Delbert Smith and Mrs. Bob Hastings Saturday.

BREAD OF LIFE

My soul, wait thou only upon God. Psalm 62:5

Thou art our Counsellor, Our Pattern and our Guide, And Thou our Shepherd art; Ah! keep us near Thy side.



In The Kitchen

BY DINAH WILSON

One of the most important parts of an organized kitchen is your food inventory. You know how aggravating it is to begin preparation of a meal and at the last minute discover that you don't have a particular item to complete your meal. You might as well count on a delay of at least half an hour while running to the store to pick up what you need. You also might as well count on spending at least \$5, because who can go to the store for less than \$5 these days?

In an effort to become more organized, we must first think about the best arrangement for our cupboards. In your mind, set a plan for arranging your food supply where it will be most convenient for you to find and use. You should place your most used items in the most convenient spots, and the least used items out of your way.

Provide a special place to store every item in your cabinets. Have your canned goods arranged in order of variety, i.e. peas, beans, fruits, soups, sauces, etc. When you do this, you can tell at a glance if there is something needed.

You not only store food in your cabinets, you also store food in your freezer and refrigerator.

Letters TO THE EDITOR

Dear Editor:

Who says nobody cares any more? Our local editor H.V. O'Brien cared enough to state publicly that he was against the proposed new constitution.

Jay Staggs at radio station KERC cared enough to urge people to vote and gave voting locations over and over.

District Attorney Emory Walton and Attorney Mike Siebert cared enough to seek out crowds and travel at their own expense to speak on the evils of the new Constitution.

To each of you, a big "thank you" from a grateful voter.

Mmes. Iris Reed, Lucille Furr and Ada Wright visited Mrs. Vina Marsh of Cisco last Thursday.

You need to keep these storage areas clean and organized too. Again, just a glance will tell you when your cold food supply is diminishing.

Keep a pad and pen handy at all times. When you notice an item needs to be replenished, jot it down. When you keep an accurate account of your food inventory, you will soon find that your short trips to the store will soon become a thing of the past.

Your kitchen is just like a business. You must maintain an inventory, replenish your supplies, and manage it carefully, if you want to show a profit. Your profit will not only be in the dollars you save by careful planning, but also the ease with which your business operates.

UNTIL NEXT TIME

Wynelle Catlin To Autograph "Old Wattles"



Wynelle Catlin will autograph copies of "OLD WATTLES" in Sanders Book Store, Westgate Mall, Abilene, Saturday, Nov. 15, 2:30 to 4:30 p.m.

Wynelle Catlin of Jacksboro, author of Old Wattles, released by Doubleday September 5, was born July 29, 1930, in Jermyn, Jack County, daughter of

George and Dovie Powell Smith. She was one of seven children.

She lived on Jack County farms except for short periods of time. Mrs. Catlin graduated from Jacksboro High School in 1947. She married L.E. Catlin Jr., who has worked in various oil field activities over much of the southwest. They have four children and one grandchild.

For 10 years she worked for Jack County Herald. She was director of the day care center for seven years.

Mrs. Catlin began free lancing five years ago, using colorful area history. Sales include: The Cattleman, This Is West Texas, Today's Family, Great West, Texas Farmer-Stockman, Texas Co-Op Power, The West, Frontier West, Old West, Golden West, Horseman.

Juvenile short stories were sold to: Junior News, Friend, Story Friends, Roadrunner, Kindergarten, Explore, Grit, Discovery, Listen, Misc. to Today's Christian Mother, and Family Digest.

OLD WATTLES is a children's book portraying Texas

farm life at the turn of the century. Characters and plot are fictional but setting is grandmother's log cabin home still standing in Jack County. Story is based on way of life during mother's childhood.

The plot revolves around Eleanore, a little girl who has to follow a contrary old turkey hen, Old Wattles, to find the nest and get the eggs.

Second printing was neces-

sary third week after release.

Agent is marketing other books with area historical settings. The author is now writing a book using the oil boom days of Ranger as background.

The Catlins lived in Cisco in the late 50's, where her husband was employed by Johnson Testers. He has also worked as driller on rigs in much of the area.

She had a Brownie Scout troop while in Cisco.

NOW OPEN

Williamson Automotive

215 S. Seaman 629-2012

In The McCathren Motor Co. Building

Williamson Automotive Will Feature Repair Work On All Vehicles Of Any Kind. As Well As Providing Warranty Repair For All Chrysler Products.

1 Month Only
Tune Up Special
6 Cyl - \$22.50
8 Cyl - \$26.95

Southern Television Systems Inc

CHURCH SERVICES

<p>CHURCH OF GOD Main & Connellee Rev. Ronald Bear</p> <p>Sunday School 9:45 a.m.; Morning Worship 11:00 a.m.; Evening Worship 7:00 p.m.; Wednesday Night Service, 7:30 p.m.; Ladies Prayer Meeting 8:15 a.m. Thursday.</p> <p>CALVARY BAPTIST Rev. L.C. Williams</p> <p>Sunday School 10:00 a.m.; Morning Worship 10:45 a.m.; Training Union 6:30 p.m.; Evening Worship 7:00 p.m.; Wednesday night Service 7:30 p.m.</p> <p>FIRST BAPTIST CHURCH N. Seaman St. Rev. J.L. Norris</p> <p>Sunday School 9:30 a.m.; Morning Worship 11:00 a.m.; Baptist Training Union 6:00 p.m.; Evening Worship 7:00 p.m.; Wednesday Night Service 7:00 p.m.</p> <p>HARMONY BAPTIST CHURCH Rudy Fambrough, Minister</p> <p>Sunday School 9:45 a.m.; Morning Worship 11:00 a.m.; Evening Worship 7:00 p.m.; Wednesday Night Service 7:00 p.m.</p> <p>FIRST PRESBYTERIAN CHURCH Rev. Robert W. Marsh</p> <p>Sunday School 10:00 a.m.; Morning Worship 11:00 a.m.</p> <p>FIRST CHRISTIAN DISCIPLES OF CHRIST Steven Church</p> <p>Sunday School 9:30 a.m.; Morning Worship 10:55 a.m.; Evening Worship 6:00 p.m.</p> <p>FIRST CHURCH OF GOD 212 W. Valley Sam R. Wilson, Pastor</p> <p>Sunday School, 9:30 a.m.; Morning Worship, 10:45 a.m.; Evening Worship, 7:30 p.m.; Midweek Service, 7:30 p.m.</p> <p>ASSEMBLY OF GOD 1608 W. Commerce G.L. Huffman, Pastor</p> <p>Sunday Morning Worship, 10:00 a.m.; Sunday Night Service, 6:00 p.m.; Wednesday Night Service, 7:30 p.m.; Friday Night C.A. Service, 7:30 p.m.</p> <p>ST. FRANCIS CATHOLIC Priest John Mitchell</p> <p>Liturgy Saturdays at 6:30 p.m.</p> <p>CHURCH OF CHRIST Audy Moore, Minister</p> <p>Sunday School, 9:30 a.m.; Morning Worship, 10:20 a.m.; Evening Worship, 6:00 p.m.; Wednesday Worship, 7:00 p.m.</p> <p>EASTLAND CHRISTIAN SCIENCE SOCIETY Corner of Plummer and Lamar</p> <p>Sunday Morning Services, 11:00 a.m.; Services on first Wednesday of month 7:30 p.m. All are welcome.</p> <p>FIRST UNITED METHODIST CHURCH (Rev. Ben Marney)</p> <p>Sunday School 9:45 a.m.; Morning Worship 11:00 a.m.; Evening Worship 6:00 p.m.; Youth Meeting 7:00 p.m. Sunday: Cora Davis Prayer Group 9:30 a.m. Wednesday, Choir Practice Wednesday 7:30 p.m.</p> <p>UNITED PENTECOSTAL CHURCH Rev. E.D. Norman</p> <p>Sunday School 9:45 a.m.; Morning Worship 11:00 a.m.; Evening Worship 7:30 p.m.</p>	<p>NORTH OSTMOR ST. CHURCH OF CHRIST H.S. Lewis Norman Carlisle</p> <p>Worship 10:30 a.m.; Evening Worship 5:00 p.m.; Wednesday Evening Service 6:00 p.m. Daily Pray Service Monday thru Friday, 6:00 p.m.</p> <p>FIRST BAPTIST Rev. Haston Brewer</p> <p>Sunday School 9:45 a.m.; Morning Worship 11:00 a.m.; Training Union 6:15 p.m.; Evening Worship 7:30 p.m.</p> <p>SOUTHSIDE PENTECOSTAL 107 New Street. A.J. Woodard</p> <p>Sunday School 9:45 a.m.; Sunday Evening Service, 7:30 p.m.; Midweek Service, 7:30 p.m. Thursday</p> <p>BETHEL BAPTIST Rev. Paul Edwards, Pastor</p> <p>Sunday School 9:45 a.m.; Morning Worship 11:00 a.m.; Evening Training Union 6:00 p.m.; Evening Worship 7:00 p.m.</p> <p>FULL GOSPEL CHURCH Claude Harris, Pastor</p> <p>Sunday Morning Worship, 10:30; Sunday Evening Worship 7:00; Wednesday Evening - Worship 7:00. All denominations welcome to study and worship with us.</p> <p>OLDEN CHURCHES</p> <p>BAPTIST CHURCH Rev. Howard Meeker</p> <p>Sunday School 10:00 a.m.; Morning Worship 11:00 a.m.; Evening Prayer Service 7:00 p.m.; Wednesday Night Service 7:00 p.m.</p> <p>OLDEN CHURCH OF CHRIST Damon Smith</p> <p>Bible Class, 10:00 a.m.; Morning Worship 11:00 a.m.; Evening Worship, 6:00 p.m.</p> <p>FLATWOOD CHURCH OF CHRIST Wilkie E. Moore</p> <p>Sunday School 9:45 a.m.; Morning Worship 10:30 a.m.; Evening Worship 6:00 p.m.; Wednesday Evening 7:00 p.m.</p> <p>CARBON CHURCHES</p> <p>CARBON FIRST BAPTIST Rev. Delbert Smith, Pastor</p> <p>Sunday School 10:00 a.m.; Morning Worship, 11:00 a.m.; Training Union, 6:00 p.m.; Evening Worship, 7:00 p.m.; Wednesday Night Service, 8:00 p.m.</p> <p>CHURCH OF CHRIST Jack Landrum</p> <p>Sunday School 10:00 a.m.; Morning Worship 10:50 a.m.; Evening Worship 6:00 p.m.; Wednesday Night Worship 7:30 p.m.</p> <p>FIRST UNITED METHODIST Rev. C.C. Shultz</p> <p>Sunday School 10:30 a.m.; Morning Worship 9:30 a.m.</p> <p>MANGUM BAPTIST CHURCH Rev. A.J. Thomas</p> <p>Sunday School 10:00 a.m.; Morning Worship 11:00 a.m.; Training Union 6:00 p.m.; Evening Worship 7:00 p.m.; Wed. Evening Worship 7:00 p.m.</p> <p>FULL GOSPEL CHURCH (Charismatic) Claude Harris, Pastor</p> <p>Sunday School (from nursery through adults) 10:00 a.m.; Sunday Morning Worship 10:50 a.m.; Evening Services for young people 7:00 p.m.; Regular Sunday Evening Worship 6:00 p.m.; Wednesday Worship 7:00 p.m. Everyone is welcome to attend.</p>
--	--

Purse Pleasers

Hollands Drive In

Quality, Quantity, Quickness

And Reasonable Prices

Highway 80 West Of Eastland

Phone In Orders 629-2215 Member TRA

MONUMENTS

CISCO MONUMENT WORKS

LOYAL & DORIS LUNDSTROM - Owner

CURBING LAST DATES

442-9995

708 E B CISCO TEX

Kincaid's Real Estate Corner

377 acres in north part of County. \$300 per acre.

36 acres near Olden, will G.I. \$15,000.

215 acres Eastland County. \$350 per acre.

16 acres, good sand, near Cross Plains, 1/2 minerals, 1 well, good fences, set up for hog farm. \$16,000.

12 acres near Cross Plains, good sand, close in \$12,000.

12 acres Coastal with 4 wells and irrigation equipment, deep sandy loam soil. Will sell Texas Veteran. Near Anson.

550 acre ranch with 112 acres cultivation. Old house, corrals, barns, 5 tanks, 1 well, part minerals. \$150,000. Some terms.

160 acre peanut farm completely equipped. 70 acres peanut allotment, Gorman area. \$600 per acre

130 acres Ranger area, old improvements, some Coastal. Terms. \$350 per acre.

107 acres, 8 miles northeast of Rising Star, sandy land, 2 tanks, 1 well, 85 percent minerals. \$350 per acre

41 acres, 4 bedroom, 4 bath house, barns, 100 pecan trees, good bottom land, with water from Palo Pinto Creek for irrigation. Strawn.

135 acres with 46 acres peanut allotment, peach trees, 4 wells, \$350 per acre.

640 acre ranch, excellent hunting, live creek. \$275 per acre

1100 acre well improved ranch. House, corrals, \$325 per acre.

480 acres, Eastland County. 2 bedroom house, irrigation.

LAKE PROPERTY

Large two bedroom cabin, south side Lake Leon, fireplace, paneling, fruit trees, city water available.

16 acres Possum Kingdom Lodge, with 6 large sleeping cabins, large recreation building, water storage tanks, etc., for sale or trade. Terms available.

24 acres at Lake Leon. Staff community, approx. 1500 ft. of water front. \$24,000

Large 4 bedroom, 1 1/2 bath house on South side Lake Leon. One acre plus. \$14,000

HOMES

Two bedroom frame house. Eastland, nice corner lot, fenced back yard, \$11,750, assumable loan.

Three bedroom frame home completely remodeled, den, utility room, dining room, 2100 sq. ft. double garage with storage, nice trees, extra lots for garden, rent house and mobil home rental space in Cisco.

One bedroom house in Eastland, 3 lots, nice trees, \$6,500.

Three bedroom house in Gorman, terms considered, \$11,500. Large lot in Gorman near school. \$600.

We have motels, commercial property, large farms and ranches up to 150,000 acres in Texas and adjoining states, please contact for details.

ROBERT M. KINCAID REAL ESTATE

100 South Seaman Eastland, Texas

Robert M. Kincaid 629-1781 Night Phone 629-2815

Happy Birthday

To The Best Mother

In The World

Carolyn
Janie

Donna
Bill

Central Drug

North Side Of Square

PRESCRIPTIONS

Filled Promptly And Accurately

JUST CALL

For All Your Drug Needs

WE DELIVER

WHEN YOU CHOOSE DEARBORN IT'S FOR A LONG, LONG TIME

Plan on Lots of Warm Winters With the Unvented Deluxe

Chases chills from hard to heat spots and fills a room with delightful warmth in almost no time. Features the Forward Heat Flow that keeps the cold from settling along your floors. Often copied, but never matched in efficiency and durability, the Deluxe has a cool-to-touch cabinet for extra safety, a lifetime burner—and is Dearborn crafted for dependable, long life. Natural or LP gas. Sizes 12,000 to 39,950 BTUs.

The most respected name in gas area heating

Dearborn
STOVE COMPANY - DALLAS, TEXAS
A Division of Adison Products Company

Western Auto

201 S. Lamar-269-2011 Eastland

J.L. (Luce) Pittman Owner

M. L. TERRELL REAL ESTATE

FARM BUREAU BLDG. — HIGHWAY 80 EAST

PHONE 629-1725 NIGHTS 629-2443

HOUSES

3 bedroom, 2 bath, central air and heat, built - in oven range, and dishwasher, new carpet and drapes. Extra nice. 150' x 150' corner lot, \$29,500.

2 bedroom home, nice yard, with good repair. Located on North Daugherty Street.

3 bedroom, 1 bath, carpeted with central heat. Good location. Shown by appointment only.

3 bedroom, 2 bath home with fireplace, could be arranged for a duplex.

Lake Lot and one room cabin at Lake Leon \$5,250.00

1 acre with a 3 bedroom, 2 bath home in Olden.

8 city lots suited for trailer park. \$6,500

6 city lots in Ranger, well located

Store building, station, living quarters, fixtures and stock at Morton Valley, \$8,000

Duplex on South Walnut, shown by appointment only. \$6,850.

SMALL ACREAGE

5 acres, 3 bedroom, fireplace, den and 2 bath home, northwest of Cisco. \$25,000

8 acres on Interstate, Ranger. Good location.

2 tracts on Interstate 20 near Cisco, will G.I.

1 acre with 2 bedroom, paneled, house. Has a two car garage, storage, workshop, 2 water wells and city water in Olden.

26 acres near Eastland with city water \$12,600

Small tracts of land near Lake Leon.

11 acres with 2 bedroom, rock home, extra nice, good barns, city water, on pavement, north of Eastland.

FARMS AND RANCHES

695 acres in Eastland County with some river bottom, \$315 per acre.

306 acres near Eastland on Leon River with 106 acres coastal bermuda and remaining improved grasses, ample irrigation. Water and equipment for all of tract. 7 stock tanks, pecan trees, good fences, metal corrals and a 40' x 72' all steel barn, also other out buildings.

328 acres in Stephens County. \$262.50 per acre.

2375 acre ranch in Shackelford County, \$367.50 per acre, with annual oil and gas income of \$35,000 to \$40,000 per year. Exclusive listing.

320 acres with all improved grasses, good fences, 1/2 minerals, \$350 per acre with good terms.

160 acres with a 3 bedroom home, fireplace, 2 good tanks, natural gas, on pavement, city water with some love grass.

163 acres, 3 bedroom home, all coastal, good fences, and barns. Located in the Carbon area. \$475 per acre.

668 acres some improved grasses with a 2 bedroom house, good barns, good well water, located in Stephens County.

210 acres north of Eastland, 60 acres of cultivation, on pavement, good fences, city water, \$300 per acre. \$12,000 down, owner will finance at 7 1/2 percent.

160 acres southeast of Ranger. Deer and 1/2 minerals. \$300 per acre.

198 acres with 3 bedroom home on pavement with city water, 70 acres of cultivation, near Lake Leon.

245 acres, 7 miles southeast of Eastland with city water, 1/2 minerals, \$325 per acre.

224 acres improved grasses with good fences and good set of pens. \$10,000 down, owner will finance. \$315 per acre. Location near Carbon.

215 acres near Olden with good fences and good stock tanks.

491 acres in Eastland County with nice brick home, some coastal, fenced and cross fenced. Approximately 1/2 the minerals. Shown by appointment only.

320 acres near Carbon, 60 acres of coastal, fair fences, 1/2 minerals. \$315 per acre.

486 acres near Lake Leon with 2 bedroom rock home, irrigation, and good fences, on pavement.

544 acres with coastal and other improved grasses, good terms, some minerals.

815 acres south of Cross Plains with deer and turkey. Approximately 1/2 minerals.

1450 acres near Albany with approx. \$500 a month oil income, on pavement, \$210 per acre.

1297 acres in Eastland County with some cultivation and improved grasses, good place.

150 acres north of Eastland on pavement with 77 acres of cultivation, and city water. \$400 per acre.

138 acres, 11 acres peanut allotment, 5 miles west of Rising Star. \$235 per acre.

80 acres southwest of Cisco with 2 bedroom home, \$29,400.

120 acres on Sabanna River, pecan trees, deer and turkey, 1/2 minerals. Good terms.

74 acres north of Eastland with city water on pavement \$400 per acre.

140 acres close to Eastland with 2 bedroom home, good barns, good fences, \$450 per acre.

74 acres with cultivation on County Road North of Eastland with city water on pavement \$400 per acre.

143 acres northwest of Ranger, with 52 acres of peanuts, \$375 per acre.

150 acres south of Eastland, 140 acres in coastal, good fences on County Road with city water. \$425 per acre.

WE HAVE OTHER TRACTS

LARGE AND SMALL,

AND ALL LISTINGS WILL BE APPRECIATED.

OFFICE PHONE 629-1725

FARM BUREAU BLDG.

HIWAY 80 EAST

EASTLAND, TEXAS

RODGER TERRELL
Home Phone 629-2896

M.L. TERRELL
Home Phone 629-2443
Eastland, Texas

**R.M. Sneed,
Contractor**

Hwy. 80 East - 629-1756

**Arrington
Funeral Home**

301 S. Lamar - 629-2611



Eastland 1975 Football Schedule

Date	Opponent	Score	7th	8th	B team
Sept. 5	Dublin at Eastland	0-18			
Sept. 12	Ranger at Eastland	20-35			
Sept. 19	DeLeon at DeLeon	38-6			7:00
Sept. 26	Albany at Albany	27-14			
Oct. 3	Open				
Oct. 10	+ Coleman at Coleman	33-7			
Oct. 17	+ Hamilton at Eastland	7-18			
Oct. 24	+ Cisco at Cisco	54-7			
Oct. 31	+ Breckenridge at Eastland	52-7			
Nov. 7	+ Clyde at Clyde				
Nov. 14	+ Comanche at Eastland				
Sept. 11	Clyde at Clyde		5:30	6:45	7:00
Sept. 18	DeLeon at Eastland		5:30	6:30	7:45
Sept. 25	Albany at Eastland		5:00	6:00	7:30
Oct. 2	Blanket at Blanket		open	open	7:30
Oct. 9	Cisco at Cisco		5:00	6:00	7:30
Oct. 16	Breck at Eastland		5:00	6:00	
	Breck. at Breck.				5:30
Oct. 23	Cisco at Eastland		4:30	5:30	7:30
Oct. 30	Cisco at Cisco		5:00	6:00	7:30
Nov. 6	Clyde at Eastland		5:30	6:45	7:00
	Clyde at Clyde				7:00

all varsity games 8 o'clock

**National
Farmers Union
Insurance Companies**

Larry Armstrong
104 Commerce 629-1342
RCG Building



Bray's

EASTLAND - RANGER
EASTLAND COUNTY'S FAMILY STORE
FEATURING NATIONALLY ADVERTISED BRANDS
OF MERCHANDISE
Store Hours 9 a.m. - 5 p.m.

**Eastland Medical
& Surgical Clinic PA**

404 W. Commerce - 629-2633

M.A. Treadwell, M.D.
R.H. Garrett, M.D.

**EASTLAND
NATIONAL BANK**
EASTLAND, TEXAS



**D.L. Kinnaird
General Insurance**

Don Kinnaird Jr.
207 W. Main
Office 629 - 2544 Res. 629 - 1116

City Garage

103 W. White - 629-1709



Graham Trim Shop

708 W. Main - 629-2266

B & W Clinic

100 W. Plummer -
629-1711



**Hillcrest Food
Market**

1401 W. Main - 629-1600
James Zuspann

Comanche Co.

1311 W. Main - 629-2088



MAVERICKS

vs.
CLYDE

FRIDAY THERE

**M
A
V
E
R
I
C
K
S**



**N
O.
1**

CARBON FOOTBALL SCHEDULE

Scrimmage games at Mozelle August 22, and at Carbon August 29.

Sept. 4	Mullin at Carbon	Oct. 10	Sidney at Sidney
Sept. 12	Pottsville at Pottsville	Oct. 17	Gustine at Gustine
Sept. 18	May at Carbon	Oct. 23	Open
Sept. 26	Strawn at Strawn	Oct. 30	Gordon at Carbon
Oct. 2	Santo at Carbon	Nov. 6	Moran at Carbon
		Nov. 14	Bryson at Bryson

Holland's Drive In

Hwy. 80 West - 629-2215

Eastland Telegram

Your Family Newspaper

110 W. Commerce Eastland

**Morren Plumbing
& Gift Shop**

1013 W. Main - 629-2092

**ALTMAN'S STYLE
SHOP**

North Side Of Square

Eastland

THIS PAGE IS SPONSORED BY BOOSTERS WHO URGE YOU TO BACK

THE SCHOOLS

**C-Wholesale
Tire Co.**

403 E. Main - 629-2922

Town Merchants Fast Gulf Oil
Square Motor Lines Products,
Fashions Dist.
629 - 2193 629 - 2440 629 - 2884

W.H. (Bill) Hill, Fam.

Dairy Queen

LIVE A LITTLE

Hwy. 80 East - 629-2400

Inviting You To Watch All Of
The Games NCAA-AFL-NFL-WFL

Cisco, Eastland, Ranger

SOUTHERN TV CABLE SYSTEM

Dr. Robert Morton Speaks On Cancer Patients To Service Clubs

Pleading for understanding for cancer patients this week was Dr. Robert Morton, vice president of the Texas Cancer Center and vice president of the Health Science Center, both in Houston.

Guest speaker for members of the Eastland Rotary Club Monday, and the Lions Club Tuesday, at the Ramada Inn, Dr. Morton, well-known to Eastlanders, especially urged that patients be given the opportunity to live normal productive lives.

"So often," he explained, "patients who are undergoing treatment, and those who have their disease 'arrested' are given undue amounts of sympathy when what they really want and need is ready acceptance to be treated like any other ordinary person, which they are."

Ben Hamner arranged for the Rotary program and introduced Dr. Morton. President Ken Reese presided and guests included Mrs. Tip Arther, H.V. O'Brien, Mike Siebert, Milton Krause and Jim Reynolds.

Bruce Pipkin was Lion program chairman and introduced the speaker. Guests were Ken Mahall and David Bryan, both of Abilene and Bill Richardson of Commerce.

Dr. Morton explained the Center, stating that the best-known facility is the M.D. Anderson hospital (which has a 300-bed capacity and operates at 98 per cent capacity), but that the Center also includes an important research center at Smithville where important and very promising work is being done.

There've been 112,000 patients treated at Anderson, he said, with 99,250 being analyzed as one of some 95 different types of cancer. Twenty five percent of these have been operated and found to be benign (non-malignant) tumor, he explained.

"Our present average is 42 percent cured," he said, and the center has researched some 10,000 drugs, finding about 40 which are being used beneficially.

One drug under consideration was found to be helpful in many treatments in use during the recent S. Vietnamese War, he explained.

Another drug is proving to help cure some 97 percent of cancers occurring in young mothers following child birth. A new Swedish medical expert is now at the hospital

leading in a program of marrow transplants which offers bright hopes, Dr. Morton said.

It's primarily a Texas institution and out-of-country patients are required to make a \$500 deposit with out-of-country patients asked for \$1,000 deposits. Of the patients, 13.6 percent pay full hospital costs and 32.3 are treated free by the hospital.

Using slides and a brand-new film, Dr. Morton showed many cases of treatment and recovery in his appeal to help dispell the inherent fear that accompnys the disease. The film shows, in simple diagram, how cancer is a cell mutation (one that goes haywire and doesn't function normally), and that the most important tool is early detection.

Time and again patients showed that by responding quickly for examination and treatment, that full recovery was possible.

The new film will be made available throughout the state to show the importance of understanding the disease and the hope that exists for patients - if they respond quickly.

Survey Complete

Shirley B. Cawyer of Stephenville has completed a survey of cemetery inscriptions in Eastland County.

Mrs. Cawyer copied all names, complete dates and nay relationship listed on 22,500 tombstones. Her survey included 77 cemeteries in Ranger, Gorman, Eastland, Cisco, Rising Star and Pioneer.

The inscriptions will be printed in three volumes, each containing about 230 pages plus an index. The books will then be placed in genealogical libraries throughout the United States.

Mrs. Cawyer and Weldon Hudson of Fort Worth, past president of the Fort Worth Genealogical Society, catalogued and published 92 cemeteries in Erath County in 1973.

The Stephenville woman requests information on the location, names of people buried and completed dates for the following cemeteries: Downtain, Jordan, Sutton, McBroom, Basham, Booger Mountain, Baseline, Morgan, Big Sandy, Indian Mountain, Bacon Rancho and other lone graves. Her address is P.O. Box 164, Stephenville, Texas 76401.



Mr. and Mrs. Roger Van Weber of Greenwood announce the birth of their daughter Monica Jane, November 3, 1975, in the Decatur Community Hospital.

The baby weighed eight pounds and five ounces and was 20 1/2 inches long.

Grandparents are Mr. and Mrs. C.R. Weber of Decatur and Mr. and Mrs. Gene Boney of Eastland.

The paternal great-grandfather is Rudolph Weber of Bayonne, New Jersey.

Maternal great-grandmothers are Mrs. Jewell Boney and Mrs. Annie Harper, both of Ranger. Mrs. Dessie Harper of Tyler is the maternal great-grandmother.

Immunizations To Prevent Diseases

Each year many U.S. children die or become disabled from diseases they needn't have contracted, Carla Shearer, a health education specialist, says.

"Immunizations are readily accessible to prevent these tragedies. Diphtheria, pertussis (whooping cough), tetanus, polio, measles and rubella are diseases which can cause disabilities and even death, but they can be prevented through immunizations," Miss Shearer, with the Texas Agricultural Extension Service, The Texas A&M University System, said.

"When vaccines were first available, the incidence of childhood diseases dropped sharply. But as the effects of the diseases faded from people's minds, parents made

less effort to be sure their children were fully protected - so immunization levels declined."

The Texas Immunization Law requires that all children be immunized before entering school - but it's important to protect preschoolers also. This is the parents' responsibility since these youngsters aren't in school yet, Miss Shearer said.

She noted that reports show immunity levels among 1- to 4-year-olds are low enough to sustain substantial spread of disease, including outbreaks.

The Texas Department of Health Resources suggests that a child start his immunization series at 2 months of age by receiving DTP (diphtheria - tetanus - pertussis) and polio immunizations.

Suggested immunization schedule:

Basic Series
2 months - DTP and Polio
4 months - DTP and Polio
6 months - DTP and Polio
12 months - Measles and Rubella
15 - 18 months - DTP and Polio

Booster Doses
4 - 6 years - DTP and Polio
14 - 16 years - Td (Tetanus - diphtheria)
Thereafter - Td every 10 years

The specialist urged parents to check their children's immunization records. If unsure about the need for immunization, call the private physician or the county health department office.



Bobby Emfinger displays his snake hunting catch which he and another Eastlander, Kenneth Stroud, killed Saturday night near Pumpkin Center, south of Eastland. Emfinger said they waited on a small lane for the snakes to pass by, then shot them with 22 rifles. The total number killed was 38.

(Photo by James Dabney)



(Photo by Roy Petty)

CWF Holds Meet

The Christian Women's Fellowship afternoon group met November 3, at 2:30 in the annex of the Christian Church with nine members present.

Meeting opened with prayer by President Evelyn Daniels. The group decided to give to the patients in a nursing home and donate to the Men's Fellowship Class for Christmas.

Margaret Tow brought the lesson on "Who Are the Mexican Americans". It was very interesting and informative. Mae Woods brought the

devotional from Ephesians 2:14 and 3:6.

The benediction was said in unison.

Those present were Naomi Young, Jane Day, Shirley Garrett, Evelyn Daniels, Margaret Tow, Ressie Cramer, Mae Woods, Berniece Tankersley, and Opal Clifton.

Mr. and Mrs. Boyd Hazard of Ranger and Mr. and Mrs. J.C. Foreman of Olden visited Mr. and Mrs. A.H. Crosby during the weekend.

Personals

Mr. and Mrs. Larry Tankersley, Tami, Teri, Trent and Tona of Tuscola spent the weekend in the home of his parents, Mr. and Mrs. W.E. Tankersley.

Mr. and Mrs. J.A. Jackson and G.A. Earp attended the Homecoming services at East Side Baptist Church in Cisco Sunday evening.

Mr. and Mrs. L.I. Amato of Hitchcock visited Mrs. Ruiy Cavanaugh during last weekend. Also visiting on Sunday was Mrs. Georgia Mae Rush of Ranger.

Too Late To Classify

FOR SALE--1969 Mercury - Marquis Brougham. Call Noland Butler after 5 p.m. week days or any time on weekends. 629-8106. t-1f

PORCH SALE--Thursday, Friday and Saturday. House east of Auction Barn, clothes, furniture and misc. items. t-89

FOR SALE--140 acres, 42 acres peanut allotment, improvements, 2 irrigation wells, wheel mover, call 734-2005. t-99

Visiting Mrs. Adele Whitten during the weekend were her children and grandchildren Mrs. Nell Fortenberry and children of Decatur, Mr. and Mrs. Neal Edwards, Diana and Allen of Breckenridge.

TEXAS PRESS ASSOCIATION

JUTE SALE 6 Ply
10 lbs. JUTE Reg. \$18.00
NOW \$14.95
8 lbs. JUTE Reg. \$13.95
NOW \$11.95
Macrame Boards 89¢
All Colored Jute
20% Off
Film Processing Drop Station With Over Night Service.
Morren's Plumbing And Gift Shop
1013 West Main
629-2092

SINCE 1919
"Your Insurance Specialist"

We Tune Up Tired Insurance Programs

D.L. Kinnaird
General Insurance
20 W. Main 629-2544
"Eastland's Oldest Insurance Agency"

No. 1 Ambulance Service In Eastland

EULA ARRINGTON CAUBLE
Owner

BOBBY BOUDREAUX
Mortician
Emergency Ambulance Attendant
First Aid Instructor

EDDIE UNDERWOOD
Funeral Director
Ambulance Attendant

EASTLAND'S OLDEST 56 YEARS FUNERAL SERVICE FOR EASTLAND

JACKIE ARRINGTON
Ambulance Attendant

DONNA UNDERWOOD
Receptionist - Secretary

MACK WALKER
Ambulance Attendant

ARRINGTON FUNERAL HOME

301 S. Lamar Ph. 629-2611

BURIAL INSURANCE PRE-NEED FUNERAL ARRANGEMENTS

EXPERIENCE UNDERSTANDING FRIENDLINESS

Friendly Personalized Service