



J. E. CHISHOLM



PAUL CARMICKLE



JAMES SHOTWELL

Voters Return City Incumbents

Incumbent voters trekked to the polls Tuesday stream Tuesday and all three city incumbents to

will meet tonight at 7 for their meeting.

Turnout of 1,252 voters in the city didn't need a change in mayor nor city councilmen, and J. E. Chisholm defeated his two challengers with a landslide victory of 1,187 to 120. Charles Ary received 120 votes. C. E. Steward trailed with 30

persons received write-in votes in the election. Warren McCurry received 120 write-in votes and Lenard Mendoza received two write-in votes.

Incumbent city councilmen

came out with the most votes in that race. Paul Carmickle received 762 votes and James Shotwell tallied 717 votes. Gaining the next highest number of

RESULTS	
MAYOR	
J. E. CHISHOLM	1,187
CHARLES ARY	120
C. E. STEWARD	30
CITY COUNCILMEN	
PAUL CARMICKLE	762
JAMES E. SHOTWELL	717
VIRGIE HAILE	455
RAY BROOKS	218
STEVEN ROUNTREE	190
LEONARD SIMINGTON JR.	171

votes was Mrs. Virgie Haile, with 455. Then next in line were Ray Brooks with 218, Steven Rountree with 190, and Leonard Simington Jr. with 171.

With the 110 votes that were cast absentee, total votes cast in the election were 1,362.

Mayor Chisholm begins his sixth two-year term, while Paul Carmickle begins his third four-year term and Dr. James Shotwell begins his fourth four-year term.

Mrs. Hazel Clement served as election judge, and Mrs. Johnnie Ross was presiding judge. Mrs. Blanche Dodgen served as clerk.

Absentee balloting judge was Jan Reel, city tax assessor-collector, and her secretary, Vera Moya, was clerk.

In Another Election Saturday, 10 Vie For School Board Posts

Three school board members from a field of 10 candidates will be named in the Saturday board of trustee election. Three terms are expiring and two of the incumbents are seeking re-election.

A total of 74 voted absentee before the Tuesday deadline.

Polling hours are 8 a.m. to 7 p.m. in the Littlefield Junior High School.

SCHOOL TRUSTEE CANDIDATES

Mickey Ratliff and David Hampton have signed for another term. Werner Birkelbach declined to run for another term.

Candidate names will appear on the ballot in this order:

1. Charlene Terry, 2. David Hampton, 3. Troy Gardner, 4. Jay Bridwell, 5. Howard Head, 6. Carolyn Hodge, 7. Jack Despre, 8. Mickey Ratliff, 9. James Bolen and 10. Orville Bassett.

Mrs. Terry is a clerk at Cliff's Grocery. Hampton is field manager at Tide. Gardner is a U.S. postman.

Bridwell is a partner in Littlefield Butane. Head is owner and operator of the veterinarian clinic in Littlefield. Mrs. Hodge is a licensed vocational nurse. Jack Despre is a city policeman. Mickey Ratliff is a local attorney. James Bolen is employed by Littlefield Butane. Bassett is manager of Shook Tire.



CHARLENE TERRY



DAVID HAMPTON



TROY GARDNER



JAY BRIDWELL



HOWARD HEAD



CAROLYN HODGE



JOHN DESPRE



MICKEY RATLIFF



JAMES BOLEN



ORVILLE BASSETT

LAMB COUNTY LEADER-NEWS

VOLUME 52 NUMBER 97 LITTLEFIELD, LAMB COUNTY, TEXAS, THURSDAY, APRIL 3, 1975 8 PAGES

15 CENTS TAX INCLUDED

Eliminate Generation Gap, Learn To Communicate

Teaching parents ways of preventing the Generation Gap is the matter of a special workshop offered in Littlefield by Mrs. Ann and Mrs. Nina Harris, staff members of the Central Plains Mental Center, Littlefield Outreach Center, 128-B E. 10th.

The class will be conducted one night a week for eight weeks, beginning April 10, from 7 to 10 p.m.

Mrs. Ford and Mrs. Harris will be offering the program, called Parent Effectiveness Training (P.E.T.) to Littlefield families who are intrigued by the philosophy of its founder, Dr. Thomas Gordon of Pasadena, Calif., who states that all conflicts in the home can be resolved without either parents or child losing face or sacrificing his needs.

"Parenthood is the only major job in our culture for which no training is required, or even available," they stated, "and P.E.T. can bring to Littlefield the effective interpersonal skills needed to fill that void."

Founded in 1962 in California, the program has recently spread across the country, with more than 1,000 licensed instructors now teaching classes of approximately 30 parents how to listen so children will talk, talk so their children will listen, and solve problems so that no one in the family loses. The resulting closeness and cooperation has been reported to make both children and parents happier and to eliminate the so-called generation gap.

Mrs. Ford is director of Occupational Therapy at Central Plains Mental Health Center in Plainview and Mrs. Harris is the Mental Health Outreach worker in the Littlefield office.

Those interested in the P.E.T. program are asked to call Mrs. Harris at 385-4013 in Littlefield.

Further details regarding the class will appear in Sunday's Leader-News.

Producers Ask Cutback Of All Major Crops

Every idea imaginable was advanced in a meeting of at least 1,000 farmers, ranchers and agribusinessmen in Hereford Monday night.

Joe Montgomery of Security State Bank was one of the farm lenders attending. He termed the lengthy meeting "disorganized."

At times persons attending tried to express political views, especially concerning the farm bill, but the master of ceremonies led the discussion toward what farmers could do to cut production of major crops to keep prices up.

The group agreed that the cattle feeder shouldn't be alienated. A resolution was passed to send letters to congressmen to ask that beef imports be stopped.

Gerald McCathern, a Hereford man elected president of the group, summed up the group's feelings by saying, "It seems strange to me something can't be done to cut back on the beef imports and set prices for farm commodities that both the cattlemen and the grain producer can live with."

One producer wanted farmers to leave out 25 percent of all major crops. This idea wasn't popular. But the group did agree to hold back 10 percent of all major commodities to escape a glutted market and hopefully overcome low to non-existent profits.

The 1,000 or more attending hope to convince other farmers to cut back on all of the major crops by 10 percent.

Turnover Injures Four Youths, Seven Booked At County Jail

Four young people escaped serious injury in a one car turnover six miles west of Littlefield on FM 54 about 10:35 Sunday night.

Taken to the Littlefield Hospital by ambulance was Danny Moore, 18, of Littlefield, driver of the car. Rosemary Phillips, 16, Richard Harris, 21, of Lubbock, and Roger Johnson, 18, of Anton were taken by private auto to the hospital. None of the injuries were believed to be serious.

According to the officer's report, the driver said he thought a tire blew out.

The '74 Ford Torino rolled twice, one of the doors was knocked off, and all of the occupants were thrown out of the car.

At the Lamb County sheriff's office this weekend, six were jailed on various charges.

Two Levelland men, Pablo Hinojosa and Margarito Hinojosa are in the county jail on burglary charges with

their bonds reset at \$100,000 each. Jerry Ralph Moore was charged with violation of probation. The original charge was burglary and he was sentenced to seven years.

A Littlefield woman and an Amherst man were charged with check law violation, a Springlake man was fined \$150 plus cost on a charge of carrying an unlawful weapon, and an Olton man is being held for Amarillo officials.

Four thefts have been reported to county officers. David Debusk reported the loss of a battery off an irrigation well motor northeast of Littlefield.

Charles Carpenter reported the theft of 400 gallons of gas valued at \$168 stolen from his farm 11 miles northwest of Littlefield.

W. O. Hampton reported the felony theft of a 1965 Ford car. Ray Stansell reported the theft of a trailer and trailer full of cast iron valued at \$300 taken from the Earth Elevator feed lot.

Wildcat Band Members Bake Sale

Wildcat Band members are sponsoring a bake sale Saturday, starting at 9 a.m. in the vacant building at the corner of 10th and 12th streets.

The bake sale will feature approximately 90 cakes and pies will be sold to the public, and money from the project will go to help pay for the trip to San Antonio, where the band will play in the Festival of San Antonio and the Battle of Flowers April 10-12.

Other fund-raising projects will be held during the week.



FOUR YOUNG PEOPLE WERE INJURED Sunday night when this 1974 Ford Torino rolled over and threw the occupants out of the vehicle. (Staff Photo)



THE SINGING SEMINARIANS of Asbury Theological Seminary, Wilmore, Ky. may be heard in concert Monday, April 7, 8 p.m. at the First United Methodist Church, 100 W. 15th, Littlefield. The 38-voice male choir is on an 11-day tour of Texas. Their program features both traditional and contemporary hymns and sacred songs. Occasionally, stringed and brass instruments are used in accompaniment. The public is invited to attend the concert. There is no admission charge; an offering will be received. Rev. Wesley N. Daniel is host pastor. (ATS Photo)

'A Star Is Born' To Be Staged Friday

"A Star Is Born" talent show will be Friday, April 4, at 7 p.m. in the Littlefield High School Auditorium. Admission will be 50 cents for students and \$1 for adults. Persons under six years will be admitted free. Contestants of all ages have entered and will be judged accordingly. Judges for the event will be Roger Haile, Roy Faubian, and Mrs. Warren Cate. Haile of Hereford, is actively involved in the musical recording and publishing business. Faubian is the manager of the KPAN radio station in Hereford and the past president of the Hereford Chamber of Commerce. Mrs. Cate is a housewife and the mother of three sons. She is a past president of P-TA in Anton

and has been the director of the Variety Show at Anton several years. Color portraits by Oecia, collector's coins and trophy buckets will be a few of the prizes awarded. The Alpha Lambda Zeta Chapter of Beta Sigma Phi invites everyone to attend.

Coffee-Coats Wedding Solemnized In Clovis

ENOCHS—Sandra Coffee and Waymon Keith Coats of Hobbs, N.M. exchanged double ring wedding vows Friday night, March 21, in the United Methodist in Clovis, N.M. Parents of the couple are Mr. and Mrs. Melvin Coffee of Clovis and Mr. and Mrs. Kenneth Coats of Rt. 2, Morton.

Officiating for the reading of the vows was Rev. Douglas Wofford, pastor of the Kingswood Methodist Church at Clovis. Melvin Coffee presented his daughter for marriage. She wore a gown of unbleached domestic featuring a lace inset in the long sleeves and bodice. She wore a large white picture hat trimmed in apricot ribbon, bone colored shoes, and carried a bouquet of yellow daisies, tiny apricot colored rosebuds, bridal wreath and greenery.

Mrs. Deanna Jones of Clovis, sister of the groom, was the maid of honor. She wore a gown of apricot with bone accessories and carried a bouquet of flowers identical to the bride's. Robert Thedford Jones of Clovis was groomsmen. Vows were exchanged before the altar, decorated with apricot gladiolus and carnations, flanked by candelabras holding white and apricot candles. Mrs. Deanna Jones, sister of the groom, sang "The Wedding Song", as she was accompanied by Linda Dahoff on the piano. She also played several selections while the guests were seated by the ushers, Kim Coats, brother of the groom; and Roger of Pasadena, cousin of the bride. For her daughter's wedding, Mrs. Coffee wore a floor-length gown of blue, and bone accessories, and a corsage of daisies and apricot rosebuds. Mrs. Coats wore a floor-length mint green gown with bone accessories and daisies and apricot rosebuds in her corsage. Following the wedding, a

reception was held in the home of the bride's parents. The bride's table was covered in white lace and centered with the wedding cake, trimmed with apricot roses and white wedding bells. Apricot punch and coffee were served with the cake. The room was decorated with the glads and carnations from the church. Refreshments were served by Mrs. Ruth Jefferson, Dianna Glicas and Pauline Campbell. After a short wedding trip the couple will reside in Hobbs, N.M. where he is employed by New Mexico Refrigeration Company and she is employed by the Bank Americard of Citizens National Bank in Hobbs. She is a graduate of Clovis High School and Keith is a graduate of Morton High School.

Attending from Morton were Mrs. R. H. Baker, Susan, Sharita and Mrs. Kay Baker; Mr. and Mrs. Nolan Harlan and John of Bula were in Carlsbad, N.M. Thursday through Sunday with Mrs. Britt's daughter, Mrs. Adele Cole. Mrs. S. J. Tharp returned from Sweetwater Sunday evening. She had attended funeral services for her son, Clay Tharp, who had died in a hospital following a car accident. His wife Jean is a patient in a hospital as the result of the accident. Services were held in the First United Methodist Church, Sweetwater, at 2 p.m. Sunday, interment in Sweetwater Cemetery. They were long-time residents of Sweetwater. His wife, two daughters and a son survive. His brother Rev. Jarrell Tharp of Powell, Wyo. arrived there Saturday afternoon by plane and plans to come to Amherst to see his mother this week. Mrs. HELEN EADY of Tehuacana, Texas is spending several days with her son L. B. and family. TODD EADY the eight-year-old son of the Chris Eadys, Lubbock, spent part of his Easter vacation at school with his grandparents Mr. and Mrs. L. B. Eady. VONDELL and Juanell and Terry Wood of Slaton and Mr. and Mrs. Roy Mahan and Mr. and Mrs. Virgil Masengale of Monahans were guests of Mr. and Mrs. Jay House Sunday and attended the Easter service at the United Methodist Church.

Gleaners Class Holds Luncheon

AMHERST—Gleaners class members of the First Baptist Sunday school had an Easter luncheon with Mrs. Della Thomas hostess at noon Friday. The Easter motif was in the assorted salads, cream cheese sandwiches, coconut cake, hot spiced tea and coffee served. Mrs. Ted Long read Matthew 27th chapter and gave the story, "Flowers Aren't Everything" by Wilma G. Wells and the "Legend of the Ticket Rose". Mrs. S. E. Lance vice-chairman, presided in a short business session. Those attending were Meses W. M. Tomes, Bud Emory, Ed Love, S. E. Lance, Paul Gonzales, T. I. Batson, Ted Long and Thomas.

Scouts Schedule Spaghetti Event

Girl Scout Troop 218 is sponsoring a spaghetti dinner Saturday, April 5, from 11 a.m. to 1:30 p.m. in the Lamb County Community Center, Third and Ripley Streets in Littlefield. Tickets are \$2 for adults and \$1 for children under 12 years old. "Everyone go vote then come by and eat with the Girl Scouts," state members of the troop.



MR. AND MRS. W.T. VEREEN

Mr., Mrs. W.T. Vereen To Celebrate Anniversary

Mr. and Mrs. W. T. (Tobe) Vereen will celebrate their 50th Wedding Anniversary Sunday afternoon, April 6, from 2 to 4 p.m. in the Sudan Community Center. The informal reception will be given by their three daughters and their families: Billie Grigsby of Sudan, Mr. and Mrs. James Oliver of Lovington, N.M., and Mr. and Mrs. T. A. Henson of Littlefield.

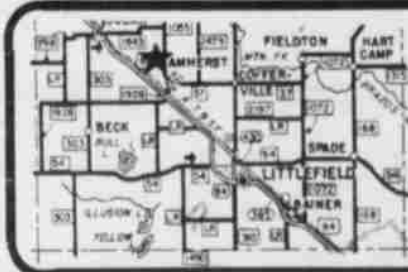

NEWS FROM AMHERST

MRS. LESTER LaGRANGE 246-3338

GUEST OF Mr. and Mrs. Don Hevern Thursday was her mother, Mrs. Susie Lynch, of Lubbock. MRS. MARY E. BRITT and Mr. and Mrs. Nolan Harlan and John of Bula were in Carlsbad, N.M. Thursday through Sunday with Mrs. Britt's daughter, Mrs. Adele Cole. Mrs. S. J. Tharp returned from Sweetwater Sunday evening. She had attended funeral services for her son, Clay Tharp, who had died in a hospital following a car accident. His wife Jean is a patient in a hospital as the result of the accident. Services were held in the First United Methodist Church, Sweetwater, at 2 p.m. Sunday, interment in Sweetwater Cemetery. They were long-time residents of Sweetwater. His wife, two daughters and a son survive. His brother Rev. Jarrell Tharp of Powell, Wyo. arrived there Saturday afternoon by plane and plans to come to Amherst to see his mother this week.

where Mrs. House (Hazel) is and Mrs. Eugene Young girls.

MRS. DOROTHY ABBOTT had visited her son Sherwood and family in Amarillo and was getting ready for the trip home Saturday when she fell, breaking her left wrist.

MR. AND MRS. W. P. Stone returned home Saturday. They visited their son Bill and family in Midland and in Amarillo and Pampa with relatives. They were in Pampa at the time the tornado struck Lefors, 12 miles away.

MR. AND MRS. W. O. Long of Albuquerque spent Friday night and Saturday morning with his parents Mr. and Mrs. Ted Long. They went to canyon for a visit with Helen's relatives.

MRS. BARBARA BLAIR and children of Lubbock were here for Easter with her parents, Mr. and Mrs. Robert D' Ruth and Mrs. Robert D' Ruth who was here from Lubbock, also with her parents.

MR. AND MRS. C. A. Duffy Jr., fished at Lake Whitney during the Easter vacation.

MR. AND MRS. Carlton Bowman, daughter, Judy and Jana Heath of Hale Center returned home from Bryan and Houston. Mrs. Bowman (Ruby) received a favorable check-up at Anderson Hospital and Clinic. In Bryan they visited the Donnie Gene Bownmans. Karlan accompanied them to Houston.

MR. AND MRS. Randy Plank and Amber of Lubbock spent Easter with her parents, Mr.

and Mrs. Eugene Young girls.

MRS. DOROTHY ABBOTT had visited her son Sherwood and family in Amarillo and was getting ready for the trip home Saturday when she fell, breaking her left wrist.

MR. AND MRS. W. P. Stone returned home Saturday. They visited their son Bill and family in Midland and in Amarillo and Pampa with relatives. They were in Pampa at the time the tornado struck Lefors, 12 miles away.

MR. AND MRS. W. O. Long of Albuquerque spent Friday night and Saturday morning with his parents Mr. and Mrs. Ted Long. They went to canyon for a visit with Helen's relatives.

MRS. BARBARA BLAIR and children of Lubbock were here for Easter with her parents, Mr. and Mrs. Robert D' Ruth and Mrs. Robert D' Ruth who was here from Lubbock, also with her parents.

MR. AND MRS. C. A. Duffy Jr., fished at Lake Whitney during the Easter vacation.

MR. AND MRS. Carlton Bowman, daughter, Judy and Jana Heath of Hale Center returned home from Bryan and Houston. Mrs. Bowman (Ruby) received a favorable check-up at Anderson Hospital and Clinic. In Bryan they visited the Donnie Gene Bownmans. Karlan accompanied them to Houston.

MR. AND MRS. Randy Plank and Amber of Lubbock spent Easter with her parents, Mr.

Palace Theatre April 2-8

IT'S SURVIVAL THE FIERCE AND THE FUNNIEST.

"THE LONGEST YARD" is a movie cracks a lot of jokes And a lot of bones. Burt Reynolds star tough, sassy and always that fine.

BURT REYNOLDS "THE LONGEST YARD" EDDIE ALBERT ED LAUTER MIKE CON

You really CAN earn MORE DOLLARS On Your Savings

Look how much more a \$10,000 deposit will earn with US than with a BANK.

BANK TYPE	Our Rate	\$10,000 At A Bank	\$10,000 With Us	We Pay This Much More
4-YEAR C.D.	7.25%	\$13,363.80	\$13,498.10	\$134.30
2-YEAR C.D.	6.50%	\$11,764.30	\$11,838.00	\$ 73.70
1-YEAR C.D.	6.00%	\$10,618.30	\$10,671.50	\$ 53.20

NOW AVAILABLE - A 6-year, 7 1/2% Certificate of Deposit, \$1,000 minimum, yielding an effective annual rate of 8.06%. Ask us about it!

If you want your savings to earn MORE DOLLARS, open a savings account with US. Come to any of our conveniently located offices, call us or use the coupon below. Savings with us are insured to \$40,000 by the Federal Savings and Loan Insurance Corporation.

And what about other investments such as:

- Stocks • Treasury Notes • Bills • Bonds • Money Market Mutual Funds • Floating Rate Notes

Get the real story. See how our Certificate of Deposit compares in earning power, safety and availability. You'll be surprised! Use the coupon below to get your FREE copy of our new Investment Comparison Booklet.

Learning more about the benefits, comparisons, etc. is a controlled investment business. Learning more about the benefits, comparisons, etc. is a controlled investment business. Learning more about the benefits, comparisons, etc. is a controlled investment business. Learning more about the benefits, comparisons, etc. is a controlled investment business.



MAIN OFFICE • 1602 Avenue Q • Lubbock • Telephone 783-9401
50TH STREET OFFICE • 3024 50th Street • Lubbock • Telephone 795-6448
REDBUD SQUARE OFFICE • 40 Redbud Center • Lubbock • Telephone 792-3381

TO OPEN AN ACCOUNT, ADD TO YOUR PRESENT ACCOUNT, OR TRANSFER YOUR ACCOUNT TO US, SEND COUPON TODAY.

I want to open a new account.
 I want to add to my present account.
 I want to transfer my account from _____ (Check or Money Order) My passbook or Certificate with _____ (Name of Bank or Savings & Loan)
 I want to open a new account with _____ (Name of Bank or Savings & Loan)
 I want to add to my present account with _____ (Name of Bank or Savings & Loan)
 I want to transfer my account from _____ (Name of Bank or Savings & Loan) to _____ (Name of Bank or Savings & Loan)
 I want to open a new account with _____ (Name of Bank or Savings & Loan) and transfer my account from _____ (Name of Bank or Savings & Loan) to _____ (Name of Bank or Savings & Loan)
 I want to add to my present account with _____ (Name of Bank or Savings & Loan) and transfer my account from _____ (Name of Bank or Savings & Loan) to _____ (Name of Bank or Savings & Loan)
 I want to transfer my account from _____ (Name of Bank or Savings & Loan) to _____ (Name of Bank or Savings & Loan) and add to my present account with _____ (Name of Bank or Savings & Loan)
 I want to open a new account with _____ (Name of Bank or Savings & Loan) and add to my present account with _____ (Name of Bank or Savings & Loan)
 I want to add to my present account with _____ (Name of Bank or Savings & Loan) and open a new account with _____ (Name of Bank or Savings & Loan)
 I want to transfer my account from _____ (Name of Bank or Savings & Loan) to _____ (Name of Bank or Savings & Loan) and open a new account with _____ (Name of Bank or Savings & Loan)
 I want to open a new account with _____ (Name of Bank or Savings & Loan) and transfer my account from _____ (Name of Bank or Savings & Loan) to _____ (Name of Bank or Savings & Loan)
 I want to add to my present account with _____ (Name of Bank or Savings & Loan) and transfer my account from _____ (Name of Bank or Savings & Loan) to _____ (Name of Bank or Savings & Loan)
 I want to transfer my account from _____ (Name of Bank or Savings & Loan) to _____ (Name of Bank or Savings & Loan) and add to my present account with _____ (Name of Bank or Savings & Loan)
 I want to open a new account with _____ (Name of Bank or Savings & Loan) and add to my present account with _____ (Name of Bank or Savings & Loan)
 I want to add to my present account with _____ (Name of Bank or Savings & Loan) and open a new account with _____ (Name of Bank or Savings & Loan)
 I want to transfer my account from _____ (Name of Bank or Savings & Loan) to _____ (Name of Bank or Savings & Loan) and open a new account with _____ (Name of Bank or Savings & Loan)
 I want to open a new account with _____ (Name of Bank or Savings & Loan) and transfer my account from _____ (Name of Bank or Savings & Loan) to _____ (Name of Bank or Savings & Loan)
 I want to add to my present account with _____ (Name of Bank or Savings & Loan) and transfer my account from _____ (Name of Bank or Savings & Loan) to _____ (Name of Bank or Savings & Loan)
 I want to transfer my account from _____ (Name of Bank or Savings & Loan) to _____ (Name of Bank or Savings & Loan) and add to my present account with _____ (Name of Bank or Savings & Loan)
 I want to open a new account with _____ (Name of Bank or Savings & Loan) and add to my present account with _____ (Name of Bank or Savings & Loan)
 I want to add to my present account with _____ (Name of Bank or Savings & Loan) and open a new account with _____ (Name of Bank or Savings & Loan)
 I want to transfer my account from _____ (Name of Bank or Savings & Loan) to _____ (Name of Bank or Savings & Loan) and open a new account with _____ (Name of Bank or Savings & Loan)
 I want to open a new account with _____ (Name of Bank or Savings & Loan) and transfer my account from _____ (Name of Bank or Savings & Loan) to _____ (Name of Bank or Savings & Loan)
 I want to add to my present account with _____ (Name of Bank or Savings & Loan) and transfer my account from _____ (Name of Bank or Savings & Loan) to _____ (Name of Bank or Savings & Loan)
 I want to transfer my account from _____ (Name of Bank or Savings & Loan) to _____ (Name of Bank or Savings & Loan) and add to my present account with _____ (Name of Bank or Savings & Loan)
 I want to open a new account with _____ (Name of Bank or Savings & Loan) and add to my present account with _____ (Name of Bank or Savings & Loan)
 I want to add to my present account with _____ (Name of Bank or Savings & Loan) and open a new account with _____ (Name of Bank or Savings & Loan)
 I want to transfer my account from _____ (Name of Bank or Savings & Loan) to _____ (Name of Bank or Savings & Loan) and open a new account with _____ (Name of Bank or Savings & Loan)
 I want to open a new account with _____ (Name of Bank or Savings & Loan) and transfer my account from _____ (Name of Bank or Savings & Loan) to _____ (Name of Bank or Savings & Loan)
 I want to add to my present account with _____ (Name of Bank or Savings & Loan) and transfer my account from _____ (Name of Bank or Savings & Loan) to _____ (Name of Bank or Savings & Loan)
 I want to transfer my account from _____ (Name of Bank or Savings & Loan) to _____ (Name of Bank or Savings & Loan) and add to my present account with _____ (Name of Bank or Savings & Loan)
 I want to open a new account with _____ (Name of Bank or Savings & Loan) and add to my present account with _____ (Name of Bank or Savings & Loan)
 I want to add to my present account with _____ (Name of Bank or Savings & Loan) and open a new account with _____ (Name of Bank or Savings & Loan)
 I want to transfer my account from _____ (Name of Bank or Savings & Loan) to _____ (Name of Bank or Savings & Loan) and open a new account with _____ (Name of Bank or Savings & Loan)
 I want to open a new account with _____ (Name of Bank or Savings & Loan) and transfer my account from _____ (Name of Bank or Savings & Loan) to _____ (Name of Bank or Savings & Loan)
 I want to add to my present account with _____ (Name of Bank or Savings & Loan) and transfer my account from _____ (Name of Bank or Savings & Loan) to _____ (Name of Bank or Savings & Loan)
 I want to transfer my account from _____ (Name of Bank or Savings & Loan) to _____ (Name of Bank or Savings & Loan) and add to my present account with _____ (Name of Bank or Savings & Loan)
 I want to open a new account with _____ (Name of Bank or Savings & Loan) and add to my present account with _____ (Name of Bank or Savings & Loan)
 I want to add to my present account with _____ (Name of Bank or Savings & Loan) and open a new account with _____ (Name of Bank or Savings & Loan)
 I want to transfer my account from _____ (Name of Bank or Savings & Loan) to _____ (Name of Bank or Savings & Loan) and open a new account with _____ (Name of Bank or Savings & Loan)
 I want to open a new account with _____ (Name of Bank or Savings & Loan) and transfer my account from _____ (Name of Bank or Savings & Loan) to _____ (Name of Bank or Savings & Loan)
 I want to add to my present account with _____ (Name of Bank or Savings & Loan) and transfer my account from _____ (Name of Bank or Savings & Loan) to _____ (Name of Bank or Savings & Loan)
 I want to transfer my account from _____ (Name of Bank or Savings & Loan) to _____ (Name of Bank or Savings & Loan) and add to my present account with _____ (Name of Bank or Savings & Loan)
 I want to open a new account with _____ (Name of Bank or Savings & Loan) and add to my present account with _____ (Name of Bank or Savings & Loan)
 I want to add to my present account with _____ (Name of Bank or Savings & Loan) and open a new account with _____ (Name of Bank or Savings & Loan)
 I want to transfer my account from _____ (Name of Bank or Savings & Loan) to _____ (Name of Bank or Savings & Loan) and open a new account with _____ (Name of Bank or Savings & Loan)
 I want to open a new account with _____ (Name of Bank or Savings & Loan) and transfer my account from _____ (Name of Bank or Savings & Loan) to _____ (Name of Bank or Savings & Loan)
 I want to add to my present account with _____ (Name of Bank or Savings & Loan) and transfer my account from _____ (Name of Bank or Savings & Loan) to _____ (Name of Bank or Savings & Loan)
 I want to transfer my account from _____ (Name of Bank or Savings & Loan) to _____ (Name of Bank or Savings & Loan) and add to my present account with _____ (Name of Bank or Savings & Loan)
 I want to open a new account with _____ (Name of Bank or Savings & Loan) and add to my present account with _____ (Name of Bank or Savings & Loan)
 I want to add to my present account with _____ (Name of Bank or Savings & Loan) and open a new account with _____ (Name of Bank or Savings & Loan)
 I want to transfer my account from _____ (Name of Bank or Savings & Loan) to _____ (Name of Bank or Savings & Loan) and open a new account with _____ (Name of Bank or Savings & Loan)
 I want to open a new account with _____ (Name of Bank or Savings & Loan) and transfer my account from _____ (Name of Bank or Savings & Loan) to _____ (Name of Bank or Savings & Loan)
 I want to add to my present account with _____ (Name of Bank or Savings & Loan) and transfer my account from _____ (Name of Bank or Savings & Loan) to _____ (Name of Bank or Savings & Loan)
 I want to transfer my account from _____ (Name of Bank or Savings & Loan) to _____ (Name of Bank or Savings & Loan) and add to my present account with _____ (Name of Bank or Savings & Loan)
 I want to open a new account with _____ (Name of Bank or Savings & Loan) and add to my present account with _____ (Name of Bank or Savings & Loan)
 I want to add to my present account with _____ (Name of Bank or Savings & Loan) and open a new account with _____ (Name of Bank or Savings & Loan)
 I want to transfer my account from _____ (Name of Bank or Savings & Loan) to _____ (Name of Bank or Savings & Loan) and open a new account with _____ (Name of Bank or Savings & Loan)
 I want to open a new account with _____ (Name of Bank or Savings & Loan) and transfer my account from _____ (Name of Bank or Savings & Loan) to _____ (Name of Bank or Savings & Loan)
 I want to add to my present account with _____ (Name of Bank or Savings & Loan) and transfer my account from _____ (Name of Bank or Savings & Loan) to _____ (Name of Bank or Savings & Loan)
 I want to transfer my account from _____ (Name of Bank or Savings & Loan) to _____ (Name of Bank or Savings & Loan) and add to my present account with _____ (Name of Bank or Savings & Loan)
 I want to open a new account with _____ (Name of Bank or Savings & Loan) and add to my present account with _____ (Name of Bank or Savings & Loan)
 I want to add to my present account with _____ (Name of Bank or Savings & Loan) and open a new account with _____ (Name of Bank or Savings & Loan)
 I want to transfer my account from _____ (Name of Bank or Savings & Loan) to _____ (Name of Bank or Savings & Loan) and open a new account with _____ (Name of Bank or Savings & Loan)
 I want to open a new account with _____ (Name of Bank or Savings & Loan) and transfer my account from _____ (Name of Bank or Savings & Loan) to _____ (Name of Bank or Savings & Loan)
 I want to add to my present account with _____ (Name of Bank or Savings & Loan) and transfer my account from _____ (Name of Bank or Savings & Loan) to _____ (Name of Bank or Savings & Loan)
 I want to transfer my account from _____ (Name of Bank or Savings & Loan) to _____ (Name of Bank or Savings & Loan) and add to my present account with _____ (Name of Bank or Savings & Loan)
 I want to open a new account with _____ (Name of Bank or Savings & Loan) and add to my present account with _____ (Name of Bank or Savings & Loan)
 I want to add to my present account with _____ (Name of Bank or Savings & Loan) and open a new account with _____ (Name of Bank or Savings & Loan)
 I want to transfer my account from _____ (Name of Bank or Savings & Loan) to _____ (Name of Bank or Savings & Loan) and open a new account with _____ (Name of Bank or Savings & Loan)
 I want to open a new account with _____ (Name of Bank or Savings & Loan) and transfer my account from _____ (Name of Bank or Savings & Loan) to _____ (Name of Bank or Savings & Loan)
 I want to add to my present account with _____ (Name of Bank or Savings & Loan) and transfer my account from _____ (Name of Bank or Savings & Loan) to _____ (Name of Bank or Savings & Loan)
 I want to transfer my account from _____ (Name of Bank or Savings & Loan) to _____ (Name of Bank or Savings & Loan) and add to my present account with _____ (Name of Bank or Savings & Loan)
 I want to open a new account with _____ (Name of Bank or Savings & Loan) and add to my present account with _____ (Name of Bank or Savings & Loan)
 I want to add to my present account with _____ (Name of Bank or Savings & Loan) and open a new account with _____ (Name of Bank or Savings & Loan)
 I want to transfer my account from _____ (Name of Bank or Savings & Loan) to _____ (Name of Bank or Savings & Loan) and open a new account with _____ (Name of Bank or Savings & Loan)
 I want to open a new account with _____ (Name of Bank or Savings & Loan) and transfer my account from _____ (Name of Bank or Savings & Loan) to _____ (Name of Bank or Savings & Loan)
 I want to add to my present account with _____ (Name of Bank or Savings & Loan) and transfer my account from _____ (Name of Bank or Savings & Loan) to _____ (Name of Bank or Savings & Loan)
 I want to transfer my account from _____ (Name of Bank or Savings & Loan) to _____ (Name of Bank or Savings & Loan) and add to my present account with _____ (Name of Bank or Savings & Loan)
 I want to open a new account with _____ (Name of Bank or Savings & Loan) and add to my present account with _____ (Name of Bank or Savings & Loan)
 I want to add to my present account with _____ (Name of Bank or Savings & Loan) and open a new account with _____ (Name of Bank or Savings & Loan)
 I want to transfer my account from _____ (Name of Bank or Savings & Loan) to _____ (Name of Bank or Savings & Loan) and open a new account with _____ (Name of Bank or Savings & Loan)
 I want to open a new account with _____ (Name of Bank or Savings & Loan) and transfer my account from _____ (Name of Bank or Savings & Loan) to _____ (Name of Bank or Savings & Loan)
 I want to add to my present account with _____ (Name of Bank or Savings & Loan) and transfer my account from _____ (Name of Bank or Savings & Loan) to _____ (Name of Bank or Savings & Loan)
 I want to transfer my account from _____ (Name of Bank or Savings & Loan) to _____ (Name of Bank or Savings & Loan) and add to my present account with _____ (Name of Bank or Savings & Loan)
 I want to open a new account with _____ (Name of Bank or Savings & Loan) and add to my present account with _____ (Name of Bank or Savings & Loan)
 I want to add to my present account with _____ (Name of Bank or Savings & Loan) and open a new account with _____ (Name of Bank or Savings & Loan)
 I want to transfer my account from _____ (Name of Bank or Savings & Loan) to _____ (Name of Bank or Savings & Loan) and open a new account with _____ (Name of Bank or Savings & Loan)
 I want to open a new account with _____ (Name of Bank or Savings & Loan) and transfer my account from _____ (Name of Bank or Savings & Loan) to _____ (Name of Bank or Savings & Loan)
 I want to add to my present account with _____ (Name of Bank or Savings & Loan) and transfer my account from _____ (Name of Bank or Savings & Loan) to _____ (Name of Bank or Savings & Loan)
 I want to transfer my account from _____ (Name of Bank or Savings & Loan) to _____ (Name of Bank or Savings & Loan) and add to my present account with _____ (Name of Bank or Savings & Loan)
 I want to open a new account with _____ (Name of Bank or Savings & Loan) and add to my present account with _____ (Name of Bank or Savings & Loan)
 I want to add to my present account with _____ (Name of Bank or Savings & Loan) and open a new account with _____ (Name of Bank or Savings & Loan)
 I want to transfer my account from _____ (Name of Bank or Savings & Loan) to _____ (Name of Bank or Savings & Loan) and open a new account with _____ (Name of Bank or Savings & Loan)
 I want to open a new account with _____ (Name of Bank or Savings & Loan) and transfer my account from _____ (Name of Bank or Savings & Loan) to _____ (Name of Bank or Savings & Loan)
 I want to add to my present account with _____ (Name of Bank or Savings & Loan) and transfer my account from _____ (Name of Bank or Savings & Loan) to _____ (Name of Bank or Savings & Loan)
 I want to transfer my account from _____ (Name of Bank or Savings & Loan) to _____ (Name of Bank or Savings & Loan) and add to my present account with _____ (Name of Bank or Savings & Loan)
 I want to open a new account with _____ (Name of Bank or Savings & Loan) and add to my present account with _____ (Name of Bank or Savings & Loan)
 I want to add to my present account with _____ (Name of Bank or Savings & Loan) and open a new account with _____ (Name of Bank or Savings & Loan)
 I want to transfer my account from _____ (Name of Bank or Savings & Loan) to _____ (Name of Bank or Savings & Loan) and open a new account with _____ (Name of Bank or Savings & Loan)
 I want to open a new account with _____ (Name of Bank or Savings & Loan) and transfer my account from _____ (Name of Bank or Savings & Loan) to _____ (Name of Bank or Savings & Loan)
 I want to add to my present account with _____ (Name of Bank or Savings & Loan) and transfer my account from _____ (Name of Bank or Savings & Loan) to _____ (Name of Bank or Savings & Loan)
 I want to transfer my account from _____ (Name of Bank or Savings & Loan) to _____ (Name of Bank or Savings & Loan) and add to my present account with _____ (Name of Bank or Savings & Loan)
 I want to open a new account with _____ (Name of Bank or Savings & Loan) and add to my present account with _____ (Name of Bank or Savings & Loan)
 I want to add to my present account with _____ (Name of Bank or Savings & Loan) and open a new account with _____ (Name of Bank or Savings & Loan)
 I want to transfer my account from _____ (Name of Bank or Savings & Loan) to _____ (Name of Bank or Savings & Loan) and open a new account with _____ (Name of Bank or Savings & Loan)
 I want to open a new account with _____ (Name of Bank or Savings & Loan) and transfer my account from _____ (Name of Bank or Savings & Loan) to _____ (Name of Bank or Savings & Loan)
 I want to add to my present account with _____ (Name of Bank or Savings & Loan) and transfer my account from _____ (Name of Bank or Savings & Loan) to _____ (Name of Bank or Savings & Loan)
 I want to transfer my account from _____ (Name of Bank or Savings & Loan) to _____ (Name of Bank or Savings & Loan) and add to my present account with _____ (Name of Bank or Savings & Loan)
 I want to open a new account with _____ (Name of Bank or Savings & Loan) and add to my present account with _____ (Name of Bank or Savings & Loan)
 I want to add to my present account with _____ (Name of Bank or Savings & Loan) and open a new account with _____ (Name of Bank or Savings & Loan)
 I want to transfer my account from _____ (Name of Bank or Savings & Loan) to _____ (Name of Bank or Savings & Loan) and open a new account with _____ (Name of Bank or Savings & Loan)
 I want to open a new account with _____ (Name of Bank or Savings & Loan) and transfer my account from _____ (Name of Bank or Savings & Loan) to _____ (Name of Bank or Savings & Loan)
 I want to add to my present account with _____ (Name of Bank or Savings & Loan) and transfer my account from _____ (Name of Bank or Savings & Loan) to _____ (Name of Bank or Savings & Loan)
 I want to transfer my account from _____ (Name of Bank or Savings & Loan) to _____ (Name of Bank or Savings & Loan) and add to my present account with _____ (Name of Bank or Savings & Loan)
 I want to open a new account with _____ (Name of Bank or Savings & Loan) and add to my present account with _____ (Name of Bank or Savings & Loan)
 I want to add to my present account with _____ (Name of Bank or Savings & Loan) and open a new account with _____ (Name of Bank or Savings & Loan)
 I want to transfer my account from _____ (Name of Bank or Savings & Loan) to _____ (Name of Bank or Savings & Loan) and open a new account with _____ (Name of Bank or Savings & Loan)
 I want to open a new account with _____ (Name of Bank or Savings & Loan) and transfer my account from _____ (Name of Bank or Savings & Loan) to _____ (Name of Bank or Savings & Loan)
 I want to add to my present account with _____ (Name of Bank or Savings & Loan) and transfer my account from _____ (Name of Bank or Savings & Loan) to _____ (Name of Bank or Savings & Loan)
 I want to transfer my account from _____ (Name of Bank or Savings & Loan) to _____ (Name of Bank or Savings & Loan) and add to my present account with _____ (Name of Bank or Savings & Loan)
 I want to open a new account with _____ (Name of Bank or Savings & Loan) and add to my present account with _____ (Name of Bank or Savings & Loan)
 I want to add to my present account with _____ (Name of Bank or Savings & Loan) and open a new account with _____ (Name of Bank or Savings & Loan)
 I want to transfer my account from _____ (Name of Bank or Savings & Loan) to _____ (Name of Bank or Savings & Loan) and open a new account with _____ (Name of Bank or Savings & Loan)
 I want to open a new account with _____ (Name of Bank or Savings & Loan) and transfer my account from _____ (Name of Bank or Savings & Loan) to _____ (Name of Bank or Savings & Loan)
 I want to add to my present account with _____ (Name of Bank or Savings & Loan) and transfer my account from _____ (Name of Bank or Savings & Loan) to _____ (Name of Bank or Savings & Loan)
 I want to transfer my account from _____ (Name of Bank or Savings & Loan) to _____ (Name of Bank or Savings & Loan) and add to my present account with _____ (Name of Bank or Savings & Loan)
 I want to open a new account with _____ (Name of Bank or Savings & Loan) and add to my present account with _____ (Name of Bank or Savings & Loan)
 I want to add to my present account with _____ (Name of Bank or Savings & Loan) and open a new account with _____ (Name of Bank or Savings & Loan)
 I want to transfer my account from _____ (Name of Bank or Savings & Loan) to _____ (Name of Bank or Savings & Loan) and open a new account with _____ (Name of Bank or Savings & Loan)
 I want to open a new account with _____ (Name of Bank or Savings & Loan) and transfer my account from _____ (Name of Bank or Savings & Loan) to _____ (Name of Bank or Savings & Loan)
 I want to add to my present account with _____ (Name of Bank or Savings & Loan) and transfer my account

Hart Camp News

WILLIE CLIFTON, a resident of this area died last week in Ft. Worth following a heart attack. She had resided in Littlefield for four years. Mrs. Clifton preceded her husband several years ago. She is survived by a daughter, Mrs. Phyllis Clifton, of this community. Walter of Logan, four sisters, one grandchild, 18 children and four grandchildren.

KEVIN YANDELL, son of Mrs. Chester Yandell, is on an assignment at the missile project in Huntsville. Following this assignment he will return to Littlefield.

MRS. RONNIE WHEELER and her children are in the process of moving from Ft. Worth to Littlefield. Yandell has been in the U.S. Army and received his Army discharge and his family here this weekend in Yandell home.

MRS. VICTOR FOSTER is attending funeral for his uncle, Paul Foster, who died Tuesday in the hospital following a heart attack. Foster was retired U.S. Army and buried in military honors. Services were held in Resthaven Park.

MRS. T. J. FOSTER spent Thursday with her brother and sister, Mrs. V. L. Foster and Kimmie. They are in Brownwood on business.

MRS. AUBREY NEINAST died a few days last week. Her husband, Mr. Neinast, died in the hospital and also took treatments. They were home Sunday night.

PARKEY, son of Mr. Dewey Parkey and a Texas A&M student, spent the week vacation here with his parents, Mr. and Mrs. Parkey and sons. He is in A&M Sunday.

LEONARD of the County Junior High School is here this week on his Easter Vacation with his parents, Mr. and Mrs. D. R. Leonard.

MULLER has been in the hospital for several days. His doctor says he is recovering from the illness because of the surgery.

HIGH SCHOOL from Hart Camp that was named as honor roll member for the second quarter. Cindy Neinast, a junior; a sophomore and a freshman.

MRS. PRESTON WHEELER and Curtis Jay are in Houston to visit their daughter in England where they will spend at least a year.

MASON is a research engineer with the Humble and Esso Petroleum Company. Mrs. Mason is the former Phillis Worley of this community.

KIMMIE FOSTER participated in the Idalou Track Meet last Friday. She won third in Shot Put and a third in Discus throw.

MR. AND MRS. SAMMIE WHEELER, Donny and Shelia spent last weekend in Hobbs with Wheeler's daughter and son-in-law, Mr. and Mrs. Eric Johnson.

REVIVAL SERVICES at the Hart Camp Baptist Church ended with the Thursday night services. On Sunday a dinner was held at the church with the entire congregation participating. Preaching throughout the week was Rev. Robert Griffith of Seth Ward Baptist Church in Plainview and Tom Terrell of Edmonson led the singing. He brought several visitors who were talented singers for special music each night. Debbie Mears of Littlefield played the piano.

VISITING in the A. J. Young home this week are Mrs. Young's mother, Mrs. Sadie Collins of Abilene and a nephew, Herrell Jean Collins, also of Abilene.

TUESDAY NIGHT guests in the Aubrey Neinast home were Mrs. Nancy Srygley and son, Tommy of Humble. Both Mr. and Mrs. Srygley are employed as teachers in the Humble school system.

MR. AND MRS. DANNY MEARS of Littlefield spent last weekend with her parents, Mr. and Mrs. Edwin Olivers. Sunday they all attended church at the Hart Camp Baptist Church. The Oliver's son, Kerwin and granddaughter, Lisa of Littlefield visited in the Oliver home Sunday afternoon. Mrs. Kerwin Oliver was in Austin to attend the Spade basketball play-offs.

MRS. BERTA AGNES TALBURT, a long time resident of this community, died Friday at 1 p.m. in Medical Arts Hospital in Littlefield following a lengthy illness. Mrs. Talbert had lived here 48 years before retiring to the Hospitality House in Littlefield because of illness. She was a charter member of the Hart Camp Baptist Church. Her husband, John A. Talbert, died in 1969. Services were held Saturday in the First Baptist Church in Littlefield. Survivors include one son, Johnny of Littlefield, two daughters, Mrs. Clark B. Hill of Fieldton and Mrs. Forrest Lattimer of Olton. Also she is survived by seven sisters, seven grandchildren and one great-grandchild.

MR. AND MRS. GENE LIGHT, Acie and Kandy are moving from Lubbock to Waxahachie where Light will be employed. VISITING in the K. Sorensen home this week are their grandchildren, Fredda McElfresh of South Plains College in Levelland, and Ronnie and Jo Anne McElfresh of Lubbock.

CHERYL STEWART, daughter of Mr. and Mrs. George Stewart, was one of 10 twirlers from Olton entered in the West Texas Pageant contest in West Texas Field House in Canyon on March 15. Cheryl won a 1 rating in basic strutt, a 2 rating in military strutt, a 2 in T strutt. She also was a member of the dance twirl team that won a first place.

BRAD McCARY of Lubbock spent the weekend here with his grandparents, Mr. and Mrs. D. R. Leonard. His, Mrs. Jim McCary came for him on Monday.

SUNDAY AFTERNOON, Mr. and Mrs. D. R. Leonard and Danny visited in Spade with Leonard's brother and family, Mr. and Mrs. Leon Leonard. The Leon Leonards' daughter, Marketta, was at home from Dallas where she is doing her nurse's training at Baylor Hospital.

MR. AND MRS. PAUL HUKILL were in Lubbock on Friday last week for a family gathering in the home of Mrs. Hukill's sisters, Mrs. LaNell Ratliff. Others present were Mrs. Hukill's sister and husband, Mr. and Mrs. Ab Johnston of O'Brien, a nephew, Kenneth Johnston, Amarillo, a niece, and her husband, Mr. and Mrs. Al Downs of Clovis. Also Mrs. Ratliff's daughter, Roxie Ratliff who is an Airline Stewardess out of San Francisco, Calif. Other relatives called in the afternoon.

MR. AND MRS. O. J. NEELEY visited last weekend in Oglesby with Mrs. Neeley's mother, Mrs. J. W. Brewer. Accompanying the Neeley's to Oglesby were their daughter and son-in-law, Mr. and Mrs. Gary Hammer of Abilene.

MR. AND MRS. SAMMY LEE Wheeler were in Hobbs on Friday to be with their daughter, Mrs. Eric Johnson who gave birth to a son in a Seminole Hospital Friday afternoon. The baby was a boy and he is the first child of the couple. He has been named Eric Lee for his father and grandfather. He weighed six pounds 14 ounces. Little Eric Lee is the first grandchild of Mr. and Mrs. Sammie Lee Wheeler. Mr. and Mrs. M. W. Wheeler are the maternal great-grandparents and this is their first great-grandchild.

MR. AND MRS. A. J. YOUNG have a new granddaughter, Kimberly Denise who was born to their daughter and husband, Mr. and Mrs. James Wilmouth on Feb. 11. She has an older sister, Shanna Kaylene, who is three and one-half years old. The James Wilmouth family live in Houston. Mrs. Young spent several days in Houston with her daughter after the birth of the baby.

JOE CADDELL lost a rolling cultivator by theft last Wednesday but the cultivator has been located and returned to the owner.

MR. AND MRS. A. B. JOHNSTON of O'Brien spent the weekend with Mrs. Johnston's sister and family, Mr. and Mrs. Paul Hukill. They returned home Monday morning.



JOHN MOORE, LITTLEFIELD CITY PATROLMAN, looks over a new "mug shot" camera that was obtained through SPAG. The camera was part of a \$752 grant from the Association, which also included a Narcotics and Dangerous Drug Identification Kit. (Staff Photo)



LITTLEFIELD CITY PATROLMAN, Gayle Morgan, left, and John Moore look over a newly-acquired Narcotics and Dangerous Drug Identification Kit. The kit was obtained through the South Plains Association of Governments. Police Chief James Cox said the kit would enable identification of suspected drugs on the spot, rather than having to send the material off for identification. (Staff Photo)

Luncheon Honors Johnny Carden

Mr. and Mrs. Johnny Carden of Littlefield were honored at a luncheon at the Holiday Inn in Plainview Friday, March 28, in recognition of Carden's retirement from the American National Insurance Co., of the Plainview District, after 25 years of service. He was presented a gold watch from the company, and Mrs. Carden received a set of stainless tableware from the Plainview District.

Special guests were their son and Mrs. Ronnie Carden, of Levelland. Others attending were District Manager Mr. and Mrs. J. H. Walker; assistant managers E. G. Nichols and Mr. and Mrs. Bill Landrum; secretaries, Mrs. Donna Burge and Mrs. Dunavan; Agents, Mr. and Mrs. J. D. Vardy, Bill Herrington, Carl Rowell, J. L. Gonzales, all of Plainview; Agents, R. W. Jones of Anton, R. E. Griffith of Hart, Mr. and Mrs. C. C. Holt of Muleshoe, Sam Hunley of Abernathy and T. J. Reed of Littlefield.

Reed will now serve as agent in Littlefield and Amherst.



MR. AND MRS. JOHNNY CARDEN

Miss Lawson In Dominican Republic

SPRINGLAKE— Judy Lawson, niece of Mrs. Jettie Lawson of Olton, is doing student teaching in the Dominican Republic. Judy's parents are Mr. and Mrs. Tom Lawson, Pleasant Grove, Ala.

Miss Lawson received her degree from Auburn University March 18 in Absentia. She is teaching in a private school where the students are of rich families who send them to school in cars driven by chauffeurs. Most families have three maids, one who attends the children, one who cooks and one who is housekeeper. Miss Lawson has a personal maid.

Her host family, which is from England, has as members the father, a professional scuba diver, and his wife who is working on her PhD in medicine. They have two children.

She writes that most of the people in the Dominican Republic are extremely poor and many search for food in garbage. Beggars are numerous. The people are not wasteful but use every bit of the food for example, chicken feet with toe nails included, in a stew.

Miss Lawson wrote "The principal warned me that if politics is mentioned in class, I do not comment, change the subject, immediately and play dumb and indifferent. She wrote police are not allowed on the university campus but surround it with machine guns in case of revolts and uprisings, thus prohibiting students from leaving the campus and involving others.

She said "It is not uncommon to see a policeman with machine guns at restaurants and other public places."

She said there are no drug or race problem in the Dominican Republic, which is some 700 miles southeast of Florida between Cuba and Puerto Rico.

For additional information, contact Brooks Motors, or call 512-625-9642.

Antique Cars To Go On Sale

Approximately 100 antique and classical cars collected from around the state and beyond will be on display and sale Sunday, April 6, at 10 a.m. as the Grand Springtime Antique and Classic Auto Auction gets under way at Brooks Motors, 921 S. Seguin, New Braunfels.

Old cars will be sold at the auction on consignment from collectors. Admission tickets to the grounds are available to the public at the gate.

Public viewing of the autos will also be the preceding Friday and Saturday from 9 a.m. to 8 p.m.

KIRBY VACUUM CLEANERS

Sales & Service
PAT'S RECORD CENTER
APPLIANCE DEPARTMENT

JCPenney

BIG CLOSEOUT SALE

BIG CLOSEOUT SALE

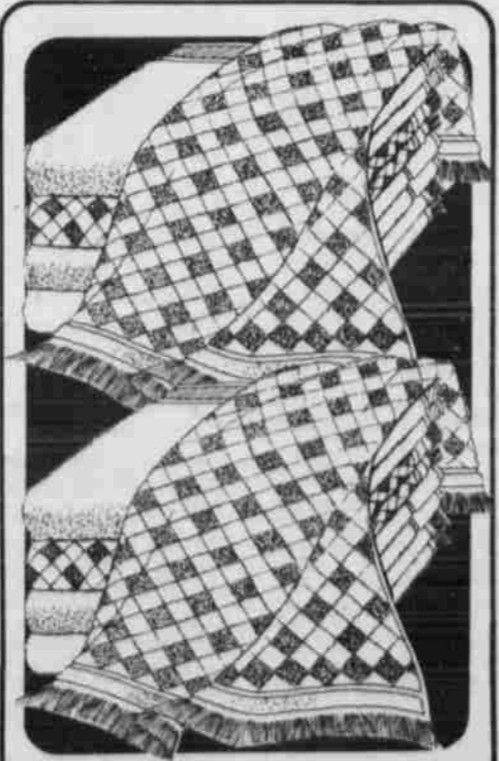

Save 40% to 50% on shower curtains. Now 2.99

Orig. 4.99. 70x72". Country Gingham check shower curtain of semi-opaque vinyl. In assorted colors. Vinyl window curtain, orig. 4.99, Now 2.99

Now 1.99

Orig. 3.99. 70x72". Floral print 'Heritage' shower curtain of easy-care vinyl. 45" vinyl window curtain, orig. 3.99, Now 1.99

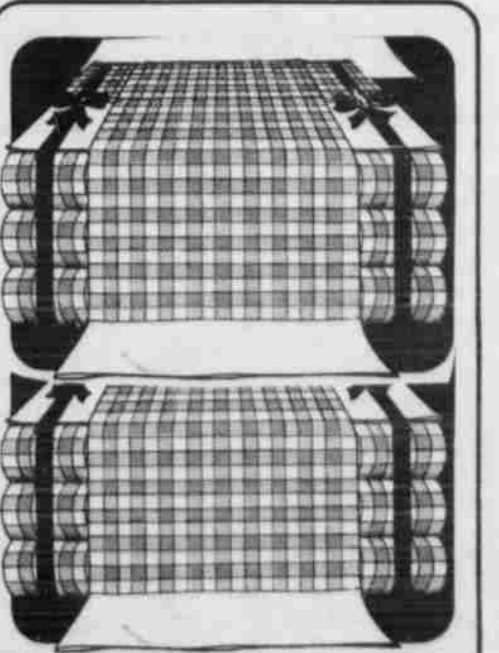

BIG SAVINGS ON THESE BEDSPREADS

NOW 9.88 TO 14.88

Orig. 13.90 to 40.00. Twin and full size bedspreads. Fitted and throw styles, including quilted prints and fringed woven jacquards. Also quilt throw styles in prints and patterns.

30% to 40% off checked sheets.

Now 2.17 Twin size orig. 4.29

Full size, orig. 5.29, Now \$3.47
Queen size, orig. 9.29, Now \$5.97
King size, orig. 11.29, Now \$7.97
Pkg. of 2 standard pillowcases, orig. 3.79, Now \$2.47
Stock up now and save on our country-look 'Gingham Check', easy-care polyester/cotton muslin that never need ironing. In a bright assortment of colors. Flat and fitted sheets are the same price. Queen and king size cases also on sale.

BIG SAVINGS ON FULL SIZE

BED PILLOWS 2 FOR 4.88

100% polyester fill bed pillows at big savings. Use your Penney Charge.

33% to 40% off checked towels.

Now 1.66 orig. 2.79 bath towel, orig. 1.69, Now 1.06 Wash cloth, orig. 99¢, Now 66¢

If you thought our 'Checkmate' towels were a great buy before, wait 'til you see how they check out now. Soft, absorbent cotton terry jacquard weave ensembles at terrific 33% to 40% off last December's prices. In an assortment of decorator colors that coordinate with the JCPenney Home Color Collection. So hurry in, stock up and save.

USE YOUR PENNEY CHARGE

LITTLEFIELD, TEXAS

SHOP CATALOG PHO. 385-5166

MARCUM OLDS-CADILLAC
announces the opening of their
Body Shop
Vinyl Tops *Glass Installation
Complete Paint & Body Repairs
801 Hall Ave. 385-5171

We Will Be Closed Sunday For Inventory

GIBSON'S DISCOUNT CENTER
WHERE YOU ALWAYS BUY THE BEST FOR LESS

EDITORIAL

Leukemia And Hope

LEUKEMIA IS STILL a word that strikes fear, especially among parents of young children. Understandably, since cancer, next to accidents, is the greatest cause of death among children under 15. Half of these deaths are from leukemia, or cancer of the blood-forming organs of the body.

That is one reason why the American Cancer Society has devoted so much of its research funding to leukemia. Together with related lymphomas the Society devotes more than \$3,000,000 a year to the research attack against this type of cancer.

TODAY THE SITUATION is radically different from what it was not many years ago. There is good reason for hope and optimism.

With a proper use of a combination of drugs, in many medical centers 90 percent of all acute lymphocytic leukemias can be put into remission.

Most doctors won't use the word "cure" as yet, but there are many cases of leukemia patients who have lived normal lives free of all symptoms years after treatment.

WHAT CAN YOU DO if leukemia strikes in your family? The American Cancer Society Unit in your community has a list of more than 80 medical centers throughout the United States providing highly effective treatment for leukemia. They will not turn away any patient.

The fight against leukemia, both in research and in treatment, is a vital part of the crusade against cancer.

4 Defendants Draw Sentences

Four persons set to be tried in district court this week waived jury trials and entered pleas of guilty before District Judge Pat Boone Jr.

Brownie M. Martinez who was charged with arson waived trial by jury and pleaded guilty to the charge. He was sentenced to 10 years, probated.

Gilberto Ortega Gonzales, charged with felony possession of marijuana over 4 ozs., waived a jury trial and entered a guilty plea. Gonzales was found guilty and sentenced to three years, probated.

Freddie Trevino who was charged with burglary of Sudan schools waived a jury trial and pleaded guilty before

Judge Boone. He was found guilty and sentenced to four years, probated.

Ignacio Martinez Rendon waived a jury trial and entered a guilty plea to a charge of aggravated assault. He was found guilty and sentenced to four years, probated.

Jurors called for duty Monday were dismissed.

At press time Wednesday, jurors were to report. Set for trial were Rosie Linda Garcia and Mary Hernandez Huerta, charged with theft by shoplifting from Anthony's.

Twelve civil cases are set for trial next week.

Heart Board Conducts Meet

The Board of Directors of the Lamb County Division of the American Heart Association met Thursday, March 27, at the Tasty Taco, with vice-president, Janice Sebring, presiding.

Minutes were read by Carole Faver and were approved.

A change of meeting time was discussed and members decided to meet in the evenings on the fourth Thursday of every other month, with the executive board continuing their monthly meeting.

A report was given on the progress of the Heart Fund Drive and the board

decided to sponsor two fund raising projects in the near future. The board also discussed the purchasing to resusanniens for the Lamb County Division. These annies are used in teaching CPR. Other committee reports were also given.

Those attending were Janice Sebring, Carole Faver, Billy Moore, Jeni'D Brunson, Evone Oliver, Kay Kendall, Mary Johnson, regional director from Lubbock and guest Don Bell.

The next meeting will be the annual meeting to be held April 15th.

Commissioners Act On Short Agenda

The Lamb County commissioners court acted on a short agenda in the end-of-month meeting Monday.

The teletype project for the county sheriff's office was extended for another year. Lamb County pays 40 percent of the \$178 per month, with SPAG paying 60 percent of the monthly costs.

Jodi Maxwell of Sudan was approved as assistant county librarian. She

replaces Dorothy Spencer who resigned last month.

Filling mortar cracks in the county courthouse was discussed but no action was taken. Setting a bounty for coyotes was discussed, but commissioners did not take action.

In another matter, the court approved the closing of county offices in the courthouse on April 22, the day for the constitutional amendment election.

OBITUARIES

HENRY CALDWELL
Funeral services for Henry Caldwell Jr., 44, of Lubbock, who died Thursday, March 27, in West Texas Hospital, were conducted Monday afternoon in the Faith First Baptist Church with Rev. G. B. Coleman, pastor, officiating.

Burial was in Peaceful Gardens Cemetery under direction of South Plains Funeral Home.

Caldwell was a farm laborer.

Survivors include his wife Essie; a son, Renza Caldwell of Lubbock; a daughter, Mrs. Barbara L. Brown of Lubbock; his father, Henry Caldwell Sr. of Arp; his mother, Mrs. Juanita Brown of Lubbock; eight brothers, Ralph and Shorty both of Tyler, Lonnie of Dallas, Charlie of Fort Worth, William of Midland, J. D. of Plainview, David of Lubbock and Rufus of Amarillo; five sisters, Mrs. Ila Mae Cary of Olton, Mrs. Lou Anna Patterson of Pasadena, Calif., Mrs. Juanita Brown and Mrs. Jimmie Ann Johnson both of Long Beach, Calif., and Mrs. L. M. Williams of Tyler; and three grandchildren.

Emanuel of El Reno, Okla.; a sister, Mrs. Eli Northcutt of Muleshoe; seven grandchildren and four great-grandchildren.

The family requests memorials be made in the form of donations to the Muleshoe Nursing Home Auxiliary.

ALTON MERRELL
Services of Alton B. Merrell, 69, of Lubbock were conducted Monday afternoon in Monterey Church of the Nazarene with Rev. Bill Childs, pastor, and Rev. Michael Summers, pastor of the First Baptist Church of Sudan, officiating.

Interment was in Resthaven Memorial Park with Franklin-Bartley Funeral Home handling arrangements.

Merrell, a native of Irene, lived in Lubbock 20 years. He was a member of the Monterey Church of the Nazarene.

He died at 2:50 a.m. Saturday at Methodist Hospital following a short illness.

Survivors include his wife, Mattie; two daughters, Mrs. Vernon Reed of Lubbock and Mrs. Bob Taylor of Sudan; two sons, Bobby Zinn Merrell of Big Spring and Marvin Edwin Merrell of El Paso; two sisters, Mrs. Cecil Johnson of Littlefield and Mrs. James Shaw of Port Arthur; three brothers, Maurice Merrell of Rolling Hills, Calif., Burns Merrell of Lubbock and Bayne Merrell of Pecos; and 13 grandchildren.

MAGGIE EMANUEL
Services for Mrs. Maggie M. Emanuel, 82, of Muleshoe were conducted Monday afternoon at Singleton-Ellis Chapel in Muleshoe.

Rev. V. L. Huggins, pastor of Trinity Baptist Church, and Rev. A. J. Kenemer, pastor of the First Baptist Church of Littlefield, officiated.

Burial was in Littlefield Memorial Park under directions of Singleton-Ellis Funeral Home.

Mrs. Emanuel died at 8:40 a.m. Sunday in West Plains Memorial Hospital.

She was born Jan. 19, 1893, in Vashti, Tex. A resident of Muleshoe three years, Mrs. Emanuel moved there from Littlefield where she had lived since 1942. She was a member of the First Baptist Church of Littlefield.

Survivors include a daughter, Mrs. Ernest Brock of Muleshoe; a son, Allen

WELDON MOORE
Services for Weldon Truett Moore, 66, of Plainview, were conducted Monday morning at Wood-Dunning Colonial Chapel in Plainview with Rev. David Ebert, pastor of St. Paul's Lutheran Church of Plainview, officiating.

Burial was in Olton Cemetery under direction of Wood-Dunning Funeral Home.

Moore died at his home at 10 p.m. Thursday, March 27, following a two-and-one-half-year illness.

Born at Merkel in Taylor County,



CLIPS & TIPS

By JOELLA LOVVORN

I CAME ACROSS this news item about allergies, written by Dr. J. E. Peavy, M.D., Commissioner of Health for the Texas State Department of Health. It has some good information for you.

IF YOU SNEEZE and sniffle during the ragweed season, if you have cramps, diarrhea, or rash after eating a particular food or drug, if you wheeze or itch when around a cat, a horse, chicken feathers, or some other substance—then you may be suffering from an allergy.

An allergy is an unusual reaction to a substance, an abnormal behavior of the body to it. Half of the people in the world sneeze or sniffle, wheeze or itch, suffer intestinal disturbances or other uncomfortable symptoms because of their allergies. Half of the adult population in Texas and one-third of our children are afflicted, say state health officials.

In some it occurs only at certain seasons of the year, in others it is a daily problem.

When the allergy-producing substance enters your system and comes in contact with the antibodies in the cell, that union produces dramatic effects. The best known of the results of these miniature explosions is the release of the chemical histamine from the cell. Normally, presence of histamine stimulates production of adequate amounts of antihistamine which would of course cause no symptoms to develop. Sometimes enough antihistamine is not produced to counter the levels of histamine.

Histamine is perfectly harmless when inside the cell, but once released outside the cell it produces undesirable changes. It dilates and congests blood vessels so that fluids from your blood stream leak out into the tissue, causing swelling.

If this change takes place in the skin the result is hives. If this reaction occurs in the nose, the membrane swells and you have a condition known as hay fever or "sinus." Another action of histamine

Moore moved to Plainview from Las Cruces, N.M., in March, 1974. He was an office supply salesman and a member of St. Paul's Lutheran Church.

He married the former Rosella Sunde Feb. 12, 1932, at Sioux Falls, S.D.

Survivors include his wife; three sons, Donald E. Moore of Palo Verde, Calif., Dean L. Moore of El Cajon, Calif., and Merton L. Moore of San Antonio; a sister, Mrs. G. E. Ragle of Plainview; two brothers, J. Fay Moore of Hart Camp and Grady of Sante Fe, N.M.; and eight grandchildren.

ARLIE H. VINCENT
Services for Arlie Homer Vincent, 77, of Anton, were conducted Wednesday afternoon at Lawrence Street Church of Christ of Anton.

Officiating were Ed Lobough, minister, Alvin Mitchell.

Burial was in Lubbock's Resthaven Memorial Park.

Hammons Funeral Home of Littlefield is handling arrangements for Vincent, who died at 8:30 a.m. Monday in Littlefield Hospital.

A native of Collin County, Vincent had been an Anton resident 33 years. He was a retired bookkeeper. He was a member and deacon of the Lawrence Street Church of Christ at Anton.

He married the former Alta Henington at Trenton in 1917.

Survivors include his wife and several nieces and nephews.

is to contract or put into spasm involuntary muscle fibers—muscles not controlled by your own will, such as stomach, intestine, urinary bladder, or the uterus. If this muscle effect takes place in the muscle fibers around the bronchial tubes, asthma is the result; if in the intestine, cramps and diarrhea may be the effect.

At least one in three Texans who have untreated hay fever will develop asthma, says state health officials. In many cases, seasonal asthma may fail to subside with the end of the season and may become chronic.

Among the most common forms of respiratory allergy is "pollinosis"—a respiratory reaction to pollens. Tree pollens cause trouble from about the middle of March to the middle of May, grass pollens from May to August, and ragweed pollen from approximately the middle of August to October. Because they come in direct contact with the tissues, only small amounts of pollen are required to produce symptoms.

The severity of hay fever varies in different parts of the country, from season to season and day to day. It is largely dependent on the weather condition during the growth of the plant, and the temperature, humidity, sun shine and wind velocity during pollination time.

Molds commonly grow on plant life, and the seeds (or spores) are microscopic in size, many of them being even smaller than pollen. The kinds of molds which produce hay fever and asthma are particularly prevalent on grains, such as wheat, oats, rye and corn. Next to pollen, molds are the most common causes of seasonal hay fever and asthma.

Then there is contact dermatitis. If you go for a hike in the woods you may suffer an inflammation of the upper layers of the skin, varying from redness to blisters and also accompanied by itching. It is an allergy caused by direct contact of the causative substance. Poison ivy is not a poisonous plant. No one is affected by it the first time he touches it. Only on subsequent exposure does an allergy show up in about half or more of the persons. But many other plants and common substances in use in the house can produce this disease.

Three factors may play a part in the production of allergic illness. Susceptibility is one. Only certain people have the ability or the background to become allergic. Granting you have this background, you still must become sensitized to a special substance and then be re-exposed to it. If you avoid either of these steps, you will have no allergic illness. A third factor is what might be called contributing factors. Various conditions—temperature, chemical irritants, dust, emotional disturbances, etc.—may aggravate allergies or trigger their attacks. But by themselves they do not cause allergic symptoms.

If there is a family history of an allergy either on the father's or mother's side, then the disease frequently manifests itself in the offspring. But the allergy they develop will not necessarily be the same type as their parents'.

Specific allergy tests can be given by your doctor to discover the substances to which you are reacting. Specific desensitizing treatment may be given to build up immunity gradually. Prevention and avoidance of the offending substance, if possible, is the most effective means of dealing with an allergy.

THE ABUNDANT LIFE

No Pettiness

IT DOES MAKE A DIFFERENCE whether or not we are inclined to "pettiness" in our thoughts and actions. We can be very diligent about what we consider the "big" things, and let a disposition toward "pettiness" (small-mindedness) spoil what might otherwise be a very effective life.

Much of our best intentions, hard work and potential accomplishment can be nullified by "our pettiness".

THE DISRUPTION of pleasant associations can be caused by any one of a number of unnecessary and undesirable attitudes, and "pettiness" is one of the very worst offenders.

All of us dislike this, when it is the manifestation which dominates the behavior of others in their reaction or their response to us.

In our own behavior, we may not always recognize it, or admit it; if we do recognize it. Regardless, it can just about offset every good quality in our character and personality. We must make sure that there is "not pettiness" in our thoughts and actions.

"PETTINESS" CAUSES untold difficulties in the ordinary, routine and commonplace living experiences. It short-circuits much of the energy, the peace, the joy, and the satisfaction that we could know; if we would just try harder to rise above that which is "little" and "petty".

In fact, it is amazing; almost unbelievable, that something like "pettiness" can discolor so much that is wholesome; and, in some instances, it can completely spoil everything.

IF THIS HURTFUL ATTITUDE and manifestation were confined to the situations, in which its damage was just

person-to-person, it would be fortunate enough, but it is not possible.

It is just as likely to be the attitude of the people who make up the administration that affect multitudes of "big" places apply to everybody, and "pettiness" found, is harmful to all people be involved.

IN PERSONALITY SIDERATIONS, "pettiness" that most nearly resembles and disliked flaws which are as infantile, self-centered expressions.

It probably does as much to the individual as any other trait; it may do more to any other perverse character.

If there is any one area of action, in which we are "pettiness", this is a guard against which we should guard.

In fact, we must find a way to make the indicated correction instabilities which can make our personal effectiveness possible.

THE DISTORTION of the corruption of our honest dissipation of our life force of the hurtful influences ourselves be controlled by

MORE THAN A PERSONAL flaw, "pettiness" is a sin in the individual life structure. Therefore, our aim must be "pettiness".



HOMINY GRITS

By CORNBALL

"SA WAY IT GOES! I leave town for a couple days, and the whole situation goes to pot!

Not only does the wind sand down everything in sight, the freeze gathers my fruit, and Lake Brownwood has the most unseasonable weather of the last ten years. A vent pipe is missing from a waterheater in one of the apartments, a couple of newly-wed birds set up housekeeping in the dryer vent, causing the dryer to take the day off, (and the better half to lose her lovely disposition) and, now, Turn Row has BOTH feet in his mouth!

THEN I'M FACED with making up my mind on the upcoming elections and whether or not to go ahead and file my income tax. And on top of all this, it seems that every Motor Vehicle Inspection sticker in Lamb County (I work at an inspection station) has expired!

Next time I leave town, guess I'd better leave someone in charge.

WE ARE A spoiled people anyone is satisfied with one of these United States. And why doing about it? Yelling to the government for SOMETHING!

One wonders whatever became enterprise, and self reliance been babied and supported brother so long that we don't know how to do for ourselves.

BUT THEN, WE still blame government to blame for our life. How do you teach a youngster himself, when he's been lapdog life.

READ SOMEWHERE that men usually make the best of life.

THEN, what on earth are you for Heavens sake?

Turn Row COMMENTS

By EMIL

I JUST DON'T KNOW how to start this column. All I can think of is how you people turned out and offered assistance to the tornado-stricken community of Lafors.

The people who started the drive, were hoping to get maybe a pickup load of items. Instead, they took a boatload of items. Instead of this was appliances, two pickup loads of clothing, furniture and food, two trailers, a station wagon and a car. I'm sure that there would have been quite a bit more if a little more notice was given and the weather had been a little more cooperative. I've been told that many people took items in dividually.

The people at Lafors were grateful and couldn't believe that a community as far as Littlefield and the area would help them.

People from all walks of life and nationalities answered the call. Not only from here inside the limits of Littlefield, but also in the rural areas and some of the surrounding communities—Anton and Amberst—just to name a few.

I'd like to call names as to who helped, but so many helped and I know if we started with a series of recognitions, I'm sure several would be left out.

I would like to say that many of the people who worked are some of the same people who are always working behind the scenes to make things happen here in Littlefield. Again from the people in Lafors, Thank You.

SPOTTED THIS IN The Ranganman's Journal:

"Livestock are animals that are bred in the western states to keep the producer broke and the buyer crazy. Livestock are born in the spring,

mortgaged in the summer, paid the fall, and given away in the spring.

They vary in size, color and weight is called a livestock business man by his banker.

"The price of livestock is determined by consumers, and goes up if you have sold and down after you bought."

NOTICED OLE CORNBALL from under his shell after I said that Texas should be divided into five different states.

LONG RANGE WEATHER FORECAST... The second year of drought should end this year. It's somewhat of a repeat performance of the 50's and the 30's. But I believe most of the dry weather will be in northern portion of the middle states.

IF ALL THE GOOD intentions of the world were put end to end, they still get us nowhere.

LAMB COUNTY LEADER-NEWS
ESTABLISHED IN 1903
Lubbock County, Texas
Published by JOELLA LOVVORN
Subscription Rates: \$1.00 per year in advance, \$0.50 per copy.
Single Copies: 10¢
Advertising Rates: See back page.
Second Class Postage Paid at Littlefield, Texas
Postmaster: Please send address changes to: LEADER-NEWS, P.O. Box 100, Littlefield, Texas 79401.



Now OPEN SUNDAY

9:AM TO 7:PM

WE RESERVE THE RIGHT TO LIMIT QUANTITIES.



TOMATO & PEPPER PLANTS
EACH **2 FOR 29¢**

ORANGES
JUICY, FRESH
5 LB BAG **89¢**

6 FOR \$1

CORN GOLDEN EARS EACH
CARROTS 1 LB CELLO BAG **26¢**

LETTUCE FRESH SALAD HEADS, LB **25¢**

POTATOES ALL PURPOSE RUSSETS 10 LB BAG **69¢**

RIB STEAK FURR'S PROTEN LB **\$1.09**

CHUCK STEAK LB **89¢**

RANCH STEAK FURR'S PROTEN LB **98¢**

SHORT RIBS FURR'S PROTEN DELUXE BAR B QUE LB **59¢**

CHUCK ROAST LB **79¢**

TURKEYS JUNIOR SIZE HENS USDA GRADE A, 6-9 LBS **69¢**

ROUND STEAK Furr's Protén, Lb **\$1.09** **HOT LINKS** Lb **89¢**

SIRLOIN STEAK Furr's Protén, Lb **\$1.09** **CHOROIZOS** Lb **79¢**

T-BONE STEAK Furr's Protén, Lb **\$1.49** **BEEF LIVER** Lb **39¢**

CLUB STEAK Furr's Protén, Lb **\$1.39** **TRIBE** Lb **25¢**

SOUP FOOD CLUB CHICKEN RICE NO. 1 CAN **5 FOR \$1**

CANNERS MACARONI & CHEESE, FOOD CLUB, 7 1/4 OZ. **4 FOR \$1**

SAUCE HUNT'S TOMATO 8 OZ CAN **6 FOR \$1**

TOMATOES HUNT'S 14 1/2 OZ CAN **3 FOR \$1**

APPLE SAUCE MUSSELMAN'S NO. 303 CAN **3 FOR \$1**

MEAT FOOD PUSS 'N BOOTS 25 1/2 OZ CAN **3 FOR \$1**

TOWELS TOPCREST LARGE ROLL **2 FOR 89¢**

DE 10¢ OFF LABEL 49 OZ BOX **\$1.15**

ETERGENT GAYLORD PINK LIQUID FOR DISHES 22 OZ. **39¢**

Hunt's Tomato 12 Oz Can **51¢** **KETCHUP** Hunt's 14 Oz **39¢**



CASCADE DISHWASHER DETERGENT 35 OZ **\$1**

OXYDOL 171 OZ BOX **\$3.99**

☆ YOU PAY THE LOWER PRICE AT FURR'S
☆ WE WILL NOT CHANGE A PRICE ON A MARKED CAN OR PACKAGE EXCEPT TO LOWER THE PRICE.
☆ ONCE PRICED... ALWAYS PRICED.

COFFEE CREAMER FOOD CLUB NON DAIRY 16 OZ **99¢**

TOWELS CHIFFON ASSORTED PRINTS ROLL **49¢**

SPINACH Food Club No. 303 Can **4 For \$1**

SPRAY & WASH Texize 16 Oz **\$1.18**

STA PUF Fabric Softner 1/2 Gallon **87¢**

COUNTRYSTONE Acapulco & Spice DINNERWARE



this weeks feature... **SAUCER** EACH **59**



NO PURCHASE REQUIREMENT Good thru 4-9-75 **COMPLETER ITEM BEVERAGE SERVER** \$6.99

Frozen Food Favorites

ORANGE JUICE GAYLORD 6 OZ FROZEN **5 FOR \$1**

POT PIES TOP FROST, BEEF, CHICKEN, TURKEY, MAC & CHEESE, 8 OZ. **29¢**

POTATOES Gaylord, Fresh Frozen, Shoestring, 20 Oz Pkg **4 FOR \$1**

WAFFLES DOWNY FLAKE, HOT & BUTTERY, 12 OZ **58¢**

YARD & GARDEN TOOLS

THRIFT VALUE BOW RAKE 14 TEETH \$2.99

THRIFT VALUE GARDEN HOE HEAVY SHANK PERMANENT WELDED TO SHARP 6 1/2" BLADE 4-FT. HANDLE, EA. \$2.49

THRIFT VALUE HOMEOWNER'S SHOVEL BLADE SIZE 7 1/2" X 10 1/4", 16 GA. STEEL, EA. \$2.99

TOPCO CHARCOAL BRIQUETS 10 LB BAG **99¢**

SINE-OFF SINUS TABLETS 24'S **73¢**

BABY BOTTLES SEVENFLO PLASTIC COMBINATION 8 OZ **33¢**

HAND LOTION SUE PREE 16 OZ SIZE **48¢**

BATH OIL BEADS CALGON 16 OZ **\$1.49**

HEMORROID OINTMENT PREPARATION H 2 OZ SIZE **\$2.89**

SHOP Furr's MIRACLE PRICES

TO	PLACE	YOUR	LOW	COST	WANT	AD	DIAL
3	8	5	-	4	4	8	1
WANT	ADS	GET	RESULTS	IN	LAMB	COUNTY	NEWS

Rates on CLASSIFIED ADVERTISING are 10 cents per word 1st insertion (\$1.50 minimum charge) and 6 cents per word 2nd insertion (\$1.00 minimum charge). Blind box ads are \$1.00 additional. DISPLAY CLASSIFIED RATES: \$1.40 per column inch first insertion and additional insertions, \$1.15 per column inch.

Card Of Thanks—1 time—maximum of 20 words, \$1.50. All cards of Thanks over 20 words are to be charged at regular classified rates.

DEADLINES: Noon, Friday for Sunday, noon Tuesday for Thursday, Too Late to Classify Ads will be taken later if at all possible. Please check ad carefully the first time it appears. In event of error, the News will not assume responsibility for more than one incorrect insertion.

Readers are cautioned to investigate thoroughly any advertiser whose ad requires schooling paid for by the reader or an investment as a condition of employment. This Newspaper does not knowingly accept Help-Wanted Ads that indicate a preference based on age from employers covered by the Age Discrimination in Employment Act.

Help Wanted

Good Job
For Littlefield Area

Route Salesman
Retail route sales, permanent position. Live in Littlefield, 5 day week. Mon-Fri. Employee group life and hospitalization plan. Profit sharing, vacation. Earn more, not limited by hourly or monthly salary. Equal opportunity employer.
Bell Dairy Products
201 University
765-8833
Lubbock, Texas

Wanted

HORSESHOEING and trimming by graduate farrier. Contact Macha, 385-5780. TF-M

CUSTOM Farm work-breaking, listing, discing, treflating, fertilizing. Phone Leroy Davis 385-3253 or Littlefield Butane, 385-3010. TF-D

Will buy clean furniture and appliances, also antiques, dolls and furniture. 385-5979, 385-3714. TF-Y

WILL DO underground repairs on water pipes. Reasonable. Contact 262-4742. 4-27 N

HAVE TRACTOR, will travel. Would like to do garden work. Will plow to suit you. Call 385-4263. 4-6 C

Misc.

BACK IN service doing well work, pump sales. Also cess pool pumping. Warren's Well Service, Needmore, 946-3612. 5-29-W

OLD PHOTOGRAPHS copied and restored. Bring your photographs in for an estimate. Roberts Studio Fine Photography, 203 W. 3rd St., Littlefield, Tex. TF-R

FOR RENT: 18 ft. self contained travel trailer, complete, ready to go. \$100 week or \$17.50 day. Call 385-6079 or 720 E. 14th. TF-N

Apts. For Rent

KITCHENETTE for rent. Crescent Park Motel, 385-4464. TF-C

Pork May Be Short
A 15% decrease in pork production this spring is forecast by the USDA. The cutback is due largely to high feed prices and other rising costs.

NOTICE

HAVE SEVEN bottom breaking plow and packer, will leave smooth enough to list, can break 4 acres an hour, 12 or more inches deep. Also big ox (17 chisel), listing (eight row), treflan applications, or anything else. Call Don Bell, 385-5816 or 385-3620. 4-17-B

NOTICE: Senior citizens mini bus. Littlefield area every Fri. Call 385-5425. TF-S

Motorcycles

GRIMES KAWASAKI. New and used motorcycles. Full line of parts and accessories. Factory trained technicians. Repair done on all kinds of motorcycles. Levelland Hwy. 385-3049. TF-g

1974 Harley-Davidson sportster motorcycle. Excellent condition. Call 385-5181 for Steve. TF-W

Real Estate

Lamb Co. 160 A. 2-8" wells underground pipe. Natural gas line, good heavy soil for corn or milo, all minerals. Good terms. Call Ed Elliott, Goodacre-Day Mantooth, 792-2128 or 795-2810, Lubbock.

Houses For Sale

BEAUTIFUL brick, 3 bedroom, separate den and living room, fireplace, eight closets, refrigerated air, covered patio, outdoor grill and storage house. 385-5795 or 385-3366. 2-2-L

BY OWNER, in Whitharral, 2 bedroom, within walking distance of schools. Just repainted. Fenced backyard. Good water well, garage. Central heat and cooling. Located on Highway 385. See to appreciate. Call 299-4541 or 894-4541. 4-3-B

VA OR FHA approved for \$9850. Completely remodelled, new carpet, heater, air conditioner, garbage disposal, attached garage. 614 Duggan, Anton, Tex. Call evenings or early morning 997-3501. TF-W

2 bedrooms and bath, near downtown Littlefield. Call 832-4429. 4-6-D

FOR SALE, 3 bedroom brick, 2 bath, excellent location, fenced back yard with storage house. Call 385-6108. TF-J

Personal

LOSE WEIGHT safely and fast with X-11 Diet Plan, \$3.00. Reduce excess fluids with X-Pel \$3.00. Brittain Pharmacy, 430 Phelps, 385-5114. 5-4-B

Beauty By Mary Kay Call: Freddie Duke 385-5064

Bus. Services

Will build re-enforced concrete cellars. Redi-built houses. H. G. Ferguson, 385-5508. 4-6-F

TREWAX rug shampooer for \$2. per day. Harrell Building Supply, Anton.

MATTRESSES complete renovating. New mattresses & box springs, any size. Call Mrs. Claude Steffy, 385-3386, agent for A&B Mattress Co., Lubbock, Tex. TF-S

ROOFING

LITTLEFIELD ROOFING
All types built-up asphalt roofs. Composition shingles. All work guaranteed. Call Ron Foshee, 385-5680, Littlefield, Texas.

Bus. Services

Coming to Lubbock? T.V. need repair? Same day service on most sets in by noon. Bring, pick-up and save 10 percent on sales and service. Authorized Zenith warranty service. Ray's TV and Appliance, 2825 34th, Lubbock, 795-5566. TF-R

RENT CONVALESCENT

equipment at Brittain Pharmacy. Wheel chairs, crutches, hospital beds, other items. Complete line convalescent needs. TF-B

Sewer stopped up? Let us unclog your sewer line with our Roto Rooter Service. Harrell Building Supply, Anton, 997-3621. TF-H

INCOME TAX Service for farmers, businessmen or individuals. Free pickup and delivery within five miles. Reasonable rates. Send name, address and phone number to "Mr. Taxman", Box 822, Littlefield. You will be quickly contacted. 4-15-T

MONUMENTS: Order now for Memorial Day. See or call Toby Walker, 1407 Nichols, 385-3539. 5-1-W

KEEP carpet cleaning problems small—use Blue Lustre wall to wall. Rent electric shampooer \$1. (Nelson's Hardware)

CONKLIN IS HERE. Try some. Maintenance, lubrication, cleaning supplies. Farm, business, industry and home. Ray Reed, Sales and Service, 385-4964. 5-9-C

MARTIN ROOFING

Roofing Specialists
Roofing of all kinds
Asphalts of All Kinds
Asphalt Built-up Roofs
All Work Guaranteed
Littlefield
1115 W. 9th
385-3507

Industrial BEARINGS & BELTS

Forney Welders & Supplies
*Farm Equip.
*Industrial Equip.

G & C AUTO SUPPLY
700 E. 14th 385-4431

CARPET

Shop at home and save. Hi lo plush shags, multicolor shags, hi lo shags, level loop tweeds, pattern and tweeds in bath and kitchen carpet and commercials. Installation guaranteed to satisfy. Call for samples and free estimates. 385-4953 or 385-6194. J. C. & Bill Duncan.

CAPROCK PROCESSING INDUSTRIES

Abernathy, Texas
Free Dead Stock Removal
7 Days A Week
Serving The Cattle Industries
Since 1963
Phone 298-4198
Nights: 298-4083 or 757-2562

Too Late To Classify

FOR SALE by owners: 1-3 bedroom and 1-2 bedroom on large corner lot. Property address 401 Sunset, total \$5,000. Deed and abstract furnished. Call after 6 p.m. 272-4812, Muleshoe. 4-13-C

FURNISHED trailer house for rent, on Westside. Call 385-3366. TF-L

Lost

LOST: Part Chihuahua, brown, black and white. 10" tall, answers to name of "Honey". Lost in vicinity of E. 12th. 385-6030

Misc For Sale

ACRES AND ACRES of new and used aluminum pipe and fittings 4" through 8" sprinkler line, flowline, mainline and gated pipe—Side roll sprinklers and PVC plastic pipe, State Line Irrigation Inc., Levelland, Muleshoe and Littlefield, Tex. Contact T.L. Timmons at 806/385-4487. 4-10-S

TWO 1200 ft. lateral roll sprinkler systems, with 5 ft. wheels, 18 months old. 262-4081. TF-S

9 x 12 camping tent with floor and screen windows. Call 246-3447. TF-H

1-2 wheel flat bed trailer. 8' x 16'. 1-2 wheel dolly, 16 rabbit hutches with feeders. Electric stove, 2 washers, 1-7 1/4" skill saw, 2 trailer hitches, Fieldton, 262-4742. 3-30-N

10 horse Johnson motor and stand, used very little. Will trade for good Toro lawn mower. Ernest E. Sells, 521 E. 16th, phone 385-4517. 4-3-S

DELUXE models, these machines zig-zag, blind hem, make button holes, fill bobbin in machine, etc. Desk cabinets, with drawer space. Used only three months. Several left out of public school systems. Your choice, \$75. each. Fully guaranteed. Sewing Machine Service Center, 2716 50th, Lubbock, 792-8226. TF-S

Electric Singer sewing machine, basic model with steel foot. Electric adding machine, \$45. Call 385-5434 after 5 p.m. 4-6-S

PANELING SALE

4x8 SHEETS
PECAN VINYL FACED
\$3.00
WOOD-2 COLORS
\$4.00

ALL PAINT THIS MONTH

WHOLESALE PRICES.

ALSO THIS MONTH
EVAPORATIVE COOLERS
REFRIGERATED AIR CONDITIONERS
PRE-SEASON DISCOUNT
15%
OFF RETAIL PRICE

HARRELL'S BUILDING SUPPLY
997-3621, Anton

Autos For Sale

1977 Dodge pickup. Radio, heater, air, power cruise control, bucket seats, head-ache rack, 6 steel belted radial tires, low mileage. 262-4284. TF-J

1967 Chev. Coupe Super Sport. Blue with black vinyl top. 385-5486. 4-13-M

1971 half ton heavy duty Chevrolet pickup. Very good. Phone 385-4703. TF-S

CLEANEST USED CARS in town. Marcum-Olds Cadillac, 8th and Hiway 385, Littlefield. 385-5171. TF-M

AROUND LITTLEFIELD

MR. GRACE Robertson and Rhonda, along with Mrs. Fran Hammock and Craig of Lubbock, formerly of Littlefield, have returned from a nine-day trip to Cisco, Mt. Sellman, Henderson and Wichita Falls, where they have been visiting friends and relatives. While gone, they went fishing and caught some catfish and perch.

FRED LICHTER is in St. Mary's Hospital in Lubbock, undergoing further chemotherapy treatment for cancer. Visiting him Monday afternoon were his brother and wife, Mr. and Mrs. Art Lichte, and Joella Lovvorn.

VISITING the Earl Milligan family Saturday were Mr. and Mrs. H. R. Haney, Mrs. Opal Haney and Renee, all of Claude.

GUESTS SUNDAY at the First United Methodist Church were Mrs. Mary Lou Martin of Whiteface, Mrs. Ona Ruth Neff and Mrs. Ann Smith of Floydada, Sharon Seay of Denver, Colo., Catherine Wright of Dallas, Rhonda Betts, Rene Anderson, Cathy Hearn and Mr. and Mrs. Glenn L. Taylor, all of Littlefield.

MR. AND MRS. E. E. Huggins of Dimmitt, former residents of Littlefield, have returned to Littlefield to make their home. They now reside at 312 E. 9th.

BULA NEWS

RELATIVES from away to attend the funeral for Mrs. Nettie Blackman, Saturday afternoon were Mr. and Mrs. Cleo Aduddell of Layton, Utah; Mr. and Mrs. Roy Blackman of Claredon; Mrs. Pat Carter of Lovington; Mr. and Mrs. Vernon Bass, Purcell, Okla.; Mr. and Mrs. Gordon Bain, Turkey; Mr. and Mrs. Bill Blackman of Fritch; Mr. and Mrs. Monty Blackman of Spearman; Brent Blackman of Lubbock; and Mr. and Mrs. Dudley Cash and children of Portales.

JACKIE WITHROW, Jerry Sowder are among our students from South Plains College, who are enjoying a spring break this week.

MR. AND MRS. Lowell Walden of Earth spent Monday night with his mother, Mrs. Pearl Walden.



WARNER HYBRID

WARNER SEED CO. introduces another fine product
WARNER W-832.
W-832 is bred upon the good strong stalk of the evergreen 839.
W-832 also has the heat and water stress tolerance of the 839.
The large semi-compact heads of W-832, with their dark brown berries, produce high test weight grain, the marks of a great producer with its long wide leaves characterize all heavy producing grain hybrids. Its leaf area not only makes for higher yields, but also water, and prevents weed growth by shading the ground.
W-832 is another winner from WARNER SEED CO. "line" quality seedsmen for the Golden Spread.
See Your Local Warner Seed Dealer Today!
Warner Seed Co.
806-364-4470

FIX IT NOW! CARS & LIGHT TRUCKS

LUBE AND OIL CHANGE

\$4.44

Up to 5 qts. of major brand multi-grade oil

- Complete chassis lubrication & oil change
- Helps ensure longer wearing parts & smooth, quiet performance
- Please phone for appointment
- Includes light trucks

BRAKE OVERHAUL

\$56.95

U.S. drum type cars and light trucks, all four wheels

- Our professionals install new linings, seals, springs, fluid & precision-grind drums
- Analysis of total braking system to ensure safe, dependable service you can trust
- Any new wheel cylinders, if required, only \$10 each

FRONT-END ALIGNMENT

\$8.88

Any U.S. car, plus parts, if needed

- Includes complete front-end inspection
- Camber, caster and toe-in set by precision equipment
- A sound investment for helping assure maximum tire mileage

ALL-WEATHER BATTERY

\$22.88

12-Volt with exchange - group 24, 24F, 22F

- Dry charged for dependable, long-lasting power
- Durable, polypropylene case and cover for high power-to-weight ratio, heat and shock resistant
- Gang vent caps, large plates, plastic-rib separators

QUALITY MUFFLER

\$14.77

- Quality mufflers to fit many models of U.S. cars at one low price
- Buy now at this low price

Fits most U.S. cars, plus \$5 for installation

TIRE ROTATION

\$1.99

- Complete tire rotation to recommended patterns depending on tire construction
- Helps maintain even wear for maximum tire mileage
- Inspect tires for hazardous wear, breaks and cracks

A*75 Quality Tire Designed To Meet Inflation Head-On!

\$15.50 All-Weather 78

- Tempered polyester cord for optimum strength and resilience
- "Reverse Molded" 78-series tread for full, flat road contact
- Well grooved rib-type tread design with plenty of traction edges for a decisive grip

B78-13 blackwall plus \$1.88 F.E.T. and old tire

\$20.75 | **\$22.85** | **\$23.85** | **\$24.90**

E78-14 blackwall | F78-14 blackwall | G78-14 blackwall | H78-15 blackwall

Old tire in trade. Plus \$2.32 to \$2.69 F.E.T., depending on size, whitewalls slightly higher.

7 Easy Ways to Buy

- Cash
- Our Own Customer Credit
- American Express Money Card
- Master Charge
- Discover Card
- Carte Blanche
- BankAmericard

GOOD YEAR

Home Convenience. . . Is It Costly?

and trouble in home preparations. But this built-in labor-saving device may cost slightly more than 'from scratch' foods. On the plus side, some convenience foods enjoy such popularity and volume sales that they actually may cost less. Some of the pie crust, cake, biscuit and cornbread mixes are sold in large enough volume that they may be a real bargain. These products may be as delicious as the homemade counterpart. Frosting mixes, although more expensive, are foolproof in flavor and texture. Other bargain convenience foods are frozen juices, especially the larger cans. Frozen orange concentrate is one of the cheapest forms of orange juice. Refrigerated canned biscuits are much less expensive than those baked at home. The date code insures freshness for consumers, but frozen breakfast foods such as waffles or biscuits cost more than homemade ones. More varieties of macaroni and seasoned rice as well as one dish skillet meals are available now. These convenience foods do have their place—especially for the inexperienced cook or working homemaker. But consumers can save money by using a favorite recipe to combine basic ingredients and spices to make the same dish. Frozen vegetables in the boil-

in-bags are definitely more expensive but do offer vegetables processed at the peak of the season throughout the year. Consumers will have to decide for themselves if the extra expense of some convenience foods is worth the time saved in the kitchen.

SHOP LITTLEFIELD FIRST

Vets' Widows May Regain VA Benefits

The Veterans Administration today reminded widows of veterans whose pension and compensation payments were terminated after their remarriage, that a 1970 law allows restoration of these benefits if they become widowed a second time.



Volunteers donated goods for the Lefors tornado victims, and these vehicles were sent to the stricken area Sunday afternoon. Everything from household appliances, clothing and other items were sent. (Photo by Emil Macha)

"A Star Is Born"
Talent Show
Friday, April 4, 1975
7:00 P.M.
Littlefield High School Auditorium
\$1.00 Adults 50c Students
All Ages Entered
Sponsored By Alpha Lambda Zeta
Chapter Of Beta Sigma Phi

BEAUTY THAT UPLIFTS

HAMMONS FUNERAL HOME

Henry Block has 17 reasons why you should come to us for income tax help.

Reason 8. H & R Block is a year-round service. We do not disappear after April 15th.

H & R BLOCK
THE INCOME TAX PEOPLE

519 PHELPS
Daily 9-6, Sat. 9-5
385-5520
Come In Soon

"THERE IS A TIME FOR EVERYTHING . . ." Ecclesiastes 3:1, The Living Bible, Tyndale House

GOD'S FIVE MINUTES

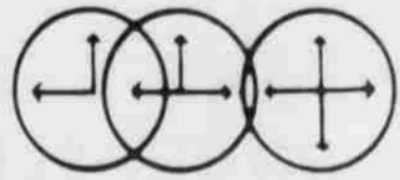

This Series Made Possible by These Business Firms and Individuals Who Support Our Right to Worship Freely.

- BIRKELBACH MACHINE & PUMP**
12 E. 9th. 385-5123
- LAMB COUNTY ELECTRIC CO-OP. INC.**
ROBERT SMITH 385-5191
- ARMES EQUIPMENT CO.**
FARM & LAWN EQUIPMENT
BOX 849 385-4121
- LITTLEFIELD MEAT & POULTRY CENTER**
PH. 385-3818
LITTLEFIELD, TEXAS 79339
- STATE LINE IRRIGATION CO. Inc.**
IRRIGATION SYSTEMS
LITTLEFIELD
WELLAND MULESHOE
- BYERS GRAIN & FEED**
BONDED STORAGE
LITTLEFIELD
- HAMMONS FUNERAL HOME**
SERVING THE LITTLEFIELD AREA SINCE 1925
385-5121



EASTER

When you speak of the love of God, do not do so in any superficial and saccharine manner. For it was the love of God that required the death of Christ.

The cross of Christ does not represent the love of God. It IS the love of God.

So it is that any child of God, through faith in Jesus Christ, puts the cross at the center of the Christian faith.

As wonderful as the birth and the resurrection of Christ were, it is the crucifixion of Christ which is central. You see, the death of Christ for all is equivalent to the death of Christ for each. It is the great proof that Jesus Christ loves you and He loves me. For the love of Christ which constrains us is the love that died and the love that raised itself from death to live forever.

See II Corinthians 5:14-15

ATTEND CHURCH THIS WEEK

© Community Advertising 1975
This column belongs to our readers. We will accept printable items and pay \$1.00 for each item published. In the case of quotations, the name of the author and the title and publisher of the book must be given. Address items to "God's Five Minutes," Box 12157, Fort Worth, Tex. 76116

CHURCH SECRETARIES ARE URGED TO SEND SCHEDULES OF WORSHIP SERVICES OF THEIR CHURCHES SO THAT THEY MAY BE INCLUDED ON THIS PAGE.

- Dairy Queen**
FRANK & GLADYS ROBINSON
LITTLEFIELD 385-3666
- KNIGHT'S REST HOME**
BOX 328
520 ASH 385-3921
- LITTLEFIELD CABLEVISION**
Call Today For Hook-Up Information.
385-4522
- LITTLEFIELD MEMORIAL PARK**
PERPETUAL CARE
CLOVIS ROAD 385-3911
- DEEP ROCK**
KENNETH OVERLAND - OWNER
84 BY -PASS 385-8964
- PIERCE OIL CO.**
E. H. Pierce
- Marcum Olds-Cadillac - Pontiac**
801 HALL 385-5171

- CASE POWER & EQUIPMENT**
236 W. 2nd. 806-385-4427
- Auto Supply Co.**
WHOLESALE - RETAIL Littlefield
Automotive Parts and Accessories

- MERCURY CARLISLE-OLDHAM FORD, INC.**
Phone 385-5164 525 29 Phelps Ave Littlefield, Texas
- THE ORIGINAL TASTY TACO**
AUTHENTIC MEXICAN FOOD.
MR. & MRS. RALPH MENDEZ
HALL AVE. & 7th. 385-3764

- ROWE ABSTRACT & TITLE COMPANY**
REPRESENTING
STEWART TITLE GUARANTY COMPANY OF TEXAS
COMMERCIAL STANDARD TITLE INSURANCE COMPANY
Littlefield P.O. Box 311
- LITTLEFIELD FEDERAL SAVINGS & LOAN ASSOCIATION**
INSURED
801 KIT DRIVE PHONE: 385-5197
LITTLEFIELD, TEXAS AREA CODE: 806

- DAIRY MART**
"YOU ARE ALWAYS WELCOME AT THE DAIRY MART"
1030 W. 10th 385-5022
- NICKELS GIN**
"SERVICE ABOVE ALL"
385-4880

Girls Practice Schedule

All Major League Teams will practice in the Junior High Gym on Saturdays at the following times:

Littlefield Service Center <i>TV Boys</i> Coach: Minnie Sanderson & Beth Ford	9:00 - 11:00 a.m.
Pay & Save <i>Trackers</i> Coach: Mr. & Mrs. Jackie Howell	10:00 - 12:00 a.m.
Jones <i>Little Lambs</i> Coach: David Jones & Mary Lou Newton	12:00 - 2:00 p.m.
Hills <i>Dotson Buyers</i> Coach: Linda Spencer & Vannie Gregory	1:00 - 3:00 p.m.
Armes <i>Little Deeres</i> Coach: Weldon Pace & Ronald Dutton	3:00 - 5:00 p.m.
Richard's <i>Real-Trackers</i> Coach: Merlene Williams	4:00 - 6:00 p.m.

All Major League Teams will practice in the High School Gym on Saturdays at the following times:

Sedell's <i>Barberettes</i> Coach: Angie Sawyer Charles Schroeder	9:00 - 11:00 a.m.
Littlefield Putane <i>Phillip Sellers</i> Coach: Merlene Bridwell & Annette Fowler	10:00 - 12:00 a.m.
Leak County Electric <i>Big Trucks</i> Coach: Johnny Richardson	12:00 - 2:00 p.m.
McCormick's <i>Trimmers</i> Coach: Mr. & Mrs. Jerry Tunnell	1:00 - 3:00 p.m.
Deiry Joseph <i>D.K. Dudes</i> Coach: Mr. Don Stubbs & Mrs. Wene Donald	3:00 - 5:00 p.m.
Caboa <i>Little Wranglers</i> Coach: Vannie Gregory	4:00 - 6:00 p.m.

The practice schedule and playing schedule for the Senior Division will be announced later.

Tracksters Finish Third In Meet

Littlefield captured third place in the Floydada Invitational Track meet Thursday as the Wildcats' mile relay team won their event for the third week in a row.

Relay members Stanley Patterson, Steve Cruz, Buddy Jungman and Bill Turner won the event in 3:36.2.

Turner received the only other first-place ribbon with a first in the 440 yard dash with a time of 53.8. Patterson finished third with a 54.3 and Cruz was sixth with 55.2.

Jungman had a third-place finish in the 880 with a time of 2:10.8 and Toney Cowan finished fourth in the mile run with a time of 5:06.0. In the other running events, the 440 relay team finished third with a 46.4 clocking and Jimmy Durham finished fourth in the 220 with a 24.1 mark.

In the field events, Rick Hopping finished third in the shot put with 47' 10 3/4" and Hopping had a sixth place finish in the discus.

Brian Goss finished fourth in the high jump with a 5'6" mark and Patterson finished sixth in the event with a 5'4" mark.

Host Floydada won the meet with 189 points, while Olton came in second with 79 and Littlefield had 75 for their third-place finish.



Little League Summer Camp Begins June 15

Baseball season is right around the corner and Little League is making plans for its 1975 Summer Camp program.

Dutch Schroeder, Little League Summer Camp Director at Waco, said the camps are open to boys 9 through 15 years of age, whether affiliated or not with a Little League team. Located on the campus of Baylor University, the camp session is a combination of

sound baseball instruction, healthful recreational programs. The camp is geared to building and ability in fundamental baseball skills. Youngsters and interested can obtain and applications for Summer Camp from Little League Baseball, 1999, Waco, Texas.

PURDY MOTOR MACHINERY
812 E 9th 385-4111
Car, Pick-up & Irrigation Engines Rebuilt.
We Sell & Finance USED CARS

USE SHOOK'S FAST, DEPENDABLE — ON THE FARM SERVICE —



REAR TRACTOR TIRE

This is the farm tire that's long on traction, short on cost. Built with deep, 38 to 45° angle lugs (depending on size) the Lee Extra Power Deep Lug provides an outstanding self-cleaning design with maximum draw-bar pulling power.

This is the tire that has all its treads pulling together to help you do a great job... and that means its strong nylon cords work together, providing the strength and the ruggedness to resist bruises and breaks.

A special combination of rubber and nylon keeps the tire "right" (retaining the tire stretching that weakens its strength). And it's a tough customer on rocks, roots, stumps and stubble, resisting cracking, chipping, and chunking that beat up other tires.

From top to bottom, from down to back, the Lee Extra Power Deep Lug is the best buy in the postwar tractor tire field, one that will stay on the job with you.



FARM SERVICE TIRE

Here's the "friendly tire" that sticks with you wherever you have to go—a maneuverable, go-anywhere wagon tire, or for use on front tractor wheels where additional flotation is needed. More rubber on the road, up to 50% more, provides the wide tread that "floats" the tire across difficult wet fields. With the load distributed over a greater contact area, this tire, in size 11-15, will support loads of 2,350 pounds, with minimum ground compaction. The Lee Farm Service Tire is the extra-wide implement tire that doesn't know when to stop.

ASK FOR A FREE DEMONSTRATION
Push-button shockpower!



Brake job, Drum or Disc.

* Drum package on all four wheels includes replacement of shoes and lining, resurfacing drums, repacking bearings.

CHECK OUR LOW PRICES

* Disc package includes replacement of front pads, resurface of front rotors, repacked bearings, inspection of rear brakes.

ANOTHER SHOOK'S SERVICES FOR SAFETY & TROUBLE FREE DRIVING
ALL NEW TUBELESS PASSENGER TIRES SOLD HERE WILL BE MOUNTED WITH NEW VALVE STEMS AT NO CHARGE

FREE INSTALLATION ON SHOCKS AND MUFFLERS WHEN PURCHASED HERE



SHOOK HI TREADS \$11.95 ANY SIZE W/EXHC. MUD AND SNOW TIRES \$2.00 MORE

I'm tellin' ya...
I'm tellin' ya...
just one more time..

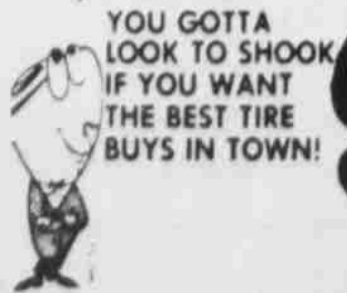

Shook Tire Co.

TEXAS' LARGEST TIRE DEALER

VISIT OUR STORES in Pampa, Amarillo, Hereford, Plainview, Brownfield, Muleshoe, Littlefield, Tahoka, Lemasa, San Angelo, Odessa, Sweetwater, Abilene, Brownwood, San Antonio and Houston, Texas, and Hobbs, and Clovis, N.M.

HOME FURNISHINGS SALE



BOUQUET

Matching Bedspreads And Drapes

Beautiful machine washable quilted bedspreads of 100% cotton top cloth with polyester filling and backing. To make your room complete add matching foam backed drapes, both in white, colors of gold, blue and red. These designs on beige ground.

BEDSPREADS	Reg.	SALE PRICE
TWIN	12.99	8.88
FULL	15.99	10.88
QUEEN	19.99	15.88
KING	21.99	18.88

DRAPES	Reg.	SALE PRICE
48" x 63"	8.99	6.88
48" x 84"	9.99	7.88

DAN RIVER SASSY FLOWERS SHEETS

DAN PRESS® MUSLIN SHEETS — A NO-IRON BLEND OF 50% FORTREL® POLYESTER, 50% COTTON

Sassy Flowers multi-prints will make your bedroom light and airy as a breath of spring. Enjoy our low prices plus the easy care of Dan Press.

	Reg.	Sale Price
TWIN	3.99	2 \$ 5.50
FULL	4.99	2/5 7.
QUEEN	7.99	2 \$12.
KING	10.69	2 \$16.

Cases 42" x 36" 3.49 pr. 2.75 pr.
Cases 42" x 46" 3.99 pr. 3.25 pr.

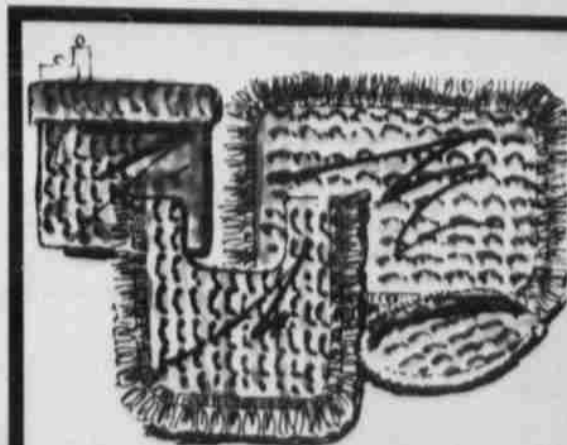

5 Piece Boxed Bath Set

This set is machine washable and includes lid cover, tank lid cover, tank body cover, contour bath rug and bath rug. All made of 50% Polyester, 50% Nylon.

REG. \$8.99 HOME FURNISHINGS SALE PRICE **\$7.88**

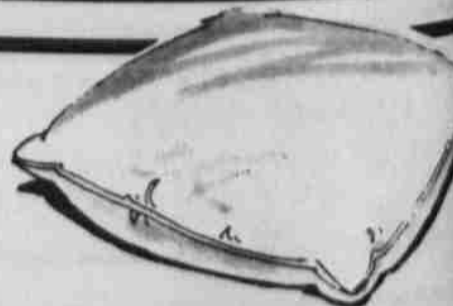

PILLOWS

- * Polyester Filled
- * Machine Washable
- * Non-Allergenic

Reg. 3.99

HOME FURNISHINGS SALE PRICE **2 For 5.50**