

GLASSES
Correctly Fitted
Economically Priced
Dr. Geo. Blackwell
Blackwell Sanitarium
Gorman Texas

To Relieve Misery of
COLDS
take **666**
LIQUID OR TABLETS—SAME FAST RELIEF

MAKE IT LIGHT
MOTOR OIL
As a rule, the motor oil you use in winter should be light. Heavy oil is a major cause of hard starting, and oil made heavy with grit and grime can RUIN your engine by Spring. See us for a change to oil that's light — Oil that's RIGHT for you.

SPENCE
Service Station
PICK-UP & DELIVERY PHONE 225
Across Street from Ross Lumber Company

If You Are Looking For Trouble —
... you are sure to find some of it during the new year. The weather may be bad and speed will increase. Watch out for bombs, walk-outs, government waste, Commies, economic adjustments et cetera. And the person who buys real estate in 1954 without an abstract is headed for trouble. But 1954 will be about what we make it. If we live prayerfully, drive carefully and act thoughtfully, it won't be so bad. Happy New Year!
Earl Bender & Company
EASTLAND (Abstracting since 1923) Texas

POLIO PREVENTION PROG. READY FOR LAUNCH
A Polio Prevention Program has been made possible through the March of Dimes. Polio Prevention has passed all laboratory tests.
Texas hopes to get a center located within her borders.
The introduction of this new and costly operation, the administration of vaccine serum for the prevention of the crippling disease, marks a historical turning point in the history of one of the world's most devastating diseases.
It must be remembered that the laboratory tests must be proven by the injection in the masses.

Roy L. Lane Is Candidate For District Clerk
District Clerk Roy L. Lane has asked us to state to the voters of Eastland County that he is a candidate for re-election and solicits your vote and influence.
On another page of this issue of the Sunday Voice you will find his name properly listed in our political column.
Mr. Lane says he sincerely appreciates the cooperation and courtesies shown him during his time in office, by citizens of Eastland County, and if you see fit to elect him again he promises to continue to render conscientious service in the future.
Mr. Lane will make a formal statement at a later date.

DEAD ANIMALS
Un-Skinned
REMOVED free
CALL COLLECT
Gorman 300 - or Brownwood 9494
Brownwood Rendering Co.

GORMAN PROGRESS
Published on Thursday at Gorman Eastland County, Texas
Entered as Second Class Mail at the Postoffice in Gorman, Texas, under the Act of March 3, 1879.
Card Of Thanks 50 cents
ADVERTISING RATES
35c Per Column Inch
SUBSCRIPTION RATES
Local, Trade Territory — 1.50 Yr.
Six months or less — \$1.00
Out of Trade Territory — \$2 Yr.
EUGENE (Gene) BAKER
Owner-Publisher
LUCRETIA FAIRBETTER, Editor
JOE BENNETT, Shop Foreman
Manning Fairbetter, Apprentice

WANT ADS
MARKET-PLACE OF MILLIONS...
2 Cents per word - MINIMUM Charge 50 cents.

NOTICE - We do first class renovating on mattresses. We make new cotton and innerspring mattresses. Pritchard Mattress Factory. Phone 3841, De Leon, Texas. We pick up and deliver. fn

DEAD ANIMAL SERVICE — Hamilton Rendering Co. — Free and Sure — Call Collect Phone 303, Hamilton, Texas. fn

FOR DOZER WORK see SCHUMAN and VANCE, De Leon, Tex. as. Brush Pushing, Tanks and Sub-Soil Plowing. 12-18fn

Radio - TV Dead — See KAY Radio & Television, De Leon - written guarantee on every job.
Frank Holland
Automatic Saw Grinding
Lawn Mower Grinding
Dial 4581, De Leon, 5-30fn

Mattresses Rebuilt — Have your old mattress made like a new, beautiful interspring mattress. Prices are reasonable, work guaranteed. Eppler Furniture Store of Gorman, Representing Summers and Son Mattress Company of Stephenville. fn

ROSES - Fine selection of Roses standard and patented and other nursery stock. Womack's Nursery, (on Hwy. 6 near Rucker) De Leon, Texas. 11-26fn

FOR SALE - Two peanut farms near Rising Star. \$35 per acre. C. E. Sims, De Leon. 1-21-c

GIFTS you will appreciate Pfaff's Sewing Machine and Service. Mrs. Frank Hagood.

FOR SALE - Plenty of broilers. C. H. Groomer, 1-28p

FOR RENT - Four room furnished apartment in Gorman. Modern conveniences. Phone De Leon 2085. 11-56fn

FARM For Sale - 160 acres, modern home, conveniences. Write: Lloyd Browning, 1316 West Park Row, Arlington, Texas. Phone AR4-8469. 1-28p

FOR SALE - To be moved - Good house, 5 rooms and bath, with fixtures and other modern conveniences. Also electric water pump and pipe. Mrs. Sissala Williams, Box 13, Cayuga, Texas. For other information see Davis Smith, Gorman. 1-14fn

FOR SALE - 40 acres of land, with 5-room house and 5 out buildings. See Jake Stamey, Rt 3, 2 miles East of Gorman. 1t

WILL TRADE - One Atomike for City Property. T. L. Acrea, Gorman, Texas. 1t

FOR SALE or TRADE — Our home in town for place on edge of town or in country. W. C. Smiths, Rt. 2, Gorman. 1t

FOR SALE — Peanut Hay, \$30 per ton. J. C. Donaldson, Kokomo, Texas. 1t

FOR SALE — Used Frigidaire and 4-burner gas range - Cheap. See C. E. Sims. 1tp

Owens-Keeler Wed At Dublin, January 1
Miss Jeanette Owens, daughter of Mrs. Agnes Owens of Desdemona, was married to Mr. Charles Keeler, son of Mr. John Keeler, Rt. 5, Dublin, on January 1, 1954 in Dublin.
They were attended by Mr. Richard Keeler and Miss Eunice Mae Keeler.
The bride wore the traditional long sleeved fitted bodice satin wedding gown.
Mrs. Keeler is a 1951 graduate of Desdemona High. She lettered four years in basketball being the outstanding player. After finishing school she worked at Blackwells, Stephenville, and Ranger General Hospitals.
Mr. Keeler, with three and one half years of service, in the U S Air Force behind him, is a freshman at Ranger Junior beginning his major radio engineering. Mr. Keeler left high school to join the Air Force where he was able to complete his high school education.
The couple at home in Ranger.

OLIVER SPRINGS NEWS
Margaret Woodall, Reporter
Due to the sudden change in the weather there was only a few who attended Sunday School.
The Wayne Atchisons picked up the C. E. Atchisons at their home Saturday and continued to De Leon for a visit with the Cleo Jenkins.
The W. J. Atchisons, formerly of this community, bought the Adcock place. The Dewey Lindleys visited them in their new home recently.
Kenneth and Bill Kampe of San Antonio brought W. J. Wood all back to the Norman Woodall home after a visit. They had Sunday dinner with the F. E. Woodalls.
The community was surprised last week to hear of the marriage of 2 of our young people. Peggy Parks, daughter of the Roy Parks, became the bride of Buddy Box, son of the N. L. Boxes. They plan to live in De Leon. Peggy will continue her schooling.
The N. F. Wodalls visited the Gene Koonces Saturday night.
Mr. and Mrs. John Arnold returned home Friday after a short visit with their daughter, Mrs. Frank Leazar, and Mr. Leazar in Sundown.

NATIONAL PEANUT WEEK
MARCH 7TH - 13TH
Use SPANISH PEANUTS
The Type We Grow

Charter No. 7410 Reserve District No. 11
REPORT OF CONDITION
of

The First National Bank GORMAN, TEXAS
"Oldest Bank In Eastland County"

ASSETS	
Cash, balances with other banks, including reserve balance, and cash items in process of collection	\$1,010,954.31
U. S. Govt. Obligations, direct and guaranteed	728,550.00
Obligations of States and political subdivisions	10,640.32
Corporate stocks (including \$2,250.00 stock of Federal Reserve Bank)	2,250.00
Loans and discounts (including \$2,066.52 overdrafts)	503,910.19
Bank premises owned \$1.00, furniture and fixtures \$1.00	2.00
Real Estate owned other than bank premises	7,500.00
TOTAL ASSETS	\$2,263,806.82
LIABILITIES	
Demand deposits of individuals, partnerships, and corporations	1,962,635.76
Time deposits of individuals, partnerships, and corporations	25,000.00
Deposits of U. S. Govt. (inc. postal savings)	8,185.84
Deposits of States and political subdivisions	117,985.22
Total Deposits	\$2,113,806.82
Total Liabilities	\$2,113,806.82
CAPITAL ACCOUNTS	
Capital Stock:	
Common stock, total par \$50,000.00	\$50,000.00
In the State of Texas, at the close of business December 31, 1953 published in response to call made by Comptroller of the Currency, under Section 5211, U. S. Revised Statutes.	
Surplus	25,000.00
Undivided profits	75,000.00
Total Capital Accounts	150,000.00
Total Liabilities & Capital Accounts	2,263,806.82
MEMORANDA	
Assets pledged or assigned to secure liabilities and for other purposes	116,400.00
Loans as shown above are after deduction of reserves of	4,029.66

I, ANNA LOUISE SPENCE, Cashier of the above-named bank, do solemnly swear that the above statement is true to the best of my knowledge and belief.
ANNA LOUISE SPENCE, Cashier

Correct—Attest:
W. G. KIRK EDWARD F. HARRISON JOHN S. KIMBLE
Directors
Sworn to and subscribed before me this 6 day of January, 1954, and I hereby certify that I am not an officer or director of this bank.
E. E. TODD, Notary Public

STATEMENT OF CONDITION
THE FIRST NATIONAL BANK
GORMAN, TEXAS
At The Close of Business December 31, 1953

RESOURCES	
Loans & Discounts	430,873.38
Banking House, Furniture & Fixtures	7,500.00
Other Real Estate	2,250.00
Stock in Federal Reserve Bank	2,250.00
Bills of Lading & Public Obligations	83,676.13
U. S. Government Bonds Owned	728,550.00
Cash	1,010,954.31
TOTAL	\$2,263,806.82
LIABILITIES	
Capital Stock	50,000.00
Surplus	25,000.00
Undivided Profits	75,000.00
Deposits	2,113,806.82
TOTAL	\$2,263,806.82

OFFICERS
W. G. Kirk, President
Edward F. Harrison, Vice President
Annie Louise Spence, Cashier
Dorothy Sparks, Assistant Cashier
DIRECTORS
Dr. G. T. Blackwell
Edward F. Harrison
Dr. D. V. Rodgers
W. G. Kirk
Dr. J. B. Brandon
John S. Kimble

CLOVER FARM STORES
CITRUS
FRESH-CANNED
Keep sunshine "in" your family all winter long! Guard against winter sniffles and enjoy the golden goodness of juicy-sweet oranges, delicately flavored tangerines, tangy grapefruit or lemons. Buy "health insurance" NOW at your Clover Farm Store.

ORANGE JUICE 46-Oz. Can	35¢	CUT GLENDALE GREEN BEANS No. 303 Can	17¢
GRAPEFRUIT JUICE 46-Oz. Can	27¢	AMERICAN BEAUTY CUT MACARONI	
CORN BEEF HASH 16-Oz. Can	33¢	MACARONI 7-Oz. Pkgs.	31¢
CHILI AUSTEX No. 300	35¢	CATSUP WAPCO 12-Oz. Bottle	15¢
CHILI PLAIN Can	35¢	LARGE PANTRY PACK	
POTTED MEAT 3 1/4's Cans	25¢	LIMA BEANS 1-Lb. Pkg.	20¢
VIENNA SAUSAGE 2 1/2's Cans	35¢	COCOA HERSEY'S 1/2-Lb. Can	27¢
MILK CLOVER FARM 3 Tall Cans	37¢	PEAS GLENDALE EARLY JUNE No. 303	31¢
PETER PAN 12-Oz. Jar	35¢	CRACKERS SUNSHINE KRISPY 1-Lb. Box	25¢
PEACHES SLICED OR HALVES No. 303	45¢	VANILLA WAFERS SUNSHINE	31¢
FRUIT COCKTAIL 2 No. 303 Cans	53¢	BUTTER COOKIES SUNSHINE 10-Oz. Pkg.	29¢
SPINACH GLENDALE 2 No. 303 Cans	25¢	PUREX 1-Quart	17¢
MUSTARD PREPARED CLOVER FARM Jar	10¢	PUREX 1/2-Gal.	31¢
BEETS CLOVER FARM No. 303	17¢		

BRUCE'S FLOOR CLEANERS Quart 59¢
SELF POLISHING FLOOR POLISH Quart 69¢
TREND (TWIN PACK) 2 Packs For 39¢

FRESH FRUITS • VEGETABLES **CHOICE FRESH MEATS**

FOODS **CLOVER FARM STORES** **MEATS**

CHECK NOW!
Check into those strange knocks and squeaks immediately! They are warning signals that major trouble is on the way. Drive in today and save Big Expenses later on!
KING MOTOR CO.
Phone 42 Eastland

J. E. WALKER
Druggist
Phones 55 Nite 109
Mehaffey Drug

JAMES JOBE ATTENDS DEALERS MEET

James Jobe is attending an Allis-Chalmers Dealers business meeting being held in Temple this week. Jobe is Junior member of the D. J. Jobe and Son Implement Company.

Mr. and Mrs. Hardy Tidwell left Friday for Kansas City, Mo. to attend a turkey meet.

Mrs. Ida Wilhite is in Stephen ville this week with Sue, Nancy and Sonny Tidwell, who are attending school there.

CHEANEY NEWS
Reporter, Mrs. Bill Tucker

Some illness is reported this week. Mrs. Richard Tucker was hospitalized on Saturday in Ranger with a severe head cold. Mrs. Ann Love was feeling poorly over the week end. She has been taking treatments weekly for several ailments.

Mrs. Beulah Melton is recuperating from her recent stay, as a patient, in the Gorman hospital. J. B. Blackwell is also reported feeling better on Sunday. He is a treatment case at the Brown Sanatorium at Cisco, where he has been hospitalized since last Sunday. Mrs. Blackwell is at Cisco with him.

Word has come of the serious injury of Mrs. J. B. Griffith, former Cheaneyite, now living in New Mexico, who was in an auto mishap. The nature or extent of her injury was not available for our report, but her children have been called in.

Sunday services at the Cheaney Church of Christ were conducted by Lloyd Ash, student minister of Abilene, who also was the dinner guest of Mr. and Mrs. John Love.

Mr. and Mrs. W. E. Walton and Billie Jo of Ranger were callers in the John Tucker home Saturday night.

The Boyd Wisdoms of Abilene

DESDEMONA NEWS
Reporter, Mrs. Ethel Keith

Mrs. Joe Murrel was home on Wednesday from the hospital at Gorman where she had been a patient for several days.

Mr. and Mrs. Hugh Abel are both patients in the Gorman hospital resulting from an accident Saturday near Eastland when the car got out of control and left the slick pavement and overturned.

A number of people attended the funeral in Ranger Monday evening of Aunt Frona Browning. Mrs. Browning was almost 89 years of age - and was a former resident of Desdemona.

Mrs. Fuqua, mother of Mrs. Buna Abernathy, is on the sick list.

Mr. and Mrs. Raymond Anderson and Mr. and Mrs. R. D. Wright were Sunday visitors with Mrs. Buchan and Lillie.

made a round of calls on Sunday in Eastland and in this community with relatives.

Visitors at Church Sunday morning and in the home of her parents, the Joe Butlers, were Mr. and Mrs. Graham Compton and family from Weatherford.

Mr. and Mrs. John Kemper of Tulia were overnight guests Friday night in the Bill Tucker home. The Kempers were neighbors of the Tuckers in Swisher County 23 years ago and were enroute to Glen Rose and Dallas, also points in Oklahoma.

Mrs. Pat Brown was hostess for a Cosmetic Sales Party on Tuesday of last week. A demonstration lesson on proper selection and use of make-up with analysis and suggested skin-care emphasized, is given at each hostess meeting where Diana Deering Cosmetics are available through the local distributor.

Mr. and Mrs. Billy Tucker and Garland of Jal, N. M., were visitors Friday through Tuesday with the parental Bill Tuckers at Cheaney and near Gorman with the Fred Joiners.

Misses Ann and Sue Weekes and Dickie Weekes of Comanche were church visitors here on Sunday with their aunts, Mrs. Sophie Freeman and Mrs. Maud Dean, during the absence of their mother, Mrs. Pearl Weekes, who is at the bedside of Mrs. J. B. Griffith, her mother, in New Mexico.

This community and that of Alameda were saddened to hear of the serious illness of Mrs. Julia

Blackwell of Eastland, pioneer resident of Alameda for many years, with a host of friends at Cheaney, who are offering sympathy and understanding to Mrs. Salie Bishop, the daughter

with whom she makes her home since moving to Eastland in 1950. Mr. and Mrs. J. D. Rogers and family are enjoying a new Chevrolet pick-up in the past few days. Olive M. Pilgrimage and his sister,

Miss Artie, are enjoying that new television, installed last week.

Lamar Perrin has purchased the 3-room house on the Haley farm and moved it this past week to the Perrin homeplace.

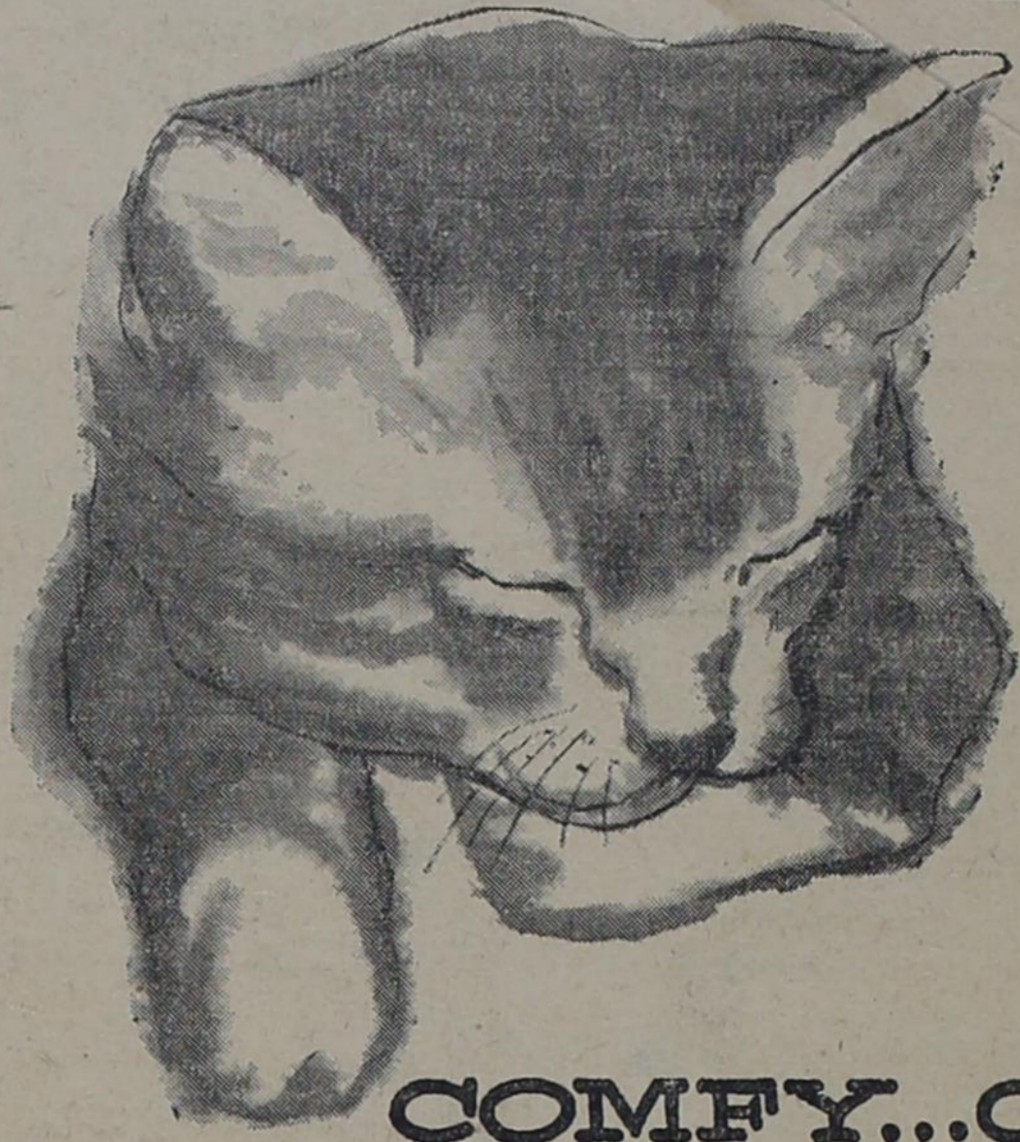

COMFY...COZY
All through the night... under ELECTRIC BEDCOVERING

Thanks to low-cost electricity, you can take your choice of a good night's sleep in any one of three ways... electric sheet, comfort, or electric blanket... and spend the most relaxed winter night of your life. Sudden drops in room temperature never have a chance to disturb your slumber when you spread your bed with the comfort of electric bedcovering... for Reddy Kilowatt controls the heat automatically and lets you sleep through the night. Your winter nights will be spent blissfully unaware of cold or chill under the protection of your electric bedcovering.



ELECTRICITY DOES SO MUCH - COSTS SO LITTLE

Your electric appliance dealer has a complete stock of the wonderful electric bedcovering you need for a winter of restful sleep. See him today for a good night tonight.

Texas Electric Service Company
L. D. STEWART, Manager

WHAT METHODISTS BELIEVE 2

We Believe in Jesus Christ



Jesus is the Son of God, the eternal divine Word made flesh and dwelling among men. In His sinless life He revealed the nature of His Father and our Father. His infinite wisdom is our guide. His sacrifice upon the cross is our redemption, and His resurrection from the dead is our pledge of eternal life. He lives today, unseen though ever present, and in the acceptance of Him as Saviour and as Lord lies humanity's hope for the present and for the future.



Attend the Church of Your Choice Every Sunday

EXPERT BODY REPAIR at

Reasonable prices
KING MOTOR CO.
Phone 42 EASTLAND

State Farm Insurance sells for less
Inquire - save money - see us

THOMPSON Insurance Service
Phone 590 P O Box 69
COMANCHE, TEXAS

Quitting Business Sales Continues

In addition to this list you'll find many items You will be interested in.

COME IN

SERVE YOUR SELF

DISCOUNT
33 1/3
On All Merchandise

Bibby's Variety Store

Gorman, Texas

- A** Adhesive Tape, Account Books, Rubbing Alcohol, Childrens Anklets, Antiseptics, Appliance Plugs, Ash Trays, Axes, Anniversary Cards, Toy Autos
- B** Bear, Big Goods, Bathroom Fixture, Beach Balls, Dress Belting, Bias Tapes, Belts, Bicycle Bells, Billfolds, Birthday Cards, Crib Blankets, Toy Boats, Toy Brooms, Corner Brackets, Brassiers, Dental Plate Brushes, Paint and Varinsh
- C** Clothes Pins, Cake Boxes, Decorations, Carbon Paper, Window Catches, School Chalks, Corn Pads, Wax Crayolas, Crepe Paper, Cup Hooks, Cut-Out Books, Crochet Threads, & Hooks, Cold Creams, Composition Books, Compasses, Coloring Books, Comb & Brush Sets, Chicken Feeders
- D** Dental Floss
- E** Decalcomanias, Deodorants, Dish Cloths, Dish Towels, Paper Doilies, Drawer Pulls, Drain Pipe Cleaners, Door Stops, Drawing Papers
- F** Electric Supplies, Shelf Edging, Egg Beaters, Elastic Webbing, Eye Shades, Envelopes, Enamels and Paint, Erasers, Juice Extractors, Extension Cords, Eyebrow Pencils
- G** Notebook Fillers, Faucet Washers, Flower Pots, Flashlight Bulbs, Face Powders, Flour Sifters, Fry Sprays, Folding Rules, Fountain Pens, Friction Tape, Fry Pans, Funnels, Furniture Knobs
- H** Glassware, Cotton Gloves, Goggles, Grass Shears, Greeting Cards, Graduation Cards, Index Files, Infants Accessories, Hair Accessories, Half Soles, Hammers, Handkerchiefs, Clothes Hampers, Hardware
- I** Dog Harness, Hot Water Bags, Ice Picks, Ice Tea Spoons, Ice Tea Tumblers, Infants Accessories, Incense Burners, Inks, Insoles, Iodine, Ironing Board Covers, Invitation Cards
- J** Jack Knives, Jack Stones, Journals, Jewelry, Japanese Ware, Juice Strainers
- K** Key Ring and Cases, Kitchen Equipment, Knife Sharpeners, Knitting Yarns, Knitting Needles, Knives and Forks
- L** Lawn Sprinklers, Lead Pencils, Leather Goods, Lemon Squeezers, Library Paste, Lingerie, Linoleum Nails, Listerine, Looseleaf Books
- M** Mechanical Pencils, Measuring Spoons, Medicine Droppers
- N** Mendets, Mecurachrome, Mixing Spoons, Modeling Clay, Mop Handles, Moth Balls, Nail Clippers, Nail Polishes, Shoe Nails, Hair Nets, Nested Bowls, Napkins & Napkin Holders
- O** Oil Cans, Office Supplies, Onion Choppers, Olive Oil, Oven Thermometer
- P** Picture Frames, Pot Covers and Knobs, Polishing Wax, Pulleys, Card Punch, Putty, Puzzles
- Q** Paint Books, Writing Paper, Paper Clips, Paper Fastners, Paper Cups, Wax Paper, Typing Paper, Plate Scraper
- R** Rat Traps, Receipt Books, Repair Kits, Ricers, Rolling Pins
- S** Salad Bowls, Sand Pails, Grease Sets, School Goods, Sash Leeks, Scrap Books, Screw Drivers, Screws, Scrub Brushes, Window Shades, Shade Brackets, Shade Bulbs, Shaving Brushes, Shampoo, Shaving Lotion, Shelf Brackets, Shipping Tags, Shoe Trees, Shoe Laces, Sink Stoppers, Fruit Squeezers, Stationery, Step-on-Cans, Stove Bolts, Sugar Bowls, Surgical Cotton, Suspenders, Fly Swatters, Syrup Pitchers, Syringes
- T** Table Spoons, Tank Balls, Talcum Powder, Tea Strainers, Teething Rings, Toy Telephones, Testaments, Thank You Cards, Thumb Tacks, Time Books, Tire Patch, Tooth Powders, Toy Tractors, Toy Trains, Trouser Hangers, Turnbuckles, Tumbler Halder, Tweezers, Twines, Turpentine
- V** Varnishes, Vaseline, Vegetable Brushes, Washboards, Waste Baskets, Window Wipers, Window Cleaners, Window Shades, Water Bottles, Water Pistols, Wine Glasses, Whisk Brooms, Watch Bands

DALE GLASSONS HAVE NEW BABY

Mr. and Mrs. Dale Glasson of Baird have announced the birth of a new baby, Delbra Glasson.

Delbra was born December 23rd in Baird weighing 8 pounds and several ounces. Mrs. J. L. Glasson left Monday morning for a visit with the new grandchild.

What's your Type?

Colonial Cape Cod, Ranch, no matter what it's worth would cost a fortune. After a fire may strike. The best type of protection? Strong and adequate insurance.

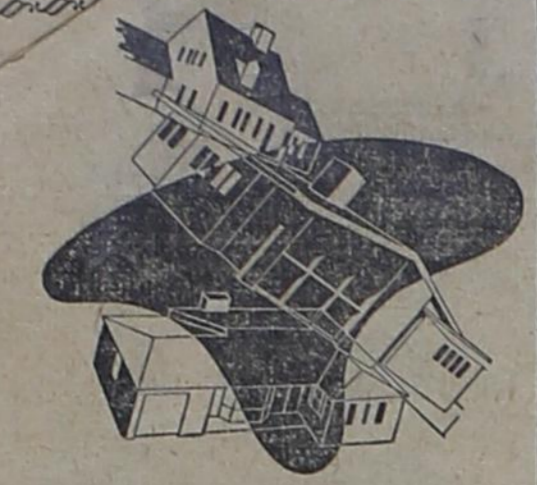

Gorman Insurance Agency
Gorman, Texas

CHURCH OF CHRIST NOTES

The Radio Program of the local Church of Christ has been changed from 8:00 to 9:00 A. M. and can now be heard at 9:00 A. M. over Station KERC, Eastland.

Beginning next Sunday, January 17, we will have a series of 10 sermons, dealing with questions people raise about the Church of Christ. The first one will be: "Why doesn't the Church of Christ recognize Alexander Campbell as its founder and builder?" Other such questions will be answered on following broadcasts.

Following is a calendar of services Sunday:
9:00 - 9:15 - Radio Program
10:00 - 10:45 - Bible Study
10:50 - 12:00 - Morning Worship
6:00 - 6:45 - Young Peoples Class
7:00 - 8:00 - Evening Worship
MONDAY —
2:00 - 3:00 - Ladies Bible Class
7:00 - 8:00 - Men's Bible Class
WEDNESDAY —
7:00 - 8:00 - Mid-Week Service

W. S. C. S. Open Bible Study Monday At 3

The Woman's Society of Christian Service met in the home of their study leader, Mrs. M. H. Fairbetter, for the opening session of the mid-winter Bible Study Monday afternoon.

The devotional was a period of silent worship as Milton Fairbetter, Jr. played "What A Friend" on the accordion.

A resume of Bible History through the creation to the time of Jeremiah was given by the leader, followed by a brief biography of the prophet and his call to service.

During the business session committees for the planning and serving of lunch at the District Layman's Meet on January 21st were announced.

Mrs. G. C. Acrea, Mrs. Edna Nunnally and Mrs. D. J. Jobe assisted the hostess in serving a dessert plate.

Others attending were Mesdames Don Bolt, B. F. Pendarvis, J. W. Ramsey, J. E. Walker, A. A. Brown, Bob Burns, Craig Smith, Marvin Blair, Eugene Baker, A. M. Thurman, Newt Crawley, and Floyd Thrash.

The January 18th meeting for the second session will be held in the home of Mrs. Edna Nunnally at 3 p. m.

Illness In Gorman

Postmaster Dona Moorman was hospitalized on Saturday afternoon and has been treated for the flu. It was expected that she would be able to return to her home by the middle or the latter part of this week.

Mrs. Ruth Carter, mother of Mrs. J. A. Baze, has been a patient at Blackwells for the past week but she returned to her home on Monday with her condition improved. Visiting with her during her stay at the hospital were Mr. and Mrs. Loyd Tankersley and son Mike of Knox City, Mr. and Mrs. Oren Covey of O'Brien and Mr. and Mrs. Shorty Williams, Alice and Toni of Haskell.

Judy Burns is at home. She likes visitors and books on her reading level. Judy must lay on her stomach for sometime yet as her back will be healed only with time.

Mrs. Reeves Pittman of the Duster Community has been quite ill this week. She is a patient at Blackwells.

J. E. (Doc) Foster entered the hospital on Monday evening. He suffers a chronic asthma condition.

Card Of Thanks

I wish to express my deep appreciation to the Odd Fellows Lodge for their visits and the

flowers sent to me, to the friends for visiting me, and to the doctors and nurses for their courtesy and kindness to me during my stay at the hospital.

Leland Warren

Mrs. Albert Hendricks Progressive Speaker Tells About Cancer

Mrs. Albert Hendricks, program leader of the Progressive Study Club on Thursday evening January 7th, spoke on the overall topic CANCER. She discussed the symptoms, possible influence of heredity, control of disease, surgery as a cure and the pros and cons of radium treatment.

Roll Call was answered with a symptom of cancer.

A sandwich plate was served by the hostess, Mrs. D. J. Jobe.

The January 15th meeting will be a joint meeting with other study clubs hosted by the Woman's Study Club.

CARBON MAN CRITICALLY ILL

Mr. Ernest Reece of Carbon is at this writing, Tuesday, critically ill.

Mrs. Paul Nunley, his daughter and her family are at his bedside. Floyd Nunley is staying with his grandparents, Mr. and Mrs. Floyd Nunley, Sr.

Dr. Fehrman H. Lund OPTOMETRIST

Eye Examinations — Prescribing of Lenses — Visual Rehabilitation
Phone 30 405-6 Exchange B. EASTLAND, TEXAS



For Complete Auto Service
GABE
WRIGHT'S GARAGE
PHONE 139 GORMAN



SEE OUR NEW STOCK OF BEAUTIFUL SPRING SHOES - TODAY

\$2 98

FROSSARD'S
DEPARTMENT STORE
Gorman, Texas

Panther Cagers

Continued from Page One

Goldthwaite, Eastland, and Stephenville. The girl's bracket includes the following teams thus far: Gorman, De Leon, Carbon, Desdemona, Lingleville, Goldthwaite, Eastland and Comanche.

Tournament play is expected to open on Wednesday, January 27 and finish on Saturday, January 30. Two afternoon sessions probably will be conducted in order to aid the crowded schedule.

Your only DODGE Dealer in Eastland County
McGRAW MOTOR CO.
Sales - Service
EASTLAND

Beaded Mocassons

JUST ARRIVED - NEW STYLES IN LADIES CAMP MOCASSONS GENUINE HAND-LACED

These Are In A New Two-Color Combination Also In White Sizes 4 to 8 1/2

ONLY - \$1 98 - \$2 98 - \$3 49

(Children's Sizes - \$1.98)

MEN'S TIES



SOME GOOD BUYS AT ONLY

50c

Men's HAT SALE CONTINUES



ONE COUNTER YOUR CHOICE FOR ONLY

\$3 95

Armstrong Quaker FLOOR & WALL COVERING

New Patterns & Color Combinations To Fit Every Room In The Home. To Brighten Your Home Begin With —

FLOOR COVERINGS

6 Ft. Wide Yard Goods 59c Running Ft.

9 Ft. Wide Yard Goods 89c Running Ft.

12 Ft. Wide Yard Goods \$1 19 Running Ft.

9x12 BORDERED RUGS \$10 95

QUAKER WALL COVERINGS

Choice Colors and Patterns To Wainscoat Your Bathroom & Kitchen Walls.

4 1/2 Ft. High 59c Running Ft.

Trade In Your Old Suite For One Of Our Beautiful New Suites

40 Years Ahead with Overhead Valve Engines

NEW 1954 CHEVROLET

It stands to reason that you'll get the finest Valve-in-Head engine in the low-price field from the world's largest builder with 40 years of experience in developing and improving this type of engine. And now for '54... New power! New economy of operation! Smoother, quieter, finer performance!

For 1954, Chevrolet brings you your choice of two great high-compression Valve-in-Head engines. One, the advanced "Blue-Flame 125" engine, delivering 125-h.p. and teamed with the highly perfected Powerglide Automatic Transmission, now available on all models at extra cost. And the other, the advanced "Blue-Flame 115" engine, deliver-

ing 115-h.p. and teamed with the highly improved Synchro-Mesh Transmission, providing smooth, quiet gear engagement. Both of these engines bring you sensational new power and performance as well as new and improved gasoline economy. Come in; see and drive this smarter, livelier, thrifter Chevrolet and place your order now!



Builder of more than twice as many VALVE-IN-HEAD ENGINES as all other makers combined

SMITH BROS. CHEVROLET CO.

PHONE 26

GORMAN

HIGGINBOTHAM BROS. & Co.
GORMAN, TEXAS
"EVERYTHING"