

## Also Elects Seibert VP

# IFC Retains Controversial Clause

By **BILL HEARD**  
Toreador Copy Editor

Tech's Interfraternity Council voted Wednesday to retain a newly added amendment restricting its hearings to members and persons it "deems necessary."

Over the past weeks, IFC has expressed dissatisfaction with news coverage and has complained of "sensationalism" accorded stories about the organization and its members.

**THE DECISION** to retain the clause capped a series of negotiations with the Student Publications Committee, THE DAILY TOREADOR staff, and delegates of the IFC in a Feb. 6 meeting attended by Charles Richards, TOREADOR editor, and Bronson Havard, assistant news editor.

In meetings with the Publications Committee and THE DAILY TOREADOR staff, Pete Feather, IFC president, with members of his committee attempted negotiations for TOREADOR guarantees to give IFC more favorable news coverage.

In the Wednesday afternoon meeting, THE DAILY TOREADOR staff recommended that a liaison officer be appointed by IFC to work with news media, covering meetings and court proceedings. The staff offered a four-point program for cooperation with IFC:

- An executive order would be issued to reporters covering IFC proceedings stressing a thorough checking of facts before the story is written.
- Only qualified reporters would be allowed to report IFC proceedings.
- The IFC would be given access to news columns and letters to the editor for rebuttal on any points so desired.

● THE DAILY TOREADOR would publish a feature, or features, explaining the workings of IFC, its projects, etc.

IFC's committee members asked for coverage by a reporter not associated with any fraternity in order to assure unbiased reporting. The committee also asked for guarantees that any facts IFC feels need to be delayed will be honored by the newspaper.

**ROYAL FURGESON**, committee member, during discussion before the adoption of the motion retaining the disputed clause, said, "It seems the conception of the press is that you don't ask a newspaper to do certain things."

Tommy Ewens, another member, thought, "it will help the whole system in the long run to have our stories printed," but suggested that the clause be left in the constitution.

Furgeson stressed that IFC is "trying to lay a strong foundation for the IFC but we need something in writing for future years." He and others voiced fears that future DAILY TOREADOR staffs would fail to cooperate with IFC in news coverage.

Leo Brown, a Kappa Sigma delegate, noted that originally the clause was directed at keeping IFC proceedings restricted to IFC delegates and was not aimed at keeping the press out.

**ON THIS POINT**, Ewens agreed, "I think it is an outside chance we'd ever bar the press."

Following the passage of the motion retaining the clause, it was moved the clause be again referred to committee for reexamination. The same committee that revised the old court proceedings after the recent Sigma Chi hazing case and recommended the restric-

tion clause was directed by Feather to do the study.

Elections to fill posts vacated after the fall semester placed Guy Seibert, Sigma Alpha Epsilon, in the vice president's chair. Bill Honey, Sigma Chi, was elected secretary and Posey Brown, Alpha Tau Omega, will begin his second term as treasurer.

After meeting with the new officers, Feather appointed a new five-man court. To serve are Guy Seibert, Sigma Alpha Epsilon; Larry Lawrence, Kappa Sigma; Johnny Ayres, Phi Gamma Delta; Royal Furgeson, Phi Delta Theta; and Tommy Ewens, Alpha Tau Omega.

An appellate court made up of three faculty members not closely associated with fraternities was discussed.

A by-law setting up suspension and expulsion rules for fraternities habitually absent from IFC meetings was passed 8 to 2. A fraternity missing three regular and special meetings may be placed on suspension to last for 35 consecutive school days. After missing five meetings, a fraternity may be expelled from IFC and may regain its membership only by a three-fifths vote of IFC court.

Under both suspension and expulsion a fraternity loses its vote, use of floor, and all rights except that of attending meetings.

In other action, a motion to change the start of official rush week from 12:01 p.m. Saturday to 1 a.m. Sunday was passed. Larry Doty, Kappa Alpha, moved that a committee be appointed to look into possibilities of a pre-semester rush week, similar to that of sororities, for fraternities. His motion was passed.



**GOT A PENNY?**—Talley Bell and Bet Keller celebrate Valentine's Day with a box of candy and a handful of pennies. The candy is self-explanatory and the pennies will go to AWS—one for each minute they remain out past the regular Thursday night dorm deadline.

—Staff Photo

## You Gotta Be My Valentine - Please?

By **ARTIE SHAW**  
Toreador Staff Writer

The spirit of St. Valentine reigns.

Tuesday's mail brought me a card saying, "You gotta be my Valentine!" I was genuinely touched by its urgency, being the typical red-blooded American boy.

"Good grief," I gasped, "I have a fan!"

All was not lost. A new outlook on life came over me. I suddenly realized that woman-kind is not so stupid after all. The knock on my proverbial heart had been enacted with much **vigah**.

"Alas and alack," I thought. "One must not judge a book by its cover."

So I opened the creation of love to find what bits of romanticism its inner portion held.

And inside I found a picture of a forlorn woman standing in the snow, holding a newborn babe.

I was shattered. Was this romantic? How incongruous can a creation be? What did a woman with a baby have to do with love and true romance? I was dumbfounded.

Maybe the poor love-starved fool who sent the card had a preoccupation with domestic affairs. Maybe she had a maternal complex.

Ah, for the days of yore—when men were men and love was love.

However, in every black sheep one can find strands of white hair. I have found one.

A friend once told me of his truthful approach to the touchy process of date-getting. It went like this:

He called the girl and made an attempt to obtain the "big date." "Hi," he said, "this is Joe Smith (we will change his name to protect his love-sick identity). I'll be very honest

with you. I would like to have a date with you and I am a firm believer in honesty. I have no car, no fraternity pin, no money and very little social status. To be truthful, I even like Mozart and Bach better than Peter, Paul and Mary and Joan Baez."

The course of love sometimes runs true. Her answer was encouraging—and honest.

"Sure," she replied, "I'd love to have coffee with you—some-time next year."

This type thing makes one's heart warm with love for the sincerity of the feminine race. They don't care about superficialities—only the true person matters to them. Money doesn't count.

Sigmund Freud was a great man. He lifted the female from her Victorian role. He made her a person. She is no longer a slave to man. Praise Sigmund Freud!

Think of it. Without Freud and his followers Valentine Day would be worthless. Who sends a card of love to a slave?

While we're asking questions—who sends cards with pictures of women with babies to males on St. Valentine's Day?

Praise Sigmund Fredd, St. Valentine and Mickey Mouse!

### AWS To Sponsor Valentine Special

Valentine's Day may be even costlier this year than last. Along with the usual flowers, candy and cards, AWS is sponsoring a "penny - a - minute" night in all women's dormitories.

Money for "penny-a-minute" night goes to AWS to help finance various projects.

Senior girls will be allowed to stay out until 12 p.m. and freshmen, sophomores and juniors may stay out until 11 p.m.

# British Actors Play In Powerful Drama



STAR IN DRAMA — George Cormack and Carol Marsh star in "Music at Midnight," a powerful British political drama to be presented at 8 p.m. Tuesday in Municipal Auditorium.

The only Lubbock performance of "Music at Midnight," an intensely moving drama which played over 200 performances in London, will be presented in Municipal Auditorium at 8 p.m. Tuesday.

A story of 24 hours of political and personal action on both sides of an "iron curtain" is presented with telling force by an outstanding cast of British actors, headed by Nora Swinburne and Walter Fitzgerald. Both are well known to American audiences through their many appearances on Broadway and in films.

#### Flown From England

The handsome production, flown directly from England for its American tour, premiered in Los Angeles last month. It was met immediately with enthusiastic acclaim from critic and audience alike and drew a fantastic opening night attendance, akin only to early movie premieres.

At a subsequent performance in Palm Springs, the cast was honored by the presence of General and Mrs. Eisenhower.

#### Writer Is Former Newsman

"Music at Midnight" was written by one of England's best known playwrights, Peter Howard. Until a few years ago, he was considered the most influential political writer on the London Daily Express.

Appalled by the lack of awareness and indifference which historically leads to the decline and fall of nations, Howard turned his writing talents to politically inspired dramas.

#### Encourages Action

He is determined to demonstrate that heroes are men and women of today as they have been for centuries, and to urge action and resistance to decadence and defeat, even as people of all suppressed nations are doing now behind the iron and silk curtains which imprison them. It is a powerful, captive drama played in the finest tradition of theatre at its best.

Student tickets can be obtained for "Music at Midnight" from Lubbock Municipal Auditorium for \$1.

## Three Take Trophies For Speaking Abilities

Trophies were presented Monday to first place winners in the second round of the Intramural Speech Tournament.

Second round trophy winners were: Juanice Newbill, poetry interpretation, representing Sock and Buskin; Judy Eaton, humorous reading, also from Sock and Buskin; and Carol Brennan, extemporaneous speaking, entering from Pi Beta Phi.

Second and third place winners respectively in each division were: Pat Rolfe, Pi Beta Phi, and George Bailey, Thompson Hall, poetry interpretation; Carol O'Connell, Alpha Chi Omega, and Kay Sanders, Delta Delta Delta, humorous reading; Pat Eakins, Alpha Chi Omega, and Michele LaMarca, Kappa Kappa Gamma, impromptu.

The final round of the tourney is scheduled for April. At that time the sweepstakes trophy will be presented to the organization with the most points. Sock and Buskin now leads with 141 points, followed by Pi Beta Phi, 102 points; Alpha Chi Omega, 91; Chi Omega, 79; Pre-Law Club, 47;

Kappa Kappa Gamma, 38; Delta Delta Delta, 30; Thompson Hall, 15; Angel Flight, 4.

Judges for second round events were Robert Fields, Bennie Gilchrist, and Edwin Hall, poetry; Don Garnett, humorous readings and poetry; and Durward Porter, impromptu.

James G. Robbins, director of forensics, is conducting the tournament series.

## Lost & Found Is Relocated

Lost & Found has been moved from the Tech Union cigarette counter to room 204, according to Alpha Phi Omega members. New hours are 11-12 a.m. and 1-5 p.m. Monday through Friday.

Members of the service fraternity urge all students with lost articles to check for them at the new location.

### HI FI COMPONENTS

Acoustic Research	Garrard
Ampex	Electro-Voice
H. H. Scott	Thorens
Shure	Dynakit

OPEN TIL 9 P.M. THURSDAYS

### HI-FIDELITY

of Lubbock, Inc.

SHerwood 4-8733 • 2237 34th STREET • LUBBOCK, TEXAS

#### LOSE SOMETHING?

Articles which were lost by contestants in the Miss Mademoiselle contest may be claimed by identifying the lost item and picking it up in the Journalism Bldg., room 102.

### Tuxedo Rentals All New Stock

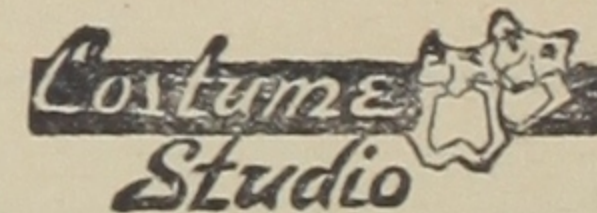

COSTUMES FOR ALL OCCASIONS  
2422 Broadway — PO3-2388

## HOWARD TOURS

THE ORIGINAL STUDY TOUR IN THE PACIFIC

### HAWAII TOUR

SIX UNIVERSITY CREDITS

56 DAYS . . . \$589 Plus \$9 Tax

Attend University of Hawaii summer session. Includes jet roundtrip between West Coast and Hawaii, residence accommodations, and the greatest diversification of dinners, parties, shows, cruises, sightseeing events, beach activities, and cultural entertainment; plus all necessary tour services. Steamship passage and neighbor island visits available at adjusted tour rates. 1963 "Big Summer in Hawaii" — the biennial year of the Trans-Pacific Yacht Race from Los Angeles to Hawaii.

### ORIENT TOUR

SIX UNIVERSITY CREDITS

67 DAYS . . . . . \$1989

San Francisco State College summer session program. Hawaii, Japan, Formosa, Hong Kong, Philippines, Vietnam, Thailand, and Singapore — fabulous program for sophisticated travelers whose intellect, adventurous spirit, and previous travel make them ready for one of their most exciting travel experiences. Includes combination steamship-air travel between West Coast and Orient, plus all first class services ashore — hotels, all meals, sightseeing, all tips, and the most extensive schedule of special dinners, cosmopolitan entertainment, evening events, and social functions; plus all necessary tour services. Also available — 21 day extension Around the World Study Tour; 3 university credits.

### SO. AMERICA

SIX UNIVERSITY CREDITS

45 DAYS . . . . . \$1799

San Francisco State College summer session program. Panama, Colombia, Ecuador, Peru, Chile, Argentina, Uruguay, and Brazil — highlighted by excursions to the Andean highlands, the lost cities of the Incas, Iguassu Falls, and Brasilia; a great educational and adventurous experience. Includes air roundtrip from Miami, and very best hotels, meals, sightseeing, evening activities, social functions, and special events; plus all essential tour services.

### EUROPE TOUR

SIX UNIVERSITY CREDITS

43 DAYS . . . . . \$1499

San Francisco State College summer session program. England, Holland, Germany, Switzerland, Austria, Italy and France — a continental vacation encompassing exciting and traditional highlights of Europe, with many fascinating "off the beaten path" excursions — a truly Grand Tour. Includes jet roundtrip from New York, meals, sightseeing, tips, all necessary tour services.

Howard Tours

Mrs. C. C. Turner

Southwest Representative

6311 Hillcrest, Dallas 5, Texas

Tel: LA 6-2470 Res. LA 8-6224



## The Brute

Mennen Spray Deodorant is rugged. Hard working. Long lasting. Delivers 3 times the anti-perspirant power of any other leading men's deodorant. That's right. 3 times the anti-perspirant power. Mennen Spray... in the handy squeeze bottle. What a brute!



## Sled Accidents Hurt Techsans At Local Park

Two Tech students are recovering from minor injuries received Monday in sledding accidents at Mackenzie State Park.

Linda Booker, Fort Worth sophomore, suffered a 10-stitch cut on her leg when she fell on a snow-covered broken bottle.

Donald Bethel, Lamesa sophomore, received a cut on his hand requiring seven stitches when he sledded into a tree. Both were treated at Methodist Hospital.

#### ATTENTION

COEDS!

Skin Problems?

Skin Consultation & Skin Care With LUZIER

Call for Free Appointment after 3:00 p.m.

Carrol Fisher  
SH 4-4733

Lydia Duncan  
SH 4-5222

# Home Economists Here For Two Conferences

Texas Tech will host home economists from throughout the state at two meetings this week.

The Texas State Nutrition Council begins its one-day meeting at 9 a.m. today, and registration for the Texas Home Economics Association three-day conference opens at 6 p.m.

The Nutrition Council will meet in Lubbock for the first time in its history. In the Council's afternoon sessions, all at the Pioneer Hotel, Dr. Mina Lamb, head of Tech's department of food and nutrition, will present "Nutrition of Young Children."

At the THEA conference, Dr. Willa Vaughn Tinsley, dean of Tech's School of Home Economics and president of the THEA, will preside. Dr. R. C. Goodwin, Tech president, will give a welcome in the opening business meeting Friday morning.

Lasting through Saturday, the THEA's conference will be highlighted by the presentation of "Home Economist of the Year."

Exhibits will be on display in the Tech Union ballroom for Association members. Also on the agenda for the conference are a "Prairie Party" in the West Texas Museum, a dinner meeting in the Anniversary Room of the Union, and a concluding luncheon in the Union ballroom.

In addition to Dr. Tinsley and Dr. Lamb, members of the Tech

faculty participating in the programs include Dr. Paschal N. Strong, associate professor of psychology; Dr. Berlie Fallon, professor of education; Mrs.

Wildring Edwards of the home and family life department; and Miss Nickie Woelfel, past vice president of the Texas Home Economics college chapter.

## A Phi O Seeks Beauty And Beast

A Phi O's annual search for "Beauty and Beast" contestants is now underway.

All campus organizations are urged to enter contestants in either category.

Entries must be accompanied by an 8x10 photo of the contestant, according to Frankie Claunts, A Phi O president. Attached to the photo must be the contestant's name, classification, and sponsoring organization.

A \$5 fee must accompany each entry, which should be mailed to "Beauty and Beast" Contest, 2628 Auburn, Lubbock, by Feb. 20.

Winners will be announced at a dance following the Tech-Rice game Feb. 23. Everyone is invited to the dance in the Coronado Room of the Tech Union, and each couple attending will be given ten free votes. Additional votes may be purchased at the dance for one cent each.

Individual prizes will be awarded to the winners of the contest

and the sponsoring organization will receive a traveling trophy.

Claunts emphasized that checks should be made out to Alpha Phi Omega, and all photos would be returned.

## Newman Members Attend Meeting

Three Tech students were elected to province offices of the Newman Club, Catholic student organization, at the Texoma Province Convention in Dallas last weekend.

Elected were Sam Burt, extension vice president; Marianne McCarthy, internal affairs vice president; and Rita Witkowski, secretary.

Twelve members of the Tech Newman Club attended the convention with Father William Hanley, chaplain of the local group.

The keynote speaker at the general session was Rev. Richard Butler, national club chaplain.

## Drops Get 'W' Until March 4

Students wishing to drop a course for a grade of "W" may do so beginning today and continuing through March 4.

To drop a course, a student should see his academic dean to obtain drop slips. One slip is to be signed by the instructor in the course being dropped. A fee of \$3 must be paid to the Auditor's office cashier for each course dropped.

SLEDS - TOBOGGANS

SKIS - BOOTS - POLES

SKI CLOTHING

A complete line of Physical Education Equipment

HOLT'S Sporting Goods Company  
601 COLLEGE of Lubbock, Texas

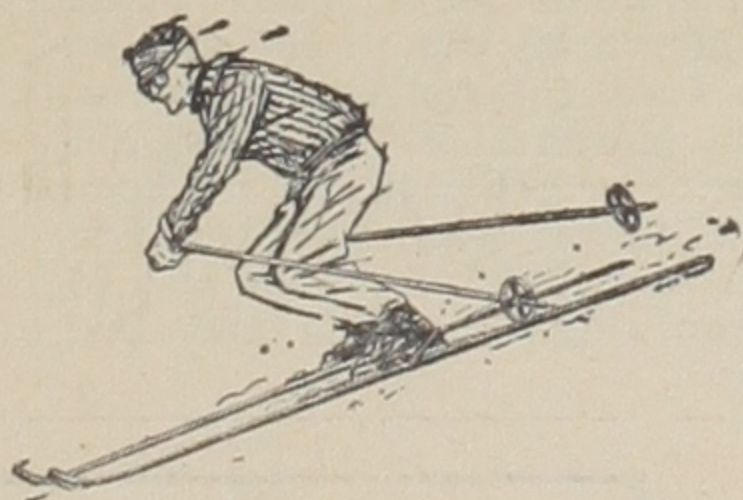

## SPORTSMANSHIP

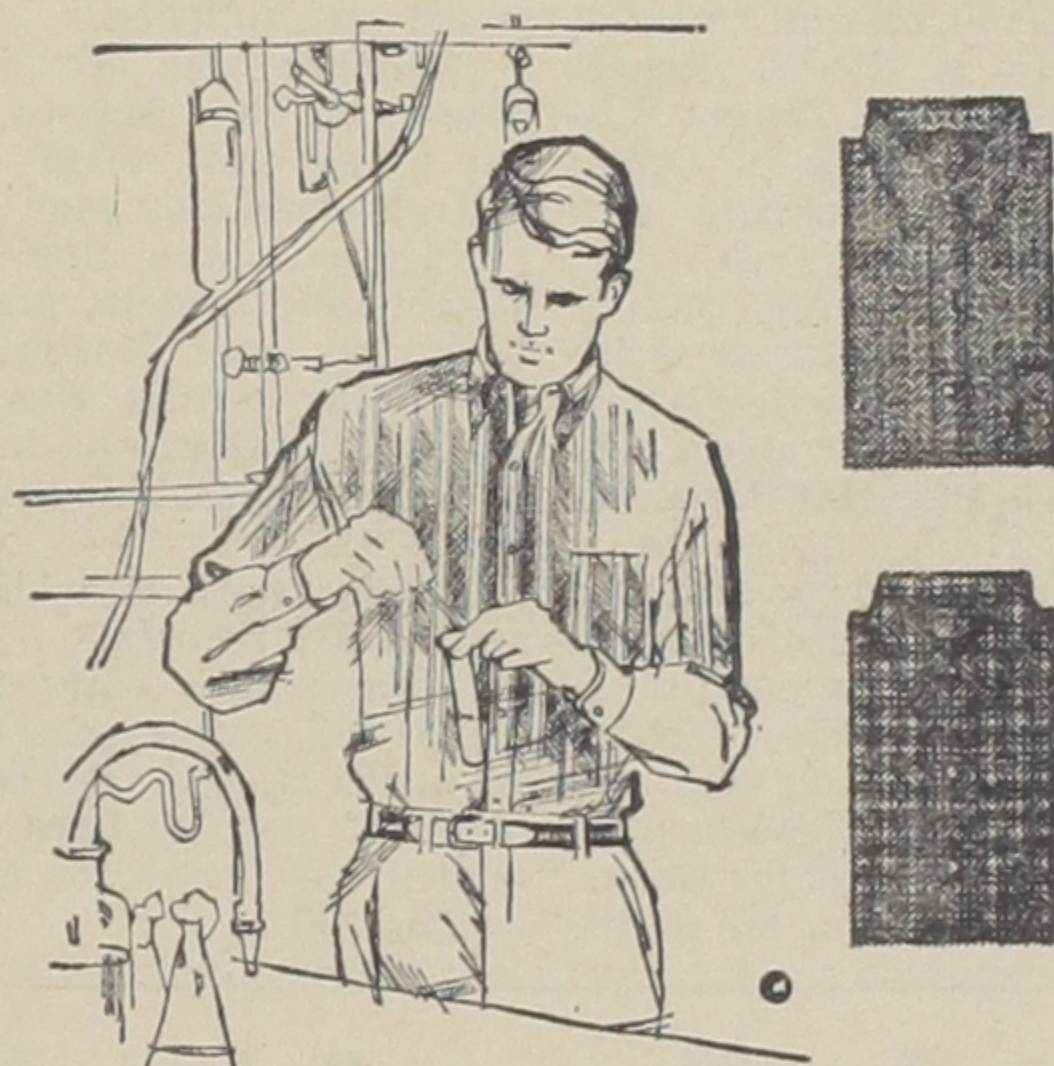

The active sportsman and he who eases up in sport shirts will score high the traditional styles which may be purchased in a variety of fine fabrics...in this sporting collection.

4.95 - 6.95

Use your College Charge Account

S & Q Clothiers  
**COLLEGE CORNER**  
1108 Broadway - - - Downtown

## TECH ADS

TYPING: Themes, thesis, research papers. 4519 40th St., SW 5-4565.

I do ironing in my home, \$1.50 per doz. PO 2-4513, Mrs. Etta Mae Lambert, 710 3rd St.

TYPING: Experienced. Thesis, term papers and research papers. Fast service. Mrs McMahan, 1412 Ave. T, PO3-7620.

Fast, accurate typing in my home. PO 2-2474.

TV rentals, Tech student discount, more economical than buying, free upkeep, no deposit. Phone PO 5-9914.

Garage apartment, efficiency kitchen, large bath. Swimming privileges. Two blocks from campus. \$45 single. 2619 21st.

Experienced seamstress, expert fitting, weddings, formals after-5 gowns. Mrs. Ethel West, 5432 32nd, SW 5-2951, if no answer call evenings.

Excellent economy car, 1960 Renault, radio, heater, white side walls, good tires, 33 mpg. SW 5-1189.

Bedroom, share my home, garage, close to Tech, bus and shopping center. 2603 1st Place. PO 3-4508.

Knight 40-watt stereo amp-preamplifier, musicmaster turntable, Knight diamond needle cartridge, 2 Norelco 12" speakers (Karlson enclosures). Call 885-4957.

For Sale: Ampex 1260 4-track stereo recorder. Separate record and playback facilities, separate line and microphone mixing, 3 months old. Call Curtis Polk at SW5-5889 or SW5-9122.

Private room, large, private, quiet, 2 blocks from Tech. \$25 per month. See Roy Gladson at Varsity Barber Shop.

FOR SALE: Mobile Packard lounge, complete with Hi-Fi, central heat and large dance area. \$100.00 Ext. 2579.

FOR SALE: Large Magnavox portable stereo. Excellent condition. Good tone quality. \$150.00. Call SW5-0223.

1/2 blocks of Tech, first class furnished efficiency apartment, carpeted, furnace, bills paid. 2313 14th St.

Ironing wanted. \$1.50 per dozen. 2717 Baylor.

# Tech Village Apartments

for Married Students

### LOCATION

Tech Village Apartments are located on the north edge of the Texas Tech campus. One block north of National Guard armory. The apartments are within walking distance of all Tech facilities, but ample free parking is available at Tech Village.

### APARTMENTS

Tech Village Apartments, designed exclusively for married students, are modern, attractive living room, bedroom, kitchen-dining room and bath units. They are furnished in contemporary style to suit the needs of the married students. Air conditioning, heating, and all kitchen appliances supplied by GENERAL ELECTRIC.

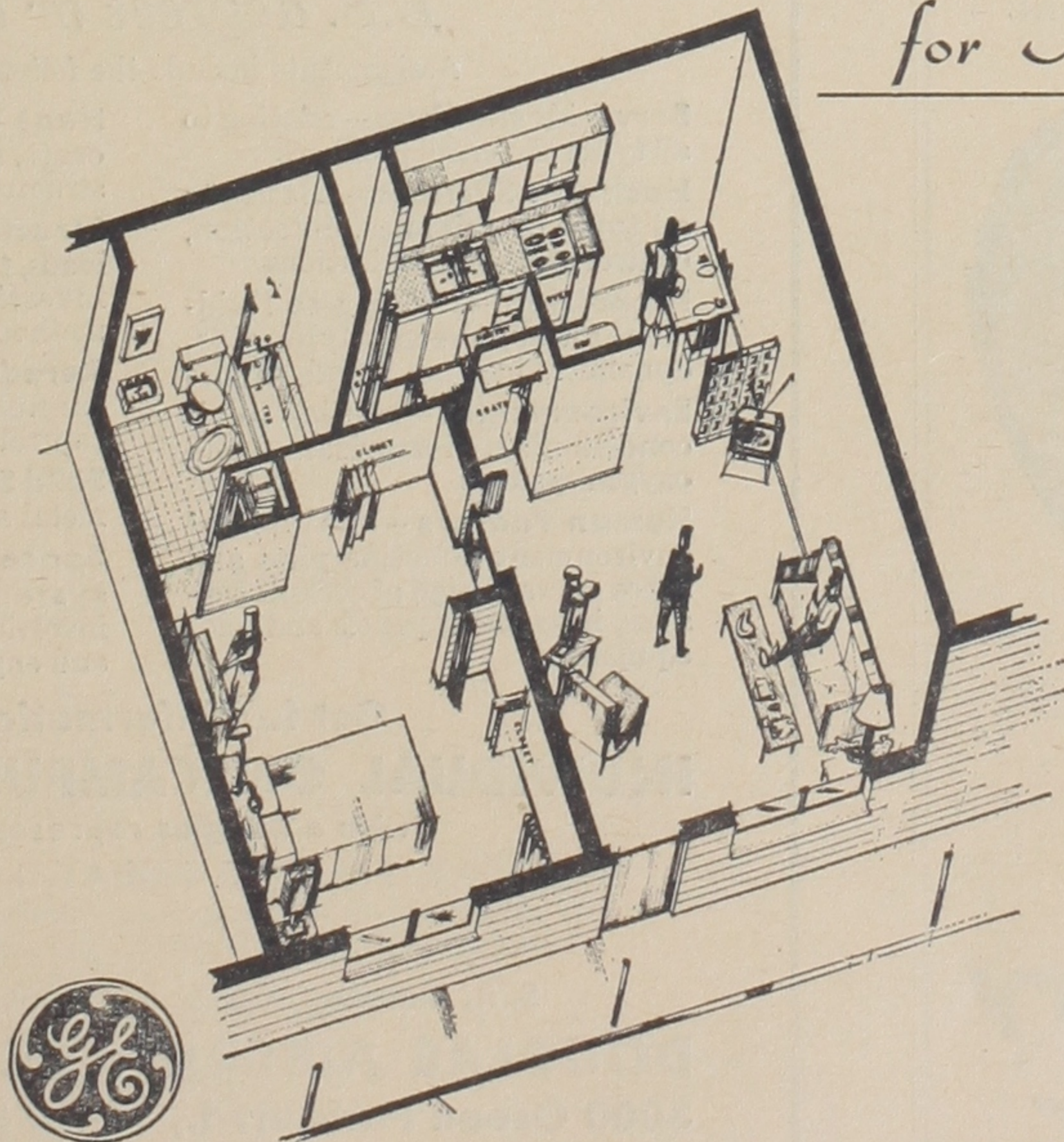

Detroit & 3rd Place VISITORS WELCOME Phone PO4-0649

# Footballers Sign Letters Of Intent

Eight backs and four linemen from Texas and New Mexico high schools have signed letters of intent to play football for Texas Tech next year, J T King announced yesterday.

Tony and Pete Estrada from Littlefield, Danny Shelton from Quanah, Gilbert Coats of Amarillo, Ray Hallmark of Clovis, Charles Mitchell of Childress, Danny Ellsworth and Guy Griffis of Dallas Samuell are the backfield men who agreed to attend Tech.

The four linemen are Stanley Edwards, Dallas Northside; Clifford Smith, Fort Worth Carter-Riverside; Quenten Reynolds, Wilmer-Hutchins and Bill Herndon, Sweetwater.

Tony Estrada was considered one of the outstanding backs in Class AAA. He was named as one of the finest defensive backs in his district. Brother Pete was one of Coach John Howle's most valuable assets at blocking back. Mitchell has timed a 9.7 in the

hundred and gained 1,270 yards this year. Coats, an excellent quarterback for Denver City back in the Bert Gravitt days, moved to Amarillo his junior year. He will probably play end for Tech.

Shelton is an all-around ball-player, having played end, center, guard and fullback.

Hallmark was one of the top players in New Mexico last year. He made first team all-district and all-state last year.

Ellsworth is a fine all-around student and athlete, playing half-back this past season for Samuells, Guy Griffis was the field general for Samuells but probably will be moved to the line next year.

Tackle Smith is a big boy, 6-1, scaling 210 pounds.

Edwards also plays tackle. He stands 6-3 and weighs 205 and is an honor student. Reynolds is another of the big boys that Tech landed this year. He is 6-3, and weighs 190.

## Philbrick Announces Court Team

George Philbrick, Tech tennis coach, has announced the 1963 varsity tennis schedule and team members.

Beau Sutherland and Daryl Allison, who surprised everyone last year by winning the SWC doubles title spearhead this year's team that will play 16 matches. Their first match will be March 2 with Trinity University in San Antonio. Trinity boasts the number one and two players in the nation in Chuck McKinley and Frank Froeling. McKinley finished second in the Wimbledon behind Ron Laver, who eventually won the coveted tennis grand slam.

Allison, who is captain of the team, was the number one singles player last year and is battling for the position against sophomores Greer Kothman of Junction and Robert Peterson of Wichita Falls. Also in line for the spot are Don Draper of Houston and John Gottschall of Midland. Other team members are Don Foils, Edinburg, and Fred Wickett from Fort Worth.

Following their home match with Trinity, they will travel to San Antonio for a return match on March 20 and to Houston for the Rice Intercollegiate Tournament March 21-23. The first conference match will be at home with Baylor, April 6, followed by SMU and TCU, April 19 and 20, respectively in Dallas and Fort Worth.

## Tech Honors 1939 Basketball Team

Texas Tech's 1938-39 basketball team will be honored at the Red Raiders' game with Baylor University here Saturday night. Berl Huffman was coach, and

Elmer Tarbox, captain. Huffman is now head baseball and freshman football coach at Texas Tech. Tarbox is in business in Lubbock. The team won 12 games and lost only six.

### HABERDASHERY



Our haberdashery is a habit with best dressed gentlemen of our community. If you would join the ranks, you will be most heartily welcomed. A few of our wares are shown here.

Use your College Charge Account

S & Q Clothiers  
**COLLEGE CORNER**

1108 Broadway - - - Downtown

### U-Need-A Cleaners & Laundry

Call PO5-7385 2424 8th St. Cor. 8th & College.

- UNEEDA New Pocket
- UNEEDA New Zipper
- UNEEDA Button
- UNEEDA Alteration

You need to always remember U-Need-A Cleaners  
VELMA McDONALD, Owner

SEND A

# VALENTINE

by NORCROSS

A NEW and wide selection of Valentines are still available . . . Don't fail to send yours . . .

Also, an ADORABLE  
STUFFED ANIMAL

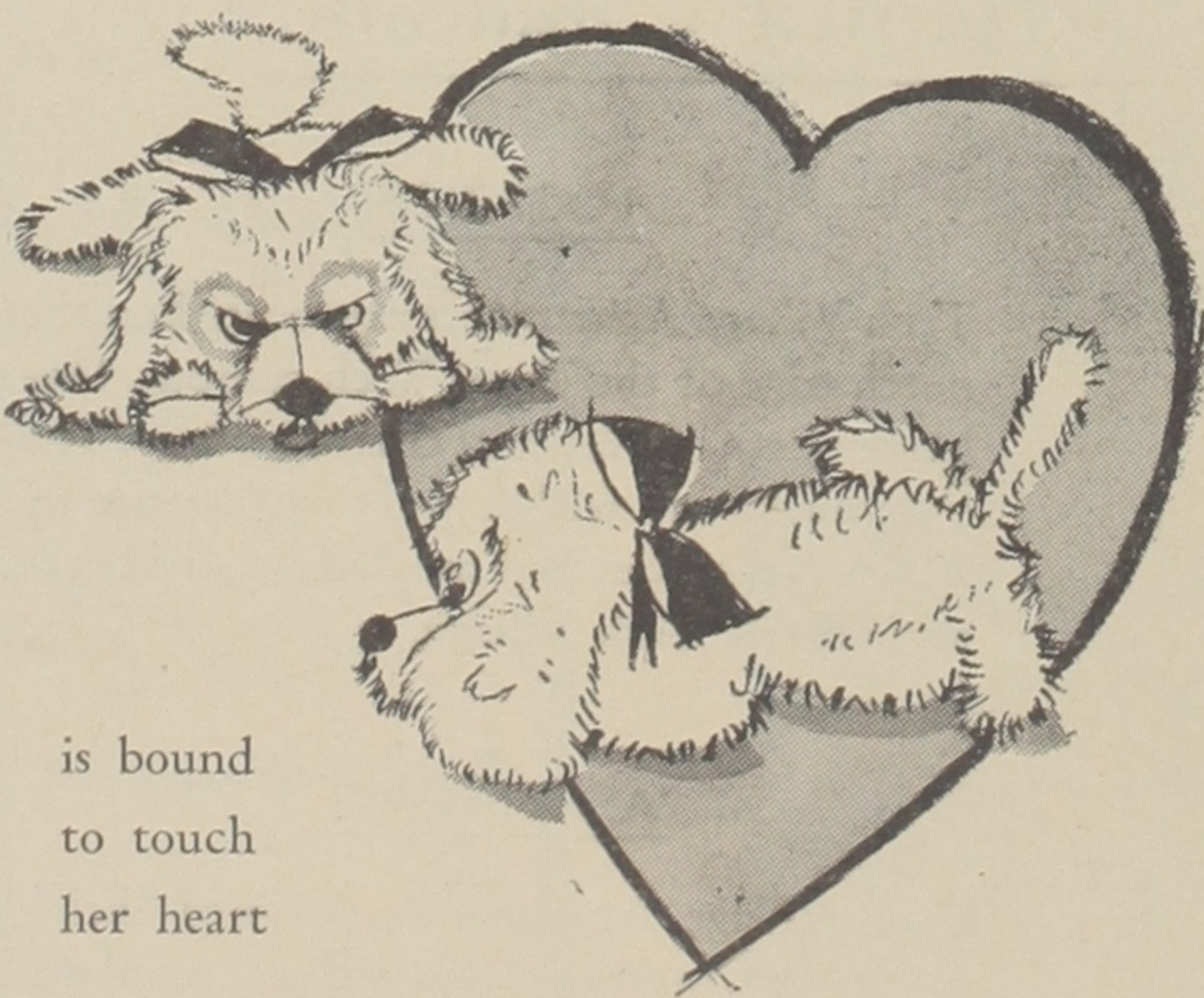

is bound to touch her heart



## Book & Stationery Center

1103 College Ave. PO5-5775

## ADVANCED AEROSPACE PROGRAMS AT DOUGLAS

*have created outstanding career opportunities for*

### SCIENTISTS and ENGINEERS

*B.S. degrees or better*

Assignments include the following areas:

<p><b>Servo-Mechanisms</b> — relating to all types of control problems</p> <p><b>Electronic Systems</b> — relating to all types of guidance, detection, control and communications</p> <p><b>Propulsion</b> — relating to fluid-mechanics, thermodynamics, dynamics, internal aerodynamics</p> <p><b>Environmental</b> — relating to air conditioning, pressurization and oxygen systems</p> <p><b>Human Factors</b> — analysis of environment affecting pilot and space crews, design of cockpit consoles, instrument panels and pilot equipment</p>	<p><b>Heat Transfer</b> — relating to aircraft, missile and space vehicle structures</p> <p><b>Structures</b> — relating to cyclic loads, temperature effects, and the investigation of new materials, methods, products, etc.</p> <p><b>Aerodynamics</b> — relating to wind tunnel, research, stability and control</p> <p><b>Solid State Physics</b> — relating to metal surfaces and fatigue</p> <p><b>Space vehicle and weapon system studies</b> — of all types, involving a vast range of scientific and engineering skills</p>
---	---

**Get full information at**  
**INDIVIDUAL ON CAMPUS INTERVIEWS**  
with a Douglas representative

THURSDAY, FEB. 28 & FRIDAY, MARCH 1

We urge you to make an appointment through Mrs. Jean A. Jenkins, Director, Placement Service. If you cannot, please write to

S. A. Amestoy, Engineering Employment Manager

**DOUGLAS AIRCRAFT COMPANY, INC.**  
3000 Ocean Park Blvd., Santa Monica, California

An equal opportunity employer