

Green Thumb program salutes older workers

Three local women have been involved in the Green Thumb program for years and are examples of how this program can be an asset to the community and to the non-profit places in which they work.

The week of March 12-18 has been proclaimed "Hire the Older Worker Week" and that is just what the Green Thumb program does. It salutes the ability of older workers and encourages people to employ them.

"Hire the Older Worker Week" is a time to spotlight the contributions of these seniors, Thursie Reid, Adele Tompkins and Lena Ruthardt of Muleshoe, and what they bring to the local labor force.

Adele, Thursie and Lena all work for what they are paid and are highly depended on at their working places at the Texas Department of Health

Office in Muleshoe, the Muleshoe Public Library and at Muleshoe Healthcare Center.

Green Thumb, Inc. has operated the Senior Community Service Employment Program for 13 years. The program provides the nation's seniors with part-time employment and training opportunities. The Green Thumb program operates primarily in 132 rural Texas counties.

Lena has worked at Muleshoe Public Library for nine years, helping out with a variety of library operational tasks.

"I like my job very much because it makes me feel independent," Lena said.

Adele Tompkins has worked at the Texas Department of Health for 12 years, where she helps keep medical records, post lab reports, type and do other tasks.



DEDICATED WORKER - Employed under the Green Thumb Program, senior citizens like Thursie Reid (Center) get the opportunity to put their skills to use and serve as valuable workers for the non-profit organizations they work for. Thursie is one of three local Green Thumb employees and works at Muleshoe Healthcare Center, where she helps coordinate activities such as this card game for residents.

"I have enjoyed my work," Adele said. "It has been a learning experience for me, learning about medicine." She is supervised by Registered nurse Judy Jacobs.

"I like the Green Thumb program because it is only part-time and I never feel dis-

criminated against because I am older," Adele said. "People here depend on us and we help ease the work load."

Thursie Reid has worked with the Green Thumb program at Muleshoe Healthcare Center for three years. She basically assists residents with ac-

tivities.

"I like everything about my work here, I love these people, everyone of them," Thursie said.

"I have gotten a lot of experience, learning to get along

Continued on page 2

Around Muleshoe

Pep High School graduation slated

The management board and staff of Pep High School invites the public to attend a graduation ceremony Friday at 1:30 p.m. followed by an open house at Pep High School on Highway 303.

Graduation speaker will be Miss Texas Adrian Archer.

Applications for scholarship now available at MHS

All Muleshoe High School seniors are welcome to apply for the Kristy Landers Memorial Scholarship. Applications are now available from the MHS counselor or call 272-4488.

The final day to apply is April 3.

Drawing for place on ballot to be held Thursday

A drawing to determine the order in which names of candidates are to be printed on the ballot for the School Trustee May 6 election will be held Thursday, March 23 at 8:30 a.m. at the Administration Building.

Wednesday, March 22 is the deadline to file an application for a place on the ballot and April 6 is the deadline for a write-in candidate to file.

Benefit luncheon for Shaws slated

Friends, neighbors and church family are hosting a benefit luncheon for Eugene and Donna Shaw. A Mexican pile-on will be served on Monday, March 20 from 11 a.m. to 2 p.m. at the Muleshoe

Continued on page 2

Precipitation enhancement workshop to be held

During the past year, many High Plains residents have wondered just what they could do to make it rain and relieve the dry conditions across the region.

Many large white clouds full of moisture have passed over the region but they have refused to release their precious cargo.

Weather experts from across the country will meet to address this problem and discuss one possible solution: precipitation enhancement.

The Texas Tech Water Re-

sources Center, the Texas Natural Resource conservation Commission and the High Plains Underground Water Conservation District No. 1 will sponsor a workshop on precipitation enhancement in Lubbock at the Sheraton Inn on April 7, 1995.

Workshop topics include the history, legal aspects, and the cloud seeding process. Workshop participants will also have the opportunity to review the progress of current cloud seeding projects in Texas.

The Colorado River Municipal Water District has operated a cloud seeding program since 1971.

Representatives of the District will also be at the workshop to present information on their program. According to CRMWD officials, the cloud seeding has increased average annual rainfall by 30 to 40 percent in its target areas.

Precipitation enhancement is an attempt to change or control natural development of precipitation cloud

forms in the lower half of the earth's atmosphere.

Silver iodide is introduced into the cumulus clouds to cause raindrops to form. This also produces a more efficient cloud system that will last longer and produce more moisture droplets.

One positive aspect of precipitation enhancement is that it does not increase rainfall in one area at another area's expense.

Clouds are very inefficient and only release a small portion of their moisture at any

one time. Even after seeding, large amounts of available moisture are still left in the cloud.

The workshop will begin at 8:00 a.m. and conclude at 4:30 p.m. Registration includes meeting costs, one meal, and coffee breaks.

For more information or to register for the workshop, contact Dr. Lloyd Urban, Water Resources Center, Texas Tech University, Box 41022, Lubbock, Texas 79409-1022, or call (806) 742-3597.

Hospital board meets Thursday

The board of directors of the Muleshoe Area Hospital District will meet in regular session Thursday, March 23 at 7 p.m. in the dining room at Muleshoe Area Medical Center.

The board will hear an update on FmHA and review and consider alcohol testing equipment.

They will also hear a report from the administrator, hospital financial and statistical reports and HealthCare Center financial and statistical reports.

An executive session will also be conducted with board action resulting from the executive session, followed by management matters.



VIEWING STUDENT ARTWORK - Donnie and April Coker, along with their son Trevor, view artwork during an open house held at Lazbuddie Schools Thursday night. Other events held in observance of Public School Week were a Parent's Breakfast, band concert and technology fair.

Poster contest and open house to highlight County Government Week

Bailey County will join 254 counties in Texas observing County Government Week April 2-8. The highlights of this year's County government Week celebration in Bailey County will include a poster contest and open house, as well as tours of local facilities.

A poster contest will be open to 3rd through 8th grade students. The deadline for

submission of posters is Friday, March 24. First, second and third place ribbons will be presented to winners in each grade.

Posters will be displayed at area businesses to advertise County Government Week. Posters should depict some aspect of how county government works and it should contain this information: Cel-

brate County Government Week, April 2-8, come to the Bailey County Courthouse Open House, County Government Day, Tuesday, April 4, from 8 a.m. to 5 p.m.

In celebration of County Government Week, as well as the 70th anniversary of the Bailey County courthouse,

Continued on page 2

Blood drive to be held on March 30

A blood drive will be held in Muleshoe Thursday, March 30 from 10 a.m. to 7 p.m. at the Trinity Baptist Church located at 312 East Ave. B. In an effort to further safeguard the community blood supply, United Blood Services will require that blood donors show identification before they donate at the Muleshoe Blood Drive.

The identification program started Feb. 1, 1995 to help United Blood Services assure the accuracy of donor records and verify the identity of each donor.

The ID must have the donor's given name and one of the following: birthday, Social Security number or a picture of the donor. Some examples of acceptable identification

include a current driver's license, a Social Security card, a United Blood Services donor card or a passport.

"Most people carry an ID so we don't expect this requirement to create a problem," said Cheryl Keefer of the United Blood Services.

"We're quite flexible as to

Continued on page 2

Muleshoe

Continued from page 1

Church of Christ Fellowship Hall on 20th & American Blvd.

Donations will be accepted. All proceeds will go to help defray medical expenses for Donna, who is undergoing radiation treatments for cancer and chemotherapy.

Muleshoe Youth Baseball sign up to be held Tuesday

Muleshoe Youth Baseball will have signups for the 1995 Little League baseball season on Tuesday, March 21 at the Muleshoe Volunteer Fire Station Meeting Room from 6-8 p.m. Boys and girls who will be age 6 on or before Aug. 1 will be eligible. Proof of age will be required. There will be signup fees.

Anyone who has equipment or uniforms belonging to the league may turn them in on Tuesday. This may be your

last opportunity to sign up this year. For more information call David Marricle at 272-4863.

Hospital meeting is rescheduled

A special meeting of the Muleshoe Area Hospital District Board of Directors will be held Tuesday, March 21 at 5 p.m. in the dining room. Agenda items include ordering an election for Places 2 and 4 and ordering a special election for place 1.

The meeting, which was originally to be held Thursday night, has been rescheduled for Tuesday.

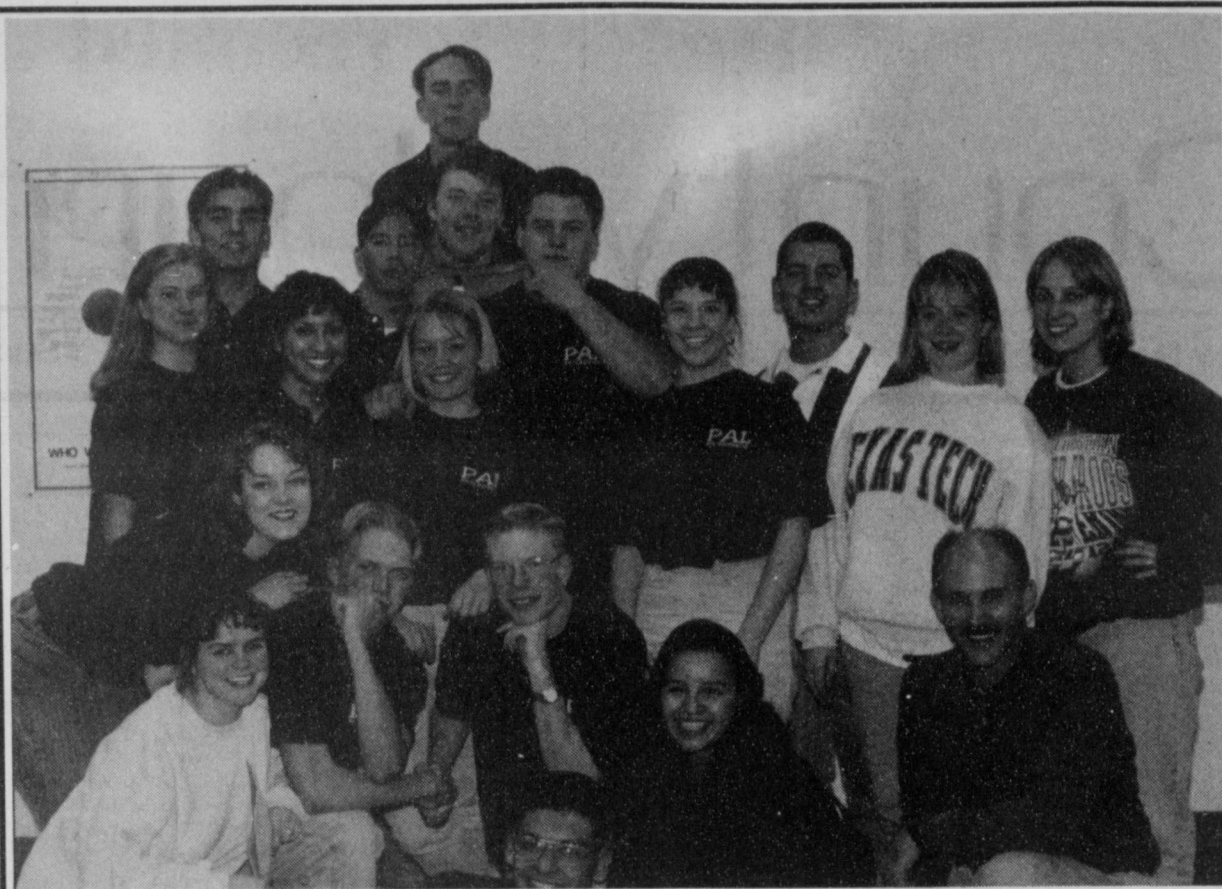

PALS PARTICIPATE IN FACILITATOR TRAINING - Participating in the PAL facilitator training workshop held at Muleshoe High School on January 21 were: (Back, left) Crystal Sharp, Edward Rodriguez, Josie Cortez, Jesus Flores, Crystal Howe, Ryan Clapp, Chad Johnson, Jared Clarkson, Audra Lee, Dacia Stewart, Bryan Field, Riley Byers, Robet Jaime, Hilmar Moore from PAN-Texas. Students from Midland High School and Midland Lee High School, their teachers and Alice Liles, high school PAL teacher.

County

Continued from page 1

officials and employees invite the public to come in, visit and express their concerns and see for themselves how county government is working for them in Bailey County.

In addition, Muleshoe school teachers are invited to call and schedule a tour of the courthouse and Law Enforcement Center for their class

during this week.

County Government Week was created by the National Association of Counties and proclaimed in the State of Texas by Governor George W. Bush to recognize the contributions made by county governments. This annual event is celebrated the first full week of April.

To Receive Your Muleshoe or Bailey County Journal Call 272-4536! Call us Today!

Green Thumbs

Continued from page 1

with the residents. And since many of the residents can't do things for themselves, they depend on us."

Thursie enjoys making coffee for the residence every morning and reminiscing.

Muleshoe Healthcare Center Activity Director Joy Stancell said that the Green Thumb worker, Thursie Reid, is a valuable part of the staff.

"We have to depend on a lot of volunteer help here and Thursie is here everyday," She said. "She is just like another employee, although we do not pay her salary. And we have a lot of residence with different needs. We have to meet their emotional, spiritual and social needs, and that is what Thursie



Adele Tompkins, Green Thumb worker

helps us do."

Employees of the Green Thumb program are paid by funds from the U.S. Department of Labor.

Blood

Continued from page 1

the kind of ID that can be used, as long as it has the donor's name and one of the criteria."

Donors may sign up to give

blood on March 30 or by contacting Glenda Powell at 272-5676.

Country Peddler Show

Lubbock Memorial Civic Center, 1501 Sixth Street
March 24, 25, 26

Show Hours: Fri., 4-9 p.m. • Sat., 9 a.m. - 6 p.m. • Sun., 11 a.m. - 5 p.m.
Admission: Adults \$4 • Children Under 12 Free • Seniors over 65 \$2

"The Perfect Street of Shops"

Furniture, metalwork, quilts, baskets, rugs, dried flowers, clothing, collectibles, teddy bears, pottery, dolls, lamps and shades, woodworking and much, much more... everything quality, original and handcrafted.

American Country Shows, Inc. • Country Peddler Show
P. O. Drawer E Fredericksburg, TX 78624 • (210) 997-0098

Birthday policy

The Muleshoe and Bailey County Journals publish birthday announcements free of charge for babies one year old or for people ages 90 and over. A photo may also be included with the announcement. Complete guidelines and forms are available at the Muleshoe Journal office.

The deadline for items to be submitted is at 5 p.m. on the preceding Monday for the Thursday edition and at 5 p.m. on the preceding Thursday for the Sunday edition.

We Will Beat All Competitors Prices At Furniture Plus • We Will Beat All Competitors Prices At Furniture Plus •

MARCH BLOWOUT SALE

40% TO 60% OFF

0 DOWN - 0 A MONTH FOR 6 MONTHS!
No Payments Til October 1995 O.A.C.
We Will Beat All Competitors Prices!

Vanities Cherry or Oak, Complete With Bench Reg. \$299.99 SALE \$174⁹⁹	5 Dinettes With Fan Back Chairs, With Glass Top, 2 Fabrics To Choose From, Reg. \$399.99 SALE \$299⁹⁹	3 Piece Tables Reg. \$249.99 SALE \$84⁹⁹	5 Piece Bedroom Suite Reg. \$899.99 SALE \$399⁹⁹
--	--	---	---

90 DAYS SAME AS CASH! ON THE SPOT FINANCING!

Entertainment Centers STARTING AT SALE \$149⁹⁹	4 Drawer Chests While They Last! Reg. \$169 SALE \$79⁹⁹	Daybeds Complete With Frame And Link Spring With 5 yr. matt., Reg. \$449.99 SALE \$249⁹⁹	Sofa, Loveseat & Chair Reg. \$899.99 SALE \$499⁹⁹
---	---	--	--

NO REASONABLE OFFER REFUSED! WE WILL NOT BE UNDERSOLD!

NAME BRANDS OFFERED <ul style="list-style-type: none"> • Washington • Universal • LaCrosse • Frisco • Beech Brook • Lehigh • Orleans • Benchcraft • Athens • Stoneville • Bassett • King Koil • Spring Aire • Ashley • Smith • Vaugh 	TERMS OF SALE <ul style="list-style-type: none"> • Mastercard • Discover • On-The-Spot-Financing • Cash or Personal Check • Use Your Furniture Plus Charge Card • Visa • American Express
---	---

FURNITURE PLUS

A Name You Can Trust

421 N. Main, Clovis, NM 505-762-5001

We Will Beat All Competitors Prices At Furniture Plus • We Will Beat All Competitors Prices At Furniture Plus •

LEASE MORE FOR LESS

Brand New Full-Size F-150 \$199 Down \$199 Month

Your Choice Of **56**

Subject to prior sale!

64

Super Cabs & 4-Wheel Drives Also Available
Subject to prior sale!

WE'LL PAY CASH FOR YOUR TRADE-IN!

• Air Conditioning • Cruise Control • Tilt Steering Wheel • AM/FM Cassette • XL Trim • Plus Much More!

<p style="font-size: 2em;">Only \$199 Down</p> <p style="font-size: 2em;">Or Only \$4200 Single Payment</p>	<p style="font-size: 2em;">\$199 Month</p> <table border="1" style="font-size: 0.8em; width: 100%;"> <tr><th colspan="2">THE ARITHMETIC</th></tr> <tr><td>Monthly Lease Payment</td><td>\$199.00</td></tr> <tr><td>Number of Months</td><td>24</td></tr> <tr><td>Refundable Security Deposit</td><td>\$200.00</td></tr> <tr><td>Cash Down Payment</td><td>\$199.00</td></tr> <tr><td>Total Amount Due at Inception</td><td>\$598.00</td></tr> <tr><td>Total of Monthly Payments</td><td>\$4776.00</td></tr> <tr><td>Total Mileage Allowed</td><td>30,000</td></tr> <tr><td>Mileage Charge Over 30,000</td><td>11c</td></tr> </table> <table border="1" style="font-size: 0.8em; width: 100%;"> <tr><th colspan="2">THE ARITHMETIC</th></tr> <tr><td>Single Lease Payment</td><td>\$4200.00</td></tr> <tr><td>Number of Months</td><td>24</td></tr> <tr><td>Refundable Security Deposit</td><td>\$0.00</td></tr> <tr><td>Cash Down Payment</td><td>\$0.00</td></tr> <tr><td>Total Amount Due at Inception</td><td>\$4200.00</td></tr> <tr><td>Total of Payments</td><td>\$4200.00</td></tr> <tr><td>Total Mileage Allowed</td><td>30,000</td></tr> <tr><td>Mileage Charge Over 30,000</td><td>11c</td></tr> </table>	THE ARITHMETIC		Monthly Lease Payment	\$199.00	Number of Months	24	Refundable Security Deposit	\$200.00	Cash Down Payment	\$199.00	Total Amount Due at Inception	\$598.00	Total of Monthly Payments	\$4776.00	Total Mileage Allowed	30,000	Mileage Charge Over 30,000	11c	THE ARITHMETIC		Single Lease Payment	\$4200.00	Number of Months	24	Refundable Security Deposit	\$0.00	Cash Down Payment	\$0.00	Total Amount Due at Inception	\$4200.00	Total of Payments	\$4200.00	Total Mileage Allowed	30,000	Mileage Charge Over 30,000	11c
THE ARITHMETIC																																					
Monthly Lease Payment	\$199.00																																				
Number of Months	24																																				
Refundable Security Deposit	\$200.00																																				
Cash Down Payment	\$199.00																																				
Total Amount Due at Inception	\$598.00																																				
Total of Monthly Payments	\$4776.00																																				
Total Mileage Allowed	30,000																																				
Mileage Charge Over 30,000	11c																																				
THE ARITHMETIC																																					
Single Lease Payment	\$4200.00																																				
Number of Months	24																																				
Refundable Security Deposit	\$0.00																																				
Cash Down Payment	\$0.00																																				
Total Amount Due at Inception	\$4200.00																																				
Total of Payments	\$4200.00																																				
Total Mileage Allowed	30,000																																				
Mileage Charge Over 30,000	11c																																				

Lessee is responsible for excess wear and tear. Includes \$750 factory rebate. Must qualify for \$300 commercial rebate. All rebates assigned to dealer. Lease subject to credit approval and insurability as determined by Ford Credit. Lease payment excludes tax, title and license. Residual \$10,925.36. See dealer for end of lease options.

24 Month Red Carpet Lease - Then Walk Away!
See One Of Our Lease Specialists
Hurry In! This Offer Expires March 27th!

TEAGUE STREBECK

(505) 356-8581 (505) 762-3845
1115 North Chicago
Portales, NM
(On the first curve into Portales)

The very best prices and service anywhere...
We personally guarantee it!

Take trip in time at production of 'Beehive'

Muleplex Productions will present the Amarillo Little Theatre's Sixth Annual Touring Production for 1995, the rollicking Off-Broadway smash by Larry Gallagher, "Beehive." It will be presented at Muleshoe High School Auditorium on Friday, March 31 at 8 p.m.

"Beehive" follows in the footsteps of such fine ALT touring productions as "Nonsense," "Quilters," "Pump Boys and Dinettes," and "The Nerd."

ALT's touring project travels extensively throughout the Panhandle of Texas and eastern New Mexico and was cited as an outstanding example of cultural outreach by the Texas Commission on the Arts in the publication, "Arts In Unexpected Places."

"Beehive" is a nostalgic tribute to the girl groups and the great female singers of the 1960s. Come take a trip in time with the touring produc-



THE CAST - The cast of the upcoming "Beehive" production include (Top, L-R) Jo Herrington, Elizabeth Pelton, Leslie D. Smith, Keralee Johnson, Chana Smith, Treva Bradford and Melva Patteson.

tion of "Beehive." This musical retrospective chronicles the 1960s, a decade of monumental change, both artistically and politically through the rock n' roll, Motown and rockability sounds of yester-

day.

The strong and versatile casts includes Jo Herrington, Keralee Johnson, Elizabeth Pelton, Leslie D. Smith, Treva Bradford, Chana Smith and Melva Patterson.

Spring women's conference to be held

CLOVIS - A Spring Women's Conference has been scheduled by the Women's Ministry of Central Baptist Church in Clovis. The dates are March 23-25 in Clovis. Sessions will be nightly on Thursday and Friday from 6-9 p.m., and on Saturday from 9 a.m. to 3 p.m.

Registration deadline is Monday, March 20. For further information call Bette Cox (505) 76303903, Judi Gill

(505) 985-2231 or Wilma Fulgham (505) 763-6231.

Leading the conference will be Pencie Culiver of Phoenix, Ariz. She serves on the staff of "Victorious Christian Living" (VCL) as a Teacher and Counselor. Pencie has co-authored the women's Bible study "Victorious Christian Woman". She is a Precept Bible Study Teacher and has also served as the keynote speaker for numerous

Women's Retreats.

Pencie attended Baylor University where she met Wayne, her husband of 30 years. They have two sons.

The theme for the conference is "God's Blueprint For Contentment" Thursday's subject will be "Content To Be Me", Friday, "Content With Who You Are", Saturday: "Content With Where God Put Me".

Turkey is recalled in 14 states

The U.S. Department of Agriculture this week announced that a Springfield, Mo., food processing firm voluntarily has recalled from 14 states over a million pounds of ground turkey because small pieces of bone were found in the produce.

Hudson Foods, Inc., is recalling all 16-ozs. (1 lb.) packages of its "Delightful Farms Finely Ground Turkey"

distributed to retail stores in Texas, Tennessee, Louisiana, California, Arkansas, Florida, Illinois, Kansas,

Massachusetts, Minnesota, Missouri, New Jersey, Pennsylvania and Virginia.

All packages covered under the recall will have "Est. P-7249" inside the circular

USDA inspection seal on the label. No other Delightful Farms food product is affected by the recall.

"Because of the potential for injury, we urge consumers who may have purchased the suspect product to return it unopened to the place of purchase," said Michael R. Taylor, acting under secretary for food safety.

USDA learned of the problem after two consumers in Minnesota reported finding bone in the ground turkey. Subsequent USDA laboratory

tests confirmed the presence of small pieces of bone in unopened packages. As a precautionary measure, the firm is recalling 1,117,256 pounds of Delightful Farms finely ground turkey.

Consumers with questions about the recall may phone the toll free USDA Meat and Poultry Hotline at 1-800-535-4555 from 10 a.m. to 4 p.m. Monday through Friday. This number also provides access to a telecommunications device for the deaf and hearing impaired.

Complete Line
Monuments - Markers
Memorials
Granites - Bronze
Muleshoe Memorial
Park Cemetery, Inc.
232 Main P.O. Box 373
Muleshoe, TX
272-5727 or 272-4670

Muleshoe Journal USPS 367820
Established February 23, 1924. Published by Triple S Publishing, Inc. Every Thursday at 304 W. Second, P.O. Box 449, Muleshoe, Tx. 79347. Second Class Postage paid at Muleshoe, Tx. POSTMASTER: Send address changes to the Muleshoe Journal, P.O. Box 449, Muleshoe, Tx. 79347.
We Are Qualified Members Of:
Panhandle Press Association, National Newspaper Association, West Texas Press Association and Texas Press Association.
WEST TEXAS PRESS ASSOCIATION
PPA
Panhandle Press Association
MEMBER 1995
TA TEXAS PRESS ASSOCIATION
© 1990
Scot Stinnett, Publisher
Lisa Stinnett, Vice-President/Comptroller
Helena Rodriguez, News
Holly Millsap, Advertising
SUBSCRIPTIONS
Muleshoe Journal and Bailey County Journal
By Carrier Yearly - \$15.00
Bailey and surrounding counties
By Mail - \$16.75
Elsewhere - \$18.50
Advertising Rate Cards on Application
"Advertisers should check their ad the first day of insertion. The Journals will not be liable for failure to publish an ad or for a typographical error or errors in publication except to the extent of the cost of the ad for the first day of insertion. Adjustment for errors will be limited to the cost of that portion of the ad where the error occurred."

PRE-SPRING PRICE CUTTERS

ALLSUP'S
EFFECTIVE MARCH 19-25, 1995
318 W. American Blvd.
272-4862 MULESHOE

ALLSUP'S "MADE TO ORDER" BAR-B-Q BEEF SANDWICH FOR ONLY 99¢

DECKER CHOPPED HAM 4" X 6" 10 OZ. PKG. \$1.49

DECKER MEAT FRANKS 12 OZ. PKG. 69¢

SAVE ON COCA-COLA 6 pk. 12 oz. cans \$2.39

HAM, EGG, & CHEESE OR SAUSAGE, EGG, & CHEESE BREAKFAST BURRITOS FOR ONLY 99¢

GROCERY SPECIALS
LANA'S PORK EGG ROLLS 2 FOR \$1.00
ALLSUP'S 1.5 LB. LOAF SANDWICH BREAD 69¢ EACH OR 2 FOR \$1.00
SHURFINE SALTINE 1 LB. PKG. CRACKERS EACH 79¢
"ASSTD. 2 FREE CRACKERS IN EACH PKG."
TOM'S CRACKERS... 4 FOR \$1.00
"REGULAR OR HOT" REGULAR 99¢
FRITOS & BAKENETTS .. EACH 79¢

SAVE ON ALLSUP'S MONEY ORDERS UP TO \$299.00 FOR ONLY 29¢

Shurfine Dry Dog Food 20 lb. bag \$4.49

Post Toasties Corn Flakes 18 oz. box \$1.99

Fresh Made Hot Dogs 3 for 99¢

Rip's 1943-1995
314 Wheeler St. Texico, NM
"Where The Highways Meet"
52 years of the best quality at the lowest price!

Let Us Show You "THE BEST OF THE WEST"

Newest in Innovative Tack
Cutter Saddle Blankets 10% OFF
Good Selection - New & Used Saddles

Short & Long Sleeve Shirts by Mo Betta, Brooks & Dunn & Panhandle Slim ALL 20% OFF

4X Felt Hats \$69.98 & UP

New for Ladies: Jeans by Wrangler Riata, Lawman, Calamity, Sharon Camarillo PLUS: Tops & Vests For Jeans by Sharon Young, On The Verge, Hamilton & Others ALL 20% OFF

JUSTIN Sport Lacers Men's & Women's \$69.98 Children's \$52.50

Justin Ropers \$99.98 Ladies' \$69.98 & UP Children's \$39.98 & UP

Justin SPECIAL BUY Calfskin Cowboy Boots \$99.98

1-800-748-2459 • 482-3363
We Accept VISA M.C. AMERICAN EXPRESS Layaways Welcome

Jamboree in Floyd to be held March 23-25

The annual Floyd Country Jamboree will be held March 23-25 beginning at 7 p.m. nightly in the Floyd High School Gym in Floyd, N.M. Twenty four performers, including a couple from the Three Way area, will present country and gospel music.

The annual event is held as a fundraiser for the Floyd Lions Club. Proceeds will be used to fund various projects which the Lions help with every year.

Floyd Lions Country Jamboree fans will be welcoming back after a 12-year absence, fiddle-player Lance Dial. Lance is a native of Taiban, N.M., and was 15 years old when he last performed at the Jamboree.

Lance attended Baylor University, majoring in business finance and real estate and played his fiddle and guitar at fraternity functions. In 1990, he put together a four-piece band which emphasized original material. The band opened for major acts such as Lori Morgan, Willie Nelson, Holly Dunn and Dan Seals.

During this time, Lance was the lead guitar, fiddler, back up and lead vocalist. He wrote and co-wrote most of the music.

Lance currently lives in DeSoto, Texas, where he has his own band.



FIDDLER TO MAKE RETURN TO JAMBOREE - Lance Dial will be the featured performer at the annual Floyd Lions Club Country Jamboree in Floyd, N.M., March 23-25.

The Floyd Lions Club will pay a special dedication to Jimmy Ted Bilberry, who died Aug. 30, 1994. For 25 years,

his dynamic voice filled the air at the Floyd Country Jamboree with his gospel music. He served as master of ceremonies during the years.

Bilberry was 54 when he died of an apparent heart attack at his ranch home west of Fort Sumner. This year's Floyd Lions Country Jamboree is being presented in honor of Bilberry.

Logan is elected to Healthcare Facilities Management board

AUSTIN - Bud Logan, Director of Engineering at Muleshoe Area Medical Center, was recently installed to serve a two-year-term on the Texas Association of Healthcare Facilities Management board of directors. He was installed at a Feb. 23 meeting in Corpus Christi.

Logan has worked at Muleshoe Area Medical Center since 1989. He joins three other board members and three board officers.

TAHFM is an affiliated society of the Texas Hospital Association, an Austin-based trade association representing more than 80 percent of Texas hospitals and health care systems.

Edwards
Men's Wear

has moved to
418 Main, Clovis

with The Collection
in the former Vohs building

Come shop with us at our new location and register to win a

- Warren Sewell Suit
- Warren Sewell Blazer
- Shirt and Tie

Drawing will be Saturday, March 25, 1995

Edwards Men's Wear features a full line of Dress and Casual Clothes, Shoes and Accessories

Regular Sizes and a BIG & TALL Department

"Shop Where Quality Is Affordable"

Landscape Oil Painting Classes
Begin Tuesday, March 21
For 6 weeks 9:30 am. - 12:30 pm.
Still Life and Flowers
Saturday, April 1 & 15
9:30 am. - 2:30 pm.
Call 272-3889 or 272-4696
(Before 6 pm)

Rheata White Studios

Weather		R.G. Bennett, Muleshoe			
Date	High	Low	Soil	Rain	
Wednesday, March 15	64	31	49-47	.5	
Thursday, March 16	54	33	49-46		
Friday, March 17	73	33	50-47		

So Many Bricks, So Many Walls

So many bricks. So many walls. The bricks we use to build them are questions all dressed up in religious veneer, as if the whole future of the Christian faith depended upon issues instead of upon a Savior.

Pick a brick. Any brick. The Lord's Supper. How often? Bap-

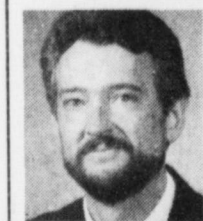

Focus On Faith
Curtis Shelburne

tism. How deep? Music. Pitch pipe or pipe organ? Robes. Only around the house or in the pulpit, too? Choirs. Just in heaven or also in church?

Lots of "religious" bricks used to build sanctimonious walls. The names of the bricks change, but the mortar remains the same. It is our own pride, not a very religious thing, but it holds walls together quite nicely, thanks.

Some shore up walls with Scripture, or worse, the lack of it, building elaborate positions based on nothing more than silence. And when we do build walls with Scripture, we tend to pull out a verse here and one there, forgetting the chapter which is truly the Lord's Prayer, a poignant prayer for unity (John 17).

We are so much more like the apostles than like the Lord. Like tattletale kids, we run to tell on our religious neighbors: "Lord, we saw someone who doesn't worship behind the right wall doing good works in your name, so right away we warned him to stop!"

Sound familiar? It happened before. I'm sure Christ's answer is still the same: "Do not stop him, for whoever is not against us is for us."

Still, we're very attached to our walls. They shore up our self-justification, the very heart of sin. They serve for us like the black hats and white hats in old Westerns, color-coding the bad guys and good guys. We forget that our only claim to goodness is that we've been dressed in His righteousness in absolute mercy and grace.

One thing's sure. If we raise our eyes high enough to look up to the Savior on the cross, we'll find ourselves looking over walls. In the light of the cross, issues assume their proper size.

Jesus is the Son of God. He is Lord. On the cross, He paid the price for the salvation of the world. Nothing else matters much.

So many walls. So many bricks. Maybe it's time we loved the Lord enough to quit building.

Curtis Shelburne is minister of the 16th & Avenue D Church of Christ in Muleshoe.

Texas Cable Company

Wireless Cable is Here!

Receive 50-200 TV Channels

No Money Down

Don't Miss Your Favorite Movies or Sporting Events

Showtime, HBO, Family Channel and MORE!

No More Blackouts

CALL 1-800-518-1993

National Brands

Spring

ROUND-UP

All Types
Coca-Cola
3 liter btl.
\$1.89

All Types
Coca-Cola
6 pack, 20 oz. btl.
\$2.99



Meat



Preferred Trim Family Pak
Round Steak
\$1.49
lb.

Preferred Trim Single Pack Round Steak	lb.	\$1.59
Preferred Trim Boneless Round Steak	lb.	\$1.69
Preferred Trim Boneless Rump Roast	lb.	\$2.19
Preferred Trim Sirloin Tip Roast or Steak	lb.	\$2.39
Tenderized Beef Cube Steak	lb.	\$2.89
Fresh Ground Beef	lb.	\$1.99

Jumbo Pack Split Fryer Breasts	lb.	99¢
Plump 'N Tender, 5-8 lb. avg. Basted Turkey Breasts	lb.	\$1.39
David's Corn Beef Briskets	lb.	\$1.79
Louis Rich Red Rind Turkey Bologna	1 lb. pkg.	99¢
Oscar Mayer Chopped Ham or Ham & Cheese	1 lb. pkg.	\$1.99
Oscar Mayer Cooked Ham	1 lb. pkg.	\$3.49
Oscar Mayer Assorted Fun Pack Lunchables	11.2 oz. pkg.	\$1.79
Assorted Underwoods Meats	4.25 oz. pkg.	\$1.79

Wilson Reg. or Honey Boneless Half Hams	lb.	\$2.79
Wilson Reg. or Polish Smoked Sausage	lb.	\$1.69
Wilson Assorted, 8-10 lb. pkg. Lunch Meat		\$2.19
Wilson, 12 oz. pkg. Meat Franks		59¢
Wilson Center Cut Bone-In Ham Steak	lb.	\$2.29
Hormel Reg., Low Salt or Mesquite Black Label Bacon	1 lb. pkg.	\$1.59
Hormel 10 oz. patties or 12 oz. links Little Sizlers	pkg.	99¢
1 lb. Regular, Hot, Sage or 12 oz. Lite Jimmy Dean Sausage	roll	\$1.89
Reg. or Hot, 2 lb. roll Jimmy Dean Sausage		\$3.75

Produce



Cello Wrapped
Dole Lettuce
69¢
each

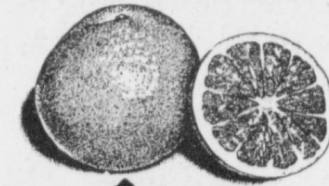

Tender
Asparagus
\$1.49
lb.



Sweet
Navel Oranges
Lunch Box Size

15 for **\$1**

Garden Fresh Broccoli	lb.	69¢
Fresh, 1 lb. bag Carrots		3 for \$1
Green Onions		4 for \$1
Granny Smith Apples	lb.	59¢
Baking, 5 lb. bag Potatoes		99¢
French or Italian, Dole Salad Mix	1 lb. bag	\$1.69

All Purpose Gold Medal Flour	5 lb. bag	79¢
Assorted Charmin Bath Tissue	4 roll pkg.	89¢
Kraft Regular or Light Parkay Margarine	2 for	89¢
Assorted Minute Maid Orange Juice	10-12 oz. cans	89¢
Assorted Minute Maid Slush Pops	24 pack box	\$2.19
Assorted, Blue Bunny Ice Cream	1/2 gal. sqr.	2 for \$4

Minute Maid Apple Juice	12 oz. can	99¢
Minute Maid Orange Juice	10-12 oz. can	89¢
Minute Maid Assorted Chilled, 96 oz. jug Orange Juice		\$2.99
Parkay Spread	3 lb. tubs	2 for \$3
Assorted, Friskies Cat Food	5.5 oz. cans	3 for 89¢

Clorox Clean-Up or Toilet Bowl Cleaner		
Tilex Instant Mildew or Scum Remover		
Pine-Sol Liquid Cleaner		
Cleaners	16-32 oz. btl.	2 for \$3

Assorted, 1 ct. pkgs. M & M Candy Bars	2 for	99¢
---	-------	-----

Cheddar, Colby, Monterey Jack, Marble Jack or Mozzarella, Crystal Farms Cheese	lb.	\$2.59
---	-----	--------

Assorted Kraft, 8 oz. jar Cheez-Whiz	\$1.89
Swiss, 12 oz. pkg. Kraft Regular or Light American Kraft Singles	\$1.99
Kraft Assorted, 8 oz. pkg. Shredded Cheese	\$1.69
Kraft, 14 oz. pkgs., Longhorn 1/2 Moon Colby or Cheddar Cheese	2 for \$5
Kraft 8 oz. pkg., Philadelphia Reg. or Light, Cream Cheese	99¢
Velveeta Kraft Regular or Light, 2 lb. box	\$3.99
Kraft 18 oz. btl., Assorted Reg. or Thick N Spicy, Kraft BBQ Sauce	99¢
Kraft Jet-Puffed or Mini, 10-10.5 oz. pkg. Marshmallows	89¢
Kraft, 5.5-7.25 oz. boxes Assd. Shapes or Macaroni Cheese Dinners	5 for \$3
Assorted Kraft, 24 oz. btl. Dressing	\$2.99
Bonus Pack Kraft, 40 oz. jar Mayonnaise	\$2.39

Hormel Chunk, 5 oz. can Ham or Turkey	\$1.29
Dinty Moore, 24 oz. can Beef Stew	\$1.89
Assorted Spam*, 12 oz. can Lunch Meat	\$1.79
Downy Ultra, Assorted 20 oz. btl., Fabric Softener	\$1.99

Frozen • Dairy • Health & Beauty

Assorted Banquet 9-11 oz. pkg. Dinners	99¢
Assorted Banquet Extra Helping 17-19 oz. pkg. Dinners	\$1.99
Assorted Banquet 14 oz. pkg. Cream Pies	99¢
Assorted Banquet 20 oz. boxes Fruit Pies	2 for \$3
Assorted Patio 5 oz. pkgs. Burritos	2 for 89¢
Assorted Chun King 6 oz. pkg. Egg Rolls	\$1.19

Tylenol Caplets or Gels 20-24 ct. btl. Allergy Sinus	\$3.99
Tylenol Caplets 24 ct. btl. Extended Relief	\$2.79
Sensor For Women 1 ct. pkg. Gillette Razor	\$3.99
Gillette Sensor For Women 5 Ct. pkg. Cartridge Blades	\$4.69
Assorted Condition 3 in 1 12 oz. btl. Shampoo	2 for \$3
Assorted, Condition 3 in 1 8 oz. cans Mousse	2 for \$3
Assorted, Condition 3 in 1 7 oz. cans Hairspray	2 for \$3

Libby's Reg. or Chicken, 5 oz. cans Vienna Sausage	2 for 99¢
Libby's, 3 oz. cans Potted Meat	3 for 89¢
Purina, 7 lb. bag Meow Mix	\$4.99
Purina Asstd., Moist & Meaty, 72 oz. box Dog Food	\$3.29
Purina Asstd. Tender Vittles, 12 oz. box Cat Food	99¢
Hershey's Assorted, 6 ct. pkg. Candy Bars	\$1.89
Lay's® or Wavy Lay's® Assorted P.O. \$1.49 - 6 oz. pkg. Potato Chips	89¢
Post Toasties, 18 oz. box Cereal	99¢
Thrifty Hound, 20 lb. bag Dog Food	\$2.99
Schilling Plain or Seasoned, 3.12-3.87 oz. btl. Meat Tenderizer	\$1.69
Schilling Lemon & Pepper, 3.5 oz. btl. Seasoning Salt	\$1.99
Schilling Salad Supreme, 2.62 oz. btl. Seasoning	\$2.49
Schilling Bits or Chips, 3.25 oz. btl. Bac'n Pieces	\$1.19
Schilling Assorted, .81-1.6 oz. pkg. Mixes	\$1.19
Schilling, 3 oz. pkg. Fajita Seasoning	\$1.49
Oil or Water Packed, Chunk Light Star-Kist Tuna	6 oz. can 59¢
Star-Kist Water Packed, 6 oz. can Albacore Tuna	\$1.39
Campbell's Regular or Healthy Request 10.75 oz. cans Tomato Soup	2 for 99¢
Campbell's Assorted, 16 oz. cans Healthy Request Soup	4 for \$5
Campbell's Assorted, 16 oz. can Healthy Request Soup	99¢
Campbell's Assorted, 18 oz. cans Chunky Soup	2 for \$3
Ramen Pride Assorted, 3 oz. pkgs. Oriental Noodles	6 for 99¢
Ramen Pride, Assorted, 2.3 oz. cups Oriental Soup Cups	2 for 79¢
Assorted, 6 pk., 5.5 oz. cans V8 Juice	\$1.99
Assorted Del Monte, 11-15.25 oz. cans Vegetables	5 for \$2
Assorted Reg. or Light, 16-17 oz. cans Del Monte Fruit	89¢
Del Monte, 8 oz. cans Tomato Sauce	5 for 99¢
Del Monte Assorted, 26-26.5 oz. cans Spaghetti Sauce	99¢
Del Monte Squeeze, 28 oz. btl. Ketchup	89¢
Del Monte Assorted, 4 pk. cnt. Pudding Cups	99¢
Assorted In Syrup or Juice, 15 oz. cans Del Monte Pineapple	59¢
Assorted Rasarita, 16 oz. jars Picante Sauce	2 for \$3
Hunt's, 6 oz. cans Tomato Paste	2 for 89¢
Assorted Peter Pan, 18 oz. jar Peanut Butter	\$1.79
Assorted Pringles, 6-7 oz. can Potato Chips	\$1.19

Bisquick, 60 oz. box Biscuit Mix	\$1.99
Gold Medal, 6.5 oz. pkgs. Corn Muffin Mix	6 for 99¢
Betty Crocker Assorted, 3-9.25 oz. box Hamburger/Tuna Helper	99¢
Betty Crocker Assorted, 5-5.5 oz. box Specialty Potatoes	99¢
Betty Crocker Assorted, 3 pk. pkgs. Pop-Secret Popcorn	2 for \$3
Betty Crocker Assorted, 5-6 oz. box Bugles Snacks	99¢
Assorted, 12-13 oz. can Folgers Coffee	\$2.69
Assorted Puffs, 144-250 ct. boxes Facial Tissue	2 for \$3
Pampers Asstd., 14-50 ct. Diapers or Trainers	\$6.29
Reg., Honey Nut or Apple Cinnamon 14-15 oz. boxes Cheerios Cereal	2 for \$5
Assorted, 4 roll pkg. Charmin Tissue	89¢
White or Decorated Scott Paper Towels	59¢
Hormel, 5 oz. cans Breast of Chicken	2 for \$3
Hormel Asstd., 7.3-7.5 oz. cups Microwave Cups	89¢
Hormel, 14.5 oz. jar, Not-So-Sloppy-Joe Sauce Sloppy-Joe Sauce	\$1.19
All Purpose Gold Medal, 5 lb. bag Flour	79¢
Old El Paso, 18 ct. box Taco Shells	\$1.89
Old El Paso, 31 oz. can Refried Beans	\$1.39
Old El Paso Chopped, 7 oz. can Green Chillies	\$1.09
Old El Paso Assorted, 16 oz. jar Salsa	\$1.89
Quaker, 8 lb. bag Harina Preparada	\$3.99
Quaker, 4.4 lb. bag Masa Harina	\$1.99
Kellogg's, 20 oz. box Raisin Bran	\$2.89
Kellogg's Postarits, 11.1-12.5 oz. box Crunch Cereal	\$2.19

WESTERN UNION TRANSFER™
"The fastest way to send money"

Lowe's

MARKETPLACE

515 W. American Blvd.
Muleshoe 272-4585

Pay-n-Save
QUALITY AND SERVICE

WE RESERVE THE RIGHT TO LIMIT QUANTITIES IN TEXAS

Muleshoe 272-4406

Public Record

Obituaries

Gertrude Elizabeth Fish

SNYDER - Funeral services for Gertrude Elizabeth Fish, 88, of Snyder, were held Friday, March 17 at Bell Cyfert Seale with the Rev. Miller Robinson of Colonial Hill Baptist Church officiating.

Fish died Monday, March 13, 1995 at Turner Care Center in Galveston after an illness.

She was born Feb. 14, 1907 in Snyder. She married Joe Collie Fish on Jan. 1, 1929 in Snyder. He died June 20, 1978.

Mrs. Fish was a lifetime resident of Snyder. She and her husband owned and operated Fish and Newton Hardware and Sporting Good in Snyder for many years. She was a member of the First Baptist Church.

She is survived by two sons, Don and Mary Fish of Tuscaloosa, Ala. and Jay and Sally Fish of Galveston; by a daughter Ann and Thom Falls of Los Angeles, Calif.; by a sister Farene Harris of Muleshoe; by seven grandchildren and by several great-grandchildren.

Births

Jonathan Gabriel Ramirez

Kimberlee and David Ramirez of Muleshoe are the parents of a newborn son, Jonathan Gabriel Ramirez. Jonathan Gabriel was born March 14, 1995 at Muleshoe Area Medical Center at 11:37 p.m. He weighed 7 lbs., 3 ozs.

Grandparents are Debbie Kennemer of Muleshoe and Gerald Vaughn of Lindale and Mary Ann and Albert Ramirez of Muleshoe. Great-grandparents are Carol and Darrell Kennemer of Muleshoe and Trinidad Ramirez of Muleshoe.

Cruz Antonio Castorena

Gilbert and Sylvia Castorena are the parents of a newborn son, Cruz Antonio Castorena. He was born March 15, 1995 at Muleshoe Area Medical Center at 1:39 a.m. and weighed 7 lbs., 5 ozs. He has a brother, Christian, 18 months old.

Grandparents are Gilbert and Sylvia Castorena of Muleshoe and Geronima Perez of Muleshoe. Great-grandparent is Clara Castorena of Muleshoe.

Thomas A. Germain

Maria Nicolas and Louis Germain of Muleshoe are the parents of a newborn son, Thomas A. Germain. He was born Feb. 22, 1995 at 4:12 p.m. at Muleshoe Area Medical Center. He weighed 8 lbs., 1 oz. He has a brother, Anthony Germain.

Grandparents are Alberto and Sahara Nicolas of Eagle Pass and Rosa Hernandez of Muleshoe and Thomas Rey of Muleshoe. Great-grandparent is Juanita Zaragoza of Piedras Negras, Mexico.

Hospital Admissions

The following hospital admissions have been reported at Muleshoe Area Medical Center:

March 10
Adrian Garza, Jodee Hal,

Hettie Hutchison, Barbara Trimble, Janet Wagon, Bobby Redwine, Rhonda Bentley

March 11

Abraham Flores, Adrian Garza, Vallie Kimbrough, Barbara Trimble, Socorro Granillo, Janet Wagon, Burley Locke, Rhonda Bentley

March 12

Abraham Flores, Carolyn Reeder, Vallie Kimbrough, Barbara Trimble, Veldom

Wallace, Janet Wagon, Socorro Perez, Rhonda Bentley, Baby boy Reeder

March 13

Kimberlee Vaughn, Hope Jaime, Vallie Kimbrough, Judi Ketterling, Veldon Wallace, Janet Wagon, Socorro Perez, Ralph Black, Rhonda Bentley, Baby boy Jaime

March 14

George Martinez, Thomas Germain, Kimberlee Vaughn, Marie Castorena, Valli

Kimbrough, Judi Ketterling, Billye Jones, Sandra Gray, Ralph Black, Maria Toscano, Baby boy Ramirez

March 15

Thomas Germain, Kimberly Vaughn, Marie Castorena, Valli Kimbrough, Judi Ketterling, Elizabeth King, Billye Jones, Sandra Gray, Michelle Flores, Ralph Black,

Maria Toscano, March 16

Thomas Germain, Maud Young, Kimberlee Vaughn, Marie Castorena, Vallie Kimbrough, Judi Ketterling, Elizabeth King, Billye Jones, Sandra Gray, Michelle Flores, Ralph Black, Elva Estrada, Maria Toscano

When it comes to your life savings, a gamble is never worth the risk.



LaDonna K. Scott

Never!!

For Security That Lasts A Lifetime, Call:

Scott Financial Services

Muleshoe, Texas 806-272-4754 or 1-800-995-3510

Spring Special

Motorola Bags \$49

Motorola Mobiles \$49

(Installation Not Included) Activation on Plateau Cellular

Call For Details!

W.T. Services

404 Columbia Hereford 296-2672

☆ Be ever mindful and thankful to GOD for...

HEALTH and FOOD

In our nation today, the majority of us have so much to be thankful for. Sure we lose a tooth or two in growing up, as the one pictured here, but these will soon be replaced. Health and Happiness are generally ours, and through our abundance we should share with others who are less fortunate. God's word and the church encourage sharing with others. There are many areas of service to others within the churches, and these we should not neglect, but God has said that we should take advantage, as we are able, of all opportunities to give aid.

"As we have therefore opportunity, let us do good unto all men."

GALATIANS 6:10

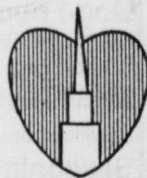

THE CHURCH ENCOURAGES LOVE AND COMPASSION FOR OTHERS

The Church is God's appointed agency in this world for spreading the knowledge of His love for man and of His demand for man to respond to that love by loving his neighbor. Without this grounding in the love of God, no government or society or way of life will long persevere and the freedoms which we hold so dear will inevitably perish. Therefore, even from a selfish point of view, one should support the Church for the sake of the welfare of himself and his family. Beyond that, however, every person should uphold and participate in the Church because it tells the truth about man's life, death and destiny; the truth which alone will set him free to live as a child of God.

Colman Ads. Serv.

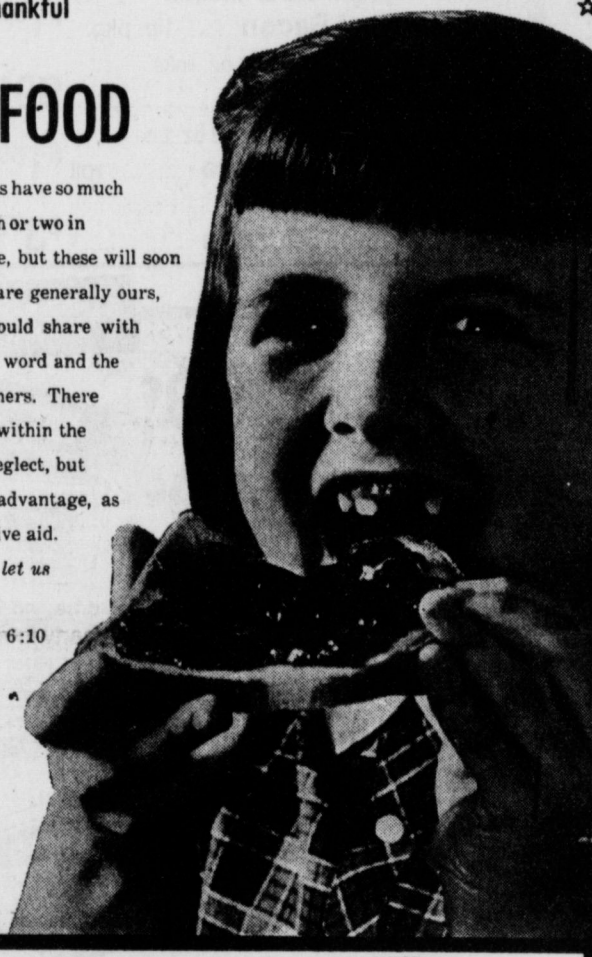

Immaculate Conception Catholic Church
805 E. Hickory
Father Joseph Augustine

First Baptist Church
220 West Ave. E.
Pastor, Stacey Conner

Emmanuel Baptist Church
Iglesia Bautista Emmanuel
107 East Third
Isaias Cardenas, Pastor

Trinity Baptist Church
314 E. Ave. B
Rev. Dale Berry, Pastor

Circle Back Baptist Church
Intersection FM 3397 & FM 298
Rev. Jessie Shaver
946-3676

Calvary Baptist Church
1733 W. Ave. C
Pastor Ben Davis

Progress Baptist Church
Progress, Texas

Richland Hills Baptist Church
17th & West Ave. D

St. Matthews Baptist Church
Corner of West Boston & West Birch
Pastor, Floyd R. Monroe

Progress Second Baptist Church
1st and 3rd Sundays
Rev. Arthur Hayes

Primitive Baptist Church
621 South First
Elder Cleveland Bass, Pastor

1st Baptist Church
Lazbuddie, Tx.
Bobby Alexander, Pastor
965-2126

St. John Luthern
Lariat, Texas
Sunday School and Bible Classes 10:30 a.m.
Church Services 9:30 a.m.
Rev. Richard Greenhaner

The Christian Center
Morton Hwy.
Reydon Stanford
272-5263 or 272-5105

New Covenant Church
Plainview Hwy
Sunday 10:00 a.m.
Wednesday 7:00 p.m.
Phil Ensminger, Pastor

Lazbuddie Methodist Church
965-2121
G. Scott Richards, Pastor

New Vision Church Of The Nazarene
814 W. Ave. C
272-3622
Pastor David R. McIntire

Primera Iglesia Bautista
223 E. Ave. B
Roy Martinez, Pastor

"Iglesia Pentecostal Unida"
207 East Ave. G
272-3636
Pastor: Wenceslato Trevino

Lariat Church of Christ
Sunday School 10:00 a.m.
Worship 11:00 & 6:00
Wednesday Services 7:00 p.m.
Sam Billingsley, Minister

Muleshoe Church of Christ
22nd & W. Amer. Blvd
Sunday School 9:30 a.m.
Morning Worship 10:20
Evening Services 6 p.m.
Wed. Night 7:30 p.m.
Mark Whitmire, Minister

16th & Ave. D Church of Christ
Sunday 10:30 a.m.
Evening 6:00 p.m.
Wednesday 7:30 p.m.
Curtis Shelburne, Minister
272-4619

Lazbuddie Church of Christ
Minister, Nathan Crawford
Sunday School 9:30 a.m.
Morning Services 10:20 a.m.
Evening Services 5:00 p.m.
Wednesday Night 7:00 p.m.

First Assembly of God
272-3017 or 272-3984
Rev. Darrell R. Sanderlin, Pastor
521 South First Street
Sunday Services:
9:45 & 11:00 a.m.
6:30 p.m.
Wednesday Services 7:30 p.m.

First United Methodist Church
507 W. 2nd Street
Dr. James Bell, Pastor

El Divino Salvador Methodist Church
E. 5th and E. Ave. D
Rev. Libney Penada, Pastor

Shepherd's Chapel - of the Sacred Heart of Jesus Christ
Non-Denominational Spirit Filled Fellowship Worship:
809 E. Fir, Muleshoe
Rev. Manuel A. Cruz-Medina
Sunday Services:
9:00 a.m. - En Espanol - Devine Services
11:00 a.m. - In English - Devine Services
6:00 p.m. - In English - Devine Services
The Doors Are open each day from 9 a.m. to 6 p.m. for whomever needs our Lord, Jesus Christ or to talk with the Pastor.

Portales Massage Clinic and Herb Shoppe

For anyone who may be having problems such as:

- Headaches
- Back
- Shoulders
- Tenston
- Poor Circulation

Therapist Lic. #056
Loretta Looper
116 S. Ave. B
Portales, NM
Call
505-356-3785

Irrigation Pumps & Power W. Hwy 84 272-4483	Bob Stovall Printing 221 E. Ave. B. 272-3373	James Crane Tire Co. 322 N. 1st 272-4594	Decorator's Floral & Gifts 616 S. 1st 272-4340
Wes-Tex Feed Yards, Inc. 272-7555	Bobo Insurance Agency 108 E. Ave. C 272-4264	American Valley, Inc. W. Hwy 84 272-4266	Bailey Gin Co. 946-3397
Western Drug 114 Main 272-3106	First Bank Member F.D.I.C. 202 South First 272-4515	Dairy Queen & Church's Fried Chicken 272-3412 272-5581	5-Area Telephone Cooperative, Inc. 302 Uvalde 272-5533

Journal Classifieds

Call 272-4536 Deadlines: For Thursday, Noon Tuesday; for Sunday, Noon Friday Call 272-4536

Legal Notice

NOTICE TO CREDITORS OF THE ESTATE OF HOPE KING, DECEASED

Notice is hereby given that original Letters Testamentary upon the Estate of HOPE KING, Deceased, were granted to STANLEY MAX KING, Muleshoe, Texas on the 27th day of February, 1995, by the County Court of Bailey County, Texas. All persons having claims against said estate are hereby requested to present same to it within the time prescribed by law. Residence and Post Office address for these purposes is:

Stanley Max King, Independent Executor of the Estate of Hope King, Deceased, % Harold P. Brown, Jr., Post Office Box 2426, Lubbock, Texas 79408 12s-1tc

Help Wanted

Muleshoe Area Healthcare Center is currently taking applications for nursing assistants. Contact Terri Brown, R.N. Director of Nursing at 106 W. Ave. H. Please apply in person. No phone calls please. 7t-8tc

Heating & Air Conditioning firm seeks person for position of installer's helper. Advancement for motivated individual. Benefits. For application contact Bruce Inc., Hwy. 214 north, Muleshoe, Texas. 12s-4tc

Customer Service Representative. Fast growing cable TV company seeks an experienced efficient energetic hardworking individual to fill a customer service representative position. The right candidate must have excellent customer phone skills reliable and detailed orientated with a willingness to work hard as a team player. Typing and data entry skills required. Competitive salary benefits package, in a non smoking office. Send resume to Mission Cable attn. Rose Gonzales, Box 1470, Idalou, TX 79329. No phone calls please. EOE. 12s-1tc

FOR SALE
3 Gifford Hill Sprinklers
Fransé Irrigation, Inc.
Box 99, Farwell, TX.
(806) 481-3316 or 481-9977

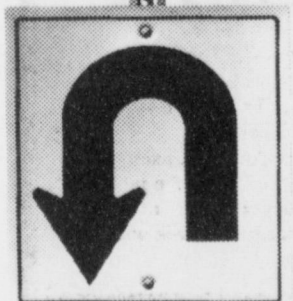

We have discounts to help you drive down the cost of car insurance.

Allstate has car insurance discounts that can help you save money. Which discounts do you qualify for? Give us a call to find out.

Henry Insurance Co.
111 W. Ave. B
272-4581
Muleshoe, Texas

Allstate
You're in good hands.

Allstate Insurance Company, Northbrook, Illinois. Subject to qualifications and local availability.

Muleshoe Area Healthcare center is accepting applications for Assistant Director of Nurses. Applicants must be an L.V.N. or R.N. Knowledge of Medicare and Medicaid a must! Salary based on experience. Contact Terri Brown, R.N. D.O.N. at 106 West Ave. H., Muleshoe, Texas. Apply in person and bring a current resume. 10t-1tc

Team Drivers Needed! to run trams from Friona, Texas to Dodge City, Kansas. Plant to Plant. Home every day! 33 cents a mile to start. Call Booker Transportation at 1-800-569-4633 ext. 304 or 300 Monday - Friday. 12s-1tc

POSTAL JOBS--Start \$11.41/hr. For exam and application info. call (219) 769-8301 ext TX 759, 8 a.m. - 8 p.m., Sun.-Fri. 9t-7tpd

Real Estate

For Sale: Richard Hills, 1715 W. Avenue H. Remodeled inside & out last year, 3 br, 1 3/4 bath, 2 car garage, large living room, ceiling fans, new drapes. Call 272-4754

FOR SALE LENAU ADDITION
305 East Fir Avenue, large 3 bedroom, 1 3/4 baths, auto lawn sprinkler, single garage, 2 car carport and storage. Call day or night 272-3373. D8-11s-1tc

HOUSE FOR SALE--226 Elm, 2 Bedroom, 1 bath, 1 car garage, 1 large spare room, central heat, 8'x14' storage bldg., cellar, fenced backyard. Call 272-5133 after 12. 10t-2tpd

Farm For Sale

Farm For Sale or Trade - 160 Irrigated Acres, Cotton and Corn Base. 2 Wells, excellent water, on County Line Road. Call 806-745-5870. 9t-4tpd

Farm For Sale: 108 acres for sale, 8 inch irrigation well,

The Current Texas Migrant Building located at 101 E. Ave. B, is for sale. For more information call 272-7533 or come by the TMC office. 12s13 tc

REAL ESTATE • 173 ACRES SELLING IN 3 TRACTS • REAL ESTATE

Thursday, March 30, 1995 — Sale Time 10:00 a.m.
LOCATED: Muleshoe, Texas, 4 Miles East On U.S. Hwy. 70, Then 1/2 Mile North, Then West In Field.
BARNEY & LUCILLE SCHELLER ESTATE — Owners
For More Information, Call Auctioneer/Broker: James G. Cruce (806) 296-7252

TRACT I — 30 ACRES ML.
LEGAL DESCRIPTION: Tracts 33, 34, 35 O & J of Section 92, Blk. Y of The W.D. & F.W. Johnson Subdivision, Bailey Co., Texas.
LOCATED: From Muleshoe, Texas, 4 Miles East On U.S. Hwy. 70, Then 1/2 Mile North, Then 1/2 Mile East.
IMPROVEMENTS: Frame House, Approximately 1500 Sq. Ft. 3 BR, 2 Bath, Open Side Garage, 24'x36'x12' Well Insulated Metal Shop Building With Several Smaller Buildings.
IRRIGATION: 1-5" Irrigation Well W/Pump, Domestic Well W/Pump - Small Amount of U/G Pipeline, 1-Older 10" Well (Not Pumped in Several Years)

TRACT II — 133 ACRES ML.
LEGAL DESCRIPTION: 133 Acres ML of L and Out of The North 1/4 of Section 80, Blk. Y of The W.D. & F.W. Johnson Subdivision, Bailey Co., Texas.
LOCATED: From Muleshoe, Texas, 4 Miles East On U.S. Hwy. 70, Then 1/2 Mile North To SE Corner Of Property (West Side Of Property Fronts On Y-L Road).
IMPROVEMENTS: Cow Shed & Corral. IRRIGATION: 1-6" Well And Approx. 1/4 Mile Of Underground Pipe.

TRACT III — 10 ACRES ML.
LEGAL DESCRIPTION: 10 Acres Out Of The Middle Of The South Side Of Section 80, Blk. Y of The W.D. & F.W. Johnson Subdivision, Bailey Co., Texas. (This Tract Lies South Of Tract II An Fronts On North Side Of U.S. Hwy. 70.)
LOCATED: From Muleshoe, Texas, 3 1/2 Miles East On U.S. Hwy. 70.
IMPROVEMENTS: None. (Make Someone A Good Building Or Mobile Home Site. Tract Is All Native Grass With Fence On 3/4 Sides.)

SALE SITE: On Property On Tracts II & III, Tract I Will Be Sold From Tract II. Sale Time 10:00 a.m.
TERMS OF SALE: 10% in Escrow Day Of Sale; Remainder Upon Closing.
CLOSING & POSSESSION: 30 Days If Possible With Immediate Possession With Provisions To Protect The Seller.
TAXES: Buyer Assumes 1995 Taxes. All Pr or Year Taxes Have Been Paid.
MINERALS: Sellers Share Will Pass To Buyer - Believed To Be 1/4 Interest.
MANNER OF SALE: By Sum Total On Tract I & II, By The Acre On Tract III.
OWNER WILL BE GIVEN 15 MINUTES TO ACCEPT OR REJECT ANY OR ALL BIDS.
NOTE: Any Announcement Sale Day Taxes Tract Ince

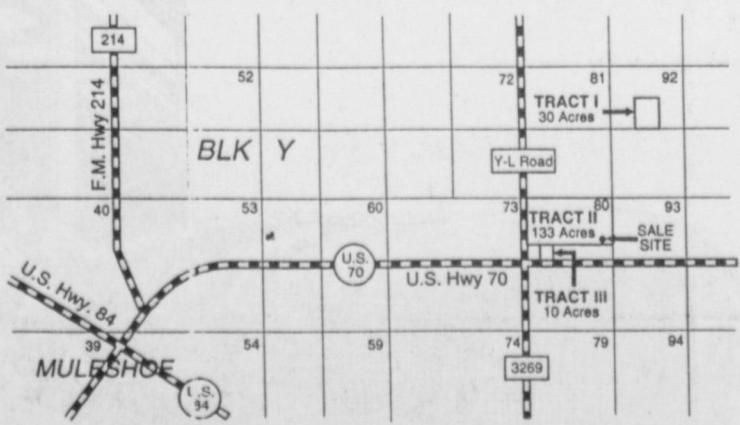

Five Star Auctioneers
P. O. BOX 1030
PLAINVIEW, TEXAS 79073-1030
OFFICE PHONE: (806) 296-0379

JAMES G. CRUCE (806) 296-7252
MERRYL W. EVANS (806) 293-8195
JIM SUMMERS (806) 864-3811
JIMMY REEVES (806) 864-3382

NOT RESPONSIBLE FOR ACCIDENTS
WE ARE AGENTS AND AGENTS ONLY
NOTE: PLEASE BRING YOUR OWN CHECK BOOK
Terms of Sale: 10% in Escrow Day Of Sale -
Closing In 30 Days If Possible
Lunch Will Be Available

can divide into 3 veteran tracks, 12 miles east hwy 70, 1/2 mile south, paved road. 512-836-7104. 11t-2tc

For Sale

1988 Nitro 120 Horse Outboard Bass/Ski, depth finder trolling motor. Stored in a shed, excellent condition. Call (806) 927-5423.

For Sale GE Mobile phone with 272 number. Call 272-5255 or 946-8852. 8s-6tc

For Sale Yamaha Street Bike, Lime Colored couch and chair. For More Information Call 806-965-2693 9s-1tc

For Sale: Longlife 3.5 20" Blade Lawn Mower, 6' Aluminum Ladder Call 806-272-3906 9s-4tpd

FARMERS -- Seedgrowers needed for sorghum, sorghum sudan, pearl millet, cane, blackeyed peas, purple hull peas and others. Call

MUST SELL! 90 CHEVROLET SUBURBAN

Conversion package, front and rear air conditioning, custom paint, low miles - like new !!, power windows, power door locks, cruise control, tilt steering wheel, am-fm stereo cassette, running boards and Much More. No old contract to assume, no back payments to make, just need responsible party to make reasonable monthly payments

Call I DOUG HULDERMAN in the credit department Friona Motors. (806)247-2701

MUST SELL! 1994 MERCURY COUGAR XR7

V-8, automatic with overdrive, power windows, power locks, power mirrors, 6-way power driver's seat, tilt, landan rod package, cruise, air conditioning, am-fm cassette, dual airbags, rear defrost, aluminum wheels and much more. No old contract to assume, no back payments to make, just need responsible party to make reasonable monthly payments.

Call Doug Hulderman in the Credit Dept. Friona Motors, (806)247-2701

MUST SELL! 1994 MERCURY TOPAZ GS.

Automatic transmission, power windows, power door locks, power mirrors and power driver's seat, tilt steering cruise control, with am-fm cassette stereo and much more. No old contract to assume, no back payments to make, just need responsible party to make reasonable monthly payments.

Call Doug Hulderman in the credit dept. Friona Motors (806)247-2701

MUST SELL! 1994 FORD F150

Supercab 4x4, XLT package, automatic transmission, bucket seats, power windows, power door locks, electric dual mirrors, am-fm cassette, air conditioning, tachometer, bedliner and Much More. No old contract to assume, no back payments to make, just need responsible party to make reasonable monthly payments.

Call Eddie Echevarria in the Credit Dept. Friona Motors, 806-247-2701

Production Plus at 1-800-530-4364.

For Sale Adorable Lab puppies will be ready April 1. Call Jack Little at 272-4805. 11t-2tc

Miscellaneous

Need overweight people who are serious about losing weight. Call in Levelland 806-894-7302. 8s-25tc

Any type livestock fencing or corals built. Call 925-6742 after 6 p.m. 12s-1tc

Automobile

1992 Ford XLT Lariat, extended cab, short bed. Loaded, 302 automatic. \$10,200. (505)356-5509.

For Sale 1989 Chevy Silverado pickup. Standard cab, long wide bed. 350 automatic with overdrive, new tires. Excellent condition. \$9300. Call (505) 356-5509, Portales. 10s-1tc-wp

KEMP HOME FURNISHINGS
We will save you 30 - 50% on brand-named furniture and Serta bedding (Guaranteed)
414 West American Boulevard
Phone 272-5023

KIRBY SALES & SERVICE
207 W. 7th
Clovis, NM 88101
505 - 762-4991

Corner of 7th & Mitchell
Next to Sonic Drive-in
Come In and Look At The New Self Propelled Kirby.
Bring Your Kirby In For Service!
We Also Have Rebuilt Kirbys!
Call Joe Ennis, Distributor.
Only Authorized Dealer In Clovis and Surrounding Area.
Open Saturdays.
9s-t&s-1tc

Smallwood Real Estate
232 Main 272-4838



3 Bedroom, 2 bath, living room, den, large kitchen, stucco house. In Cont. Bk. Highway 70. Owner will finance.

One and one half story house five miles out of town. Water well, detachable two car garage, over one acre of land. Owner will finance.

1984 Chevrolet pickup, 1/2 ton, 60,000 miles, new brakes and new air conditioner compressor. Manual shift, high speed rear end. 272-4838 days, 272-3137 after five.

Byrd Realty
OFFICE (806)481-3846
MOBILE (505) 760-1495

In the country! Approximately 2,500 sq. ft. home, 4 bedroom, 2 1/2 bath, called on 5 acres. Only \$46,000!

Oklahoma Lane - approximately 155 acres, 18" well, 1 Gifford Hill sprinkler. Lays well.

East of Farwell - 160 acres, good water area. 1 circular sprinkler, 1 8" well. Would make excellent hay farm.

Richland Hills Addition, Approx. 2500 sq. ft. 3-2-2 nice brick home, basement, fenced backyard, ref. air & central heat, lots of storage, assumable loan to qualified buyer. OWNER SAYS SELL!!!! Call for an appointment. PRICE REDUCED!!

Northwest of Muleshoe - 78 acres, has highway frontage. Owner will sale as one unit or divide in two smaller tracts. Has approximately 40 acres in CRP. \$50,000 buys it all. 160 Acres; North of Muleshoe, hwy 214. Two Story house. Circular sprinkler, irrigation well, lays well. Possible Owner Financing to a Qualified Buyer Call For Details.

Nieman Realty

116 E. Ave. C George Nieman, Broker 272-5285 or 272-5286

HIGH SCHOOL

NICE 3-2-1 carport home, Cent. A&H, built-ins, basement, ceiling fans, water softener, covered patio w/gas grill, fenced yd., & one bdrm. apartment. PRICE REDUCED!!!! HS-12

NICE 3-2-2 Brick, 2150+ lv. area, Heat pump, built-ins, Ceiling fans, nice carpets, fenced yd. MORE!! \$70K HS-6

VERY NICE 3,000+ sq. ft. Home, recently remodeled, built-ins, heat pump, FP, splkr. system, storage bldg. fenced yd., CONSIDER TRADE!!! \$ 70's!!!! HS-11

3-2-1 Brick, Cent. A&H, built-ins, workshop-storage, fenced yd. \$30's!!!! HS4

HIGHLAND AREA
3-2 Home, 1900+ lv. area, heat pump, st. bldg., fenced yd. \$30's!!!! HL-2

VERY NICE 3-2-2 Brick, Cent. A&H, built-ins, fenced yd., splkr. sys., MUCH MORE!!!! \$60's!!!! HL-1

Nice 4-2-1 Brick, Cent. A&H, built-ins, fans, encl. patio, man. splkr sys., gas grill, st. bldg., fenced yd. \$60's!! HL-5

LENAU ADDITION
Nice 2-1-1 Home, new interior paint, new carpet, fenced yd., storage bldg. MORE!!!! & 20's!!!!-4

James F. Hayes & Co.

AGRICULTURAL REAL ESTATE SERVICES

584 Acres of C.R.P. (SOLD) in Castro county.

316 acres at west camp area, lays good, good soil, lots of underground pipe, 1 center pivot sprinkler, located on pavement. PRICE REDUCED TO SELL!!

157 acres west of Muleshoe on 1760. 2 wells, electric center pivot, fully allocated, good. Owner says sell!!

I have buyers interested in both dryland and strong irrigation. With the outstanding 94 cotton group, now may be the best opportunity to sell that we have had in several years. If you have been thinking of selling, give VIC A CALL!

160 Acres - West Camp Area, south-east of Farwell on County line. Livable 10651 sq. ft. pool well. Will make a good livestock place. \$275.00 per acre.

320 Acres Northwest of Lariat in Parmer County. Excellent soil and water. 2 center pivot sprinklers, house, barn and other improvements.

80 acres West of Muleshoe. Call for details.

191 Acres in Northwestern Lamb County. Excellent soils. Good water, 2 wells, 40' of underground pipe. PRICED TO SELL!!

800 Acres - Northern Bailey County. 8 wells, 6 sprinklers, good water, excellent soil, no noxious weeds, good set of improvements A Top Notch Operation!

Vic Coker, Agent
Office 310 Main St. Suite 103 Home
272-3100 Muleshoe 965-2468

HENRY REALTY

Small acreage on highway near Muleshoe. New development. Please call for information. 5 acres to 40 acres. Excellent location.

NEW LISTING--2 Bedroom, 1 bath, recently remodeled - new paint, new floor covering throughout. Wood fence. Storm doors and windows.

Near High School, 3 bedroom, 1 bath, floor furnace heat, roof ducted. Evaporative air cond, storm windows & doors, equipped for washer/dryer. Fenced back yard.

Four bedroom, 2 bath, 2 car garage, 2 - car carport. Refrig. air, central heat. Carpet, beautiful dining area with built-in china cabinet and paneled walls and other extras. Storm doors, storm windows and awnings. Concrete fence, front yard has automatic sprinkler. Kitchen built-ins, 1,000 sq. ft. storage. Large home with extra storage.

Near High School - 3 bedroom, 3 bath, BV central heat, ducted in evaporative air cond., carpet throughout., large den with rock fireplace, top grade wood paneling throughout. Storm windows and doors. Insulation in ceiling, large utility room and spacious storage area. Kitchen built-ins.

Country Club Addition, 2 bedrooms, 1 bath, 4 car carport, new roof, carpet, 2 ceiling fans, includes vacant lot next door. Storm doors and windows.

Reduced Price - Owner ready to sell. 2 bedroom, 1 bath, 1 car garage, carpet, wood fence.

COMMERCIAL PROPERTY

Ideal location on west American Blvd. 150' highway frontage. A great business opportunity.

West American Boulevard 150' frontage. Priced to sell. 111 WEST AVE B. MULESHOE, TX 272-4581

Nieman Realty

116 E. Ave. C George Nieman, Broker 272-5285 or 272-5286

LENAU ADDITION

VERY NICE 3-2-1 Home, Heat Pump, storm windows & doors, extra insulation, nice carpet, splkr. sys. & MORE!!! \$30's!!!!-L2

RURAL HOMES

IMMACULATE 3-2-2 Brick Home, 2900+ lv. area, Heat Pump, built-ins, FP, spacious den, office, 1 acre tract on pavement, close to town, horse barn/tack room. MUCH MORE!!!! \$90's!! HR-3

JUST LISTED- Very Nice 4-2 Home on 40 acre tract close to town, heat pump, built-in stove, nice carpet & tile. 6" irrig. well with high pressure lines, stock shed & pens, tractor & equipment. \$70's!!!!

COUNTRY CLUB
2-1-1 carport home, wall furnace heat, nice carpet, storm shelter, storage bldg., fenced yd. MORE!!!! \$20'S.

2-1 Home. Lg. Carport, wall furnace heat. fenced yd. st. bldg., on 2 lots!!! \$14,900!!! HL-2

ASK ABOUT OUR COMMERCIAL LISTINGS!!!!

COMMERCIAL-200'+ Hwy. 84 frontage-Former Richland Hills Texaco, excellent business location. PRICED TO SELL!!!!!!

JUST LISTED 160 acres N. of Progress. Good productive farm in good water area, 8" well and Valley Sprinkler. PRICED TO SELL!!!!

White attends a shoe expo

Marlin White, co-owner of Joe's Boot Repair, just returned from the 48th annual Shoe Service Exposition held in Arlington on March 5. Approximately 2,000 people attended the two-day event and seminars that were offered.

Today's consumer is more interested than ever in quality footwear that is comfortable and durable. White said that he obtained several good ideas at the expo on the best uses for today's leather and vinyl products. He also participated in a "Choosing a Proper Adhesive" seminar.

Marlin also plans to attend a school in September in Saint Joe which will teach old fashioned bootmaking. This is what he plans to add to his business.

"I basically learned about different techniques and getting into shoe care products," Marlin said. "Techniques on how to do shoe repairs."

Marlin has lived in

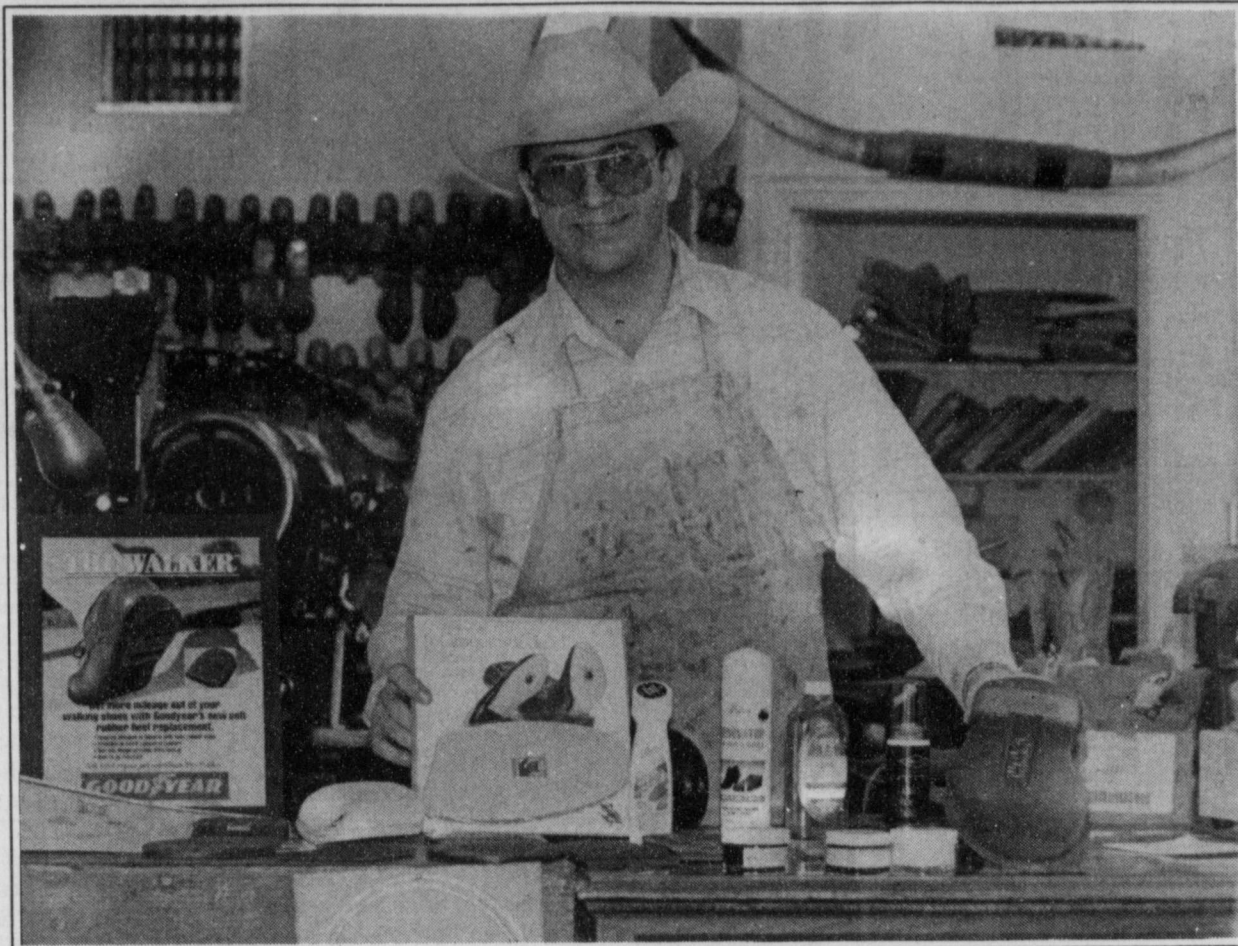

NEW TECHNIQUES IN SHOE REPAIR - Melvin White, co-owner of Joe's Repair Shop in Muleshoe displays some materials and new techniques he aquired at a recent shoe exposition he attended in Arlington. He will incorporate some of the new innovative ideas and techniques he learned into his business.

Muleshoe since May of 1994. His mom and stepdad, the Pinettes, came to Muleshoe from Missouri where they operated a similar business since 1981. Joe Rhodes invited them to Muleshoe in 1993.

Florence Pinette operates a cobbler business with the help of her son Marlin White and Deanna White and family.

Joe's Repair Shop has three employees and repairs about

40 pairs of shoes a week, in addition to about 100 pairs for

Joe's Boot Shop.

White said he was invited to the recent expo by the Shop Repair Industry.

Letter to the Editor Nebraska student seeking information on Texas

Dear Editor:

I am from Kearney's North-east Elementary School in the 5th grade. Our grade is having a "States Fair." I chose Texas for my state because I would really like to go there sometime, and I think Texas will be an interesting place to learn about.

It would be helpful if you would please print this in your

new paper. I look forward to receiving information on your town and surrounding areas to help me with my report.

Sincerely,
Karen Bult
3907 Indian Rd
Kearney, NE.,
68847

P.S. Please send me information by April 20th.

Muleshoe horse gets 2nd in Panhandle competition

Crazy Dave, a horse owned by Craig Rucker and ridden by Allen Sloit of Muleshoe at the recent Panhandle Team Penning Association sanctioned event on March 4 took 2nd place in the 500 novice rider class.

The horse had a score of 67.

The next cutting event will be held on April 29 in Amarillo at Alford's Indoor Arena. Practice cattle will be available and there will be a Jackpot Cutting in Tulia on March 25.

For more information call Jan Roper at (806)627-4260 or at 373-3377.

Workshop to help residents plan landscapes

LUBBOCK - South Plains residents who find their "green thumbs" itching to do some Spring beautification around their yards can get some professional guidance here Saturday, March 25, during an all-day Landscape Development Workshop for Individuals and Families.

Conducting the training will be Dr. Steve George, associate professor and horticulturist with the Texas Agricultural Extension Service at Dallas,

and a faculty of leading landscape architects and designers from the South Plains.

The workshop will be from 9 am. until 6 pm. at the Breedlove Dehydration Plant, 1818 N. Martin Luther King Blvd.. Breedlove is on the road to the airport just north of Loop 289.

The workshop is sponsored by the Extension Service, West Texas Arts and Botanical Association, South Plains Extension Master Gardeners and the

Land Use Board of South Plains Food Bank.

To provided individual instruction and counseling, only 40 registrants will be accepted. A family will be counted as a single registrant. Participants are encouraged to bring a plan of their property or a diagram showing dimensions of the yard and buildings, and pictures of the house and landscape if possible.

From 9 am. until noon, George will lecture, demon-

strate and discuss home landscape design development and remodeling. From 1 to 2 p.m. participants will write designs, work on plans for their yards and ask questions of the faculty.

From 2 to 6 p.m. each registrant will have a 30-minute consultation with George or other landscape professionals.

To register, write to Elaine Shields, 5512-79th Street, Lubbock, TX 79424.

- Attention Farmers -

If you want to replace some of that corn with a crop which makes quick and can be profitable - we have growing contracts for certified pea seed - these peas mature in 73 days.

Work well on grazed out or harvested wheat land.

We also have contracts on regular dry peas production and pinto beans production.

Call Kenneth Gray 806-634-5902

Oilseed Systems Inc.
Crosbyton, Texas

\$ Spring Clearance

BEDROOMS

Complete with mattresses & pop-up Trundle Bed	Reg. \$899.95	\$649 ⁹⁵
Selection of Metal Decorator Beds		1/3 Off
Complete with mattresses, 1 only Red Over & Under Bed		\$549 ⁹⁵
Thomasville & Kincaid CLOSE OUT Solid Cherry & Oak Bedroom Groups		50% Off
Solid Wood, One Of A Kind Bedroom Pieces		50% Off
4 C. with mattress & box spring King Size Bedroom Suite		\$1999 ⁹⁵

LIVING ROOM GROUPS

All Sofas & Sleepers	20% to 50% Off
La-Z-Boy Reclina-Rockers	\$288 Off
By La-Z-Boy, Reg. \$1599 Leather Sofa	\$1299

Discontinued,
By Thomasville & Kincaid
Dining Room Groups
50% Off

Credit Terms
Available With
Approved
Credit

Calton Furniture

507 E. 2nd Portales, NM 359-1442
Where Hwy. 70 Divides

Pictures

1/3 Off

Bedspreads
25% Off

Table & Floor
Lamps

1/3 Off

All
Entertainment

Centers

1/3 Off

Introductory Offer,
Boys & Girls
by Thomasville

Bedroom
Impressions

40% Off

Attention Area Farmers!

WES-TEX FEEDYARD of Muleshoe

Would Like To Contract Your Hi-Moisture Corn For 1995

Contact:
Wayne Tunnell

272-7555 or 272-4403

