



The Hansford Plainsman



VOLUME VIII., NUMBER 17

SPEARMAN, HANSFORD COUNTY, TEXAS

THURSDAY, DECEMBER 15, 1966

LIBRARY PETITION REFUSED

Council Gets Reports from Departments

Spearman's City Council had a routine meeting Monday night and accepted the reports from the city departments.

There were 93 cases filed in Corporation Court during November by the local policemen. A total of \$885 was assessed in fines and a total of \$576 was collected at the end of the month.

The fire department answered seven fire alarms during the month with five being trash and grass fires and two being car fires.

Police officers wrote 80 traffic tickets in November. They investigated six accidents, arrested 13 persons, investigated three thefts and recovered the property taken in two of the thefts.

The animal control officers picked up 35 stray animals and 19 of these were destroyed.

Approval was given for the purchase of two police radios for the cars. These will replace the old radios in the cars.

The audit report that was presented to the council last month was formally approved after council members had studied its contents.

Councilmen also voted to accept the paving of Seventh street from Roland to Highway 15.

This will be the only regular meeting of the council this month. They will meet again in January.

Driverless Car Smashes Store

A driverless car mashed in the front of Bob's Sales and Service on Main street Tuesday morning while the driver was in Gordon's Drug across the street.

Rex Sanders parked his car in front of Bob's Sales and left the motor running while he went across to the drug store.

While he was gone the car managed to shift itself into drive, climb the curb and run into the front of the store.

Investigating officers said ice in the gutter made a ramp for the car to climb onto the sidewalk.

The brick wall of the store was broken and the plate glass window was shattered.

Navy Deserters Caught Here

Hansford County Sheriff's officers arrested two men wanted by the Navy as deserters here this week.

Sheriff J.B. Cooke said Bob Christie and Mike Brady were arrested and turned over to Air Police from Amarillo Air Force Base. They will be turned over to the Navy.



SHOPPER--This driverless car went into the front of Bob's Sales and Service Tuesday morning. The car is owned by Rex Sanders. It was left running at the curb and somehow got in gear to go on the sidewalk.

Plainsman Photo

School Board Gives Approval For Two Federal Programs

The Spearman school board voted Tuesday night to participate in two Federal Government Title III programs.

One of the projects is known as the Canyon project. This involves all the Panhandle schools in the PESO program. This program has been approved and funds are available.

In the Canyon program there will be the development of exemplary programs in certain fields. These different programs will be established in different schools. Then the other schools in the program will study the exemplary programs in the schools and then take the results back to their schools for possible use.

The areas to be studied will be the non-graded elementary school, social studies (world history), elementary science program, English-language arts programs, CAI program and NASA material programs.

Dr. Bill Reeves said Spearman is interested right now in the non-graded elementary school and the elementary science program.

He pointed out that specialists who have studied the programs all over the nation will be available to help on all the projects. Also, local teachers and administrators will study in workshops in preparation for setting up projects.

The second project is the Spearman project. This is still in the planning stage. It must be presented, approved and funds provided under the Title III program.

The Spearman project in-

volves the north part of the Texas Panhandle, Oklahoma Panhandle, Northeastern New Mexico, Southeastern Colorado and Southwestern Kansas.

In the project proposal the aim of the program is to pro-

vide specialists personnel to local districts in evaluating present programs and in planning future programs in academic and service areas.

Centers would be set-up (Con't. on back page.)

Commissioners Will Not Call Bond Election

The Hansford County Commissioners Court Monday refused to let voters have a voice in deciding the fate of the proposed Hansford County library.

The court refused to call a proposed \$100,000 bond election for the construction of the library after a petition bearing the signatures of 216 voters were presented to the court.

Precinct Commissioner Joe Day made the motion to call the election, but the motion died for the lack of a second.

County Judge Johnnie Lee said the court could refuse to call a bond election for bonds for such things as libraries and other things the court feels are not necessary and will raise taxes. The court is required to call an election when petitioned for roads and health facilities.

The petition had been awaiting action since it was circulated last spring. The library board had agreed last May to wait 90 days before bringing it before the court.

Mrs. Wesley Garnett, Mrs. Tom Etter and Dr. Bill Reeves represented the Library Board at the meeting Monday.

The commissioners opposing the bond election, Buddy Lowe, B.W. Renner and Edd Vernon, all of Gruver, opposed it on the grounds it would raise taxes.

Judge Lee said any tax increase would be on local property owners, because the oil companies would fight any further tax increases.

The court is afraid the oil companies will demand an equalization of property values for tax purposes if there is any further increase in taxes.

Mrs. Tom Etter said one of the commissioners opposing the bond election said he opposed calling the election because he was afraid the people would not know what they were voting upon.

Mrs. Etter said it was also brought up that before too long a bond election will be necessary to enlarge the courthouse.

Library Board Chairman Emmett Sanders was out of town attending a funeral and did not get to attend the meeting.

He said this week that the people should have had a chance to decide the library question. He said the county is in good financial situation and if the people wanted the library, they can afford to pay for it.

In other action the court agreed to suspend the time limit on the construction of the \$20,000 overpass on the dirt road between Gruver and Morse. This overpass crosses the railroad just west of the intersection of highway 136 and the FM road that goes through McKibben.

Mrs. Dickie Robinson was appointed County Health Nurse at no salary.

The Court approved the purchase of a historical marker for Hansford Cemetery. It is the first official cemetery in the county. The marker cost \$160.

The court also approved the payment of \$304.50 in charity bills from grocery stores, drug stores, doctors and rest homes.

Four Selected As All-Tourney

Four members of the Spearman basketball teams in the Gruver tournament were named to the All-Tournament team by a vote of the coaches of teams playing in the three-day contest.

Charles Shieldknight was selected from the Lynx and Lynettes Marsha Shieldknight, Barbara Wilde and Nancy McCullough were selected. Shieldknight and Wilde are forwards and McCullough is a guard.

Latham Hurt In Home Fire

Orville Latham received a severely burned hand in a fire at his home about 3 p.m. Tuesday.

An electric light in a small doghouse at the rear of the house shorted out and ignited the doghouse and the blaze damaged the back of the Latham home at 903 S. Bernice.

Firemen said that Latham burned his hand while fighting the fire. He said he slipped and put his hand against the hot asphalt shingle siding. He had the blaze almost under control when the firemen arrived.



SHIELDKNIGHT SCORES--Sophomore Marsha Shieldknight beats the Sanford-Fritch defenders on this lay-up shot. The speedster began shooting Tuesday night and led the Lynettes in scoring with 26 points. Barbara Wilde and Linn Robinson are the other Lynettes.

Plainsman Photo

Spearman Study Club Hosts Tour Of Homes

Unusual Christmas decorations were featured at seven area homes Sunday, Dec. 11 when members of Spearman Study Club hosted its tour of homes.

Guests were greeted from 2 until 5 p.m. at the homes of the Rev. and Mrs. Wesley Daniel and the Kiff Whites in Spearman; in Waka at the home of Mrs. Sandra Ladd; and at the country homes of Mr. and Mrs. Chalmers Porter, Mr. and Mrs. John Trindle, Mr. and Mrs. Frank Davis and Dr. and Mrs. Earl E. Novak.

Handmade Christmas decorations were featured at many of the homes and guests also enjoyed viewing unusual furniture and arrangements, draperies, the arrangements of new and remodeled homes as well as traditional holiday decorations.

Assisting with hostess duties at the Porter home were Barbara Pendergraft, Patty Sheppard and Betty Porter.

At the Trindle home guests were greeted by Mr. and Mrs. Trindle, Jan and Connie, Mary Jane DeArmond and Sherry Partridge.

Assisting Dr. and Mrs. Novak in hosting guests in their home were Karen Countiss, Jo Larson and Kay Vernon.

Mrs. Ladd was assisted in greeting guests at her home by Margaret Adamson, Judy Martin and Marilyn Wilson, who also served refreshments of wassail and an assortment of dainty Christmas cookies and candies from a table laid with a red Christmas cloth.

At the White home, guests were greeted by the Whites.

Annual Christmas Party Held

The Arts and Craft Guild held their annual Christmas party Friday, Dec. 9 at 2:30 p.m. at the HD Club building. Hostesses were Mmes. Deta Blodgett, Bill Russell and Guy Fuller, who presented beautiful Christmas corsages to all present.

Gifts of hand painted plates were exchanged.

Delicious refreshments of Christmas sandwiches, date pudding, pickles, olives, coffee and tea were served to members, Mmes. P.A. Lyon, Garrett Allen, F.J. Daily, Kiff White, Fred Hoskins, Pope Gibner, Freeman Barkley, Joe Dan Bryan, Nolan Holt, Ned Turner, Bruce Sheets, Clay Gibner, Joe Traylor, J. E. Womble and the hostesses.

Masonic Hall Is Scene of Holiday Party

The Order of Eastern Star held their annual family Christmas party Saturday evening at 6:30 at the Masonic Hall.

Each family brought a covered dish and all enjoyed a bountiful dinner. The tables were gaily decorated in the Christmas motif and the serving table was laid in white with a feathered flower arrangement flanked on either side with multi-colored candles.

Gifts were exchanged by all attending.

Present were Messrs. and Mmes. Don Hendricks and Danny, Roy Jones, Roy Lee Uptergrove and children, Preston Scott, Archa Morse, Miss Judy Creacy, Bobby Brown and Deta Blodgett.

Joyce Lackey and Frankie Sloan.

The Methodist parsonage, home of the Rev. and Mrs. Daniel was opened to guests on the tour with Linda McLain and Dona Baxter assisting the hosts.

Mr. and Mrs. Frank Davis' home was another of the homes on the tour. Lois Shieldknight and Margarette Evans assisted the Davises in welcoming guests.

Evans Hosts Bridge Club Evening Party

Mr. and Mrs. James Evans and Mr. and Mrs. Sid Evans were hosts for their bridge club Saturday evening at the Hospitality Room of the First State Bank.

Jack Reed held high score for the men and Gwen Reed had high score for the women. Low score was held by Sarah Gooch and Tommie White. Traveling prize was won by Kay Nollner.

Assorted nut breads, snacks, coffee and cokes were served to guests and members, Messrs. and Mmes. Jerry Evans, Roy Bulls, Tommie White, Bobby Nollner, Jack Reed, J.L. Brock, Bill Douglas, Tommie Gooch and the host couples.

Square Dance Association Elects Officers

Six members of the Do-Si-Do Square Dance Club of Spearman were elected to offices in the Panhandle Square Dance Association.

Mr. and Mrs. Jack Gilbert were elected Vice President of District Five. Mr. and Mrs. Robert Adamson and Mr. and Mrs. Cecil Reynolds were elected representatives.

The Do-Si-Do club is planning a salad supper on Jan. 14. All persons interested in learning the square dance are invited to attend.

The club had a dance Saturday night with Archie Flowers of Borger and Gene Umphress of Perryton as guest callers. Robert Adamson was the regular caller.

Spearmanites Attend Rites

Mr. and Mrs. Homer Sanders and Emmett Sanders were in Corsicana last weekend attending the funeral services of an uncle, Mr. Jim Moore.

Services for Mr. Moore were held Sunday.

He had lived in Clarendon and Claude at one time, but had lived in Corsicana for the past 25 years.

Frank Davis Home Is Scene For Christmas Club Party

The Dahlia Flower Club met Monday afternoon in the country home of Mrs. Frank Davis for the annual Christmas party and gift exchange. Hostesses were Deta Blodgett and Mrs. J. W. Walker.

Mrs. Olin Sheets, president, called the meeting to order, minutes of the last meeting were read and the roll call answered with "Christmas

The Plainswoman



VISIT WITH SANTA—Four Junior High band students give their orders to Santa at the opening of the Christmas season in Spearman recently.

Baptist Church SS Class Holds Christmas Party

The TEL Sunday School Class of the First Baptist Church met for their Christmas party in the country home of Mrs. Fred Fewin. Mrs. Lera Langston gave the opening prayer, the business meeting followed. The class prepared baskets of fruit and took them

to the Hansford Hospital. Mrs. Ruby Wilbanks gave the devotional, taken from the 2nd chapter of Luke. Mrs. Lillie Hacker gave the closing prayer.

Refreshments of fruit cake, fruit salad and hot punch were served to Mmes. Lera Langston, Lillie Hacker, Lena Stephenson, Dan Jackson, Dana Hazelwood, Hattie Mackie, Susan Wagnon, Alma Kizziar, Ethel Baley, Ruby Wilbanks, Sibyl Jones, one guest, Mrs. Jackson's daughter, Winell Leverton of Odessa by the hostess.

A gift exchange was also enjoyed by the group.

Community Christmas Tree Given

The annual Waka school Christmas program and community tree will be presented Monday night, Dec. 19 at 7:30 at the Waka School Cafeteria when the Waka P-TA meets for their monthly meeting.

A paginat, "Christmas Around the World" will be presented with each student of the school participating.

Santa Claus will make his appearance to give out the presents and treats at the close of the program.

Serving on the treat committee are Messrs. and Mmes. David Burger, Bob Mosier, and Carl Scroggs.

The public is cordially invited to attend the evening of festivities.

Christmas Program To Be Given

A Christmas program will be presented at the First Presbyterian Church at 7 p.m. Sunday. The program will be presented by the Church school.

The program will be preceded by a supper at 6 p.m.

On Christmas Eve a Candlelight Communion Service will be held in the church at 7 p.m.



Day by Day

by Day McClellan

Sunday was a sort of holiday for those of us, and there were many, who made Spearman Study Club's tour of homes and visited Windy Acres Farm for the annual Christmas open house.

Every single home was elaborately decorated for Christmas. I suspect many of the hosts and hostesses had been getting things ready for weeks or maybe months when you consider how many decorations were handmade.

At the Frank Davises' country home many of us were entranced by Mrs. Davis' electronic oven which she uses only occasionally.

You see you have to use the exact recipes that come with the oven and follow instructions and timing to the letter in order to use the oven. And, Mrs. Davis had already established herself as a wonderful cook on her own before the electronic wonder was added to her kitchen, so for lots of things she prefers her own recipes and know-how and her regular oven.

However, Mrs. Davis thinks an electronic oven would be ideal for the working girl because foods are cooked in a matter of a very few minutes with a minimum of effort. I was quick to agree with her! (I only wish I could believe Santa had taken the hint.)

Anyway, you bake in either paper or glass containers and lift the container right out of the oven without a potholder because it's only slightly warm to the touch even though the food is piping hot.

Mr. Davis popped us some very tasty popcorn in a plain old brown grocery sack in the oven. It was fascinating to smell the familiar aroma and to watch the bag fill up as a few seconds ticked off on the oven timer!

An enormous old-fashioned tree that would delight the heart of any child stands in the living room of the Davis home. It is as tall as the room allows and covered with literally hundreds of baubles and lights that bring back special memories because they have been collected through many happy Christmas seasons.

For the past few years, Mr. and Mrs. Davis have joined their only daughter, her husband and son for Christmas in Colorado. This year they aren't making the trip but their grandson was here this week on his way home for Christmas. "However, we always put up a big tree whether we are at home for Christmas or not," Mrs. Davis stated, "and it always stays up until New Year's."

One very unusual idea for the base of the Christmas tree is carried out each year by the Davises. They place a large ring of greenery, highlighted by a strand of tiny white lights in glistening pine cones, around the packages under the tree. When the packages are opened, they put the bows and trims back under the tree inside the ring of greenery, and it still looks beautiful!

I thought that was an especially good idea since the Christmas tree usually looks kind of sad and forlorn when all the pretty packages are gone.

Another highlight of the tour was Bobbie and Earl Novak's beautiful country home which has been completed in the past few months. You just must wrangle an invitation out of the Novaks so you can see their beautifully furnished home for yourself. That probably won't be too hard to do wither because I think they are pretty proud of it.

As Karen Countiss, a member of the houseparty, said when we entered the exquisite burgundy and white living room, "Don't you just feel like you ought to talk in a whisper in here, it's so beautiful." And that you do.

The new home of the John Trindles is another one you must see for yourself. Maybe it's their background in 4-H or could be it's their mother's training, but both Jan and Connie Trindle have picked beautiful color schemes and handsome furnishings for their own rooms; both rooms seem to suit their personalities perfectly.

Betty Porter's talent as an artist and collector of antiques as well as her hobby of refinishing furniture show in the decor of her home. Betty, Chalmers and their three sons are all artists, you know, so they enjoy displaying their art throughout their home. It's quite good indeed. Even seven-year-old Raymie paints beautifully.

If you know Sandra Ladd you probably would expect her to do beautiful handwork. I had never been in her home though or even through her Needlework Nook over at Waka, so it was a real pleasure for me.

Sandra's Christmas decorations carried out the "Partridge in a Pear Tree" theme even down to that particular piece of sheet music being out on the piano.

You can't imagine what beautiful things you can make for Christmas unless you've seen Sandra's handiwork. I think her mother may have made the lavish felt wall hanging of three kings which caught everyone's eye so I guess talent runs in the Stump family.

There were some other stops on the home tour at other beautiful homes. I hope Spearman Study Club makes a tradition of the tour at Christmastime. It was lovely.

I could go on at length about all the pretty decorations, the antiques and most of all the congeniality at Windy Acres Farm's annual open house, but I think I've used up all the adjectives I know.

This recipe for cranberry crunch is delicious served in squares topped with scoops of vanilla ice cream. It's especially good served warm.

CRANBERRY CRUNCH

1 cup (uncooked) oatmeal
1/2 cup flour
1 cup brown sugar
1/2 cup butter
2 cups cranberry sauce (jellied or whole)
Mix oatmeal, flour and sugar. Cut in butter until crumbly. Place half of this mixture in a greased 8 x 8 inch cake pan. Cover with cranberry sauce. Top with remainder of oatmeal mixture and bake at 350 degrees for 45 minutes.

The Hansford Plainsman

PUBLISHERS INC.



Co-Publishers . . . Jim O. Davis and Burl McClellan
County-Wide, Independent Newspaper published every Thursday and Sunday at 209 Main St., Post Office Box 668, Spearman, Texas 79081. Second Class postage paid in Spearman, Texas 79081.
Editor Burl McClellan
Manager Jim O. Davis

Lynxettes Defeat Eagles In First District Game

The much talked about one-two punch of Barbara Wilde and Marsha Shieldknight developed here Tuesday night and the Sanford-Fritch Lynxettes were annihilated 55-40 in the opening district game. Sophomore Shieldknight found the range on a new style offense and pumped in 26 points on nine field goals and eight free shots to lead the Lynxette scoring. Senior Wilde was right behind Shieldknight in the point department with 25 points on 10 field goals and five free shots. Linn Robinson had two points on two free shots and Cather-

ine Lyon got two points the same way. Fritch's tall Linda Moore kept the visitors in the scoring department with 28 points on ten field goals and eight free shots. Linda Yell had 12 points, but they were not match for Lynxette combination. Moore gave the Lynxette defenders plenty of trouble as she was able to rebound over them and shoot over their heads. She is over six feet tall and jumps well. Shieldknight was hitting from outside on jump shots over a screen by Wilde. Wilde was scoring off the post and from the outside. Nancy McCullough led the defensive unit with Sandra Shufeldt, Jyniece Callaway, and Jeanette McAdams seeing most of the outside duty. In the last quarter all of the reserves saw action.

MOO-LAH!

The highest price ever paid for a cow was \$40,600, in 1873, for a Shorthorn, "8th Duchess of Geneva," at a New York Mills auction.

About 25 million tons of fish are taken from the seas of the world each year, for human consumption. Yet-over half of the world's population never seem to get enough to eat.

Fritch Give Lynx First District Loss

Spearman's Lynx dropped their first district contest here Tuesday night as they let two leads slip away from them and fell to Sanford-Fritch 55-48. With Charles Shieldknight leading the way the Lynx got off to a good start and were leading 15-10 at the end of the first quarter. Shieldknight got all 10 of his points in the first half. The Lynx broke Fritch's full court press in the second quarter and built up a 19-10 lead on some quick down court passes. Midway of the second quarter the Lynx defense went to pieces and Fritch pulled to a 27-29 halftime lead. They did most of their damage driving in for lay-up shots. The visitors pulled away to a 33-38 third quarter lead. In the fourth quarter the Lynx rallied and tied the game at 41-41. Mike Hendrick led this recovery with some timely ball thefts. Spearman went ahead 43-41 but lost the lead on some fouls and close-in shots by the Eagles.

Lynx in scoring with 13 points. Carroll Day had 11 and Shieldknight had 10. Hendrick had eight, Gary Faries four and Benny McCullough two. Joe Whatley led Fritch with 12. He was the only visitor to get in the double figures. Spearman made 10 of 18 free shots and Fritch made 13 of 21.

Eight Grade Defeat Sunray

Robert Archer scored 17 points to lead the Spearman Eighth grade to a 38-23 win over Sunray here Monday afternoon. The Eighth graders made 14 of 18 free shots in the game. Edgar Womble led the free shot parade with eight of nine attempts. He had 12 points in the game for second high scoring honors.

Spearman was down only three points going into the last two minutes, but foul mistakes and two quick lay-ups by the Eagles put the game out of reach. Carl Close hit nine points in the fourth quarter to lead the

Mrs. George Archer of Alpine, California came Dec. 2 and is spending the month with her sister, Mrs. C.A. Kleeberger. Mrs. Kleeberger is recuperating after surgery at her home.

Miss Barkley Is Sorority Pledge

Mary Ellen Barkley, daughter of Mr. and Mrs. Freetman Barkley, has been accepted as a pledge into Mu Phi Epsilon, international professional music sorority at Texas Technological College. Those asked to become members are selected on the basis of scholarship (3.0 grade average in music and a 2.5 overall grade average), musicianship, character and personality.

Lynx Team Improving

The Lynx basketball team is greatly improved from last year. The team is anchored by four lettermen from last years team. One of the Lynx is Carl Close, a 6 ft. 4 in. senior. Carl is a two year letterman. Also there is 6 ft. 1 in. Charles Shieldknight, a one year letterman; Mike Hendricks, 5 ft. 11 in. also a one year letterman. Carrol Day, a 6 ft. one year letterman. These boys are joined by Gary Faries, Harley Reeves, Steve Drake, Steve Jordan, Benny McCullough, Mike Davis and Joe Hutchison. "The team is really trying this year; we hope that the student body comes to every game possible to give the boys the support that they need," says Carl Close.

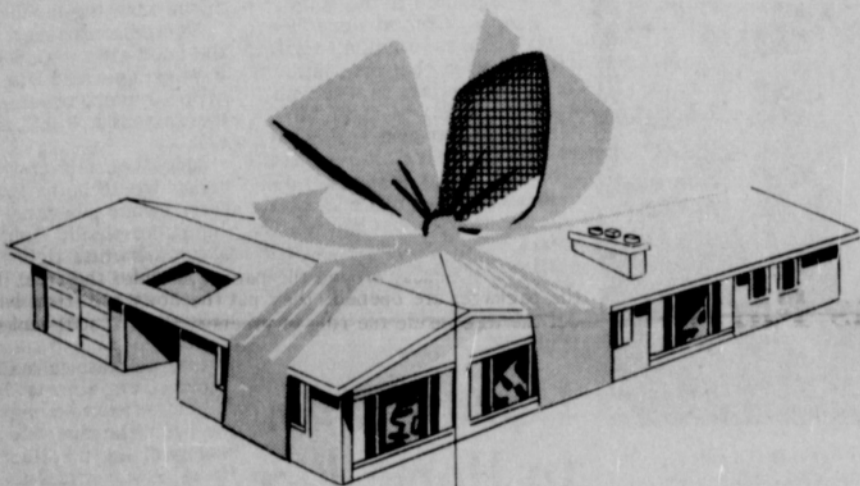

Total comfort and convenience in one neat package...



TOTAL ELECTRIC LIVING

(WHAT BETTER GIFT COULD YOU GIVE YOUR FAMILY?)

In a Total Electric Gold Medallion Home, the joy of better living is all wrapped up and waiting for you and the family. You work or relax in comfort year around in the delightful climate provided by electric heating and cooling. Electricity cooks your meals, heats water and performs many other household tasks the clean, flameless way. And planned, modern lighting adds a special glow of charm to your home. Decide this Christmas to give your family the time-saving comforts, the work-saving conveniences of Total Electric living. We can give you full information on Gold Medallion standards before you buy or build.

COMMUNITY PUBLIC SERVICE

Your Electric Light & Power Company



LOOK WHAT SANTA FOUND

YOUR PHILCO DEALER!



WE HAVE STEREOS & RADIOS TO FIT EVERY BUDGET

LOOK FIRST AT BURTON'S

YOUR PHILCO SALES & SERVICE HEADQUARTERS

WHEN YOU NEED SERVICE THINK FIRST OF BURTON'S TV

GLEN MAYBEN SERVICE MAN OVER 20 YEARS EXPERIENCE

BURTON'S TV

106 E. KENNETH

PHONE 659-2121

CLASSIFIED ADS WORK WONDERS

FOR SALE

For Fuller Brush products write 2301 Georgia Drive, Perryton, Texas or call 435-4967. 73tfc

FOR SALE-Corner bathtub, Virgil Wilbanks, 659-3385. 3-tfc

FOR SALE-3 bedroom house, garage, built in electric range, approximately 4 years old. Phone 659-2837 or 99979. 15-8c

FOR SALE-2 girls bicycles, new tires, good saxophone. Ph. 2644. 14-tfc

FOR SALE-1962 Skyline house trailer, size 10' x 50' with kitchen, living room, 2 bedrooms and bath. This mobile home is in excellent condition and can be seen by contacting George C. Miller, Darrouzett, Texas. 7-tfc

Industrial lots on Gruver Highway. Cecil Crawford, 659-2409. 61tfc

FOR SALE-50 ft. antenna. Call 2082. 15-tfc

3 bedroom brick house, 2 baths, fenced--to be shown by appointment. Only call 659-3166, 1005 Barkley, will take trade for equity. 80tfc

Select your Christmas cards today from our selection of Hallmark cards in a wide variety of choices. Plainsman Office Supply.

FOR SALE-Lot and barn with water in Crawford addition. Cheap. See Pete Vernon. 104-tfc

FOR SALE-Ideal, industrial lot 100' x 225' with good fence, Emmett Sanders, Real Estate. 6-tfc

Electrolux

The Amazing Electrolux with power nozzle. Rotating brush action cleans all rugs faster--gently fluffs carpet nap. Sales and Service, call Don Seymour at 435-3880, Perryton, Texas. 68-69-p-70tfc

Parts of the old Wilderness Road, forged through Kentucky wilderness by Daniel Boone, are now parts of U. S. 25, commonly called the Dixie Highway.

Beautiful selection of Hallmark Christmas cards at Plainsman Office Supply.

Write Santa in Care of The Plainsman, Box 668, Spearman, Texas.

WANTED TO BUY-Cash register. Call 2466. 12-tfc

610,000 American people are directly affected by TB. Use Christmas Seals to help them.

WANTED-Shop Hand. Apply in person at Permian Corporation. Phone 659-2572. 9-tfc

WANTED: Real estate listings; Emmett Sanders, real estate broker. Phone 659-2516, nights 659-2601. 104-tfc

LOST-full grown wire haired terrier, white with a few brown markings on head. Wearing yellow and black collar, no tags. Answers to "Sam". Call Mrs. Jimmie Shieldknight at 659-3460. 17-tfc

The United States imports about \$12 billion worth of nine food products yearly--coffee, sugar, fruits and nuts, fish, chocolate, tea, fancy vegetables spices and cheese.

SERVICES

SERVICE-Ditches from 3-12 inches, any desired dept. S. D. Jones 659-2809, Harold Shaver 659-3474. 17tfc-c

WANTED: Irrigated and dry farmland. Cash lease or crop rent. Phone 3063, Spearman. 1-tfc

SHORT AND SWEET



Bread was accidentally born thousands of years ago... As legend has it, in 1500 B.C., an absent-minded Egyptian baker left some dough standing out overnight... By the next morning, the dough had curiously doubled in size... He baked the mysterious dough and to his surprise the first yeast bread in history was born... From that day on, what came to be known as bread, was highly acclaimed... Skillful bakers artistically kneaded their breads in a variety of shapes -- round, conical, braided--the more enterprising among them carefully carved bread into fish, bird and pyramid forms... In fact, bread was so prized by Egyptians that pharaohs used the decorative loaves as barter.

Service ditches and foundations dug. Call Don Schmehr 659-2858. 10-tfc

LADIES-Like to be your own boss with unlimited earnings potential? Part time or full time. Husband and wife can work together. For interview appointment Call Ft-2763 Gruver. 13-4p

LOST-3 mo. old English Setter bird dog. Collar has Bossen, Amarillo, Texas on it. Phone 2743. 12-tfc

FOR RENT

FOR RENT-Downtown Apts. Furnished 1 and 2 bedroom. Call 2269. 11-tfc

FOR RENT-One bedroom brick apt. Call 2274. 93-tfc

FOR RENT-2 room furnished apartment. Phone 3239. 16-2c

FOR RENT-Four room house, newly decorated, \$55. 210 N. Snider. See party next door. 17-1c

FOR RENT-2 bedroom house. 1002 Evans. Call 2770 or 3017. 17-tfc

IMPORTED DATES FOR COOKING

It's well known among home-makers that different apples, oranges and potatoes should be selected for different cooking purposes. But did you know that there is also an important difference between imported and domestic dates?

You'll find that both types are wonderful for eating right as they come from the package. However,

when dates are to be used in cooked or baked dishes, you would be wise to select imported dates, advises the Bordo Products Company. Imported dates are more richly flavored than domestic dates, and therefore, imported dates retain the date flavor far better under the heat of cooking. Imported dates retain their form and texture best, also.

Shop in Spearman this Christmas season. You'll find many bargains and all the name brand merchandise you have come to know and appreciate.

Hallmark Christmas Cards, and they're more beautiful than ever, at Plainsman Office Supply.

For Your Convenience We now have

ICE

L. D. Staggs Top Mechanic

Simmons CHEVRON SERVICE

Loren Simmons 659-9985 Plains Shopping Center

THE HOME FOR ACTIVE FAMILIES-2019 feet of floor space with all the closets a home needs, two full baths, play room, formal living room and the biggest master bedroom you've ever seen. Three bedrooms, built in appliances. Don't spend another cramped Christmas season. Call Macias Construction Co. Perryton-435-5464 or 435-2030, FHA Loan, lots of money available for homes. 10-12c

MACIAS CONST. CO. is proud to announce that Mr. Lloyd King has joined their staff to bring his experience as a custom builder of fine and larger homes to the Panhandle area. Complete services from planning through building is now available. If you are thinking of trading in your present home or building call Mr. Lloyd King at 435-5464 or 435-2030 in Perryton. 10-12c

Saucy Holiday Touch

Sauces give a crowning touch that makes your holiday desserts extra special. yet they require only a few additional minutes to prepare.

For example, serve a hot lemon butter sauce over warm slices of date pudding or other similar holiday dessert. The tangy flavor of the sauce nicely complements the sweetness of the pudding.

A sauce to serve either hot or cold is a traditional hard sauce with a lemony flavor. It's delicious on fruit cake or steamed pudding.

Both sauces are prepared from convenient bottled lemon juice... a great kitchen aid to have in your refrigerator during the busy Christmas season.

You can serve holiday sauces over many other dishes too. Have you ever tried pancakes topped with a hard sauce? It's a particularly delightful combination for breakfast or brunch. Or serve hard sauce on mince or apple pie. Lemon Butter Sauce might also be spooned over cake or ice cream.

Lemon Butter Sauce
1/2 cup ReaLemon bottled lemon juice
2 cups sugar
3/4 cup butter or margarine
4 eggs

Combine bottled lemon juice, sugar and butter or margarine in a sauce pan; cook over low heat until butter is melted and sugar is dissolved. Remove from heat. Beat eggs until thick and lemon colored; blend into lemon mixture. Return to heat and cook, stirring constantly, until mixture coats a spoon. Serve warm, over holiday pudding, ice cream or cake. Yield: 3 cups.

Lemon Hard Sauce
1/2 cup butter or margarine
2 tablespoons ReaLemon bottled lemon juice
2 1/2 cups confectioners' sugar, sifted

Cream softened butter or margarine; add lemon juice gradually and continue creaming until blended thoroughly. Add sifted sugar; stir until blended. Chill and serve. Serve over steamed puddings, fruitcake, pancakes or hot apple pie. Yield: 2 1/2 cups.

The Right Toy

At Christmastime, toys do more than gladden the hearts of preschoolers. They can, if chosen wisely, point the way toward new skills, new discoveries, new interests. According to Playskool Research, a child discovers himself and the world around him through play. Because the child depends on toys to help him grow, learn, and experiment, one of the most important responsibilities of the parent is to select the right toys at the right time.

Frame in Holly

Spread Christmas cheer all through the house by adding holiday color and greenery to pictures on the wall. The Picture and Frame Institute suggests decorating pictures with traditional boughs and cones, holly or mistletoe, strings of lights, or your own combination of favorite Christmas decorations. Or, "frame" pictures with holiday wreaths. Attach decorations to frames or the wall with masking tape.

Gift Pens

Do you have trouble understanding a friend's handwriting? Or, do your friends complain about not being able to decipher yours?

A person's handwriting is subconscious. Paper Mate researchers have demonstrated that a person who uses a fuzzy-tipped, scratchy pen writes the most illegibly. Give the same person a smooth-flowing pen and, unconsciously, he improves his handwriting.

All of which are some strong points in favor of slipping a gift pen into the Christmas stocking of your favorite correspondent.

Party Sausage Snacks

For holiday sweet-sour sausage snacks, drain 2 cans (5 ounces each) Vienna Sausages, reserving broth. Cut sausages in half. Combine sausage broth, 1 cup apricot jam or preserves, 1/4 cup pickle relish, 2 tablespoons ReaLemon bottled lemon juice, 4 teaspoons dry mustard and 2 teaspoons ginger. Heat and stir until blended; add sausages and heat through. Serve hot.

Tommy Gooch Agency

Farm Bureau Insurance

Spearman, Texas

Spearman TV & Appliance Service

All Brands Appliance and TV Service

Carol Willis TV

Junior Hollis Appl. 309 Main Phone 659-2625

Everett E. Greene Agency

Real Estate-Loans Insurance-Cattle Aluminum Pipes

410 Davis Phone 659-2587

White House Lumber Co.

Building & Plumbing Supplies
Phone 659-2818
306 Davis



Cummings

Refrigeration
Heating
Air Conditioning
Sales & Service
Specialist
659 - 2721
Spearman

City Directory

CLEANERS

CLEANING
PRESSING
CARPET

CLEANING SERVICE
COIN OPERATED
DRY CLEANING

FREE
PICK-UP & DELIVERY
PHONE 659-2511

Wardrobe Cleaners

Oscar Donnell
302 MAIN ST.
SPEARMAN, TEXAS
DENTISTS

F. J. Daily D.D.S.

16 SW COURT STREET
SPEARMAN

ELECTRICIAN

Anthony Electric
Industrial, Commercial
and House Wiring
Heating and
Air Conditioning
Contracting
and Repairs
Fully Insured

SHOPPING CENTER
PHONE 659-2441
BOX 727
SPEARMAN, TEXAS

BURGLAR ALARM
EARLY AMERICAN BURGLAR ALARM WAS A BRASS LOCK WITH A SMALL GUN BUILT IN; WHEN AN INTRUDER TURNED THE DOORKNOB, THE EXPLODING PERCUSSION CAP GAVE A LOUD WARNING!

KIRBY SPECIALS SERVICES
SALES PARTS
ALL MAKES & MODELS YEAR GUARANTEE
SPECIALIZE IN KIRBY, COMPACTS, ELECTROLUX, AND HOOVER
MOBIL UNITS SERVING YOU
LIBERAL VACUUM CLEANER COMPANY
704 S. KANSAS LIBERAL, KANSAS AREA OUTLET STORE
SPEARMAN HARDWARE
PHONE 659-2737

Part of all you earn - should be yours to keep

Ed Dear
Office: 659-2516
Home: 659-3073
222 Main St.
Spearman, Texas

Homemaking Notes

by Linda Webb
Home Demonstration Agent

The best defense against household stains is a good offense. As soon as a dropped lipstick lands on your best dresser scarf, or salad dressing splashes on a slipcover, go into action. Even short delay can be dangerous. "Set" stains are difficult and sometimes even impossible to remove.

Keep a chart of stain removal procedures where you can refer to it quickly. And remember that while home removal methods are usually adequate when dealing with washable fabrics, it's better to entrust non-washables to a professional spotter.

Removing Stains From Fabrics is a very good Extension Service Bulletin, giving directions for removing most types of stain you would encounter in your home. For your copy of this free bulletin, contact the Home Demonstration Agents' office.

Meanwhile here are some hints for removing several common types of stains which may likely occur during this holiday season.

Ballpoint Ink-Use carbon tetrachloride to remove the stains. Soak in warm suds, then wash and rinse in clear water. If discoloration remains on white or bleach fast material, use a mild bleach and re-laundry.

Instant Tea and Coffee-Pour boiling water from a height of 3 or 4 feet through the stained fabric stretched taut over a bowl. Then wash in hot suds.

Plastic Glue and Lacquers- First try removing stain by washing in hot suds. Actually, there are two types of plastic glues and lacquers. The type with a nitrocellulose base may be removed with any acetate, followed by carbon tetrachloride. The type with a resin base is soluble in acetone, followed by carbon tetrachloride.

CAUTION: Test the fabric first to make sure what acetone can be used safely.

Spray Paints: Use a dry cleaning solvent, such as carbon tetrachloride; then launder.

Liquid Shoe Polish: Fresh stains can usually be removed by laundering warm suds. If needed, follow up by sponging any residue on white or colorfast fabrics with a weak solution of bleach and re-laundry.

Hand Lotion: Most types including those with silicone bases, can be removed with hot suds.

Hair Sprays and Lacquers: Most sprays and lacquers can be completely removed with hot suds. Sponging with alcohol will remove stains made by a spray with a shellac base. But first pre-test to make sure that alcohol doesn't harm the dye or fabric-especially if it is an acetate fabric.

Hair Rinses: Sponge with vinegar and rinse thoroughly. Then apply a thick solution of soap or detergent suds and rinse again. Follow by laundering in clean suds with a little ammonia added. If necessary, use bleach on white or colorfast fabrics, and re-laundry.

Solid Perfume: This should wash out with warm suds. If it has an oily base, sponge with carbon tetrachloride, then re-laundry.

Perfumes and Colognes: Launder as soon as possible in hot suds, followed by bleaching with sodium perborate if the stain remains on bleachable fabric. Then re-laundry. The longer perfume "ages" the more damage its alcohol content may do to fabric.

Salad Dressings: If spilled on colored material, apply weak ammonia water or baking soda to the spot immediately to prevent any vinegar or lemon juice content from injuring dyes. Sponge delicate washable materials with lukewarm suds (not hot if egg or cream used in dressing). Apply a grease solvent such as carbon tetrachloride or benzene after the stain has been sponged with water and dried.

Candle Wax, Paraffin: Remove as much wax as possible by placing the stain between clean

white blotters or several layers of facial tissue and press with warm iron. To remove remaining stain sponge with a grease solvent. Or, if safe for the fabric, pour boiling water through the spot. Remove remaining stain with grease solvent.

Food shoppers have a wide variety of choices when shopping the frozen foods department for concentrated fruit drinks. Your choices range from lemonade to fruit drinks. Your choices range from lemonade to fruit drinks to fruit juices.

If you select juices, you have only juice or juices and very fine pulp. There's no water added. The label will indicate if sugar has been added. Cocktails and nectars are usually mixtures of juices and pulps with water and in some instances sugar and seasonings.

Fruit drinks may be artificially flavored and contain none of the natural fruit. Others may contain some fruit juice. Fruit punch is a mixture of juices. The combination of juices is shown on the label with the one named first in the greatest amount.

Instant and powdered drinks and liquid concentrates contain fruit or imitation flavor, fruit acid, and added color. Some are packed with sugar, and you add the water.

LAST NOTE: Whoops! Do be careful. In December it's so easy to slip up on the bills and down on the steps.

Junior Girls Beat Sunray

Spearman's Junior High girls basketball teams beat Sunray Monday afternoon. The Seventh grade won 33-13 and the Eighth grade won 30-27.

Scoring for the seventh grade was Sheila Patterson 14, Leslie Nollner 12, Marla McWhirter 4 and Diane Robertson 1.

Susan Brillhart led the Eighth grade with 14 points, Anita Smith had 11 and Wanda Green had five.

The girls play in Gruver at 6:30 p.m., Thursday.

Bowling Beat

Pintopplers League		
TEAM	WON	LOST
Neelys	37	19
Berrys	22	24
Boxwells	31	25
J.L. Brock	30	26
Ivans	28	28
Tendercrust	27	29
Massads	21	35
Gordons	18	38
HIGH TEAM SERIES		
Neelys	2079	
J.L. Brock	2076	
Tendercrust	2020	
HIGH INDIVIDUAL SERIES		
Juanita Tucker	502	
Sheryl Meek	496	
Jo Larson	463	
HIGH TEAM GAME		
Berrys	763	
J.L. Brock	754	
Neelys	698	
HIGH INDIVIDUAL GAME		
Juanita Tucker	179	
Sheryl Meek	174	
Lou Howk	173	
Ada Rex (sub)	206	

"The Messiah"

To Be Presented

The Community Choir will present "The Messiah" at the First Baptist Church of Gruver on Wednesday, Dec. 21 at 7:30 p.m. This program is sponsored by the Gruver Music Club. Everyone is invited to attend.

Morse Code

by Mrs. Earl Henderson

The Morse Jr. Leaders 4-H Club met Monday night, Dec. 5. Bob Womble gave a report on his trip to Citizenship Seminar this past summer. Sylvia Parks and Doug McCloy also reported on their trip to Chicago to National 4-H Congress.

The club voted to send Christmas boxes to servicemen from this county who are in Viet Nam. Each member volunteered what they would bring and met at the H.B. Parks home Saturday and packed the boxes. Nine boxes were sent to the servicemen. This was done instead of exchanging gifts for Christmas. Those sending food or helping pack these boxes were Judy Scribner, Becky Fleming, Carolyn Henderson, Wade Parks, Mark McCloy, Doug McCloy, Sylvia Parks, Susanne Dixon, Jimmie Dale Womble, Bob Womble, Mike Johnson and Alva Henderson.

The Morse Parent Teacher Association met Monday, Dec. 12 in the school auditorium. They voted to accept the recommendations of the executive committee of helping purchase a copying machine. The PTA will donate \$200 toward this purchase. The program was by the third grade under the direction of Mrs. Glover aided with the mothers in the making of the costumes. A beautiful Christmas pageant was presented.

The Lions Club of Morse will sponsor the community Christmas tree which is held annually. Anyone wishing to make contributions for this please contact any member.

According to Supt. Johnny Brumley, school will dismiss for the holidays at 2:30 on Dec. 22 and will resume at the regular time Jan. 3. All school parties will be held from 1:30 to 2:30 on the 22nd. The student council will be in charge of the party for grades 6 thru 12.

The Morse community extends their sympathy to the family of Chesta Lieb, who passed away Sunday afternoon and was buried Tuesday in Lieb Cemetery.

Card of Thanks

I wish to express my sincere thanks for the beautiful flowers, cards, visits and many other kind remembrances and attention while in the hospital and recuperating at home.

Mrs. C.A. Kleeberger

Guests in the Ray Skinner home last week were Mrs. Skinner's brother and wife, Mr. and Mrs. Claude Danford of Lamont, Okla.

Growth in Facilities Caused By Changes

COLLEGE STATION, Definite changes in the livestock and meat industry have resulted in growth of cattle feedlot facilities and specialized slaughtering plants in the Southwest, according to a research report just completed at Texas A&M University.

Dr. Raymond A. Dietrich, USDA economist assigned to the A&M Agricultural Economics and Sociology Department, said the report traces adjustments which have affected the entire marketing systems of the livestock and meat business.

Developments in food retailing, meat packaging, transportation, communications and cattle feeding have influenced the livestock and meat marketing picture during the past two decades, the report shows.

Large volume retail establishments, which generally feature fed beef, and a growing population with rising per capita incomes are important factors that have encouraged the surge of highly specialized, large-scale feedlots.

Dietrich said feedlots with a capacity to handle 1,000 or more cattle have more than tripled in Texas and Oklahoma from 1955-66. And indications are for cattle feeding to continue increasing in these states.

"Another interesting change is that the slaughtering industry is becoming more decentral-

ized with more specialization and a movement toward areas of concentrated livestock production," the economist pointed out. "These actions are taken to cut procurement costs and to obtain adequate supplies of slaughter animals."

Federally inspected slaughter plants which specialize in cattle and calf slaughtering more than doubled in Texas and Oklahoma in the past 10 years, Dietrich added.

Dr. Tyrus R. Timm, head of the A&M Agricultural Economics and Sociology Department, said the study is part of an expanding market research program being conducted at the university with the USDA.

"This research, like that with other major food items, is aimed at staying abreast of marketing changes so that the overall efficiency of the market system can continue to improve in all segments of our economy," Timm said.

Card of Thanks

We wish to thank everyone for the flowers, cards and visits during our stay in Amarillo and Perryton hospitals. May the Lord bless each of you.

Mr. and Mrs. Knox Pipkin

A NEW SERVICE

SYLVANIA SELF TUBE CHECKER

When you have trouble - bring your old tubes in. This machine will tell you what your trouble is.



SYLVANIA
GENERAL TELEPHONE & ELECTRONICS GTE
Sylvania Entertainment Products Corp., 700 Ellicott St., Batavia, N.Y. 14020

Replacement tubes are on sale to replace those old tubes.

Come in today and replace those weak tubes.

WESTERN AUTO

Associate Store

The Lynx Claw

High School News

Club Attends District Meet

The Library Club recently attended a district meeting at Levelland. After registration, the morning began with a business session in which Donna Byrd, treasurer of the district, ended with a report and new district officers were elected. When lunch was over, the members listened to a speech on the topic of how adults attempt to understand teenagers. The district meeting ended at 2 Saturday afternoon. The librarians enjoyed the meeting and getting to meet other school librarians.

Assembly Set For Dec. 21

During the past few days the Spearman High School Spanish I-II classes have been practicing for a Christmas program they will give on December 21.

The classes have been practicing Christmas carols in Spanish and French, and a short play concerning the birth of Christ.

The carols will be traditional ones from Spain and France. They will be sung by all the classes.

The play will also be traditionally Spanish and will be centered around the nativity scene.

The Spanish club will give the program with the choir and the aid of members of the Spearman High School Band.

All-Regional Band Holds Annual Concert

This last weekend the all-regional band held its concert. The band is made of members from all the bands in the region.

The tryouts for the band were held on Dec. 3 in Panhandle. The members from Spearman that made all-regional band are Danny Knox and Steve Baggerly, cornet; Toni Hudson, baritone saxophone; Janie Beck, bass clarinet; Pat Massad, clarinet; Larry Campbell, baritone; Jim David-Crawford, trombone; Randy Watson, bass; and David Holland, French horn.

The members of the all-regional band spent the weekend in Shamrock where the concert was held. The Shamrock Jaycee's furnished entertainment, such as a dance and a free movie.

Channing Drops Lynx In Gruver Tournament

The Spearman Lynx fell to Channing 60-55 in consolation finals of the Gruver tournament Saturday afternoon.

After trailing 15-7 at the end of the first quarter, the Lynx started hitting in the second quarter and were trailing only 21-27 at the half.

Charles Shieldknight, Carl Close and Mike Hendrick in the second quarter to pull the

Lynx within striking distance. Channing's Skelton hit 14 points in the third quarter to put Channing farther in front 47-37 at the end of the third quarter.

Spearman again closed the gap in the final quarter, but could not catch the front runners. Skelton had 36 points for the winners.

Shieldknight and Close each had 16 for the Lynx. Hendrick had 12, Benny McCullough had five, Carroll Day 4 and Gary Faries 2.

Both teams had 25 field goals, but Spearman made five on nine free throws and Channing scored on 10 of 18 free shots.

The Lynx grabbed off 32 rebounds to Channings 26.

Homeakers Give Christmas Party

The Future Homeakers of America had a Christmas party for children from the first through the sixth grade on Monday, Dec. 5. Sue Sloan led the group in singing and afterwards they played games including relay races and pin the tag on the tree. Following the recreation, refreshments were served to everyone attending.

Library Being Decorated

The library is being decorated for Christmas. In the library showcase, gift articles made by hand add to a creative Christmas spirit. When entering the library, a gay, colorful drawing of Santa Claus is posted on the bulletin board to greet you. The traditional large decorated Christmas tree stands in the back of the library overlooking all students of S.H.S. The Christmas spirit can be seen and felt by all students in the library.

New Colors For Christmas

To add spice to that winter wardrobe choose from all the latest Christmas colors. Poinsettia and holly red are sure to catch the eye of that special guy.

The pants suit, with the cut-away jacket and long-legged pants, will turn heads as you walk into the room. Add a white lacy blouse that spills over the jabot, for the feminine touch.

The long sweaters are great this year. Work with a kilt and knee socks, it makes a neat looking ensemble, very practical for the busy high school girl.

Tournament Set At Phillips

On Saturday, Dec. 17, the Spearman High School speech department will participate in a speech tournament at Phillips University in Enid, Okla. Although this is a tournament for the large schools in Oklahoma, Spearman received a special invitation to attend.

The two debate teams will be Gary Benge and D'dee Col-lard and Lisa Curry and Glynn Sanders. These teams will be required to debate a Cross-Examination style of debate which is different from the standard debate form.

Other entries are Boys Ex-temp, Marty Jones and Jock Lee; Standard Oratory, Lynn Brock and Steve Spoonemore; Poetry Interpretation, Cloetta Fullbright and Steve Spoonemore; Dramatic Literature Interpretation, Donna Ownbey; Humorous Literature Interpretation, Lynn Brock and Jan Jones; Original Oratory, Janice Buchanan.

New Musical Organization

Spearman High School has acquired a new musical organization. The band, named the Precious Few by the organizer's mother, played for the first time at half-time at the Gruver-Spearman basketball game. Everyone agreed that the Tijuana Brass music was good.

The members are: Gary Ellsworth, who is the organizer, and Lawrence Brown, cornets; Jim David Crawford and David McClellan, trombones; Brenton Haworth, drummer; Larry Campbell, guitarist. The band plans to specialize in Tijuana Brass-type music.

Girls Make Holiday Items

The homemaking girls will spend the last week and a half before the Christmas holidays making Christmas items. The following will be included among the Christmas items: kissing balls, Christmas stockings, candles, yardstick holder, padded clotheshangers, frosted jars, paper mache jewelry and tissue paper pictures.

LCC Band Gives Concert

Tuesday, Dec. 6, the Spearman High School was honored with a concert given by the Lubbock Christian College Royal Blue Band.

The band, directed by Spearman Ex Larry Kingsley, has two other Spearman exes, Patsy Kingsley, who is Larry's sister and Ernie Vanderberg.

The band played a variety of selections and featured three soloists: the first was a guitarist, Tom Waters, who got a standing ovation after the first of his three songs.

The other two soloists played with a band accompaniment. They were Robert Joe Lee, on a baritone, and Eddie Don Hankins, on a trap drum set. Robert Joe Lee played "Blue Bells of Scotland" and Eddie Don Hankins played "Hootenanny."

An extra treat was prepared ahead of time. Larry turned the baton over to Mr. Watson, who directed the band through a piece entitled "Vanishing Army."

Mr. and Mrs. Loyd Carroll spent Saturday in Amarillo on business.

School Menus

SCHOOL MENUS
 MONDAY, DEC. 19
 Barbecue on Bun
 Buttered Potatoes
 Polka Dot Corn
 Combination Tossed Salad
 Oatmeal Cake Milk
 High School Meat Choice
 Tuna Casserole
 TUESDAY, DEC. 20
 Cubed Turkey with Gravy
 Cornbread Dressing
 Green Beans with Bacon
 Candied Sweet Potatoes
 Stuffed Celery
 Festive Congealed Salad
 Bread Milk
 High School Meat Choice
 Ham Salad Sandwich
 WEDNESDAY, DEC. 21
 Grilled Cheese Sandwich
 Beef and Vegetable Stew
 One-Half Orange
 Christmas Cake
 Ice Cream Bars
 Milk
 High School Meat Choice
 Steak Fingers
 THURSDAY, DEC. 22
 MERRY CHRISTMAS

WIN A FREE TURKEY



Register Each Day Need Not Be Present To Win

ONE GIVEN EACH NIGHT
 Thrs.-Fri.-Sat.
 OPEN 8P.M. EACH NIGHT
Come Register

SHOP AT SEARS AND SAVE
 Satisfaction Guaranteed
 or Your Money Back

Sears

SEARS, ROEBUCK AND CO.

Gift Sale

Make this Christmas special for that loved one of yours by giving a gift they'll remember long after the holidays.

We have Gifts For every One of the family



SANTAS HEADQUARTERS FOR CHRISTMAS CHEER

Spearman Hardware

Christmas Cheer Starts **HERE**

WESTERN AUTO

IN SPEARMAN

IS THE BEST FRIEND SANTA EVER HAD!

THERE ARE GIFTS FOR EVERY MEMBER OF THE FAMILY

SMALL GIFT IDEAS!

Billfolds, Pendant Watches, Electric Razors, Swinger Cameras, Games, Toys, Dolls!

OUIJA BOARDS!



ANOTHER WESTERN AUTO
EXCEPTIONAL VALUE

(D) **40⁸⁸**
Layaway Now! \$1 Holds!

LARGE SELECTION BICYCLES

Coba and Hallicrafter Citizenband Radios

Handicraft Purses

You assemble these

Doll Houses

Baby Strollers



BILLY RAY HADEN WITH SANTA CLAUS



JEFF COUNTISS WITH SANTA CLAUS

Santa Claus

WILL BE IN OUR STORE THIS

SATURDAY FROM 3 UNTIL 7 .

BRING THE KIDS IN TO HAVE

THEIR PICTURE TAKEN

Starting Saturday Will Be Open Until 8:00 Until Christmas

Santa Sizzler
JUST 50c HOLDS 'til Christmas!

SAVE 15% on Western Flyer[®] Rocket!
6.99
Regular 8.25 Value in Our Big Catalog!

34 In. Long!
All Steel!
Sleek Red & White Beauty!
3PC1342

Santa Sizzler

HEAT Control Dial
Vanity Lid with Mirror
Large Fashion Hood

Wizard Hair Dryer
988
JC2570

Western Auto 55

MANY SHOTGUNS AND RIFLES

FREE GIFT WRAPPING

Western Auto
Associate Store



Perry Sheets

Sheets Receives Army Promotion

A Spearman man has been promoted to Captain in the U.S. Army, his parents learned here this week.

It is now Captain Perry Sheets. He was promoted from First Lieutenant this month.

Captain Sheets is Assistant Post Veterinarian at Fort Stewart, Ga., He is in the small animal clinic on the post.

Captain Sheets is a 1960 graduate of Spearman High School and a 1965 graduate of the school of Veterinary Medicine at Texas A&M University. He was commissioned First Lieutenant on June 13, 1965.

He is married to the former Sharon Novak of Spearman; they have three children.

He is the son of Mr. and Mrs. Daniel Sheets and his parents are Mr. and Mrs. Robert Novak, both of Spearman.

WMU Circles Hold Meeting

Mrs. Herb Howe was hostess for the Betty Morris Circle of the WMU when it met Wednesday morning at the First Baptist Church.

Mrs. Howe conducted the business session. The prayer calendar and prayer was given by Lena Stephenson.

Frances Kilgore, mission study leader, finished the book "Beneath the Himalayas".

Refreshments of hot cherries and apple pie was served by the hostesses to members, Miss Stephenson, Bob Baley, Al Kizzlar, Verna Jarvis, Kilgore and Wanda Widener.

The Carolyn McClellan Circle met Wednesday morning at the church with Mrs. Ray Devers as hostess.

Mrs. Delmar Parsons presided at the business session. Mr. Arthur Adkison and Mrs. A. Loftin led in prayer.

Mrs. Major Lackey gave the study "Beneath the Himalayas".

Present were Meses, Loff Lawton Guthrie, Adkison, Irene Anthony, Marshall Werner, Lackey, Abbye Ownbey Parsons and the hostesses.

The Willa Dean Murry Circle met at the home of Mrs. Patricia Conner with Mrs. R.H. Gray presiding.

The mission study was given by Dean Green who finished the book "Beneath the Himalayas". Prayer calendar was read by Pat Denham with Marguerite Nelson giving the prayer.

Mrs. Dana Hazelwood was the only member present other than those on the program.

Mrs. Scott Is Bridge Hostess

Mrs. Preston Scott was hostess to the Hi-Lo Bridge Club at her home, Thursday evening, Dec. 8.

Mrs. John Berry had high score for the evening and Mr. Joe Dan Bryan had low.

Attending were Meses, Berry, Bryan, R.E. Lee, W.H. Gandy, Vi Whitson, Gwen Lackey, Faye Lynch and the hostess.

Take your problems to Church this week — millions leave them there!

the Word

"Thy word is a lamp unto my feet; and a light unto my path."
— Psalm 119:105



If you are a Christian, you are blessed with a great heritage. It is a heritage of truth and has nothing to do with imagination or myths. It is a truth that remains unchanged, no matter how many times someone attempts to rewrite or offers a "studied" translation.

This truth is the word of God. It is found in the Holy Bible. It is found in Ten Commandments, which form a guidepost for Christian living.

Accept this truth; it is useless to argue against it. Conscience and common sense will not permit you to be unaware. You fool no one, not even yourself, if you pretend to ignore or disbelieve.

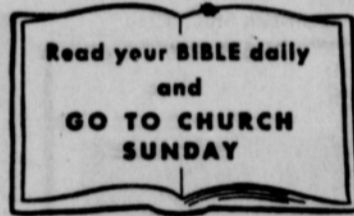

Sponsored By

**R. L. McCLELLAN
GRAIN CO., INC.**

FIRST STATE BANK
Member F.D.I.C.

B & B GRAIN CO., INC.

The Hansford Plainsman

Honor Roll Announced

Students in high school making the honor roll and honorable mention are:

HONOR ROLL
Debra Brock
Cloetta Fullbright
Toni Hudson
Randy Weston
Barbara Kitchens
Sharon Mauldin
Gary Cates
Donna Ownbey
Barbara Wilde
Susan Uptergrove
D'dee Collard
Hal Sanders
Rebecca Hutchison

HONORABLE MENTION
Dallas Haner
Kurt Shedeck
Cheryl Bollinger
Janice Buchanan
Marilyn Blodgett
Randy Collard
James Lemons
Marsha Shieldknight
Connie Trindle
Cindy Cochran
Marsha Schumann
Karen Baggerly
Joe Clement
Joe Cochran
Mike Cox
Sandra Fowler
Danny Hendricks
Lynn Hohertz
Hazle Leslie
Becky McClellan
Vicki Rosenbaum
Rondall Schell
Sandra Shufeldt
Cindy Ward
Frank Willmeth
DeAnna Sheets
Steve Spoonemore
Debra Largent
Pennye Sanders
Mike Banks
Lynn Brack
Linda Willis
Carla Archer
Melinda Pearson
Janice Trindle
Gail Upchurch
Dallen Scroggs
Sue Sloan
Steve Baggerly
David McClellan
Thel Daniel
Darlene Waggoner
Debbie Hazelwood
Linnie Bollinger
Glenna Sanders

Attend

The Church Of Your Choice Sunday



—Weekly Opportunities For Worship—

Apostolic Faith Church
Robert Girouard, Pastor

9th & Dressen
Sunday School 10:00 a.m.
Morning Worship 11:00 a.m.
Children's Church 7:00 p.m.
Evening Worship 7:30 p.m.
Thursday:
Prayer Service 9:00 a.m. to 3:00 p.m.
Night Service 8:00 p.m.

First Christian Church
Rev. Dayle Schnell

29 S. Bernice
Sunday School 9:45 a.m.
Morning Worship 11:00 a.m.
Youth Meetings 5:30 p.m.
Evening Worship 7:30 p.m.
Wed. Choir Practice 7:30 p.m.

First Methodist Church
Rev. Wesley Daniel, Pastor

407 S. Haney
Sunday School 9:45 a.m.
Morning Worship 11:00 a.m.
M.Y.F. 6:30 p.m.
Evening Worship 7:00 p.m.
Women's Society of Christian Service Wed. 3:00 p.m. and 9 a.m.
Choir Rehearsal 7:30 p.m.

**Sacred Heart
Catholic Church**
Rev. James C. Gurzynski

Sunday Masses 8:00 a.m.
11:00 a.m.
Wednesday evening

Sunday Mass 8:00 a.m.
11:00 a.m.
Wednesday 8:00 p.m.
First Baptist Church

Assembly of God Church
Rev. Roger Rounsaville

403 N. Bernice
Sunday School 9:45 a.m.
Morning Worship 11:00 a.m.
Sunday C.A.'s 6:30 p.m.
Evening Worship 7:30 p.m.
Wed. Bible Study 7:30 p.m.

Fellowship Baptist Church
Rev. Roy Meksch

11th & Archer
Sunday School 10:00 a.m.
Preaching Service 11:00 a.m.
Sunday Evening Service 7:30 p.m.
Wed. Evening Service 7:30 p.m.

**Waka
Church of the Brethren**
Lawrence Lehman, Pastor

Sunday School 10:00 a.m.
Morning Worship 11:00 a.m.
Evening Service 7:00 p.m.
Choir Practice Wed. 7:30 p.m.

Union Full Gospel Church
Rev. George R. Bollinger,
Pastor

1st & Endicott
Sunday School 10:00 a.m.
Morning Worship 11:00 a.m.
Bible Classes Sunday 6:45 a.m.
Evening Worship 7:30 p.m.
Wed. Bible Study 7:30 p.m.

Oslo Lutheran Church
Pastor, Edward Swanson

18 mi. N.W. of Gruver
Sunday School 9:45 a.m.
(includes adults)
Worship Services 11:00 a.m.

Church of Christ
Charles Milner, Minister

121 S. Haney
Bible Class 9:45 a.m.
Worship 10:35 a.m.
Teen Age Class 6:00 p.m.
Worship 7:00 p.m.
Wed. Ladies Bible Class 9:30 a.m.
Wed. Bible Study 7:30 p.m.
Daily Television on Channel 3, Mon. thru Fri. 10:15 a.m.

Pentecostal Church

Sunday School 9:45 a.m.
Morning Worship 11:00 a.m.
Evening Worship 7:30 p.m.

Faith Lutheran Church
Pastor William Hill

11th & Bernice
Sunday School 9:45 a.m.
Services 11:00 a.m.

**First United
Presbyterian Church.**
Rev. Lewis Koerselman

1021 Cotter Drive.
Sunday Church School 9:45 a.m.
Morning Worship 11:00 a.m.
Evening Study Group 7:30 p.m.
Wed. Choir Practice 7:30 p.m.



"Do not be afraid; for I know that you seek Jesus who was crucified. He is not here; for He is risen as He said . . ."
Matthew 28:5-6

Gift Box Memo:

Believe it or not, we have finally managed to get in some more of those round 72" vinyl tablecloths that everyone is so crazy about. They always go fast, so we urge you to hurry and get the ones you want.

With this shipment of round cloths we received a good selection of other size cloths in a new fabric. We realize not everyone has a round table, so we hope you will like these new cloths.

Something else that is new is the oval pictures in the antique frames. These are beautiful items we believe you will like, especially the frames. We, also, have an oval mirror in an antique frame. There just isn't anything square about this place.

For the gift for the little girl we suggest the Tinker Bell cosmetics for girls. We have soaps, powder, and colognes for little girls. The price begins at \$1.

Looking for a Christmas card for a special person, you will probably find it in our selection.

We still have a large selection of gifts for Christmas and other occasions. The prices start at \$1 and you get free gift wrapping.

Gift Box

Build-Up Started

COLLEGE STATION-Texas has already started the build-up phase of the beef cattle cycle.

We are running slightly ahead of the nation which is in the tail end of the liquidation phase, according to Ed Uvacek, Extension livestock marketing specialist at Texas A&M University.

Uvacek said the cattle cycle is simply the changes in the total numbers of cattle and calves on farms as of the first of each year. The cycle is in two distinct parts, the build-up or increase in numbers, and the liquidation or decrease in numbers, he said.

He said the present cattle cycle was at its low in 1958 and the build-up took place for seven years, reaching a new record high in U.S. cattle numbers in 1965. But at the beginning of 1966, fewer head were reported in the nation--indicating the beginning of the liquidation phase of the cycle. Forecasts point to a slightly further reduction in cattle numbers this year, with a possible build-up by 1968. This would mean a new cattle cycle is starting nationally, he said.

Since Texas is already increasing in cattle numbers, this indicates Texas is past the liquidation phase and into the build-up, he said. The reason is that Texas cattlemen have taken less time to readjust their herd sizes.

The A&M specialist explained that the slaughter of cattle and calves follows fairly close to the cattle numbers cycle. Usually as numbers increase, slaughter becomes heavier, and cattle prices are pushed somewhat lower. Then, numbers tend to decrease, pushing prices somewhat lower. Then, numbers tend to decrease, pushing prices somewhat higher, and so the cycle goes.

Cattlemen who can adjust their operation opposite to the national cycle, as Texas cattlemen are now doing, should be able to capitalize on the extra profit potentials, he said.

SAT Test

Given Seniors

Saturday, Dec. 3, the SAT test was given at Perryton High School. Lasting three hours, it consisted of verbal and mathematics tests. The purpose of the SAT test is to give the college to which the tests are sent an idea of the prospective college freshman's abilities. The colleges use these tests to decide whether to accept a person or not.

Students from towns all over the area took this test. Approximately fifteen Spearman seniors took the test.

Bowling News

WEDNESDAY MIXED DOUBLES		
TEAM	WON	LOST
Shurfresh	32	20
Cable TV	32	20
No. 7	27	25
Sprn Radiator	26	26
Riley Bros	25	27
Wardrobe	23	29
M&M	22	30
United Mud	21	31
HIGH TEAM SERIES		
No. 7	1936	
Cable TV	1873	
Shurfresh	1790	
HIGH INDIVIDUAL SERIES		
Sheryl Meek	564	
Shorty Hamlett	539	
Clyde Yeary	495	
HIGH TEAM GAME		
No. 7	669	
No. 7	646	
M&M	629	
HIGH INDIVIDUAL GAME		
Shorty Hamlett	204	
Clyde Yeary	198	
Sheryl Meek	195	

Lynxettes Dropped By Elkettes In Tourney

A first quarter surge by the Stratford Elkettes gave them a 48-41 win over the Spearman Lynxettes and the championship of the Gruver tournament Saturday night.

Stratford jumped off to a 19-7 first quarter lead before Barbara Wilde and company got rolling for Spearman. The Lynxettes were trailing 15-38 at the half.

The Elkettes scored well from the floor and their height advantage gave them control of the rebounds most of the game.

Spearman had cut the lead to 28-36 at the end of three quarters. Wilde turned in a great scoring effort in the second half, but was unable to overtake the Elkettes.

At one time the Lynxettes cut the lead to four points, but a series of fouls in the rough

and tumble contest killed their chance of overtaking the leaders.

Wilde had 33 points, Linn Robinson had six and Marsha Shieldknight had two.

Carla Hester had 24 for Stratford and the other two forwards hit in the double figures.

Mrs. B.J. Garnett's sisters, Mr. and Mrs. C.B. Alexander and Miss Lula Deck of San Marcos spent the past week in the Garnett home. Miss Deck remained for an indefinite visit with Mrs. Garnett.

Riding home with Lynne Garnett from West Texas to spend the weekend with their parents were Toni Morgan, Frances Whitson, Linda Hall and Ceedell Anderson.

High School Teams Enter A&M Tourney

The Spearman High School Lynx have entered the Panhandle A&M College High School basketball tournament. The tournament will be held January 5, 6, and 7.

The boys team will have a Class A, B, and C bracket, and the girl's teams will have a Class A and B bracket. These brackets will be released in the near future.

High schools that have entered to this date are: BOYS TEAMS: Sanford-Fritch; Spearman; Laverne; Price Catholic; Amarillo; Camp; Vilas; GIRLS TEAMS: St. Mary's, Amarillo; and Amistad. BOYS AND GIRLS TEAMS: Selling, Adams, Felt Boise City, Yarbrough, Goodwell, Plainview, Tyrone, Texhoma; Morse; Turpin; Eureka; and Edison; Yoden, Colorado. Others boys teams coming are Hooker, Woodward and Alva.

Calendar of Events

THURSDAY, DEC. 15 20th Century Club Christmas party at 2:30 p.m. at HD clubroom

B&PW Christmas party at Farm Bureau Building at 7:30 p.m.

Family Christmas party for Happy Homes HD Club at clubroom

SATURDAY, DEC. 17 Reunion and Christmas dinner for descendants of L.P. Brown family at HD clubroom at 6:30 p.m., Mr. and Mrs. Marion Close hosts.

MONDAY, DEC. 19 Blue Monday Christmas party-Mrs. Pope Gibner

Bridge Club Christmas party for husbands at Marvin Chambers home at 7:30 p.m. Kay Nollner hostess.

TUESDAY, DEC. 20 Lions Club

Hi-Lo Bridge Christmas Party at R.E. Lee home.

Spearman HD Club annual family dinner and gift exchange at HD clubroom.

We're Santas Little Helpers! To Help You Fill Those Christmas Lists.

By Simmons Reg. \$249.50

Hide-A-Beds \$198.50

Dresser, Mirror & Bed By Bassett Reg. \$199.50

Modern Walnut \$139.95

Dresser, Mirror, Nite Stand & Bed by Link Taylor Reg. \$423.95

Spanish Oak \$298.50

Early American Print By Broyhill

Chairs Reg. \$139.50 \$79.95

Turquoise French Provincial By Clyde Pearson

Chair Reg. \$149.50 \$98.50

Mediterranean Armless By Clyde Pearson

Chair Reg. \$159.50 \$98.50

Dresser, Mirror, Chest, Bed & Nite Stand By Bassett Reg. \$509.35

Mediterranean Pecan \$359.50

(Light Finish) Dresser, Mirror, King Size Bed & Nite Stand By Bassett

Mediterranean Pecan Reg. \$358.95 \$249.50

King Size By Samsonite Reg. \$58.75

Bridge Table & 4 Chairs

\$38.75

Modern Olive Green by Selig

Sofa

Reg. \$259.95

\$149.95

Gold Tufted Back by

Sofa

Clyde Pearson

Reg. \$319.50

\$198.50

Danish Modern Orange Tweed

Sofa

by Mattison

\$169.50

Early American Orange Tweed

By Broyhill Reg. \$159.50

Loveseat

\$129.95

Boody FURNITURE CO.

PLAINS SHOPPING CENTER
659-3044

Give A Gift For The Home

**SPEARMAN INDEPENDENT SCHOOL DISTRICT
STATEMENT OF CASH RECEIPTS AND DISBURSEMENTS
FOR THE FISCAL YEAR ENDED AUGUST 31, 1966**

DESCRIPTION	OPERATING FUND			Food Service Fund	Athletic Fund	Building Fund	Interest & Sinking Fund	Elementary & Secondary Education Act (Title I)	Other Special Funds	Totals
	State & County Available	Local Maintenance	Trans- portation							
Opening Cash Balance, 9- 1-65	\$ 7,914.99	\$ 26,868.83	\$ 11,682.85	\$ 4,646.07	\$ 26.96	\$ 134,761.16	\$ 14,687.58	\$ -0-	\$ -0-	\$ 200,588.44
Receipts:										
10 Local										
20 County Sources	\$ 408.70	\$ 589,903.13	\$	\$ 51,574.64	\$ 10,422.81	\$ 4,229.65	\$ 138,547.63	\$	\$	\$ 794,677.86
30 State Sources	91,446.84	17,034.03	10,330.00	9,152.67				18,221.40		146,184.94
40 Federal Sources										
50 Sale of Bonds										
60 Loans		17,000.00				5,000.00				17,000.00
70 Sale of Property										5,226.60
80 Incoming Transfers										
85 Interfund Transfers				354.20				2,142.97	1,735.05	3,878.02
Returned Checks										354.20
Investments Sold										320,000.00
Total Cash Receipts	\$ 91,855.54	\$ 863,937.16	\$ 10,556.60	\$ 61,081.51	\$ 10,422.81	\$ 9,229.65	\$ 218,547.63	\$ 20,364.37	\$ 1,735.05	\$ 1,287,730.32
Total Funds Available	\$ 99,770.53	\$ 890,805.99	\$ 22,239.45	\$ 65,727.58	\$ 10,449.77	\$ 143,990.81	\$ 233,235.21	\$ 20,364.37	\$ 1,735.05	\$ 1,488,318.76
Disbursements:										
Budgetary Disbursements	\$ 73,502.89	\$ 570,479.03	\$ 18,167.52	\$	\$	\$ 3,016.08	\$ 136,319.49	\$ 20,363.37	\$ 1,735.05	\$ 823,583.43
Retirement of Current Loans		17,000.00								17,000.00
Food Service Fund				62,524.71						62,524.71
Student Activity Fund					9,275.48					9,275.48
Interfund Transfers		3,878.02								3,878.02
Investments Purchased		240,000.00					80,000.00			320,000.00
Inventory Purchases										
Prior Year Payables Liquidated		6,833.13								6,833.13
Total Cash Disbursements	\$ 73,502.89	\$ 838,190.18	\$ 18,167.52	\$ 62,524.71	\$ 9,275.48	\$ 131,258.55	\$ 216,319.49	\$ 20,363.37	\$ 1,735.05	\$ 1,374,353.32
Closing Cash Balance, 8-31-66	\$ 26,267.64	\$ 52,615.81	\$ 4,071.93	\$ 3,202.87	\$ 1,174.29	\$ 9,716.18	\$ 16,915.72	\$ 1.00	\$ -0-	\$ 113,965.44
Less: Accounts Payable, 8-31-66	-0-	11,768.83	-0-	-0-	-0-	-0-	-0-	-0-	-0-	11,768.83
Unencumbered Cash Balance, 8-31-66	\$ 26,267.64	\$ 40,846.98	\$ 4,071.93	\$ 3,202.87	\$ 1,174.29	\$ 9,716.18	\$ 16,915.72	\$ 1.00	\$ -0-	\$ 102,196.61
Add: Accounts Receivable, 8-31-66		28,078.69								28,078.69
Temporary Investments and Time Deposits, Balances at 8-31-66		10,000.00					10,000.00			20,000.00
Unencumbered Fund Balance, 8-31-66	\$ 26,267.64	\$ 78,925.67	\$ 4,071.93	\$ 3,202.87	\$ 1,174.29	\$ 9,716.18	\$ 26,915.72	\$ 1.00	\$ -0-	\$ 150,275.30

County Agent's Report

by Robert Adamson

The 1967 edition of the Farmer's Tax Guide is now available in my office. If you would like a copy, please come by the office or call or drop me a card and I will mail you one. INVESTMENT TAX CREDIT SUSPENDED

There are several income tax changes this year that will affect farmers, ranchers and other self-employed people. According to James I. Mallett, Extension farm management specialist at Texas A&M University, there are two noteworthy suspensions.

First, the 7 percent investment tax credit on machinery and certain real property has been suspended on investments of over \$20,000 for the period Oct. 10, 1966 through Dec. 31, 1967.

Mallett says investments which otherwise qualify for the investment tax credit and were purchased during the current tax year and before the October 10 suspension, are still eligible for the tax credit. The tax credit can mean quite a reduction in income taxes since it's deducted directly from the amount of taxes to be paid.

However, taxpayers may still select up to \$20,000 of investments made during the suspension period (Oct. 10, 1966

-Dec. 31, 1967) to be eligible for the investment credit. Mallett says taxpayers need to de-

cide which tax year, the remainder of 1966, or all of 1967, to make investments up to \$20,000 for the investment tax credit.

The carryover period for unused investment credit has been extended from 5 to 7 years and the 3 year carry-back period is unchanged, he says.

Another suspension--the right to use rapid depreciation rates on buildings costing \$50,000 or more is suspended except for "buildings whose construction was begun before October 10, 1966, or where the taxpayer was under contracts in effect on October 9, 1966, calling for later construction."

The suspension applies only to property that would be used in a trade or a business--not property used for investment or rental purposes. The legislation does not affect the right to claim the 20 percent first year additional depreciation on tangible personal property with an expected useful life of six years or more for use in a trade or business.

In another change, the maximum amount of combined wages and self-employment earnings subject to social security tax has been increased from \$4,800 to \$6,600. This legislation did not affect the self-employment tax rate which is still 6.15 percent for the 1966 tax year, says Mallett.

The maximum amount of gross income which may be used by farmers reporting their self-employment tax by the option method has been increased from \$1,800 to \$2,400, says Mallett.

The gas tax refund of 6 cents per gallon on gasoline used on a farm for farming purposes must now be claimed as a tax credit on the annual income tax report and must be filed before the end of the tax reporting period, usually April 15. The tax credit has been extended to include the federal tax on lubricating oils, diesel and special motor fuels used other than in a highway vehicle. Gas tax credits will not be allowed on late reports.

Formerly, the gas tax refund period was July 1 to June 30 and claims were to be filed by September 30, according to the A&M specialist. Since this is the first full year for the new filing system, farmers will claim credit for federal tax on gasoline purchased since July 1, 1965. Tax credit on lubricating oils can be claimed from the beginning of 1966 on lubricating oils used other than in a highway vehicle.

For more information, see IRS publication No. 308, available from the District Director of Internal Revenue Service or your county agent.

Card of Thanks

A sincere thank you to all those who helped make our Christmas home tour a success.

Our special thanks to the home owners for their gracious gift of time and self in sharing their homes with us, to the

Holt News

Mr. and Mrs. Percy Hill and Bob Terry of Canadian were Sunday guests of Mr. and Mrs. Dan Terry.

Mrs. B.C. Holt was honored with a birthday party in her home Saturday afternoon, Dec. 10. Gifts were given to the honoree and refreshments were served to Mrs. Nolan Holt, Raymond Kirk, Fred Holt, O. C. Holt, C.W. Kirk, Bruce Fiedler, Travis Reger, Debra and Dale, Martha Batton, Dan Terry, John Campbell, Maude Rosson and Mrs. Holt.

Mr. and Mrs. Oliver Leverton of Odessa, Mrs. Don Chisum and Danny of Stinnett were Saturday luncheon guests of Mr. and Mrs. Dan Jackson. Mrs. Bergner and daughter of Stinnett visited in the afternoon.

Mr. and Mrs. Owen Pendergraft had a family reunion over the weekend of the Pendergrafts. It was the first time they had been together since their lost their mother four years ago. Present were Mrs. Frankie Forsythe of Phoenix, Ariz., Mr. and Mrs. Rymer of Winona, Mo., Mr. and Mrs. Lloyd Pendergraft of Wichita, Kans.

Mr. and Mrs. Dan Jackson were Sunday night guests of their daughter, Mr. and Mrs. Bob Phelps and family of Forgan, Okla.

newspapers for their publicity and to all who made the tour for their interest and enthusiasm. Spearman Study Club

Wonderland of Christmas Gifts

FOR THE WHOLE FAMILY
At our **Rexall** Drug Store

Jewelry Gifts

Diamond Pendants Brackets Earrings

Necklaces Grandmother's Pins

Men's & Ladies Jewelry Cases



Leather Goods For The Man & Woman

Bulova Watches

Colibri Lighters

Radios Razors

Pen & Pencil Sets

Pipes & Accessories

THE VOICE OF MUSIC

"ORIGINAL" PORTABLE COMPONENT SYSTEM



Model 369

design combines component styling with truly portable utility. Housing a powerful Solid State amplifier, the central unit sits on bookshelf or tabletop. The detachable matching speaker enclosures can be placed up to 16 feet apart for true stereo separation. Everything locks up into one compact case for carrying. Though small in size the 369 is an astonishing performer, with the two dual speaker systems and the transistors teaming up for music of remarkable scope. The "Stere-O-Matic" changer plays all four record speeds, stereo or mono in all popular sizes. The lightweight tubular tone arm carries an ultra-sensitive ceramic cartridge with a diamond LP stylus. Available in Metallic Olive or Walnut-grained vinyl. Dimensions (closed for carrying): 10 1/4" h. x 20" w. x 14" d.

VM Has the Stereo to please anyone at Christmas time.

Santa Claus has made us headquarters for Christmas shoppers. So come in and look over our VM Products.

WESTERN AUTO

Associate Store

Toys

Games

Chess Sets

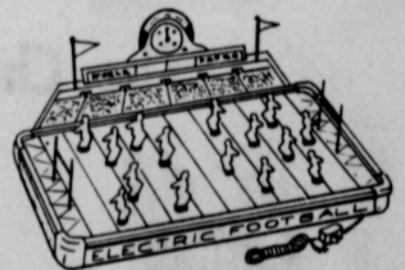

Adult Bookshelf Games

Tinkerbell Cosmetics For The Young Girls

Remember Our Many Fragrances

For Men & Women In Our

House of Fragrance

Spearman Rexall

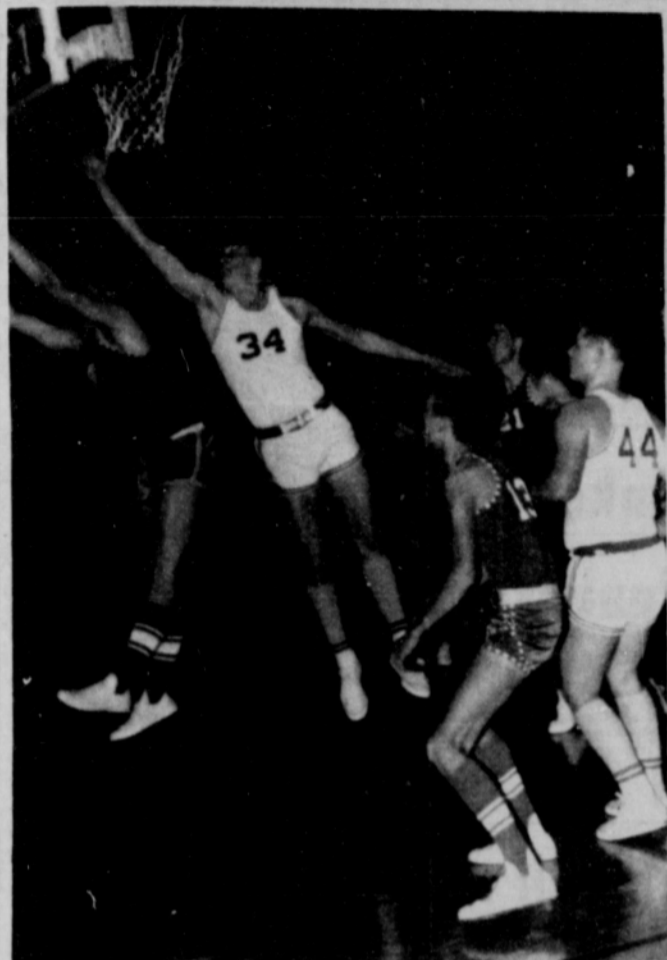

KEEP AWAY---A Sanford-Fritch Eagle keeps a rebound away from the outstretched hand of Lynx Charles Shield-knight (34). The other Lynx in the picture is Gary Faries (44). Fritch won the game.

Plainsman Photo

Annual Christmas Party Held By HD Club

The Town and Country HD Club met at the Larry Hays home Tuesday at 1 p. m. for the annual Christmas party and salad luncheon.

After the luncheon new officers for '67 were installed by Miss Linda Webb. Each new officer was presented a white rose as she was installed and instructed in the duties of the office. New officers are president, Louise Hawkins; vice president, Mary Lovett; secretary and reporter, Barbara Bell; trea-

surer; Linda Bodey; parliamentarian, Nellie Buchanan and Mary Lovett, council delegate.

Each member present gave a part on the program and all joined in singing Christmas carols, followed by a gift exchange.

Attending were Nedra Hays, Linda Webb, Sherry Anderson, Linda Bodey, Nellie Buchanan, Nelva White, Donetta Greene, Louise Hawkins, Jan Rinker, Barbara Bell and Mary Lovett.

B&PW Club Holds Special Meeting

At a special called meeting of the Business & Professional Women's Club Dec. 7 in the Hospitality room of the First State Bank, Elmon Jacobs, postmaster showed a 30 minute film titled "The Importance of Zip Codes."

Other guests were Ray Robertson, assistant postmaster, Kenneth Bailey and Freeman Barkley.

The club's project for the year is the sale of zip code books of which more will be available soon after Christmas.

After the film a business meeting was conducted by Le-

ona King. Plans were completed for the club Christmas party on Dec. 15 to be held at the Farm Bureau Building.

Attending were Leona King, Jennie Massad, Sammy Bishop, Luella Howerter, Ludie Mae Lovett, Ola Mae Henry, Juanita Kemper, Mildred Roles, Hazel Jackson, Evelyn Mackie and Dorothy Roden and the special guests.

Refreshments were served by Leona King and Ola Mae Henry.

Girl Scouts Work on Gifts

Girls of Junior Girl Scouts met Dec. 8 at the scout house. They worked on Christmas gifts for their mothers.

Attending were Linda Jordan, Gina Bulls, Linda Hamilton, Carma Burch, Debbie Gregg, Rhonda Nelson, Debrah Shelton, Nikki Jones, Debbie Sheppard, Cheryl Gibson, Debbie Simmons, Angela Craig and Sheila Cochran.

Leaders of the troop are Mmes. Shelton and Sheppard.

Pipkins Visit Over Holidays

Mr. and Mrs. John Pipkin left Wednesday for Greenville, S. Carolina, where they will pick up their son Richard, who attends Bob Jones University. They will then go on to visit their daughter, Betty and Bart Clifford in Ingersoll, Ontario during the Christmas holidays.

When they return from Canada they will visit their daughter, Pauline and Tom Mayes at Rochester, N. Y. before returning home.

Ola Mae Henry and Lou Howarter were in Shattuck Monday where Mrs. Howarter had a check-up. While there they visited Dot Jenkins and Mattie Ruth Grigsby, who are both patients in the Shattuck hospital.

Mr. and Mrs. Bud Beeson and Mr. and Mrs. Virgil Floyd drove to Shattuck and visited Dot Jenkins and Mattie Ruth Grigsby who are patients in the hospital. Both are doing nicely and expect to be home before long. After visiting in Shattuck Sunday afternoon, they drove to Woodward and visited Mr. and Mrs. Lee Grunewald.

Hansford Hospital News

Patients in Hansford Hospital this week are J.W. Williamson, Mary Cone, John Jasper, W.W. Weaver, Bill Miller, A. W. Mobley, Leonard Mackey, Ethel Davis, Alta Weikesser, Elsie Trolinder, Eva Holt, Albert Mackie, Sammy Arnold, Trudy Goodheart, Charles Riley, Vicki Mickler.

Dismissed were Rose Cassidy, Jackie Nichols, R.B. Anderson, Kay Hobbs and son, Venita Martin, Violet Mabrey, Nolan Lewis Crandall, W.W. Weaver, Linda Christie, Sammy Arnold (transferred to Amarillo).



WHERE IS IT--These Seventh graders from Spearman (in dark) and Sunray battle for a free ball under the Sunray basket. The Spearman girls went on to win the game.

Plainsman Photo



FINISHED SECOND--The Spearman Lynxettes finished second in the Gruver Tournament Saturday night. They lost the finals to Stratford. The Lynxettes had won the Shamrock tournament the previous week-end.

Plainsman Photo

PARKER

THAT PERFECT CHRISTMAS PRESENT

PARKER PENS \$3.95	PARKER PENCILS \$2.95
STAINLESS STEEL T-BALL TIP GIFT BOXED	
PARKER CUSTOM JOTTERS	\$2.95
PARKER SET	\$5.95
PARKER COMPACT JOTTERS	\$1.98

YOUR NEW HEADQUARTERS

CROSS PEN & PENCIL SETS

CENTURY . . . \$9.00

PLAINSMAN

OFFICE SUPPLY

209 MAIN

"Week-End Values for Friday & Saturday Dec. 16 & 17th"

Everybody SAVES at our Pre-Holiday Stock-Up SALE



Save Shurfresh
COUPONS FOR VALUABLE PRIZES ABSOLUTELY **Free**

Ellis Shelled 10 oz. Bag
Pecan Meats 87¢

Shurfine 303 size can
Fruit Cocktail 2 for 39¢

Hersheys 9 oz. Can
COCOA 33¢

Mortons Frozen 10 oz.
HONEY BUNS 25¢

Welchs Frozen 6 oz. Can
GRAPE JUICE 19¢

Durkees Premium Shred 14 oz. Bag
COCANUT 49¢

Shurfine Layer
CAKE MIXES & FROSTING MIXES 4 for 89¢

Dromedary Pitted lb. Box
Dates 45¢

Get ready for the Holiday feasting and merry-making and be SAVINGS ahead in the bargain . . . in the many, many fine food bargains featured in Cut Rate's Pre-Holiday STOCK-UP SALE! You'll find the traditional favorites sale-priced 'way down LOW to give you the BEST BUYS in holiday feasting supplies. HURRY OVER to Cut Rate's - where smart Santas come for quality foods to fill their pantry and BIG VALUES to stock up SAVINGS!

Viking 12 in. x 25 ft. roll
ALUMINUM FOIL 21¢

Lanes Parti-Time Half Gallon
Mellorine 37¢

Shurfresh Rich n Thick Quart
Egg Nog Mix 45¢

Shurfresh Fresh Creamy Rich 8 oz.
Whipping Cream 35¢

Shurfresh Thick Sliced Hickory Smoked
BACON 2 lb. Pkg. \$13.99

Top O' Texas All Meat
BOLOGNA 59¢ lb.

Lean & Meaty
BACK BONE Country Style lb. 69¢

USDA CHOICE BEEF lb.
RIB STEAK 79¢

Dessert Topping Large 4 oz. Box
DREAM WHIP 39¢

Gladiola 5 lb. Bag
FLOUR 47¢

Shurfresh 38 oz. Bottle
SALAD OIL 79¢

Aunt Jemima 24 oz. Bottle
WAFFLE SYRUP 57¢

Del Monte 303 size Can
Pumpkin 15¢

Hersheys Semi-Sweet 12 oz. Bag
CHOCOLATE CHIPS 39¢

Shurfresh Yellow Quarters 2 lb.
MARGARINE 39¢

Liberty Glace 4 oz.	29¢
CHERRIES	
Liberty Slices 4 oz.	29¢
PINEAPPLE	
Liberty Peel 4 oz.	23¢
ORANGE	
Liberty Peel 4 oz.	23¢
LEMONS	
Liberty Mixed 8 oz.	39¢
FRUIT	

Niblets Whole Kernel
Corn Vac. Pac 12 oz. Can 2 for 39¢

Shurfine Crushed no. 2 Can
Pineapple 2 for 49¢

Shurfine 2 lb. box
PANCAKE FLOUR 35¢

13¢ OFF
REGULAR PRICE
GIANT SIZE
TOP JOB ONLY 56¢

Shurfine 46 oz. Can
PINEAPPLE JUICE 25¢

Green Giant English 303 size can
PEAS 2 for 49¢

Shurfine Chunk
TUNA 3 for 89¢

Shurfine "More Good Flavor" lb. can
COFFEE 67¢



MAKE THIS YEARS GIFT FRUIT

Extra fancy Red Full Size Boxes Ready to Ship
RED DELICIOUS APPLES \$6.99

Extra large Navel Sunkist Full Size Box Ready to Ship
NAVEL ORANGES \$5.50

Florida Best Indian River Ready to Ship Full Size Box
RED GRAPEFRUIT \$4.75

US#1 Russett
POTATOES 10 lbs. 49¢

3¢ OFF
REGULAR PRICE



1 COMPLEXION SIZE ONLY
2 for 33¢



Cut Rate GROCERY



GOVERNOR-WATCHER—Ronnie Martinez, 3, of Austin observes Governor John Connally as he signs a proclamation of Christmas Seal Days in Texas until December 25. Ronnie took the visit with the Governor in a matter-of-fact way. He's learned to adapt rapidly to change. Ronnie and his baby sister, Lisa, are children of Mr. and Mrs. Edward Martinez. They are presently living with their paternal grandparents while their mother is recovering from TB at the Austin-Travis County Tuberculosis Hospital. Ronnie and Lisa surely hope their mother will get home for Christmas.

Bank Holds Annual Christmas Dinner

The First State Bank held the annual Christmas dinner for the husbands and wives of the directors and employees Tuesday evening, Dec. 6 at the hospitality room of the bank.

Sutphens of Borger catered the dinner from beautifully decorated tables carrying out the Christmas motif.

Various table games were enjoyed by the group following the dinner.

Attending were Messrs. and

Mmes. H.B. Hart, Don Hudson of Gruver, C.A. Gibner, Rex Sanders Sr., Peyton Gibner, Woody Gibner, Freeman Barkley, Paul Hazelwood, E. C. Abston, Gene Duryee, Lee Phillips, Larry Anthony, Sid Evans, Mrs. Dan Collins, Peggy Robinson and Verna Lee Schnell

My Neighbors



"Who knows what evil lurks in the hearts of men!"

The Shari River, Africa, rises about 1,000 miles from the ocean, follows a course equal in length to the Rhine, and ends 1,000 miles from the ocean--in Lake Chad.

Chesta Lieb Services Held

Chesta Ernest Lieb, 52, a lifelong resident of Hutchinson County, died Sunday after. on in Northwest Texas Hospital in Amarillo following a long illness.

A farmer and rancher, he had been a resident of Gruver 25 years. He was a member of the First Baptist Church.

Services were held Tuesday, Dec. 13 at 2 p.m. in the First Baptist Church of Gruver with Rev. Bill Butts officiating.

Interment was in Lieb cemetery with Minton Mortuary of Borger in charge.

Survivors include his wife, Clara, sons, Kenneth and Billy of Gruver; a daughter Mrs. Peggy Perryman of Alamogordo, N.M.; his parents, Mr. and Mrs. C.E. Lieb of Pringle; brother, Dean and Pete of Pringle and five grandchildren.

Driverless Auto Makes Tour of Main

A second driverless automobile made a tour of Main Street Wednesday morning and smashed into a traffic light pole in front of Edwards Fabrick Shop.

William H. Forrest of 202 S. Bernice parked his car in front of Spearman Rexall Drug Wednesday morning and left the motor running while he went in the store.

The car managed to get into reverse. It backed out from the curb, through the intersection of Main and Davis and hit the stop light pole. The stop light was snapped off.

Officers also investigated an accident last Thursday at the intersection of Hancock and Kenneth. Drivers of the vehicles were Kay Vernon of 520 S. Haney and Nellie Morley of 319 Archer. Officers estimated damage at \$60.

The longest possible length of time for a solar eclipse is 7 minutes and 40 seconds, and that on the equator, only. The longest recorded eclipse in continental United States occurred on September 10, 1923, and lasted for 3 minutes and 31 seconds.

France produces 435 kinds of cheese.

School . . .

(Cont. from page 1.)

throughout the five-state area to work in the program. One of the main centers would be established in Spearman.

The board also passed a motion that no children can be enrolled in the Spearman schools beginning with the second semester and each year thereafter who has not had a smallpox vaccination.

This is a restatement of policy of the school.

The parents of eight children attending Spearman schools met with the board, its attorney, J.D. Helms and Dr. Damon Gregg. The parents have not had their children vaccinated against smallpox because of religious beliefs.

Dr. Gregg pointed out to the board that should just one case of smallpox develop in the school, it could be closed for 18 days.

It was also brought out that the chance of smallpox is greater now with the larger number of workers moving into the area from Mexico.

The school administration, school nurse and school board have been working for several months with the parents to get them to have their children vaccinated.

T.G.&Y.®

5¢ TO 51¢ STORES

Open Until 8:00 p.m. every nite til Christmas

CHRISTMAS SPECIALS

72 x 90 1st Quality, Asst. Colors Reg. \$4.99 TG&Y Price

OPEN LATE UNTIL CHRISTMAS

Prices good while quantities last

Beacon Blanket \$3.66

Rose or Plaid Pattern TG&Y O Price Size 72 x 90 Reg. \$5.88

Cannon Blanket \$3.99

Cannon Belmont TG&Y Price Size 72 x 90 Reg. \$4.99

Thermal Blanket \$3.66

Ladies & Misses Reg. \$6.99, \$5.99 and \$4.66

Go-Go Boots pr. off \$2.00

26 pc. Reg. \$4.99 TG&Y Price

Punch Bowl Set \$3.66

Reg. \$12.88

Baby Secret Doll 8 only \$9.99

Scout with Foot Brake

Reg. \$15.88) TG&Y Price

Scout Wagon 2 only \$10.00

\$6.99 Value TG&Y Price

Early American Doll Cradle 5 only \$4.88

Reg. \$29.88 TG&Y Price

Large Stuffed Teddy Bear 1 only \$20.00

Stuffed

TG&Y Price Reg. \$8.99

Large Stuffed Dog 1 only \$6.66

Black Stuffed

Gorilla 1 only \$15.00

Reg. \$19.99 TG&Y Price

Stuffed

Donkey 1 only \$6.66

TG&Y Price Reg. \$8.88

Stuffed

Bulldog 1 only \$6.66

Reg. \$8.99

Stuffed

Tiger 2 only \$3.88

TG&Y Price Reg. \$4.99

w/Legs Reg. \$19.99

Pool Table 1 only \$17.88

Reg. \$5.99

Fiesta Guitar 6 only \$3.88

Long John Remco Motorized \$19.95 Value

Fire Truck 4 only \$10.00

Parker Bros. #246

Ping Pong Set 6 only \$2.99

Mattel Fighting Men, Creeple People, Creepy Crawlers

Thing Maker Sets 13 only \$7.88

Marx Reg. \$12.88

Electric Pinball Machine 1 only \$9.99

let action washer Reg. \$14.88

Suzy Homemaker 3 only \$11.88

Marx Reg. \$4.99

Beauty Vanity Set 5 only \$3.44

Values to \$1.49

Batman Toys Closeout 27¢ & 57¢

by Eldon

\$6.95 Value

Baby Joys Tiny Room 3 only \$3.44

use **Super MASQUE** a new ACRYLIC INTERIOR FINISH



Satin finish dries in 20 min. scrubbable... in 16 colors 12 intermixes, Sterling 12 Star Product!

STERLING 12 PAINT

White House Lumber Co.